

4

3

2

1

THIS DRAWING IS UNPUBLISHED. RELEASED FOR PUBLICATION. ALL RIGHTS RESERVED.

REVISIONS				
P	LYR	DESCRIPTION	DATE	DWN APVD
10		REVISED	05JUN2018	J. J. W. H.

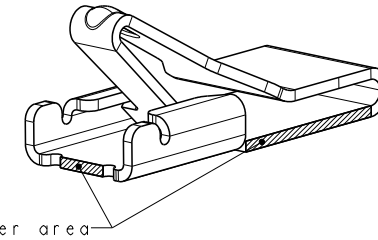
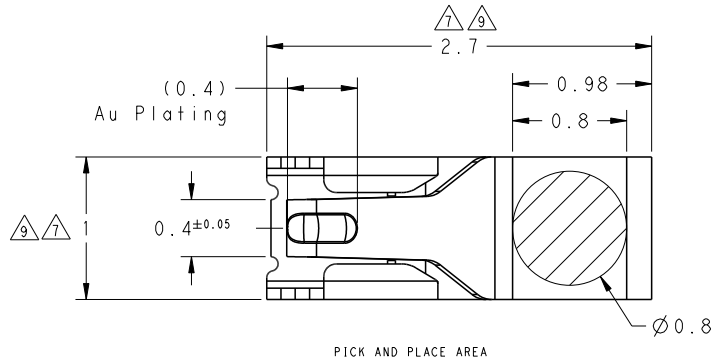

PICK AND PLACE AREA

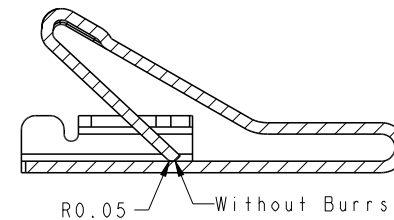
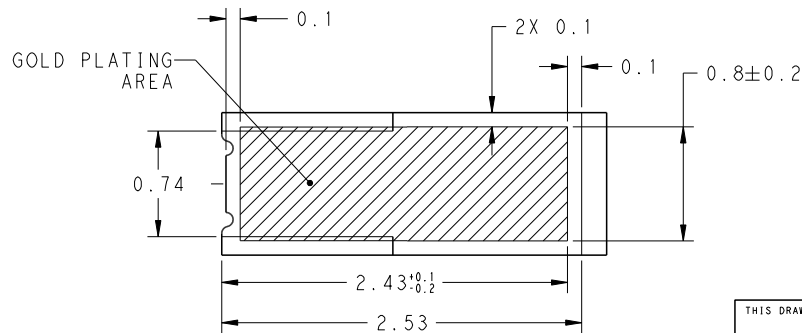
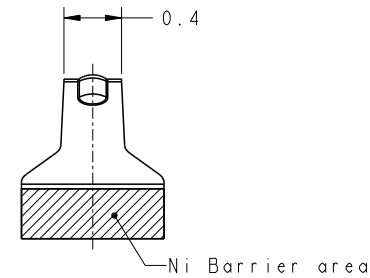
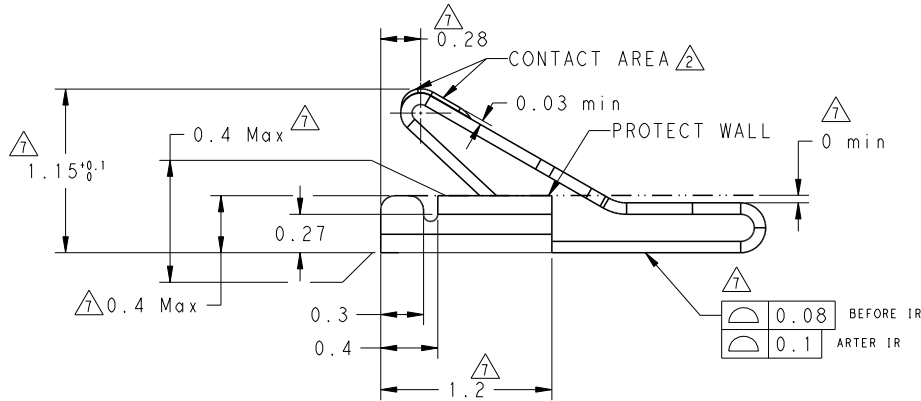
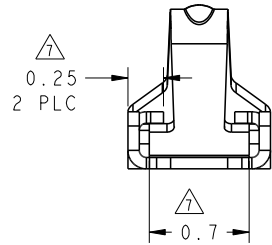

DESIGN APPROVED THIS PRINT IS  
**PRELIMINARY**  
 TO FIRST PIECE APPROVAL  
 CONTACT PRODUCT ENGINEERING  
 BEFORE USING THIS PRINT

2329497-1  
 PART NO.

THIS DRAWING IS A CONTROLLED DOCUMENT.		DWN JONE JJ 02JAN2018	TE Connectivity															
DIMENSIONS: mm		CHK WENKE HE 02JAN2018																
TOLERANCES UNLESS OTHERWISE SPECIFIED: ±0.1		APVD WENKE HE 02JAN2018	NAME 1.15H LOWER PROFILE SPRING FINGER															
<table border="1"> <tr><td>0-PLC</td><td>±0.1</td></tr> <tr><td>1-PLC</td><td>±0.1</td></tr> <tr><td>2-PLC</td><td>±0.04</td></tr> <tr><td>3-PLC</td><td>±0.04</td></tr> <tr><td>4-PLC</td><td>±0.004</td></tr> <tr><td>5-PLC</td><td>±0.004</td></tr> </table>		0-PLC	±0.1	1-PLC	±0.1	2-PLC	±0.04	3-PLC	±0.04	4-PLC	±0.004	5-PLC	±0.004	PRODUCT SPEC	SIZE	CAGE CODE	DRAWING NO	RESTRICTED TO
0-PLC	±0.1																	
1-PLC	±0.1																	
2-PLC	±0.04																	
3-PLC	±0.04																	
4-PLC	±0.004																	
5-PLC	±0.004																	
MATERIAL		APPLICATION SPEC	A2	-	©=2329497													
FINISH		WEIGHT	0.004g	SCALE	22:1	SHEET 1 OF 3												
		CUSTOMER DRAWING				REV 10												

4

3

2

1

THIS DRAWING IS UNPUBLISHED. RELEASED FOR PUBLICATION. ALL RIGHTS RESERVED.

REVISIONS				
P	LYR	DESCRIPTION	DATE	APVD
-	-	SEE SHEET 1	-	-

DESIGN APPROVED THIS PRINT IS  
**PRELIMINARY**  
 TO FIRST PIECE APPROVAL  
 CONTACT PRODUCT ENGINEERING  
 BEFORE USING THIS PRINT

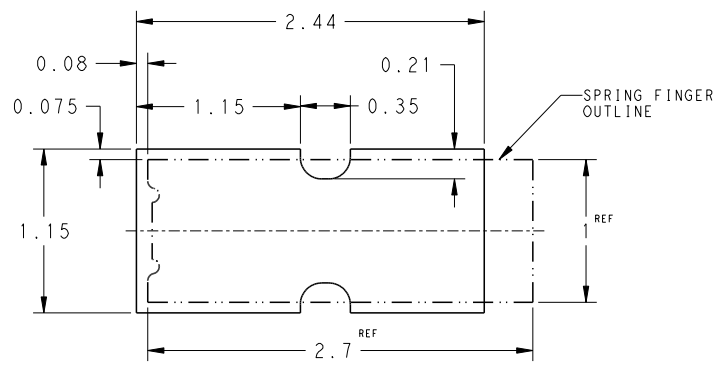
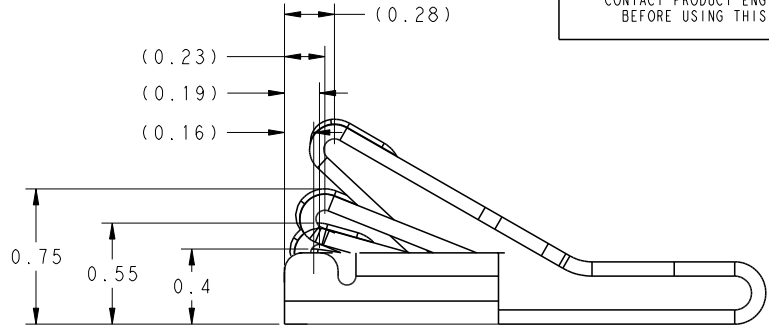

SCALE 40:1  
 RECOMMENDED PCB FOOTPRINT AND METAL MASK  
 TOL. ±0.02

NOTE:

- 1 MATERIAL: SUS301 K1500, THK: 0.08 mm.
- 2 FINISH:  
 NICKEL PLATE ALL OVER 0.002 mm~0.0076 mm THK.  
 GOLD PLATE AREA 0.00025 mm MIN. THK. AT CONTACT AREA;  
 GOLD PLATE AREA 0.000075~0.0002 mm MIN. THK.  
 AT SOLDERING AREA. NEED HAVE SEALING PROCESS AFTER PLATING.
- 3 PERMITTED BURR 0.05 mm MAX.
- 4 NFORCE OF 0.40~0.75mm 0.5N MIN. (READ FROM RETURNED CURVE)
- 5 WORKING POSITION: 0.4~0.75 mm.
- 6 LLCR: 30 mΩ MAX. AT INITIAL, AND THE CHANGED LLCR NOT GREATER THAN 20 mΩ AFTER TEST.
- 7 KEY CHARACTERISTIC PER STANDARD OPERATING PROCEDURE 407-55.
- 8 DURABILITY: 1500 CYCLES, THE NORMAL FORCE IS 0.4N MIN (READ FROM RETURN CURVE)
- 9 FEATURES IDENTIFIED AS STATISTICALLY TOLERANCED (ST) SHALL BE PRODUCED WITH STATISTICAL PROCESS CONTROLS.
- 10 SALT SPRAY SPEC: EIA-364-26B TEST CONDITION B 24H. PUT THE PRODUCT FLAT IN SALT SPRAY BOX. CONTACT AREA HAS NO CORROSION, DISCOLORING AND OTHER DEFECT.

REV	CHANGE LIST	DATA
1	INITIAL	02JAN2018
2	ADJUST CONTACT HEIGHT AND CUT LENGTH	12JAN2018
3	ADD QIP DIM, ADJUST CONTACT HEIGHT AND PLATING CONTROL SPEC	31JAN2018
4	ADJUST PLATING CONTROL SPEC	01FEB2018
5	ADD QIP CONTROL FOR COPLANARITY DIM	01FEB2018
6	ADJUST NI BARRIER CONTROL AREA	02FEB2018
7	ADJUST MATERIAL THICKNESS	07FEB2018
8	ADD QIP AND CPK CONTROL DIM	07FEB2018
9	ADJUST SOLDER PAD SPEC	14FEB2018
10	ADD SALT SPRAY SPEC AND SEALING PROCESS	05JUN2018

THIS DRAWING IS A CONTROLLED DOCUMENT.

DIMENSIONS: mm	TOLERANCES UNLESS OTHERWISE SPECIFIED:	DWN: JONE JI 02JAN2018	CHK: WENKE HL 02JAN2018	APVD: WENKE HL 02JAN2018	NAME: 1.15H LOWER PROFILE SPRING FINGER
MATERIAL: -	FINISH: -	PRODUCT SPEC: -	APPLICATION SPEC: -	WEIGHT: 0.004g	SIZE: A2
CUSTOMER DRAWING			SCALE: 22:1	SHEET: 2 of 3	REV: 10

TE Connectivity

4

3

2

1

THIS DRAWING IS UNPUBLISHED. RELEASED FOR PUBLICATION. ALL RIGHTS RESERVED.

REVISIONS				
P	LTN	DESCRIPTION	DATE	APVD
-	-	SEE SHEET 1	-	-

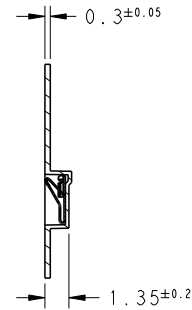
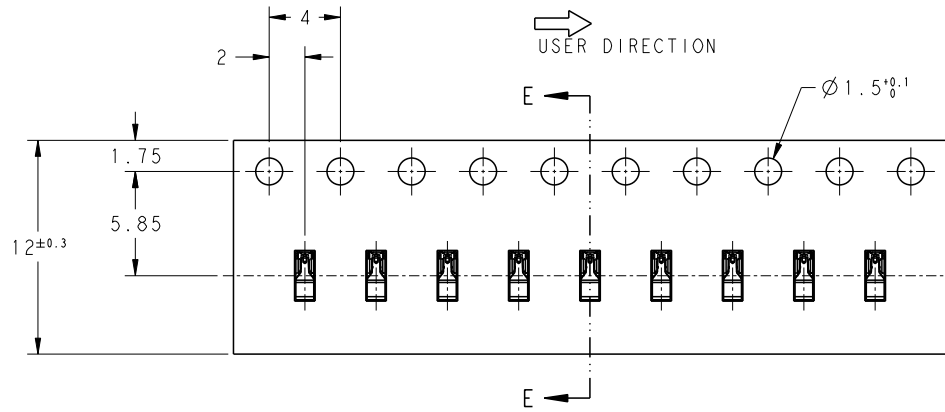

SECTION E-E

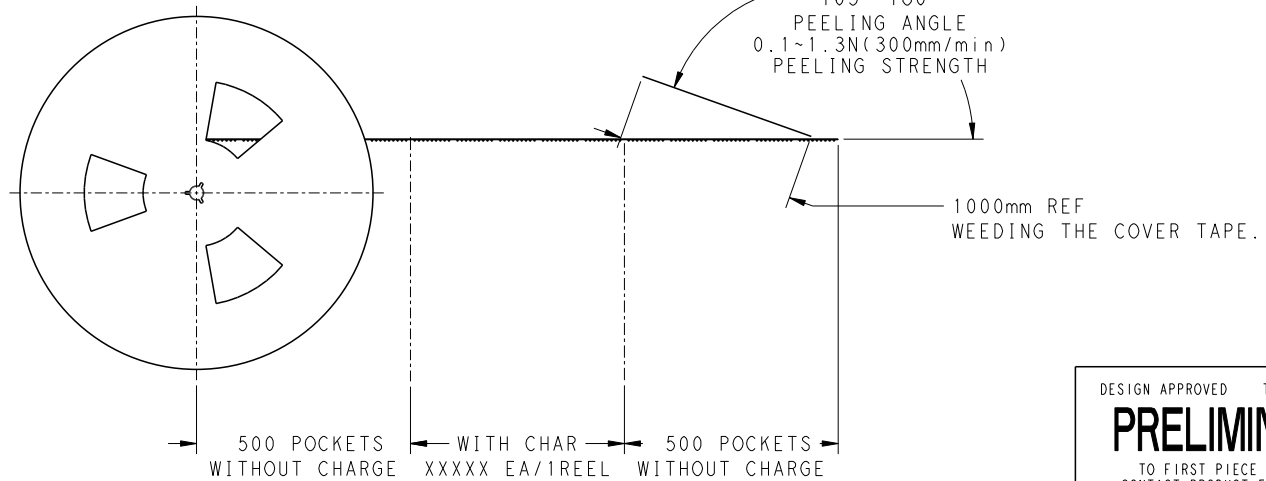
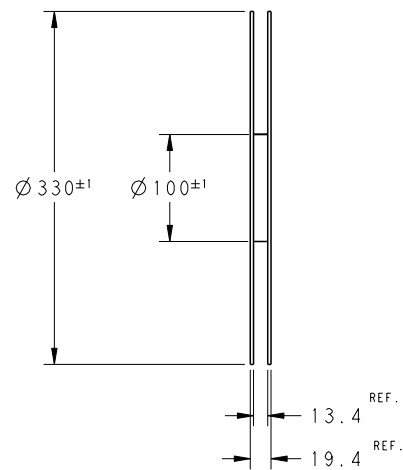

DESIGN APPROVED THIS PRINT IS  
**PRELIMINARY**  
 TO FIRST PIECE APPROVAL  
 CONTACT PRODUCT ENGINEERING  
 BEFORE USING THIS PRINT

NOTE:  
 PACKAGE QUANTITY: 10,000 PCS PER REEL.

THIS DRAWING IS A CONTROLLED DOCUMENT.		DWN: JONE JJ 02JAN2018	TE Connectivity	
DIMENSIONS: mm		CHK: WENKE HL 02JAN2018		
TOLERANCES UNLESS OTHERWISE SPECIFIED: $\pm 0.1$		APVD: WENKE HL 02JAN2018	NAME: 1.15H LOWER PROFILE SPRING FINGER	
		PRODUCT SPEC:	SIZE: A2	
MATERIAL:		APPLICATION SPEC:	CAGE CODE: -	
FINISH:		WEIGHT: 0.004g	DRAWING NO: C=2329497	
CUSTOMER DRAWING		SCALE: 22:1	RESTRICTED TO: 3 OF 3	
		SHEET: 3 OF 3	REV: 10	

## X-ON Electronics

Largest Supplier of Electrical and Electronic Components

*Click to view similar products for te connectivity manufacturer:*

Other Similar products are found below :

[570416-000](#) [CLTEQ-M81CE-SSRELAY-4-20V](#) [D38999/24FJ4AN](#) [358838-000](#) [4-1195131-0](#) [650069-000](#) [SMD100-2](#) [CB-1022B-78](#)  
[RM707012](#) [RP410012](#) [MMS42](#) [1-640426-8](#) [2EDL4CM](#) [DTS20W19-11PD-3028-LC](#) [RM202615](#) [NC6-P104-06](#) [TXR64AB90-3616AI](#)  
[MSPS103B](#) [DTS26F21-41AE](#) [DTS26F21-41PE-LC](#) [DTS26F21-11SE-3028-LC](#) [1932144-1](#) [293545-4](#) [LVR125S](#) [MS27466T25F4PB](#) [CKB-](#)  
[38-78010](#) [1206SFF150F/63-2](#) [5-2027513-8](#) [D38999/20JB35HA](#) [D38999/24WJ20PA](#) [1754138-1](#) [TE1500A2R2J](#) [DTS24F25-29PC-3028-LC](#)  
[164-8033-08](#) [D38999/24WG11HA](#) [D38999/24WG11HN](#) [MS27467T21F11H](#) [DJT16E21-11HA](#) [1206SFH150F/24-2](#) [1-532955-3](#) [DTS24F19-](#)  
[11SC-3028-LC](#) [DTS24F21-41HN-LC](#) [DTS24F21-41AN](#) [DTS24F21-41PN-LC](#) [DBAS 70-7-0 SN 090-1A SCC](#) [MS27467T21F35J](#)  
[MS27467T21F11J](#) [MS27467T21F16H-LC](#) [MS27467T21F35H](#) [MS27467T21F41H-LC](#)