

# MINIATURE SMD CHIP CHOKE COILS

闭磁路贴片电感

Shielded SMD Power Inductors

Operating Temp:-30℃ ~ 100℃



**特征:**

- 小尺寸与电极连接到铁芯直接。
- 利于磁屏蔽。
- 低直流电阻。
- 适合大电流。
- 可利用的磁带和自动卷轴表面的设置。

**FEATURES:**

- Small size with the electrode attached to the ferrite core directly.
- Available in magnetically shielded.
- Low DC resistance.
- Suitable for large currents.
- Available on tape and reel for auto surface mounting.

**用途:**

- 录像机。
- OA 仪器。
- 液晶电视。
- 笔记本计算机。
- 小型通信机器。
- DC/DC 变压器 DSC, DVC, MP3, PDA 等产。

**APPLICATIONS:**

- Power supply for VTRs.
- OA equipment
- LCD televisions.
- Notebook PCs.
- Portable communication equipment.
- DC/DC converters, DSC, DVC, MP3, PDA, products.

**产品型号:**

**PRODUCT IDENTIFICATION:**

**SMRH**

**5D28**

**220**

**N**

**T**

①

②

③

④

⑤

①

类型 Type	
SMRH	闭磁路贴片电感 Shielded SMT Power Inductors

②

外形尺寸(LxH) (mm) External Dimensions (LxWxH) (mm)	
5D28	5.7x5.7x3.0

③

Inductance
22 uH

④

Tolerance	
J: ±5%, K: ±10%, L: ±15%	
M: ±20%, P: ±25%, N: ±30%	

⑤

包装 Packing	
B	散装 Bulk Package
T	编带 Tape & Reel

Shape and Size(Dimension are in mm):

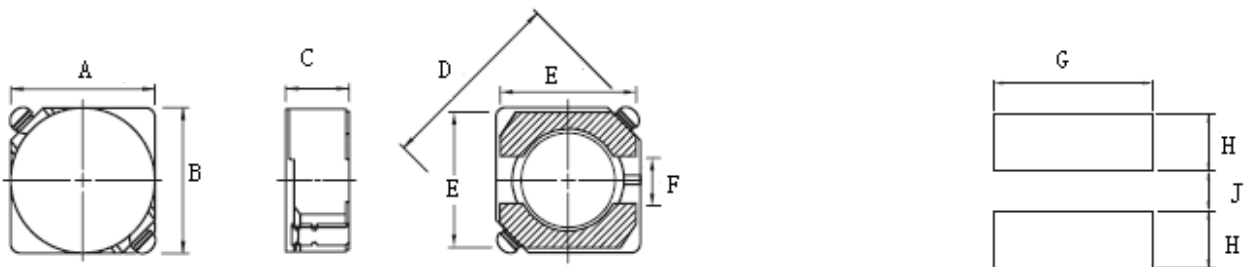

# MINIATURE SMD CHIP CHOKE COILS

Part No	A(max)	B(max)	C(max)	D(max)	E(max)	F	G	H	J
SMRH2D09	3.2	3.2	1.1	4.2	3.3	2.1	1.3	1.3	1.7
SMRH2D11	3.2	3.2	1.3	4.2	3.3	2.1	1.3	1.3	1.7
SMRH2D14	3.2	3.2	1.6	4.2	3.3	2.1	1.3	1.3	1.7
SMRH2D18	3.2	3.2	2.0	4.2	3.3	2.1	1.3	1.3	1.7
SMRH3D11	4.0	4.0	1.4	5.5	3.7	1.2	4.5	1.5	1.2
SMRH3D14	4.0	4.0	1.7	5.5	3.7	1.2	4.5	1.5	1.2
SMRH3D16	4.0	4.0	2.0	5.5	3.7	1.2	4.5	1.5	1.2
SMRH3D28	4.0	4.0	3.1	5.5	3.7	1.2	4.5	1.5	1.2
SMRH4D18	5.0	5.0	2.0	6.9	4.5	1.5	5.3	1.9	1.5
SMRH4D28	5.0	5.0	3.0	6.9	4.5	1.5	5.3	1.9	1.5
SMRH5D18	6.0	6.0	2.0	8.2	5.5	2.0	6.3	2.15	2.0
SMRH5D28	6.0	6.0	3.0	8.2	5.5	2.0	6.3	2.15	2.0
SMRH6D28	7.0	7.0	3.0	9.5	6.5	2.0	7.3	2.65	2.0
SMRH6D38	7.0	7.0	4.0	9.5	6.5	2.0	7.3	2.65	2.0

## SMRH2D09 Series

Part No.	Inductance (uH)			Quality Factor		DCR (OHM) Max	Rated DC Current (Amp)Max
	Nominal Value	Tole.	Test Freq.	Spec. Min	Test Freq.		
SMRH2D09-1R2N	1.2	N	100KHz	20	1MHz	0.097	0.80
SMRH2D09-1R5N	1.5	N	100KHz	20	1MHz	0.110	0.73
SMRH2D09-1R8N	1.8	N	100KHz	20	1MHz	0.131	0.65
SMRH2D09-2R2N	2.2	N	100KHz	20	1MHz	0.143	0.60
SMRH2D09-2R7N	2.7	N	100KHz	20	1MHz	0.150	0.53
SMRH2D09-3R3N	3.3	N	100KHz	20	1MHz	0.193	0.47
SMRH2D09-3R9N	3.9	N	100KHz	20	1MHz	0.225	0.45
SMRH2D09-4R7N	4.7	N	100KHz	30	1MHz	0.287	0.41
SMRH2D09-5R6N	5.6	N	100KHz	30	1MHz	0.325	0.37
SMRH2D09-6R8N	6.8	N	100KHz	30	1MHz	0.425	0.33
SMRH2D09-8R2N	8.2	N	100KHz	30	1MHz	0.475	0.30
SMRH2D09-100N	10	M	100KHz	35	1MHz	0.537	0.28
SMRH2D09-120 M	12	M	100KHz	35	1MHz		
SMRH2D09-150 M	15	M	100KHz	35	1MHz		
SMRH2D09-220 M	22	M	100KHz	35	1MHz		
SMRH2D09-330 M	33	M	100KHz	35	1MHz		
SMRH2D09-470 M	47	M	100KHz	35	1MHz		

# MINIATURE SMD CHIP CHOKE COILS

## SMRH2D11 Series

Part No.	Inductance (uH)			Quality Factor		DCR (OHM) Max	Rated DC Current (Amp)Max
	Nominal Value	Tole.	Test Freq.	Spec. Min	Test Freq.		
SMRH2D11-1R2N	1.2	N	100KHz	20	1MHz		
SMRH2D11-1R5N	1.5	N	100KHz	20	1MHz	0.068	0.90
SMRH2D11-1R8N	1.8	N	100KHz	20	1MHz		
SMRH2D11-2R2N	2.2	N	100KHz	20	1MHz	0.098	0.78
SMRH2D11-2R7N	2.7	N	100KHz	20	1MHz		
SMRH2D11-3R3N	3.3	N	100KHz	20	1MHz	0.132	0.60
SMRH2D11-3R9N	3.9	N	100KHz	20	1MHz		
SMRH2D11-4R7N	4.7	N	100KHz	30	1MHz	0.240	0.50
SMRH2D11-5R6N	5.6	N	100KHz	30	1MHz		
SMRH2D11-6R8N	6.8	N	100KHz	30	1MHz	0.360	0.44
SMRH2D11-8R2N	8.2	N	100KHz	30	1MHz		
SMRH2D11-100N	10	N	100KHz	35	1MHz	0.400	0.35
SMRH2D11-120 M	12	M	100KHz	35	1MHz		
SMRH2D11-150 M	15	M	100KHz	35	1MHz		
SMRH2D11-220 M	22	M	100KHz	35	1MHz		
SMRH2D11-330 M	33	M	100KHz	35	1MHz		
SMRH2D11-470 M	47	M	100KHz	35	1MHz		

## SMRH2D14 Series

Part No.	Inductance (uH)			Quality Factor		DCR (OHM) Max	Rated DC Current (Amp)Max
	Nominal Value	Tole.	Test Freq.	Spec. Min	Test Freq.		
SMRH2D14-1R2N	1.2	N	100KHz	20	1MHz		
SMRH2D14-1R5N	1.5	N	100KHz	20	1MHz	0.063	1.80
SMRH2D14-1R8N	1.8	N	100KHz	20	1MHz	0.075	1.65
SMRH2D14-2R2N	2.2	N	100KHz	20	1MHz	0.094	1.50
SMRH2D14-2R7N	2.7	N	100KHz	20	1MHz	0.106	1.35
SMRH2D14-3R3N	3.3	N	100KHz	20	1MHz	0.125	1.20
SMRH2D14-3R9N	3.9	N	100KHz	20	1MHz	0.138	1.10
SMRH2D14-4R7N	4.7	N	100KHz	30	1MHz	0.185	1.00
SMRH2D14-5R6N	5.6	N	100KHz	30	1MHz	0.220	0.95
SMRH2D14-6R8N	6.8	N	100KHz	30	1MHz	0.250	0.85
SMRH2D14-8R2N	8.2	N	100KHz	30	1MHz	0.281	0.80
SMRH2D14-100N	10	N	100KHz	35	1MHz	0.318	0.65
SMRH2D14-120 M	12	M	100KHz	35	1MHz	0.438	0.62
SMRH2D14-150 M	15	M	100KHz	35	1MHz		
SMRH2D14-220 M	22	M	100KHz	35	1MHz		
SMRH2D14-330 M	33	M	100KHz	35	1MHz		
SMRH2D14-470 M	47	M	100KHz	35	1MHz		

# MINIATURE SMD CHIP CHOKE COILS

## SMRH2D18Series

Part No.	Inductance (uH)			Quality Factor		DCR (OHM) Max	Rated DC Current (Amp)Max
	Nominal Value	Tole.	Test Freq.	Spec. Min	Test Freq.		
SMRH2D18-1R2N	1.2	N	100KHz	20	1MHz		
SMRH2D18-1R5N	1.5	N	100KHz	20	1MHz		
SMRH2D18-1R8N	1.8	N	100KHz	20	1MHz		
SMRH2D18-2R2N	2.2	N	100KHz	20	1MHz	0.041	0.85
SMRH2D18-2R7N	2.7	N	100KHz	20	1MHz		
SMRH2D18-3R3N	3.3	N	100KHz	20	1MHz	0.054	0.75
SMRH2D18-3R9N	3.9	N	100KHz	20	1MHz		
SMRH2D18-4R7N	4.7	N	100KHz	30	1MHz	0.078	0.63
SMRH2D18-5R6N	5.6	N	100KHz	30	1MHz		
SMRH2D18-6R8N	6.8	N	100KHz	30	1MHz	0.115	0.52
SMRH2D18-8R2N	8.2	N	100KHz	30	1MHz		
SMRH2D18-100N	10	N	100KHz	35	1MHz	0.180	0.43
SMRH2D18-120 M	12	M	100KHz	35	1MHz		
SMRH2D18-150 M	15	M	100KHz	35	1MHz	0.220	0.35
SMRH2D18-220 M	22	M	100KHz	35	1MHz	0.363	0.30
SMRH2D18-330 M	33	M	100KHz	35	1MHz	0.516	0.24
SMRH2D18-470 M	47	M	100KHz	35	1MHz	0.750	0.20

## SMRH3D11 Series

Part No.	Inductance (uH)			Quality Factor		DCR (OHM) Max	Rated DC Current (Amp)Max
	Nominal Value	Tole.	Test Freq.	Spec. Min	Test Freq.		
SMRH3D11-1R5N	1.5	N	100KHz	20	1MHz		
SMRH3D11-2R2N	2.2	N	100KHz	20	1MHz		
SMRH3D11-2R4N	2.4	N	100KHz	20	1MHz		
SMRH3D11-2R7N	2.7	N	100KHz	20	1MHz	0.105	0.53
SMRH3D11-3R2N	3.2	N	100KHz	20	1MHz		
SMRH3D11-3R3N	3.3	N	100KHz	20	1MHz		
SMRH3D11-4R7N	4.7	N	100KHz	30	1MHz	0.156	0.4
SMRH3D11-6R8N	6.8	N	100KHz	30	1MHz	0.225	0.34
SMRH3D11-8R2N	8.2	N	100KHz	30	1MHz	0.294	0.32
SMRH3D11-100N	10	N	100KHz	30	1MHz	0.338	0.28
SMRH3D11-120 M	12	M	100KHz	35	1MHz	0.418	0.25
SMRH3D11-150 M	15	M	100KHz	35	1MHz	0.550	0.23
SMRH3D11-180 M	18	M	100KHz	35	1MHz	0.626	0.21
SMRH3D11-220 M	22	M	100KHz	35	1MHz	0.731	0.19
SMRH3D11-330 M	33	M	100KHz	35	1MHz	1.108	0.17
SMRH3D11-390 M	39	M	100KHz	35	1MHz	1.390	0.15
SMRH3D11-470 M	47	M	100KHz	35	1MHz		0.14

# MINIATURE SMD CHIP CHOKE COILS

## SMRH3D14 Series

Part No.	Inductance (uH)			Quality Factor		DCR (OHM) Max	Rated DC Current (Amp)Max
	Nominal Value	Tole.	Test Freq.	Spec. Min	Test Freq.		
SMRH3D14-1R5N	1.5	N	100KHz	20	1MHz	0.076	2.6
SMRH3D14-2R2N	2.2	N	100KHz	20	1MHz		
SMRH3D14-2R4N	2.4	N	100KHz	20	1MHz	0.129	2.0
SMRH3D14-2R7N	2.7	N	100KHz	20	1MHz		
SMRH3D14-3R2N	3.2	N	100KHz	20	1MHz	0.139	1.8
SMRH3D14-3R3N	3.3	N	100KHz	20	1MHz		
SMRH3D14-4R7N	4.7	N	100KHz	30	1MHz	0.214	1.45
SMRH3D14-6R8N	6.8	N	100KHz	30	1MHz	0.290	1.20
SMRH3D14-8R2N	8.2	N	100KHz	30	1MHz		
SMRH3D14-100N	10	N	100KHz	30	1MHz	0.44	1.00
SMRH3D14-120 M	12	M	100KHz	35	1MHz		
SMRH3D14-150 M	15	M	100KHz	35	1MHz	0.65	0.80
SMRH3D14-180 M	18	M	100KHz	35	1MHz		
SMRH3D14-220 M	22	M	100KHz	35	1MHz	0.83	0.65
SMRH3D14-330 M	33	M	100KHz	35	1MHz		
SMRH3D14-390 M	39	M	100KHz	35	1MHz		
SMRH3D14-470 M	47	M	100KHz	35	1MHz		

## SMRH3D16 Series

Part No.	Inductance (uH)			Quality Factor		DCR (OHM) Max	Rated DC Current (Amp)Max
	Nominal Value	Tole.	Test Freq.	Spec. Min	Test Freq.		
SMRH3D16-1R5N	1.5	N	100KHz	20	1MHz	0.052	1.55
SMRH3D16-2R2N	2.2	N	100KHz	20	1MHz	0.072	1.20
SMRH3D16-2R4N	2.4	N	100KHz	20	1MHz		
SMRH3D16-2R7N	2.7	N	100KHz	20	1MHz		
SMRH3D16-3R2N	3.2	N	100KHz	20	1MHz		
SMRH3D16-3R3N	3.3	N	100KHz	20	1MHz	0.085	1.10
SMRH3D16-4R7N	4.7	N	100KHz	30	1MHz	0.105	0.90
SMRH3D16-6R8N	6.8	N	100KHz	30	1MHz	0.170	0.73
SMRH3D16-8R2N	8.2	N	100KHz	30	1MHz		
SMRH3D16-100N	10	N	100KHz	30	1MHz	0.210	0.55
SMRH3D16-120 M	12	M	100KHz	35	1MHz		
SMRH3D16-150 M	15	M	100KHz	35	1MHz	0.295	0.45
SMRH3D16-180 M	18	M	100KHz	35	1MHz		
SMRH3D16-220 M	22	M	100KHz	35	1MHz	0.430	0.40
SMRH3D16-330 M	33	M	100KHz	35	1MHz	0.675	0.32
SMRH3D16-390 M	39	M	100KHz	35	1MHz		
SMRH3D16-470 M	47	M	100KHz	35	1MHz		

# MINIATURE SMD CHIP CHOKE COILS

## SMRH3D28 Series

Part No.	Inductance (uH)			Quality Factor		DCR (OHM) Max	Rated DC Current (Amp)Max
	Nominal Value	Tole.	Test Freq.	Spec. Min	Test Freq.		
SMRH3D28-1R5N	1.5	N	100KHz	20	1MHz		
SMRH3D28-2R2N	2.2	N	100KHz	20	1MHz		
SMRH3D28-2R4N	2.4	N	100KHz	20	1MHz		
SMRH3D28-2R7N	2.7	N	100KHz	20	1MHz		
SMRH3D28-3R2N	3.2	N	100KHz	20	1MHz		
SMRH3D28-3R3N	3.3	N	100KHz	20	1MHz	0.072	2.0
SMRH3D28-4R7N	4.7	N	100KHz	30	1MHz	0.088	1.65
SMRH3D28-6R8N	6.8	N	100KHz	30	1MHz	0.119	1.24
SMRH3D28-8R2N	8.2	N	100KHz	30	1MHz		
SMRH3D28-100N	10	N	100KHz	30	1MHz	0.145	1.05
SMRH3D28-120 M	12	M	100KHz	35	1MHz		
SMRH3D28-150 M	15	M	100KHz	35	1MHz	0.213	0.90
SMRH3D28-180 M	18	M	100KHz	35	1MHz		
SMRH3D28-220 M	22	M	100KHz	35	1MHz	0.335	0.76
SMRH3D28-330 M	33	M	100KHz	35	1MHz	0.481	0.58
SMRH3D28-390 M	39	M	100KHz	35	1MHz		
SMRH3D28-470 M	47	M	100KHz	35	1MHz	0.599	0.48

## SMRH4D18 Series

Part No.	Inductance (uH)			Quality Factor		DCR (OHM) Max	Rated DC Current (Amp)Max
	Nominal Value	Tole.	Test Freq.	Spec. Min	Test Freq.		
SMRH4D18-1R0N	1.0	N	100KHz	20	1MHz	0.045	1.72
SMRH4D18-1R2N	1.2	N	100KHz	20	1MHz		
SMRH4D18-1R8N	1.8	N	100KHz	20	1MHz		
SMRH4D18-2R2N	2.2	N	100KHz	20	1MHz	0.075	1.32
SMRH4D18-2R6N	2.6	N	100KHz	20	1MHz		
SMRH4D18-2R7N	2.7	N	100KHz	20	1MHz	0.105	1.28
SMRH4D18-3R0N	3.0	N	100KHz	20	1MHz		
SMRH4D18-3R3N	3.3	N	100KHz	20	1MHz	0.110	1.04
SMRH4D18-3R9N	3.9	N	100KHz	20	1MHz	0.155	0.88
SMRH4D18-4R1N	4.1	N	100KHz	30	1MHz		
SMRH4D18-4R2N	4.2	N	100KHz	30	1MHz		
SMRH4D18-4R7N	4.7	N	100KHz	30	1MHz	0.162	0.84
SMRH4D18-5R0N	5.0	N	100KHz	30	1MHz		
SMRH4D18-5R3N	5.3	N	100KHz	30	1MHz		
SMRH4D18-5R4N	5.4	N	100KHz	30	1MHz		
SMRH4D18-5R6N	5.6	N	100KHz	30	1MHz	0.170	0.80
SMRH4D18-6R0N	6.0	N	100KHz	30	1MHz		
SMRH4D18-6R2N	6.2	N	100KHz	30	1MHz		
SMRH4D18-6R8N	6.8	N	100KHz	30	1MHz	0.200	0.76

# MINIATURE SMD CHIP CHOKE COILS

Part No.	Inductance (uH)			Quality Factor		DCR (OHM) Max	Rated DC Current (Amp)Max
	Nominal Value	Tole.	Test Freq.	Spec. Min	Test Freq.		
SMRH4D18-7R3N	7.3	N	100KHz	30	1MHz		
SMRH4D18-7R4N	7.4	N	100KHz	30	1MHz		
SMRH4D18-8R2N	8.2	N	100KHz	30	1MHz	0.245	0.68
SMRH4D18-8R6N	8.6	N	100KHz	30	1MHz		
SMRH4D18-8R7N	8.7	N	100KHz	30	1MHz		
SMRH4D18-8R9N	8.9	N	100KHz	30	1MHz	0.200	0.61
SMRH4D18-100N	10	N	100KHz	35	0.796MHz	0.210	0.56
SMRH4D18-120 M	12	M	100KHz	35	0.796MHz	0.240	0.50
SMRH4D18-150 M	15	M	100KHz	35	0.796MHz	0.338	0.48
SMRH4D18-180 M	18	M	100KHz	35	0.796MHz	0.397	0.41
SMRH4D18-220 M	22	M	100KHz	35	0.796MHz	0.441	0.35
SMRH4D18-270 M	27	M	100KHz	35	0.796MHz	0.694	0.32
SMRH4D18-330 M	33	M	100KHz	35	0.796MHz	0.709	0.30
SMRH4D18-390 M	39	M	100KHz	35	0.796MHz		
SMRH4D18-470 M	47	M	100KHz	35	0.796MHz		
SMRH4D18-560 M	56	M	100KHz	35	0.796MHz		
SMRH4D18-680 M	68	M	100KHz	35	0.796MHz		
SMRH4D18-820 M	82	M	100KHz	35	0.796MHz		
SMRH4D18-101 M	100	M	100KHz	40	0.796MHz		
SMRH4D18-121 M	120	M	100KHz	40	0.796MHz		
SMRH4D18-151 M	150	M	100KHz	40	0.796MHz		
SMRH4D18-181 M	180	M	100KHz	40	0.796MHz		

## SMRH4D28 Series

Part No.	Inductance (uH)			Quality Factor		DCR (OHM) Max	Rated DC Current (Amp)Max
	Nominal Value	Tole.	Test Freq.	Spec. Min	Test Freq.		
SMRH4D28-1R0N	1.0	N	100KHz	20	1MHz		
SMRH4D28-1R2N	1.2	N	100KHz	20	1MHz	0.023	2.56
SMRH4D28-1R8N	1.8	N	100KHz	20	1MHz	0.027	2.20
SMRH4D28-2R2N	2.2	N	100KHz	20	1MHz	0.031	2.04
SMRH4D28-2R6N	2.6	N	100KHz	20	1MHz		
SMRH4D28-2R7N	2.7	N	100KHz	20	1MHz	0.043	1.60
SMRH4D28-3R0N	3.0	N	100KHz	20	1MHz		
SMRH4D28-3R3N	3.3	N	100KHz	20	1MHz	0.049	1.57
SMRH4D28-3R9N	3.9	N	100KHz	20	1MHz	0.064	1.44
SMRH4D28-4R1N	4.1	N	100KHz	30	1MHz		
SMRH4D28-4R2N	4.2	N	100KHz	30	1MHz		
SMRH4D28-4R7N	4.7	N	100KHz	30	1MHz	0.072	1.32
SMRH4D28-5R0N	5.0	N	100KHz	30	1MHz		
SMRH4D28-5R3N	5.3	N	100KHz	30	1MHz		
SMRH4D28-5R4N	5.4	N	100KHz	30	1MHz		

# MINIATURE SMD CHIP CHOKE COILS

Part No.	Inductance (uH)			Quality Factor		DCR (OHM) Max	Rated DC Current (Amp)Max
	Nominal Value	Tole.	Test Freq.	Spec. Min	Test Freq.		
SMRH4D28-5R6N	5.6	N	100KHz	30	1MHz	0.100	1.17
SMRH4D28-6R0N	6.0	N	100KHz	30	1MHz		
SMRH4D28-6R2N	6.2	N	100KHz	30	1MHz		
SMRH4D28-6R8N	6.8	N	100KHz	30	1MHz	0.108	1.12
SMRH4D28-7R3N	7.3	N	100KHz	30	1MHz		
SMRH4D28-7R4N	7.4	N	100KHz	30	1MHz		
SMRH4D28-8R2N	8.2	N	100KHz	30	1MHz	0.117	1.04
SMRH4D28-8R6N	8.6	N	100KHz	30	1MHz		
SMRH4D28-8R7N	8.7	N	100KHz	30	1MHz		
SMRH4D28-8R9N	8.9	N	100KHz	30	1MHz		
SMRH4D28-100N	10	N	100KHz	35	1MHz	0.128	1.00
SMRH4D28-120 M	12	M	100KHz	35	1MHz	0.131	0.84
SMRH4D28-150 M	15	M	100KHz	35	1MHz	0.149	0.76
SMRH4D28-180 M	18	M	100KHz	35	1MHz	0.166	0.72
SMRH4D28-220 M	22	M	100KHz	35	1MHz	0.235	0.70
SMRH4D28-270 M	27	M	100KHz	35	1MHz	0.261	0.58
SMRH4D28-330 M	33	M	100KHz	35	1MHz	0.378	0.56
SMRH4D28-390 M	39	M	100KHz	35	1MHz	0.383	0.50
SMRH4D28-470 M	47	M	100KHz	35	1MHz	0.587	0.48
SMRH4D28-560 M	56	M	100KHz	35	1MHz	0.624	0.41
SMRH4D28-680 M	68	M	100KHz	35	1MHz	0.699	0.35
SMRH4D28-820 M	82	M	100KHz	35	1MHz	0.914	0.32
SMRH4D28-101 M	100	M	100KHz	40	0.796MHz	1.102	0.29
SMRH4D28-121 M	120	M	100KHz	40	0.796MHz	1.127	0.27
SMRH4D28-151 M	150	M	100KHz	40	0.796MHz	1.135	0.24
SMRH4D28-181M	180	M	100KHz	40	0.796MHz	1.154	0.22

## SMRH5D18 Series

Part No.	Inductance (uH)			Quality Factor		DCR (OHM) Max	Rated DC Current (Amp)Max
	Nominal Value	Tole.	Test Freq.	Spec. Min	Test Freq.		
SMRH5D18-1R0N	1.0	N	100KHz	20	1MHz		
SMRH5D18-1R2N	1.2	N	100KHz	20	1MHz		
SMRH5D18-1R8N	1.8	N	100KHz	20	1MHz		
SMRH5D18-2R2N	2.2	N	100KHz	20	1MHz		
SMRH5D18-2R6N	2.6	N	100KHz	20	1MHz		
SMRH5D18-2R7N	2.7	N	100KHz	20	1MHz		
SMRH5D18-3R0N	3.0	N	100KHz	20	1MHz		
SMRH5D18-3R3N	3.3	N	100KHz	20	1MHz		
SMRH5D18-3R9N	3.9	N	100KHz	20	1MHz		
SMRH5D18-4R1N	4.1	N	100KHz	30	1MHz	0.057	1.95
SMRH5D18-4R2N	4.2	N	100KHz	30	1MHz		



# MINIATURE SMD CHIP CHOKE COILS

Part No.	Inductance (uH)			Quality Factor		DCR (OHM) Max	Rated DC Current (Amp)Max
	Nominal Value	Tole.	Test Freq.	Spec. Min	Test Freq.		
SMRH5D18-4R7N	4.7	N	100KHz	30	1MHz		
SMRH5D18-5R0N	5.0	N	100KHz	30	1MHz		
SMRH5D18-5R3N	5.3	N	100KHz	30	1MHz	0.076	1.60
SMRH5D18-5R4N	5.4	N	100KHz	30	1MHz		
SMRH5D18-5R6N	5.6	N	100KHz	30	1MHz		
SMRH5D18-6R0N	6.0	N	100KHz	30	1MHz	0.096	1.40
SMRH5D18-6R2N	6.2	N	100KHz	30	1MHz		
SMRH5D18-6R8N	6.8	N	100KHz	30	1MHz		
SMRH5D18-7R3N	7.3	N	100KHz	30	1MHz		
SMRH5D18-7R4N	7.4	N	100KHz	30	1MHz		
SMRH5D18-8R2N	8.2	N	100KHz	30	1MHz		
SMRH5D18-8R6N	8.6	N	100KHz	30	1MHz		
SMRH5D18-8R7N	8.7	N	100KHz	30	1MHz		
SMRH5D18-8R9N	8.9	N	100KHz	30	1MHz	0.116	1.25
SMRH5D18-100N	10	N	100KHz	35	1MHz	0.124	1.20
SMRH5D18-120 M	12	M	100KHz	35	1MHz	0.153	1.10
SMRH5D18-150 M	15	M	100KHz	35	1MHz	0.196	0.97
SMRH5D18-180 M	18	M	100KHz	35	1MHz	0.210	0.85
SMRH5D18-220 M	22	M	100KHz	35	1MHz	0.290	0.80
SMRH5D18-270 M	27	M	100KHz	35	1MHz	0.330	0.75
SMRH5D18-330 M	33	M	100KHz	35	1MHz	0.386	0.65
SMRH5D18-390 M	39	M	100KHz	35	1MHz	0.520	0.57
SMRH5D18-470 M	47	M	100KHz	35	1MHz	0.595	0.54
SMRH5D18-560 M	56	M	100KHz	35	1MHz	0.665	0.50
SMRH5D18-680 M	68	M	100KHz	35	1MHz	0.840	0.43
SMRH5D18-820 M	82	M	100KHz	35	1MHz	0.978	0.41
SMRH5D18-101 M	100	M	100KHz	40	0.796MHz	1.200	0.36
SMRH5D18-121 M	120	M	100KHz	40	0.796MHz		
SMRH5D18-151 M	150	M	100KHz	40	0.796MHz		
SMRH5D18-181 M	180	M	100KHz	40	0.796MHz		

## SMRH5D28 Series

Part No.	Inductance (uH)			Quality Factor		DCR (OHM) Max	Rated DC Current (Amp)Max
	Nominal Value	Tole.	Test Freq.	Spec. Min	Test Freq.		
SMRH5D28-1R0N	1.0	N	100KHz	20	1MHz		
SMRH5D28-1R2N	1.2	N	100KHz	20	1MHz		
SMRH5D28-1R8N	1.8	N	100KHz	20	1MHz		
SMRH5D28-2R2N	2.2	N	100KHz	20	1MHz		
SMRH5D28-2R6N	2.6	N	100KHz	20	1MHz	0.018	2.60
SMRH5D28-2R7N	2.7	N	100KHz	20	1MHz		

# MINIATURE SMD CHIP CHOKE COILS

Part No.	Inductance (uH)			Quality Factor		DCR (OHM) Max	Rated DC Current (Amp)Max
	Nominal Value	Tole.	Test Freq.	Spec. Min	Test Freq.		
SMRH5D28-3R0N	3.0	N	100KHz	20	1MHz	0.024	2.40
SMRH5D28-3R3N	3.3	N	100KHz	20	1MHz		
SMRH5D28-3R9N	3.9	N	100KHz	20	1MHz		
SMRH5D28-4R1N	4.1	N	100KHz	30	1MHz		
SMRH5D28-4R2N	4.2	N	100KHz	30	1MHz	0.031	2.20
SMRH5D28-4R7N	4.7	N	100KHz	30	1MHz		
SMRH5D28-5R0N	5.0	N	100KHz	30	1MHz		
SMRH5D28-5R3N	5.3	N	100KHz	30	1MHz	0.038	1.90
SMRH5D28-5R4N	5.4	N	100KHz	30	1MHz		
SMRH5D28-5R6N	5.6	N	100KHz	30	1MHz		
SMRH5D28-6R0N	6.0	N	100KHz	30	1MHz		
SMRH5D28-6R2N	6.2	N	100KHz	30	1MHz	0.045	1.80
SMRH5D28-6R8N	6.8	N	100KHz	30	1MHz		
SMRH5D28-7R3N	7.3	N	100KHz	30	1MHz		
SMRH5D28-7R4N	7.4	N	100KHz	30	1MHz		
SMRH5D28-8R2N	8.2	N	100KHz	30	1MHz	0.053	1.60
SMRH5D28-8R6N	8.6	N	100KHz	30	1MHz		
SMRH5D28-8R7N	8.7	N	100KHz	30	1MHz		
SMRH5D28-8R9N	8.9	N	100KHz	30	1MHz		
SMRH5D28-100N	10	N	100KHz	35	1MHz	0.065	1.30
SMRH5D28-120 M	12	M	100KHz	35	1MHz	0.076	1.20
SMRH5D28-150 M	15	M	100KHz	35	1MHz	0.403	1.10
SMRH5D28-180 M	18	M	100KHz	35	1MHz	0.110	1.00
SMRH5D28-220 M	22	M	100KHz	35	1MHz	0.122	0.90
SMRH5D28-270 M	27	M	100KHz	35	1MHz	0.175	0.85
SMRH5D28-330 M	33	M	100KHz	35	1MHz	0.189	0.75
SMRH5D28-390 M	39	M	100KHz	35	1MHz	0.212	0.70
SMRH5D28-470 M	47	M	100KHz	35	1MHz	0.260	0.62
SMRH5D28-560 M	56	M	100KHz	35	1MHz	0.305	0.58
SMRH5D28-680 M	68	M	100KHz	35	1MHz	0.355	0.52
SMRH5D28-820 M	82	M	100KHz	35	1MHz	0.463	
SMRH5D28-101 M	100	M	100KHz	40	0.796MHz	0.520	0.42
SMRH5D28-121 M	120	M	100KHz	40	0.796MHz		
SMRH5D28-151 M	150	M	100KHz	40	0.796MHz		
SMRH5D28-181 M	180	M	100KHz	40	0.796MHz		

# MINIATURE SMD CHIP CHOKE COILS

## SMRH6D28 Series

Part No.	Inductance (uH)			Quality Factor		DCR (OHM) Max	Rated DC Current (Amp)Max
	Nominal Value	Tole.	Test Freq.	Spec. Min	Test Freq.		
SMRH6D28-1R2N	1.2	N	100KHz	20	1MHz		
SMRH6D28-1R8N	1.8	N	100KHz	20	1MHz		
SMRH6D28-2R2N	2.2	N	100KHz	20	1MHz		
SMRH6D28-2R7N	2.7	N	100KHz	20	1MHz		
SMRH6D28-3R0N	3.0	N	100KHz	20	1MHz		
SMRH6D28-3R3N	3.3	N	100KHz	20	1MHz	0.024	3.00
SMRH6D28-3R9N	3.9	N	100KHz	20	1MHz		
SMRH6D28-4R1N	4.1	N	100KHz	30	1MHz	0.027	2.60
SMRH6D28-4R2N	4.2	N	100KHz	30	1MHz		
SMRH6D28-4R7N	4.7	N	100KHz	30	1MHz		
SMRH6D28-5R0N	5.0	N	100KHz	30	1MHz	0.031	2.40
SMRH6D28-5R3N	5.3	N	100KHz	30	1MHz		
SMRH6D28-5R4N	5.4	N	100KHz	30	1MHz		
SMRH6D28-5R6N	5.6	N	100KHz	30	1MHz		
SMRH6D28-6R0N	6.0	N	100KHz	30	1MHz	0.035	2.25
SMRH6D28-6R2N	6.2	N	100KHz	30	1MHz		
SMRH6D28-6R8N	6.8	N	100KHz	30	1MHz		
SMRH6D28-7R3N	7.3	N	100KHz	30	1MHz	0.054	2.10
SMRH6D28-7R4N	7.4	N	100KHz	30	1MHz		
SMRH6D28-8R2N	8.2	N	100KHz	30	1MHz		
SMRH6D28-8R6N	8.6	N	100KHz	30	1MHz	0.058	1.85
SMRH6D28-8R7N	8.7	N	100KHz	30	1MHz		
SMRH6D28-8R9N	8.9	N	100KHz	30	1MHz		
SMRH6D28-100N	10	N	100KHz	35	1MHz	0.065	1.70
SMRH6D28-120 M	12	M	100KHz	35	1MHz	0.07	1.55
SMRH6D28-150 M	15	M	100KHz	35	1MHz	0.084	1.40
SMRH6D28-180 M	18	M	100KHz	35	1MHz	0.095	1.32
SMRH6D28-220 M	22	M	100KHz	35	1MHz	0.128	1.20
SMRH6D28-270 M	27	M	100KHz	35	1MHz	0.142	1.05
SMRH6D28-330 M	33	M	100KHz	35	1MHz	0.165	0.97
SMRH6D28-390 M	39	M	100KHz	35	1MHz	0.210	0.86
SMRH6D28-470 M	47	M	100KHz	35	1MHz	0.238	0.80
SMRH6D28-560M	56	M	100KHz	35	1MHz	0.277	0.73
SMRH6D28-680 M	68	M	100KHz	35	1MHz	0.304	0.65
SMRH6D28-820 M	82	M	100KHz	35	1MHz	0.390	0.60
SMRH6D28-101 M	100	M	100KHz	40	0.796MHz	0.535	0.54
SMRH6D28-121 M	120	M	100KHz	40	0.796MHz		
SMRH6D28-151 M	150	M	100KHz	40	0.796MHz		
SMRH6D28-181 M	180	M	100KHz	40	0.796MHz		

# MINIATURE SMD CHIP CHOKE COILS

## SMRH6D38 Series

Part No.	Inductance (uH)			Quality Factor		DCR (OHM) Max	Rated DC Current (Amp)Max
	Nominal Value	Tole.	Test Freq.	Spec. Min	Test Freq.		
SMRH6D38-1R0N	1.0	N	100KHz	20	1MHz		
SMRH6D38-1R2N	1.2	N	100KHz	20	1MHz		
SMRH6D38-1R8N	1.8	N	100KHz	20	1MHz		
SMRH6D38-2R2N	2.2	N	100KHz	20	1MHz		
SMRH6D38-2R7N	2.7	N	100KHz	20	1MHz		
SMRH6D38-3R0N	3.0	N	100KHz	20	1MHz		
SMRH6D38-3R3N	3.3	N	100KHz	20	1MHz	0.020	3.50
SMRH6D38-3R9N	3.9	N	100KHz	20	1MHz		
SMRH6D38-4R1N	4.1	N	100KHz	30	1MHz		
SMRH6D38-4R2N	4.2	N	100KHz	30	1MHz		
SMRH6D38-4R7N	4.7	N	100KHz	30	1MHz		
SMRH6D38-5R0N	5.0	N	100KHz	30	1MHz	0.024	2.90
SMRH6D38-5R3N	5.3	N	100KHz	30	1MHz		
SMRH6D38-5R4N	5.4	N	100KHz	30	1MHz		
SMRH6D38-5R6N	5.6	N	100KHz	30	1MHz		
SMRH6D38-6R0N	6.0	N	100KHz	30	1MHz		
SMRH6D38-6R2N	6.2	N	100KHz	30	1MHz	0.027	2.50
SMRH6D38-6R8N	6.8	N	100KHz	30	1MHz		
SMRH6D38-7R3N	7.3	N	100KHz	30	1MHz		
SMRH6D38-7R4N	7.4	N	100KHz	30	1MHz	0.031	2.30
SMRH6D38-8R2N	8.2	N	100KHz	30	1MHz		
SMRH6D38-8R6N	8.6	N	100KHz	30	1MHz		
SMRH6D38-8R7N	8.7	N	100KHz	30	1MHz	0.034	2.20
SMRH6D38-8R9N	8.9	N	100KHz	30	1MHz		
SMRH6D38-100N	10	N	100KHz	35	1MHz	0.038	2.00
SMRH6D38-120 M	12	M	100KHz	35	1MHz	0.053	1.70
SMRH6D38-150 M	15	M	100KHz	35	1MHz	0.057	1.60
SMRH6D38-180 M	18	M	100KHz	35	1MHz	0.092	1.50
SMRH6D38-220 M	22	M	100KHz	35	1MHz	0.096	1.30
SMRH6D38-270 M	27	M	100KHz	35	1MHz	0.109	1.20
SMRH6D38-330 M	33	M	100KHz	35	1MHz	0.124	1.10
SMRH6D38-390 M	39	M	100KHz	35	1MHz	0.138	1.00
SMRH6D38-470 M	47	M	100KHz	35	1MHz	0.155	0.95
SMRH6D38-560 M	56	M	100KHz	35	1MHz	0.202	0.85
SMRH6D38-680 M	68	M	100KHz	35	1MHz	0.234	0.75
SMRH6D38-820 M	82	M	100KHz	35	1MHz	0.324	0.70
SMRH6D38-101 M	100	M	100KHz	40	0.796MHz	0.358	0.62
SMRH6D38-121 M	120	M	100KHz	40	0.796MHz		
SMRH6D38-151M	150	M	100KHz	40	0.796MHz		
SMRH6D38-181 M	180	M	100KHz	40	0.796MHz		

## X-ON Electronics

Largest Supplier of Electrical and Electronic Components

*Click to view similar products for [Fixed Inductors](#) category:*

*Click to view products by [SXN](#) manufacturer:*

Other Similar products are found below :

[MLZ1608M6R8WTD25](#) [MLZ1608N6R8LT000](#) [MLZ1608N3R3LTD25](#) [MLZ1608N3R3LT000](#) [MLZ1608N150LT000](#)

[MLZ1608M150WTD25](#) [MLZ1608M3R3WTD25](#) [MLZ1608M3R3WT000](#) [MLZ1608M150WT000](#) [MLZ1608A1R5WT000](#)

[MLZ1608N1R5LT000](#) [B82432C1333K000](#) [PCMB053T-1R0MS](#) [PCMB053T-1R5MS](#) [PCMB104T-1R5MS](#) [CR32NP-100KC](#) [CR32NP-](#)

[151KC](#) [CR32NP-180KC](#) [CR32NP-181KC](#) [CR32NP-1R5MC](#) [CR32NP-390KC](#) [CR32NP-3R9MC](#) [CR32NP-680KC](#) [CR32NP-820KC](#)

[CR32NP-8R2MC](#) [CR43NP-390KC](#) [CR43NP-560KC](#) [CR43NP-680KC](#) [CR54NP-181KC](#) [CR54NP-470LC](#) [CR54NP-820KC](#) [CR54NP-8R5MC](#)

[MGDQ4-00004-P](#) [MGDU1-00016-P](#) [MHL1ECTTP18NJ](#) [MHL1JCTTD12NJ](#) [PE-51506NL](#) [PE-53601NL](#) [PE-53630NL](#) [PE-53824SNLT](#) [PE-](#)

[62892NL](#) [PE-92100NL](#) [PG0434.801NLT](#) [PG0936.113NLT](#) [PM06-2N7](#) [PM06-39NJ](#) [HC2LP-R47-R](#) [HC2-R47-R](#) [HC3-2R2-R](#) [HC8-1R2-R](#)