

REV.	A2	EN1202060018	2012.02.06	陈锦展	X.XXX±0.15
DESCRIPTION	DATE	NAME			X.XXX±0.05
					X.X±0.25
					ANGLE
					GENERAL TOLERANCE
					2006.05.31
					李勤
					校正一
					2006.05.31
					APPROVED BY
					1 : 1
					1 of 2
					mm
					SCALE
					SHEET
TITLE: 1.25mm PITCH 90° SINGLE ROW WAFER-SMT TYPE					
DRAW NO.: A1252WR-SF-XP					
REV. A2					



**JOINT TECH ELECTRONIC IND. CO., LTD.**  
 燦達電子工業股份有限公司

Circuit		Dimensions	
No.	A	B	C
02P	1.25	4.15	6.25
03P	2.50	5.40	7.50
04P	3.75	6.65	8.75
05P	5.00	7.90	10.00
06P	6.25	9.15	11.25
07P	7.50	10.40	12.50
08P	8.75	11.65	13.75
09P	10.00	12.90	15.00
10P	11.25	14.15	16.25
11P	12.50	15.40	17.50
12P	13.75	16.65	18.75
13P	15.00	17.90	20.00
14P	16.25	19.15	21.25
15P	17.50	20.40	22.50

**SPECIFICATIONS**  
 Current Rating: 1A AC,D.C  
 Voltage Rating: 150V AC,D.C  
 Temperature Range: -25°C ~ +85°C  
 Contact Resistance: 30mΩ Max.  
 Insulation Resistance: 500MΩ Min.  
 Withstanding Voltage: 500V AC/minute  
 Pin Material: Brass/Gold-flash  
 Solder Tabs: Phosphor Bronze/Gold-flash  
 Material: Nylon 6T,UL94V-0  
 Color: Natural(Beige)

- ① Series No.  
 ② Connector type: WR=Right angle  
 ③ Mounting type: SF=SMT with boss  
 ④ No. of circuits  
 ⑤ Option code:  
 D01=Contacts/Gold-flash and Solder tabs/Gold-flash

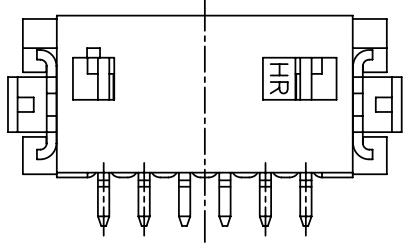
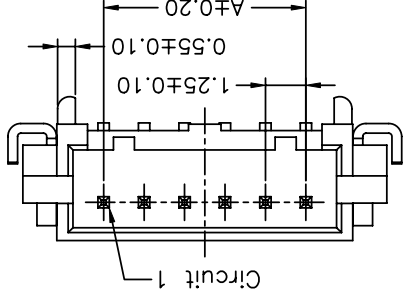
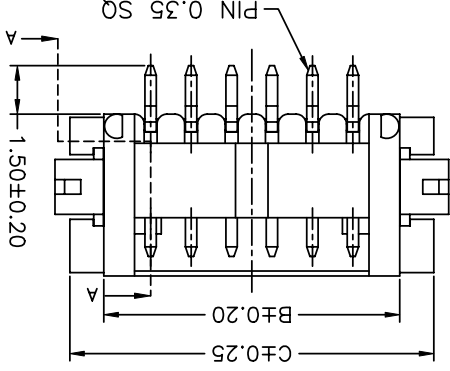
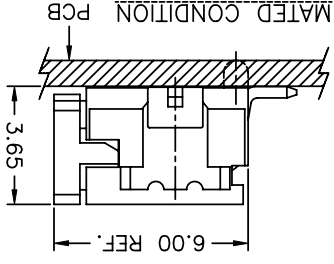
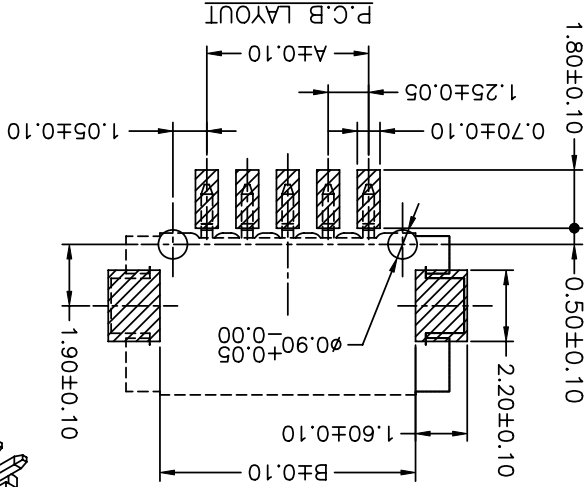
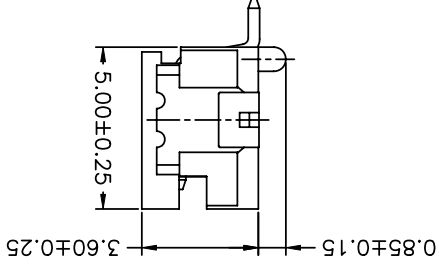
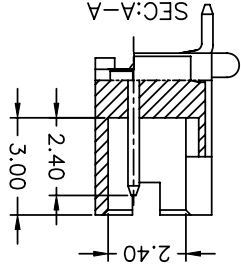
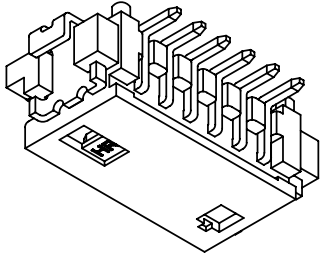
A1252 WR-SF-XP XXX  
 ① ② ③ ④ ⑤



## X-ON Electronics

Largest Supplier of Electrical and Electronic Components

*Click to view similar products for [Headers & Wire Housings](#) category:*

*Click to view products by [Joint manufacturer](#):*

Other Similar products are found below :

[95000-104TRLF](#) [10135584-644402LF](#) [DF62W-EP2022PCA](#) [95000-106TRLF](#) [DF62W-2022SCA](#) [DF62W-EP2022PC](#) [2203348](#) [DF62W-2022SC](#) [1084018](#) [1029039](#) [1084017](#) [802-10-012-10-002000](#) [1112640](#) [1112639](#) [891-007-9SS-BST1T](#) [000-34000](#) [0008550134](#) [0009482033](#) [0009507031](#) [57102-F02-18ULF](#) [57102-S06-03LF](#) [57202-S52-04LF](#) [PCN6-15S-2.5E](#) [0039019024](#) [58102-G61-06LF](#) [582553-1](#) [0009485154](#) [0009508121](#) [0022285053](#) [0050291907](#) [018731A](#) [LY20-4P-DT1-P1E-BR](#) [02.125.8002.8](#) [60101931](#) [60598-1 \(Cut Strip\)](#) [M1625-3R/100](#) [61062-3](#) [61082-181009](#) [CSU011177004](#) [636-1427](#) [638009-1](#) [641938-9](#) [641991-4](#) [644168-1](#) [644827-2](#) [647662-1](#) [65039-019ELF](#) [65692-001LF](#) [65781-018](#) [65781-047](#)