

Recommended P.C.B Layout(Top Side)
(PCB BOARD TOLERANCE±0.05)

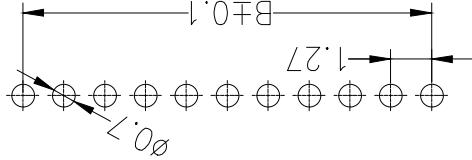

Ordering Information

13 10-11 XX X N XX S XXX 0 01

- 10=H1.0mm Plastic high
- 01~50P No. of Pins Per Row
- Insulator Material
- A=PTI
- B=PA6T
- C=PA6I
- D=PA66
- F=LCP
- G1~G10=Gold
- G11~G15=Gold
- G21~G25=Gold
- G3~G4=Gold
- G5~G6=Gold
- G7~G10=Gold
- S0=Gold Flash/Tin
- SK=Tin
- Pin Length 115=11.5mm
- Contact Plating G00,G01
- Packing 0=PE Bag
- M=Reel+Mylor
- R=Reel+Cap
- P=Tube+Cap
- A=Tray
- G1~G15=Gold
- G21~G25=Gold
- G3~G4=Gold
- G5~G6=Gold
- G7~G10=Gold
- S0=Gold Flash/Tin
- SK=Tin
- code stream 01~99

Dimension antitheses list	
ITEM	Alternate
PA	3.90
PC	2.30
L	7.20

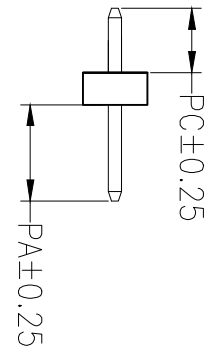

Dimensions	Per row	
	A	B
Contacts	26	26
Dimensions	33.02	31.75
Contacts	34.29	33.02
Dimensions	35.56	34.29
Contacts	36.83	35.56
Dimensions	38.10	36.83
Contacts	39.37	38.10
Dimensions	40.64	39.37
Contacts	41.91	40.64
Dimensions	43.18	41.91
Contacts	44.45	43.18
Dimensions	45.72	44.45
Contacts	46.99	45.72
Dimensions	48.26	46.99
Contacts	49.53	48.26
Dimensions	50.80	49.53
Contacts	52.07	50.80
Dimensions	53.34	52.07
Contacts	54.61	53.34
Dimensions	55.88	54.61
Contacts	57.15	55.88
Dimensions	58.42	57.15
Contacts	59.69	58.42
Dimensions	60.96	59.69
Contacts	62.23	60.96
Dimensions	63.50	62.23

Dimensions List

SPECIFICATIONS
 Rated Current:1.0AMP
 Contact Resistance:20mΩ Max
 Withstand Voltage:500V AC/DC
 Insulation Resistance:1000MΩ Min
 Operation Temperature:-40°C to +105°C
 Contact Material:Brass
 Contact Plating:Au or Sn Over Ni
 Insulator Material:Polyester(UL94V-0)
 Standard: PA6T
 Max.Processing Temp: 230°C for 30-60 seconds
 (260°C for 10 seconds)

深圳市华宇创精密电子有限公司

HOUBC

TOLERANCE:
 X.X ±0.30
 X.XX ±0.25
 X.XXX ±0.15
 X.X ±2
 X.X' ±0.5'

UNIT: mm [inch]

SCALE: 1:1 SIZE: A4

DRAWN BY: 陈一鸣	CHECKED BY: 马跃	APPROVED BY:	DATE: 2014-02-23
PART NAME: 1.27X1.0PH 1XNP 180° L7.2	PART NO.: 1310-11XXNXSXXX001	MOLD NO.:	DATE: 2014-02-23
DATE: 2014-02-23	DATE: 2014-02-23	DATE: 2014-02-23	SHEET NO.: 1 OF 1
DRAWN BY: 陈一鸣		APPROVED BY:	
DATE: 2014-02-23		DATE: 2014-02-23	
PART NO.: 1310-11XXNXSXXX001		DRAW NO.: HYC-1812011018	

X-ON Electronics

Largest Supplier of Electrical and Electronic Components

Click to view similar products for [Headers & Wire Housings](#) category:

Click to view products by [HOAUC](#) manufacturer:

Other Similar products are found below :

[95000-104TRLF](#) [10135584-644402LF](#) [DF62W-EP2022PCA](#) [95000-106TRLF](#) [DF62W-2022SCA](#) [DF62W-EP2022PC](#) [2203348](#) [DF62W-2022SC](#) [1084018](#) [1029039](#) [1084017](#) [802-10-012-10-002000](#) [1112640](#) [1112639](#) [891-007-9SS-BST1T](#) [000-34000](#) [0008550134](#) [0009482033](#) [0009507031](#) [57102-F02-18ULF](#) [57102-S06-03LF](#) [57202-S52-04LF](#) [PCN6-15S-2.5E](#) [0039019024](#) [58102-G61-06LF](#) [582553-1](#) [0009485154](#) [0009508121](#) [0022285053](#) [0050291907](#) [018731A](#) [LY20-4P-DT1-P1E-BR](#) [02.125.8002.8](#) [60101931](#) [60598-1 \(Cut Strip\)](#) [M1625-3R/100](#) [61062-3](#) [61082-181009](#) [CSU011177004](#) [636-1427](#) [638009-1](#) [641938-9](#) [641991-4](#) [644168-1](#) [644827-2](#) [647662-1](#) [65039-019ELF](#) [65692-001LF](#) [65781-018](#) [65781-047](#)