

**SPECIFICATIONS**

Rated Current:3.0AMP  
 Contact Resistance:20mΩ Max  
 Withstand Voltage:1000V AC/DC  
 Insulation Resistance:1000MΩ Min  
 Operation Temperature:-40°C to +105°C  
 Contact Material:Brass  
 Contact Plating:Au or Sn Over Ni  
 Insulator Material:Polyester(UL94V-0)  
 Standard: PA6T  
 Max.Processing Temp: 230°C for 30-60 seconds  
 (260°C for 10 seconds)

Dimensions List

Contacts		A		B	
Dimensions		A		B	
2*1	2.94	0	2*21	53.74	50.80
2*2	5.48	2*22	56.28	53.34	
2*3	8.02	2*23	58.82	55.88	
2*4	10.56	2*24	61.36	58.42	
2*5	13.10	2*25	63.90	60.96	
2*6	15.64	2*26	66.44	63.50	
2*7	18.18	2*27	68.98	66.04	
2*8	20.72	2*28	71.52	68.58	
2*9	23.26	2*29	74.06	71.12	
2*10	25.80	2*30	76.60	73.66	
2*11	28.34	2*31	79.14	76.20	
2*12	30.88	2*32	81.68	78.74	
2*13	33.42	2*33	84.22	81.28	
2*14	35.96	2*34	86.76	83.82	
2*15	38.50	2*35	89.30	86.36	
2*16	41.04	2*36	91.84	88.90	
2*17	43.58	2*37	94.38	91.44	
2*18	46.12	2*38	96.92	93.98	
2*19	48.66	2*39	99.46	96.52	
2*20	51.20	2*40	102.00	99.06	

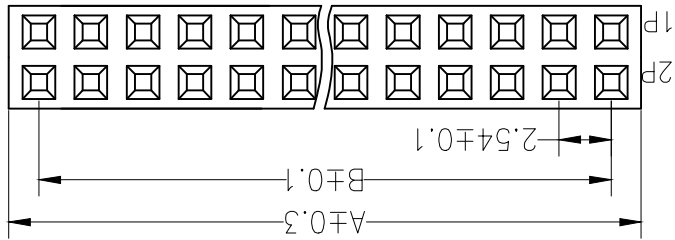

Recommended P.C.B Layout(Top Side)  
 (PCB BOARD TOLERANCE±0.05)

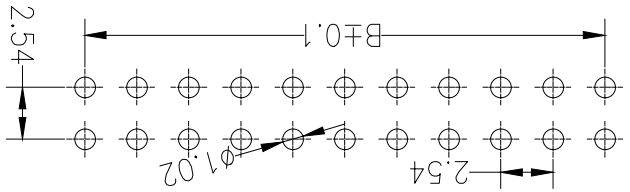

**Ordering Information**

26 85 Y-2 XX X W XX S N X 01

- 85=H8.5mm Plastic high
- Per Row 01~40P
- No.of Pins Insulator Material Option W=with Post
- Post
- Contact Plating
- G1:1U" Gold
- G2:1.5U" Gold
- G3:2U" Gold
- G4:3U" Gold
- G5:5U" Gold
- G6:10U" Gold
- G7:15U" Gold
- S0:Gold Flash/Tin
- SN:tin
- A=Troy
- Q=PE Bag
- Packing code stream 01~99
- M=Reel+Mylor
- R=Reel+Cap
- P=Tube+Cap
- D=PA66
- C=PA6T
- E=PA46
- F=LCP

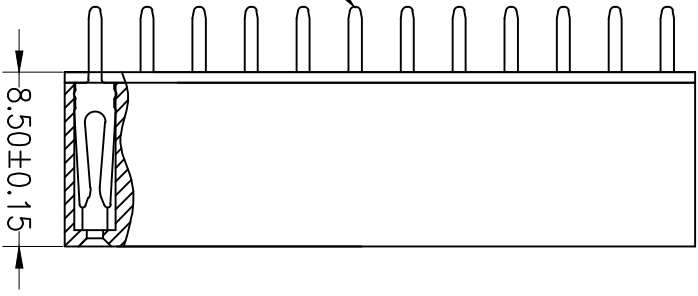
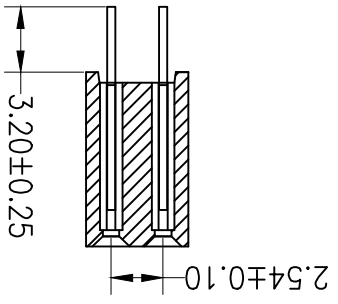

深圳市华宇创精密电子有限公司



PART NAME:		DRAWN BY: 陈一鸣		DATE: 2014-02-23		CHECKED BY: 马跃		DATE: 2014-02-23		MOLD NO.		DRAW NO. HYC-1812011109		SHEET NO. 1 OF 1	
TOLERANCE:		X.X ±0.30		X.XX ±0.25		X.X' ±0.15		X.X' ±2		X.X' ±0.5		UNIT: mm [inch]		SCALE:1:1 SIZE: A4	

## X-ON Electronics

Largest Supplier of Electrical and Electronic Components

*Click to view similar products for [Headers & Wire Housings](#) category:*

*Click to view products by [HOAUC](#) manufacturer:*

Other Similar products are found below :

[95000-104TRLF](#) [10135584-644402LF](#) [DF62W-EP2022PCA](#) [95000-106TRLF](#) [DF62W-2022SCA](#) [DF62W-EP2022PC](#) [2203348](#) [DF62W-2022SC](#) [1084018](#) [1029039](#) [1084017](#) [802-10-012-10-002000](#) [1112640](#) [1112639](#) [891-007-9SS-BST1T](#) [000-34000](#) [0008550134](#) [0009482033](#) [0009507031](#) [57102-F02-18ULF](#) [57102-S06-03LF](#) [57202-S52-04LF](#) [PCN6-15S-2.5E](#) [0039019024](#) [58102-G61-06LF](#) [582553-1](#) [0009485154](#) [0009508121](#) [0022285053](#) [0050291907](#) [018731A](#) [LY20-4P-DT1-P1E-BR](#) [02.125.8002.8](#) [60101931](#) [60598-1 \(Cut Strip\)](#) [M1625-3R/100](#) [61062-3](#) [61082-181009](#) [CSU011177004](#) [636-1427](#) [638009-1](#) [641938-9](#) [641991-4](#) [644168-1](#) [644827-2](#) [647662-1](#) [65039-019ELF](#) [65692-001LF](#) [65781-018](#) [65781-047](#)