

SPECIFICATIONS

Rated Current:3.0AMP
 Contact Resistance:20mΩ Max
 Withstand Voltage:1000V AC/DC
 Insulation Resistance:1000MΩ Min
 Operation Temperature:-40°c to +105°c
 Contact Material:Brass
 Contact Plating:Au or Sn Over Ni
 Insulator Material:Polyester(UL94V-0)
 Standard: PA6T
 Max.Processing Temp: 230°C for 30-60 seconds
 (260°C for 10 seconds)

Dimensions List

Contacts		A		B	
Dimensions	A	B	Dimensions	A	B
2*1	2.94	0	2*21	53.74	50.80
2*2	5.48	2.54	2*22	56.28	53.34
2*3	8.02	5.08	2*23	58.82	55.88
2*4	10.56	7.62	2*24	61.36	58.42
2*5	13.10	10.16	2*25	63.90	60.96
2*6	15.64	12.70	2*26	66.44	63.50
2*7	18.18	15.24	2*27	68.98	66.04
2*8	20.72	17.78	2*28	71.52	68.58
2*9	23.26	20.32	2*29	74.06	71.12
2*10	25.80	22.86	2*30	76.60	73.66
2*11	28.34	25.40	2*31	79.14	76.20
2*12	30.88	27.94	2*32	81.68	78.74
2*13	33.42	30.48	2*33	84.22	81.28
2*14	35.96	33.02	2*34	86.76	83.82
2*15	38.50	35.56	2*35	89.30	86.36
2*16	41.04	38.10	2*36	91.84	88.90
2*17	43.58	40.64	2*37	94.38	91.44
2*18	46.12	43.18	2*38	96.92	93.98
2*19	48.66	45.72	2*39	99.46	96.52
2*20	51.20	48.26	2*40	102.00	99.06

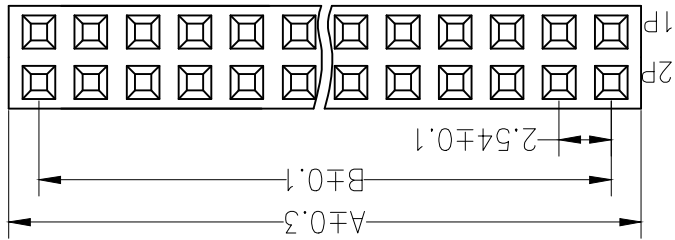

Recommended P.C.B Layout(Top Side)
 (PCB BOARD TOLERANCE±0.05)

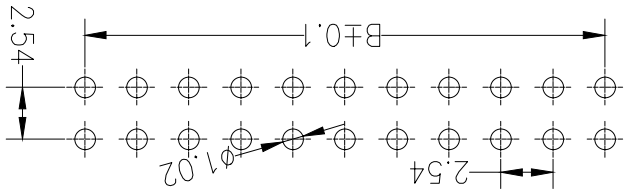

Ordering Information

26 85 Y-2 XX X W XX S N X 01

85=H8.5mm Plastic high
 Per Row 01~40P
 No.of Pins Insulator Material
 Post Option W=with Post
 Contact Plating
 G1:1U" Gold
 G0:0.8U" Gold
 A=Troy
 0=PE Bag
 Packing code stream 01~99

F=LCP
 E=PA9T
 D=PA46
 C=PA6T
 B=PA66
 G2:1.5U" Gold
 G3:2U" Gold
 G4:3U" Gold
 G5:5U" Gold
 G6:10U" Gold
 G7:15U" Gold
 S0:Gold Flash/Tin
 SN:tin

M=Reel+Mylar
 P=Tube+Cap
 R=Reel+Cap
 T=Tube

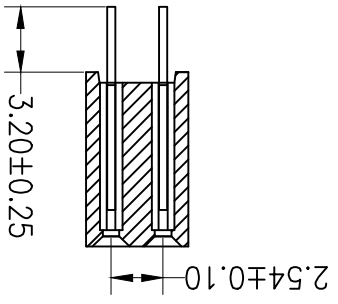
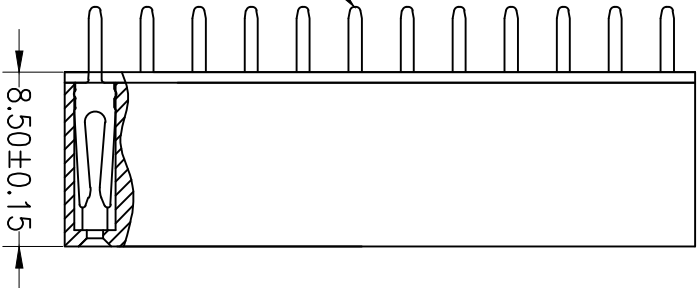

深圳市华宇创精密电子有限公司



PART NAME:		2.54X8.5FH 2XNPIN 180° Y型	
DRAWN BY:	陈一鸣	DATE:	2014-02-23
CHECKED BY:	马跃	DATE:	2014-02-23
APPROVED BY:		DATE:	
SHEET NO. 1 OF 1		DRAW NO. HYC-1812011109	

TOLERANCE:	X.X ±0.30 X.XX ±0.25 X.XX ±0.15
UNIT: mm [inch]	
SCALE:1:1	SIZE: A4

X-ON Electronics

Largest Supplier of Electrical and Electronic Components

Click to view similar products for [Headers & Wire Housings](#) category:

Click to view products by [HOAUC](#) manufacturer:

Other Similar products are found below :

[95000-104TRLF](#) [10135584-644402LF](#) [DF62W-EP2022PCA](#) [95000-106TRLF](#) [DF62W-2022SCA](#) [DF62W-EP2022PC](#) [2203348](#) [DF62W-2022SC](#) [1084018](#) [1029039](#) [1084017](#) [802-10-012-10-002000](#) [1112640](#) [1112639](#) [891-007-9SS-BST1T](#) [000-34000](#) [0008550134](#) [0009482033](#) [0009507031](#) [57102-F02-18ULF](#) [57102-S06-03LF](#) [57202-S52-04LF](#) [PCN6-15S-2.5E](#) [0039019024](#) [58102-G61-06LF](#) [582553-1](#) [0009485154](#) [0009508121](#) [0022285053](#) [0050291907](#) [018731A](#) [LY20-4P-DT1-P1E-BR](#) [02.125.8002.8](#) [60101931](#) [60598-1 \(Cut Strip\)](#) [M1625-3R/100](#) [61062-3](#) [61082-181009](#) [CSU011177004](#) [636-1427](#) [638009-1](#) [641938-9](#) [641991-4](#) [644168-1](#) [644827-2](#) [647662-1](#) [65039-019ELF](#) [65692-001LF](#) [65781-018](#) [65781-047](#)