

# CDM/CDH SERIES

DIP

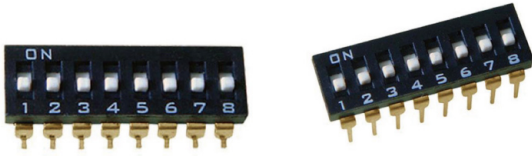

## HOW TO ORDER

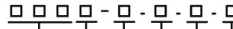

**Package Style:**  
 □ = Tube  
 T/R= Tape & Reel

**Soldering:**  
 V = Lead Free Solderable

**Seal:**  
 □ = Regular  
 T = Top Tape Sealed <Recessed Actuator Only>

**Number Of Positions:**  
 01 = 1 Position  
 02 = 2 Position  
 03 = 3 Position  
 04 = 4 Position  
 05 = 5 Position  
 06 = 6 Position  
 07 = 7 Position  
 08 = 8 Position  
 09 = 9 Position  
 10 = 10 Position  
 12 = 12 Position

**Actuator Type:**  
 □ = Raised Actuator  
 R = Recessed Actuator

CDH = Through Hole Type Dip Switch  
 CDM = Gull Wing Terminal S.M.T

TACT

## SPECIFICATIONS

- Mechanical life:2000 operations per switch
- Operation Force:1000gf max.
- Stroke :1.0mm
- Operation Temp:-20°C to 70°C
- Electrical life:2000 operations per switch-24 VDC, 25mA
- Contact Resistance:100m max. at initial
- Non-Switching Rating:100mA, 50VDC
- Switching Rating:25mA, 24VDC
- Circuit:Single pole single throw

LED TACT

PUSH BUTTON

TOGGLE

## CDM SERIES SLIDE TYPE

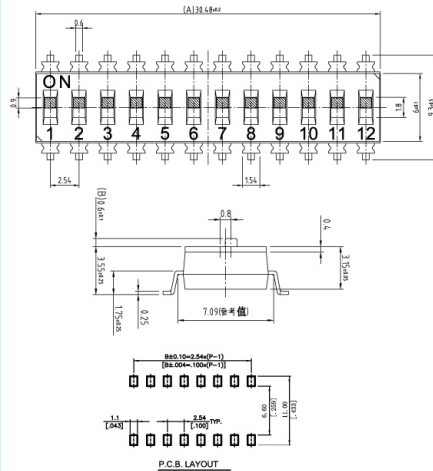
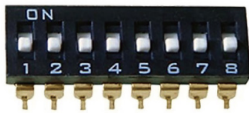

| MODEL NO. | NO. POS | A     |
|-----------|---------|-------|
| CDM-02    | 2       | 2.54  |
| CDM-03    | 3       | 5.08  |
| CDM-04    | 4       | 7.62  |
| CDM-05    | 5       | 10.16 |
| CDM-06    | 6       | 12.70 |
| CDM-07    | 7       | 15.24 |
| CDM-08    | 8       | 17.78 |
| CDM-09    | 9       | 20.32 |
| CDM-10    | 10      | 22.86 |
| CDM-12    | 12      | 25.40 |

Schematic(TYP.)  
  
 (2,3,4,5,6,7,8,9,10,12, POS AVAIL)

SLIDE

## CONTACT SYSTEM

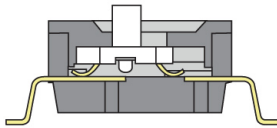

ROCKER

## CDH SERIES SLIDE TYPE

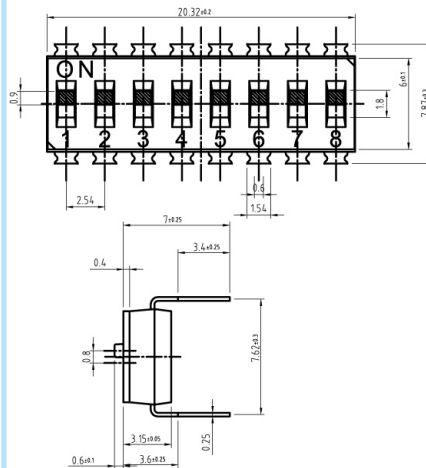
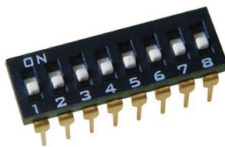

| MODEL NO. | NO. POS | A     |
|-----------|---------|-------|
| CDH-02    | 2       | 2.54  |
| CDH-03    | 3       | 5.08  |
| CDH-04    | 4       | 7.62  |
| CDH-05    | 5       | 10.16 |
| CDH-06    | 6       | 12.70 |
| CDH-07    | 7       | 15.24 |
| CDH-08    | 8       | 17.78 |
| CDH-09    | 9       | 20.32 |
| CDH-10    | 10      | 22.86 |
| CDH-12    | 12      | 25.40 |

Schematic(TYP.)  
  
 (2,3,4,5,6,7,8,9,10,12, POS AVAIL)

MICRO / POWER

## CONTACT SYSTEM

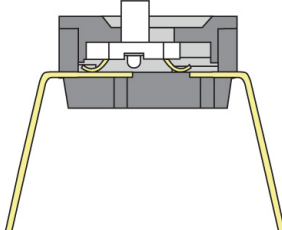

## X-ON Electronics

Largest Supplier of Electrical and Electronic Components

*Click to view similar products for [DIP Switches/SIP Switches](#) category:*

*Click to view products by [Challenge](#) manufacturer:*

Other Similar products are found below :

[78M03S](#) [79B10T](#) [8136-475G4T](#) [G7G-1A2-CB-DC12](#) [A7SS-M](#) [DBP 2110](#) [DBP 2112](#) [DBS1008](#) [DHN02FTVTR](#) [DHN10T](#) [DHS108](#)  
[DPL08TN](#) [DRD16CSE04](#) [DRR4010](#) [DRR60016](#) [DRS4016](#) [BD06E](#) [1825008-1](#) [1825444-1](#) [25.350.0653.0](#) [LA2-DC12](#) [SBS 5004 TG](#)  
[SDA10H1BDA](#) [97R06ST](#) [A2C-2A5](#) [1825444-7](#) [ADE08SA04](#) [ADE12S04](#) [2161391-1](#) [2-1825058-8](#) [CCVA 2.5/ 4-G-5.08](#) [P26THRR32](#)  
[25.330.0653.1](#) [25.352.0353.0](#) [MDG305ST](#) [IKN0600000](#) [IKN0800000](#) [LA2-002-DC24](#) [DBP2008](#) [DBS1003](#) [DBS2008](#) [438872000](#)  
[DRD10CRAE04](#) [DRS1604](#) [DSR02T](#) [DSS 208 N](#) [5-1825033-1](#) [106-SDN06-EV](#) [1-1437507-6](#) [E2FMX2D1M1TGJ03M](#)  
[E3ZMCT81M1TJ03M](#)