

FEC1008CP Series

■ SMD Wire Wound Ceramic Chip Inductors

MECHANICAL DIMENSIONS



FEC1008CP

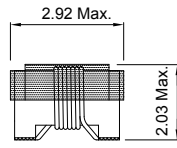

1R0~150: 2.10 Max.

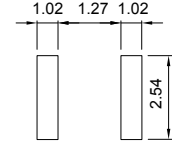
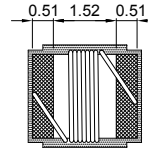
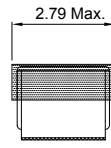

Recommended Patterns

unit: mm

ELECTRICAL SPECIFICATION

| Part Number | Inductance (nH) | Inductance Tolerance | Test Freq. (MHz) | Q Min. | Test Freq. (MHz) | SRF (GHz) Min. | DCR (Ω) Max. | I _{rms} (mA) | Color Code | | |
|--------------------|-----------------|----------------------|------------------|--------|------------------|----------------|--------------|-----------------------|------------|--------|------------|
| | | | | | | | | | 1st | 2nd | multiplier |
| FEC1008CP-5N6□-LRH | 5.6 | K, J | 50 | 50 | 1500 | 4.00 | 0.15 | 1000 | GREEN | BLUE | WHITE |
| FEC1008CP-10N□-LRH | 10 | K, J | 50 | 50 | 500 | 4.10 | 0.08 | 1000 | BROWN | BLACK | BLACK |
| FEC1008CP-12N□-LRH | 12 | K, J | 50 | 50 | 500 | 3.30 | 0.09 | 1000 | BROWN | RED | BLACK |
| FEC1008CP-15N□-LRH | 15 | K, J | 50 | 50 | 500 | 2.50 | 0.10 | 1000 | BROWN | GREEN | BLACK |
| FEC1008CP-18N□-LRH | 18 | K, J, G | 50 | 50 | 350 | 2.50 | 0.11 | 1000 | BROWN | GRAY | BLACK |
| FEC1008CP-22N□-LRH | 22 | K, J, G | 50 | 55 | 350 | 2.40 | 0.12 | 1000 | RED | RED | BLACK |
| FEC1008CP-24N□-LRH | 24 | K, J, G | 50 | 55 | 350 | 1.90 | 0.13 | 1000 | RED | YELLOW | BLACK |
| FEC1008CP-27N□-LRH | 27 | K, J, G | 50 | 55 | 350 | 1.60 | 0.13 | 1000 | RED | VIOLET | BLACK |
| FEC1008CP-33N□-LRH | 33 | K, J, G | 50 | 60 | 350 | 1.60 | 0.14 | 1000 | ORANGE | ORANGE | BLACK |
| FEC1008CP-36N□-LRH | 36 | K, J, G | 50 | 60 | 350 | 1.60 | 0.15 | 1000 | ORANGE | BLUE | BLACK |
| FEC1008CP-39N□-LRH | 39 | K, J, G | 50 | 60 | 350 | 1.50 | 0.15 | 1000 | ORANGE | WHITE | BLACK |
| FEC1008CP-47N□-LRH | 47 | K, J, G | 50 | 65 | 350 | 1.50 | 0.16 | 1000 | YELLOW | VIOLET | BLACK |
| FEC1008CP-56N□-LRH | 56 | K, J, G | 50 | 65 | 350 | 1.30 | 0.18 | 1000 | GREEN | BLUE | BLACK |
| FEC1008CP-62N□-LRH | 62 | K, J, G | 25 | 45 | 350 | 1.25 | 0.20 | 1000 | BLUE | RED | BLACK |
| FEC1008CP-68N□-LRH | 68 | K, J, G | 50 | 65 | 350 | 1.30 | 0.20 | 1000 | BLUE | GRAY | BLACK |
| FEC1008CP-75N□-LRH | 75 | K, J, G | 50 | 60 | 350 | 1.10 | 0.21 | 1000 | VIOLET | GREEN | BLACK |
| FEC1008CP-82N□-LRH | 82 | K, J, G | 50 | 60 | 350 | 1.00 | 0.22 | 1000 | GRAY | RED | BLACK |
| FEC1008CP-91N□-LRH | 91 | K, J, G | 50 | 50 | 350 | 1.00 | 0.45 | 1000 | WHITE | BROWN | BLACK |
| FEC1008CP-R10□-LRH | 100 | K, J, G | 25 | 60 | 350 | 1.00 | 0.56 | 650 | BROWN | BLACK | BROWN |
| FEC1008CP-R12□-LRH | 120 | K, J, G | 25 | 60 | 350 | 0.950 | 0.63 | 650 | BROWN | RED | BROWN |
| FEC1008CP-R15□-LRH | 150 | K, J, G | 25 | 45 | 100 | 0.850 | 0.70 | 580 | BROWN | GREEN | BROWN |
| FEC1008CP-R18□-LRH | 180 | K, J, G | 25 | 45 | 100 | 0.750 | 0.77 | 620 | BROWN | GRAY | BROWN |
| FEC1008CP-R20□-LRH | 200 | K, J, G | 25 | 50 | 100 | 0.750 | 0.81 | 500 | RED | BLACK | BROWN |
| FEC1008CP-R22□-LRH | 220 | K, J, G | 25 | 45 | 100 | 0.700 | 0.84 | 500 | RED | RED | BROWN |
| FEC1008CP-R24□-LRH | 240 | K, J, G | 25 | 50 | 100 | 0.650 | 0.84 | 500 | RED | YELLOW | BROWN |
| FEC1008CP-R27□-LRH | 270 | K, J, G | 25 | 45 | 100 | 0.600 | 0.91 | 500 | RED | VIOLET | BROWN |
| FEC1008CP-R30□-LRH | 300 | K, J, G | 25 | 45 | 100 | 0.590 | 1.00 | 660 | ORANGE | BLACK | BROWN |
| FEC1008CP-R33□-LRH | 330 | K, J, G | 25 | 45 | 100 | 0.570 | 1.05 | 450 | ORANGE | ORANGE | BROWN |
| FEC1008CP-R36□-LRH | 360 | K, J, G | 25 | 45 | 100 | 0.530 | 1.05 | 660 | ORANGE | BLUE | BROWN |
| FEC1008CP-R39□-LRH | 390 | K, J, G | 25 | 45 | 100 | 0.500 | 1.12 | 470 | ORANGE | WHITE | BROWN |
| FEC1008CP-R43□-LRH | 430 | K, J, G | 25 | 45 | 100 | 0.480 | 1.15 | 600 | YELLOW | ORANGE | BROWN |
| FEC1008CP-R47□-LRH | 470 | K, J, G | 25 | 45 | 100 | 0.450 | 1.19 | 470 | YELLOW | VIOLET | BROWN |
| FEC1008CP-R56□-LRH | 560 | K, J, G | 25 | 45 | 100 | 0.415 | 1.33 | 400 | GREEN | BLUE | BROWN |
| FEC1008CP-R62□-LRH | 620 | K, J, G | 25 | 45 | 100 | 0.375 | 1.40 | 300 | BLUE | RED | BROWN |
| FEC1008CP-R68□-LRH | 680 | K, J, G | 25 | 45 | 100 | 0.375 | 1.47 | 400 | BLUE | GRAY | BROWN |
| FEC1008CP-R75□-LRH | 750 | K, J, G | 25 | 45 | 100 | 0.360 | 1.54 | 360 | VIOLET | GREEN | BROWN |
| FEC1008CP-R82□-LRH | 820 | K, J, G | 25 | 45 | 100 | 0.350 | 1.61 | 400 | GRAY | RED | BROWN |
| FEC1008CP-R91□-LRH | 910 | K, J, G | 25 | 35 | 50 | 0.320 | 1.68 | 380 | WHITE | BROWN | BROWN |
| FEC1008CP-1R0□-LRH | 1000 | K, J, G | 25 | 35 | 50 | 0.290 | 1.75 | 370 | BROWN | BLACK | RED |
| FEC1008CP-1R2□-LRH | 1200 | K, J, G | 7.9 | 35 | 50 | 0.250 | 2.00 | 310 | BROWN | RED | RED |
| FEC1008CP-1R5□-LRH | 1500 | K, J, G | 7.9 | 28 | 50 | 0.200 | 2.30 | 330 | BROWN | GREEN | RED |
| FEC1008CP-1R8□-LRH | 1800 | K, J, G | 7.9 | 28 | 50 | 0.160 | 2.60 | 300 | BROWN | GRAY | RED |
| FEC1008CP-2R0□-LRH | 2000 | K, J, G | 7.9 | 25 | 50 | 0.160 | 2.80 | 280 | RED | BLACK | RED |
| FEC1008CP-2R2□-LRH | 2200 | K, J, G | 7.9 | 28 | 50 | 0.160 | 2.80 | 280 | RED | RED | RED |
| FEC1008CP-2R7□-LRH | 2700 | K, J, G | 7.9 | 22 | 25 | 0.140 | 3.20 | 290 | RED | VIOLET | RED |
| FEC1008CP-3R3□-LRH | 3300 | K, J, G | 7.9 | 22 | 25 | 0.110 | 3.40 | 290 | ORANGE | ORANGE | RED |
| FEC1008CP-3R9□-LRH | 3900 | K, J, G | 7.9 | 20 | 25 | 0.100 | 3.60 | 260 | ORANGE | WHITE | RED |
| FEC1008CP-4R7□-LRH | 4700 | K, J, G | 7.9 | 20 | 25 | 0.090 | 4.00 | 260 | YELLOW | VIOLET | RED |
| FEC1008CP-5R6□-LRH | 5600 | K, J | 7.9 | 16 | 7.96 | 0.020 | 4.00 | 240 | GREEN | BLUE | RED |

SMD

Leaded

FEC1008CP Series

■ SMD Wire Wound Ceramic Chip Inductors

ELECTRICAL SPECIFICATION

| Part Number | Inductance (nH) | Inductance Tolerance | Test Freq. (MHz) | Q Min. | Test Freq. (MHz) | SRF (GHz) Min. | DCR (Ω) Max. | I _{rms} (mA) | Color Code | | |
|--------------------|-----------------|----------------------|------------------|--------|------------------|----------------|--------------|-----------------------|------------|-------|------------|
| | | | | | | | | | 1st | 2nd | multiplier |
| FEC1008CP-6R8□-LRH | 6800 | K, J | 7.9 | 15 | 7.96 | 0.040 | 4.90 | 200 | BLUE | GRAY | RED |
| FEC1008CP-8R2□-LRH | 8200 | K, J | 7.9 | 15 | 7.96 | 0.025 | 6.00 | 170 | GRAY | RED | RED |
| FEC1008CP-100□-LRH | 10000 | K, J | 2.52 | 15 | 7.96 | 0.020 | 9.00 | 150 | BROWN | BLACK | ORANGE |
| FEC1008CP-120□-LRH | 12000 | K, J | 2.52 | 15 | 7.96 | 0.018 | 10.50 | 130 | BROWN | RED | ORANGE |
| FEC1008CP-150□-LRH | 15000 | K, J | 2.52 | 15 | 7.96 | 0.015 | 11.50 | 120 | BROWN | GREEN | ORANGE |

- External electrode: FEC1008CP (Sn-plating), FEC1008C (Au-plating)
- Tolerance: K=±10% ; J=±5% ; G=±2%
- Operating Temp: -40°C to +125°C
- For 15°C Temperature Rise.
- Inductance & Q measured using the HP4291B.
- SRF measured using the HP8753E or HP8720D.
- DCR measured using the 16502BC milli-ohm meter.
- Unspecified values available on request.

CHARACTERISTIC CURVE

FEC1008CP Series

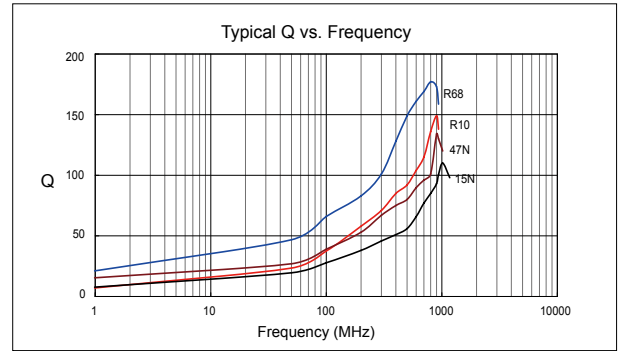
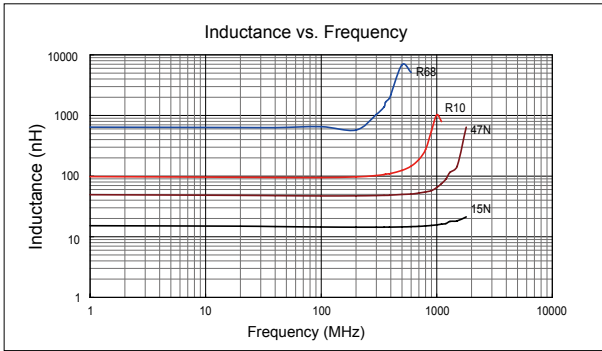

X-ON Electronics

Largest Supplier of Electrical and Electronic Components

Click to view similar products for [Fixed Inductors](#) category:

Click to view products by [Prosperity](#) manufacturer:

Other Similar products are found below :

[MLZ1608M6R8WTD25](#) [MLZ1608N6R8LT000](#) [MLZ1608N3R3LTD25](#) [MLZ1608N3R3LT000](#) [MLZ1608N150LT000](#)
[MLZ1608M150WTD25](#) [MLZ1608M3R3WTD25](#) [MLZ1608M3R3WT000](#) [MLZ1608M150WT000](#) [MLZ1608A1R5WT000](#)
[MLZ1608N1R5LT000](#) [B82432C1333K000](#) [PCMB053T-1R0MS](#) [PCMB053T-1R5MS](#) [PCMB104T-1R5MS](#) [CR32NP-100KC](#) [CR32NP-151KC](#) [CR32NP-180KC](#) [CR32NP-181KC](#) [CR32NP-1R5MC](#) [CR32NP-390KC](#) [CR32NP-3R9MC](#) [CR32NP-680KC](#) [CR32NP-820KC](#)
[CR32NP-8R2MC](#) [CR43NP-390KC](#) [CR43NP-560KC](#) [CR43NP-680KC](#) [CR54NP-181KC](#) [CR54NP-470LC](#) [CR54NP-820KC](#) [CR54NP-8R5MC](#)
[MGDQ4-00004-P](#) [MGDU1-00016-P](#) [MHL1ECTTP18NJ](#) [MHL1JCTTD12NJ](#) [PE-51506NL](#) [PE-53601NL](#) [PE-53630NL](#) [PE-53824SNLT](#) [PE-62892NL](#) [PE-92100NL](#) [PG0434.801NLT](#) [PG0936.113NLT](#) [PM06-2N7](#) [PM06-39NJ](#) [HC2LP-R47-R](#) [HC2-R47-R](#) [HC3-2R2-R](#) [HC8-1R2-R](#)