

PIN NO.	PIN NAME
C1	VCC
C2	RST
C3	CLK
C5	GND
C6	VPP
C7	I/O
S/W	Switch Pin

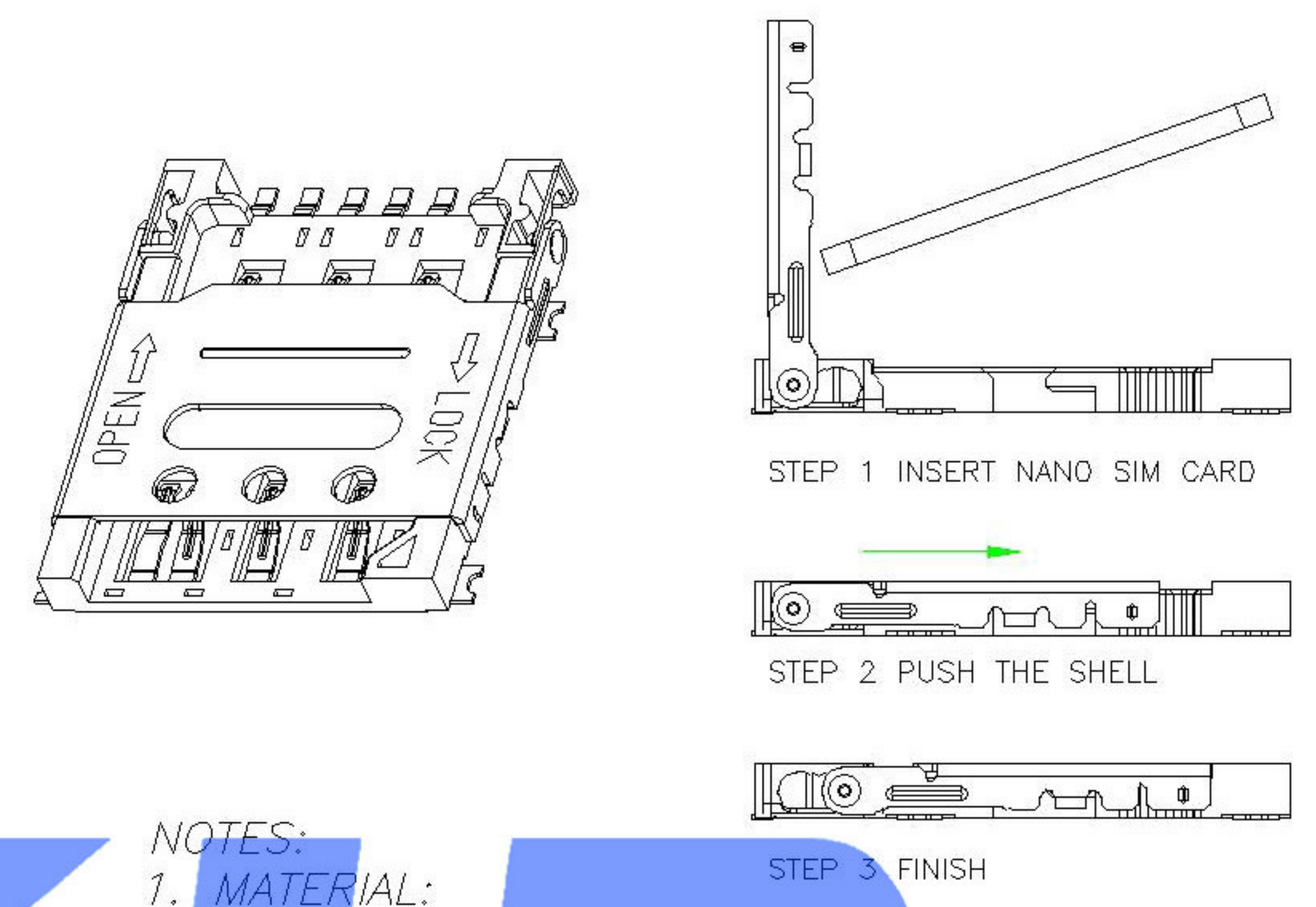
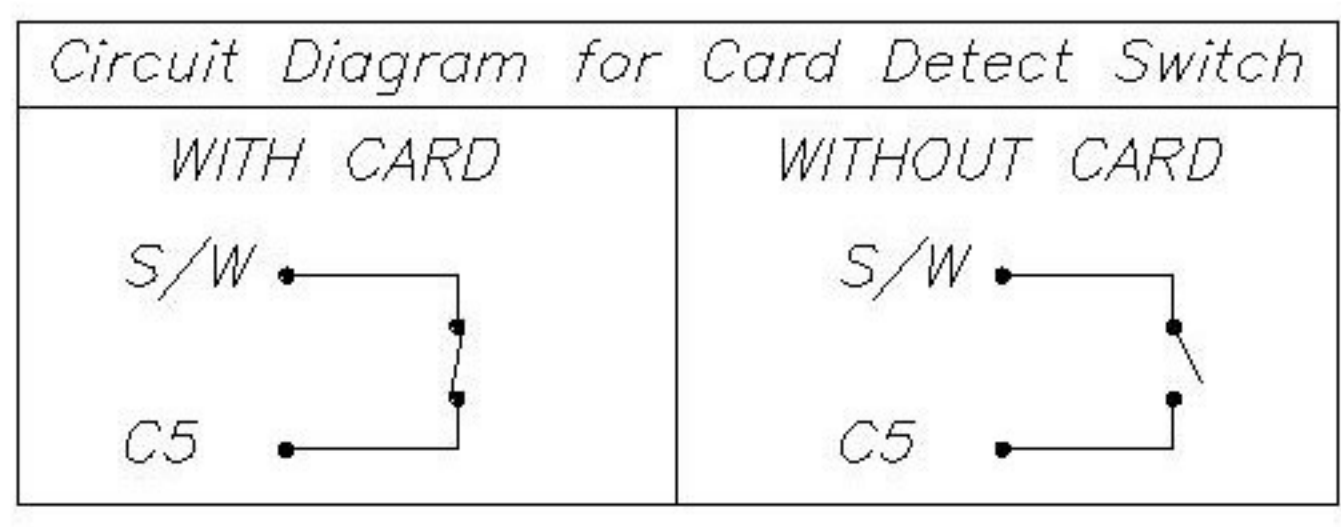

- NOTES:
- MATERIAL:
    - Housing: High Temperature Thermoplastic UL94V-0; Color Black.
    - Terminal: Copper Alloy, T=0.12mm.
    - Shell: Stainless Steel, T=0.20mm.
  - FINISH:
    - Terminal: Plated Gold on the Contact Area and Solder Tails
    - Peg: Plated Gold on the Solder Tails.
  - SPECIALITY:
    - Rated current: 0.5A
    - Rated voltage: 50V
    - Contact Resistance: 50mΩ MAX
    - Insulation Resistance: 100MΩ MIN 100V DC
    - Dielectric withstanding voltage: 100V AC.
    - Durability Cycles: 5000 Cycles.
    - Solder ability: 245±5°C, 5±0.5s.
    - Operating condition: Temperature: -30°C +80°C Humidity: 80% R.H MAX

# SWITCH CONNECTOR

MARK	DESCRIPTION	DATE	REVISED	APPROVED	UNSPECIFIED TOLERANCES	DSND	DATE	SCALE: N/A	MODEL TYPE: SIM CARD CONN	
ΔX					ANGLAR ±5°	DWN	DATE	VIEW:	PART NO.:	
ΔX					L ≤ 4 ±0.2	CHKD	DATE	UNIT: mm	DWG NO.:	
ΔX					4 < L ≤ 16 ±0.3	APPD	DATE	SIZE: A4	XKNANO-1306	
					16 < L ≤ 63 ±0.4				WEIGHT 1.0g	
					L > 63 ±0.5				SHEET 1/1	
									REVISION A0	
REVISIONS						XKB INDUSTRIAL PRECISION CO., LIMITED				
www.xk-dg.cn www.helloxkb.com www.helloxkb.cn										

## X-ON Electronics

Largest Supplier of Electrical and Electronic Components

*Click to view similar products for [Standard Card Edge Connectors](#) category:*

*Click to view products by [XKB](#) manufacturer:*

Other Similar products are found below :

[6565204-6](#) [PKC-156](#) [1437274-4](#) [147889-1](#) [1489165-4](#) [EBT156-12B1X](#) [EBT15622B2X](#) [EBT156-22R2W](#) [1-582587-1](#) [1-582589-1](#) [2-6437275-9](#) [284-0102-12100](#) [306022901000000](#) [307-012-502-202](#) [307-024-526-201](#) [307-056-520-300](#) [307-080-526-208](#) [1926088-2](#) [245-062-520-350](#) [287-0032-12101](#) [306-010-500-112](#) [306-028-525-102](#) [306-240-318](#) [307-036-502-202](#) [307-036-521-301](#) [307-072-526-202](#) [345-060-559-303](#) [368-004-520-201](#) [392-008-559-201](#) [534671-1](#) [5-530501-5](#) [341-240-317](#) [345-029-520-300](#) [345-030-500-301](#) [345-044-500-300](#) [345-220-058](#) [346-240-318](#) [357-030-526-201](#) [387-012-523-300](#) [395-044-520-300](#) [395-100-524-300](#) [50-12B-10](#) [50-6SN-5](#) [09-07-2032](#) [10035388-106LF](#) [10035388-802LF](#) [10115859-011LF](#) [10122859-009LF](#) [101269333204245CLF](#) [10127905-B04B24BLF](#)