

17		16		15		14		13		12		11	
REV. A		SCALE 1/1		DR: ZOE		QTY		FINISH		MATERIAL		UNITS mm	
SHEET 1/1		2006-11-28		CHKD: LISA		APPD: SUNNY		PART NO.(INTENDED USE)		NAME(INTENDED USE)		TITLE: MTP125-12XXS1	
DWG NO.:		MTP125-12XXS1		MINTRON CO.,LTD.		MTP125-12XXS1		MTP125-12XXS1		MTP125-12XXS1		MTP125-12XXS1	
X ± 0.30		X ± 0.20		X ± 0.10		X ± 0.05		X ± 0.5°		X ± 2°		X ± 1°	
X ± 0.10		X ± 0.05		X ± 0.5°		X ± 2°		X ± 1°		X ± 0.5°		X ± 0.10	
X ± 0.05		X ± 0.5°		X ± 2°		X ± 1°		X ± 0.5°		X ± 0.10		X ± 0.05	

Dimension antitheses list		ITEM		Standard		Alternate	
A		B		2.80		4.00	

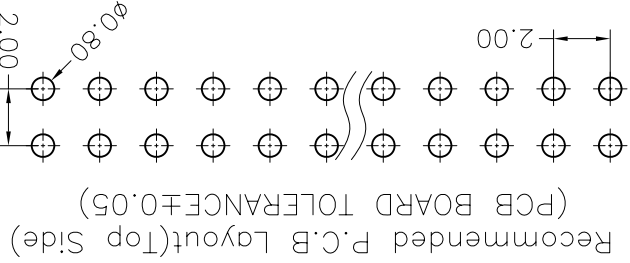
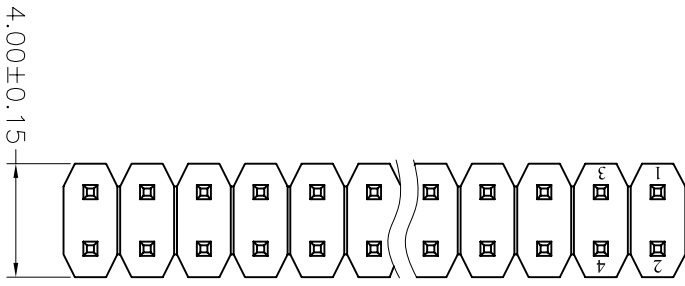
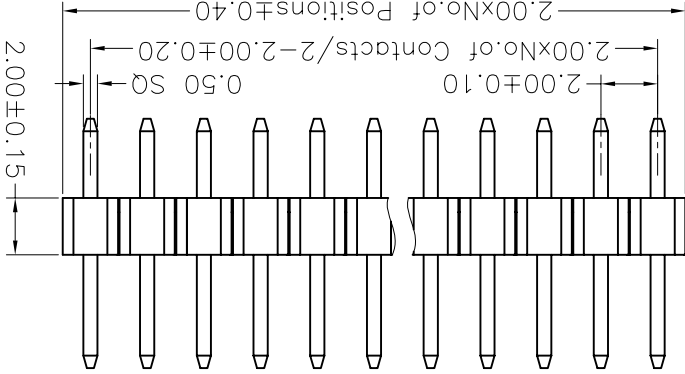
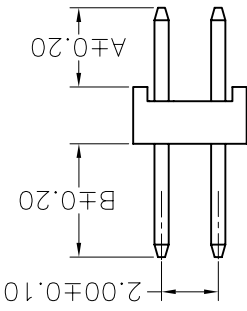

Recommended P.C.B Layout(Top Side)
(PCB BOARD TOLERANCE ± 0.05)

MTP125-12XXS1
No. of Pins per Row: 01~40

- NOTES:
- Current Rating: 1.5AMP
 - Contact Resistance: 20mΩ max
 - Withstand Voltage: 500V AC/DC
 - Insulation Resistance: 1000MΩ min
 - Operation Temperature: -40°C to +105°C
 - Contact Material: Brass
 - Contact plating: Au or Sn Over Ni
 - Insulator Material: PA6T or PBT+30%GF(UL94V-0)
 - Contact Plated: Gold Flash

REV. A	ECN. NO.	APPD.
--------	----------	-------

X-ON Electronics

Largest Supplier of Electrical and Electronic Components

Click to view similar products for [Headers & Wire Housings](#) category:

Click to view products by [MINTRON](#) manufacturer:

Other Similar products are found below :

[95000-104TRLF](#) [10135584-644402LF](#) [DF62W-EP2022PCA](#) [95000-106TRLF](#) [DF62W-2022SCA](#) [DF62W-EP2022PC](#) [2203348](#) [DF62W-2022SC](#) [1084018](#) [1029039](#) [1084017](#) [802-10-012-10-002000](#) [1112640](#) [1112639](#) [891-007-9SS-BST1T](#) [000-34000](#) [0008550134](#) [0009482033](#) [0009507031](#) [57102-F02-18ULF](#) [57102-S06-03LF](#) [57202-S52-04LF](#) [PCN6-15S-2.5E](#) [0039019024](#) [58102-G61-06LF](#) [582553-1](#) [0009485154](#) [0009508121](#) [0022285053](#) [0050291907](#) [018731A](#) [LY20-4P-DT1-P1E-BR](#) [02.125.8002.8](#) [60101931](#) [60598-1 \(Cut Strip\)](#) [M1625-3R/100](#) [61062-3](#) [61082-181009](#) [CSU011177004](#) [636-1427](#) [638009-1](#) [641938-9](#) [641991-4](#) [644168-1](#) [644827-2](#) [647662-1](#) [65039-019ELF](#) [65692-001LF](#) [65781-018](#) [65781-047](#)