

REV.	DESCRIPTION	DATE	ANG. $\pm$ .3°	TOLERANCE	0. = $\pm$ .30
A	RELEASE	2006/07/10	.0000= $\pm$ .	0.00	0.00
B	REVERSE SIZE	2008/03/07	.000 = $\pm$ .XXX		
C	修正規格尺寸	2016/12/16			
SCALE		SIZE	NONE	A4	1 OF 1
SHEET		REV.	REV.	APP'D	NEW PART NO.
DRAWER		廖小芳	REV.	APP'D	210-81-05GB01
UNITS : mm				CHECK	PIN HEADER 2.54*2.54mm
TITLE		OLD PART NO.		CHECK	STRAIGHT TYPE, SINGLE ROW
DRAW NO.					PINREX TECHNOLOGY CORP.
DRAW NO.					210-81-05GB01(C版)

Recommended P.C.B Layout

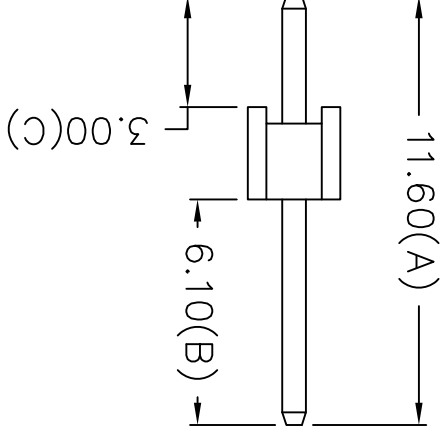
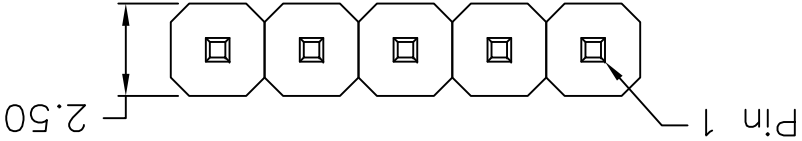
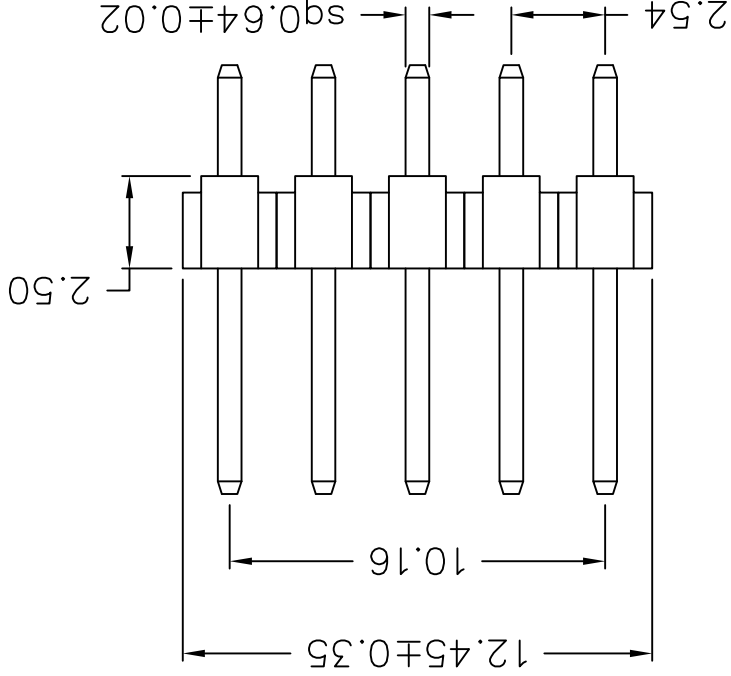
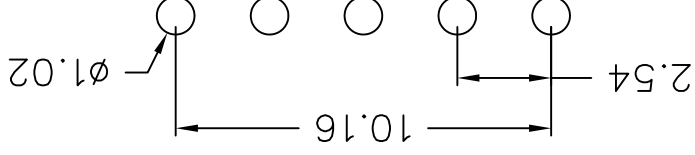

- 210-81-05GB01
- |   |   |                         |
|---|---|-------------------------|
| 1 | 8 | Green Product           |
| 2 | 1 | Single row              |
| 2 | 2 | Dual rows               |
| 3 | 3 | No. of contacts per row |
| 4 | G | Gold flash              |
| S |   | Selective               |
| T |   | Tin plated              |
| 5 | B | Black Insulator         |
| R |   | Red Insulator           |
| W |   | Nature color Insulator  |
| U |   | Blue Insulator          |
| 6 |   | Pinrex internal code.   |

**MATERIAL**  
 Insulator : NY66+30% Glass fiber  
 Contact Pin : Brass

**SPECIFICATION**

Current Rate : 3 AMP

Insulation Resistance : 5000M $\Omega$ Min. at DC 500V

Contact Resistance : 20m $\Omega$ Max. at DC 100mA

Dielectric Voltage : AC 500V for one minute

Operation Temperature : -40°C to + 105°C

## X-ON Electronics

Largest Supplier of Electrical and Electronic Components

*Click to view similar products for [Headers & Wire Housings](#) category:*

*Click to view products by [Pinrex](#) manufacturer:*

Other Similar products are found below :

[95000-104TRLF](#) [10135584-644402LF](#) [DF62W-EP2022PCA](#) [95000-106TRLF](#) [DF62W-2022SCA](#) [DF62W-EP2022PC](#) [2203348](#) [DF62W-2022SC](#) [1084018](#) [1029039](#) [1084017](#) [802-10-012-10-002000](#) [1112640](#) [1112639](#) [891-007-9SS-BST1T](#) [000-34000](#) [0008550134](#) [0009482033](#) [0009507031](#) [57102-F02-18ULF](#) [57102-S06-03LF](#) [57202-S52-04LF](#) [PCN6-15S-2.5E](#) [0039019024](#) [58102-G61-06LF](#) [582553-1](#) [0009485154](#) [0009508121](#) [0022285053](#) [0050291907](#) [018731A](#) [LY20-4P-DT1-P1E-BR](#) [02.125.8002.8](#) [60101931](#) [60598-1 \(Cut Strip\)](#) [M1625-3R/100](#) [61062-3](#) [61082-181009](#) [CSU011177004](#) [636-1427](#) [638009-1](#) [641938-9](#) [641991-4](#) [644168-1](#) [644827-2](#) [647662-1](#) [65039-019ELF](#) [65692-001LF](#) [65781-018](#) [65781-047](#)