

Recommended P.C.B Layout

REV.	DESCRIPTION	DATE
E	增加材質	2018/05/23
D	增加制程溫度	2017/09/01
C	REVISE SIZE	2011/06/08
B	REVISE DIMENSIONS	2007/09/01
A	RELEASE	2005/01/26

TOLERANCE  
 0 = ±.30  
 .00 = ±.20  
 .000 = ±.XXX  
 .0000 = ±.  
 ANG. = ±3.

SCALE NONE  
 SIZE A4  
 UNITS : mm

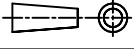

1 OF 1 SHEET REV. E  
 DRAWER 楊海毅  
 CHECK 李劍  
 APP'D  
 NEW PART NO. 210-91-04GB01  
 TITLE PIN HEADER 2.54\*2.54mm  
 STRAIGHT TYPE, SINGLE ROW

PINREX TECHNOLOGY CORP.  
 頻銳科技股份有限公司  
 DRAW NO. 210-91-04GB01(E版)

MATERIAL

Contact Pin : Brass

Insulator: NY6T UL94-V0

SPECIFICATION

Current Rate : 3 AMP

Insulation Resistance : 5000MΩMin. at DC 500V

Contact Resistance : 20mΩMax. at DC 100mA

Dielectric Voltage : AC 500V for one minute

Operation Temperature : -40°C to + 105°C

適用波峰焊製程溫度: 260°C ± 5°C 3~5S

210-9 1-04 G B 01

1 2 3 4 5 6

1. 7: Green Product
- 9: Green Product High Temp
2. 1: Single row
- 2: Dual rows
3. No. of contacts per row
4. G: Gold flash
5. B: Black insulator
6. Pinrex internal code.

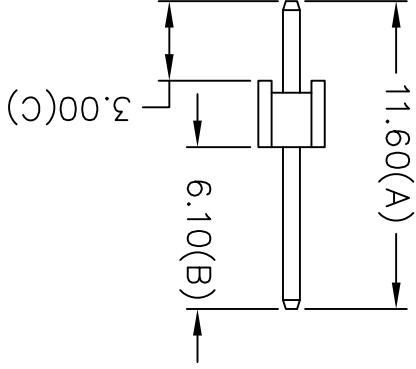

## X-ON Electronics

Largest Supplier of Electrical and Electronic Components

*Click to view similar products for [Headers & Wire Housings](#) category:*

*Click to view products by [Pinrex](#) manufacturer:*

Other Similar products are found below :

[95000-104TRLF](#) [10135584-644402LF](#) [DF62W-EP2022PCA](#) [95000-106TRLF](#) [DF62W-2022SCA](#) [DF62W-EP2022PC](#) [2203348](#) [DF62W-2022SC](#) [1084018](#) [1029039](#) [1084017](#) [802-10-012-10-002000](#) [1112640](#) [1112639](#) [891-007-9SS-BST1T](#) [000-34000](#) [0008550134](#) [0009482033](#) [0009507031](#) [57102-F02-18ULF](#) [57102-S06-03LF](#) [57202-S52-04LF](#) [PCN6-15S-2.5E](#) [0039019024](#) [58102-G61-06LF](#) [582553-1](#) [0009485154](#) [0009508121](#) [0022285053](#) [0050291907](#) [018731A](#) [LY20-4P-DT1-P1E-BR](#) [02.125.8002.8](#) [60101931](#) [60598-1 \(Cut Strip\)](#) [M1625-3R/100](#) [61062-3](#) [61082-181009](#) [CSU011177004](#) [636-1427](#) [638009-1](#) [641938-9](#) [641991-4](#) [644168-1](#) [644827-2](#) [647662-1](#) [65039-019ELF](#) [65692-001LF](#) [65781-018](#) [65781-047](#)