

REV.	DESCRIPTION	DATE	ANG.±3. 0.000=±. .000 =±.XXX .00 =±.20 0 =±.30 TOLERANCE	SCALE NONE	SIZE A4	1 OF 1	SHEET REV. C	APP'D	NEW PART NO. 210-91-04GB02	DRAW NO. 210-91-04GB02(C版)
A	RELEASE	2005/08/29								
B	REVISE DIMENSIONS	2007/09/01								
C	REVISE DIMENSIONS	2016/06/20								

OLD PART NO.	TITLE	DRAWER 廖小芳	CHECK	PIN HEADER 2.54*2.54mm STRAIGHT TYPE, SINGLE ROW	PINREX TECHNOLOGY CORP.
--------------	-------	---------------	-------	---	-------------------------

Recommended P.C.B Layout

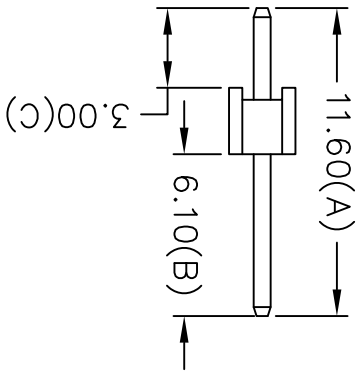
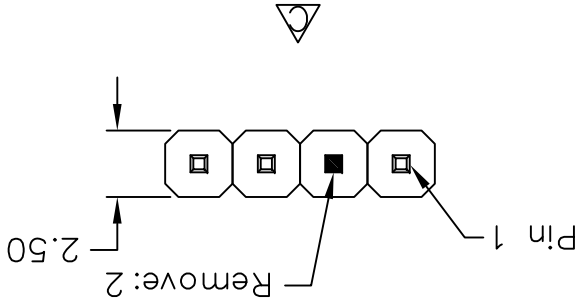
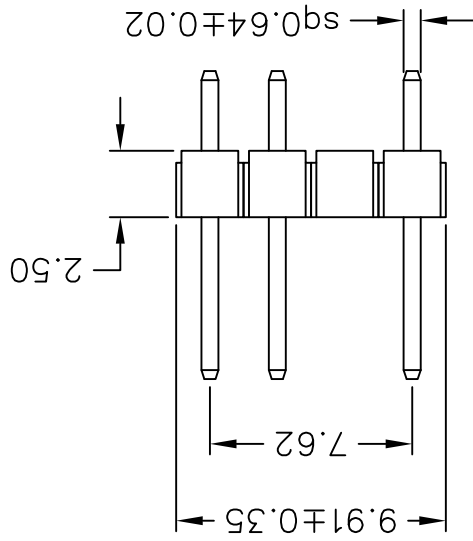
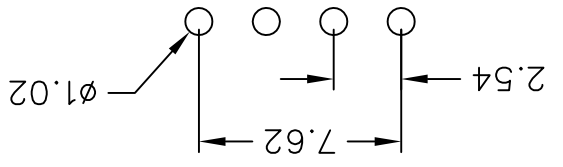

MATERIAL

Contact Pin : Brass

SPECIFICATION

Current Rate : 3 AMP
Insulation Resistance : 5000MΩMin. at DC 500V
Contact Resistance : 20mΩMax. at DC 100mA
Dielectric Voltage : AC 500V for one minute
Operation Temperature : -40°C to + 105°C

210-9 1- 04 G B 02
1 2 3 4 5 6

1. 5: Normal parts (30% Glass fiber PBT)
- 7: Green Product (30% Glass fiber PBT)
- 9: Green Product High Temp (NYLON 9T)
2. 1: Single row
- 2: Dual rows
3. No. of contacts per row
4. G: Gold flash
- S: Selective
- T: Tin plated
5. B: Black insulator
6. Pinrex internal code.

X-ON Electronics

Largest Supplier of Electrical and Electronic Components

Click to view similar products for [Headers & Wire Housings](#) category:

Click to view products by [Pinrex](#) manufacturer:

Other Similar products are found below :

[95000-104TRLF](#) [10135584-644402LF](#) [DF62W-EP2022PCA](#) [95000-106TRLF](#) [DF62W-2022SCA](#) [DF62W-EP2022PC](#) [2203348](#) [DF62W-2022SC](#) [1084018](#) [1029039](#) [1084017](#) [802-10-012-10-002000](#) [1112640](#) [1112639](#) [891-007-9SS-BST1T](#) [000-34000](#) [0008550134](#) [0009482033](#) [0009507031](#) [57102-F02-18ULF](#) [57102-S06-03LF](#) [57202-S52-04LF](#) [PCN6-15S-2.5E](#) [0039019024](#) [58102-G61-06LF](#) [582553-1](#) [0009485154](#) [0009508121](#) [0022285053](#) [0050291907](#) [018731A](#) [LY20-4P-DT1-P1E-BR](#) [02.125.8002.8](#) [60101931](#) [60598-1 \(Cut Strip\)](#) [M1625-3R/100](#) [61062-3](#) [61082-181009](#) [CSU011177004](#) [636-1427](#) [638009-1](#) [641938-9](#) [641991-4](#) [644168-1](#) [644827-2](#) [647662-1](#) [65039-019ELF](#) [65692-001LF](#) [65781-018](#) [65781-047](#)