

Features

- Low reverse current and low forward voltage.
- High reliability.
- Small surface mounting type.

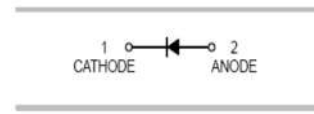

SOD-323

Typical Applications

- For general purpose applications

Mechanical Data

- Case: SOD-323
- Molding compound, UL flammability classification rating 94V-0.
- Terminals: Tin plated leads, solderable per MIL-STD-202, Method 208.

Ordering Information

Part Number	Package	Shipping	Marking Code
SD103AWS□	SOD-323	3000/Tape Reel	S4
SD103BWS□	SOD-323	3000/Tape Reel	S5
SD103CWS□	SOD-323	3000/Tape Reel	S6

□: none is for Lead Free package;

“G” is for Halogen Free package.

Maximum Ratings (@ $T_A=25^{\circ}\text{C}$ unless otherwise specified)

Characteristic	Symbol	SD103AWS	SD103BWS	SD103CWS	Units
Peak repetitive reverse voltage	V_{RRM}	40	30	20	V
RMS Reverse voltage	V_{RMS}	28	21	14	V
Maximum average forward output current	$I_{F(AV)}$	350			mA
Peak forward surge current, 8.3ms single half-sine-wave	I_{FSM}	1.5			A

Thermal Characteristics

Characteristic	Symbol	Value	Units
Power dissipation	P_D	200	mW
Typical thermal resistance per leg	$R_{\theta JA}^*$	500	$^{\circ}\text{C/W}$
Operating junction temperature range	T_J	125	$^{\circ}\text{C}$
Storage temperature range	T_{STG}	-55 to +150	$^{\circ}\text{C}$

* Part mounted on FR-4 board with recommended pad layout

Electrical Characteristics (@ $T_A=25^\circ\text{C}$ unless otherwise specified)

Characteristic	Symbol	Test conditions	Min.	Typ.	Max.	Units
Forward Voltage	V_F^*	$I_F=20\text{mA}$	-	-	0.37	V
		$I_F=200\text{mA}$	-	-	0.60	
Maximum Peak Reverse Current	I_R^{**}	$V_R=30\text{V}$ (SD103AWS) $V_R=20\text{V}$ (SD103BWS) $V_R=10\text{V}$ (SD103CWS)	-	-	5	μA
Capacitance between terminals	C_T	$V_R=0\text{V}, f=1\text{MHz}$	-	22	50	pF

*Pulse width $\leq 380\ \mu\text{s}$, Duty cycle $< 2\%$
**pulse test, $t_p \leq 5\text{ms}$

Ratings and Characteristic Curves ($T_A=25^\circ\text{C}$ unless otherwise noted)

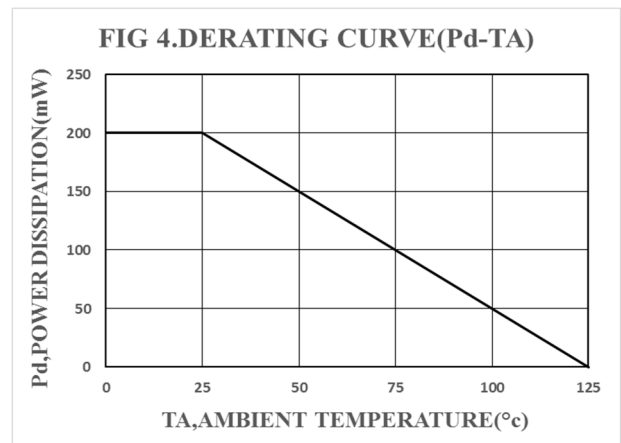
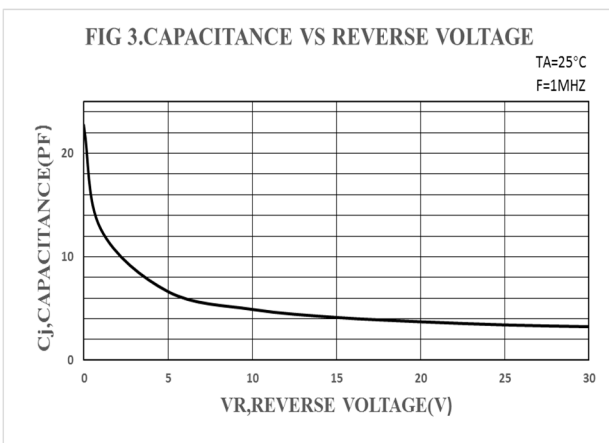
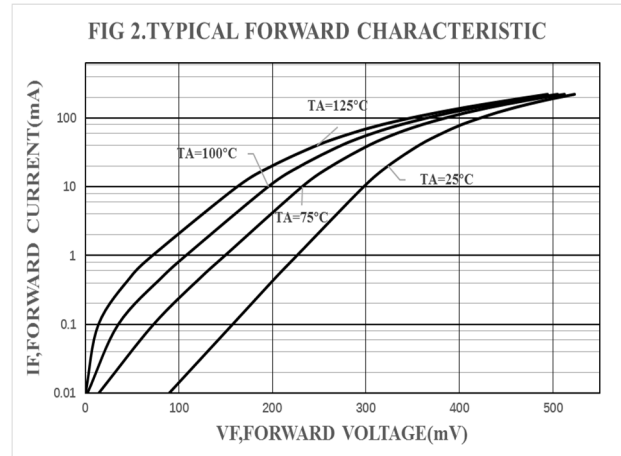
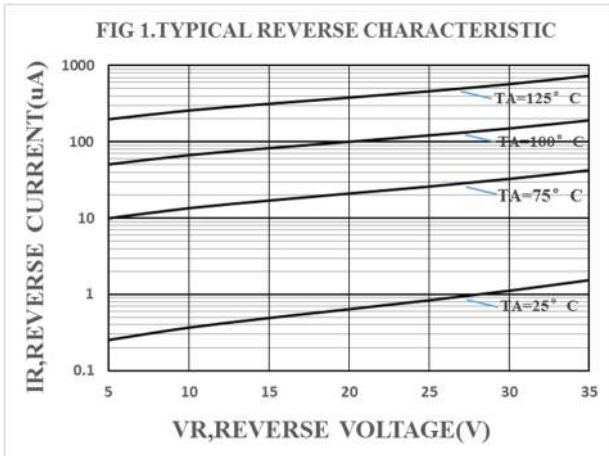

Package Outline Dimensions (unit:mm)

SOD-323

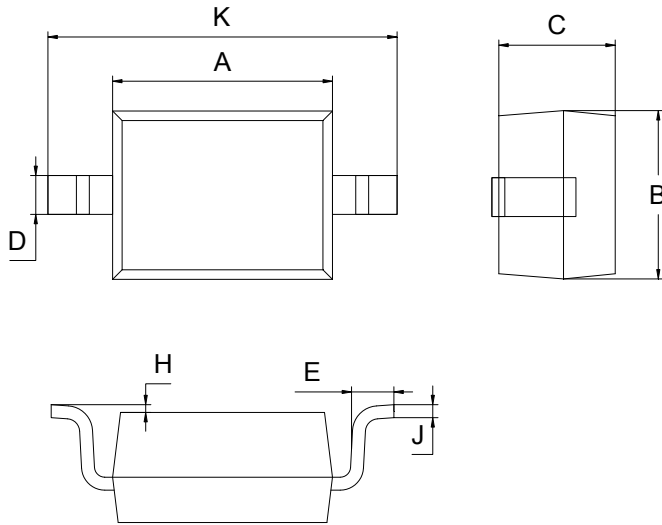

SOD-323		
Dim	Min	Max
A	1.60	1.80
B	1.20	1.40
C	0.80	0.90
D	0.25	0.35
E	0.22	0.42
H	0.02	0.10
J	0.05	0.15
K	2.55	2.75

Mounting Pad Layout (unit:mm)

SOD-323

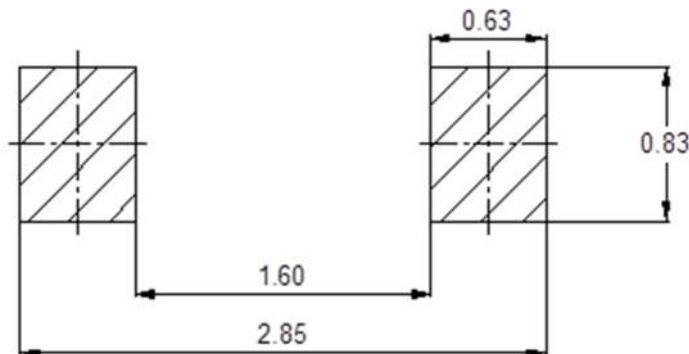

IMPORTANT NOTICE

Galaxy Microelectronics (GME) reserves the right to make changes without further notice to any product herein to make corrections, modifications, improvements, or other changes. GME does not assume any liability arising out of the application or use of any product described herein; neither does it convey any license under its patent rights, nor the rights of others.

X-ON Electronics

Largest Supplier of Electrical and Electronic Components

Click to view similar products for [Schottky Diodes & Rectifiers](#) category:

Click to view products by [Galaxy](#) manufacturer:

Other Similar products are found below :

[CUS06\(Te85L,Q,M\)](#) [MA4E2039](#) [D1FH3-5063](#) [MBR0530L-TP](#) [MBR10100CT-BP](#) [MBR30H100MFST1G](#) [MMBD301M3T5G](#) [PMAD1103-LF](#) [PMAD1108-LF](#) [RB160M-50TR](#) [RB520S-30](#) [RB551V-30](#) [DD350N18K](#) [DZ435N40K](#) [DZ600N16K](#) [BAS16E6433HTMA1](#) [BAS 3010S-02LRH E6327](#) [BAT 54-02LRH E6327](#) [IDL02G65C5XUMA1](#) [NSR05F40QNXT5G](#) [NSVR05F40NXT5G](#) [JANS1N6640](#) [SB07-03C-TB-H](#) [SB1003M3-TL-W](#) [SBAT54CWT1G](#) [SBM30-03-TR-E](#) [SBS818-TL-E](#) [SK32A-LTP](#) [SK33A-TP](#) [SK34A-TP](#) [SK34B-TP](#) [SMD1200PL-TP](#) [ACDBN160-HF](#) [SS3003CH-TL-E](#) [STPS30S45CW](#) [PDS3100Q-7](#) [GA01SHT18](#) [CRS10I30A\(Te85L,QM\)](#) [MBR1240MFST1G](#) [MBRB30H30CT-1G](#) [BAS28E6433HTMA1](#) [BAS 70-02L E6327](#) [HSB123JTR-E](#) [JANTX1N5712-1](#) [VS-STPS40L45CW-N3](#) [DD350N12K](#) [SB007-03C-TB-E](#) [SB10015M-TL-E](#) [SB1003M3-TL-E](#) [SK110-LTP](#)