



# 承 认 书

## APPROVAL SHEET

客户名称:

Customer

/

产品名称:

Part Name

片式铁氧体磁珠、电感、片式甚高频电感

Chip Beads 、 inductors 、 Chip high frequency inductors

产品规格:

Specification

CBG、CBW、CBM、CBY、CBH、CMI、 CMP、VHF Series

版本号:

Version No.

16.01

日期:

DATE

2016.04.05



| Manufacturer |            |            | Customer |            |             |
|--------------|------------|------------|----------|------------|-------------|
| 拟制           | 审核         | 确认         | 检验       | 审核         | 批准          |
| Draft by     | Checked by | Approve by | Check by | Checked by | Approval by |
| 林晓华          | 徐雪枫        | 覃贤         |          |            |             |



| 序号<br>No | 目 录<br>TABLE OF CONTENTS                  |
|----------|---|
| 1        | 履 历 表 Resume                              |
| 2        | 外形尺寸与内部结构 Dimension & Inner-configuration |
| 3        | 产品品名构成 Product Spec. Model                |
| 4        | 电性能参数表 Electrical Characteristics List    |
| 5        | 可靠性试验项目 Reliability Testing Items         |
| 6        | 产品包装 Packaging                            |
| 7        | 推荐焊接条件 Recommend Soldering Conditions     |
| 8        | 清洗 Cleaning                               |
| 9        | 存储要求 Storage Requirements                 |
| 10       | ODS（消耗臭氧层物质）的使用情况 Usage Of ODS            |
| 11       | 注意事项 Notes                                |





## 2 外形尺寸与内部结构 Dimension & Inner-configuration:

外形尺寸图:



内部结构图:



- a. 银层 Ag layer
- b. 镀层 Ni/Sn plating
- c. 内电极 Inner electrode
- d. 瓷体 Body
- e. 端电极 Terminal electrode
- f. 瓷体 ferrite or ceramic

| 序号 No. | 部位 Component              |                       | 材料 Material   |
|--------|---------------------------|-----------------------|---|
| 1      | 瓷体Body                    |                       | 铁氧体电感: 镍铜锌体系 Ni-Cu-Zn<br>甚高频电感: 陶瓷体系 Al <sub>2</sub> O <sub>3</sub> |
| 2      | 内电极 Inner electrode       |                       | 纯银Ag  |
| 3      | 端电极<br>Terminal electrode | 银层 Ag layer           | 银Ag   |
|        |                           | Ni/Sn镀层 Ni/Sn plating | 镍层-锡层 Ni-Sn   |

单位Unit: mm( inch )

| 型号 Size | L                      | W                      | T                      | a                      |
|---------|------------------------|------------------------|------------------------|------------------------|
| 100505  | 1.0±0.15 (0.040±0.006) | 0.5±0.15 (0.020±0.006) | 0.5±0.15 (0.020±0.006) | 0.25±0.1 (0.010±0.004) |
| 160808  | 1.6±0.20 (0.063±0.008) | 0.8±0.20 (0.031±0.008) | 0.8±0.20 (0.031±0.008) | 0.3±0.2 (0.01±0.008)   |
| 201209  | 2.0±0.20 (0.079±0.008) | 1.2±0.20 (0.047±0.008) | 0.9±0.20 (0.035±0.008) | 0.5±0.3 (0.020±0.012)  |
| 201212  | 2.0±0.20 (0.079±0.008) | 1.2±0.20 (0.047±0.008) | 1.2±0.20 (0.047±0.008) | 0.5±0.3 (0.020±0.012)  |
| 252009  | 2.5±0.20 (0.098±0.008) | 2.0±0.20 (0.079±0.008) | 0.9±0.20 (0.035±0.008) | 0.5±0.3 (0.020±0.012)  |
| 321609  | 3.2±0.20 (0.126±0.008) | 1.6±0.20 (0.063±0.008) | 0.9±0.20 (0.035±0.008) | 0.5±0.3 (0.020±0.012)  |
| 321611  | 3.2±0.20 (0.126±0.008) | 1.6±0.20 (0.063±0.008) | 1.1±0.20 (0.043±0.008) | 0.5±0.3 (0.020±0.012)  |
| 322513  | 3.2±0.20 (0.126±0.008) | 2.5±0.20 (0.098±0.008) | 1.3±0.20 (0.051±0.008) | 0.5±0.3 (0.020±0.012)  |
| 451616  | 4.5±0.20 (0.180±0.008) | 1.6±0.20 (0.063±0.008) | 1.6±0.20 (0.063±0.008) | 0.5±0.3 (0.020±0.012)  |
| 453215  | 4.5±0.20 (0.180±0.008) | 3.2±0.20 (0.126±0.008) | 1.5±0.20 (0.060±0.008) | 0.5±0.3 (0.020±0.012)  |



### 3 产品品名构成 Product Spec. Model









| 型号规格<br>Part NO. | 客户料号<br>Customer P/N | 误差范围<br>Tolerance (%) | 标称感量<br>Inductance (μH) | Q 值<br>(min) | 直流电阻<br>RDC (Ω) max | 测试频率<br>Test frequency (MHz) | 测试电压<br>Test voltage (mV) | 自谐振频率<br>SRF (MHz) min | 额定电流<br>Rated current (mA)max |
|------------------|----------------------|-----------------------|-------------------------|--------------|---------------------|------------------------------|---------------------------|------------------------|-------------------------------|
| CMI201209V47NKT  |                      | ±10                   | 0.047                   | 25           | 0.15                | 50                           | 50                        | 320                    | 300                           |
| CMI201209V56NKT  |                      | ±10                   | 0.056                   | 25           | 0.15                | 50                           | 50                        | 320                    | 300                           |
| CMI201209V68NKT  |                      | ±10                   | 0.068                   | 25           | 0.20                | 50                           | 50                        | 280                    | 300                           |
| CMI201209V82NKT  |                      | ±10                   | 0.082                   | 25           | 0.20                | 50                           | 50                        | 280                    | 300                           |
| CMI201209VR10KT  |                      | ±10                   | 0.10                    | 20           | 0.20                | 25                           | 50                        | 235                    | 250                           |
| CMI201209VR12KT  |                      | ±10                   | 0.12                    | 20           | 0.25                | 25                           | 50                        | 220                    | 250                           |
| CMI201209VR15KT  |                      | ±10                   | 0.15                    | 20           | 0.25                | 25                           | 50                        | 200                    | 250                           |
| CMI201209VR18KT  |                      | ±10                   | 0.18                    | 20           | 0.30                | 25                           | 50                        | 185                    | 250                           |
| CMI201209VR22KT  |                      | ±10                   | 0.22                    | 20           | 0.30                | 25                           | 50                        | 170                    | 250                           |
| CMI201209VR27KT  |                      | ±10                   | 0.27                    | 20           | 0.40                | 25                           | 50                        | 150                    | 250                           |
| CMI201209VR33KT  |                      | ±10                   | 0.33                    | 20           | 0.40                | 25                           | 50                        | 145                    | 250                           |
| CMI201209VR39KT  |                      | ±10                   | 0.39                    | 25           | 0.50                | 25                           | 50                        | 135                    | 200                           |
| CMI201209VR47KT  |                      | ±10                   | 0.47                    | 25           | 0.50                | 25                           | 50                        | 125                    | 200                           |
| CMI201209VR56KT  |                      | ±10                   | 0.56                    | 25           | 0.60                | 25                           | 50                        | 115                    | 150                           |
| CMI201209VR68KT  |                      | ±10                   | 0.68                    | 25           | 0.65                | 25                           | 50                        | 105                    | 150                           |
| CMI201209VR82KT  |                      | ±10                   | 0.82                    | 25           | 0.70                | 25                           | 50                        | 100                    | 150                           |
| CMI201209U1R0KT  |                      | ±10                   | 1.0                     | 35           | 0.40                | 10                           | 50                        | 75                     | 50                            |
| CMI201209U1R2KT  |                      | ±10                   | 1.2                     | 35           | 0.40                | 10                           | 50                        | 65                     | 50                            |
| CMI201209U1R5KT  |                      | ±10                   | 1.5                     | 35           | 0.40                | 10                           | 50                        | 60                     | 50                            |
| CMI201209U1R8KT  |                      | ±10                   | 1.8                     | 35           | 0.40                | 10                           | 50                        | 55                     | 50                            |
| CMI201209U2R2KT  |                      | ±10                   | 2.2                     | 35           | 0.60                | 10                           | 50                        | 50                     | 50                            |
| CMI201209U2R7KT  |                      | ±10                   | 2.7                     | 35           | 0.60                | 10                           | 50                        | 45                     | 50                            |
| CMI201209U3R3KT  |                      | ±10                   | 3.3                     | 35           | 0.60                | 10                           | 50                        | 41                     | 50                            |
| CMI201209U3R9KT  |                      | ±10                   | 3.9                     | 35           | 0.80                | 10                           | 50                        | 38                     | 50                            |
| CMI201209U4R7KT  |                      | ±10                   | 4.7                     | 35           | 0.90                | 10                           | 50                        | 35                     | 30                            |
| CMI201209X5R6KT  |                      | ±10                   | 5.6                     | 30           | 1.00                | 4                            | 50                        | 32                     | 15                            |
| CMI201209X6R8KT  |                      | ±10                   | 6.8                     | 30           | 1.05                | 4                            | 50                        | 29                     | 15                            |
| CMI201209X8R2KT  |                      | ±10                   | 8.2                     | 30           | 1.05                | 4                            | 50                        | 26                     | 15                            |
| CMI201209X100KT  |                      | ±10                   | 10                      | 30           | 1.15                | 2                            | 50                        | 24                     | 15                            |
| CMI201209X120KT  |                      | ±10                   | 12                      | 30           | 1.15                | 2                            | 50                        | 22                     | 15                            |
| CMI201209J150KT  |                      | ±10                   | 15                      | 25           | 1.15                | 1                            | 50                        | 19                     | 5                             |
| CMI201209J180KT  |                      | ±10                   | 18                      | 25           | 1.20                | 1                            | 50                        | 18                     | 5                             |
| CMI201209J220KT  |                      | ±10                   | 22                      | 25           | 1.20                | 1                            | 50                        | 16                     | 5                             |
| CMI201209J270KT  |                      | ±10                   | 27                      | 25           | 1.50                | 1                            | 50                        | 16                     | 5                             |
| CMI201209J330MT  |                      | ±20                   | 33                      | 25           | 1.50                | 1                            | 50                        | 16                     | 5                             |
| CMI201212J390MT  |                      | ±20                   | 39                      | 25           | 1.50                | 1                            | 50                        | 16                     | 5                             |
| CMI201212J470MT  |                      | ±20                   | 47                      | 25           | 1.70                | 1                            | 50                        | 15                     | 5                             |
|                  |                      |                       |                         |              |                     |                              |                           |                        |                               |





| 型号规格<br>Part NO. | 客户料号<br>Customer P/N | 误差范围<br>Tolerance (%) | 标称感量<br>Inductance (μH) | Q 值<br>(min) | 直流电阻<br>RDC (Ω) max | 测试频率<br>Test frequency (MHz) | 测试电压<br>Test voltage (mV) | 自谐振频率<br>SRF (MHz) min | 额定电流<br>Rated current (mA)max |
|------------------|----------------------|-----------------------|-------------------------|--------------|---------------------|------------------------------|---------------------------|------------------------|-------------------------------|
| CMI321609V47NKT  |                      | ±10                   | 0.047                   | 30           | 0.15                | 50                           | 50                        | 320                    | 300                           |
| CMI321609V56NKT  |                      | ±10                   | 0.056                   | 30           | 0.20                | 50                           | 50                        | 320                    | 300                           |
| CMI321609V68NKT  |                      | ±10                   | 0.068                   | 30           | 0.25                | 50                           | 50                        | 280                    | 300                           |
| CMI321609V82NKT  |                      | ±10                   | 0.082                   | 30           | 0.25                | 50                           | 50                        | 280                    | 300                           |
| CMI321609VR10KT  |                      | ±10                   | 0.10                    | 25           | 0.25                | 25                           | 50                        | 235                    | 250                           |
| CMI321609VR12KT  |                      | ±10                   | 0.12                    | 25           | 0.25                | 25                           | 50                        | 220                    | 250                           |
| CMI321609VR15KT  |                      | ±10                   | 0.15                    | 25           | 0.25                | 25                           | 50                        | 200                    | 250                           |
| CMI321609VR18KT  |                      | ±10                   | 0.18                    | 25           | 0.30                | 25                           | 50                        | 185                    | 250                           |
| CMI321609VR22KT  |                      | ±10                   | 0.22                    | 25           | 0.30                | 25                           | 50                        | 170                    | 250                           |
| CMI321609VR27KT  |                      | ±10                   | 0.27                    | 25           | 0.30                | 25                           | 50                        | 150                    | 250                           |
| CMI321609VR33KT  |                      | ±10                   | 0.33                    | 25           | 0.30                | 25                           | 50                        | 145                    | 250                           |
| CMI321609VR39KT  |                      | ±10                   | 0.39                    | 30           | 0.50                | 25                           | 50                        | 135                    | 200                           |
| CMI321609VR47KT  |                      | ±10                   | 0.47                    | 30           | 0.50                | 25                           | 50                        | 125                    | 200                           |
| CMI321609VR56KT  |                      | ±10                   | 0.56                    | 30           | 0.50                | 25                           | 50                        | 115                    | 150                           |
| CMI321609VR68KT  |                      | ±10                   | 0.68                    | 30           | 0.50                | 25                           | 50                        | 105                    | 150                           |
| CMI321609VR82KT  |                      | ±10                   | 0.82                    | 30           | 0.60                | 25                           | 50                        | 100                    | 150                           |
| CMI321609U1R0KT  |                      | ±10                   | 1.0                     | 35           | 0.30                | 10                           | 50                        | 75                     | 100                           |
| CMI321609U1R2KT  |                      | ±10                   | 1.2                     | 35           | 0.40                | 10                           | 50                        | 65                     | 100                           |
| CMI321609U1R5KT  |                      | ±10                   | 1.5                     | 35           | 0.40                | 10                           | 50                        | 60                     | 50                            |
| CMI321609U1R8KT  |                      | ±10                   | 1.8                     | 35           | 0.40                | 10                           | 50                        | 55                     | 50                            |
| CMI321609U2R2KT  |                      | ±10                   | 2.2                     | 35           | 0.50                | 10                           | 50                        | 50                     | 50                            |
| CMI321609U2R7KT  |                      | ±10                   | 2.7                     | 35           | 0.50                | 10                           | 50                        | 45                     | 50                            |
| CMI321609U3R3KT  |                      | ±10                   | 3.3                     | 35           | 0.50                | 10                           | 50                        | 41                     | 50                            |
| CMI321609U3R9KT  |                      | ±10                   | 3.9                     | 35           | 0.60                | 10                           | 50                        | 38                     | 50                            |
| CMI321609U4R7KT  |                      | ±10                   | 4.7                     | 35           | 0.65                | 10                           | 50                        | 35                     | 25                            |
| CMI321609U5R6KT  |                      | ±10                   | 5.6                     | 35           | 0.80                | 4                            | 50                        | 32                     | 25                            |
| CMI321609X6R8KT  |                      | ±10                   | 6.8                     | 35           | 0.80                | 4                            | 50                        | 29                     | 25                            |
| CMI321609X8R2KT  |                      | ±10                   | 8.2                     | 35           | 0.80                | 4                            | 50                        | 26                     | 25                            |
| CMI321609X100KT  |                      | ±10                   | 10                      | 35           | 0.80                | 2                            | 50                        | 24                     | 25                            |
| CMI321609X120KT  |                      | ±10                   | 12                      | 35           | 0.90                | 2                            | 50                        | 22                     | 15                            |
| CMI321609J150KT  |                      | ±10                   | 15                      | 30           | 1.00                | 1                            | 50                        | 19                     | 5                             |
| CMI321609J180KT  |                      | ±10                   | 18                      | 30           | 1.00                | 1                            | 50                        | 18                     | 5                             |
| CMI321609J220KT  |                      | ±10                   | 22                      | 30           | 1.20                | 1                            | 50                        | 16                     | 5                             |
| CMI321609J270KT  |                      | ±10                   | 27                      | 30           | 1.20                | 1                            | 50                        | 14                     | 5                             |
| CMI321609J330KT  |                      | ±10                   | 33                      | 30           | 1.30                | 1                            | 50                        | 13                     | 5                             |
| CMI321609J390KT  |                      | ±10                   | 39                      | 30           | 1.30                | 1                            | 50                        | 13                     | 5                             |
| CMI321611J470KT  |                      | ±10                   | 47                      | 30           | 1.60                | 1                            | 50                        | 12                     | 5                             |
| CMI321611J560MT  |                      | ±20                   | 56                      | 30           | 1.80                | 1                            | 50                        | 12                     | 5                             |
| CMI321611J680MT  |                      | ±20                   | 68                      | 30           | 2.00                | 1                            | 50                        | 11                     | 5                             |
| CMI321611J820MT  |                      | ±20                   | 82                      | 30           | 2.40                | 1                            | 50                        | 11                     | 5                             |
| CMI321611J101MT  |                      | ±20                   | 100                     | 30           | 3.00                | 1                            | 50                        | 8                      | 5                             |







| 型号规格<br>Part NO. | 客户料号<br>Customer P/N | 误差范围<br>Tolerance (%) | 标称感量<br>Inductance (μH) | Q 值<br>(min) | 直流电阻<br>RDC (Ω) max | 测试频率<br>Test frequency (MHz) | 测试电压<br>Test voltage (mV) | 自谐振频率<br>SRF (MHz) min | 额定电流<br>Rated current (mA)max |
|------------------|----------------------|-----------------------|-------------------------|--------------|---------------------|------------------------------|---------------------------|------------------------|-------------------------------|
| CMP201209VD47NMT |                      | ±20                   | 0.047                   | /            | 0.10                | 1                            | 50                        | 280                    | 1100                          |
| CMP201209VD56NMT |                      | ±20                   | 0.056                   | /            | 0.10                | 1                            | 50                        | 280                    | 1100                          |
| CMP201209VD68NMT |                      | ±20                   | 0.068                   | /            | 0.15                | 1                            | 50                        | 250                    | 1100                          |
| CMP201209VD82NMT |                      | ±20                   | 0.082                   | /            | 0.15                | 1                            | 50                        | 250                    | 1100                          |
| CMP201209VDR10MT |                      | ±20                   | 0.10                    | /            | 0.15                | 1                            | 50                        | 210                    | 1100                          |
| CMP201209VDR12MT |                      | ±20                   | 0.12                    | /            | 0.15                | 1                            | 50                        | 200                    | 1100                          |
| CMP201209VDR15MT |                      | ±20                   | 0.15                    | /            | 0.15                | 1                            | 50                        | 175                    | 1100                          |
| CMP201209VDR18MT |                      | ±20                   | 0.18                    | /            | 0.15                | 1                            | 50                        | 160                    | 1100                          |
| CMP201209VDR22MT |                      | ±20                   | 0.22                    | /            | 0.15                | 1                            | 50                        | 150                    | 1100                          |
| CMP201209VDR27MT |                      | ±20                   | 0.27                    | /            | 0.15                | 1                            | 50                        | 130                    | 1100                          |
| CMP201209VDR33MT |                      | ±20                   | 0.33                    | /            | 0.15                | 1                            | 50                        | 120                    | 1100                          |
| CMP201209VDR39MT |                      | ±20                   | 0.39                    | /            | 0.15                | 1                            | 50                        | 110                    | 1100                          |
| CMP201209VDR47MT |                      | ±20                   | 0.47                    | /            | 0.15                | 1                            | 50                        | 100                    | 1100                          |
| CMP201209VDR56MT |                      | ±20                   | 0.56                    | /            | 0.36                | 1                            | 50                        | 100                    | 800                           |
| CMP201209VDR68MT |                      | ±20                   | 0.68                    | /            | 0.36                | 1                            | 50                        | 95                     | 800                           |
| CMP201209VDR82MT |                      | ±20                   | 0.82                    | /            | 0.36                | 1                            | 50                        | 90                     | 800                           |
| CMP201209UD1R0MT |                      | ±20                   | 1.0                     | /            | 0.24                | 1                            | 50                        | 75                     | 800                           |
| CMP201209UD1R2MT |                      | ±20                   | 1.2                     | /            | 0.24                | 1                            | 50                        | 65                     | 800                           |
| CMP201209UD1R5MT |                      | ±20                   | 1.5                     | /            | 0.30                | 1                            | 50                        | 60                     | 700                           |
| CMP201209UD1R8MT |                      | ±20                   | 1.8                     | /            | 0.36                | 1                            | 50                        | 55                     | 600                           |
| CMP201209UD2R2MT |                      | ±20                   | 2.2                     | /            | 0.36                | 1                            | 50                        | 50                     | 600                           |
| CMP201209UD2R7MT |                      | ±20                   | 2.7                     | /            | 0.36                | 1                            | 50                        | 45                     | 600                           |
| CMP201209UD3R3MT |                      | ±20                   | 3.3                     | /            | 0.40                | 1                            | 50                        | 41                     | 350                           |
| CMP201209UD3R9MT |                      | ±20                   | 3.9                     | /            | 0.40                | 1                            | 50                        | 38                     | 350                           |
| CMP201209UD4R7MT |                      | ±20                   | 4.7                     | /            | 0.40                | 1                            | 50                        | 35                     | 350                           |
| CMP201209XD5R6MT |                      | ±20                   | 5.6                     | /            | 0.50                | 1                            | 50                        | 32                     | 250                           |
| CMP201209XD6R8MT |                      | ±20                   | 6.8                     | /            | 0.50                | 1                            | 50                        | 29                     | 250                           |
| CMP201209XD8R2MT |                      | ±20                   | 8.2                     | /            | 0.56                | 1                            | 50                        | 26                     | 250                           |
| CMP201209XD100MT |                      | ±20                   | 10                      | /            | 0.56                | 1                            | 50                        | 24                     | 250                           |
| CMP201209XD120MT |                      | ±20                   | 12                      | /            | 0.56                | 1                            | 50                        | 22                     | 250                           |
| CMP201209JD150MT |                      | ±20                   | 15                      | /            | 0.65                | 1                            | 50                        | 19                     | 100                           |
| CMP201209JD180MT |                      | ±20                   | 18                      | /            | 0.65                | 1                            | 50                        | 18                     | 100                           |
| CMP201209JD220MT |                      | ±20                   | 22                      | /            | 0.65                | 1                            | 50                        | 16                     | 100                           |
|                  |                      |                       |                         |              |                     |                              |                           |                        |                               |
|                  |                      |                       |                         |              |                     |                              |                           |                        |                               |
|                  |                      |                       |                         |              |                     |                              |                           |                        |                               |









| 型号规格<br>Part NO. | 客户料号<br>Customer P/N | 误差范围<br>Tolerance (%) | 标称感量<br>Inductance (μH) | Q 值<br>(min) | 直流电阻<br>RDC (Ω) max | 测试频率<br>Test frequency (MHz) | 测试电压<br>Test voltage (mV) | 自谐振频率<br>SRF (MHz) min | 额定电流<br>Rated current (mA)max |
|------------------|----------------------|-----------------------|-------------------------|--------------|---------------------|------------------------------|---------------------------|------------------------|-------------------------------|
| CMP201209VE47NMT |                      | ±20                   | 0.047                   | /            | 0.15                | 1                            | 50                        | 320                    | 350                           |
| CMP201209VE56NMT |                      | ±20                   | 0.056                   | /            | 0.15                | 1                            | 50                        | 320                    | 350                           |
| CMP201209VE68NMT |                      | ±20                   | 0.068                   | /            | 0.20                | 1                            | 50                        | 280                    | 350                           |
| CMP201209VE82NMT |                      | ±20                   | 0.082                   | /            | 0.20                | 1                            | 50                        | 280                    | 350                           |
| CMP201209VER10MT |                      | ±20                   | 0.10                    | /            | 0.20                | 1                            | 50                        | 235                    | 350                           |
| CMP201209VER12MT |                      | ±20                   | 0.12                    | /            | 0.20                | 1                            | 50                        | 220                    | 350                           |
| CMP201209VER15MT |                      | ±20                   | 0.15                    | /            | 0.20                | 1                            | 50                        | 200                    | 350                           |
| CMP201209VER18MT |                      | ±20                   | 0.18                    | /            | 0.25                | 1                            | 50                        | 185                    | 300                           |
| CMP201209VER22MT |                      | ±20                   | 0.22                    | /            | 0.25                | 1                            | 50                        | 170                    | 300                           |
| CMP201209VER27MT |                      | ±20                   | 0.27                    | /            | 0.25                | 1                            | 50                        | 150                    | 300                           |
| CMP201209VER33MT |                      | ±20                   | 0.33                    | /            | 0.25                | 1                            | 50                        | 145                    | 300                           |
| CMP201209VER39MT |                      | ±20                   | 0.39                    | /            | 0.30                | 1                            | 50                        | 135                    | 250                           |
| CMP201209VER47MT |                      | ±20                   | 0.47                    | /            | 0.30                | 1                            | 50                        | 125                    | 250                           |
| CMP201209VER56MT |                      | ±20                   | 0.56                    | /            | 0.36                | 1                            | 50                        | 115                    | 200                           |
| CMP201209VER68MT |                      | ±20                   | 0.68                    | /            | 0.36                | 1                            | 50                        | 105                    | 200                           |
| CMP201209VER82MT |                      | ±20                   | 0.82                    | /            | 0.36                | 1                            | 50                        | 100                    | 200                           |
| CMP201209UE1R0MT |                      | ±20                   | 1.0                     | /            | 0.26                | 1                            | 50                        | 75                     | 220                           |
| CMP201209UE1R2MT |                      | ±20                   | 1.2                     | /            | 0.26                | 1                            | 50                        | 65                     | 220                           |
| CMP201209UE1R5MT |                      | ±20                   | 1.5                     | /            | 0.30                | 1                            | 50                        | 60                     | 180                           |
| CMP201209UE1R8MT |                      | ±20                   | 1.8                     | /            | 0.30                | 1                            | 50                        | 55                     | 180                           |
| CMP201209UE2R2MT |                      | ±20                   | 2.2                     | /            | 0.36                | 1                            | 50                        | 50                     | 150                           |
| CMP201209UE2R7MT |                      | ±20                   | 2.7                     | /            | 0.36                | 1                            | 50                        | 45                     | 150                           |
| CMP201209UE3R3MT |                      | ±20                   | 3.3                     | /            | 0.40                | 1                            | 50                        | 41                     | 120                           |
| CMP201209UE3R9MT |                      | ±20                   | 3.9                     | /            | 0.40                | 1                            | 50                        | 38                     | 120                           |
| CMP201209UE4R7MT |                      | ±20                   | 4.7                     | /            | 0.40                | 1                            | 50                        | 35                     | 120                           |
| CMP201209XE5R6MT |                      | ±20                   | 5.6                     | /            | 0.60                | 1                            | 50                        | 32                     | 100                           |
| CMP201209XE6R8MT |                      | ±20                   | 6.8                     | /            | 0.60                | 1                            | 50                        | 29                     | 100                           |
| CMP201209XE8R2MT |                      | ±20                   | 8.2                     | /            | 0.65                | 1                            | 50                        | 26                     | 100                           |
| CMP201209XE100MT |                      | ±20                   | 10                      | /            | 0.65                | 1                            | 50                        | 24                     | 100                           |
| CMP201209XE120MT |                      | ±20                   | 12                      | /            | 0.65                | 1                            | 50                        | 22                     | 100                           |
| CMP201209JE150MT |                      | ±20                   | 15                      | /            | 0.75                | 1                            | 50                        | 19                     | 50                            |
| CMP201209JE180MT |                      | ±20                   | 18                      | /            | 0.75                | 1                            | 50                        | 18                     | 50                            |
| CMP201209JE220MT |                      | ±20                   | 22                      | /            | 0.75                | 1                            | 50                        | 16                     | 50                            |
|                  |                      |                       |                         |              |                     |                              |                           |                        |                               |
|                  |                      |                       |                         |              |                     |                              |                           |                        |                               |
|                  |                      |                       |                         |              |                     |                              |                           |                        |                               |





| 型号规格<br>Part NO. | 客户料号<br>Customer P/N | 误差范围<br>Tolerance (%) | 标称感量<br>Inductance (μH) | Q 值<br>(min) | 直流电阻<br>RDC (Ω) max | 测试频率<br>Test frequency (MHz) | 测试电压<br>Test voltage (mV) | 自谐振频率<br>SRF (MHz) min | 额定电流<br>Rated current (mA)max |
|------------------|----------------------|-----------------------|-------------------------|--------------|---------------------|------------------------------|---------------------------|------------------------|-------------------------------|
| CMP321609VE47NMT |                      | ±20                   | 0.047                   | /            | 0.15                | 1                            | 50                        | 320                    | 450                           |
| CMP321609VE56NMT |                      | ±20                   | 0.056                   | /            | 0.15                | 1                            | 50                        | 320                    | 450                           |
| CMP321609VE68NMT |                      | ±20                   | 0.068                   | /            | 0.20                | 1                            | 50                        | 280                    | 450                           |
| CMP321609VE82NMT |                      | ±20                   | 0.082                   | /            | 0.20                | 1                            | 50                        | 280                    | 450                           |
| CMP321609VER10MT |                      | ±20                   | 0.10                    | /            | 0.20                | 1                            | 50                        | 235                    | 350                           |
| CMP321609VER12MT |                      | ±20                   | 0.12                    | /            | 0.20                | 1                            | 50                        | 220                    | 350                           |
| CMP321609VER15MT |                      | ±20                   | 0.15                    | /            | 0.20                | 1                            | 50                        | 200                    | 350                           |
| CMP321609VER18MT |                      | ±20                   | 0.18                    | /            | 0.20                | 1                            | 50                        | 185                    | 350                           |
| CMP321609VER22MT |                      | ±20                   | 0.22                    | /            | 0.20                | 1                            | 50                        | 170                    | 350                           |
| CMP321609VER27MT |                      | ±20                   | 0.27                    | /            | 0.20                | 1                            | 50                        | 150                    | 350                           |
| CMP321609VER33MT |                      | ±20                   | 0.33                    | /            | 0.20                | 1                            | 50                        | 145                    | 350                           |
| CMP321609VER39MT |                      | ±20                   | 0.39                    | /            | 0.30                | 1                            | 50                        | 135                    | 220                           |
| CMP321609VER47MT |                      | ±20                   | 0.47                    | /            | 0.30                | 1                            | 50                        | 125                    | 220                           |
| CMP321609VER56MT |                      | ±20                   | 0.56                    | /            | 0.30                | 1                            | 50                        | 115                    | 220                           |
| CMP321609VER68MT |                      | ±20                   | 0.68                    | /            | 0.30                | 1                            | 50                        | 105                    | 220                           |
| CMP321609VER82MT |                      | ±20                   | 0.82                    | /            | 0.30                | 1                            | 50                        | 100                    | 220                           |
| CMP321609UE1R0MT |                      | ±20                   | 1.0                     | /            | 0.20                | 1                            | 50                        | 75                     | 250                           |
| CMP321609UE1R2MT |                      | ±20                   | 1.2                     | /            | 0.20                | 1                            | 50                        | 65                     | 250                           |
| CMP321609UE1R5MT |                      | ±20                   | 1.5                     | /            | 0.25                | 1                            | 50                        | 60                     | 250                           |
| CMP321609UE1R8MT |                      | ±20                   | 1.8                     | /            | 0.25                | 1                            | 50                        | 55                     | 250                           |
| CMP321609UE2R2MT |                      | ±20                   | 2.2                     | /            | 0.30                | 1                            | 50                        | 50                     | 200                           |
| CMP321609UE2R7MT |                      | ±20                   | 2.7                     | /            | 0.30                | 1                            | 50                        | 45                     | 200                           |
| CMP321609UE3R3MT |                      | ±20                   | 3.3                     | /            | 0.30                | 1                            | 50                        | 41                     | 200                           |
| CMP321609UE3R9MT |                      | ±20                   | 3.9                     | /            | 0.35                | 1                            | 50                        | 38                     | 150                           |
| CMP321609UE4R7MT |                      | ±20                   | 4.7                     | /            | 0.35                | 1                            | 50                        | 35                     | 150                           |
| CMP321609UE5R6MT |                      | ±20                   | 5.6                     | /            | 0.50                | 1                            | 50                        | 32                     | 100                           |
| CMP321609XE6R8MT |                      | ±20                   | 6.8                     | /            | 0.50                | 1                            | 50                        | 29                     | 100                           |
| CMP321609XE8R2MT |                      | ±20                   | 8.2                     | /            | 0.50                | 1                            | 50                        | 26                     | 100                           |
| CMP321609XE100MT |                      | ±20                   | 10                      | /            | 0.50                | 1                            | 50                        | 24                     | 100                           |
| CMP321609XE120MT |                      | ±20                   | 12                      | /            | 0.60                | 1                            | 50                        | 22                     | 100                           |
| CMP321609JE150MT |                      | ±20                   | 15                      | /            | 0.80                | 1                            | 50                        | 19                     | 50                            |
| CMP321609JE180MT |                      | ±20                   | 18                      | /            | 0.80                | 1                            | 50                        | 18                     | 50                            |
| CMP321609JE220MT |                      | ±20                   | 22                      | /            | 1.00                | 1                            | 50                        | 16                     | 50                            |
| CMP321609JE270MT |                      | ±20                   | 27                      | /            | 1.00                | 1                            | 50                        | 14                     | 50                            |
|                  |                      |                       |                         |              |                     |                              |                           |                        |                               |
|                  |                      |                       |                         |              |                     |                              |                           |                        |                               |



| 型号规格<br>Part NO. | 客户料号<br>Customer P/N | 误差范围<br>Tolerance (nH) | 标称感量<br>Inductance (nH) | Q 值<br>(min) | 直流电阻<br>RDC ( $\Omega$ ) max | 测试频率<br>Test frequency (MHz) | 测试电压<br>Test voltage (mV) | 自谐振频率<br>SRF (MHz) min | 额定电流<br>Rated current (mA)max |
|------------------|----------------------|------------------------|-------------------------|--------------|------------------------------|------------------------------|---------------------------|------------------------|-------------------------------|
| VHF100505H1N0ST  |                      | $\pm 0.3$              | 1.0                     | 7            | 0.10                         | 100                          | 50                        | 10000                  | 400                           |
| VHF100505H1N1ST  |                      | $\pm 0.3$              | 1.1                     | 7            | 0.10                         | 100                          | 50                        | 10000                  | 400                           |
| VHF100505H1N2ST  |                      | $\pm 0.3$              | 1.2                     | 7            | 0.10                         | 100                          | 50                        | 10000                  | 400                           |
| VHF100505H1N3ST  |                      | $\pm 0.3$              | 1.3                     | 7            | 0.10                         | 100                          | 50                        | 10000                  | 400                           |
| VHF100505H1N5ST  |                      | $\pm 0.3$              | 1.5                     | 7            | 0.10                         | 100                          | 50                        | 6000                   | 300                           |
| VHF100505H1N6ST  |                      | $\pm 0.3$              | 1.6                     | 7            | 0.10                         | 100                          | 50                        | 6000                   | 300                           |
| VHF100505H1N8ST  |                      | $\pm 0.3$              | 1.8                     | 7            | 0.10                         | 100                          | 50                        | 6000                   | 300                           |
| VHF100505H2N0ST  |                      | $\pm 0.3$              | 2.0                     | 7            | 0.20                         | 100                          | 50                        | 6000                   | 300                           |
| VHF100505H2N2ST  |                      | $\pm 0.3$              | 2.2                     | 7            | 0.20                         | 100                          | 50                        | 6000                   | 300                           |
| VHF100505H2N4ST  |                      | $\pm 0.3$              | 2.4                     | 7            | 0.20                         | 100                          | 50                        | 6000                   | 300                           |
| VHF100505H2N7ST  |                      | $\pm 0.3$              | 2.7                     | 7            | 0.20                         | 100                          | 50                        | 6000                   | 300                           |
| VHF100505H3N0ST  |                      | $\pm 0.3$              | 3.0                     | 7            | 0.20                         | 100                          | 50                        | 6000                   | 300                           |
| VHF100505H3N3ST  |                      | $\pm 0.3$              | 3.3                     | 7            | 0.20                         | 100                          | 50                        | 6000                   | 300                           |
| VHF100505H3N6ST  |                      | $\pm 0.3$              | 3.6                     | 7            | 0.20                         | 100                          | 50                        | 4000                   | 300                           |
| VHF100505H3N9ST  |                      | $\pm 0.3$              | 3.9                     | 7            | 0.20                         | 100                          | 50                        | 4000                   | 300                           |
| VHF100505H4N3ST  |                      | $\pm 0.3$              | 4.3                     | 7            | 0.20                         | 100                          | 50                        | 4000                   | 300                           |
| VHF100505H4N7ST  |                      | $\pm 0.3$              | 4.7                     | 7            | 0.20                         | 100                          | 50                        | 4000                   | 300                           |
| VHF100505H5N1ST  |                      | $\pm 0.3$              | 5.1                     | 7            | 0.30                         | 100                          | 50                        | 4000                   | 300                           |
| VHF100505H5N6ST  |                      | $\pm 0.3$              | 5.6                     | 7            | 0.30                         | 100                          | 50                        | 4000                   | 300                           |
| VHF100505H6N2ST  |                      | $\pm 0.3$              | 6.2                     | 7            | 0.30                         | 100                          | 50                        | 3900                   | 300                           |
| VHF100505H6N8JT  |                      | $\pm 5\%$              | 6.8                     | 7            | 0.30                         | 100                          | 50                        | 3900                   | 300                           |
| VHF100505H7N5JT  |                      | $\pm 5\%$              | 7.5                     | 7            | 0.40                         | 100                          | 50                        | 3700                   | 300                           |
| VHF100505H8N2JT  |                      | $\pm 5\%$              | 8.2                     | 7            | 0.40                         | 100                          | 50                        | 3600                   | 300                           |
| VHF100505H9N1JT  |                      | $\pm 5\%$              | 9.1                     | 7            | 0.40                         | 100                          | 50                        | 3400                   | 300                           |
| VHF100505H10NJT  |                      | $\pm 5\%$              | 10                      | 7            | 0.40                         | 100                          | 50                        | 3200                   | 300                           |
| VHF100505H12NJT  |                      | $\pm 5\%$              | 12                      | 8            | 0.50                         | 100                          | 50                        | 2700                   | 300                           |
| VHF100505H15NJT  |                      | $\pm 5\%$              | 15                      | 8            | 0.50                         | 100                          | 50                        | 2300                   | 300                           |









| 型号规格<br>Part NO. | 客户料号<br>Customer<br>P/N | 误差<br>范围<br>Tolerance | 标称阻抗<br>Impedance<br>(Ω) | 直流电阻<br>RDC<br>(Ω)max | 测试频率<br>Test<br>frequency<br>(MHz) | 测试电压<br>Test voltage<br>(mV) | 额定电流<br>Rated<br>current<br>(mA)max |
|------------------|-------------------------|-----------------------|--------------------------|-----------------------|------------------------------------|------------------------------|-------------------------------------|
| CBG100505U000T   |                         | 0~15Ω                 | 0                        | 0.10                  | 100                                | 50                           | 300                                 |
| CBG100505U050T   |                         | 0~15Ω                 | 5                        | 0.10                  | 100                                | 50                           | 300                                 |
| CBG100505U070T   |                         | 0~11Ω                 | 7                        | 0.10                  | 100                                | 50                           | 300                                 |
| CBG100505U090T   |                         | 5~13Ω                 | 9                        | 0.10                  | 100                                | 50                           | 300                                 |
| CBG100505U110T   |                         | 7~15Ω                 | 11                       | 0.10                  | 100                                | 50                           | 300                                 |
| CBG100505U150T   |                         | 9~21Ω                 | 15                       | 0.10                  | 100                                | 50                           | 300                                 |
| CBG100505U190T   |                         | 12~25Ω                | 19                       | 0.10                  | 100                                | 50                           | 300                                 |
| CBG100505U260T   |                         | ±25%                  | 26                       | 0.15                  | 100                                | 50                           | 300                                 |
| CBG100505U310T   |                         | ±25%                  | 31                       | 0.20                  | 100                                | 50                           | 300                                 |
| CBG100505U360T   |                         | ±25%                  | 36                       | 0.20                  | 100                                | 50                           | 300                                 |
| CBG100505U600T   |                         | ±25%                  | 60                       | 0.35                  | 100                                | 50                           | 200                                 |
| CBG100505U800T   |                         | ±25%                  | 80                       | 0.40                  | 100                                | 50                           | 200                                 |
| CBG100505U121T   |                         | ±25%                  | 120                      | 0.50                  | 100                                | 50                           | 150                                 |
| CBG100505U151T   |                         | ±25%                  | 150                      | 0.55                  | 100                                | 50                           | 150                                 |
| CBG100505U181T   |                         | ±25%                  | 180                      | 0.60                  | 100                                | 50                           | 150                                 |
| CBG100505U221T   |                         | ±25%                  | 220                      | 0.70                  | 100                                | 50                           | 100                                 |
| CBG100505U301T   |                         | ±25%                  | 300                      | 0.80                  | 100                                | 50                           | 100                                 |
| CBG100505U501T   |                         | ±25%                  | 500                      | 1.10                  | 100                                | 50                           | 100                                 |
| CBG100505U601T   |                         | ±25%                  | 600                      | 1.30                  | 100                                | 50                           | 100                                 |
| CBG100505U801T   |                         | ±25%                  | 800                      | 1.40                  | 100                                | 50                           | 50                                  |
| CBG100505U102T   |                         | ±25%                  | 1000                     | 1.60                  | 100                                | 50                           | 25                                  |
|                  |                         |                       |                          |                       |                                    |                              |                                     |
|                  |                         |                       |                          |                       |                                    |                              |                                     |
|                  |                         |                       |                          |                       |                                    |                              |                                     |
|                  |                         |                       |                          |                       |                                    |                              |                                     |
|                  |                         |                       |                          |                       |                                    |                              |                                     |
|                  |                         |                       |                          |                       |                                    |                              |                                     |
|                  |                         |                       |                          |                       |                                    |                              |                                     |
|                  |                         |                       |                          |                       |                                    |                              |                                     |
|                  |                         |                       |                          |                       |                                    |                              |                                     |
|                  |                         |                       |                          |                       |                                    |                              |                                     |



| 型号规格<br>Part NO. | 客户料号<br>Customer<br>P/N | 误差<br>范围<br>Tolerance | 标称阻抗<br>Impedance<br>( $\Omega$ ) | 直流电阻<br>RDC<br>( $\Omega$ )max | 测试频率<br>Test<br>frequency<br>(MHz) | 测试电压<br>Test voltage<br>(mV) | 额定电流<br>Rated<br>current<br>(mA)max |
|------------------|-------------------------|-----------------------|-----------------------------------|--------------------------------|------------------------------------|------------------------------|-------------------------------------|
| CBG160808U000T   |                         | 0~15 $\Omega$         | 0                                 | 0.10                           | 100                                | 50                           | 800                                 |
| CBG160808U050T   |                         | 0~15 $\Omega$         | 5                                 | 0.10                           | 100                                | 50                           | 800                                 |
| CBG160808U070T   |                         | 0~11 $\Omega$         | 7                                 | 0.10                           | 100                                | 50                           | 800                                 |
| CBG160808U090T   |                         | 5~13 $\Omega$         | 9                                 | 0.10                           | 100                                | 50                           | 800                                 |
| CBG160808U110T   |                         | 7~15 $\Omega$         | 11                                | 0.10                           | 100                                | 50                           | 800                                 |
| CBG160808U150T   |                         | 9~21 $\Omega$         | 15                                | 0.10                           | 100                                | 50                           | 800                                 |
| CBG160808U190T   |                         | 12~25 $\Omega$        | 19                                | 0.10                           | 100                                | 50                           | 800                                 |
| CBG160808U260T   |                         | $\pm 25\%$            | 26                                | 0.10                           | 100                                | 50                           | 500                                 |
| CBG160808U310T   |                         | $\pm 25\%$            | 31                                | 0.10                           | 100                                | 50                           | 500                                 |
| CBG160808U600T   |                         | $\pm 25\%$            | 60                                | 0.20                           | 100                                | 50                           | 300                                 |
| CBG160808U700T   |                         | $\pm 25\%$            | 70                                | 0.20                           | 100                                | 50                           | 300                                 |
| CBG160808U800T   |                         | $\pm 25\%$            | 80                                | 0.20                           | 100                                | 50                           | 300                                 |
| CBG160808U101T   |                         | $\pm 25\%$            | 100                               | 0.20                           | 100                                | 50                           | 300                                 |
| CBG160808U121T   |                         | $\pm 25\%$            | 120                               | 0.20                           | 100                                | 50                           | 300                                 |
| CBG160808U151T   |                         | $\pm 25\%$            | 150                               | 0.30                           | 100                                | 50                           | 300                                 |
| CBG160808U181T   |                         | $\pm 25\%$            | 180                               | 0.30                           | 100                                | 50                           | 300                                 |
| CBG160808U221T   |                         | $\pm 25\%$            | 220                               | 0.30                           | 100                                | 50                           | 300                                 |
| CBG160808U301T   |                         | $\pm 25\%$            | 300                               | 0.35                           | 100                                | 50                           | 200                                 |
| CBG160808U501T   |                         | $\pm 25\%$            | 500                               | 0.50                           | 100                                | 50                           | 200                                 |
| CBG160808U601T   |                         | $\pm 25\%$            | 600                               | 0.50                           | 100                                | 50                           | 200                                 |
| CBG160808U801T   |                         | $\pm 25\%$            | 800                               | 0.60                           | 100                                | 50                           | 200                                 |
| CBG160808U102T   |                         | $\pm 25\%$            | 1000                              | 0.60                           | 100                                | 50                           | 200                                 |
| CBG160808U122T   |                         | $\pm 25\%$            | 1200                              | 0.85                           | 100                                | 50                           | 100                                 |
| CBG160808U152T   |                         | $\pm 25\%$            | 1500                              | 0.85                           | 100                                | 50                           | 50                                  |
| CBG160808U202T   |                         | $\pm 25\%$            | 2000                              | 1.10                           | 100                                | 50                           | 50                                  |
| CBG160808U222T   |                         | $\pm 25\%$            | 2200                              | 1.20                           | 100                                | 50                           | 50                                  |
| CBG160808U252T   |                         | $\pm 25\%$            | 2500                              | 1.30                           | 100                                | 50                           | 50                                  |



| 型号规格<br>Part NO. | 客户料号<br>Customer<br>P/N | 误差<br>范围<br>Tolerance | 标称阻抗<br>Impedance<br>( $\Omega$ ) | 直流电阻<br>RDC<br>( $\Omega$ )max | 测试频率<br>Test<br>frequency<br>(MHz) | 测试电压<br>Test voltage<br>(mV) | 额定电流<br>Rated<br>current<br>(mA)max |
|------------------|-------------------------|-----------------------|-----------------------------------|--------------------------------|------------------------------------|------------------------------|-------------------------------------|
| CBG201209U000T   |                         | 0~15 $\Omega$         | 0                                 | 0.08                           | 100                                | 50                           | 900                                 |
| CBG201209U050T   |                         | 0~15 $\Omega$         | 5                                 | 0.08                           | 100                                | 50                           | 900                                 |
| CBG201209U070T   |                         | 0~11 $\Omega$         | 7                                 | 0.08                           | 100                                | 50                           | 900                                 |
| CBG201209U090T   |                         | 5~13 $\Omega$         | 9                                 | 0.10                           | 100                                | 50                           | 900                                 |
| CBG201209U110T   |                         | 7~15 $\Omega$         | 11                                | 0.10                           | 100                                | 50                           | 900                                 |
| CBG201209U150T   |                         | 9~21 $\Omega$         | 15                                | 0.10                           | 100                                | 50                           | 900                                 |
| CBG201209U190T   |                         | 12~25 $\Omega$        | 19                                | 0.10                           | 100                                | 50                           | 900                                 |
| CBG201209U260T   |                         | $\pm 25\%$            | 26                                | 0.10                           | 100                                | 50                           | 900                                 |
| CBG201209U310T   |                         | $\pm 25\%$            | 31                                | 0.10                           | 100                                | 50                           | 900                                 |
| CBG201209U360T   |                         | $\pm 25\%$            | 36                                | 0.10                           | 100                                | 50                           | 900                                 |
| CBG201209U600T   |                         | $\pm 25\%$            | 60                                | 0.15                           | 100                                | 50                           | 900                                 |
| CBG201209U700T   |                         | $\pm 25\%$            | 70                                | 0.18                           | 100                                | 50                           | 500                                 |
| CBG201209U800T   |                         | $\pm 25\%$            | 80                                | 0.18                           | 100                                | 50                           | 500                                 |
| CBG201209U101T   |                         | $\pm 25\%$            | 100                               | 0.18                           | 100                                | 50                           | 500                                 |
| CBG201209U121T   |                         | $\pm 25\%$            | 120                               | 0.20                           | 100                                | 50                           | 500                                 |
| CBG201209U151T   |                         | $\pm 25\%$            | 150                               | 0.20                           | 100                                | 50                           | 400                                 |
| CBG201209U181T   |                         | $\pm 25\%$            | 180                               | 0.20                           | 100                                | 50                           | 400                                 |
| CBG201209U221T   |                         | $\pm 25\%$            | 220                               | 0.20                           | 100                                | 50                           | 400                                 |
| CBG201209U301T   |                         | $\pm 25\%$            | 300                               | 0.25                           | 100                                | 50                           | 400                                 |
| CBG201209U501T   |                         | $\pm 25\%$            | 500                               | 0.35                           | 100                                | 50                           | 300                                 |
| CBG201209U601T   |                         | $\pm 25\%$            | 600                               | 0.35                           | 100                                | 50                           | 300                                 |
| CBG201209U801T   |                         | $\pm 25\%$            | 800                               | 0.40                           | 100                                | 50                           | 300                                 |
| CBG201209U102T   |                         | $\pm 25\%$            | 1000                              | 0.40                           | 100                                | 50                           | 300                                 |
| CBG201209U122T   |                         | $\pm 25\%$            | 1200                              | 0.60                           | 100                                | 50                           | 100                                 |
| CBG201209U152T   |                         | $\pm 25\%$            | 1500                              | 0.70                           | 100                                | 50                           | 100                                 |
| CBG201209U182T   |                         | $\pm 25\%$            | 1800                              | 0.90                           | 100                                | 50                           | 50                                  |
| CBG201209U202T   |                         | $\pm 25\%$            | 2000                              | 0.90                           | 100                                | 50                           | 50                                  |
| CBG201209U222T   |                         | $\pm 25\%$            | 2200                              | 1.00                           | 100                                | 50                           | 50                                  |
| CBG201209U252T   |                         | $\pm 25\%$            | 2500                              | 1.20                           | 50                                 | 50                           | 50                                  |
| CBG201209U272T   |                         | $\pm 25\%$            | 2700                              | 1.40                           | 50                                 | 50                           | 30                                  |





| 型号规格<br>Part NO. | 客户料号<br>Customer<br>P/N | 误差<br>范围<br>Tolerance | 标称阻抗<br>Impedance<br>( $\Omega$ ) | 直流电阻<br>RDC<br>( $\Omega$ )max | 测试频率<br>Test<br>frequency<br>(MHz) | 测试电压<br>Test voltage<br>(mV) | 额定电流<br>Rated<br>current<br>(mA)max |
|------------------|-------------------------|-----------------------|-----------------------------------|--------------------------------|------------------------------------|------------------------------|-------------------------------------|
| CBG321609U000T   |                         | 0~15 $\Omega$         | 0                                 | 0.10                           | 100                                | 50                           | 1000                                |
| CBG321609U050T   |                         | 0~15 $\Omega$         | 5                                 | 0.10                           | 100                                | 50                           | 1000                                |
| CBG321609U070T   |                         | 0~11 $\Omega$         | 7                                 | 0.10                           | 100                                | 50                           | 1000                                |
| CBG321609U090T   |                         | 5~13 $\Omega$         | 9                                 | 0.10                           | 100                                | 50                           | 1000                                |
| CBG321609U110T   |                         | 7~15 $\Omega$         | 11                                | 0.10                           | 100                                | 50                           | 1000                                |
| CBG321609U150T   |                         | 9~21 $\Omega$         | 15                                | 0.10                           | 100                                | 50                           | 1000                                |
| CBG321609U190T   |                         | 12~25 $\Omega$        | 19                                | 0.10                           | 100                                | 50                           | 1000                                |
| CBG321609U260T   |                         | $\pm 25\%$            | 26                                | 0.10                           | 100                                | 50                           | 1000                                |
| CBG321609U310T   |                         | $\pm 25\%$            | 31                                | 0.10                           | 100                                | 50                           | 1000                                |
| CBG321609U600T   |                         | $\pm 25\%$            | 60                                | 0.15                           | 100                                | 50                           | 1000                                |
| CBG321609U700T   |                         | $\pm 25\%$            | 70                                | 0.15                           | 100                                | 50                           | 1000                                |
| CBG321609U800T   |                         | $\pm 25\%$            | 80                                | 0.15                           | 100                                | 50                           | 1000                                |
| CBG321609U101T   |                         | $\pm 25\%$            | 100                               | 0.15                           | 100                                | 50                           | 1000                                |
| CBG321609U121T   |                         | $\pm 25\%$            | 120                               | 0.15                           | 100                                | 50                           | 1000                                |
| CBG321609U151T   |                         | $\pm 25\%$            | 150                               | 0.20                           | 100                                | 50                           | 800                                 |
| CBG321609U181T   |                         | $\pm 25\%$            | 180                               | 0.20                           | 100                                | 50                           | 800                                 |
| CBG321609U221T   |                         | $\pm 25\%$            | 220                               | 0.20                           | 100                                | 50                           | 800                                 |
| CBG321609U301T   |                         | $\pm 25\%$            | 300                               | 0.20                           | 100                                | 50                           | 800                                 |
| CBG321609U501T   |                         | $\pm 25\%$            | 500                               | 0.30                           | 100                                | 50                           | 600                                 |
| CBG321609U601T   |                         | $\pm 25\%$            | 600                               | 0.30                           | 100                                | 50                           | 600                                 |
| CBG321609U801T   |                         | $\pm 25\%$            | 800                               | 0.35                           | 100                                | 50                           | 400                                 |
| CBG321609U102T   |                         | $\pm 25\%$            | 1000                              | 0.35                           | 100                                | 50                           | 400                                 |
| CBG321609U122T   |                         | $\pm 25\%$            | 1200                              | 0.60                           | 100                                | 50                           | 100                                 |
| CBG321609U152T   |                         | $\pm 25\%$            | 1500                              | 0.80                           | 50                                 | 50                           | 100                                 |
| CBG321609U182T   |                         | $\pm 25\%$            | 1800                              | 0.90                           | 50                                 | 50                           | 80                                  |
| CBG321609U202T   |                         | $\pm 25\%$            | 2000                              | 1.00                           | 50                                 | 50                           | 50                                  |
| CBG321609U252T   |                         | $\pm 25\%$            | 2500                              | 1.20                           | 50                                 | 50                           | 50                                  |
| CBG321609U302T   |                         | $\pm 25\%$            | 3000                              | 1.50                           | 50                                 | 50                           | 30                                  |









| 型号规格<br>Part NO. | 客户料号<br>Customer<br>P/N | 误差<br>范围<br>Tolerance | 标称阻抗<br>Impedance<br>( $\Omega$ ) | 直流电阻<br>RDC<br>( $\Omega$ )max | 测试频率<br>Test<br>frequency<br>(MHz) | 测试电压<br>Test voltage<br>(mV) | 额定电流<br>Rated<br>current<br>(mA)max |
|------------------|-------------------------|-----------------------|-----------------------------------|--------------------------------|------------------------------------|------------------------------|-------------------------------------|
| CBW100505U000T   |                         | 0~15 $\Omega$         | 0                                 | 0.04                           | 100                                | 50                           | 800                                 |
| CBW100505U050T   |                         | 0~15 $\Omega$         | 5                                 | 0.04                           | 100                                | 50                           | 800                                 |
| CBW100505U070T   |                         | 0~11 $\Omega$         | 7                                 | 0.04                           | 100                                | 50                           | 800                                 |
| CBW100505U090T   |                         | 5~13 $\Omega$         | 9                                 | 0.04                           | 100                                | 50                           | 800                                 |
| CBW100505U110T   |                         | 7~15 $\Omega$         | 11                                | 0.04                           | 100                                | 50                           | 800                                 |
| CBW100505U150T   |                         | 9~21 $\Omega$         | 15                                | 0.04                           | 100                                | 50                           | 800                                 |
| CBW100505U190T   |                         | 12~25 $\Omega$        | 19                                | 0.06                           | 100                                | 50                           | 700                                 |
| CBW100505U260T   |                         | $\pm 25\%$            | 26                                | 0.06                           | 100                                | 50                           | 700                                 |
| CBW100505U310T   |                         | $\pm 25\%$            | 31                                | 0.08                           | 100                                | 50                           | 700                                 |
| CBW100505U360T   |                         | $\pm 25\%$            | 36                                | 0.15                           | 100                                | 50                           | 600                                 |
| CBW100505U500T   |                         | $\pm 25\%$            | 50                                | 0.15                           | 100                                | 50                           | 600                                 |
| CBW100505U600T   |                         | $\pm 25\%$            | 60                                | 0.15                           | 100                                | 50                           | 600                                 |
| CBW100505U700T   |                         | $\pm 25\%$            | 70                                | 0.20                           | 100                                | 50                           | 450                                 |
| CBW100505U750T   |                         | $\pm 25\%$            | 75                                | 0.20                           | 100                                | 50                           | 450                                 |
| CBW100505U800T   |                         | $\pm 25\%$            | 80                                | 0.20                           | 100                                | 50                           | 450                                 |
| CBW100505U101T   |                         | $\pm 25\%$            | 100                               | 0.20                           | 100                                | 50                           | 450                                 |
| CBW100505U121T   |                         | $\pm 25\%$            | 120                               | 0.25                           | 100                                | 50                           | 450                                 |
| CBW100505U151T   |                         | $\pm 25\%$            | 150                               | 0.25                           | 100                                | 50                           | 450                                 |
| CBW100505U181T   |                         | $\pm 25\%$            | 180                               | 0.40                           | 100                                | 50                           | 300                                 |
| CBW100505U221T   |                         | $\pm 25\%$            | 220                               | 0.40                           | 100                                | 50                           | 300                                 |
| CBW100505U301T   |                         | $\pm 25\%$            | 300                               | 0.50                           | 100                                | 50                           | 300                                 |
| CBW100505U501T   |                         | $\pm 25\%$            | 500                               | 0.65                           | 100                                | 50                           | 200                                 |
| CBW100505U601T   |                         | $\pm 25\%$            | 600                               | 0.70                           | 100                                | 50                           | 200                                 |
| CBW100505U801T   |                         | $\pm 25\%$            | 800                               | 0.90                           | 100                                | 50                           | 200                                 |
| CBW100505U102T   |                         | $\pm 25\%$            | 1000                              | 1.00                           | 100                                | 50                           | 200                                 |
| CBW100505U122T   |                         | $\pm 25\%$            | 1200                              | 1.00                           | 100                                | 50                           | 200                                 |
|                  |                         |                       |                                   |                                |                                    |                              |                                     |



| 型号规格<br>Part NO. | 客户料号<br>Customer<br>P/N | 误差<br>范围<br>Tolerance | 标称阻抗<br>Impedance<br>( $\Omega$ ) | 直流电阻<br>RDC<br>( $\Omega$ )max | 测试频率<br>Test<br>frequency<br>(MHz) | 测试电压<br>Test voltage<br>(mV) | 额定电流<br>Rated<br>current<br>(mA)max |
|------------------|-------------------------|-----------------------|-----------------------------------|--------------------------------|------------------------------------|------------------------------|-------------------------------------|
| CBW160808U000T   |                         | 0~15 $\Omega$         | 0                                 | 0.08                           | 100                                | 50                           | 1000                                |
| CBW160808U050T   |                         | 0~15 $\Omega$         | 5                                 | 0.08                           | 100                                | 50                           | 1000                                |
| CBW160808U070T   |                         | 0~11 $\Omega$         | 7                                 | 0.08                           | 100                                | 50                           | 1000                                |
| CBW160808U090T   |                         | 5~13 $\Omega$         | 9                                 | 0.08                           | 100                                | 50                           | 1000                                |
| CBW160808U110T   |                         | 7~15 $\Omega$         | 11                                | 0.08                           | 100                                | 50                           | 1000                                |
| CBW160808U150T   |                         | 9~21 $\Omega$         | 15                                | 0.08                           | 100                                | 50                           | 1000                                |
| CBW160808U190T   |                         | 12~25 $\Omega$        | 19                                | 0.08                           | 100                                | 50                           | 1000                                |
| CBW160808U260T   |                         | $\pm 25\%$            | 26                                | 0.08                           | 100                                | 50                           | 1000                                |
| CBW160808U300T   |                         | $\pm 25\%$            | 30                                | 0.08                           | 100                                | 50                           | 1000                                |
| CBW160808U310T   |                         | $\pm 25\%$            | 31                                | 0.08                           | 100                                | 50                           | 1000                                |
| CBW160808U500T   |                         | $\pm 25\%$            | 50                                | 0.12                           | 100                                | 50                           | 1000                                |
| CBW160808U600T   |                         | $\pm 25\%$            | 60                                | 0.12                           | 100                                | 50                           | 1000                                |
| CBW160808U700T   |                         | $\pm 25\%$            | 70                                | 0.15                           | 100                                | 50                           | 1000                                |
| CBW160808U800T   |                         | $\pm 25\%$            | 80                                | 0.15                           | 100                                | 50                           | 1000                                |
| CBW160808U101T   |                         | $\pm 25\%$            | 100                               | 0.15                           | 100                                | 50                           | 1000                                |
| CBW160808U121T   |                         | $\pm 25\%$            | 120                               | 0.15                           | 100                                | 50                           | 1000                                |
| CBW160808U151T   |                         | $\pm 25\%$            | 150                               | 0.20                           | 100                                | 50                           | 1000                                |
| CBW160808U181T   |                         | $\pm 25\%$            | 180                               | 0.20                           | 100                                | 50                           | 1000                                |
| CBW160808U221T   |                         | $\pm 25\%$            | 220                               | 0.20                           | 100                                | 50                           | 1000                                |
| CBW160808U301T   |                         | $\pm 25\%$            | 300                               | 0.25                           | 100                                | 50                           | 1000                                |
| CBW160808U501T   |                         | $\pm 25\%$            | 500                               | 0.30                           | 100                                | 50                           | 1000                                |
| CBW160808U601T   |                         | $\pm 25\%$            | 600                               | 0.30                           | 100                                | 50                           | 1000                                |
| CBW160808U801T   |                         | $\pm 25\%$            | 800                               | 0.55                           | 100                                | 50                           | 500                                 |
| CBW160808U102T   |                         | $\pm 25\%$            | 1000                              | 0.55                           | 100                                | 50                           | 500                                 |
| CBW160808U122T   |                         | $\pm 25\%$            | 1200                              | 0.65                           | 100                                | 50                           | 500                                 |
| CBW160808U152T   |                         | $\pm 25\%$            | 1500                              | 0.75                           | 100                                | 50                           | 400                                 |
| CBW160808U182T   |                         | $\pm 25\%$            | 1800                              | 0.75                           | 100                                | 50                           | 400                                 |
| CBW160808U202T   |                         | $\pm 25\%$            | 2000                              | 0.90                           | 100                                | 50                           | 400                                 |
| CBW160808U252T   |                         | $\pm 25\%$            | 2500                              | 0.90                           | 100                                | 50                           | 400                                 |
|                  |                         |                       |                                   |                                |                                    |                              |                                     |



| 型号规格<br>Part NO. | 客户料号<br>Customer<br>P/N | 误差<br>范围<br>Tolerance | 标称阻抗<br>Impedance<br>( $\Omega$ ) | 直流电阻<br>RDC<br>( $\Omega$ )max | 测试频率<br>Test<br>frequency<br>(MHz) | 测试电压<br>Test voltage<br>(mV) | 额定电流<br>Rated<br>current<br>(mA)max |
|------------------|-------------------------|-----------------------|-----------------------------------|--------------------------------|------------------------------------|------------------------------|-------------------------------------|
| CBW201209U000T   |                         | 0~15 $\Omega$         | 0                                 | 0.03                           | 100                                | 50                           | 3000                                |
| CBW201209U050T   |                         | 0~15 $\Omega$         | 5                                 | 0.03                           | 100                                | 50                           | 3000                                |
| CBW201209U070T   |                         | 0~11 $\Omega$         | 7                                 | 0.03                           | 100                                | 50                           | 3000                                |
| CBW201209U090T   |                         | 5~13 $\Omega$         | 9                                 | 0.03                           | 100                                | 50                           | 3000                                |
| CBW201209U110T   |                         | 7~15 $\Omega$         | 11                                | 0.03                           | 100                                | 50                           | 3000                                |
| CBW201209U150T   |                         | 9~21 $\Omega$         | 15                                | 0.03                           | 100                                | 50                           | 3000                                |
| CBW201209U190T   |                         | 12~25 $\Omega$        | 19                                | 0.03                           | 100                                | 50                           | 3000                                |
| CBW201209U300T   |                         | $\pm 25\%$            | 30                                | 0.05                           | 100                                | 50                           | 3000                                |
| CBW201209U310T   |                         | $\pm 25\%$            | 31                                | 0.05                           | 100                                | 50                           | 3000                                |
| CBW201209U360T   |                         | $\pm 25\%$            | 36                                | 0.06                           | 100                                | 50                           | 3000                                |
| CBW201209U600T   |                         | $\pm 25\%$            | 60                                | 0.06                           | 100                                | 50                           | 3000                                |
| CBW201209U700T   |                         | $\pm 25\%$            | 70                                | 0.08                           | 100                                | 50                           | 2500                                |
| CBW201209U800T   |                         | $\pm 25\%$            | 80                                | 0.08                           | 100                                | 50                           | 2500                                |
| CBW201209U101T   |                         | $\pm 25\%$            | 100                               | 0.10                           | 100                                | 50                           | 2500                                |
| CBW201209U121T   |                         | $\pm 25\%$            | 120                               | 0.10                           | 100                                | 50                           | 2000                                |
| CBW201209U151T   |                         | $\pm 25\%$            | 150                               | 0.10                           | 100                                | 50                           | 2000                                |
| CBW201209U181T   |                         | $\pm 25\%$            | 180                               | 0.15                           | 100                                | 50                           | 2000                                |
| CBW201209U201T   |                         | $\pm 25\%$            | 200                               | 0.15                           | 100                                | 50                           | 2000                                |
| CBW201209U221T   |                         | $\pm 25\%$            | 220                               | 0.15                           | 100                                | 50                           | 2000                                |
| CBW201209U301T   |                         | $\pm 25\%$            | 300                               | 0.20                           | 100                                | 50                           | 2000                                |
| CBW201209U501T   |                         | $\pm 25\%$            | 500                               | 0.25                           | 100                                | 50                           | 1500                                |
| CBW201209U601T   |                         | $\pm 25\%$            | 600                               | 0.25                           | 100                                | 50                           | 1500                                |
| CBW201209U801T   |                         | $\pm 25\%$            | 800                               | 0.30                           | 100                                | 50                           | 800                                 |
| CBW201209U102T   |                         | $\pm 25\%$            | 1000                              | 0.30                           | 100                                | 50                           | 800                                 |
| CBW201209U122T   |                         | $\pm 25\%$            | 1200                              | 0.45                           | 100                                | 50                           | 500                                 |
| CBW201209U152T   |                         | $\pm 25\%$            | 1500                              | 0.50                           | 100                                | 50                           | 300                                 |
| CBW201209U202T   |                         | $\pm 25\%$            | 2000                              | 0.50                           | 100                                | 50                           | 300                                 |
| CBW201209U222T   |                         | $\pm 25\%$            | 2200                              | 0.60                           | 100                                | 50                           | 100                                 |
| CBW201209U252T   |                         | $\pm 25\%$            | 2500                              | 0.60                           | 50                                 | 50                           | 100                                 |



| 型号规格<br>Part NO. | 客户料号<br>Customer<br>P/N | 误差<br>范围<br>Tolerance | 标称阻抗<br>Impedance<br>( $\Omega$ ) | 直流电阻<br>RDC<br>( $\Omega$ )max | 测试频率<br>Test<br>frequency<br>(MHz) | 测试电压<br>Test voltage<br>(mV) | 额定电流<br>Rated<br>current<br>(mA)max |
|------------------|-------------------------|-----------------------|-----------------------------------|--------------------------------|------------------------------------|------------------------------|-------------------------------------|
| CBW321609U000T   |                         | 0~15 $\Omega$         | 0                                 | 0.04                           | 100                                | 50                           | 4000                                |
| CBW321609U050T   |                         | 0~15 $\Omega$         | 5                                 | 0.04                           | 100                                | 50                           | 4000                                |
| CBW321609U070T   |                         | 0~11 $\Omega$         | 7                                 | 0.04                           | 100                                | 50                           | 4000                                |
| CBW321609U090T   |                         | 5~13 $\Omega$         | 9                                 | 0.05                           | 100                                | 50                           | 4000                                |
| CBW321609U110T   |                         | 7~15 $\Omega$         | 11                                | 0.05                           | 100                                | 50                           | 4000                                |
| CBW321609U150T   |                         | 9~21 $\Omega$         | 15                                | 0.05                           | 100                                | 50                           | 3000                                |
| CBW321609U190T   |                         | 12~25 $\Omega$        | 19                                | 0.05                           | 100                                | 50                           | 3000                                |
| CBW321609U260T   |                         | $\pm 25\%$            | 26                                | 0.05                           | 100                                | 50                           | 3000                                |
| CBW321609U280T   |                         | $\pm 25\%$            | 28                                | 0.07                           | 100                                | 50                           | 3000                                |
| CBW321609U300T   |                         | $\pm 25\%$            | 30                                | 0.07                           | 100                                | 50                           | 3000                                |
| CBW321609U310T   |                         | $\pm 25\%$            | 31                                | 0.07                           | 100                                | 50                           | 3000                                |
| CBW321609U500T   |                         | $\pm 25\%$            | 50                                | 0.07                           | 100                                | 50                           | 3000                                |
| CBW321609U600T   |                         | $\pm 25\%$            | 60                                | 0.07                           | 100                                | 50                           | 3000                                |
| CBW321609U700T   |                         | $\pm 25\%$            | 70                                | 0.07                           | 100                                | 50                           | 3000                                |
| CBW321609U800T   |                         | $\pm 25\%$            | 80                                | 0.07                           | 100                                | 50                           | 3000                                |
| CBW321609U101T   |                         | $\pm 25\%$            | 100                               | 0.07                           | 100                                | 50                           | 3000                                |
| CBW321609U121T   |                         | $\pm 25\%$            | 120                               | 0.07                           | 100                                | 50                           | 3000                                |
| CBW321609U151T   |                         | $\pm 25\%$            | 150                               | 0.12                           | 100                                | 50                           | 2500                                |
| CBW321609U181T   |                         | $\pm 25\%$            | 180                               | 0.12                           | 100                                | 50                           | 2500                                |
| CBW321609U221T   |                         | $\pm 25\%$            | 220                               | 0.12                           | 100                                | 50                           | 2500                                |
| CBW321609U301T   |                         | $\pm 25\%$            | 300                               | 0.15                           | 100                                | 50                           | 2000                                |
| CBW321609U501T   |                         | $\pm 25\%$            | 500                               | 0.20                           | 100                                | 50                           | 2000                                |
| CBW321609U601T   |                         | $\pm 25\%$            | 600                               | 0.20                           | 100                                | 50                           | 2000                                |
| CBW321609U801T   |                         | $\pm 25\%$            | 800                               | 0.25                           | 100                                | 50                           | 2000                                |
| CBW321609U102T   |                         | $\pm 25\%$            | 1000                              | 0.25                           | 100                                | 50                           | 2000                                |
| CBW321609U122T   |                         | $\pm 25\%$            | 1200                              | 0.35                           | 100                                | 50                           | 1000                                |
| CBW321609U152T   |                         | $\pm 25\%$            | 1500                              | 0.45                           | 50                                 | 50                           | 500                                 |
| CBW321609U182T   |                         | $\pm 25\%$            | 1800                              | 0.60                           | 50                                 | 50                           | 500                                 |
| CBW321609U202T   |                         | $\pm 25\%$            | 2000                              | 0.70                           | 50                                 | 50                           | 300                                 |
| CBW321609U252T   |                         | $\pm 25\%$            | 2500                              | 0.90                           | 50                                 | 50                           | 200                                 |
| CBW321609U302T   |                         | $\pm 25\%$            | 3000                              | 0.90                           | 50                                 | 50                           | 200                                 |

















| 型号规格<br>Part NO. | 客户料号<br>Customer<br>P/N | 误差<br>范围<br>Tolerance | 标称阻抗<br>Impedance<br>( $\Omega$ ) | 直流电阻<br>RDC<br>( $\Omega$ )max | 测试频率<br>Test<br>frequency<br>(MHz) | 测试电压<br>Test voltage<br>(mV) | 额定电流<br>Rated<br>current<br>(mA)max |
|------------------|-------------------------|-----------------------|-----------------------------------|--------------------------------|------------------------------------|------------------------------|-------------------------------------|
| CBM321609U000T   |                         | 0~15 $\Omega$         | 0                                 | 0.01                           | 100                                | 50                           | 6000                                |
| CBM321609U050T   |                         | 0~15 $\Omega$         | 5                                 | 0.01                           | 100                                | 50                           | 6000                                |
| CBM321609U070T   |                         | 0~11 $\Omega$         | 7                                 | 0.01                           | 100                                | 50                           | 6000                                |
| CBM321609U090T   |                         | 5~13 $\Omega$         | 9                                 | 0.015                          | 100                                | 50                           | 6000                                |
| CBM321609U110T   |                         | 7~15 $\Omega$         | 11                                | 0.015                          | 100                                | 50                           | 6000                                |
| CBM321609U150T   |                         | 9~21 $\Omega$         | 15                                | 0.015                          | 100                                | 50                           | 6000                                |
| CBM321609U190T   |                         | 12~25 $\Omega$        | 19                                | 0.015                          | 100                                | 50                           | 6000                                |
| CBM321609U260T   |                         | $\pm 25\%$            | 26                                | 0.015                          | 100                                | 50                           | 6000                                |
| CBM321609U280T   |                         | $\pm 25\%$            | 28                                | 0.015                          | 100                                | 50                           | 6000                                |
| CBM321609U300T   |                         | $\pm 25\%$            | 30                                | 0.015                          | 100                                | 50                           | 6000                                |
| CBM321609U310T   |                         | $\pm 25\%$            | 31                                | 0.025                          | 100                                | 50                           | 4000                                |
| CBM321609U500T   |                         | $\pm 25\%$            | 50                                | 0.025                          | 100                                | 50                           | 4000                                |
| CBM321609U600T   |                         | $\pm 25\%$            | 60                                | 0.025                          | 100                                | 50                           | 4000                                |
| CBM321609U700T   |                         | $\pm 25\%$            | 70                                | 0.035                          | 100                                | 50                           | 4000                                |
| CBM321609U800T   |                         | $\pm 25\%$            | 80                                | 0.035                          | 100                                | 50                           | 4000                                |
| CBM321609U101T   |                         | $\pm 25\%$            | 100                               | 0.035                          | 100                                | 50                           | 4000                                |
| CBM321609U121T   |                         | $\pm 25\%$            | 120                               | 0.035                          | 100                                | 50                           | 4000                                |
| CBM321609U151T   |                         | $\pm 25\%$            | 150                               | 0.045                          | 100                                | 50                           | 3000                                |
| CBM321609U181T   |                         | $\pm 25\%$            | 180                               | 0.055                          | 100                                | 50                           | 3000                                |
| CBM321609U221T   |                         | $\pm 25\%$            | 220                               | 0.055                          | 100                                | 50                           | 3000                                |
| CBM321609U301T   |                         | $\pm 25\%$            | 300                               | 0.065                          | 100                                | 50                           | 2500                                |
| CBM321609U501T   |                         | $\pm 25\%$            | 500                               | 0.085                          | 100                                | 50                           | 2500                                |
| CBM321609U601T   |                         | $\pm 25\%$            | 600                               | 0.10                           | 100                                | 50                           | 2000                                |
| CBM321609U801T   |                         | $\pm 25\%$            | 800                               | 0.11                           | 100                                | 50                           | 2000                                |
| CBM321609U102T   |                         | $\pm 25\%$            | 1000                              | 0.12                           | 100                                | 50                           | 2000                                |
|                  |                         |                       |                                   |                                |                                    |                              |                                     |
|                  |                         |                       |                                   |                                |                                    |                              |                                     |
|                  |                         |                       |                                   |                                |                                    |                              |                                     |
|                  |                         |                       |                                   |                                |                                    |                              |                                     |
|                  |                         |                       |                                   |                                |                                    |                              |                                     |
|                  |                         |                       |                                   |                                |                                    |                              |                                     |
|                  |                         |                       |                                   |                                |                                    |                              |                                     |
|                  |                         |                       |                                   |                                |                                    |                              |                                     |
|                  |                         |                       |                                   |                                |                                    |                              |                                     |

























## 5 可靠性试验项目 Reliability Testing Items

| 序号<br>No. | 项目<br>Items                           | 要求<br>Requirements   | 试验方法及备注<br>Test Methods and Remarks   |
|-----------|---------------------------------------|--|---|
| 1         | 工作温度范围<br>Operating Temperature Range | -40℃~+85℃  |   |
| 2         | 可焊<br>Solder ability                  | 至少 90%端电极表面被焊锡覆盖。<br>At least 90% of terminal electrode should be covered with solder  | <p>预热温度:120 ~ 150℃<br/>           预热时间: 60s<br/>           焊料: (96.5Sn/3.0Ag/0.5Cu) 焊锡<br/>           焊锡温度: 245±5℃<br/>           浸锡时间 : 5±1s<br/>           浸入松香助焊剂约 3 ~ 5 s<br/>           浸入速度:25mm/sec<br/>           Preheating temperature:120 to 150℃<br/>           Preheating time: 60s<br/>           Solder 96.5Sn/3.0Ag/0.5Cu of the Sn solder.<br/>           Solder temperature: 245±5℃<br/>           Duration : 5±1s<br/>           Immersion into the colophony flux for 3 to 5 sec.<br/>           Immersion speed: 25mm/sec</p>      |
| 3         | 耐焊接热<br>Resistance to Soldering       | <p>至少 75%的焊锡覆盖在端电极表面，无可见机械损伤。<br/>           电感量变化率如下：<br/>           陶瓷体电感（H料）：±10%<br/>           铁氧体电感（V、U料）：±20%<br/>           铁氧体电感（X料）：±25%<br/>           铁氧体电感（J料）：±30%<br/>           品质因素变化率（铁氧体）小于±30%，<br/>           品质因素变化率（陶瓷）小于±20%，<br/>           阻抗变化率小于±30%。<br/>           At least 75% of terminal electrode should be covered with solder.<br/>           No mechanical damage.<br/>           Inductance :<br/>           H : change within ±10%<br/>           V、U : change within ±20%<br/>           X : change within ±25%<br/>           J : change within ±30%<br/>           Q value change(ferrite): within ±30%<br/>           Q value change(ceramic): within ±20%<br/>           Impedance change: within ±30%</p> | <p>预热温度: 120 ~ 150℃<br/>           预热时间: 60s<br/>           焊料: (96.5Sn/3.0Ag/0.5Cu) 焊锡<br/>           浸锡温度: 260±5℃<br/>           浸锡时间 : 10±1s<br/>           浸入松香助焊剂约 3 ~ 5 s<br/>           浸入速度: 25mm/sec<br/>           Preheating temperature: 120 to 150℃<br/>           Preheating time: 60s<br/>           Solder 96.5Sn/3.0Ag/0.5Cu of the Sn solder.<br/>           Solder temperature: 260±5℃<br/>           Duration : 10±1s<br/>           Immersion into the colophony flux for 3 to 5 sec.<br/>           Immersion speed: 25mm/sec</p> |



| 序号<br>No. | 项目<br>Items                       | 要求<br>Requirements   | 试验方法及备注<br>Test Methods and Remarks  |
|-----------|-----------------------------------|--|--|
| 4         | 端电极强度<br>Adhesion of electrode    | 端电极与磁体不应受损，无可见机械损伤。<br>The termination and body should be no damage.   | 施加力: 1005 和 1608 系列为 5N; 2012、3216、2520、3225、4516、4532 系列为 10N。<br>保持时间: 10±1S<br>Applied force: 5N force for 1005 and 1608 series. 10N force for 2012、3216、2520、3225、4516、4532 series.<br>Keep time : 10±1S<br> |
| 5         | 耐低温<br>Low temperature resistance | 无可见机械损伤，<br>电感量变化率小于±10%，<br>品质因素变化率（铁氧体）小于±30%，<br>品质因素变化率（陶瓷）小于±20%，<br>阻抗变化率小于±30%。<br>No mechanical damage.<br>Inductance change: within ±10%<br>Q value change(ferrite): within ±30%<br>Q value change(ceramic): within ±20%<br>Impedance change: within ±30% | 测试温度: -55±2℃<br>+24<br>测试时间: 500 -0 h<br>Temperature: -55±2℃<br>+24<br>Testing time: 500 -0 h  |
| 6         | 抗弯强度<br>Bending strength          | 无可见机械损伤，<br>电感量变化率小于±10%，<br>品质因素变化率（铁氧体）小于±30%，<br>品质因素变化率（陶瓷）小于±20%，<br>阻抗变化率小于±30%。<br>No mechanical damage.<br>Inductance change: within ±10%<br>Q value change(ferrite): within ±30%<br>Q value change(ceramic): within ±20%<br>Impedance change: within ±30% | 弯度: 2mm<br>测试基板: 玻璃环氧树脂基板<br>厚度: 0.8mm<br>Warp: 2mm<br>Testing board: glass epoxy-resin substrate<br>Thickness: 0.8mm<br>  |



| 序号<br>No. | 项目<br>Items                        | 要求<br>Requirements   | 试验方法及备注<br>Test Methods and Remarks  |
|-----------|------------------------------------|--|--|
| 7         | 跌落<br>Drop                         | 无可见机械损伤,<br>电感量变化率小于 $\pm 10\%$ ,<br>品质因素变化率(铁氧体)小于 $\pm 30\%$ ,<br>品质因素变化率(陶瓷)小于 $\pm 20\%$ ,<br>阻抗变化率小于 $\pm 30\%$ 。<br>No mechanical damage.<br>Inductance change: within $\pm 10\%$<br>Q value change(ferrite): within $\pm 30\%$<br>Q value change(ceramic): within $\pm 20\%$<br>Impedance change: within $\pm 30\%$ | 从高度为 1 米的空中自由落到混凝土地板重复 10 次。<br>Drop 10 times on a concrete floor from a high of 1m.   |
| 8         | 振动<br>Vibration                    | 无可见机械损伤,<br>电感量变化率小于 $\pm 10\%$ ,<br>品质因素变化率(铁氧体)小于 $\pm 30\%$ ,<br>品质因素变化率(陶瓷)小于 $\pm 20\%$ ,<br>阻抗变化率小于 $\pm 30\%$ 。<br>No mechanical damage.<br>Inductance change: within $\pm 10\%$<br>Q value change(ferrite): within $\pm 30\%$<br>Q value change(ceramic): within $\pm 20\%$<br>Impedance change: within $\pm 30\%$ | 振幅: 1.5mm<br>测试时间: 沿三个垂直方向轴各做 2 小时<br>频率范围: 10Hz ~ 55Hz ~ 10Hz (1 分钟)<br>Amplitude modulation: 1.5mm<br>Test time: A period of 2h in each of 3 mutually perpendicular directions.<br>Frequency range: 10Hz to 55Hz to 10Hz for 1min.   |
| 9         | 耐高温<br>High temperature resistance | 无可见机械损伤,<br>电感量变化率小于 $\pm 10\%$ ,<br>品质因素变化率(铁氧体)小于 $\pm 30\%$ ,<br>品质因素变化率(陶瓷)小于 $\pm 20\%$ ,<br>阻抗变化率小于 $\pm 30\%$ 。<br>No mechanical damage.<br>Inductance change: within $\pm 10\%$<br>Q value change(ferrite): within $\pm 30\%$<br>Q value change(ceramic): within $\pm 20\%$<br>Impedance change: within $\pm 30\%$ | 施加额定电流(仅适用于大电流磁珠)<br>测试时间: $1000 \begin{smallmatrix} +24 \\ -0 \end{smallmatrix} h$<br>测试温度: $85 \pm 2^\circ C$<br><br>Applied current: rated current(CBW Series)<br>Testing time: $1000 \begin{smallmatrix} +24 \\ -0 \end{smallmatrix} h$<br>Temperature: $85 \pm 2^\circ C$ |

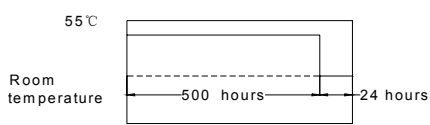
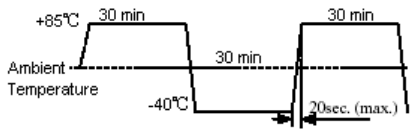

| 序号<br>No. | 项目<br>Items             | 要求<br>Requirements   | 试验方法及备注<br>Test Methods and Remarks  |
|-----------|-------------------------|--|--|
| 10        | 恒定湿热<br>Static Humidity | 无可见机械损伤,<br>电感量变化率小于±10%,<br>品质因素变化率(铁氧体)小于±30%,<br>品质因素变化率(陶瓷)小于±20%,<br>阻抗变化率小于±30%。<br>No mechanical damage.<br>Inductance change: within ±10%<br>Q value change(ferrite): within ±30%<br>Q value change(ceramic): within ±20%<br>Impedance change: within ±30% | 湿度:90~95% RH, 温度:55±2℃<br>+24<br>测试时间:500 <sup>-0</sup> h<br>Humidity: 90 to 95% RH<br>Temperature: 55±2℃<br>+24<br>Testing time: 500 <sup>-0</sup> h<br>                                |
| 11        | 温度循环<br>Thermal Shock   | 无可见机械损伤,<br>电感量变化率小于±10%,<br>品质因素变化率(铁氧体)小于±30%,<br>品质因素变化率(陶瓷)小于±20%,<br>阻抗变化率小于±30%。<br>No mechanical damage.<br>Inductance change: within ±10%<br>Q value change(ferrite): within ±30%<br>Q value change(ceramic): within ±20%<br>Impedance change: within ±30% | 温度: -40℃, 30±3 分钟<br>+85℃, 30±3 分钟<br>转换时间: 20 秒(最大)<br>循环次数: 32<br>Temperature: -40℃ for 30±3min<br>+85℃ for 30±3min<br>Transforming interval :max 20 sec<br>Number of cycles: 32<br> |

注: 以上要求测试电性能的项目, 应试验后在标准条件下放置 24 小时后测试。

**Note: When there are questions concerning, measurement shall be made after 24±2hrs of recovery under the standard condition.**



## 6 产品包装 Packaging

### 1) 编带图 Taping drawings



### 2) 卷盘尺寸 Reel dimensions (Unit:mm)

|       | A           | B            | C            | N          | G      |
|-------|-------------|--------------|--------------|------------|--------|
| CF-8  | 178<br>±2.0 | 22.0<br>±2.0 | 12.5<br>±1.5 | 57<br>±2.0 | 8      |
| CF-12 | 330±2<br>.0 | 22.0±<br>2.0 | 12.5±<br>1.5 | 98<br>±2.0 | 1<br>2 |

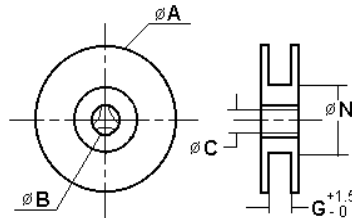

### 3) 导带及空格部分 Leader and blank portion



### 4) 编带尺寸 Taping dimensions (Unit: mm)

#### 纸带 Paper tape



| Part NO. | A        | B        | F        | T      |
|----------|----------|----------|----------|--------|
| 100505   | 0.65±0.1 | 1.15±0.1 | 2.0±0.05 | 0.8max |
| 160808   | 1.1±0.2  | 1.9±0.2  | 4.0±0.2  | 1.1max |
| 201209   | 1.5±0.2  | 2.3±0.2  | 4.0±0.2  | 1.1max |
| 321609   | 1.9±0.2  | 3.5±0.2  | 4.0±0.2  | 1.1max |



5) 塑料胶带 Embossed tape



|                   | 4532        | 4516        | 3225        | 3216        | 2012        | 2520        |
|-------------------|-------------|-------------|-------------|-------------|-------------|-------------|
| W                 | 12.0+/-0.2  | 12.0+/-0.2  | 8.1+/-0.2   | 8.1+/-0.2   | 8.1+/-0.2   | 8.00+/-0.2  |
| P                 | 8.0+/-0.10  | 4.0+/-0.10  | 4.0+/-0.10  | 4.0+/-0.10  | 4.0+/-0.10  | 4.00+/-0.10 |
| E                 | 1.75+/-0.10 | 1.75+/-0.10 | 1.75+/-0.10 | 1.75+/-0.10 | 1.75+/-0.10 | 1.75+/-0.10 |
| F                 | 5.50+/-0.10 | 5.50+/-0.10 | 3.50+/-0.10 | 3.50+/-0.10 | 3.50+/-0.10 | 3.50+/-0.05 |
| D                 | 1.55+/-0.05 | 1.55+/-0.05 | 1.55+/-0.05 | 1.55+/-0.05 | 1.55+/-0.05 | 1.50+/-0.10 |
| D1                | 1.50+/-0.10 | 1.50+/-0.10 | 1.00+/-0.10 | 1.00+/-0.10 | 1.00+/-0.10 | 1.00+/-0.10 |
| P <sub>0</sub>    | 4.0+/-0.10  | 4.0+/-0.10  | 4.0+/-0.10  | 4.0+/-0.10  | 4.0+/-0.10  | 4.00+/-0.10 |
| P <sub>0</sub> 10 | 40.0+/-0.20 | 40.0+/-0.20 | 40.0+/-0.20 | 40.0+/-0.20 | 40.0+/-0.20 | 40.0+/-0.20 |
| P <sub>2</sub>    | 2.0+/-0.05  | 2.0+/-0.05  | 2.0+/-0.05  | 2.0+/-0.05  | 2.0+/-0.05  | 2.0+/-0.10  |
| A <sub>0</sub>    | 3.66+/-0.10 | 1.93+/-0.10 | 2.80+/-0.10 | 1.90+/-0.10 | 1.52+/-0.10 | 2.20+/-0.10 |
| B <sub>0</sub>    | 4.95+/-0.10 | 4.95+/-0.10 | 3.50+/-0.10 | 3.51+/-0.10 | 2.41+/-0.10 | 2.75+/-0.10 |
| t                 | 0.23+/-0.10 | 0.23+/-0.10 | 0.23+/-0.10 | 0.23+/-0.10 | 0.23+/-0.10 | 0.23+/-0.05 |
| K <sub>0</sub>    | 1.74+/-0.10 | 1.85+/-0.10 | 1.55+/-0.10 | 1.27+/-0.10 | 1.35+/-0.10 | 1.05+/-0.01 |

6) 剥离力检验 Peeling off force



① 盖带的剥离力：沿面胶移动方向拉时要求剥离力为 0.1N~0.7N。

Peeling force should be 0.1~0.7N pulling in the direction of arrow.

② 剥离速度：300mm/min

Speed of peeling off: 300mm/min.

③ 在胶带、纸带剥落时，面胶不能有破损，不能粘纸带。

The cover bond should not be damaged and bond the tape when it peeled off.

7) 包装数量 (单位: 粒) Packaging number (Unit: Pcs)

| 类型 SIZE   | 453215 | 451616 | 322513 | 321611 | 321609 | 252009 | 201212 | 201209 | 160808 | 100505 |
|-----------|--------|--------|--------|--------|--------|--------|--------|--------|--------|--------|
| 每卷数量 REEL | 3000   | 5000   | 3000   | 3000   | 4000   | 3000   | 3000   | 4000   | 4000   | 10000  |
| 每盒数量 BOX  | 12000  | 20000  | 30000  | 30000  | 40000  | 30000  | 30000  | 40000  | 40000  | 100000 |
| 每箱数量 CASE | 36000  | 无      | 180000 | 180000 | 240000 | 180000 | 180000 | 240000 | 240000 | 600000 |



## 8) 标签粘贴位置 Label stick station

| 卷盘标签  | 纸盒标签  | 纸盒标签   | 外箱标签  |
|---|---|--|---|
|  |  |  |  |

## 7 推荐焊接条件 Recommend Soldering Conditions

### ② 焊接要求 Soldering conditions

- 预热时，产品表温与焊料温度的温差最大不允许超出 150℃，焊接完冷却时，产品表温与溶剂温度之间的温差最大不超过 100℃。预热不足有可能引发产品表面裂纹，从而导致产品品质下降。
- Pre-heating should be in such a way that the temperature difference between solder and ferrite surface is limited to 150℃ max. Also cooling into solvent after soldering should be in such way that the temperature difference is limited to 100℃ max. Un-enough pre-heating may cause cracks on the ferrite, resulting in the deterioration of product quality.
- 产品要在以下画出的曲线允许的范围进行焊接。其它焊接条件可能引起产品电极的腐蚀。当焊接重复时，允许的时间为第一次做的累计时间。
- Products should be soldered within the following allowable range indicated by the slanted line. The excessive soldering conditions may cause the corrosion of the electrode. When soldering is repeated, allowable time is the accumulated time.

### 1) 回流焊曲线 Reflow soldering profile



### 2) 波峰焊曲线 Flow soldering profile







### 3) 手工焊接 Iron soldering

烙铁温度: 350°C Perform soldering at 350°C on 30W max

功率: 最大为 30W Time: < 5S

烙铁停留时间: < 5S (注意不要将烙铁碰到产品端电极) Take care not to apply the tip of the soldering iron to the terminal electrodes

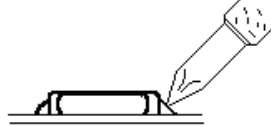

## 8 清洗 Cleaning

### 1) 清洗条件 Cleaning Conditions

清洗温度: 60°C (最高) Cleaning temperature : 60°C max

清洗时间: 1 分钟 (最少) Cleaning time: 1 minute min.

超声波功率: 最大为 200W Ultrasonic output power: 200W max

## 9 存储要求 Storage Requirements

### 1) 存储期限 Storage period

距电感公司出厂检验时间 6 个月内, 产品可以使用检验时间可以通过包装外侧标记的检验号确认。若时间超过 6 个月, 应检查焊接性能后方可使用。

Products which inspected in INDUCTOR COMPANY over 6 months ago should be examined and used, which can be Confirmed with inspection No. marked on the container. Solder ability should be checked if this period is exceeded.

### 2) 存储条件 Storage conditions

(1) 存放货物的库房应满足以下条件: 温度: -10 ~ +40°C, 相对湿度: 30 ~ 70%。

(2) 禁止将产品保管在腐蚀性物质中, 如硫磺、氯气或酸, 否则将引起端头氧化, 导致降低焊接性。

(3) 为了避免受潮气、灰尘等物质的影响, 产品应保管于货架上。

(4) 产品保管在库房中, 应避免热冲击、振动以及直接光照等等。

(5) 产品应密封包装。

(1) Products should be storage in the warehouse on the following conditions:

Temperature : -10~+40°C Humidity: 30~70% relative humidity

(2) Don't keep products in corrosive gases such as sulfur, chlorine gas or acid , or it may case oxidization of Electrodes resulting in poor solder ability.

(3) Products should be storaged on the palette for the prevention of the influence from humidity, dust and so on.

(4) Products should be storaged in the warehouse without heat shock, vibration, direct sunlight and so on.

(5) Products should be storaged under the airtight packaged condition.





## 10 ODS（消耗臭氧层物质）的使用情况 Usage Of ODS

1) 对于以下所列物质，我公司在生产过程中绝不使用。

ODS: CCl<sub>4</sub>（四氯化碳）、HCFC 等。

1) For ODS listed below , we don't use in process.

ODS: CCl<sub>4</sub>, HCFC, etc.

## 11 注意事项 Notes

(1) 若本次承认的为“整体无铅”产品，则表明该产品符合 RoHS 指令的要求。

(2) 本承认书保证我司产品作为一个单体时的质量情况，当我司产品被安装到贵司产品上时请保证贵司的产品已根据贵司的规范进行了有效评价和确认。

(3) 如果贵司对我司产品的试用已超过了本测试规范所界定的产品功能，对于此所引发的失效我司将不予保证。

(1) If the parcel label on product is "Unitary lead free" that indicate the products in accord with ROHS appointed requests.

(2) This product specification guarantees the quality of our product as a single unit, Please make sure that your product has been evaluated and confirmed against your specifications when our product is mounted to your product.

(3) We can't warrant against failure caused by any use of our product that deviates from the intended use as described in this product specification.

## X-ON Electronics

Largest Supplier of Electrical and Electronic Components

*Click to view similar products for [Fixed Inductors](#) category:*

*Click to view products by [Fenghua Advanced](#) manufacturer:*

Other Similar products are found below :

[MLZ1608M6R8WTD25](#) [MLZ1608N6R8LT000](#) [MLZ1608N3R3LTD25](#) [MLZ1608N3R3LT000](#) [MLZ1608N150LT000](#)

[MLZ1608M150WTD25](#) [MLZ1608M3R3WTD25](#) [MLZ1608M3R3WT000](#) [MLZ1608M150WT000](#) [MLZ1608A1R5WT000](#)

[MLZ1608N1R5LT000](#) [B82432C1333K000](#) [PCMB053T-1R0MS](#) [PCMB053T-1R5MS](#) [PCMB104T-1R5MS](#) [CR32NP-100KC](#) [CR32NP-](#)

[151KC](#) [CR32NP-180KC](#) [CR32NP-181KC](#) [CR32NP-1R5MC](#) [CR32NP-390KC](#) [CR32NP-3R9MC](#) [CR32NP-680KC](#) [CR32NP-820KC](#)

[CR32NP-8R2MC](#) [CR43NP-390KC](#) [CR43NP-560KC](#) [CR43NP-680KC](#) [CR54NP-181KC](#) [CR54NP-470LC](#) [CR54NP-820KC](#) [CR54NP-8R5MC](#)

[MGDQ4-00004-P](#) [MGDU1-00016-P](#) [MHL1ECTTP18NJ](#) [MHL1JCTTD12NJ](#) [PE-51506NL](#) [PE-53601NL](#) [PE-53630NL](#) [PE-53824SNLT](#) [PE-](#)

[62892NL](#) [PE-92100NL](#) [PG0434.801NLT](#) [PG0936.113NLT](#) [PM06-2N7](#) [PM06-39NJ](#) [HC2LP-R47-R](#) [HC2-R47-R](#) [HC3-2R2-R](#) [HC8-1R2-R](#)