

REV.	DESCRIPTION	DATE	ANG. = ±3. 0.000 = ±. .000 = ±.XXX .00 = ±.20 0 = ±.30	TOLERANCE	OLD PART NO.	TITLE	NEW PART NO.	DRAW NO.
A	RELEASE	2005/01/27					712-71-03TW01	712-71-03TW01 (C版)
B	REVISE ILLUSTRATION	2008/01/11						
C	ADD ILLUSTRATION	2012/11/14						

SCALE NONE
SIZE A4
SHEET 1 OF 1
REV. C
DRAWER 胡海峰
CHECK
APP'D
PINREX TECHNOLOGY CORP.
频锐科技股份有限公司

Recommended P.C.B Layout

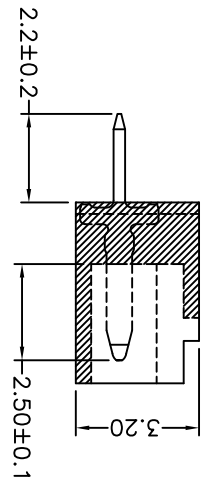
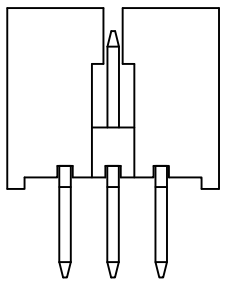
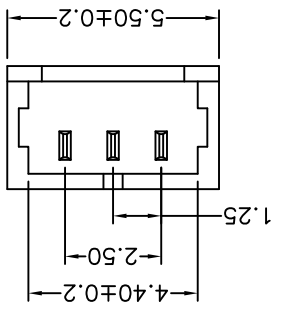
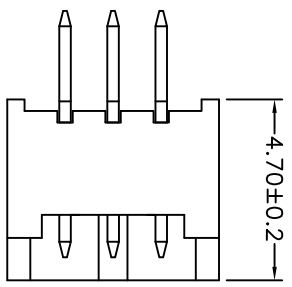
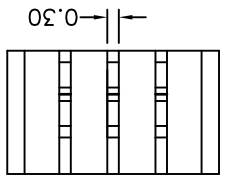
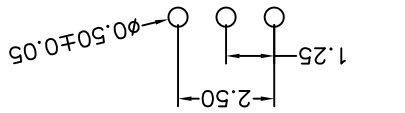

1. 5: Normal parts
- 7: Green Product
- 9: Green Product High Temp
2. No. of contacts per row
3. G: Gold flash
- S: Selective
- T: Tin plated
4. S: Crystal insulator
- W: Nature Color Insulator
5. Pinrex internal code.

712-71-03 T W 0 1
1 2 3 4 5

SPECIFICATION
 Insulator : NYLON 46
 Contact Pin : Brass
 Current Rate : 1 AMP
 Dielectric voltage : 500V AC for one minute
 Insulation Resistance : 500MΩMin.
 Contact Resistance : 20mΩMax
 Operation Temperature : -25°C to + 85°C

MATERIAL
 Insulator : NYLON 46
 Contact Pin : Brass

X-ON Electronics

Largest Supplier of Electrical and Electronic Components

Click to view similar products for [Headers & Wire Housings](#) category:

Click to view products by [Pinrex](#) manufacturer:

Other Similar products are found below :

[95000-104TRLF](#) [10135584-644402LF](#) [DF62W-EP2022PCA](#) [95000-106TRLF](#) [DF62W-2022SCA](#) [DF62W-EP2022PC](#) [2203348](#) [DF62W-2022SC](#) [1084018](#) [1029039](#) [1084017](#) [802-10-012-10-002000](#) [1112640](#) [1112639](#) [891-007-9SS-BST1T](#) [000-34000](#) [0008550134](#) [0009482033](#) [0009507031](#) [57102-F02-18ULF](#) [57102-S06-03LF](#) [57202-S52-04LF](#) [PCN6-15S-2.5E](#) [0039019024](#) [58102-G61-06LF](#) [582553-1](#) [0009485154](#) [0009508121](#) [0022285053](#) [0050291907](#) [018731A](#) [LY20-4P-DT1-P1E-BR](#) [02.125.8002.8](#) [60101931](#) [60598-1 \(Cut Strip\)](#) [M1625-3R/100](#) [61062-3](#) [61082-181009](#) [CSU011177004](#) [636-1427](#) [638009-1](#) [641938-9](#) [641991-4](#) [644168-1](#) [644827-2](#) [647662-1](#) [65039-019ELF](#) [65692-001LF](#) [65781-018](#) [65781-047](#)