

DIMENSIONS					
POSITION	A ±0.20	B +0.20 -0.08	C ±0.25	D ±0.25	E ±0.25
36	6	7.65	9.15	25.00	27.00
64	20	21.65	23.15	39.00	41.00
98	37	38.65	40.15	56.00	58.00
164	70	71.65	73.15	89.00	91.00

- NOTES:
1. MATERIAL: THERMOPLASTIC, HIGH TEMP, UL94V-0.
 - 1.1 HOUSING: THERMOPLASTIC, HIGH TEMP, UL94V-0.
 - 1.2 CONTACTS: COPPER ALLOY.
 - 1.3 HOLDDOWN: COPPER ALLOY.
 2. FINISH: 100µ" MIN. MATTE TIN PLATING ON CONTACT AREA.
 - 2.1 CONTACT: 50µ" MIN. NICKEL UNDERPLATING OVERALL. 100µ" MIN. MATTE TIN PLATING ON SOLDER TAILS.
 - 2.2 HOLDDOWN: 50µ" MIN. NICKEL UNDERPLATING OVERALL. 100µ" MIN. MATTE TIN PLATING WITH 50µ" MIN. NICKEL UNDERPLATE OVERALL.

- PART NO. 3113 - 1 X X X
- Packaging Options
- T: Tray Without Cap
 - C: Tray With Cap
 - N: Tray With Mylar
 - R: Tape & Reel Packaging
 - Without Cap
 - (For 36 & 64P)
 - P: Tape & Reel Packaging With Cap
 - (For 36 & 64P)
 - M: Tape & Reel Packaging With Mylar
 - (For 36 & 64P)
- POS. Options
- 0: 36 Pin
 - 1: 64 Pin
 - 2: 98 Pin
 - 3: 164 Pin
- HSG Color
- 1: Black
 - 0: 30µ" Gold
 - 1: 15µ" Gold
 - 2: 1µ" Gold
- CONTACT PLATING
- PCI EXPRESS Series No.

TITLE:		DONGGUAN UMAXCONN ENTERPRISE LIMITED		UMax 东莞市盈友实业有限公司		TOLERANCE	
PCI EXPRESS SMT TYPE WITH POST		PART NO. 3113-1XXX		DWG NO. 311307001		REV	
REV		SCALE		SHEET		REV	
1 : 1		1 OF 2		B		REV	
MM		UNITS		SCALE		SHEET	
1 : 1		1 OF 2		B		REV	
DATE		NAME		ECN NO.		REV	
Aug.13,2009		Terry		09038		A	
Oct,06,2011		Terry		11059		B	
.XXX±0.10		.XXX±		.XXX±		.XXX±	
.XX±0.20		.XX±		.XX±		.XX±	
.X±0.30		.X±		.X±		.X±	
X±0.40		X±		X±		X±	
LINEAR ANGLES		APPD: Jason		MATERIAL:		PART NO.	
TOL		DRWN: Terry		QTY:		DWG NO.	

CUSTOMER		DATE		NAME		ECN NO.		REV	
8		Aug.13,2009		Terry		09038		A	
7		Oct,06,2011		Terry		11059		B	
6		.XXX±		.XXX±		.XXX±		.XXX±	
5		.XX±		.XX±		.XX±		.XX±	
4		.X±		.X±		.X±		.X±	
3		X±		X±		X±		X±	
2		LINEAR ANGLES		APPD: Jason		MATERIAL:		PART NO.	
1		TOL		DRWN: Terry		QTY:		DWG NO.	

I/O PANEL DIRECTION
 SECONDARY (SOLDER) SIDE
 ADD-IN CARD EDGE-FINGER DIMENSIONS

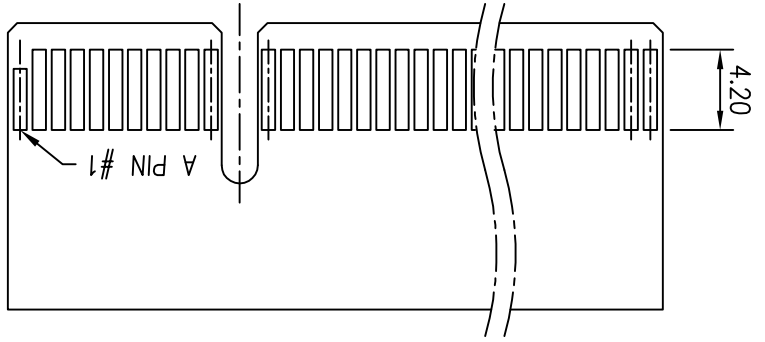

I/O PANEL DIRECTION
 PRIMARY (COMPONENT) SIDE

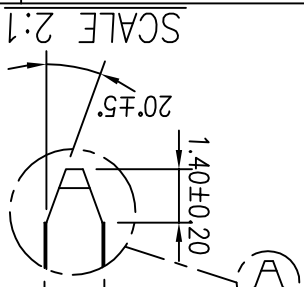
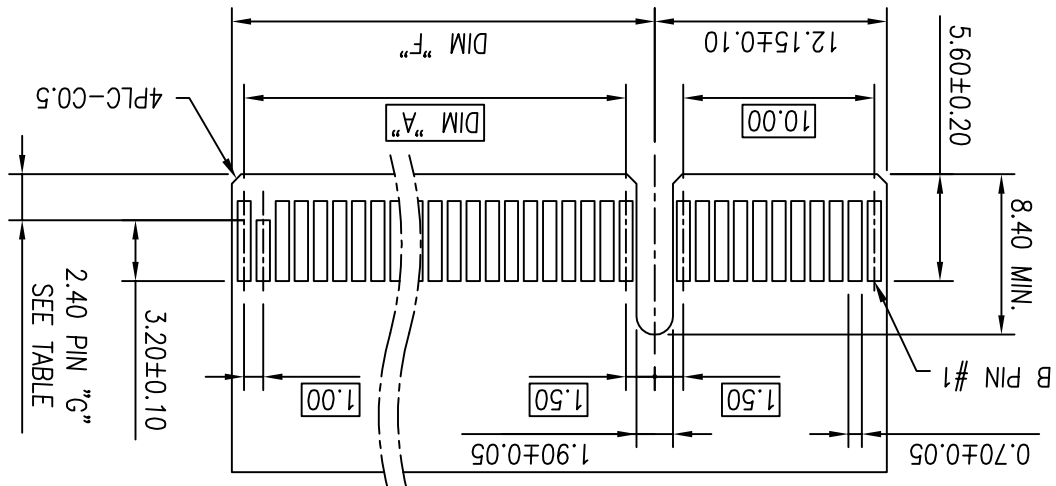

SCALE 2:1

DIMENSIONS		POSITION	
164	70	A ±0.10	F ±0.10
98	37		C ±0.10
64	20		G
36	6		H ±0.10
28.00	8.15		
42.00	22.15		
59.00	39.15		
92.00	72.15		

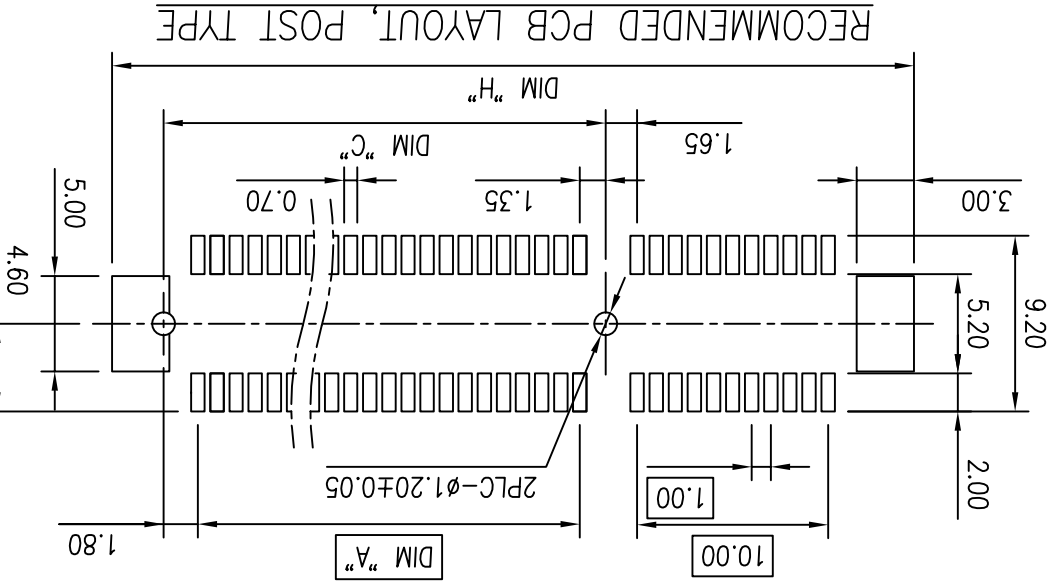

RECOMMENDED PCB LAYOUT, POST TYPE

TOLERANCE		LINEAR		ANGLES		X.±		X.±		X.XX±		X.XX±		DATE		NAME		ECN NO.		REV	
UMax conn		DONGGUAN UMAXCONN ENTERPRISE LIMITED		TITLE:		PART NO.		DWC NO.		APPD:		JASON		MATERIAL:		311307001		3113-1XXX		311307001	
PCI EXPRESS		SMT TYPE WITH POST		UNITS		SCALE		SHEET		REV		SCHUMI		FINISH:		QTY:		MM		1:1	
CUSTOMER		8		7		6		5		4		3		2		1					

X-ON Electronics

Largest Supplier of Electrical and Electronic Components

Click to view similar products for [Standard Card Edge Connectors](#) category:

Click to view products by [UMAX](#) manufacturer:

Other Similar products are found below :

[6565204-6](#) [PKC-156](#) [1437274-4](#) [147889-1](#) [1489165-4](#) [EBT156-12B1X](#) [EBT15622B2X](#) [EBT156-22R2W](#) [1-582587-1](#) [1-582589-1](#) [2-6437275-9](#) [284-0102-12100](#) [306022901000000](#) [307-012-502-202](#) [307-024-526-201](#) [307-056-520-300](#) [307-080-526-208](#) [1926088-2](#) [245-062-520-350](#) [287-0032-12101](#) [306-010-500-112](#) [306-028-525-102](#) [306-240-318](#) [307-036-502-202](#) [307-036-521-301](#) [307-072-526-202](#) [345-060-559-303](#) [368-004-520-201](#) [392-008-559-201](#) [534671-1](#) [5-530501-5](#) [341-240-317](#) [345-029-520-300](#) [345-030-500-301](#) [345-044-500-300](#) [345-220-058](#) [346-240-318](#) [357-030-526-201](#) [387-012-523-300](#) [395-044-520-300](#) [395-100-524-300](#) [50-12B-10](#) [50-6SN-5](#) [09-07-2032](#) [10035388-106LF](#) [10035388-802LF](#) [10115859-011LF](#) [10122859-009LF](#) [101269333204245CLF](#) [10127905-B04B24BLF](#)