

(2,54mm) .100"

HLE SERIES

HLE-116-02-L-DV

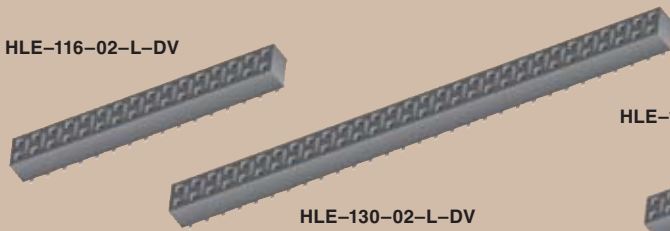

HLE-110-02-L-DV-A

HLE-130-02-L-DV

COST-EFFECTIVE RELIABLE SOCKET

SPECIFICATIONS

For complete specifications and recommended PCB layouts see www.samtec.com?HLE

Insulator Material:

Black Liquid Crystal Polymer

Contact Material:

BeCu

Plating:

Au or Sn over 50µ" (1,27µm) Ni

Current Rating:

2.5A @ 80°C ambient

Voltage Rating:

400 VAC

Operating Temp Range:

-55°C to +125°C

Insertion Depth:

(1,78mm) .070" to (3,43mm) .135", pass-through, or (2,59mm) .102" min for bottom entry

Insertion Force:

(Single contact only) 2oz (0,56N) avg.

Withdrawal Force:

(Single contact only) 1.6oz (0,44N) avg.

RoHS Compliant:

Yes

Processing:

Lead-Free Solderable: Yes

SMT Lead Coplanarity:

(0,10mm) .004" max (02-20)
(0,15mm) .006" max (21-50)



Mates With:
TSW, MTSW, DW,
EW, ZW, TLW, TSM,
MTLW, HW



-L
= 10µ" (0,25µm)
Gold on contact,
Matte Tin on tail

Note: Other Gold plating options available. Contact Samtec.

Leave blank for Surface Mount

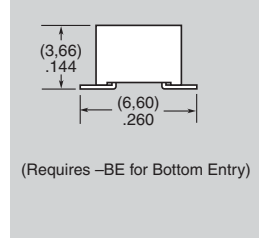

-BE
= Bottom Entry
(N/A with -TE)

-A
= Alignment Pin
(4 positions min.)
Metal or plastic at Samtec discretion
(N/A with -TE, -PE & -LC)

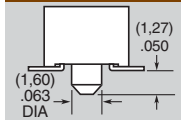

02 thru 50

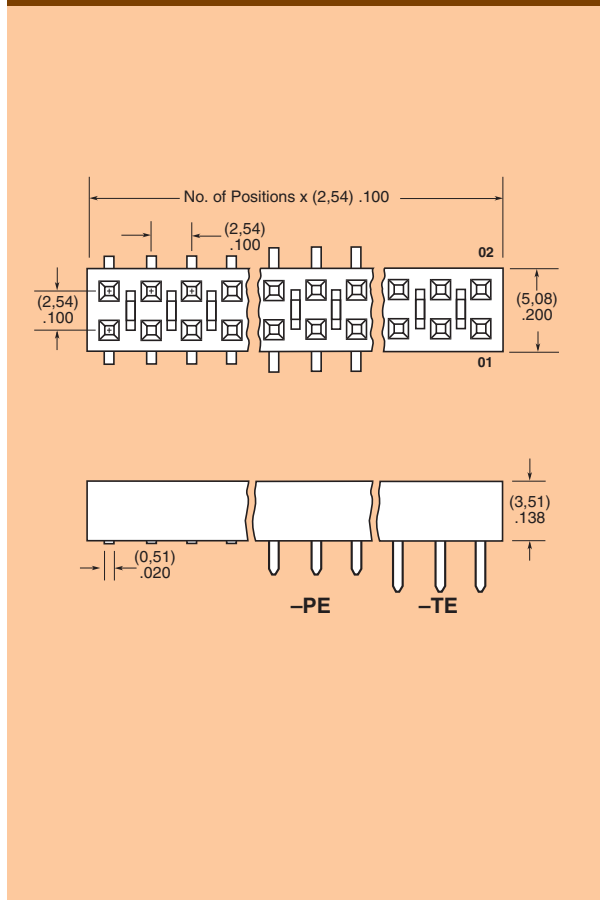

-TE
= Through-Hole Top Entry

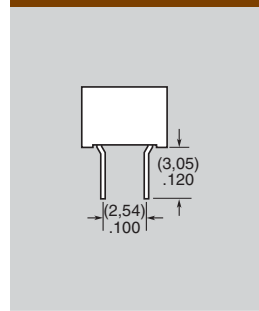

-LC
= Locking Clip
(2 positions min.)
(N/A with -A)
(Manual placement required)

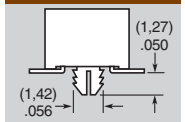

-PE
= Through-hole Pass Through Entry

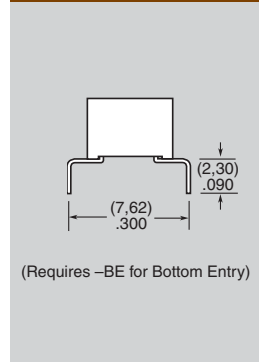

-K
= (6,50mm) .256" DIA Polyimide Film Pick & Place Pad
(3 positions min.)
Not available with -TE or -PE tail option

-P
= Metal Pick & Place Pad
(3 positions min.)

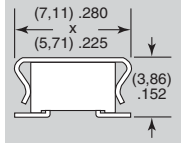

-TR
= Tape & Reel Packaging
(29 positions max.)

Note: Some lengths, styles and options are non-standard, non-returnable.

Due to technical progress, all designs, specifications and components are subject to change without notice.

WWW.SAMTEC.COM

X-ON Electronics

Largest Supplier of Electrical and Electronic Components

Click to view similar products for [Board to Board & Mezzanine Connectors](#) category:

Click to view products by [Samtec](#) manufacturer:

Other Similar products are found below :

[10135583-642402LF](#) [89885-310LF](#) [589158040000018](#) [6-1393048-0](#) [68683-613](#) [MDF7-12DP-2.54DSA](#) [MDF7-18P-2.54DSA\(01\)](#) [MDF7-20DP-2.54DSA](#) [MDF7-26D-2.54DSA\(55\)](#) [MDF7-3P-2.54DSA\(01\)](#) [MDF7B-3P-2.54DSA\(55\)](#) [MDF7C-11P-2.54DSA\(55\)](#) [MDF7C-18P-2.54DSA\(55\)](#) [MDF7C-5P-2.54DSA\(01\)](#) [MDF7P-5P-2.54DSA\(55\)](#) [75234-0516](#) [FCN-230C068-11](#) [FCN-268F012-G/BD](#) [FCN-268F036-G/BD](#) [FCN-268M012-G/0D](#) [FCN-268M024-G/1D](#) [FCN-360C008-C](#) [FCN-360C040-C](#) [FCN-723J004/1](#) [MIS-048-01-F-D-DP-K](#) [832-10-034-10-001000](#) [93696-325LF](#) [11828-1FA](#) [AXK630345P](#) [18097-0013](#) [ICA-328STT](#) [2007042-2](#) [304400-2](#) [FCN-214Q030-G/0](#) [FCN-215Q040-G/0](#) [FCN-230C068-ESA](#) [FCN-234P048-G/0](#) [FCN-235D050-G/C](#) [FCN-360A3](#) [FCN-360C040-B](#) [210-93-314-41-105000](#) [2-22603-0](#) [379-064-521-202](#) [MDF7-12P-2.54DSA\(01\)](#) [MDF7-16P-2.54DS\(56\)](#) [MDF7-40DP-2.54DSA\(55\)](#) [MDF7-8P-2.54DSA\(55\)](#) [MDF7B-16P-2.54DSA\(55\)](#) [AXG720047](#) [5031084030](#)