

## CX2045LNL

- Balun Transformer
- 1:2CT Impedance
- 3-300MHz
- Surface Mount

NOTES: UNLESS OTHERWISE SPECIFIED

1. OPERATING TEMPERATURE: -40°C TO +85°C
2. STORAGE TEMPERATURE: -50°C TO +125°C
3. JEDEC MOISTURE: LEVEL 1.
4. DIMENSIONS ARE IN INCHES WITH THE FOLLOWING TOLERANCE:  
.XX= ±.01  
.XXX= ±.005
5. OPTIONAL TAPE & REEL PACKAGING CAN BE ORDERED  
BY ADDING A "T" SUFFIX TO THE PART NUMBER(EX: CX2045LNLT)
6. ROHS COMPLIANT



## ELECTRICAL SPECIFICATIONS: @ 25°C

### RETURN LOSS:

FREQUENCY	RETURN LOSS (S11)
3 MHz	-23.5 dB MIN
5 MHz	-25 dB MIN
9 MHz	-27 dB MIN
30 MHz	-27 dB MIN
50 MHz	-24.5 dB MIN

FREQUENCY	RETURN LOSS (S11)
90 MHz	-20 dB MIN
150 MHz	-16.5 dB MIN
220 MHz	-13.5 dB MIN
250 MHz	-12 dB MIN
300 MHz	-10.5 dB MIN

### INSERTION LOSS:

FREQUENCY	ATTENUATION (S21)
3 MHz	-0.80 dB MAX
5 MHz	-0.80 dB MAX
9 MHz	-0.80 dB MAX
30 MHz	-0.80 dB MAX
50 MHz	-0.80 dB MAX

FREQUENCY	ATTENUATION (S21)
90 MHz	-0.80 dB MAX
150 MHz	-0.90 dB MAX
220 MHz	-1.00 dB MAX
250 MHz	-1.00 dB MAX
300 MHz	-1.00 dB MAX

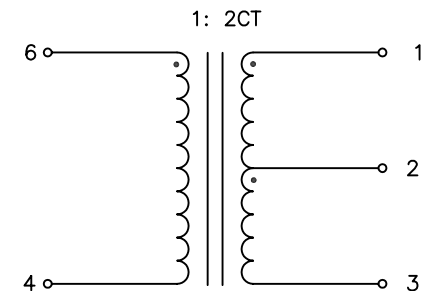

SCHEMATIC

© Copyright, 2014. Pulse Electronics Corp. All rights reserved. Drawing specifications subject to change without notice. (02/14/14)

PULSE CONFIDENTIAL  
&  
PROPRIETARY

PRODUCT SPECIFICATION:  
XFMR, RF, SGL, RAC, 1:2CT, 3-300MHz

DWG. NO./ PART NO.	SHEET:	REV.
CX2045LNL	1	M15

**MECHANICAL SPECIFICATIONS:**

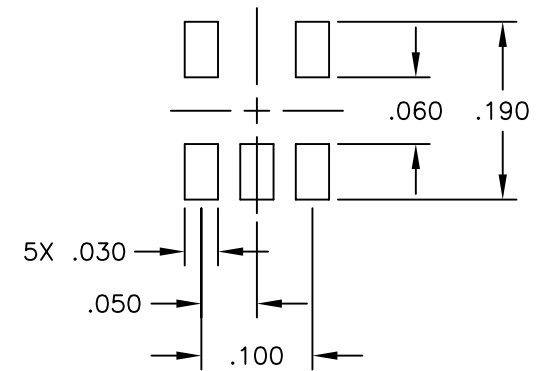
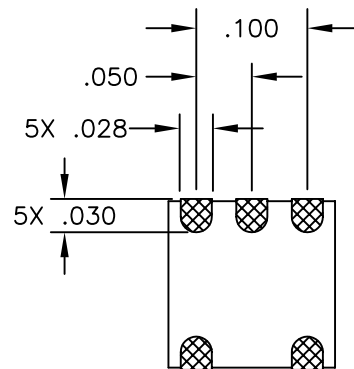
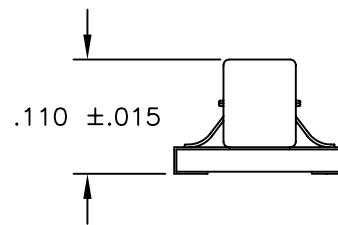
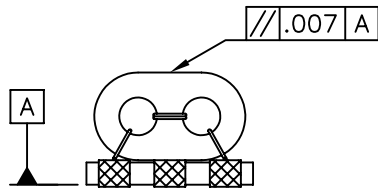
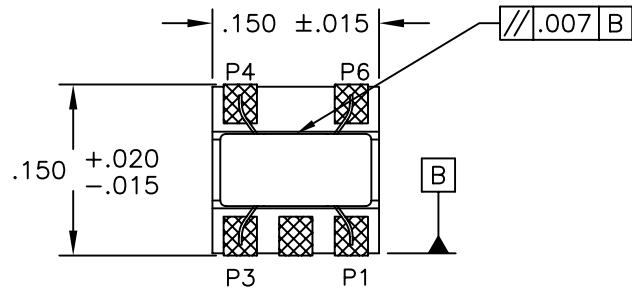

SUGGESTED LAND PATTERN

© Copyright, 2014. Pulse Electronics Corp. All rights reserved. Drawing specifications subject to change without notice. (02/14/14)

PULSE CONFIDENTIAL  
&  
PROPRIETARY

PRODUCT SPECIFICATION:  
XFMR, RF, SGL, RAC, 1:2CT, 3-300MHz

DWG. NO./ PART NO.	SHEET:	REV.
CX2045LNL	2	M15

## X-ON Electronics

Largest Supplier of Electrical and Electronic Components

*Click to view similar products for [Pulse Transformers](#) category:*

*Click to view products by [Pulse Electronics](#) manufacturer:*

Other Similar products are found below :

[IF-18-0269-N](#) [PHT-068](#) [PT5010](#) [PE-65457NLT](#) [T60403-D4721-X088](#) [H1183NLT](#) [CTX33-18971-R](#) [HM2108NLT](#) [PA1825NLT](#)  
[HM0068ANLT](#) [PE-6292](#) [P0584ANL](#) [CX2044LNL](#) [PG1427.001NLT](#) [Q4470-CLB](#) [750313723](#) [TGMR-512V6LF](#) [HM1331NL](#) [TGMR-](#)  
[430V8LF](#) [TGMR-501V6LF](#) [76615/1C](#) [B82804A0304A225](#) [TGM-040P3RL](#) [TGMR-Q440V8LF](#) [TGM-450NFRL](#) [IT 238](#) [HM41-11210LF](#)  
[TGM-210NSRL](#) [TGM-240NSRL](#) [TGM-240NSLF](#) [TGM-030P3RL](#) [CTX16-17360](#) [ITNA-0239-D202](#) [TGM-H280V8LF](#) [TGM-340NARL](#)  
[T60403-D4097-X052](#) [ITRB-0239-D502](#) [TGM-H240V8LF](#) [78601/2JC-R](#) [TGAD-292NARL](#) [HX6096NLT](#) [78601/2MC-R](#) [T60403-D4215-](#)  
[X177](#) [78613/1JC](#) [600PA](#) [H1183NL](#) [TGMR-502V6LF](#) [CTX02-13664](#) [TGMR-380V6LF](#) [T60403-F5046-X008](#)