

NCV Voltage Detector + IR Thermometer

Built-in IR Thermometer
Non-contact Voltage detector that measures non-contact temperature up to 445°F (230°C)

Features:

- Detects AC Voltage from 50 to 1000V
- Built-in InfraRed Thermometer measures temperature from -20 to 445°F (-30 to 230°C) with 0.1° resolution
- LCD displays temperature with selectable °F/°C internal switch
- Fixed 0.95 emissivity covers 90% of surface applications
- 1:1 distance to target ratio
- NCV probe with integrated indicator light
- Tip fits into outlets or against wire insulation
- Low battery indicator
- Auto power off
- Rugged double molded housing
- Complete with pocket clip and three LR44 batteries

BUILT IN IR
Thermometer
Patented



Non-Contact
AC Voltage Detector

Built-in InfraRed
Thermometer

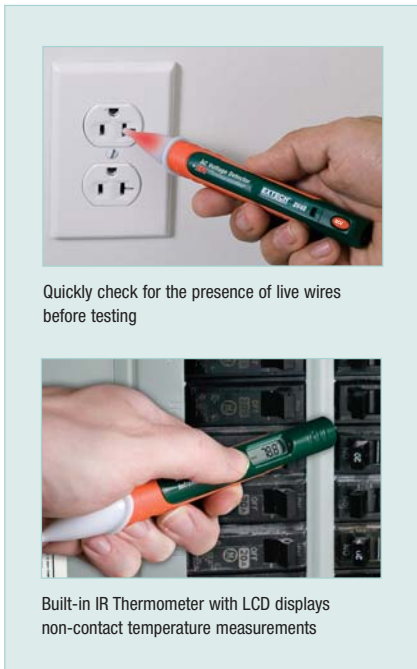

Quickly check for the presence of live wires before testing

Built-in IR Thermometer with LCD displays non-contact temperature measurements

International Patent Pending

Specifications	
Display	9,999 count LCD
IR Temperature Range	-20 to 445°F (-30 to 230°C)
Basic Accuracy	±2% of rdg or ±4°F/2°C whichever is greater
Max. Resolution	0.1°F/°C; 1°F/°C
Emissivity	0.95 fixed
Field of View (Distance to Target)	1:1
NCV Voltage Sensitivity	50 to 1000VAC
Bandwidth	50/60Hz
Detection Range	<1"
Safety Category	CAT III-1000V
Dimensions (Length x Diameter)	6.25 x 1" (159 x 25mm)
Weight	1.48oz (42g)

Ordering Information:

DV40AC Voltage Detector + IR Thermometer



X-ON Electronics

Largest Supplier of Electrical and Electronic Components

Click to view similar products for [Digital Multimeters](#) category:

Click to view products by [Extech](#) manufacturer:

Other Similar products are found below :

[8009](#) [6111-517](#) [FS881](#) [40705X](#) [USB390A](#) [780417A](#) [GPT-9904](#) [382099](#) [589250](#) [780418](#) [C.A 6131](#) [BK2408](#) [BM239R](#) [BM839](#) [FLUKE 107](#)
[FLUKE-179-2/IMSK](#) [NP06-200P1](#) [NP10-200P1](#) [NP10-500P1](#) [P 1020 A](#) [P 1035](#) [P 1075](#) [P 1080](#) [P 8102](#) [P 3365](#) [P 3315](#) [P 3320](#) [P 3335](#) [P](#)
[3340](#) [P 3410](#) [KEWMATE 2000A](#) [MD9016](#) [MTX 3292B-BT](#) [NP06-100P1](#) [NP15-500M1](#) [NP15-600M1](#) [NP15B-500M1](#) [NP15B-600M1](#) [P](#)
[3415](#) [P 3430](#) [P 3690](#) [P 3725](#) [P 4390](#) [SEFRAM7334](#) [SEFRAM7202](#) [SEFRAM7203](#) [SEFRAM7220](#) [SEFRAM7204](#) [SEFRAM7221](#)
[SEFRAM7303](#)