

## Vibration-damping elements



### • Base

- **DVA**: glossy zinc-plated steel.
- **DVA-SST**: AISI 304 stainless steel.

### • Vibration-damping body

Natural rubber NR, hardness 40, 55, 70 tolerance  $\pm 5$  Shore A, black colour.

### • Standard executions

- **DVA.6**: zinc-plated steel threaded stud.
- **DVA.6-SST**: AISI 304 stainless steel threaded stud.
- **DVA.7**: zinc-plated steel boss, threaded blind hole.
- **DVA.7-SST**: AISI 304 stainless steel boss, threaded blind hole.

### Special executions on request

Natural rubber NR, hardness 40, 70 tolerance  $\pm 5$  Shore A for executions with AISI 304 stainless steel base.

### Features and applications

ELESA vibration-damping elements have been designed to damp vibrations, shocks and noises produced by moving bodies or nonbalanced vibrating masses of equipment and machines which can cause:

- malfunctioning and reduction of the machine lifespan and/or of the adjacent ones;
- damage to health;
- noise.

Technical data and guidelines for the choice (see page 2).



DVA.6

DVA.7

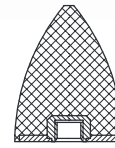
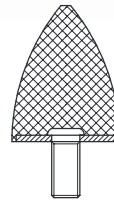

DVA.6  
DVA.6-SST

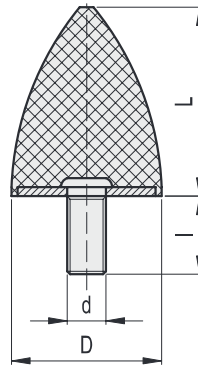

\* Complete the description with the desired hardness: 40, 55 or 70 tolerance  $\pm 5$  Shore A.

DVA.6 - 20 - 24 - M6 - 18 - 55  
D L d I Shore A

Standard Elements	Dimensions					Hardness 40 Shore A			Hardness 55 Shore A			Hardness 70 Shore A		
	D	L	d	I	g	Code	Max load [N]	Max deflection [mm]	Code	Max load [N]	Max deflection [mm]	Code	Max load [N]	Max deflection [mm]
DVA.6-20-24-M6-18-*	20	24	M6	18	10	416101	82	6	413401	130	6	418801	330	6
DVA.6-30-30-M8-18-*	30	30	M8	18	24	416111	190	7.5	413411	260	7.5	418811	630	7.5
DVA.6-30-36-M8-20-*	30	36	M8	20	39	416121	180	9	413421	320	9	418821	650	9
DVA.6-35-40-M8-23-*	35	40	M8	23	45	416131	260	10	413431	300	10	418831	630	10
DVA.6-50-61-M8-28-*	50	61	M8	28	114	416141	490	15.25	413441	600	15.25	418841	1520	15.25
DVA.6-50-68-M10-28-*	50	68	M10	28	131	416151	490	17	413451	890	17	418851	1950	17

DVA.6 - 20 - 24 - SST - M6 - 18 - 55  
D L Stainless steel d I Shore A

Standard Elements	Dimensions					Hardness 40 Shore A			Hardness 55 Shore A			Hardness 70 Shore A		
	D	L	d	I	g	Code	Max load [N]	Max deflection [mm]	Code	Max load [N]	Max deflection [mm]	Code	Max load [N]	Max deflection [mm]
DVA.6-20-24-SST-M6-18-55	20	24	M6	18	10	ON REQUEST	82	6	410501	130	6	ON REQUEST	330	6
DVA.6-30-30-SST-M8-18-55	30	30	M8	18	24		190	7.5	410505	260	7.5		630	7.5
DVA.6-30-36-SST-M8-20-55	30	36	M8	20	39		180	9	410507	320	9		650	9
DVA.6-35-40-SST-M8-23-55	35	40	M8	23	45		260	10	410511	300	10		630	10
DVA.6-50-61-SST-M8-28-55	50	61	M8	28	114		490	15.25	410521	600	15.25		1520	15.25
DVA.6-50-68-SST-M10-28-55	50	68	M10	28	131		490	17	410523	890	17		1950	17

## X-ON Electronics

Largest Supplier of Electrical and Electronic Components

*Click to view similar products for [Mounting Fixings](#) category:*

*Click to view products by [Elesa & Ganter](#) manufacturer:*

Other Similar products are found below :

[5912235-2](#) [007310](#) [007541](#) [6-141-P](#) [620HA038NF09](#) [620HA038NF11](#) [CTJ420E028-513](#) [M81714/60-12-01](#) [M81714/60-22-01](#) [L/C](#)  
[MA1EAF1200](#) [70-584649-01P](#) [71-074914-006](#) [71-215091-8S](#) [712HA170B23128-N](#) [71-344699-4S](#) [71-441549-19S](#) [71-441864-5S](#) [71-](#)  
[490451-4H](#) [EX-13-3-B-16-325PN](#) [75-69116-8S](#) [75-69211-3P](#) [75-69220-27S](#) [75-69224-5S](#) [75-69614-2S](#) [770-006A109](#) [770-006A109R](#) [770-](#)  
[006A207](#) [770-006A208W1](#) [770-006A209](#) [770-006A306](#) [770-006A703W1](#) [770-006A704](#) [770-006A704W1](#) [770-006A705](#) [770-006A706](#)  
[770-006A706W1](#) [770-006A707](#) [770-006A709](#) [770-007A203](#) [770-007A203W1](#) [770-007A204W1](#) [770-007A207W1](#) [770-007A703](#) [770-](#)  
[007A704W1](#) [770-007A706](#) [770-007A707W1](#) [770-010Y208](#) [770-010Y308](#) [770-010Y705](#) [770-010Y706](#)