

PIASTRA RIDOTTA PER INTERRUTTORI AUTOMATICI B.T.

TIGHT PLATE FOR LOW VOLTAGE MOLDED CASE CIRCUIT-BREAKERS

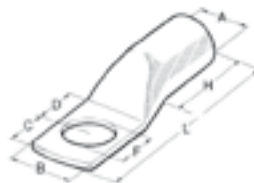

Articolo Type	Sezione mm ² Section mm ²	Per Vite For screw Ø mm	F	A	B	C	D	H	L	Utensile art. Tool	N. esagono matrice Indent	Conf. pezzi Packing pcs.
BM 017313	35	6	6,5	8,5	15	7	8	16	39		11	25
BM 018313	50	6	6,5	10	15	7	8	18	41	510	12	25
BM 018433		10	10,5	10	18,5	9,5	13,5	18	51		12	25
BM 019313	70	6	6,5	12	17	6,5	9,5	20	46		14	25
BM 019433		10	10,5	12	19	10	13	21	52	523	14	25
BM 031373	95	8	8,5	13,8	19	8	12	24	54	512	16	25
BM 031433		10	10,5	13,8	19	10	13	22	58	582	16	25
BM 032373	120	8	8,5	15,5	19	9	12	22	61	182	18	25
BM 032433		10	10,5	15,5	19	9	12	22	61	183	18	25
BM 033373	150	8	8,4	17	19	9	17	30	70	184	20	25
BM 033433		10	10,5	17	19	9	17	30	70	186	20	25
BM 034493	185	12	13	19	31	14	17	32	82	260	22	25
BM 035493	240	12	13	21,5	31,5	14	17	39	90	270	25	25

I capicorda a piastra ridotta sono disponibili anche in versione preisolata-Nylon di colore nero
Per la versione preisolata, sostituire la prima cifra "0" con il numero 9 al codice articolo

Terminals copper tinned tight plate are available also with nylon insulated execution
For order please you change first number "0" with number "9"

Es. di ordinazione
 Versione non isolata
 Versione preisolata

Example:
 uninsulated terminals
 Nylon insulated

CAPPUCCI ISOLANTI PER TERMINALI NON ISOLATI - SOFT SLEEVES



Materiale: PVC
 Autoestinguenza: UL 94 - V0
 Temperatura d'esercizio: T 85°C

Material: PVC
 Self extinguishing: UL 94 - V0
 Exercise temperature: T 85°C

Articolo Type	Sezione mm ² Section mm ²	A	B	L	Conf. pezzi Packing pcs.
BM 81001	1,5	3,8	3,5	15	100
BM 81002	2,5	5	4	16,7	100
BM 81006	6	7	5,2	20,6	100
BM 81010	10	6,8	6,3	21	100
BM 81016	16	8	7	28	100
BM 81025	25	8	7,6	28	100
BM 81035	35	10,3	9,2	29	100
BM 81050	50	12	10,3	34	100
BM 81070	70	14	13,5	42	100
BM 81095	95	17	16	46	50
BM 81120	120	20	18	55	50
BM 81150	150	22	20	60	50
BM 81185	185	24	22	65	50
BM 81240	240	30	24	69	50
BM 81300	300	32	27	75	25
BM 81400	400	34	30	75	25

X-ON Electronics

Largest Supplier of Electrical and Electronic Components

Click to view similar products for [Terminals](#) category:

Click to view products by [BM Group](#) manufacturer:

Other Similar products are found below :

[HT-13-10](#) [71M-250-32-NB](#) [01-2065-1-0216](#) [00581P0075](#) [M10-10RX](#) [M10BCK](#) [60205-1](#) [604200-1](#) [60598-1-CUT-TAPE](#) [60617-1-C](#) [60873-1](#) [M14-516R/SK](#) [M14-6RSX](#) [M18-10FLX](#) [M18-8FBX](#) [M18-8R/LX](#) [M18BCK](#) [61314-6-C](#) [61-S](#) [61-SN-A](#) [62-NBM-A](#) [63-S](#) [640179-1](#) [640917-2-CUT-TAPE](#) [6501550002](#) [66107-2-C](#) [66107-4-C](#) [696683-1](#) [696834-1](#) [696861-1](#) [696931-1](#) [696999-1](#) [M8-516RK](#) [M86700006](#) [MA250DMFMX-A](#) [701-2007](#) [701-2307](#) [701-7761-03](#) [70F-110-32-PB](#) [718-N-A](#) [71M-187-20-NBL](#) [71M-250-32-NBL](#) [72F-187-20-NBL](#) [72M-250-32-NBL](#) [7310](#) [73F-250-32](#) [73F-250-32-NBL](#) [73F-250-32-NL](#) [F14-10C](#) [F-1M](#)