

REV.	MODIFICATION.	DATE	DRN
01	NEW DRAWING	18/10/04	NJB
02	ECN2005-057	27/04/05	OW
03	ECN2005-069	26/05/05	OW
04	ECN06-227	03/10/06	NJB

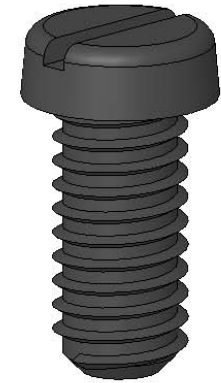
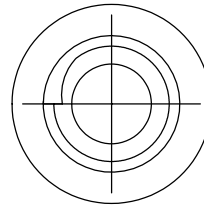
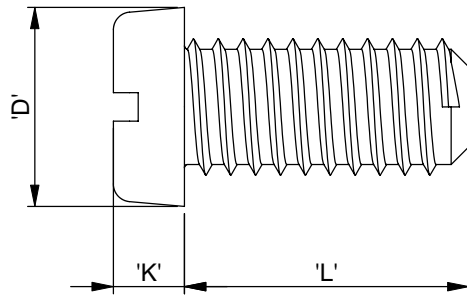

**NOTES:**

- 1a) Metric primary units: mm.
- b) Imperial secondary units: [Inches].

NSE-1580-M6-L	5.0 (.197)	6.0 (.236)	8.0 (.315)	10.0 (.394)	12.0 (.473)	16.0 (.630)	20.0 (.788)	25.0 (.985)	30.0 (1.182)	40.0 (1.575)	50.0 (1.969)	12.0 [.473]	3.6 [.141]
NSE-1580-M5-L	6.0 (.236)	8.0 (.315)	10.0 (.394)	12.0 (.473)	16.0 (.630)	20.0 (.788)	25.0 (.985)	30.0 (1.182)	40.0 (1.575)			9.5 [.374]	3.0 [.118]
NSE-1580-M4-L	6.0 (.236)	8.0 (.315)	10.0 (.394)	12.0 (.473)	16.0 (.630)	20.0 (.788)	25.0 (.985)	30.0 (1.182)	40.0 (1.575)			8.0 [.315]	2.4 [.094]
NSE-1580-M3-L	4.0 (.158)	5.0 (.197)	6.0 (.236)	8.0 (.315)	10.0 (.394)	12.0 (.473)	16.0 (.630)	20.0 (.788)	25.0 (.985)	30.0 (1.182)		5.6 [.220]	1.8 [.070]
NSE-1580-M2.5-L	6.0 (.236)	8.0 (.315)	10.0 (.394)	12.0 (.473)	15.0 (.591)	20.0 (.788)	25.0 (.985)					5.0 [.197]	1.5 [.059]
NSE-1580-M2-L	4.0 (.158)	5.0 (.197)	6.0 (.236)	8.0 (.315)	10.0 (.394)	12.0 (.473)	16.0 (.630)	20.0 (.788)	25.0 (.985)			4.0 [.158]	1.3 [.051]
PART REF:	L											D	K

INFORMATION CONTAINED IN THIS DOCUMENT IS CONFIDENTIAL TO RICHCO INTERNATIONAL Co. Ltd. AND MAY NOT BE DISCLOSED OR REPRODUCED IN WHOLE OR PART WITHOUT THEIR WRITTEN CONSENT



GENERAL TOLERANCES  $\pm 0.25$  [0.010]  
ARE FOR REFERENCE UNLESS OTHERWISE  
1 DECIMAL PLACE  $\pm$   
2 DECIMAL PLACES  $\pm$   
ANGULAR  $\pm 1^\circ$

MATERIAL: <b>NYLON 6/6 (RMS-179)</b>		COLOUR: <b>NATURAL</b>	
TITLE: <b>METRIC SCREW (DIN EN ISO 1580)</b>		PART No: <b>NSE-1580-MX-L</b>	
DRG No: <b>04-115</b>	NPR REF:		SIZE <b>A4</b>
DRN <b>NJB</b>	DATE <b>18/10/04</b>	CHKD <b>I.C</b>	DATE <b>18/10/04</b>
SCALE <b>NTS</b>		SHEET No <b>1 OF 1</b>	

## X-ON Electronics

Largest Supplier of Electrical and Electronic Components

*Click to view similar products for [Screws & Fasteners](#) category:*

*Click to view products by [Richco](#) manufacturer:*

Other Similar products are found below :

[5721-1440-1/4-SS](#) [593503FX](#) [0098.0094](#) [0098.9206](#) [0098.9219](#) [0098.9221](#) [0098.9262](#) [596-2114-013](#) [59781-4](#) [59781-6](#) [0098.0026](#)  
[0098.9210](#) [0098.9212](#) [60227-01](#) [60227-04](#) [60227-08](#) [60228-09](#) [618-00001](#) [62153-03](#) [62153-11](#) [M316-KSSTMCZ100](#) [M3440-SS](#) [M3442-SS](#) [M3448-SS](#) [6291A](#) [6292-1](#) [6-306105-9](#) [6-306131-4](#) [690432-1](#) [699161-000](#) [700989](#) [7-18023-1](#) [7-21002-8](#) [7230-3](#) [7235-3](#) [7248-1](#) [7248-2](#)  
[73542-02](#) [CAPTIVE SHORT THUMBSCREW](#) [745564-1](#) [748174-2](#) [F03-02](#) [SUS316](#) [F1209](#) [751-00001](#) [80011](#) [809704-1](#) [8700](#) [8860220](#)  
[9047](#) [95000002B](#) [9885-2](#)