

USER MANUAL

Model: TM06E



I. Main Technical Parameters:

- Working temperature: -20-60°C
- Power supply voltage: DC 12~24V
- Output: 1 channel
- Connect way: common anode
- Output current: < 8A
- Output power: 12V:< 96W, 24V:< 192W
- Static power consumption: <1W
- Net weight: 127g
- Gross weight: 177g
- External dimension: L80XW80XH41.8 mm
- Packing size: L105XW105XH53mm

II. Interface instruction

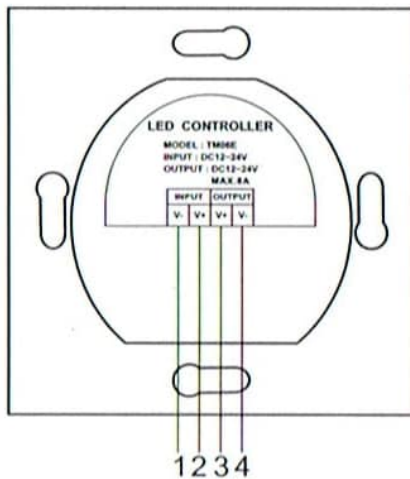

INPUT: 1 and 2 are power input pins, input voltage range is 12-24V; 1 is negative and 2 is positive.

OUTPUT: 3 and 4 are power output pins, output voltage is 12-24V, output maximum current is 8A; 3 is positive and 4 is negative.

①

III. operating instructions





 : Touch the color wheel, whether in a static or dynamic mode will switch to touch the ring on the corresponding static brightness.

 : Under any state, can open or close controller output; when controller in open state, long press this key more than 3s, can open or close the buzzer output.

 : Static state brightness add, 235 levels, dynamic state speed add, 100 levels.

 : Static state brightness minus, 235 levels, dynamic state speed minus, 100 levels.

 : Mode minus.

 : Mode add.

Mode list as follows:

Number	Mode	Number	Mode
1	Flash	5	Stroboflash
2	Sniff mode	6	One-third strobe
3	Gradually fade up/down	7	Two-thirds strobe
4	Gradually fade in/out	8	Police strobe

IV. Typical Application

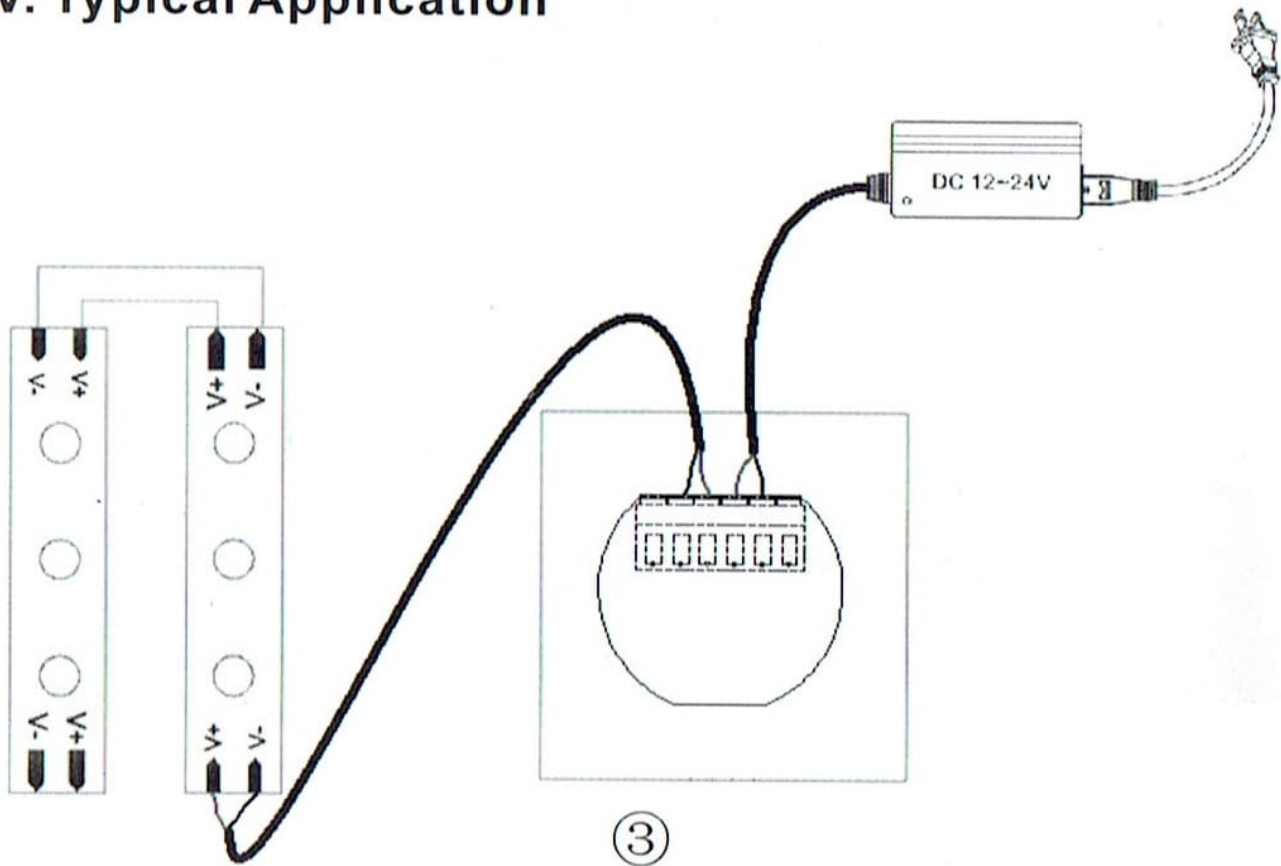

V. Installation Method

1. Wiring

In the Typical Application. Reference typical application circuit.
take the panel.

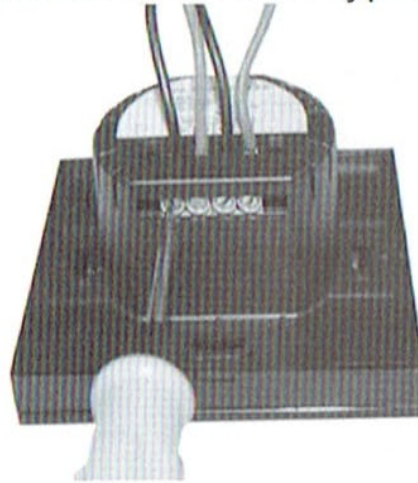

2. Open the touch panel

as shown in figure, use screwdriver in touch panel gently pry gaps,

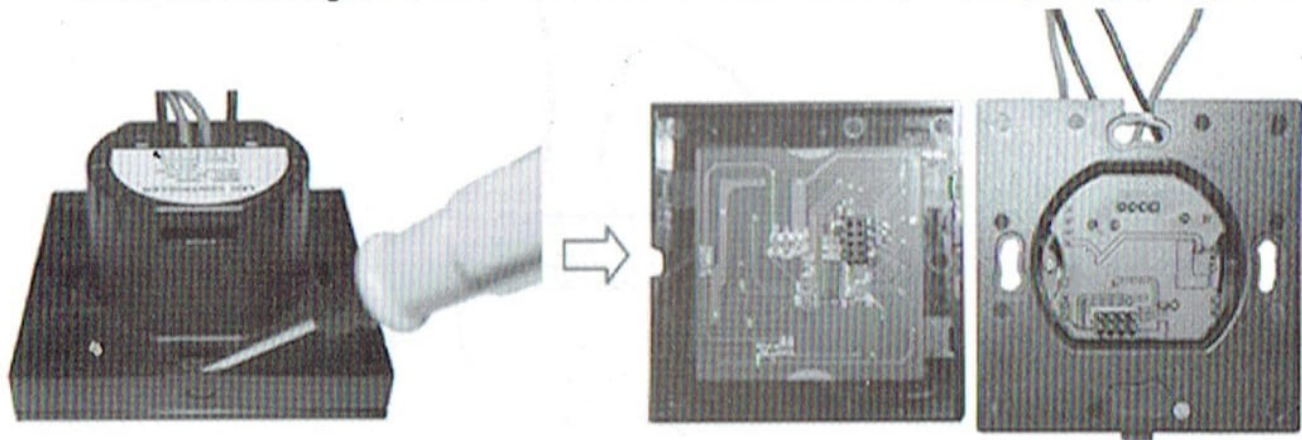

3. Installation switch base

As shown in figure, connected line will touch installed on the wall in the cassette controller, screw in screw, make fixed in the wall, will be installed base to the wall.

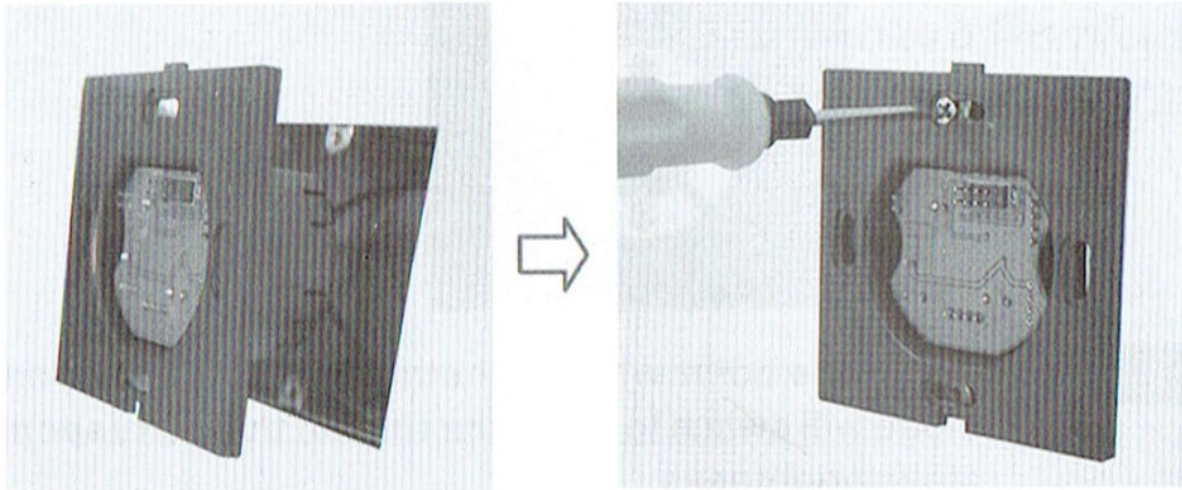

4. Cover touch panel

Look the panel direction, then cover panel, as shown in the figure.

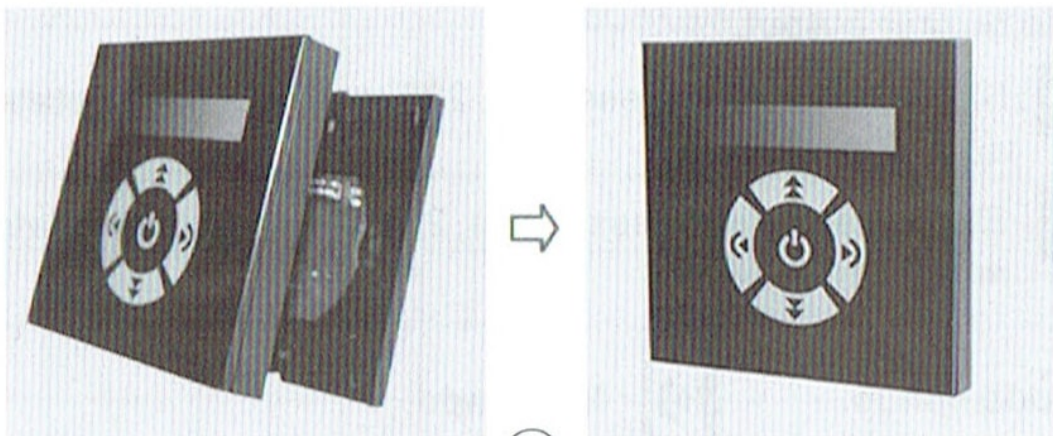

⑤

VI. Remark

1. Connect the load wire at first, following by the power wire; **Please ensure short circuit can not occur between connecting wire before you turn on the power.**

2. Power supply voltage range is DC12~24V, more than voltage range maybe will burnout the controller.

X-ON Electronics

Largest Supplier of Electrical and Electronic Components

Click to view similar products for [LED Displays & Accessories](#) category:

Click to view products by [Optoflash](#) manufacturer:

Other Similar products are found below :

[LTC-2721WC](#) [LTC-4624JD](#) [LTC-4627G](#) [LTC-4627WC](#) [LTD-5021AWC](#) [LTM-8522G](#) [LTP-4323P](#) [LTP-747G](#) [LTS-3361JG-06](#)
[F416SYGWA/S530-E3](#) [EADST040RA2](#) [1668](#) [HT-F196NB-5323](#) [IPD2131-27](#) [SA03-12EWA](#) [LDD-E2802RD](#) [LDD-E306MI](#) [LDQ-N514RI](#)
[LDS-A3506RD](#) [LDS-A3926RI](#) [LDT-M516RI](#) [SC03-12HDB](#) [SI-B9T151550WW](#) [SI-B9V171550WW](#) [SLC-3PF-WL](#) [1624](#) [LTC-2621JD](#)
[LTC-2623WC](#) [LTC-4624P](#) [LTC-4627JD](#) [LTD-2601E](#) [LTD-322G](#) [LTD-482PC](#) [LTP-1457AKR](#) [LTP-3784G-01](#) [LTS-313AP](#) [LTS-4812SKR-](#)
[P](#) [LTS-547AE](#) [LTS-6780P](#) [446010401-3](#) [HV-7W30-6829](#) [CA12240_MINNIE-WWW-MTG-ASSY](#) [DA43-11GWA](#) [LDD-A516RI-17](#) [LDD-](#)
[E305RI](#) [LDQ-M513RI](#) [LDQ-M5204RI-SI](#) [LDQ-N3402RI](#) [LDQ-N3606RI](#) [LDS-A3924RI-SI](#)