

USER MANUAL

Model: TM08E2

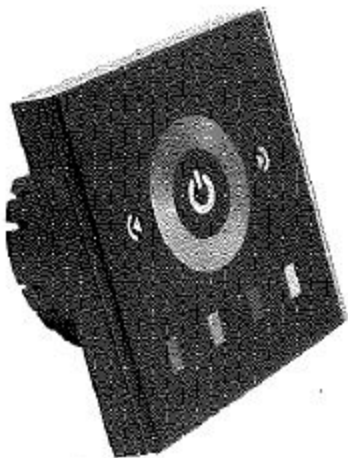

I. Main technical parameters

- Working temperature: $-20\sim 60^{\circ}\text{C}$
- Power supply voltage: DC 12~24V
- Output: 3 channel
- Connect way: common anode
- Output current: $< 4\text{A}$ (each channel)
- Output power: 12V: $< 144\text{W}$, 24V: $< 288\text{W}$
- Static power consumption: $< 1\text{W}$
- Net weight: 127g
- Gross weight: 177g
- External dimension: L80XW80XH41.8 mm
- Packing size: L105XW105XH53mm

II. Interface instruction

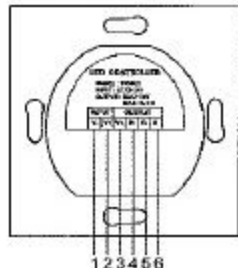

INPUT: power input pin, the range of input voltage is 12-24V, "1" is cathode, "2" is anode.

OUTPUT: power output pin, output voltage is 12-24V, output maximum current is 4A, "3" is anode, "4" is red light interface, "5" is green light interface, "6" is blue light interface.

III. operating instructions

1. Button function instruction



: Touch the color wheel, whether in a static or dynamic mode will switch to touch the ring on the corresponding static color.



: Under any state, can open or close controller output; when controller is in open state, long press this key more than 3s, can open or close the buzzer output.



: Respectively, static white, static red, static green, static blue this 4 keys, when you press corresponding color, it will bright press the corresponding color again, it will off, by combining can quickly collocation red, green, blue, yellow, purple, cyan white seven colors.



: Static state brightness minus, 25 levels.



: Static state brightness add, 25 levels.

iv. Typical Application

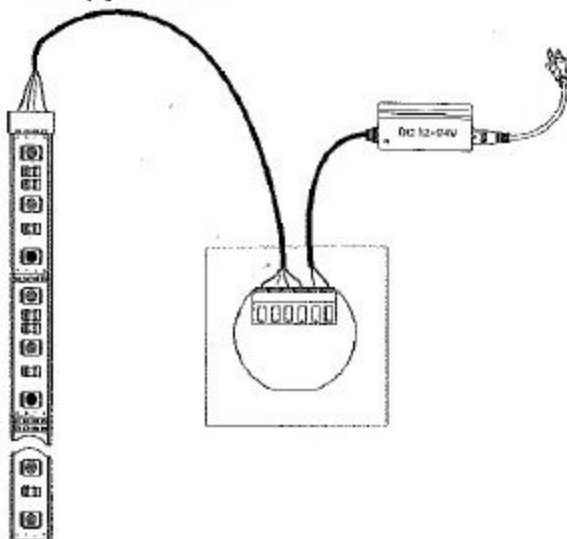

V. Installation Method

1. Wiring

In the Typical Application. Reference typical application circuit.

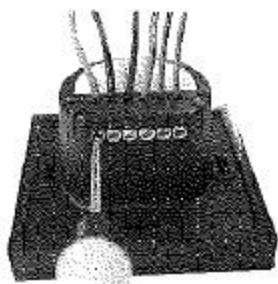

2. Open the touch panel

As shown in figure, use screwdriver in touch panel gently pry gaps, take the panel.

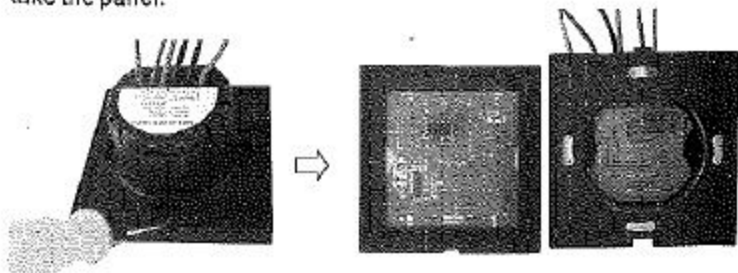

④

3. Installation switch base

As shown in figure, connected line will touch installed on the wall in the cassette controller, screw in screw, make fixed in the wall, will be installed base to the wall.

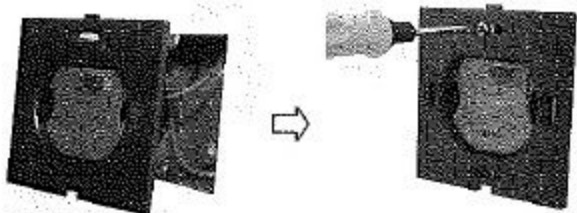

4. Cover touch panel

Look the panel direction, then cover panel, as shown in the figure.

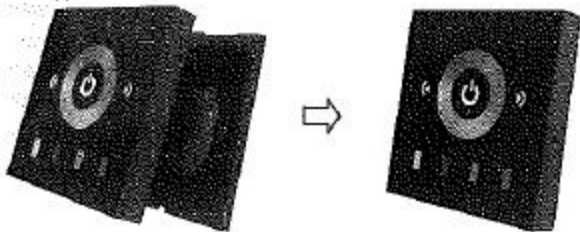

⑤

VI. Remark

1. Connect the load wire at first, following by the power wire; **Please ensure short circuit can not occur between connecting wire before you turn on the power.**

2. Power supply voltage range is DC12~24V, more than voltage range maybe will burnout the controller.

X-ON Electronics

Largest Supplier of Electrical and Electronic Components

Click to view similar products for [LED Displays & Accessories](#) category:

Click to view products by [Optoflash](#) manufacturer:

Other Similar products are found below :

[LTC-2721WC](#) [LTC-4624JD](#) [LTC-4627G](#) [LTC-4627WC](#) [LTD-5021AWC](#) [LTM-8522G](#) [LTP-4323P](#) [LTP-747G](#) [LTS-3361JG-06](#)
[F416SYGWA/S530-E3](#) [EADST040RA2](#) [1668](#) [HT-F196NB-5323](#) [IPD2131-27](#) [SA03-12EWA](#) [LDD-E2802RD](#) [LDD-E306MI](#) [LDQ-N514RI](#)
[LDS-A3506RD](#) [LDS-A3926RI](#) [LDT-M516RI](#) [SC03-12HDB](#) [SI-B9T151550WW](#) [SI-B9V171550WW](#) [SLC-3PF-WL](#) [1624](#) [LTC-2621JD](#)
[LTC-2623WC](#) [LTC-4624P](#) [LTC-4627JD](#) [LTD-2601E](#) [LTD-322G](#) [LTD-482PC](#) [LTP-1457AKR](#) [LTP-3784G-01](#) [LTS-313AP](#) [LTS-4812SKR-](#)
[P](#) [LTS-547AE](#) [LTS-6780P](#) [446010401-3](#) [HV-7W30-6829](#) [CA12240_MINNIE-WWW-MTG-ASSY](#) [DA43-11GWA](#) [LDD-A516RI-17](#) [LDD-](#)
[E305RI](#) [LDQ-M513RI](#) [LDQ-M5204RI-SI](#) [LDQ-N3402RI](#) [LDQ-N3606RI](#) [LDS-A3924RI-SI](#)