

THIS COPY IS PROVIDED ON A RESTRICTED BASIS AND IS NOT TO BE USED IN ANY WAY DETRIMENTAL TO THE INTERESTS OF PANDUIT CORP.

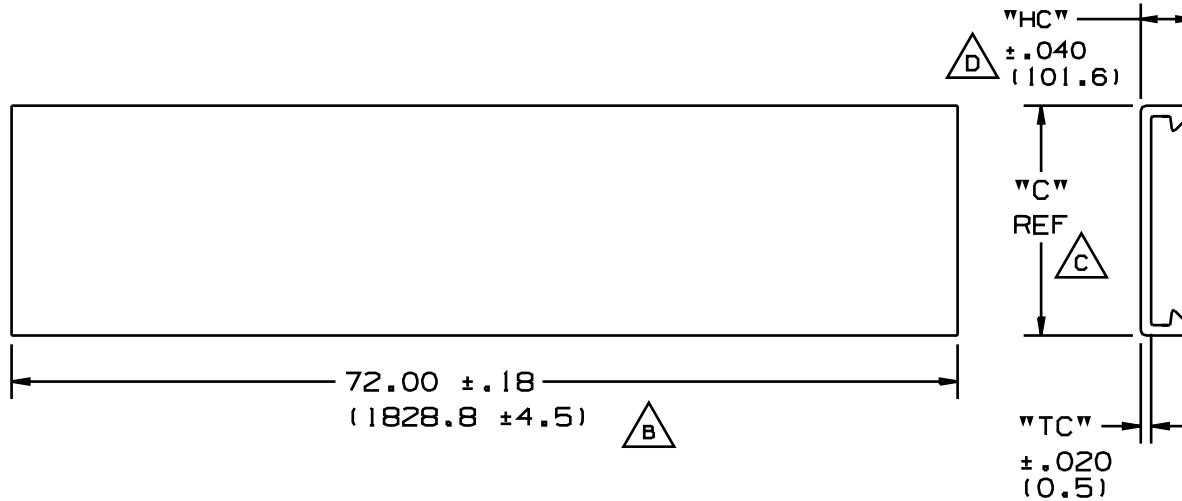

NOMINAL DUCT SIZE (W)	C in (mm)	TC in (mm)	HC in (mm)
.5	.69 (17.5)	.040 (1.0)	.230 (5.8)
.75	.94 (23.8)	.050 (1.3)	.240 (6.1)
1	1.25 (31.8)	.060 (1.5)	.350 (8.9)
1.5	1.75 (44.5)	"	"
2	2.25 (57.2)	"	"
2.5	2.75 (69.9)	"	"
3	3.25 (82.6)	.065 (1.6)	.370 (9.4)
4	4.25 (108.0)	"	"
6	6.25 (158.8)	.080 (2.0)	"

- SEE CURRENT CATALOG FOR ADDITIONAL PART NUMBER SUFFIXES TO INDICATE COLOR AND OR PACKAGE QUANTITY.
- DIMENSIONS IN PARENTHESIS ARE METRIC.

PART NO. SYSTEM  
COVER EXAMPLE  
TYPE C L5 LG 6  
WIDTH  
COLOR  
LENGTH (ft)

REV	DATE	BY	CHK	DESCRIPTION	ECN	R	CUST	SUP
2	8-24-01	JCST	JKG	D. CHANGED TOLERANCE C. MADE "C" A REFERENCE DIMENSION	34518-17	JKG	JKG	
1	2/11/00	JHNU	HIW	B. .18 WAS .125/ 4.5 WAS 3.2 A. REV'D TITLE; ADDED FS AND G DUCT TYPE	34518-17	HIW	HIW	
R	10-29-93	DW	CEF	RELEASED TO PRODUCTION.	34518-17	CEF		

CAD FILENAME/LAYERS D34518BA_PVC_COVER_02A	
PANDUIT CORP. TINLEY PARK, ILLINOIS	
WIRING DUCT COVER FOR DUCT TYPES "S", "D", "E", "F", "FS", AND "G" CUSTOMER DRAWING	
UNLESS OTHERWISE SPECIFIED, DIMENSIONAL TOLERANCES ARE: (.X) : (.XXX) : (.XX) : ANGLES :	UNLESS OTHERWISE SPECIFIED, ALL DIMENSIONS ARE GIVEN IN INCHES, THIRD ANGLE PROJECTION.
DRAWN BY DW	MAT'L: POLYVINYL CHLORIDE
DATE 10-29-93	SCALE NONE
CHK'D CEF	DWG NO. 34518-17 SIZE A

## X-ON Electronics

Largest Supplier of Electrical and Electronic Components

*Click to view similar products for [Wire Ducting](#) category:*

*Click to view products by [Panduit](#) manufacturer:*

Other Similar products are found below :

[66200A-10](#) [CVED32VEPG](#) [CVED40VEPG](#) [F512D5-5F140Y](#) [F512D5-5F200Y](#) [F512D5-5F26Y](#) [F512D5-5F30Y](#) [F512D5-5F33Y](#) [F512D5-5F34Y](#) [F512D5-5F45Y](#) [F512D5-5F50Y](#) [F512D5-5F54Y](#) [F512D5-5F66Y](#) [F512D5-5F70Y](#) [F512D5-5F75Y](#) [F512D5-5F90Y](#) [F612D5-5F100Y](#) [F612D5-5F130Y](#) [F612D5-5F50Y](#) [F612D5-5F56Y](#) [F612D5-5F58Y](#) [F6L12D5-5F46](#) [F912D5-5F11Y](#) [F912D5-5F170Y](#) [F912D5-5F175Y](#) [F912D5-5F230Y](#) [F912D5-5F300Y](#) [F912D5-5F55Y](#) [F912D5-5F56Y](#) [F912D5-5F63Y](#) [F912D5-5F6Y](#) [F912D5-5F75Y](#) [F912D5-5F85Y](#) [F912D5-5F86Y](#) [F912D5-5F88Y](#) [F912D5-5F96Y](#) [FAP0047WBLMTP](#) [FAP12WBRDRDDLZ](#) [FAP12WDYLYLDLZ](#) [FAP12WEORORDLZ](#) [FAP6WEORORDLZ](#) [FAP6WFDBDBDLZ](#) [FAP8WEORORDLZ](#) [FCE2UWCL](#) [800A-LB](#) [802A-ECSP](#) [802I-ICSP](#) [FJQADH](#) [FJQFXT](#) [PED10](#)