

ARTHERMO



General Catalogue

2013/2

Temperature under control

The Company

Arthermo has been making Measurement Instruments internationally for over 40 years. All of our products are manufactured with customary Italian style and quality.

We therefore have a wealth of experience and know-how which allows us to better tailor our products to the manufacturer's own specific needs. Service and Quality are the backbone of all our business relationships, which we are proud to have established over the decades.

Arthermo products cover many fields of application including the following:

- Refrigeration
- Washing
- Cooking
- Heating
- Floor heating

Arthermo production boasts high and consistent quality standards, thanks to advanced automation processes.



TEAMWORKING

The PEOPLE and the TEAM. The team Arthermo works together and everyone contributes to the company goals' achievement. The functions' rotation guarantees the total tasks covering also in the emerging events. The training is continuous to follow the last technical and commercial news. Our stakeholders are considered PEOPLE, like us. Thanks to this approach we are able to comprehend the real expectations at 100%. The brainstorming is considered a fundamental element of personal and professional growth.

SUPPLY CHAIN

The best customer service is obtained by searching reliable partners. Arthermo takes care about the changing market phases thanks to its global vision. Our loyalty, trust and honesty values are shared by the partnership defined which made Arthermo a real international company. The market is the king, the main actor to get vital informations.



ENGINEERING AND PRODUCTION

The customers' needs are the starting point of our solutions. We take care about the products' aesthetic and duration characteristics and we look for the best raw materials to guarantee the highest quality level.

TOTAL QUALITY: a MUST in the design and production processes. The brand Arthermo means total control and testing: every product is checked at 100% to offer the maximum quality level. Our analogical range has a low impact on the environment: low consumption and long duration. Every new component is easily recyclable and with a low environmental impact.

ARTHERMO IN THE WORLD

The partnership in the Arthermo history created a global distribution network to guarantee the capillary presence in the market. Thanks to this global network, Arthermo is a real international company which cares about the different cultures to satisfy the competitive arena's needs and expectations.

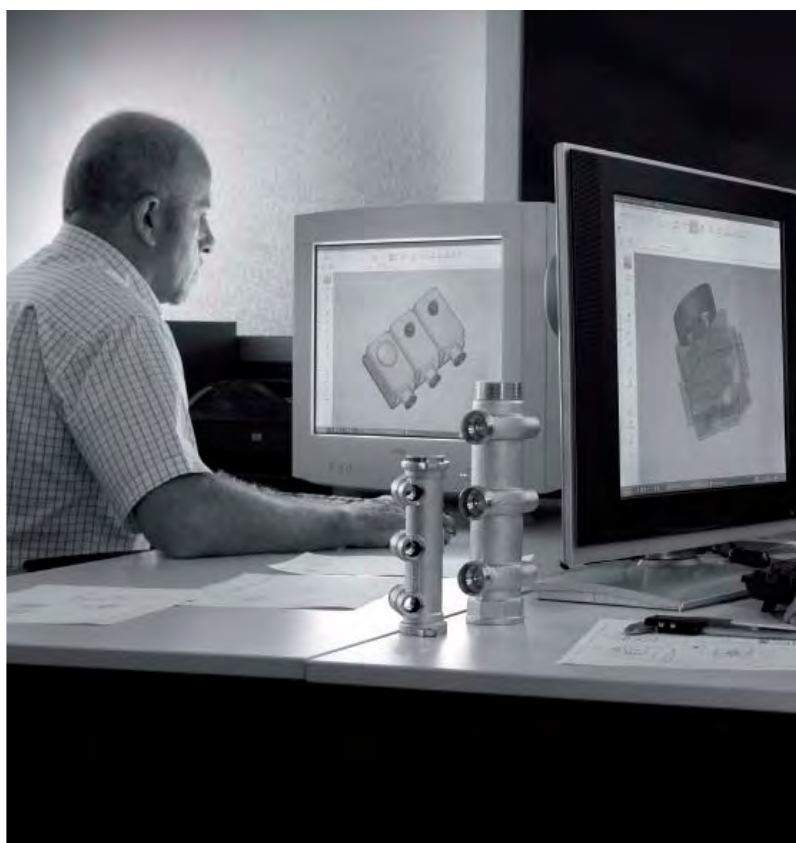

Index

| | | |
|-------------------------|-----------|----|
| Capillary Thermometers | Section 1 | 4 |
| Oven Range | Section 2 | 8 |
| Bimetallic Thermometers | Section 3 | 13 |
| Thermostats | Section 4 | 21 |
| Digital Instruments | Section 5 | 26 |
| Heating and Sanitary | Section 6 | 30 |



ARTHERMO



Capillary
Thermometers

Section 1

Capillary Thermometers

APPLICATIONS:

Boilers, refrigerators, restaurants service equipment and electrical appliances.

CHARACTERISTICS:

ABS or metal case, fixing with brackets or clips, standard capillary length: 1500 MM, thermometric movement with liquid expansion.



CP 05

Case diameter 52 mm

| MODEL | CODE | TEMPERATURE RANGE | BOX | BOX DIMENSIONS (mm) | WEIGHT (kg) |
|----------------------|--------------|-------------------|-----|---------------------|-------------|
| CPF 05* ¹ | 270133340402 | -40/+40° C | 100 | 480x290x230 | 6 |
| CP 05* | 350133319602 | 0/120° C | 100 | 480x290x230 | 6 |
| CP 05 C | 350135660202 | 50/350° C | 250 | 660x400x250 | 12,5 |



CP 03

Case diameter 52 mm

| MODEL | CODE | TEMPERATURE RANGE | BOX | BOX DIMENSIONS (mm) | WEIGHT (kg) |
|---------------------|--------------|-------------------|-----|---------------------|-------------|
| CPF 03 ¹ | 870133340102 | -40/+40° C | 250 | 660x400x250 | 14 |
| CP 03 | 990133320102 | 0/120° C | 250 | 660x400x250 | 14 |
| CP 03 C | 990135629002 | 50/350° C | 250 | 660x400x250 | 14,5 |



CP 37

Case diameter 37 mm

| MODEL | CODE | TEMPERATURE RANGE | BOX | BOX DIMENSIONS (mm) | WEIGHT (kg) |
|---------------------|--------------|-------------------|-----|---------------------|-------------|
| CPF 37 ¹ | 980133340102 | -40/+40° C | 250 | 660x400x250 | 12 |
| CP 37* | 980133319502 | 0/120° C | 100 | 480x290x230 | 5 |



QP 03

Square case 48x48 mm

| MODEL | CODE | TEMPERATURE RANGE | BOX | BOX DIMENSIONS (mm) | WEIGHT (kg) |
|---------------------|--------------|-------------------|-----|---------------------|-------------|
| QPF 03 ¹ | 614033340402 | -40/+40° C | 250 | 660x400x250 | 14 |
| QP 03 | 443033319902 | 0/120° C | 250 | 660x400x250 | 14 |



RO 88

Horizontal version, available also vertical and/or white.

Case 58x25x55 mm

| MODEL | CODE | TEMPERATURE RANGE | BOX | BOX DIMENSIONS (mm) | WEIGHT (kg) |
|----------------------------|--------------|-------------------|-----|---------------------|-------------|
| ROF 88 Black | 883033340102 | -40/+40° C | 100 | 480x290x230 | 7 |
| ROF 88 Black* ¹ | 883033342602 | -40/+40° C | 100 | 480x290x230 | 7 |
| ROF 88 White | 883233340102 | -40/+40° C | 100 | 480x290x230 | 7 |
| ROF 88 White* ¹ | 883233342602 | -40/+40° C | 100 | 480x290x230 | 7 |
| RO 88 Black* | 732033320102 | 0/120° C | 100 | 480x290x230 | 7 |
| RO 88 C Black | 734035668002 | 50/350° C | 100 | 480x290x230 | 7 |

* Products normally available at stock.

¹ According to norm UNI EN 13485 "Thermometers for measuring the air and product temperature for the transport, storage and distribution of chilled, frozen, deep-frozen/quick frozen food and ice cream". Arthermo thermometers are manufactured with accuracy class 2 ($\pm 2^\circ\text{C}$) and resolution 1°C .



RO 2000

Horizontal version, available also vertical and/or white.

Case 58x25x45 mm

| MODEL | CODE | TEMPERATURE RANGE | BOX | BOX DIMENSIONS (mm) | WEIGHT (kg) |
|-----------------|--------------|-------------------|-----|---------------------|-------------|
| ROF 2000 Black | 960133340102 | -40/+40° C | 100 | 480x290x230 | 7 |
| ROF 2000 White | 960333340102 | -40/+40° C | 100 | 480x290x230 | 7 |
| RO 2000 Black | 740133363302 | 20/120° C | 100 | 480x290x230 | 7 |
| RO 2000 C Black | 740135668002 | 50/350° C | 100 | 480x290x230 | 7 |

RN

Horizontal version, available also vertical.

Case 62x11 mm



| MODEL | CODE | TEMPERATURE RANGE | BOX | BOX DIMENSIONS (mm) | WEIGHT (kg) |
|-------------------------------|--------------|-------------------|-----|---------------------|-------------|
| RNF 1 Rounded Frame Black | 560333352621 | -30/+40° C | 200 | 480x290x230 | 13 |
| RNF 2 Rectangular Frame Black | 570333352621 | -30/+40° C | 200 | 480x290x230 | 13 |
| RNF 1 Rounded Frame White | 560133352621 | -30/+40° C | 200 | 480x290x230 | 13 |
| RNF 2 Rectangular Frame White | 570133352621 | -30/+40° C | 200 | 480x290x230 | 13 |
| RN 1 Rounded Frame Black | 210233319502 | 0/120° C | 200 | 480x290x230 | 13 |
| RN 2 Rectangular Frame Black | 212733319502 | 0/120° C | 200 | 480x290x230 | 13 |
| RN 1 Rounded Frame White | 210133319502 | 0/120° C | 200 | 480x290x230 | 13 |
| RN 2 Rectangular Frame White | 212633319502 | 0/120° C | 200 | 480x290x230 | 13 |

C 71

Fixing brackets included, zinc plated steel case.



Diameter 52 mm

| MODEL | CODE | TEMPERATURE RANGE | BOX | BOX DIMENSIONS (mm) | WEIGHT (kg) |
|--------------------|--------------|-------------------|-----|---------------------|-------------|
| CF 72 ¹ | 160133338802 | -40/+40° C | 100 | 660x400x250 | 16 |
| C 71 | 130133328902 | 0/120° C | 100 | 660x400x250 | 16 |
| C 71 C | 135035676002 | 50/350° C | 100 | 660x400x250 | 16 |



Diameter 60 mm

| MODEL | CODE | TEMPERATURE RANGE | BOX | BOX DIMENSIONS (mm) | WEIGHT (kg) |
|--------------------|--------------|-------------------|-----|---------------------|-------------|
| CF 72 ¹ | 170133338802 | -40/+40° C | 100 | 660x400x250 | 16 |
| C 71 | 140133329002 | 0/120° C | 100 | 660x400x250 | 16 |
| C 71 C | 145435675902 | 50/350° C | 100 | 660x400x250 | 16 |

F 84 FA EC

Version with zinc plated steel case, available only with front flange.



Diameter 52 mm

| MODEL | CODE | TEMPERATURE RANGE | BOX | BOX DIMENSIONS (mm) | WEIGHT (kg) |
|----------------------|--------------|-------------------|-----|---------------------|-------------|
| F 84 EC ¹ | 190133340402 | -40/+40° C | 150 | 660x400x250 | 18 |
| F 84 EC | 190133319502 | 0/120° C | 150 | 660x400x250 | 18 |
| F 84 EC | 190234665002 | 50/350° C | 150 | 660x400x250 | 20 |

¹ According to norm UNI EN 13485 "Thermometers for measuring the air and product temperature for the transport, storage and distribution of chilled, frozen, deep-frozen/quick frozen food and ice cream". Arthermo thermometers are manufactured with accuracy class 2 (± 2° C) and resolution 1° C.

F 84 FA*Metal front flange, resin hardened case.***Diameter 60 mm**

| MODEL | CODE | TEMPERATURE RANGE | BOX | BOX DIMENSIONS (mm) | WEIGHT (kg) |
|----------------------|--------------|-------------------|-----|---------------------|-------------|
| F 84 FA ¹ | 220133040311 | -40/+40° C | 50 | 660x400x250 | 10 |
| F 84 FA | 220133019502 | 0/120° C | 50 | 660x400x250 | 10 |
| F 84 FA | 220134663102 | 50/350° C | 50 | 660x400x250 | 11 |

Diameter 80 mm

| MODEL | CODE | TEMPERATURE RANGE | BOX | BOX DIMENSIONS (mm) | WEIGHT (kg) |
|----------------------|--------------|-------------------|-----|---------------------|-------------|
| F 84 FA ¹ | 230133040311 | -40/+40° C | 40 | 660x400x250 | 10 |
| F 84 FA | 230133019502 | 0/120° C | 40 | 660x400x250 | 10 |
| F 84 FA | 230134663102 | 50/350° C | 40 | 660x400x250 | 11 |

Diameter 100 mm

| MODEL | CODE | TEMPERATURE RANGE | BOX | BOX DIMENSIONS (mm) | WEIGHT (kg) |
|----------------------|--------------|-------------------|-----|---------------------|-------------|
| F 84 FA ¹ | 240133040211 | -40/+40° C | 30 | 660x400x250 | 11 |
| F 84 FA | 240133019502 | 0/120° C | 30 | 660x400x250 | 11 |
| F 84 FA | 240134665002 | 50/350° C | 30 | 660x400x250 | 12 |

**F 84 FP***Version with back flange, resin hardened case.***Diameter 60 mm**

| MODEL | CODE | TEMPERATURE RANGE | BOX | BOX DIMENSIONS (mm) | WEIGHT (kg) |
|----------------------|--------------|-------------------|-----|---------------------|-------------|
| F 84 FP ¹ | 290133040111 | -40/+40° C | 50 | 660x400x250 | 10 |
| F 84 FP | 290133019602 | 0/120° C | 50 | 660x400x250 | 10 |
| F 84 FP | 290134666102 | 50/350° C | 50 | 660x400x250 | 11 |

Diameter 80 mm

| MODEL | CODE | TEMPERATURE RANGE | BOX | BOX DIMENSIONS (mm) | WEIGHT (kg) |
|----------------------|--------------|-------------------|-----|---------------------|-------------|
| F 84 FP ¹ | 300133040411 | -40/+40° C | 40 | 660x400x250 | 10 |
| F 84 FP | 300133019802 | 0/120° C | 40 | 660x400x250 | 10 |
| F 84 FP | 300134666102 | 50/350° C | 40 | 660x400x250 | 11 |

Diameter 100 mm

| MODEL | CODE | TEMPERATURE RANGE | BOX | BOX DIMENSIONS (mm) | WEIGHT (kg) |
|----------------------|--------------|-------------------|-----|---------------------|-------------|
| F 84 FP ¹ | 310133040211 | -40/+40° C | 30 | 660x400x250 | 10 |
| F 84 FP | 310133019802 | 0/120° C | 30 | 660x400x250 | 10 |
| F 84 FP | 310134666902 | 50/350° C | 30 | 660x400x250 | 11 |

**F 87 R***Case and reversible flange in ABS.***Diameter 60 mm**

| MODEL | CODE | TEMPERATURE RANGE | BOX | BOX DIMENSIONS (mm) | WEIGHT (kg) |
|-----------------------|--------------|-------------------|-----|---------------------|-------------|
| F 87 RF* ¹ | 910133040111 | -40/+40° C | 150 | 670x430x550 | 22 |
| F 87 R | 910133019502 | 0/120° C | 150 | 670x430x550 | 22 |
| F 87 RC | 910134667002 | 50/350° C | 150 | 670x430x550 | 22 |

Diameter 80 mm

| MODEL | CODE | TEMPERATURE RANGE | BOX | BOX DIMENSIONS (mm) | WEIGHT (kg) |
|-----------------------|--------------|-------------------|-----|---------------------|-------------|
| F 87 RF* ¹ | 920133040111 | -40/+40° C | 80 | 670x430x550 | 16 |
| F 87 R | 920133019502 | 0/120° C | 80 | 670x430x550 | 16 |
| F 87 RC | 920134667002 | 50/350° C | 80 | 670x430x550 | 16 |

Diameter 100 mm

| MODEL | CODE | TEMPERATURE RANGE | BOX | BOX DIMENSIONS (mm) | WEIGHT (kg) |
|-----------------------|--------------|-------------------|-----|---------------------|-------------|
| F 87 RF* ¹ | 930133040111 | -40/+40° C | 80 | 670x430x550 | 19 |
| F 87 R | 930133019502 | 0/120° C | 80 | 670x430x550 | 19 |
| F 87 RC | 930134667002 | 50/350° C | 80 | 670x430x550 | 19 |



* Products normally available at stock.

¹ According to norm UNI EN 13485 "Thermometers for measuring the air and product temperature for the transport, storage and distribution of chilled, frozen, deep-frozen/quick frozen food and ice cream". Arthermo thermometers are manufactured with accuracy class 2 ($\pm 2^\circ\text{C}$) and resolution 1°C .

ARTHERMO



Oven Range

Section 2

Capillary Thermometers 0/500° C Ø 52 - Ø 60 - Ø 80

NEW

APPLICATIONS: Ovens, stoves, grills, barbecues, chimneys.

MATERIALS

| | |
|----------------|--|
| Case | Zinc plated steel |
| Window | Glass |
| Pointer | Aluminium |
| Capillary/Bulb | Stainless steel mm 1000 |
| Frame | S.S. AISI 304 |
| Fixing | C71: With brackets F84: FA front flange |

TECHNICAL SPECIFICATIONS

| | |
|------------------------|--|
| Norm | EN 13190 |
| Temperature limits | Ambient: -20/+60° C Storage: -20/+60° C |
| Range | 0/500° C |
| Working temperature | +50/+450° C |
| Accuracy class | 2 |
| Degree of protection | IP53 (on request IP63 thermometer) |
| Thermometric movements | By gas expansion |

Mod. C71 OVEN

STANDARD VERSION



| MODEL | CODE | Ø (mm) | Ø flange (mm) | TEMPERATURE RANGE | BOX | BOX DIMENSIONS (mm) | WEIGHT (kg) |
|-----------|--------------|--------|---------------|-------------------|-----|---------------------|-------------|
| C 71 OVEN | 092023986153 | 52 | | 0-500° C | 100 | 660x400x250 | 16 |
| C 71 OVEN | 092523986153 | 60 | | 0-500° C | 100 | 660x400x250 | 16 |
| C 71 OVEN | 093023986153 | 80 | | 0-500° C | 60 | 660X400X250 | 18 |
| F84 OVEN | 091023986153 | 52 | | 0-500° C | 150 | 660x400x250 | 20 |
| F 84 OVEN | 091523986153 | 60 | 80 | 0-500° C | 120 | 660x400x250 | 20 |
| F 84 OVEN | 091723986153 | 60 | 85 | 0-500° C | 120 | 660x400x250 | 20 |

Mod. F84 OVEN

GOLD PLATED VERSION



| MODEL | CODE | Ø (mm) | Ø flange (mm) | TEMPERATURE RANGE | BOX | BOX DIMENSIONS (mm) | WEIGHT (kg) |
|-----------|--------------|--------|---------------|-------------------|-----|---------------------|-------------|
| C 71 OVEN | 092123986153 | 52 | | 0-500° C | 100 | 660x400x250 | 16 |
| C 71 OVEN | 092623986153 | 60 | | 0-500° C | 100 | 660x400x250 | 16 |
| C 71 OVEN | 093123986153 | 80 | | 0-500° C | 60 | 660X400X250 | 18 |
| F84 OVEN | 091123986153 | 52 | | 0-500° C | 150 | 660x400x250 | 20 |
| F 84 OVEN | 091623986153 | 60 | 80 | 0-500° C | 120 | 660x400x250 | 20 |
| F 84 OVEN | 091823986153 | 60 | 85 | 0-500° C | 120 | 660x400x250 | 20 |

Capillary Thermometers 0/600° C Ø 52 - Ø 60 - Ø 80

NEW

APPLICATIONS: Ovens, stoves, grills, barbecues, chimneys.

MATERIALS

| | |
|----------------|--|
| Case | Zinc plated steel |
| Window | Glass |
| Pointer | Aluminium |
| Capillary/Bulb | Stainless steel mm 1000 |
| Frame | S.S. AISI 304 |
| Fixing | C71: With brackets F84: FA front flange |

TECHNICAL SPECIFICATIONS

| | |
|------------------------|--|
| Norm | EN 13190 |
| Temperature limits | Ambient: -20/+60° C Storage: -20/+60° C |
| Range | 0/600° C |
| Working temperature | +50/+500° C |
| Accuracy class | 2 |
| Degree of protection | IP53 (on request IP63 thermometer) |
| Thermometric movements | By gas expansion |

Mod. C71 OVEN



STANDARD VERSION

| MODEL | CODE | Ø (mm) | Ø flange (mm) | TEMPERATURE RANGE | BOX | BOX DIMENSIONS (mm) | WEIGHT (kg) |
|----------|--------------|--------|---------------|-------------------|-----|---------------------|-------------|
| C71 OVEN | 092023986053 | 52 | | 0/600° C | 100 | 660x400x250 | 16 |
| C71 OVEN | 092523986053 | 60 | | 0/600° C | 100 | 660x400x250 | 16 |
| C71 OVEN | 093023986053 | 80 | | 0/600° C | 60 | 660x400x250 | 18 |
| F84 OVEN | 091023986053 | 52 | | 0/600° C | 150 | 660x400x250 | 20 |
| F84 OVEN | 091523986053 | 60 | 80 | 0/600° C | 120 | 660x400x250 | 20 |
| F84 OVEN | 091723986053 | 60 | 85 | 0/600° C | 120 | 660x400x250 | 20 |

Mod. F84 OVEN



GOLD PLATED VERSION

| MODEL | CODE | Ø (mm) | Ø flange (mm) | TEMPERATURE RANGE | BOX | BOX DIMENSIONS (mm) | WEIGHT (kg) |
|-----------|--------------|--------|---------------|-------------------|-----|---------------------|-------------|
| C 71 OVEN | 092123986053 | 52 | | 0-600° C | 100 | 660x400x250 | 16 |
| C 71 OVEN | 092623986053 | 60 | | 0-600° C | 100 | 660x400x250 | 16 |
| C 71 OVEN | 093123986053 | 80 | | 0-600° C | 60 | 660x400x250 | 18 |
| F84 OVEN | 091123986053 | 52 | | 0-600° C | 150 | 660x400x250 | 20 |
| F 84 OVEN | 091623986053 | 60 | 80 | 0-600° C | 120 | 660x400x250 | 20 |
| F84 OVEN | 091823986053 | 60 | 85 | 0-600° C | 120 | 660x400x250 | 20 |

Timer 60 Min. Ø 60

APPLICATIONS: Ovens, stoves, grills, barbecues, chimneys.

TIMER C71 Ø 60



TIMER 60 MIN.

| MODEL | CODE | Ø flange (mm) | BOX | BOX DIMENSIONS (mm) | WEIGHT (kg) |
|----------------|---------------|---------------|-----|---------------------|-------------|
| TIMER C71 OVEN | TIMER60/01C71 | | 100 | 660x400x250 | 16 |
| TIMER F84 OVEN | TIMER60/0180 | 80 | 120 | 660x400x250 | 20 |
| TIMER F84 OVEN | TIMER60/0185 | 85 | 120 | 660x400x250 | 20 |

TIMER F84 Ø 60



GOLD PLATED TIMER 60 MIN.

| MODEL | CODE | Ø flange (mm) | BOX | BOX DIMENSIONS (mm) | WEIGHT (kg) |
|---------------------|----------------|---------------|-----|---------------------|-------------|
| TIMER C71 OVEN GOLD | TIMER60/01C71G | | 100 | 660x400x250 | 16 |
| TIMER F84 OVEN GOLD | TIMER60/0180G | 80 | 120 | 660x400x250 | 20 |
| TIMER F84 OVEN GOLD | TIMER60/0185G | 85 | 120 | 660x400x250 | 20 |

Bimetallic Thermometers Ø 40 - Ø 50 - Ø 65

APPLICATIONS: Ovens, stoves, grills, barbecues, chimneys.

MATERIALS

| | |
|---------------------|-----------------------------------|
| Case | Zinc plated steel |
| Window | Glass |
| Dial | Aluminium |
| Pointer | Aluminium |
| Stem | Zinc plated steel Ø 9 mm or brass |
| Temperature element | Bimetallic, spiralled |

TECHNICAL SPECIFICATIONS

| | |
|-----------------------|--|
| Norm | EN 13190 |
| Temperature limits | Ambient: -20/+60° C Storage: -20/+60° C |
| Operating temperature | As per dial indication |
| Accuracy class | 2 |
| Degree of protection | IP41 per EN 60 529/IEC 529 |



MOD. 569



A) DIRECT IMMERSION

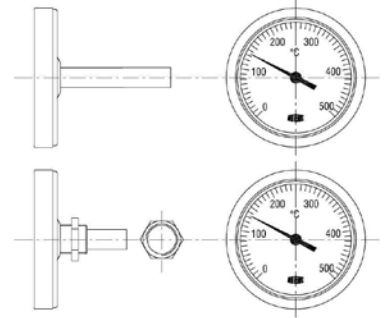

B) G1/4" THREADED WITH NUT

| TYPE | CODE | STEM (mm) | TEMPERATURE RANGE | BOX | BOX DIMENSIONS (mm) | WEIGHT (kg) |
|--------------|--------------|-------------|-------------------|-----|---------------------|-------------|
| AR569-T/B 40 | 024207438500 | 20 threaded | 0-500°C | 350 | 600x400x200 | 11,6 |
| AR569-T/B 40 | 024209138500 | 27 | 0-500°C | 350 | 600x400x200 | 11,6 |
| AR569-T/B 40 | 024227938500 | 50 | 0-500°C | 280 | 600x400x200 | 14,2 |
| AR569-T/B 50 | 030109139600 | 27 | 0-500°C | 350 | 600x400x200 | 17,7 |
| AR569-T/B 50 | 030127939600 | 50 | 0-500°C | 280 | 600x400x200 | 15,8 |
| AR569-T/B 50 | 030151739600 | 100 | 0-500°C | 200 | 660x400x250 | 16,0 |
| AR569-T/B 65 | 040127939100 | 50 | 0-500°C | 120 | 600x400x200 | 10,8 |
| AR569-T/B 65 | 040151739100 | 100 | 0-500°C | 150 | 660x400x250 | 14,0 |
| AR569-T/B 65 | 040165039100 | 150 | 0-500°C | 120 | 660x400x250 | 12,5 |
| AR569-T/B 65 | 040169639100 | 200 | 0-500°C | 100 | 660x400x250 | 12,5 |
| AR569-T/B 65 | 040177239100 | 300 | 0-500°C | 100 | 660x400x250 | 13,5 |
| AR569-T/B 65 | 040179439100 | 400 | 0-500°C | 100 | 660x400x250 | 14,5 |

Accessories

Clip, coop spring, gasket.:



| MODEL | CODE |
|-------------|-------------|
| COOP SPRING | 05034016201 |
| CLIP SPRING | 05034205PTZ |
| GASKET Ø40 | 17139252048 |
| GASKET Ø50 | 17139250042 |
| GASKET Ø65 | 17139250050 |

On request: threaded stem + nut +23% on pricelist

Bimetallic Old Style

APPLICATIONS: Ovens, stoves, grills, barbecues, chimneys.

TECHNICAL SPECIFICATIONS

| | CIRCBELL | PANEL | POINTER | ARTH-COOK |
|-------------------------|---------------|---------------|---------------------|---------------|
| CODE | 013100000000 | 014100000100 | 012400000000 | 100100004000 |
| CASE | Inox Aisi 430 | Inox Aisi 430 | Chrome-plated brass | Inox Aisi 430 |
| KNOB | Alluminium | Alluminium | - | - |
| ROTATING INDEX | Metallic | Metallic | Metallic | Metallic |
| STANDARD ROTATING INDEX | Anticlockwise | Clockwise | Anticlockwise | Clockwise |
| ON DEMAND | Clockwise | - | Clockwise | - |
| WORKING TEMPERATURE | 300°C | 300°C | 300°C | 300°C |
| GASKET | | | Klinger | - |
| QTY/BOX | 500 | 500 | 500 | 250 |

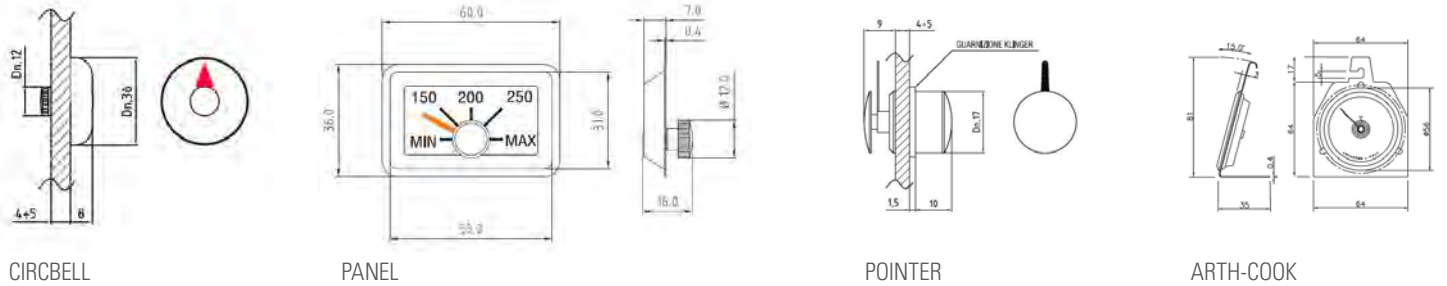
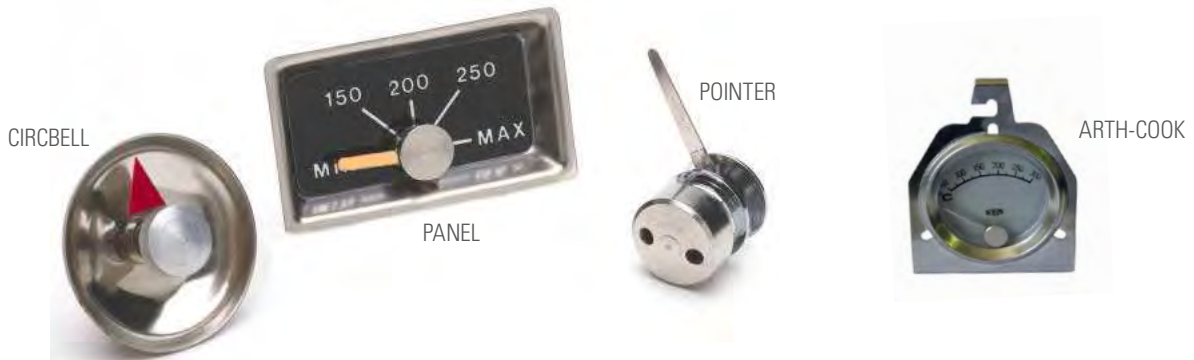

Digital Controller

APPLICATIONS: Ovens, stoves, grills, barbecues, chimneys.

CO-600



TECHNICAL SPECIFICATIONS

| | |
|---------------------|------------------------------|
| Range | 0/600° C |
| Power supply | 230 VAC ± 10% 50/60 Hz |
| Power consumption | <3 VA |
| Accuracy | ± 1° C |
| Probe | N.1 - PT1000 on demand |
| Output | N.1 relay: 30A 230 VAC ± 10% |
| Panel size | 75x34,5 mm |
| Installing size | 71x29 mm |
| Ambient temperature | -10/+60° C |
| Relative humidity | 20%/+85% |
| Qty/Box | 50 |



ARTHERMO

Bimetallic Thermometers

Section 3

Bimetallic Thermometers with Zinc Plated Steel Case

APPLICATIONS: Heating, floor heating, conditioning, boilers, ovens, stoves, chimneys and electrical appliances.

FIG. 569 Ø 32 Ø 40

Zinc plated steel case, back stem.

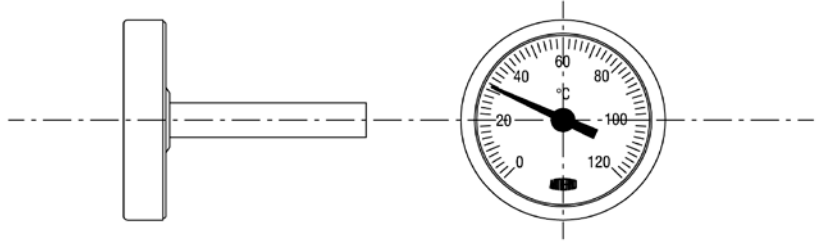

MATERIALS

| | |
|---------------------|--------------------------|
| Case | Zinc plated steel |
| Window | Clear resin/glass |
| Dial | Aluminium |
| Pointer | Resin/aluminium |
| Stem | Zinc plated steel Ø 9 mm |
| Temperature element | Bimetallic, spiralled |

TECHNICAL SPECIFICATIONS

| | |
|-----------------------|--|
| Design | UNI EN 13190 |
| Temperature limits | Ambient: -20/+60° C Storage: -20/+60° C |
| Operating temperature | As per scale indication |
| Accuracy class | 2 |
| Degree of protection | IP41 per EN 60 529/IEC 529 |

Diameter 32 mm

| TYPE | CODE | STEM (mm) | TEMPERATURE RANGE | BOX | BOX DIMENSIONS (mm) | WEIGHT (kg) |
|-----------|--------------|-----------|-------------------|-----|---------------------|-------------|
| AR-T/B 32 | 020109116200 | 27 | 0-80° C | 350 | 600x400x200 | 11,7 |
| AR-T/B 32 | 020109119700 | 27 | 0-120° C | 350 | 600x400x200 | 11,7 |
| AR-T/B 32 | 020109129100 | 27 | 0-200° C | 350 | 600x400x200 | 11,7 |
| AR-T/B 32 | | 27 | 0-300° C | 350 | 600x400x200 | 11,7 |
| AR-T/B 32 | | 27 | 0-400° C | 350 | 600x400x200 | 11,7 |
| AR-T/B 32 | 020127916200 | 50 | 0-80° C | 280 | 600x400x200 | 12 |
| AR-T/B 32 | 020127919700 | 50 | 0-120° C | 280 | 600x400x200 | 12 |
| AR-T/B 32 | 020127929100 | 50 | 0-200° C | 280 | 600x400x200 | 12 |
| AR-T/B 32 | 020127934500 | 50 | 0-300° C | 280 | 600x400x200 | 12 |
| AR-T/B 32 | 020127936500 | 50 | 0-400° C | 280 | 600x400x200 | 12 |

Diameter 40 mm

| TYPE | CODE | STEM (mm) | TEMPERATURE RANGE | BOX | BOX DIMENSIONS (mm) | WEIGHT (kg) |
|-----------|--------------|-------------|-------------------|-----|---------------------|-------------|
| AR-T/B 40 | 024207438500 | 20 threaded | 0-500° C | 350 | 600x400x200 | 11,6 |
| AR-T/B 40 | | 27 | 0-60° C | 350 | 600x400x200 | 11,6 |
| AR-T/B 40 | 024209116100 | 27 | 0-80° C | 350 | 600x400x200 | 11,6 |
| AR-T/B 40 | 024209119800 | 27 | 0-120° C | 350 | 600x400x200 | 11,6 |
| AR-T/B 40 | | 27 | 0-160° C | 350 | 600x400x200 | 11,6 |
| AR-T/B 40 | 024209134500 | 27 | 0-300° C | 350 | 600x400x200 | 11,6 |
| AR-T/B 40 | | 27 | 0-400° C | 350 | 600x400x200 | 11,6 |
| AR-T/B 40 | 024209138500 | 27 | 0-500° C | 350 | 600x400x200 | 11,6 |
| AR-T/B 40 | | 50 | 0-60° C | 280 | 600x400x200 | 14,2 |
| AR-T/B 40 | 024227916100 | 50 | 0-80° C | 280 | 600x400x200 | 14,2 |
| AR-T/B 40 | 024227919800 | 50 | 0-120° C | 280 | 600x400x200 | 14,2 |
| AR-T/B 40 | | 50 | 0-160° C | 280 | 600x400x200 | 14,2 |
| AR-T/B 40 | 024227929100 | 50 | 0-300° C | 280 | 600x400x200 | 14,2 |
| AR-T/B 40 | | 50 | 0-400° C | 280 | 600x400x200 | 14,2 |
| AR-T/B 40 | 024227938500 | 50 | 0-500° C | 280 | 600x400x200 | 14,2 |

On request: different stem length
On request: threaded stem + nut +23% on pricelist

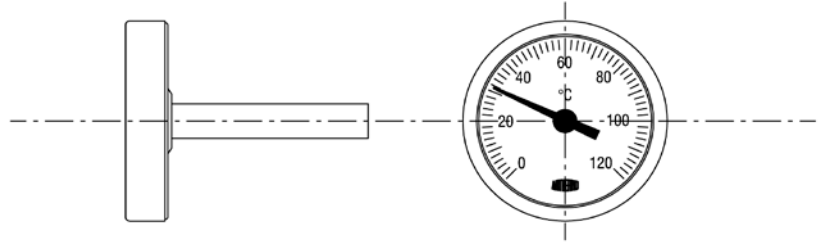
FIG. 569 Ø 50*Zinc plated steel case, back stem.***MATERIALS**

| | |
|---------------------|--------------------------|
| Case | Zinc plated steel |
| Window | Clear resin/glass |
| Dial | Aluminium |
| Pointer | Resin/aluminium |
| Stem | Zinc plated steel Ø 9 mm |
| Temperature element | Bimetallic, spiralled |

TECHNICAL SPECIFICATIONS

| | |
|-----------------------|--|
| Design | UNI EN 13190 |
| Temperature limits | Ambient: -20/+60° C Storage: -20/+60° C |
| Operating temperature | As per scale indication |
| Accuracy class | 2 |
| Degree of protection | IP41 per EN 60 529/IEC 529 |

Diameter 50 mm

| TYPE | CODE | STEM (mm) | TEMPERATURE RANGE | BOX | BOX DIMENSIONS (mm) | WEIGHT (kg) |
|-----------|--------------|-----------|-------------------|-----|---------------------|-------------|
| AR-T/B 50 | | 27 | 0-60° C | 350 | 600x400x200 | 17,7 |
| AR-T/B 50 | | 27 | 0-80° C | 350 | 600x400x200 | 17,7 |
| AR-T/B 50 | 030109119800 | 27 | 0-120° C | 350 | 600x400x200 | 17,7 |
| AR-T/B 50 | 030109124000 | 27 | 0-160° C | 350 | 600x400x200 | 17,7 |
| AR-T/B 50 | 030109134500 | 27 | 0-300° C | 350 | 600x400x200 | 17,7 |
| AR-T/B 50 | | 27 | 0-400° C | 350 | 600x400x200 | 17,7 |
| AR-T/B 50 | | 27 | 0-500° C | 350 | 600x400x200 | 17,7 |
| AR-T/B 50 | | 50 | 0-60° C | 280 | 600x400x200 | 15,8 |
| AR-T/B 50 | | 50 | 0-80° C | 280 | 600x400x200 | 15,8 |
| AR-T/B 50 | 030127919800 | 50 | 0-120° C | 280 | 600x400x200 | 15,8 |
| AR-T/B 50 | 030127924000 | 50 | 0-160° C | 280 | 600x400x200 | 15,8 |
| AR-T/B 50 | 030127934500 | 50 | 0-300° C | 280 | 600x400x200 | 15,8 |
| AR-T/B 50 | | 50 | 0-400° C | 280 | 600x400x200 | 15,8 |
| AR-T/B 50 | | 50 | 0-500° C | 280 | 600x400x200 | 15,8 |
| AR-T/B 50 | | 100 | 0-60° C | 200 | 660x400x250 | 16 |
| AR-T/B 50 | 030151718000 | 100 | 0-80° C | 200 | 660x400x250 | 16 |
| AR-T/B 50 | 030151719800 | 100 | 0-120° C | 200 | 660x400x250 | 16 |
| AR-T/B 50 | 030151724000 | 100 | 0-160° C | 200 | 660x400x250 | 16 |
| AR-T/B 50 | 030151734500 | 100 | 0-300° C | 200 | 660x400x250 | 16 |
| AR-T/B 50 | 030151736400 | 100 | 0-400° C | 200 | 660x400x250 | 16 |
| AR-T/B 50 | 030151739600 | 100 | 0-500° C | 200 | 660x400x250 | 16 |

On request: different stem length

On request: threaded stem + nut +23% on pricelist

FIG. 569 Ø 65

Zinc plated steel case, back stem.

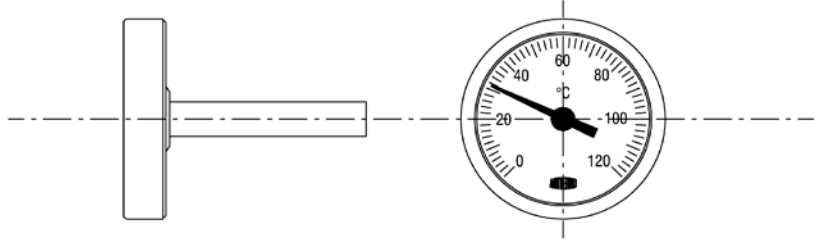

MATERIALS

| | |
|---------------------|--------------------------|
| Case | Zinc plated steel |
| Window | Clear resin/glass |
| Dial | Aluminium |
| Pointer | Resin/aluminium |
| Stem | Zinc plated steel Ø 9 mm |
| Temperature element | Bimetallic, spiralled |

TECHNICAL SPECIFICATIONS

| | |
|-----------------------|--|
| Design | UNI EN 13190 |
| Temperature limits | Ambient: -20/+60° C Storage: -20/+60° C |
| Operating temperature | As per scale indication |
| Accuracy class | 2 |
| Degree of protection | IP41 per EN 60 529/IEC 529 |

Diameter 65 mm

| TYPE | CODE | STEM (mm) | TEMPERATURE RANGE | BOX | BOX DIMENSIONS (mm) | WEIGHT (kg) |
|-----------|--------------|-----------|-------------------|-----|---------------------|-------------|
| AR-T/B 65 | 040127915100 | 50 | 0-60° C | 120 | 600x400x200 | 10,8 |
| AR-T/B 65 | | 50 | 0-80° C | 120 | 600x400x200 | 10,8 |
| AR-T/B 65 | 040127919900 | 50 | 0-120° C | 120 | 600x400x200 | 10,8 |
| AR-T/B 65 | 040127924200 | 50 | 0-160° C | 120 | 600x400x200 | 10,8 |
| AR-T/B 65 | 040127934100 | 50 | 0-300° C | 120 | 600x400x200 | 10,8 |
| AR-T/B 65 | | 50 | 0-400° C | 120 | 600x400x200 | 10,8 |
| AR-T/B 65 | 040127939100 | 50 | 0-500° C | 120 | 600x400x200 | 10,8 |
| AR-T/B 65 | 040151715100 | 100 | 0-60° C | 150 | 660x400x250 | 14 |
| AR-T/B 65 | | 100 | 0-80° C | 150 | 660x400x250 | 14 |
| AR-T/B 65 | 040151719900 | 100 | 0-120° C | 150 | 660x400x250 | 14 |
| AR-T/B 65 | 040151724200 | 100 | 0-160° C | 150 | 660x400x250 | 14 |
| AR-T/B 65 | 040151734100 | 100 | 0-300° C | 150 | 660x400x250 | 14 |
| AR-T/B 65 | | 100 | 0-400° C | 150 | 660x400x250 | 14 |
| AR-T/B 65 | 040151739100 | 100 | 0-500° C | 150 | 660x400x250 | 14 |
| AR-T/B 65 | | 150 | 0-60° C | 120 | 660x400x250 | 12,5 |
| AR-T/B 65 | | 150 | 0-80° C | 120 | 660x400x250 | 12,5 |
| AR-T/B 65 | 040165019900 | 150 | 0-120° C | 120 | 660x400x250 | 12,5 |
| AR-T/B 65 | 040165024200 | 150 | 0-160° C | 120 | 660x400x250 | 12,5 |
| AR-T/B 65 | 040165034100 | 150 | 0-300° C | 120 | 660x400x250 | 12,5 |
| AR-T/B 65 | | 150 | 0-400° C | 120 | 660x400x250 | 12,5 |
| AR-T/B 65 | 040165039100 | 150 | 0-500° C | 120 | 660x400x250 | 12,5 |
| AR-T/B 65 | | 200 | 0-60° C | 100 | 660x400x250 | 12,5 |
| AR-T/B 65 | | 200 | 0-80° C | 100 | 660x400x250 | 12,5 |
| AR-T/B 65 | 040169619900 | 200 | 0-120° C | 100 | 660x400x250 | 12,5 |
| AR-T/B 65 | 040169624200 | 200 | 0-160° C | 100 | 660x400x250 | 12,5 |
| AR-T/B 65 | 040169634100 | 200 | 0-300° C | 100 | 660x400x250 | 12,5 |
| AR-T/B 65 | | 200 | 0-400° C | 100 | 660x400x250 | 12,5 |
| AR-T/B 65 | 040169639100 | 200 | 0-500° C | 100 | 660x400x250 | 12,5 |
| AR-T/B 65 | | 300 | 0-60° C | 100 | 660x400x250 | 13,5 |
| AR-T/B 65 | | 300 | 0-80° C | 100 | 660x400x250 | 13,5 |
| AR-T/B 65 | 040177219900 | 300 | 0-120° C | 100 | 660x400x250 | 13,5 |
| AR-T/B 65 | 040177224200 | 300 | 0-160° C | 100 | 660x400x250 | 13,5 |
| AR-T/B 65 | 040177234100 | 300 | 0-300° C | 100 | 660x400x250 | 13,5 |
| AR-T/B 65 | | 300 | 0-400° C | 100 | 660x400x250 | 13,5 |
| AR-T/B 65 | 040177239100 | 300 | 0-500° C | 100 | 660x400x250 | 13,5 |
| AR-T/B 65 | | 400 | 0-400° C | 100 | 660x400x250 | 14,5 |
| AR-T/B 65 | 040179439100 | 400 | 0-500° C | 100 | 660x400x250 | 14,5 |

On request: different stem length
On request: threaded stem + nut +23% on pricelist

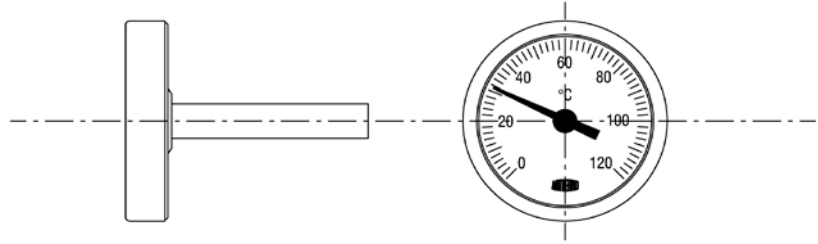
FIG. 569 Ø 80*Zinc plated steel case, back stem.***MATERIALS**

| | |
|---------------------|--------------------------|
| Case | Zinc plated steel |
| Window | Clear resin/glass |
| Dial | Aluminium |
| Pointer | Resin/aluminium |
| Stem | Zinc plated steel Ø 9 mm |
| Temperature element | Bimetallic, spiralled |

TECHNICAL SPECIFICATIONS

| | |
|-----------------------|--|
| Design | UNI EN 13190 |
| Temperature limits | Ambient: -20/+60° C Storage: -20/+60° C |
| Operating temperature | As per scale indication |
| Accuracy class | 2 |
| Degree of protection | IP41 per EN 60 529/IEC 529 |

Diameter 80 mm

| TYPE | CODE | STEM (mm) | TEMPERATURE RANGE | BOX | BOX DIMENSIONS (mm) | WEIGHT (kg) |
|-----------|--------------|-----------|-------------------|-----|---------------------|-------------|
| AR-T/B 80 | 050127916000 | 50 | 0-60° C | 120 | 600x400x200 | 15,2 |
| AR-T/B 80 | | 50 | 0-80° C | 120 | 600x400x200 | 15,2 |
| AR-T/B 80 | 050127920000 | 50 | 0-120° C | 120 | 600x400x200 | 15,2 |
| AR-T/B 80 | | 50 | 0-160° C | 120 | 600x400x200 | 15,2 |
| AR-T/B 80 | 050127935000 | 50 | 0-300° C | 120 | 600x400x200 | 15,2 |
| AR-T/B 80 | | 50 | 0-400° C | 120 | 600x400x200 | 15,2 |
| AR-T/B 80 | 050127938400 | 50 | 0-500° C | 120 | 600x400x200 | 15,2 |
| AR-T/B 80 | 050151716000 | 100 | 0-60° C | 150 | 660x400x250 | 19,5 |
| AR-T/B 80 | | 100 | 0-80° C | 150 | 660x400x250 | 19,5 |
| AR-T/B 80 | 050151720000 | 100 | 0-120° C | 150 | 660x400x250 | 19,5 |
| AR-T/B 80 | | 100 | 0-160° C | 150 | 660x400x250 | 19,5 |
| AR-T/B 80 | 050151735000 | 100 | 0-300° C | 150 | 660x400x250 | 19,5 |
| AR-T/B 80 | | 100 | 0-400° C | 150 | 660x400x250 | 19,5 |
| AR-T/B 80 | 050151738400 | 100 | 0-500° C | 150 | 660x400x250 | 19,5 |
| AR-T/B 80 | | 150 | 0-60° C | 120 | 660x400x250 | 21 |
| AR-T/B 80 | | 150 | 0-80° C | 120 | 660x400x250 | 21 |
| AR-T/B 80 | 050165020000 | 150 | 0-120° C | 120 | 660x400x250 | 21 |
| AR-T/B 80 | | 150 | 0-160° C | 120 | 660x400x250 | 21 |
| AR-T/B 80 | 050165035000 | 150 | 0-300° C | 120 | 660x400x250 | 21 |
| AR-T/B 80 | | 150 | 0-400° C | 120 | 660x400x250 | 21 |
| AR-T/B 80 | 050165038400 | 150 | 0-500° C | 120 | 660x400x250 | 21 |
| AR-T/B 80 | | 200 | 0-60° C | 100 | 660x400x250 | 15 |
| AR-T/B 80 | | 200 | 0-80° C | 100 | 660x400x250 | 15 |
| AR-T/B 80 | 050169620000 | 200 | 0-120° C | 100 | 660x400x250 | 15 |
| AR-T/B 80 | | 200 | 0-160° C | 100 | 660x400x250 | 15 |
| AR-T/B 80 | 050169635000 | 200 | 0-300° C | 100 | 660x400x250 | 15 |
| AR-T/B 80 | | 200 | 0-400° C | 100 | 660x400x250 | 15 |
| AR-T/B 80 | 050169638400 | 200 | 0-500° C | 100 | 660x400x250 | 15 |
| AR-T/B 80 | | 300 | 0-60° C | 100 | 660x400x250 | 17 |
| AR-T/B 80 | | 300 | 0-80° C | 100 | 660x400x250 | 17 |
| AR-T/B 80 | 050177220000 | 300 | 0-120° C | 100 | 660x400x250 | 17 |
| AR-T/B 80 | | 300 | 0-160° C | 100 | 660x400x250 | 17 |
| AR-T/B 80 | 050177235000 | 300 | 0-300° C | 100 | 660x400x250 | 17 |
| AR-T/B 80 | | 300 | 0-400° C | 100 | 660x400x250 | 17 |
| AR-T/B 80 | 050177238400 | 300 | 0-500° C | 100 | 660x400x250 | 17 |
| AR-T/B 80 | | 400 | 0-400° C | 75 | 660x400x250 | 14,5 |
| AR-T/B 80 | 050179438400 | 400 | 0-500° C | 75 | 660x400x250 | 14,5 |

On request: different stem length

On request: threaded stem + nut +23% on pricelist

FIG. 569 Ø 100

Zinc plated steel case, back stem.

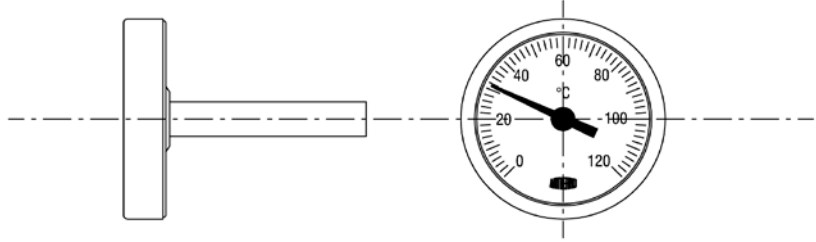

MATERIALS

| | |
|---------------------|--------------------------|
| Case | Zinc plated steel |
| Window | Clear resin/glass |
| Dial | Aluminium |
| Pointer | Resin/aluminium |
| Stem | Zinc plated steel Ø 9 mm |
| Temperature element | Bimetallic, spiralled |

TECHNICAL SPECIFICATIONS

| | |
|-----------------------|--|
| Design | UNI EN 13190 |
| Temperature limits | Ambient: -20/+60° C Storage: -20/+60° C |
| Operating temperature | As per scale indication |
| Accuracy class | 2 |
| Degree of protection | IP41 per EN 60 529/IEC 529 |

Diameter 100 mm

| TYPE | CODE | STEM (mm) | TEMPERATURE RANGE | BOX | BOX DIMENSIONS (mm) | WEIGHT (kg) |
|------------|--------------|-----------|-------------------|-----|---------------------|-------------|
| AR-T/B 100 | 060127915000 | 50 | 0-60° C | 100 | 660x400x250 | 19 |
| AR-T/B 100 | | 50 | 0-80° C | 100 | 660x400x250 | 19 |
| AR-T/B 100 | 060127919800 | 50 | 0-120° C | 100 | 660x400x250 | 19 |
| AR-T/B 100 | | 50 | 0-160° C | 100 | 660x400x250 | 19 |
| AR-T/B 100 | 060127935500 | 50 | 0-300° C | 100 | 660x400x250 | 19 |
| AR-T/B 100 | | 50 | 0-400° C | 100 | 660x400x250 | 19 |
| AR-T/B 100 | 060127939300 | 50 | 0-500° C | 100 | 660x400x250 | 19 |
| AR-T/B 100 | 060151715000 | 100 | 0-60° C | 100 | 660x400x250 | 20 |
| AR-T/B 100 | | 100 | 0-80° C | 100 | 660x400x250 | 20 |
| AR-T/B 100 | 060151719800 | 100 | 0-120° C | 100 | 660x400x250 | 20 |
| AR-T/B 100 | | 100 | 0-160° C | 100 | 660x400x250 | 20 |
| AR-T/B 100 | 060151735500 | 100 | 0-300° C | 100 | 660x400x250 | 20 |
| AR-T/B 100 | | 100 | 0-400° C | 100 | 660x400x250 | 20 |
| AR-T/B 100 | 060151739300 | 100 | 0-500° C | 100 | 660x400x250 | 20 |
| AR-T/B 100 | | 150 | 0-60° C | 80 | 660x400x250 | 17 |
| AR-T/B 100 | | 150 | 0-80° C | 80 | 660x400x250 | 17 |
| AR-T/B 100 | 060165019800 | 150 | 0-120° C | 80 | 660x400x250 | 17 |
| AR-T/B 100 | | 150 | 0-160° C | 80 | 660x400x250 | 17 |
| AR-T/B 100 | 060165035500 | 150 | 0-300° C | 80 | 660x400x250 | 17 |
| AR-T/B 100 | | 150 | 0-400° C | 80 | 660x400x250 | 17 |
| AR-T/B 100 | 060165039300 | 150 | 0-500° C | 80 | 660x400x250 | 17 |
| AR-T/B 100 | | 200 | 0-60° C | 80 | 660x400x250 | 18 |
| AR-T/B 100 | | 200 | 0-80° C | 80 | 660x400x250 | 18 |
| AR-T/B 100 | 060169619800 | 200 | 0-120° C | 80 | 660x400x250 | 18 |
| AR-T/B 100 | | 200 | 0-160° C | 80 | 660x400x250 | 18 |
| AR-T/B 100 | 060169635500 | 200 | 0-300° C | 80 | 660x400x250 | 18 |
| AR-T/B 100 | | 200 | 0-400° C | 80 | 660x400x250 | 18 |
| AR-T/B 100 | 060169639300 | 200 | 0-500° C | 80 | 660x400x250 | 18 |
| AR-T/B 100 | | 300 | 0-60° C | 50 | 660x400x250 | 13 |
| AR-T/B 100 | | 300 | 0-80° C | 50 | 660x400x250 | 13 |
| AR-T/B 100 | 060177219800 | 300 | 0-120° C | 50 | 660x400x250 | 13 |
| AR-T/B 100 | | 300 | 0-160° C | 50 | 660x400x250 | 13 |
| AR-T/B 100 | 060177235500 | 300 | 0-300° C | 50 | 660x400x250 | 13 |
| AR-T/B 100 | | 300 | 0-400° C | 50 | 660x400x250 | 13 |
| AR-T/B 100 | 060177239300 | 300 | 0-500° C | 50 | 660x400x250 | 13 |
| AR-T/B 100 | | 400 | 0-400° C | 50 | 660x400x250 | 13,50 |
| AR-T/B 100 | 060179439300 | 400 | 0-500° C | 50 | 660x400x250 | 13,50 |

On request: different stem length
On request: threaded stem + nut +23% on pricelist

Bimetallic Thermometers with Resin Case

APPLICATIONS: Heating, floor heating, pumping groups in solar systems, boilers.

FIG. 569 Ø 40 Ø 50

Resin without frame/with frame.



| TYPE | MODEL | CODE | DIAMETER | STEM (mm) | TEMPERATURE | BOX | BOX DIMENSIONS | WEIGHT (kg) |
|----------------|---------------|--------------|----------|-----------|-------------|-----|----------------|-------------|
| AR-T/B. RES 40 | without frame | 023200014800 | Ø 40 | 27 | 0-60° C | 350 | 600x400x200 | 6 |
| AR-T/B. RES 40 | without frame | 023200016100 | Ø 40 | 27 | 0-80° C | 350 | 600x400x200 | 6 |
| AR-T/B. RES 40 | without frame | 023200019800 | Ø 40 | 27 | 0-120° C | 350 | 600x400x200 | 6 |
| AR-T/B. RES 40 | without frame | 023100014800 | Ø 40 | 50 | 0-60° C | 280 | 600x400x200 | 5 |
| AR-T/B. RES 40 | without frame | 023100016100 | Ø 40 | 50 | 0-80° C | 280 | 600x400x200 | 5 |
| AR-T/B. RES 40 | without frame | 023100019800 | Ø 40 | 50 | 0-120° C | 280 | 600x400x200 | 5 |
| AR-T/B. RES 50 | without frame | 033008519800 | Ø 50 | 25 | 0-120° C | 350 | 600x400x200 | 6 |
| AR-T/B. RES 50 | without frame | 033108524000 | Ø 50 | 25 | 0-160° C | 350 | 600x400x200 | 6 |
| AR-T/B. RES 50 | without frame | 033027919800 | Ø 50 | 50 | 0-120° C | 280 | 600x400x200 | 5 |
| AR-T/B. RES 50 | without frame | 033127924000 | Ø 50 | 50 | 0-160° C | 280 | 600x400x200 | 5 |
| AR-T/B. RES 40 | with frame | 022900014800 | Ø 40 | 27 | 0-60° C | 350 | 600x400x200 | 6,5 |
| AR-T/B. RES 40 | with frame | 022900016100 | Ø 40 | 27 | 0-80° C | 350 | 600x400x200 | 6,5 |
| AR-T/B. RES 40 | with frame | 022900019800 | Ø 40 | 27 | 0-120° C | 350 | 600x400x200 | 6,5 |
| AR-T/B. RES 40 | with frame | 023000014800 | Ø 40 | 50 | 0-60° C | 280 | 600x400x200 | 5,5 |
| AR-T/B. RES 40 | with frame | 023000016100 | Ø 40 | 50 | 0-80° C | 280 | 600x400x200 | 5,5 |
| AR-T/B. RES 40 | with frame | 023000019800 | Ø 40 | 50 | 0-120° C | 280 | 600x400x200 | 5,5 |
| AR-T/B. RES 50 | with frame | 032908519800 | Ø 50 | 25 | 0-120° C | 350 | 600x400x200 | 6,5 |
| AR-T/B. RES 50 | with frame | 033208524000 | Ø 50 | 25 | 0-160° C | 350 | 600x400x200 | 6,5 |
| AR-T/B. RES 50 | with frame | 032927919800 | Ø 50 | 50 | 0-120° C | 280 | 600x400x200 | 5,5 |
| AR-T/B. RES 50 | with frame | 033227924000 | Ø 50 | 50 | 0-160° C | 280 | 600x400x200 | 5,5 |

Accessories for Bimetallic Thermometers

POCKET FOR THERMOMETERS



| MODEL | CODE | CONNECTION | LENGTH (mm) |
|--------------------------------|---------------|------------|-------------|
| BRASS POCKET WITH CLIP SPRING | 903733000803 | G 3/8 B | 30 |
| BRASS POCKET WITH COOP SPRING | 903633000801 | G 1/2 B | 57 |
| COPPER POCKET WITH COOP SPRING | 903633000501 | G 1/2 B | 100 |
| BRASS POCKET WITH SCREW | 903633000813V | G 1/2 B | 50 |
| BRASS POCKET WITH SCREW | 903633000815V | G 1/2 B | 100 |
| COPPER POCKET WITH SCREW | 003633000541V | G 1/2 B | 150 |
| COPPER POCKET WITH SCREW | 003633000542V | G 1/2 B | 200 |

CLIPS AND COOPS SPRINGS, GASKETS



| MODEL | CODE |
|-------------|-------------|
| COOP SPRING | 05034016201 |
| CLIP SPRING | 05034205PTZ |
| GASKET Ø40 | 17139252048 |
| GASKET Ø50 | 17139250042 |
| GASKET Ø65 | 17139250050 |

Bimetallic Thermometers for Surface Mounting on Pipes



FIXING WITH SPRING

| TYPE | CODE | DIAMETER | CASE MATERIAL | TEMPERATURE RANGE | BOX | BOX DIMENSIONS (mm) | WEIGHT (kg) |
|----------------|------|----------|-------------------|-------------------|-----|---------------------|-------------|
| AR-TUB 63 | | Ø 63 | Zinc plated steel | 0-120° C | 300 | 300x500x250 | 18 |
| AR-TUB. RES 63 | | Ø 63 | Resin | 0-120° C | 300 | 300x500x250 | 10,5 |

Bimetallic Thermometers for Refrigeration Field

APPLICATIONS: Cooled display windows.



FIG. 540 PIL

Bimetallic table thermometer for cooled display windows.

| MODEL | CODE | FASTENER | CASE MATERIAL | BOX | BOX DIMENSIONS (mm) | WEIGHT (kg) |
|---------|--------------|----------------|--------------------------|-----|---------------------|-------------|
| 540 PIL | 100100040500 | Hook or on top | Stainless steel Aisi 430 | 250 | 650x380x240 | 7 |



FIG. 569 A

Bimetallic industrial thermometer suitable for reading the temperature of cooled display windows.

| MODEL | CODE | FASTENER | CASE MATERIAL | BOX | BOX DIMENSIONS (mm) | WEIGHT (kg) |
|-------|--------------|---------------------------|--------------------------|-----|---------------------|-------------|
| 569 A | 030500053000 | Thread screw 3/8" and nut | Stainless steel Aisi 304 | 150 | 500x300x260 | 10 |



FIG. 519 B

Bimetallic hook thermometer for cooled display windows.

| MODEL | CODE | FASTENER | CASE MATERIAL | BOX | BOX DIMENSIONS (mm) | WEIGHT (kg) |
|-------|--------------|-----------|---------------|-----|---------------------|-------------|
| 519 B | 812600040200 | With hook | White plastic | 500 | 650x380x240 | 10 |

Thermometer for Freezers

DESCRIPTION: Rectangular thermometer for freezers. Temperature range -40° +40° C. Available Fahrenheit version.



ARTHERMO FREEZER

| MODEL | CODE | BOX | BOX DIMENSIONS (mm) | WEIGHT (kg) |
|-------------------|--------------|-----|---------------------|-------------|
| ARTHERMO FREEZER* | 701200040000 | 500 | 375X360X360 | 15 |

* Products normally available at stock



ARTHERMO



Thermostats

Section 4

Boxed Thermostats "Arthermostat Line"

NEW

APPLICATIONS: Suitable for automatic adjustment of appliances in cooling and heating field.

ARTH093 - ARTH096 - ARTH097

Boxed adjustable thermostats, single pole, liquid filled sensing bulbs, SPDT contacts.



TECHNICAL SPECIFICATIONS

| | |
|-----------------------|---|
| Switching capacity | ARTH093: C-1 2,5(0,6)A 400 VAC / C-2 15(3)A 400VAC ARTH096 - ARTH097: C-1 15(3)A 400 VAC / C-2 2,5(06)A 400VAC |
| Life of product | 100000 switching cycles |
| Minimum current | 200 mA without gold contact |
| Insulation resistant | > 100 Mohm |
| Max temp. around body | T 110° C |
| Max temp. around bulb | +15% switching value |
| Dielectric strenght | AC 2000 V 1 min |
| Connection | Faston 6,3x0,8 |
| European approvals | Thermostat inside ENEC 03 |
| Degree of protection | IP40 |

| CODE | CAPILLARY | TEMPERATURE RANGE | BOX | BOX DIMENSIONS (mm) | WEIGHT (kg) |
|----------|-----------|-------------------|-----|---------------------|-------------|
| ARTH093* | 1500 mm | -35/+35° C | 96 | 600x400x270 | 18 |
| ARTH096* | 1500 mm | 0/40° C | 96 | 600x400x270 | 18 |
| ARTH097* | 1500 mm | 0/90° C | 96 | 600x400x270 | 18 |

ARTH094 - ARTH095

Boxed adjustable thermostats, single pole, liquid filled sensing bulbs, SPDT contacts.



TECHNICAL SPECIFICATIONS

| | |
|-----------------------|--|
| Switching capacity | C-1 15(3)A 400 VAC / C-2 2,5(06)A 400VAC |
| Life of product | 100000 switching cycles |
| Minimum current | 200 mA without gold contact |
| Insulation resistant | > 100 Mohm |
| Max temp. around body | T 110° C |
| Max temp. around bulb | +15% switching value |
| Dielectric strenght | AC 2000 V 1 min |
| Connection | Faston 6,3x0,8 |
| European approvals | Thermostat inside ENEC 03 |
| Degree of protection | IP40 |

| CODE | CAPILLARY | TEMPERATURE RANGE | BOX | BOX DIMENSIONS (mm) | WEIGHT (kg) |
|----------|-----------|-------------------|-----|---------------------|-------------|
| ARTH094* | - | -35/+35° C | 50 | 600x400x170 | 9 |
| ARTH095* | - | 0/40° C | 50 | 600x400x170 | 9 |

ARTH090

Boxed room temperature control , liquid filled operating, SPDT contacts.



TECHNICAL SPECIFICATIONS

| | |
|-----------------------|--|
| Switching capacity | C-1 15(3)A 400 VAC / C-2 2,5(0,6)A 400 VAC |
| Life of product | 100000 switching cycles |
| Minimum current | 200 mA without gold contact |
| Insulation resistant | > 100 Mohm |
| Max temp. Around body | T 110° C |
| Max temp. Around bulb | +15% switching value |
| Dielectric strenght | AC 2000 V 1 min |
| Connection | Faston 6,3x0,8 |
| European approvals | Thermostat inside ENEC 03 |
| Degree of protection | IP40 |

| CODE | CAPILLARY | TEMPERATURE RANGE | BOX | BOX DIMENSIONS (mm) | WEIGHT (kg) |
|----------|-----------|-------------------|-----|---------------------|-------------|
| ARTH090* | spiral | 0/40° C | 50 | 600x400x170 | 10 |

* Products normally available at stock

Boxed Thermostats "Arthermostat Line"

NEW

APPLICATIONS: Suitable for automatic adjustment of heating systems, burners and pumps.

ARTH100

Immersion thermostat liquid filled operating, SPDT contacts, with waterproof protection pocket.



TECHNICAL SPECIFICATIONS

| | |
|-----------------------|---|
| Switching capacity | C-1 15(3)A 400 VAC / C-2 2,5(0,6)A 400VAC |
| Life of product | 100000 switching cycles |
| Minimum current | 200 mA without gold contact |
| Insulation resistant | > 100 Mohm |
| Max temp. around body | T 110° C |
| Max temp. around bulb | +15% switching value |
| Dielectric strenght | AC 2000 V 1 min |
| Connection | Faston 6,3x0,8 |
| European approvals | Thermostat inside ENEC 03 |
| Degree of protection | IP40 |

| CODE | POCKET LENGTH (mm) | TEMPERATURE RANGE | BOX | BOX DIMENSIONS (mm) | WEIGHT (kg) |
|----------|--------------------|-------------------|-----|---------------------|-------------|
| ARTH100* | 100 | 0/90° C | 42 | 600x400x170 | 10 |

ARTH300

Boxed thermostats for pipes direct contact, liquid filled sensing bulb, single pole, SPDT contacts. Easy installation through heat resistant band tie.



TECHNICAL SPECIFICATIONS

| | |
|-----------------------|---|
| Switching capacity | C-1 15(3)A 400 VAC / C-2 2,5(0,6)A 400VAC |
| Life of product | 100000 switching cycles |
| Insulation resistant | > 100 Mohm |
| Max temp. around body | T 110° C |
| Degree of protection | IP40 |

| CODE | CAPILLARY | TEMPERATURE RANGE | BOX | BOX DIMENSIONS (mm) | WEIGHT (kg) |
|----------|-----------|-------------------|-----|---------------------|-------------|
| ARTH300* | - | 0/90° C | 50 | 600x400x170 | 9,5 |

ARTH201—ARTH202

Boxed safety manual reset thermostats for pipe direct contact through heat-resistant band tie (ARTH201) and for immersion with a 1/2" x 100mm waterproof protection pocket (ARTH202). Liquid filled operating, SPDT contacts.



TECHNICAL SPECIFICATIONS

| | |
|-----------------------|--------------------------------|
| Switching capacity | C-1 1A 250VAC / C-2 16A 250VAC |
| Life of product | 6000 switching cycles |
| Minimum current | 200 mA |
| Insulation resistant | > 100 Mohm |
| Max temp. Around body | T 150°C |
| Max temp. Around bulb | T 130°C |
| Dielectric strenght | AC 2000 V 1 min |
| Connection | Faston 6,3x0,8 |
| European approvals | Thermostat inside VDE |
| Degree of protection | IP40 |

| CODE | CAPILLARY | SAFETY TEMPERATURE | BOX | BOX DIMENSIONS (mm) | WEIGHT (kg) |
|----------|-----------|--------------------|-----|---------------------|-------------|
| ARTH201* | - | 100° C ± 5° C | 50 | 600x400x170 | 9,5 |

| CODE | POCKET LENGTH (mm100) | SAFETY TEMPERATURE | BOX | BOX DIMENSIONS (mm) | WEIGHT (kg) |
|----------|-----------------------|--------------------|-----|---------------------|-------------|
| ARTH202* | 100 | 100° C ± 5° C | 42 | 600x400x170 | 10 |

* Products normally available at stock

Boxed Thermostats "Arthermostat Line"

NEW

APPLICATIONS: Suitable for automatic adjustment of heating systems, burners and pumps.

ARTH400

Double boxed thermostat adjustable and safety manual reset thermostat, liquid filled operating, SPDT contacts, with waterproof protection pocket.



TECHNICAL SPECIFICATIONS Adjustable Thermostat

| | |
|-----------------------|--|
| Switching capacity | C-1 15(3)A 400 VAC / C-2 2,5(0,6)A 400 VAC |
| Life of product | 100000 switching cycles |
| Minimum current | 200 mA without gold contact |
| Insulation resistant | > 100 Mohm |
| Max temp. Around body | T 110° C |
| Max temp. Around bulb | +15% switching value |
| Dielectric strenght | AC 2000 V 1 min |
| Connection | Faston 6,3x0,8 |
| European approvals | Thermostat inside ENEC 03 |
| Degree of protection | IP40 |

TECHNICAL SPECIFICATIONS Safety Thermostat

| | |
|-----------------------|--------------------------------|
| Switching capacity | C-1 1A 250VAC / C-2 16A 250VAC |
| Life of product | 6000 switching cycles |
| Minimum current | 200 mA |
| Insulation resistant | > 100 Mohm |
| Max temp. Around body | T 150° C |
| Max temp. Around bulb | T 130° C |
| Dielectric strenght | AC 2000 V 1 min |
| Connection | Faston 6,3x0,8 |
| European approvals | Thermostat inside VDE |
| Degree of protection | IP40 |

| CODE | POCKET LENGTH MM | RANGE TEMPERATURE | SAFETY TEMPERATURE | BOX | BOX DIMENSIONS (mm) | WEIGHT (kg) |
|----------|------------------|-------------------|--------------------|-----|---------------------|-------------|
| ARTH400* | 100 | 0 / 90°C | 100° C ± 5°C | 24 | 600x400x170 | 11 |

ARTH401

Double boxed adjustable thermostat, liquid filled operating, SPDT contacts, with waterproof protection pocket.



TECHNICAL SPECIFICATIONS Adjustable Thermostat N.1 and N.2

| | |
|-----------------------|--|
| Switching capacity | C-1 15(3)A 400 VAC / C-2 2,5(0,6)A 400 VAC |
| Life of product | 100000 switching cycles |
| Minimum current | 200 mA without gold contact |
| Insulation resistant | > 100 Mohm |
| Max temp. Around body | T 110° C |
| Max temp. Around bulb | +15% switching value |
| Dielectric strenght | AC 2000 V 1 min |
| Connection | Faston 6,3x0,8 |
| European approvals | Thermostat inside ENEC 03 |
| Degree of protection | IP40 |

| CODE | POCKET LENGTH MM | RANGE TEMPERATURE | SAFETY TEMPERATURE | BOX | BOX DIMENSIONS (mm) | WEIGHT (kg) |
|----------|------------------|-------------------|--------------------|-----|---------------------|-------------|
| ARTH401* | 100 | 0 / 90°C | 0 / 90°C | 24 | 600x400x170 | 11 |

* Products normally available at stock

Classic Boxed Thermostats "TSC Line"

APPLICATIONS: Suitable for automatic adjustment of appliances in cooling field.

TSC-093C - TSC-096C - TSC-097C

Encased adjustable thermostats, single pole, liquid filled sensing bulbs, SPDT contacts.



TECHNICAL SPECIFICATIONS

| | |
|-----------------------|---|
| Switching capacity | TSC-096C - TSC-097C: C-1 15(3)A 400 VAC / C-2 2,5(0,6)A 400VAC TSC-093C: C-1 2,5(0,6)A 400 VAC / C-2 15(3)A 400VAC |
| Life of product | 100000 switching cycles |
| Minimum current | 200 mA without gold contact |
| Insulation resistant | > 100 Mohm |
| Max temp. around body | T 110° C |
| Max temp. around bulb | +15% switching value |
| Dielectric strenght | AC 2000 V 1 min |
| Connection | Faston 6,3x0,8 |
| European approvals | Thermostat inside ENEC 03 |
| Degree of protection | IP44 |

| CODE | CAPILLARY | TEMPERATURE RANGE | BOX | BOX DIMENSIONS (mm) | WEIGHT (kg) |
|----------|-----------|-------------------|-----|---------------------|-------------|
| TSC-093C | 1500 mm | -35/+35 ° C | 96 | 660x400x250 | 18 |
| TSC-096C | 1500 mm | 0/40 ° C | 96 | 660x400x250 | 18 |
| TSC-097C | 1500 mm | 0/90 ° C | 96 | 660x400x250 | 18 |

TSC-094C - TSC-095C

Encased adjustable thermostats, single pole, liquid filled sensing bulbs, SPDT contacts.



TECHNICAL SPECIFICATIONS

| | |
|-----------------------|---|
| Switching capacity | C-1 15(3)A 400 VAC / C-2 2,5(0,6)A 400VAC |
| Life of product | 100000 switching cycles |
| Minimum current | 200 mA without gold contact |
| Insulation resistant | > 100 Mohm |
| Max temp. around body | T 110° C |
| Max temp. around bulb | +15% switching value |
| Dielectric strenght | AC 2000 V 1 min |
| Connection | Faston 6,3x0,8 |
| European approvals | Thermostat inside ENEC 03 |
| Degree of protection | IP44 |

| CODE | CAPILLARY | TEMPERATURE RANGE | BOX | BOX DIMENSIONS (mm) | WEIGHT (kg) |
|----------|-----------|-------------------|-----|---------------------|-------------|
| TSC-094C | - | -35/+35 ° C | 50 | 660x400x250 | 9 |
| TSC-095C | - | 0/40 ° C | 50 | 660x400x250 | 9 |

Capillary Thermostats

APPLICATIONS: Automatic adjustment in refrigeration equipments and cold appliances.



Accessories Included



TECHNICAL SPECIFICATIONS

| | |
|-----------------------|---|
| Switching capacity | C-1 15(3)A 400 VAC / C-2 2,5(0,6)A 400VAC |
| Life of product | 100000 switching cycles |
| Minimum current | 200 mA without gold contact |
| Insulation resistant | > 100 Mohm |
| Max temp. around body | T 110° C |
| Max temp. around bulb | +15% switching value |
| Dielectric strenght | AC 2000 V 1 min |
| Connection | Faston 6,3x0,8 |
| European approvals | Thermostat inside ENEC 03 |

| CODE | CAPILLARY | TEMPERATURE RANGE | BOX | BOX DIMENSIONS (mm) | WEIGHT (kg) |
|--------------|-------------------------|-------------------|-----|---------------------|-------------|
| C705503001B* | 1500 mm | -35+35°C | 100 | 420x370x200 | 12 |
| C702512311N* | 1500 mm copper | 0/40°C | 100 | 420x370x200 | 12 |
| C700502112N* | 1500 mm copper | 0/90°C | 100 | 420x370x200 | 12 |
| C702003235N* | 1500 mm copper | 30/120°C | 100 | 420x370x200 | 12 |
| C704253470N* | 1500 mm stainless steel | 0/220°C | 100 | 420x370x200 | 12 |
| C713202530N* | 1500 mm stainless steel | 50/315°C | 100 | 420x370x200 | 12 |

* Products normally available at stock

ARTHERMO



Digital Instruments

Section 5

Digital Instruments

CHARACTERISTICS: Digital thermometers with high accuracy for the refrigeration and heating fields.

DIGITAL CONTROLLERS

Packaging: 1 box = N° 80 pcs, size 650x380x240 mm, weight 23 kg.



TECHNICAL SPECIFICATIONS

| | |
|-------------------|-------------------------|
| Panel size | 75x34,5 mm |
| Installing size | 71x29 mm |
| Product size | 75x34,5x85 mm |
| Power supply | 220 VAC ± 10%, 50/60 Hz |
| Power consumption | <5W |
| Accuracy | ± 1° C |

| MODEL | MEASURING/REGULATION | REG. OUTPUT | DEFROSTING CYCLE | DEFROSTING Time | INPUT |
|--------|----------------------|-----------------------------------|------------------|-----------------|----------------------|
| CO3 | -50/+120°C | 1SPDT, 16A/240VAC | | | SONDA NTC 2000 mm |
| CO3D | -50/+120°C | 1SPDT,16A/240VAC;1SPDT 10A | 0/99 ORE (REG) | 0/99 MIN (REG) | SONDA NTC 2000 mm |
| CO3D2 | -50/+99°C | 2SPDT 10A/240VAC | 0/99 ORE (REG) | 0/99 MIN (REG) | 2 SOND E NTC 2000 mm |
| CO3DFA | -45/+50°C | 3 E UN SCR | 0/99 ORE (REG) | 0/99 MIN (REG) | 3 SOND E NTC 2000 mm |
| CO3H | -40/+150°C | 10A/250VAC | | | SONDA PTC 2000 mm |
| NDC200 | -45/+99°C | 30ASPDT (COMPR); 3ASPST (ALLARME) | 0/999 ORE (REG) | | SONDA NTC |

DIGITAL THERMOMETER ROF-DIG*

Packaging: 1 box = N° 100 pcs, size 320x260x270 mm, weight 8 kg.



TECHNICAL SPECIFICATIONS

| | |
|---------------------|---------------------------------|
| Panel size | 64x31 mm |
| Installing size | 58,4x25,7 mm |
| Temperature range | -30/+110° C |
| Ambient temperature | -10/+60° C |
| Relative humidity | 20% +85% |
| Power supply | 230 VAC ±10% 50-60Hz |
| Power consumption | Max 3 W |
| Resolution | 0,1° C (<100° C) 1° C (>100° C) |
| Probe | NTC mm 2000 |

DIGITAL THERMOMETER 24W*

Packaging: 1 box = N° 80 pcs, size 320x260x270 mm, weight 7 kg, back battery.



TECHNICAL SPECIFICATIONS

| | |
|-------------------|-----------------|
| Case material | White plastic |
| Fastener | Clips |
| Temperature range | -40/+70° C |
| Feed | Lithium battery |
| Battery duration | About 1 year |
| Probe | NTC mm 3000 |

On request: front battery

On request: adapter

* Products normally available at stock

DIGITAL THERMOMETER SOLARCELLAR SD-5

Packaging: 1 box = N° 100 pcs, size 320x260x270 mm, weight 7 kg.



TECHNICAL SPECIFICATIONS

| | |
|-------------------|--|
| Temperature range | -50/+99° C |
| Sampling time | 10 seconds |
| Sensor cable | 1500 mm |
| Power | Solar panel |
| Environment | A): illumination level >60 lux, humidity 5-85% B): illumination level >40 lux, humidity 5-85% |

DIGITAL THERMOMETER PT-1

Packaging: 1 box = N° 100 pcs, size 650x380x240 mm, weight 6 kg.



TECHNICAL SPECIFICATIONS

| | |
|-------------------|--------------------------|
| Temperature range | -50/+300° C; -58/572° F |
| Resolution | 0,1° C (-19,9/+199,9° C) |
| Probe dimension | 125 mm |

DIGITAL THERMOMETER PT-2

Packaging: 1 box = N° 100 pcs, size 650x380x240 mm, weight 6 kg.



TECHNICAL SPECIFICATIONS

| | |
|-------------------|--------------------------|
| Temperature range | -50/+300° C; -58/572° F |
| Resolution | 0,1° C (-19,9/+199,9° C) |
| Dimension | 59x107x19 mm |

DIGITAL THERMOMETER PT-6

Packaging: 1 box = N° 100 pcs, size 320x260x270 mm, weight 7 kg.



TECHNICAL SPECIFICATIONS

| | |
|-------------------|-------------------------------------|
| Case material | Blue or black plastic |
| Temperature range | -50/+300° C; -58/572° F |
| Accuracy | ± 1° C (2° F) between -20° C +80° C |
| Function | Memory, hold, °C/°F |
| Battery power | DC 1,5V (alkaline battery) |
| Probe size | Stainless steel 125 mm Ø 4 mm |

DIGITAL THERMOMETER TPM-20

Packaging: 1 box = N° 100 pcs, size 320x260x270 mm, weight 7 kg.



TECHNICAL SPECIFICATIONS

| | |
|-------------------|-----------------------------------|
| Temperature range | -50/+70° C |
| Resolution | ± 1° C (> -20° C) 1° C (< -20° C) |
| Accuracy | ± 1° C |
| Power | DC 1,5V AAA batteries |
| Product size | 72x32x28 mm |
| Installing size | 52x25 mm |

DIGITAL CONTROL PANEL FD-B

Packaging: 1 box = N° 100 pcs, size 650x380x240 mm, weight 6 kg.

**TECHNICAL SPECIFICATIONS**

| | |
|-------------------|------------------|
| Temperature range | -50/+99° C |
| Resolution | 1° C |
| Power supply | 230 VAC 50/60 Hz |
| Dimension | 170x60x40 mm |
| Probe | NTC 1500 mm |

TEMPERATURE RECORDER DR-400**TECHNICAL SPECIFICATIONS**

| | |
|-------------------|---|
| Temperature range | NTC -40/+120° C PT1000 -200/+650° C |
| Display | LCD, two line backlist adjustable |
| Power | 12÷24 VDC or 85÷265 VAC (optional) |
| Accuracy | NTC $\pm 0,5^{\circ}$ C PT 1000 $\pm 0,3^{\circ}$ C |
| Memory capacity | Max 13000 points IP65 Waterproof |

New Products Coming Soon

ARTHERMO

Heating and Sanitary

Section 6

Manometers

CHARACTERISTICS: Manometers with resin case, radial or back attachment, suitable in the thermosanitary sector.

MANOMETER



TECHNICAL SPECIFICATIONS

| | |
|----------------------|---|
| Case | ABS |
| Window | Plastic with red pointer |
| Attachment | Radial or back in brass |
| Accuracy class | 1,6 |
| Degree of protection | IP 31 |
| Weldings | Tin alloy for temperatures from -20 to +90° C |
| Movement | In brass |
| Dial | White with black writing "ARTHERMO" branded |

| CODE | DIAMETER (mm) | ATTACHMENT | PRESSURE RANGE | BOX | BOX DIMENSIONS (mm) | WEIGHT (kg) |
|---------|---------------|--------------|----------------|-----|---------------------|-------------|
| MA500/P | 50 | G1/4" RADIAL | 0/4 BAR | 120 | 490X240X210 | 9 |
| MA501/P | 50 | G1/4" RADIAL | 0/6 BAR | 120 | 490X240X210 | 9 |
| MA502/P | 50 | G1/4" RADIAL | 0/10 BAR | 120 | 490X240X210 | 9 |
| MA503/P | 50 | G1/4" RADIAL | 0/16 BAR | 120 | 490X240X210 | 9 |
| MA504/P | 50 | G1/4" RADIAL | 0/25 BAR | 120 | 490X240X210 | 9 |
| MA550/P | 50 | G1/4" BACK | 0/4 BAR | 125 | 490X240X210 | 11 |
| MA551/P | 50 | G1/4" BACK | 0/6 BAR | 125 | 490X240X210 | 11 |
| MA552/P | 50 | G1/4" BACK | 0/10 BAR | 125 | 490X240X210 | 11 |
| MA553/P | 50 | G1/4" BACK | 0/16 BAR | 125 | 490X240X210 | 11 |
| MA554/P | 50 | G1/4" BACK | 0/25 BAR | 125 | 490X240X210 | 11 |
| MA001/P | 63 | G1/4" RADIAL | 0/4 BAR | 100 | 490X240X210 | 9,5 |
| MA002/P | 63 | G1/4" RADIAL | 0/6 BAR | 100 | 490X240X210 | 9,5 |
| MA003/P | 63 | G1/4" RADIAL | 0/10 BAR | 100 | 490X240X210 | 9,5 |
| MA004/P | 63 | G1/4" RADIAL | 0/16 BAR | 100 | 490X240X210 | 9,5 |
| MA005/P | 63 | G1/4" RADIAL | 0/25 BAR | 100 | 490X240X210 | 9,5 |
| MA200/P | 63 | G1/4" BACK | 0/4 BAR | 80 | 490X240X210 | 9,5 |
| MA201/P | 63 | G1/4" BACK | 0/6 BAR | 80 | 490X240X210 | 9,5 |
| MA202/P | 63 | G1/4" BACK | 0/10 BAR | 80 | 490X240X210 | 9,5 |
| MA203/P | 63 | G1/4" BACK | 0/16 BAR | 80 | 490X240X210 | 9,5 |
| MA204/P | 63 | G1/4" BACK | 0/25 BAR | 80 | 490X240X210 | 9,5 |
| MA050/P | 80 | G3/8" RADIAL | 0/4 BAR | 50 | 490X240X210 | 9,5 |
| MA051/P | 80 | G3/8" RADIAL | 0/6 BAR | 50 | 490X240X210 | 9,5 |
| MA052/P | 80 | G3/8" RADIAL | 0/10 BAR | 50 | 490X240X210 | 9,5 |
| MA053/P | 80 | G3/8" RADIAL | 0/16 BAR | 50 | 490X240X210 | 9,5 |
| MA054/P | 80 | G3/8" RADIAL | 0/25 BAR | 50 | 490X240X210 | 9,5 |
| MA100/P | 100 | G1/2" RADIAL | 0/4 BAR | 30 | 490X240X210 | 8,5 |
| MA101/P | 100 | G1/2" RADIAL | 0/6 BAR | 30 | 490X240X210 | 8,5 |
| MA102/P | 100 | G1/2" RADIAL | 0/10 BAR | 30 | 490X240X210 | 8,5 |
| MA103/P | 100 | G1/2" RADIAL | 0/16 BAR | 30 | 490X240X210 | 8,5 |
| MA104/P | 100 | G1/2" RADIAL | 0/25 BAR | 30 | 490X240X210 | 8,5 |

Thermometers with Pocket

APPLICATIONS: Heating, floor heating, boilers and electrical appliances.

TECHNICAL SPECIFICATIONS

| | |
|----------------------|---|
| Design | UNI EN 13190 |
| Temperature limits | Ambient: -20/+60° C - Storage: -20/+60° C |
| Accuracy class | 2 |
| Degree of protection | IP41 per EN 60 529/IEC 529 |

FIG. 596

Bimetallic, zinc plated steel case, back stem. 1/2" pocket included.

FIG. 536

Radial thermometer with zinc plated steel or resin case. 1/2" pocket included. Working through liquid expansion.



MATERIALS (FIG. 569)

| | |
|---------------------|--------------------------|
| Case | Zinc plated steel |
| Window | Clear resin/glass |
| Dial | Aluminium |
| Pointer | Resin/aluminium |
| Stem | Zinc plated steel Ø 9 mm |
| Temperature element | Bimetallic spiral |
| Pocket | Brass, screw included |

MATERIALS (FIG. 536)

| | |
|---------------------|----------------------------------|
| Case | Black zinc plated steel or resin |
| Window | Clear resin/glass |
| Dial | Aluminium |
| Pointer | Aluminium |
| Stem | Brass Ø 6 mm |
| Temperature element | Liquid expansion |
| Pocket | Brass |

| TYPE | CODE | STEM (mm) | TEMPERATURE RANGE | BOX | BOX DIMENSIONS (mm) | WEIGHT (kg) |
|------------------|---------------|-----------|-------------------|-----|---------------------|-------------|
| AR-T/B 50 | 03012791990G | 50 | 0-120° C | 120 | 600x400x200 | 10,8 |
| AR-T/B 50 | 03015171990G | 100 | 0-120° C | 70 | 600x400x200 | 7,5 |
| AR-T/B 65 | 04012791990G | 50 | 0-120° C | 120 | 600x400x200 | 10,8 |
| AR-T/B 65 | 04015171990G | 100 | 0-120° C | 70 | 600x400x200 | 7,5 |
| AR-T/B 80 | 05012792000G | 50 | 0-120° C | 120 | 600x400x200 | 15,2 |
| AR-T/B 80 | 05015172000G | 100 | 0-120° C | 50 | 600x400x200 | 9 |
| AR-T/B 100 | 06012791980G | 50 | 0-120° C | 60 | 600x400x200 | 12 |
| AR-T/B 100 | 06015171980G | 100 | 0-120° C | 30 | 600x400x200 | 7,5 |
| AR-T/RAD 60 | 110127519502G | 50 | 0-120° C | 40 | 600x400x200 | 9 |
| AR-T/RAD 60 | 110151019502G | 100 | 0-120° C | 40 | 600x400x200 | 9,5 |
| AR-T/RAD 80 | 113727519502G | 50 | 0-120° C | 20 | 600x400x200 | 7,5 |
| AR-T/RAD 80 | 113751019502G | 100 | 0-120° C | 20 | 600x400x200 | 8 |
| AR-T/RAD 100 | 116427519502G | 50 | 0-120° C | 20 | 600x400x200 | 8,5 |
| AR-T/RAD 100 | 116451019502G | 100 | 0-120° C | 20 | 600x400x200 | 9,5 |
| AR-T/RAD.RES 60 | 111026119502 | 50 | 0-120° C | 40 | 600x400x200 | 8 |
| AR-T/RAD.RES 60 | 111049519502 | 100 | 0-120° C | 40 | 600x400x200 | 8,5 |
| AR-T/RAD.RES 80 | 114026119502 | 50 | 0-120° C | 20 | 600x400x200 | 6,5 |
| AR-T/RAD.RES 80 | 114049519502 | 100 | 0-120° C | 20 | 600x400x200 | 7 |
| AR-T/RAD.RES 100 | 116026119502 | 50 | 0-120° C | 20 | 600x400x200 | 7,5 |
| AR-T/RAD.RES 100 | 116049519502 | 100 | 0-120° C | 20 | 600x400x200 | 8,5 |

Heating Elements

CHARACTERISTICS RT

Heating element in Ø8 CU tube
 1"1/4 gas brass cap
 Sealing with epoxy resins
 Repressed bend for a more homogeneous magnesium oxide density
 Standard: 230V

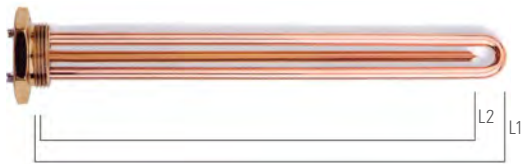

RT SERIES

| CODE RT | POWER | L1 | L2 |
|------------|--------|-------|--------|
| RT011A | 1200 W | 300mm | 280 mm |
| RT012A | 1500 W | 300mm | 280 mm |
| RT013A-400 | 2000 W | 400mm | 280 mm |

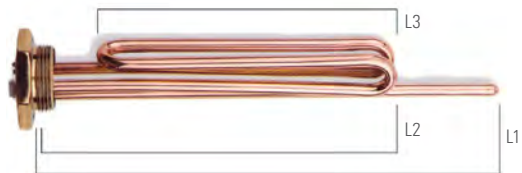

RT - BENT SERIES

| CODE RT | POWER | L1 | L2 | L3 |
|------------|--------|--------|--------|--------|
| RT140A | 1200 W | 280 mm | 170 mm | 135 mm |
| RT145A | 1500 W | 280 mm | 170 mm | 135 mm |
| RT150A-400 | 2000 W | 280 mm | 220 mm | 180 mm |

CHARACTERISTICS RF

Heating element in Ø8 CU tube
 Ø 48 brass flange
 Sealing with epoxy resins
 Repressed bend for a more homogeneous magnesium oxide density
 Standard: 230V

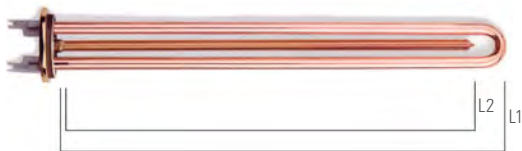

RF SERIES

| CODE RF | POWER | L1 | L2 |
|--------------------|--------|--------|--------|
| RF011A | 1200 W | 300 mm | 280 mm |
| RF012A | 1500 W | 300 mm | 280 mm |
| RF013A | 2000 W | 400 mm | 280 mm |
| RF014A high faston | 1200 W | 300 mm | 280 mm |

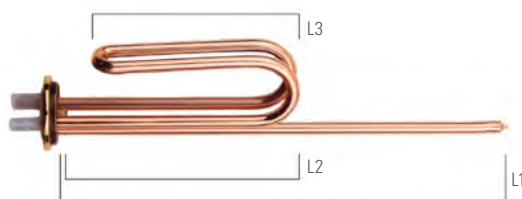

RF - BENT SERIES

| CODE RF | POWER | L1 | L2 | L3 |
|--------------------|--------|--------|--------|--------|
| RF111A | 1200 W | 280 mm | 175 mm | 135 mm |
| RF112A | 1500 W | 280 mm | 175 mm | 135 mm |
| RF113A-400 | 2000 W | 280 mm | 215 mm | 185 mm |
| RF116A high faston | 1200 W | 280 mm | 175 mm | 135 mm |

Special versions of heating elements are available on request.
 Minimum quantity: 1000 Pcs.

Adjustable Thermostats

TS 030



CHARACTERISTICS

| | |
|-------------------|------------|
| Temperature range | 20 - 80° C |
| Electric rating | 20A - 250V |
| Sensing element | Rigid stem |
| Standard stem | 275 mm |

TS 150

With bipolar safety.



On request:



CHARACTERISTICS

| | |
|----------------------------|------------|
| Temperature range | 20 - 80° C |
| Bipolar safety calibration | 90° C |
| Electric rating | 20A - 250V |
| Sensing element | Rigid stem |
| Standard stem | 275 mm |

Resistor Gaskets

| | |
|--------|-----------|
| GF 100 | RF gasket |
| GT 002 | O ring |

Neon Signals



LA 200

Safety Valves

STANDARD REGULATION: 8 bar (other regulations on request).



VA 090

1/2" MF.



VA 130

1/2" MF with lever.

Thermometers

CHARACTERISTICS: Bimetallic industrial thermometer, designed for reading the temperature of electric boilers.

FIG. 599



599.1 blue

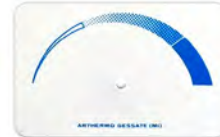

599.1 red

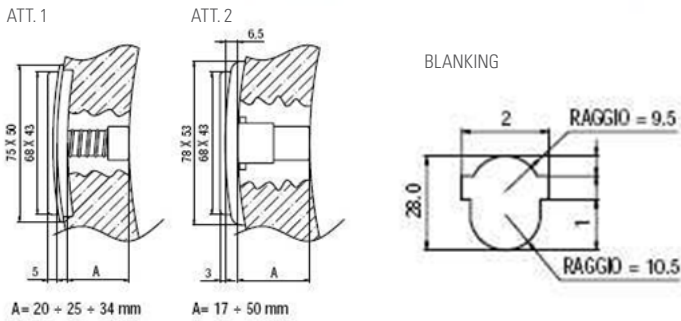

FIG. 600



600.1 blue



600.4 grey



600.2 red



600.5 white

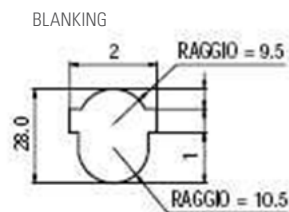
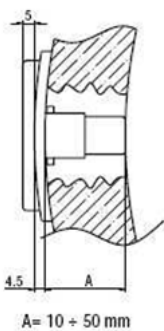

600.3 black



On request: customized dial minimum quantity: 5000 Pcs.

ARTHERMO

ARTHERMO Srl
Via Italia 32
20060 Gessate (Mi) Italy
Tel. +39 02 95781144
Fax +39 02 95382362
info@arthermo.com
www.arthermo.com

The data and the characteristics indicated in this catalogue are not binding.
Arthermo reserves the right to make changes in above specifications without obligation of notice.

X-ON Electronics

Largest Supplier of Electrical and Electronic Components

Click to view similar products for [Thermostats](#) category:

Click to view products by [Arthermo](#) manufacturer:

Other Similar products are found below :

[66F060-0099](#) [66F060-0396](#) [66L085-0477](#) [67F080-0356](#) [67L060-0368](#) [67L080-0038](#) [77877-00](#) [ASP200-22](#) [22636-00](#) [2450 00210626](#) [2450 00880010](#) [2450RC 79080002](#) [2455R--01000844](#) [2455R 80580176](#) [2455R 81610172](#) [2455R--90820376](#) [2455RA-94170955](#) [2455RC-00980620](#) [2455RCG81170352](#) [2455RM03090005](#) [2455RM 80820736](#) [2455RM-90980499](#) [2455RP-91000430](#) [2455RP-91000433](#) [2455RP-91000436](#) [2455RP-91000442](#) [300004530001](#) [300100140436](#) [300100630004](#) [3001 00830006](#) [2450G 83950014](#) [2450RC-90820307](#) [2455R--00030829](#) [2455R--01000140](#) [2455R 80820813](#) [2455R 80820815](#) [2455R 86890009](#) [2455R--99130436](#) [2455RA-04170929](#) [2455RBV00290011](#) [2455RC-01000545](#) [2455RM 80820767](#) [300000460015](#) [300005510124](#) [300100240048](#) [310000011390](#) [310000030602](#) [310000031798](#) [310000560067](#) [310000010552](#)