

## Tpower Φ4.8 Straw Series



### Characters

- Viewing angle 140 deg

### Directive Characteristics

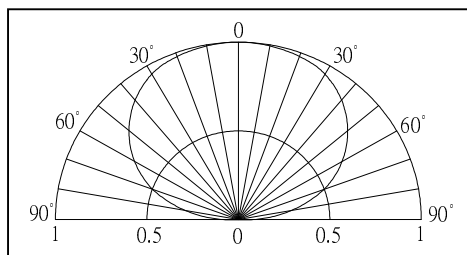

Relative Luminous Intensity

### Package Outlines

(Unit : mm)

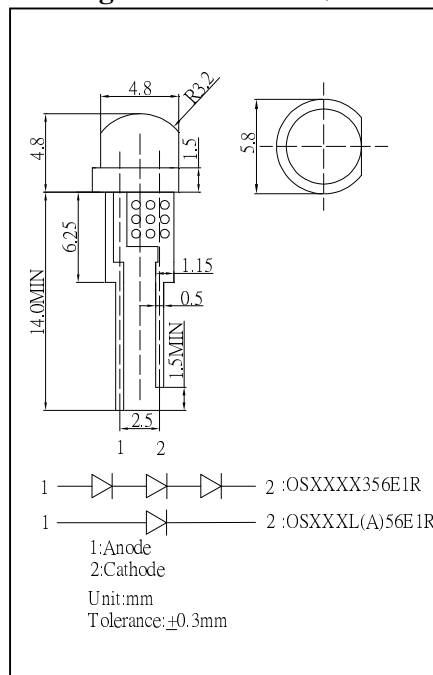

### Absolute Maximum Rating (Ta=25°C)

Item	Symbol	Value				Unit
		W/M/K/B/G	R/Y/O			
Power Series	P	0.2	0.3	0.2	0.3	W
DC Forward Current	IF	25	120	30	120	mA
Pulse Forward Current	IFP	100*1	200*1	120*1	200*1	mA
Reverse Voltage	VR	5	5	5	5	V
Power Dissipation	PD	270	480	216	360	mW
Operating Temperature	Topr	-30~+85		-30~+85		°C
Storage Temperature	Tstg	-40~+100		-40~+100		°C

\*1 Duty 1/10 Pulse Width 10 ms

### Electrical And Optical Characteristics (Ta=25°C)

Power	Part Number*2	Emitting Color	Lens Type	Forward Voltage VF(V)		Chromaticity coordinates*4				Luminous Intensity (mcd)*3		Reverse Current IR(uA)
				Typ.	Max.	X		Y		Typ.	Max.	
						Min.	Max.	Min.	Max.			
0.2W	OSW5S356E1R	Pure White	Water Clear	9.3	10.8	0.23	0.31	0.24	0.32	3800	5500	<10
	OSM5S356E1R	Warm White	Water Clear	9.3	10.8	0.41	0.49	0.37	0.45	2300	3500	<10
	OSK5S356E1R	Pink	Water Clear	9.3	10.8	0.41	0.49	0.13	0.17	750	1500	<10
0.3W	OSW5XL56E1R	Warm White	Water Clear	3.3	4.0	0.23	0.31	0.24	0.32	5500	10000	<10
	OSM5XL56E1R	Pure White	Water Clear	3.3	4.0	0.41	0.49	0.37	0.45	3300	5000	<10
	OSK5XL56E1R	Pink	Water Clear	3.3	4.0	0.41	0.49	0.13	0.17	1000	2000	<10

### Electrical And Optical Characteristics (Ta=25°C)

Power	Part Number*2	Emitting Color	Lens Type	Forward Voltage VF(V)		Dominant Wavelength wd(nm)*5		Luminous Intensity (mcd)*3		Reverse Current IR(uA)
				Typ.	Max.	Typ.	Max.	Typ.	Max.	
0.2W	OSB5S356E1R	Blue	Water Clear	9.3	10.8	470	475	1200	3000	<10
	OSG3D356E1R	Cyan	Water Clear	9.3	10.8	500	510	3800	5500	<10
	OSG5D356E1R	Pure Green	Water Clear	9.3	10.8	525	535	3800	5500	<10
	OSR5M356E1R	Red	Water Clear	6.3	7.2	624	629	2700	4500	<10
	OSY5M356E1R	Yellow	Water Clear	6.3	7.2	590	595	2700	4500	<10
	OSO5M356E1R	Orange	Water Clear	6.3	7.2	610	610	2700	4500	<10
0.3W	OSB5XL56E1R	Blue	Water Clear	3.3	4.0	470	475	2000	4000	<10
	OSG3XA56E1R	Cyan	Water Clear	3.3	4.0	500	510	5500	10000	<10
	OSG5XA56E1R	Pure Green	Water Clear	3.3	4.0	525	535	5500	10000	<10
	OSY5XA56E1R	Amber	Water Clear	2.5	3.0	590	600	4000	6000	<10
	OSR5XA56E1R	Red	Water Clear	2.5	3.0	624	629	4000	6000	<10

\*2 See table for Luminous Intensity Ranks

\*3 Axial Direction (Luminous Intensity)

\*4 Please refer to CIE 1931 chromaticity diagram

\*5 Devices are sorted by 5nm wavelength ranges

## X-ON Electronics

Largest Supplier of Electrical and Electronic Components

*Click to view similar products for [Standard LEDs - Through Hole category](#):*

*Click to view products by [Optosupply manufacturer](#):*

Other Similar products are found below :

[LTL-10254W](#) [LTL-1214A](#) [LTL-1BEDJ](#) [LTL-2231AT](#) [LTL-3251A](#) [LTL-4262N](#) [LTL-5234](#) [LTL87HTBK](#) [LTL-87HD4B](#) [7383/V7C3-BSTA-L/PR3/MS](#) [G22041431007J2C000](#) [HLMP-AG64-X10ZZ](#) [HLMP-EG1A-Z10DV](#) [HLMP-EL3B-WXKDD](#) [HLMP-HB74-UVBDD](#) [HLMP-HG65-VY0DD](#) [HLMP-HM74-34CDD](#) [HLMP-HM75-34CDD](#) [1L0532V23G0TD001](#) [NSPW500CS](#) [C4SMA-BGF-CQ34Q3C2](#) [L53GC13](#) [264-7SURTS530-A3](#) [L-C150JRCT](#) [S4SMS-BJF-CQ42QGF2](#) [S4SMS-GJF-CW12QMF2](#) [LD CQDP-1U3U-W5-1-K](#) [LNX998CKBDA](#) [LO566UHR3-70G-A3](#) [SLA560WBD2PT3](#) [LP379PPG1C0G0300001](#) [SLR-322MCT32](#) [SLR-342DUT32](#) [SLR-342MC3F](#) [SLR343BC7TT32](#) [SLR343BCTT32](#) [SLX-LX3044GD](#) [SLX-LX3044ID](#) [SLX-LX3044YD](#) [SNW-LX504SRC/4](#) [1.90690.3330000](#) [SSL-LX20483ID](#) [SSL-LX3034YD](#) [SSL-LX5093LGT-11](#) [SSL-LX5093PGC](#) [SSL-LX5093SRC/F](#) [SSL-LX5093SYT](#) [SSL-LX5099SRSGC-CA](#) [SSL-LX509E3SIT](#) [SSL-LX509FT3ID](#)