

■ **Features**

- 0.2 Inch ten Digit Display
- Long lifetime operation
- IC compatible
- Low power dissipation

■ **Applications**

- Indicating device
- Overflow indication

■ **Absolute Maximum Rating** (Ta=25°C)



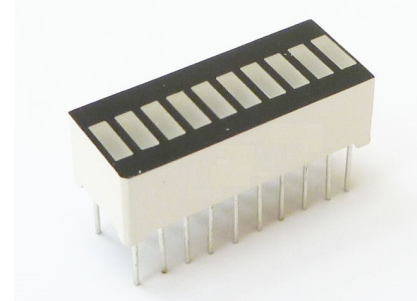

■ **Photo**



Item	Symbol	Value		Unit
		R/G/Y	B/P	
DC Forward Current	I _F	25	25	mA
Pulse Forward Current*	I _{FP}	100	100	mA
Reverse Voltage	V _R	5	5	V
Power Dissipation	P _t	62.5	72	mW
Operating Temperature	Topr	-30 ~ +70		°C
Storage Temperature	Tstg	-40~ +85		°C
Lead Soldering Temperature(1.6mm from seating plane)	Tsol	260°C/5sec		°C

*Pulse width Max.10ms Duty ratio max 1/10

■ **Electrical -Optical Characteristics** (Ta=25°C)

Part Number	Color			V _F (V)			I _R (μA)	I _v (mcd)			λD (nm)		
				Min.	Typ.	Max.	Max.	Min.	Typ.	Max.	Min.	Typ.	Max.
				I _F =20mA			V _R =5V	I _F =20mA					
OSX10201-XXXX	Blue	B		-	3.3	3.6	20	-	50	-	-	465	-
	Pure Green	P		-	3.1	3.6	20	-	262	-	-	512	-
	Yellow Green	G		-	2.1	2.5	20	-	35	-	-	570	-
	Yellow	Y		-	2.1	2.5	20	-	35	-	-	587	-
	Red	R		-	2.1	2.5	20	-	35	-	-	632	-

*1 Tolerance of measurements of dominant wavelength is +1nm

*2 Tolerance of measurements of luminous intensity is +15%

*3 Tolerance of measurements of forward voltage is ±0.1V

*4 Tolerance of measurements of chromaticity coordinate is +10%

Package Dimensions and Pin Function

OSX10201-XXXX

Part NO	Color	A/B/C/D	E/F/G	H/I/J
OSX10201-RGB1		Red	Yellow green	Blue
OSX10201-RGY1		Red	Yellow green	Yellow
OSX10201-RPB1		Red	Pure green	Blue
OSX10201-YGR1		Yellow	Yellow green	Red
OSX10201-RGG1		Red	Yellow green	Yellow green
OSX10201-GGR1		Yellow green	Yellow green	Red
Part NO	Color	A/B/C/D/E	F/G/H	I/J
OSX10201-GYR1		Yellow green	Yellow	Red

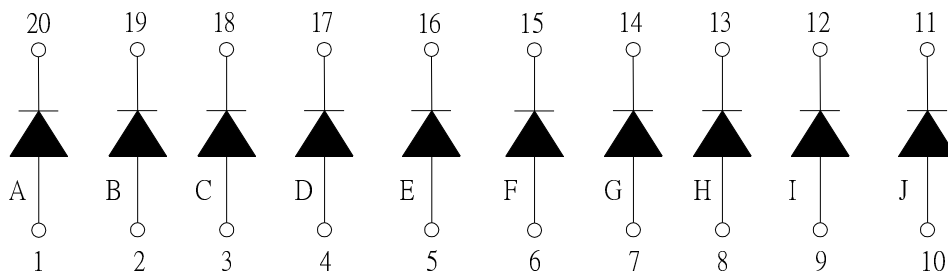
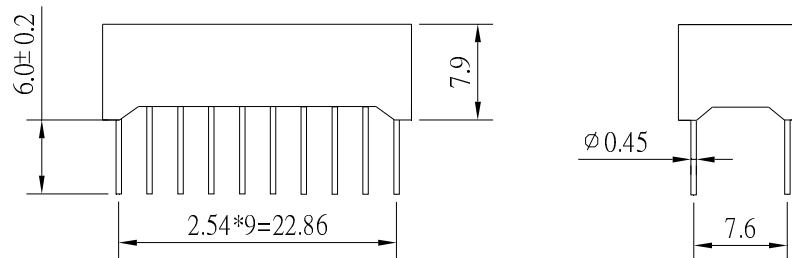
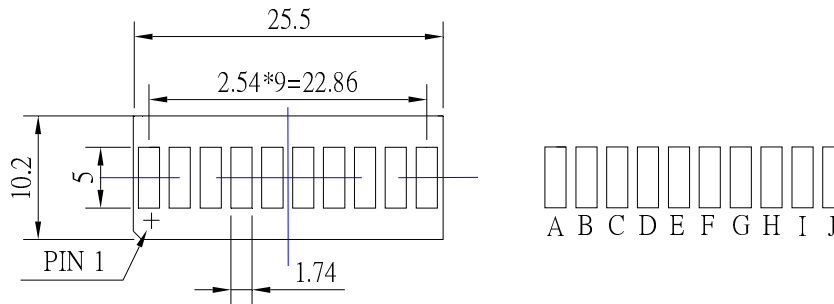

Note:

1, Unit : mm(Tolerance:±0.25mm unless otherwise noted)

2, The slope angle of any PIN may be±5.0°Max

X-ON Electronics

Largest Supplier of Electrical and Electronic Components

Click to view similar products for [LED Displays & Accessories](#) category:

Click to view products by [Optosupply](#) manufacturer:

Other Similar products are found below :

[LTC-2721WC](#) [LTC-4624JD](#) [LTC-4627G](#) [LTC-4627WC](#) [LTD-5021AWC](#) [LTM-8522G](#) [LTP-4323P](#) [LTP-747G](#) [LTS-3361JG-06](#)
[F416SYGWA/S530-E3](#) [EADST040RA2](#) [1668](#) [HT-F196NB-5323](#) [IPD2131-27](#) [SA03-12EWA](#) [LDD-E2802RD](#) [LDD-E306MI](#) [LDQ-N514RI](#)
[LDS-A3506RD](#) [LDS-A3926RI](#) [LDT-M516RI](#) [SC03-12HDB](#) [SI-B9T151550WW](#) [SI-B9V171550WW](#) [SLC-3PF-WL](#) [1624](#) [LTC-2621JD](#)
[LTC-2623WC](#) [LTC-4624P](#) [LTC-4627JD](#) [LTD-2601E](#) [LTD-322G](#) [LTD-482PC](#) [LTP-1457AKR](#) [LTP-3784G-01](#) [LTS-313AP](#) [LTS-4812SKR-](#)
[P](#) [LTS-547AE](#) [LTS-6780P](#) [446010401-3](#) [HV-7W30-6829](#) [CA12240_MINNIE-WWW-MTG-ASSY](#) [DA43-11GWA](#) [LDD-A516RI-17](#) [LDD-](#)
[E305RI](#) [LDQ-M513RI](#) [LDQ-M5204RI-SI](#) [LDQ-N3402RI](#) [LDQ-N3606RI](#) [LDT-M2804RI](#)