

Fig 1.

Fig 2.

REV.	MODIFICATION.	DATE	DRN
01	NEW DRAWING	30/05/06	NJB
02	CO2010295	23/07/08	SF
03	CO2010851	19/11/09	TC
04	CO2010863	14/12/09	TC
05	CO2010942	17/06/10	SF
06	CO2011023	18/11/10	SF
07	CO2011173	27/07/11	SF
08	CO2011181	01/08/11	SF
09	CO2011253	13/04/12	SF
10	CO2011288	04/10/12	SF

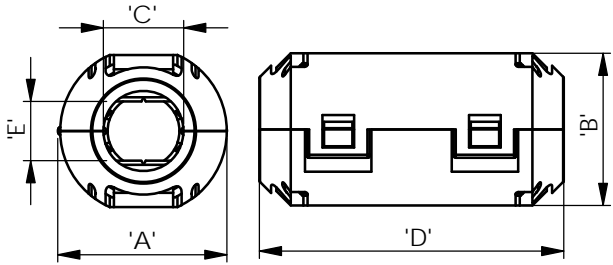

Fig 3.

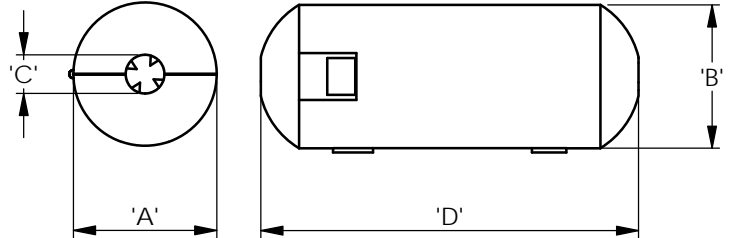

Fig 4.

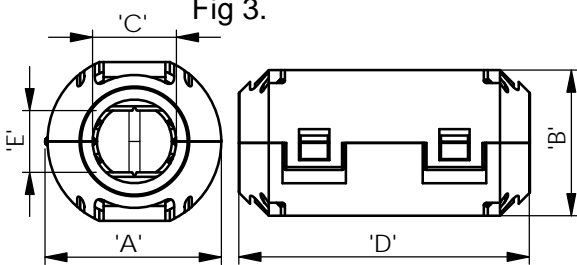

Fig 5.

NOTE:

1. IMPEDENCE VALUES FOR ONE TURN ONLY.

FERRITE MATERIAL: K5B RMS-303 - CASING MATERIAL: BLACK NYLON 6/6 RMS-244

PART NUMBER	A	B	C	D	E	APPLICABLE CABLE (MAX)	FIG
RRC-10-5-20-M	13.00±1.00	12.00±1.00	5.00±1.00	25.50±1.00	2.40±0.50	3.5	3
RRC-12-7-15-M	14.00±1.00	15.50±1.00	7.00±1.00	18.00±1.00	22.00±1.00	7	2
RRC-13-7-23-M	17.00±1.00	15.00±1.00		30.00±1.00	3.00±1.00	4	3
RRC-14-7-28-M	20.00±1.00	20.00±1.00	8.50±1.00	39.00±1.00	-	7	4
RRC-16-8-13-M	19.50±1.00	23.00±1.00	8.00±1.00	17.00±1.00	23.00±1.00	8	1
RRC-16-8-16-M	19.20±1.00	23.40±1.00	8.20±1.00	20.00±1.00	26.10±1.00		2
RRC-16-8-28-M	19.50±1.00	20.00±1.00	9.50±1.00	31.00±1.00	35.00±1.00	9	3
RRC-16-9-28-M1				36.00±1.00	6.50±1.00		11
RRC-16-9-28-M2	20.00±1.00	18.00±1.00	11.00±1.00	31.50±1.00	36.00±1.00	11	2
RRC-17-11-28-M	20.50±1.00	20.50±1.00	11.00±1.00	31.50±1.00	36.00±1.00	11	2
RRC-20-5-30-M	23.00±1.00	22.00±1.00	5.00±1.00	36.00±1.00	10.00±1.00	4*1.5	5
RRC-20-13-30-M			13.50±1.00			12	3
RRC-20-10-10-M	24.50±1.00	28.50±1.00	10.20±1.00	13.50±1.00	20.00±1.00	10	1
RRC-24-11-14-M	28.00±1.00	31.50±1.00	11.50±1.00	18.00±1.00	24.00±1.00	11.5	
RRC-25-15-12-M	29.00±1.00	33.00±1.00	15.00±1.00	15.50±1.00	21.50±1.00	15	
RRC-26-13-30-M	30.75±1.00	31.00±1.00	13.00±1.00	34.00±1.00	39.00±1.00	13	2

**RICHCO, INC.**  
WWW.RICHCO-INC.COM

ALL DIMENSIONS IN mm  
GENERAL TOLERANCES ±0.25  
UNLESS OTHERWISE STATED  
1 DECIMAL PLACE ±  
2 DECIMAL PLACES ±  
ANGULAR ±1°

MATERIAL:  
See table

COLOUR:  
See table

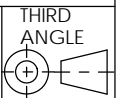

DESCRIPTION:  
**RRC SPLIT FERRITE CORES WITH PLASTIC CASING**

SHEET SIZE  
A4

DRG No:  
05-126

NPR No:

PART No:  
See Table

MASS:(g)

DRN  
SF

DATE  
17/06/10

CHKD  
TC

DATE  
17/06/10

SCALE  
NTS

SHEET No.  
1 OF 3

INFORMATION CONTAINED IN THIS DOCUMENT IS CONFIDENTIAL TO RICHCO INTERNATIONAL Co. Ltd. AND MAY NOT BE DISCLOSED OR REPRODUCED IN WHOLE OR PART WITHOUT THEIR WRITTEN CONSENT.

REV.	MODIFICATION.	DATE	DRN
01	NEW DRAWING	30/05/06	NJB
02	CO2010295	23/07/08	SF
03	CO2010851	19/11/09	TC
04	CO2010863	14/12/09	TC
05	CO2010942	17/06/10	SF
06	CO2011023	18/11/10	SF
07	CO2011173	27/07/11	SF
08	CO2011181	01/08/11	SF
09	CO2011253	13/04/12	SF
10	CO2011288	04/10/12	SF

NOTE:

1. IMPEDENCE VALUES FOR ONE TURN ONLY.

RRC-10-5-20-M

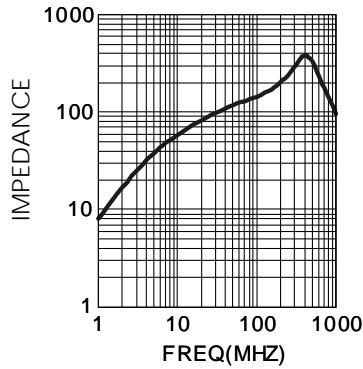

RRC-12-7-15-M

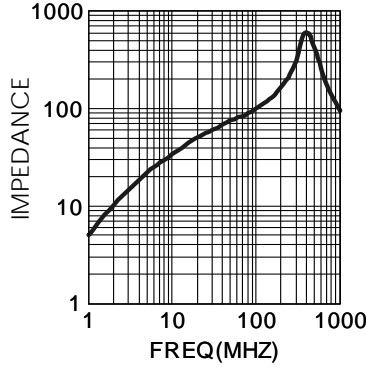

RRC-13-7-23-M

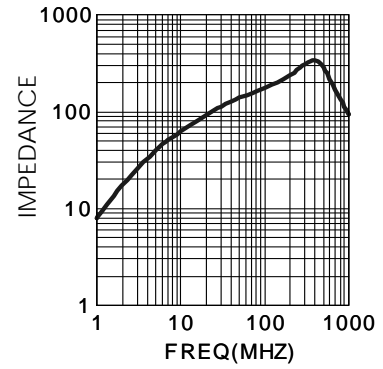

RRC-14-7-28-M

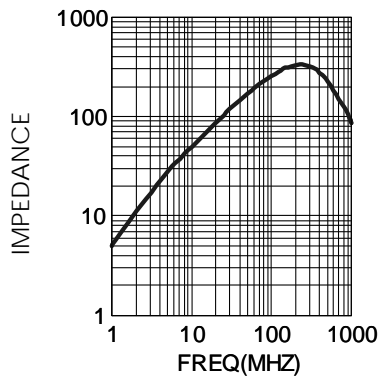

RRC-16-8-13-M

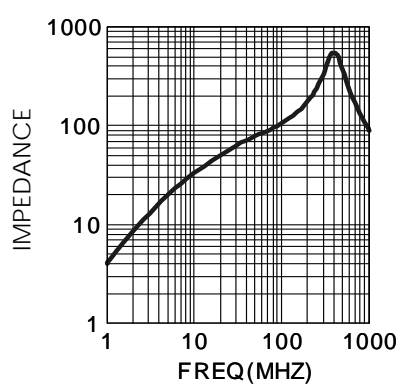

RRC-16-8-16-M

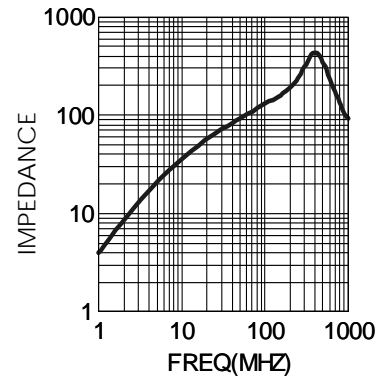

RRC-16-8-16-M

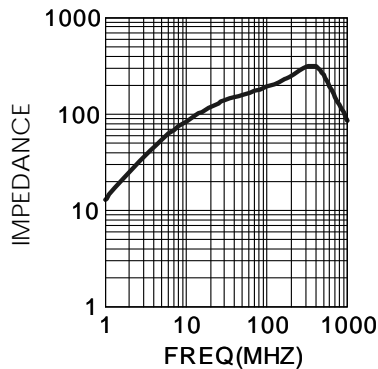

RRC-16-8-28-M

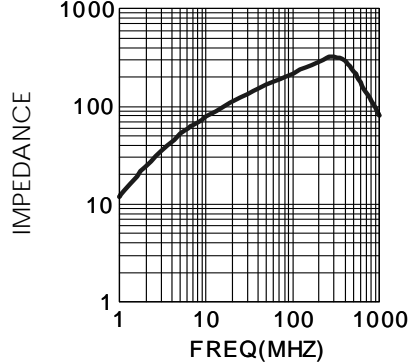

RRC-16-9-28-M1

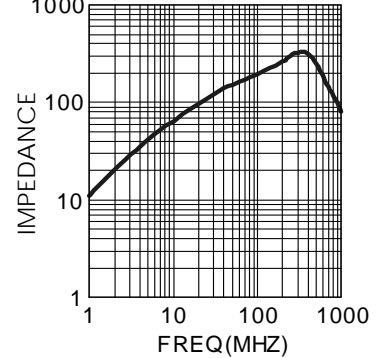

**RICHCO, INC.**  
WWW.RICHCO-INC.COM

ALL DIMENSIONS IN mm  
GENERAL TOLERANCES  $\pm 0.25$   
UNLESS OTHERWISE STATED  
1 DECIMAL PLACE  $\pm$   
2 DECIMAL PLACES  $\pm$   
ANGULAR  $\pm 1^\circ$

MATERIAL:

See table on sheet 1

COLOUR:

See table on sheet 1

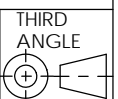

DESCRIPTION:

RRC SPLIT FERRITE CORES WITH PLASTIC CASING

SHEET SIZE  
**A4**

DRG No:  
05-126

NPR No:

PART No:  
See table on sheet 1

MASS:(g)

DRN  
SF

DATE  
17/06/10

CHKD  
TC

DATE  
17/06/10

SCALE  
NTS

SHEET No.  
2 OF 3

INFORMATION CONTAINED IN THIS DOCUMENT IS CONFIDENTIAL TO RICHCO INTERNATIONAL Co. Ltd. AND MAY NOT BE DISCLOSED OR REPRODUCED IN WHOLE OR PART WITHOUT THEIR WRITTEN CONSENT.

NOTE:

1. IMPEDENCE VALUES FOR ONE TURN ONLY.

REV.	MODIFICATION.	DATE	DRN
01	NEW DRAWING	30/05/06	NJB
02	CO2010295	23/07/08	SF
03	CO2010851	19/11/09	TC
04	CO2010863	14/12/09	TC
05	CO2010942	17/06/10	SF
06	CO2011023	18/11/10	SF
07	CO2011173	27/07/11	SF
08	CO2011181	01/08/11	SF
09	CO2011253	13/04/12	SF
10	CO2011288	04/10/12	SF

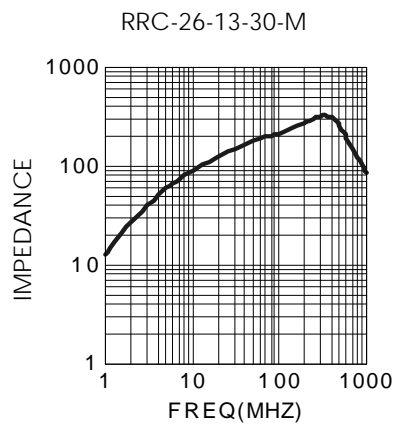
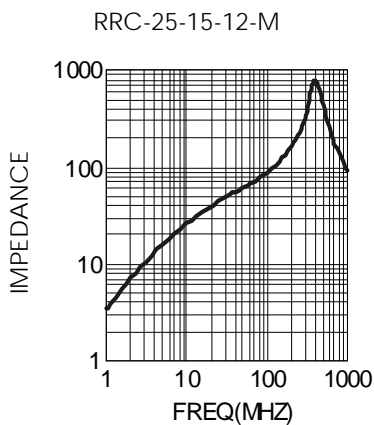
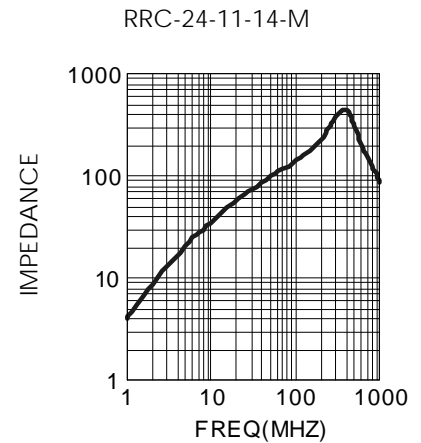
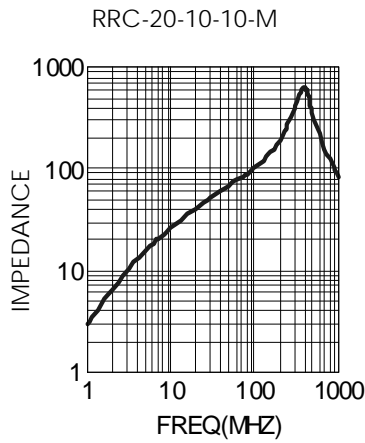
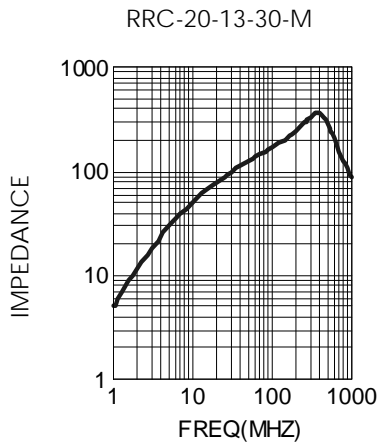
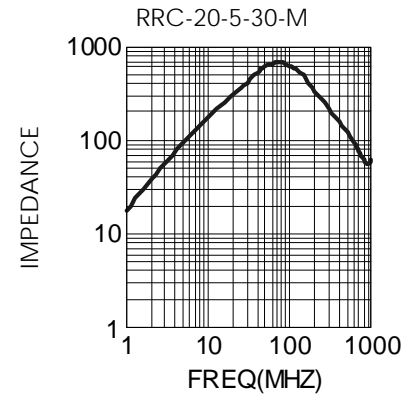
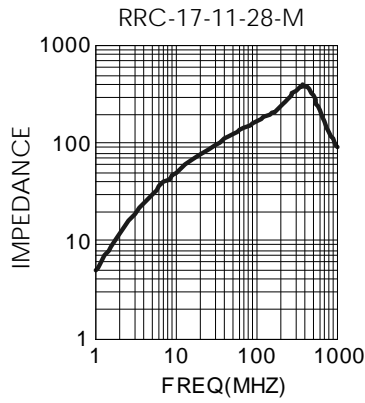
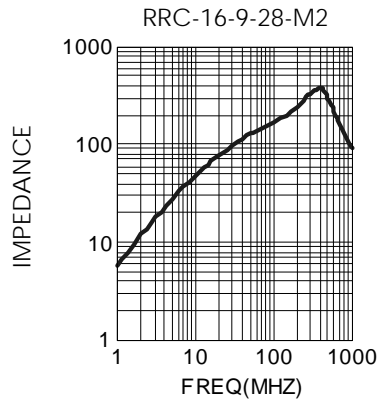

**RICHCO, INC.**  
WWW.RICHCO-INC.COM

ALL DIMENSIONS IN mm  
GENERAL TOLERANCES  $\pm 0.25$   
UNLESS OTHERWISE STATED  
1 DECIMAL PLACE  $\pm$   
2 DECIMAL PLACES  $\pm$   
ANGULAR  $\pm 1^\circ$

MATERIAL:

See table on sheet 1

COLOUR:

See table on sheet 1

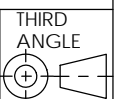

DESCRIPTION:

RRC SPLIT FERRITE CORES WITH PLASTIC CASING

SHEET SIZE

A4

DRG No:

05-126

NPR No:

PART No:

See table on sheet 1

MASS:(g)

DRN  
SF

DATE  
17/06/10

CHKD  
TC

DATE  
17/06/10

SCALE  
NTS

SHEET No.  
3 OF 3

INFORMATION CONTAINED IN THIS DOCUMENT IS CONFIDENTIAL TO RICHCO INTERNATIONAL Co. Ltd. AND MAY NOT BE DISCLOSED OR REPRODUCED IN WHOLE OR PART WITHOUT THEIR WRITTEN CONSENT.

## X-ON Electronics

Largest Supplier of Electrical and Electronic Components

*Click to view similar products for [Ferrite Cable Cores](#) category:*

*Click to view products by [Richco](#) manufacturer:*

Other Similar products are found below :

[2643626102](#) [FX28R0984-0](#) [FX28R0984-2](#) [AB 3X2X3SM](#) [2643164251](#) [2643665709](#) [2661626402](#) [LB 2.8X4.5U](#) [28R1127](#) [28R1260](#)  
[28R1575](#) [SM28R0760](#) [SM28R1531](#) [2631006302](#) [2643165451](#) [2643178351](#) [28R0760](#) [MS 21X14X4.5 W](#) [SM28B1101](#) [SS7X4X3W](#) [4327](#)  
[030 16141](#) [ASSE017-2](#) [2643103102](#) [2643164151](#) [2943666671](#) [4327 030 12611](#) [2643163851](#) [AB4X2X6SM](#) [432703013631](#) [LB4X2X8U](#)  
[28B1101](#) [28B0785](#) [SM28R1575](#) [SM28R1260](#) [74270051](#) [2643625902](#) [74278032](#) [2643480009](#) [2673069901](#) [HFB123049-300](#) [HFB143064-](#)  
[100](#) [HFB143064-300](#) [HFB170070-000](#) [ETD29/16/10-3C94](#) [ETD29-3F3](#) [ETD39-3C94](#) [RFP1-20-10-A5](#) [RFP1-40-28-M-A5](#) [RFP2-10-10-A5](#)  
[RFP2-25-12-A5](#)