

FERRITE MATERIAL: K5B(RMS-303)									
PART NUMBER	A	B	C	IMPEDANCE (Ω)		STANDARD PACK			
				25MHz	100MHz				
RT-30-10-20	3.00	2.00	1.00	20	42	4000			
RT-30-12-20			1.20	17	38				
RT-35-8-25		3.00	1	25	52				
RT-35-8-30			0.80	31	53				
RT-35-10-30			1.00	29	50				
RT-35-12-30			1.20	25	45				
RT-35-13-30		3.25	1.30	26	47				
RT-35-13-33				27	48				
RT-35-14-30		3.50	3.00	1.40	22		4000		
RT-35-14-33				26	49				
RT-35-15-15				1.54	1.50			15	36
RT-35-15-30				3.00	1.50			21	42
RT-35-15-33				3.30	1.50			21	43
RT-35-17-30				3.00	1.70			17	38
RT-35-18-13				1.30	1.80			11	31
RT-35-18-30				3.00				18	37
RT-39-23-25	3.94	2.54	2.29	15	36				
RT-40-15-20	4.00	2.00	1.50	19	39				
RT-40-15-30		3.00		23	45				
RT-40-20-15		1.50	2.00	13	35				
RT-40-20-20		2.00		14	37				
RT-40-20-30		3.00		20	41				
RT-40-22-17		1.70		2.20	12	31			
RT-41-16-40	4.10	4.00	1.60	31	55	2000			
RT-43-28-25	4.30	2.50	2.80	13	35	4000			
RT-44-28-14	4.40	1.40		12	32	5000			
RT-45-25-32	4.50	3.20	2.50	18	37	4000			
RT-50-20-20	5.00	2.00	2.00	17	37	2000			
RT-50-20-40		4.00		30	46				
RT-50-23-30		3.00		2.30	19		39		
RT-60-30-15		1.50		3.00	10		31		
RT-60-30-20	2.00	15	35						
RT-60-30-30	3.00	21	40						
RT-60-30-38	3.80	22	43						
RT-60-30-40	4.00	24	44						
RT-60-30-55	5.50	31	51						
RT-65-43-60	6.50	6.00	4.30	21	42	1000			
RT-70-35-40	7.00	4.00	3.50	23	46				
RT-70-35-60	6.00	34		59					
RT-73-33-43	7.30	4.30	3.30	27	50				
RT-75-24-40	7.50	4.00	2.40	32	62				
RT-76-52-62	7.60	6.20	5.20	21	40				
RT-79-40-70	7.90	7.00	4.00	33	57	500			
RT-80-31-40	8.00	4.00	3.10	33	52	1000			
RT-80-40-30		3.00	17	37					
RT-80-40-40		4.00	4.00	23	46				
RT-80-40-60		6.00	33	57	500				
RT-80-60-50		5.00	6.00	15		36			

FERRITE MATERIAL K5B(RMS-303)						
PART NUMBER	A	B	C	IMPEDANCE (Ω)		STANDARD PACK
				25MHz	100MHz	
RT-80-60-70	8.00	7.00	6.00	20	42	500
RT-85-50-30	8.50	3.00	5.00	16	34	1000
RT-90-50-30	9.00			37		
RT-90-50-80		8.00		38	64	500
RT-93-45-64	9.30	6.35	4.50	32	50	
RT-94-63-72	9.40	7.20	6.30	22	42	1000
RT-95-46-46		4.57	4.60	27	47	500
RT-95-48-33		3.30	4.80	22	45	1000
RT-95-50-48	9.50	4.80	5.00	26	47	500
RT-95-50-50		5.00		26	49	
RT-100-30-60		6.00		3.00	50	
RT-100-50-50		5.00	5.00	34	73	1000
RT-100-60-30		3.00		15	37	
RT-100-60-40		4.00		20	42	
RT-100-60-50		5.00	6.00	22	41	
RT-100-60-62	10.00	6.20		25	49	
RT-100-60-80		8.00		33	60	
RT-100-70-50		5.00		17	39	500
RT-100-70-70		7.00	7.00	22	44	500
RT-100-70-75		7.50		25	46	
RT-103-58-102	10.30	10.20	5.80	40	67	
RT-110-50-90	11.00	9.00	5.00	60	107	
RT-120-60-40		4.00		24	48	500
RT-120-60-60		6.00	6.00	34	58	
RT-120-60-80	12.00	8.00		46	77	
RT-120-70-55		5.50	7.00	26	49	
RT-120-70-60		6.00		28	48	
RT-125-80-64		6.35	8.00	24	46	200
RT-125-80-120	12.50	12.00		36	58	
RT-127-79-64	12.70	6.35	7.90	26	68	500
RT-130-70-30		3.00		17	39	300
RT-130-70-55		5.50	7.00	27	50	
RT-130-70-60	13.00	6.00		28	51	
RT-130-70-70		7.00		32	56	
RT-130-71-127		12.70	7.10	60	106	200
RT-140-80-50		5.00	8.00	26	50	500
RT-140-80-70	14.00	7.00		28	50	
RT-140-90-50		5.00	9.00	19	37	
RT-142-64-102		10.16	6.35	57	95	200
RT-142-64-135	14.20	13.50		75	125	
RT-142-80-120		12.00	8.00	49	76	
RT-145-102-80	14.50	8.00	10.20	29	69	
RT-150-105-120	15.00	12.00	10.50	37	62	
RT-159-79-143	15.88	14.27	7.87	79	121	100
RT-160-80-120		12.00	8.00	59	95	200
RT-160-90-120	16.00	12.00	9.00	55	87	200
RT-160-100-70		7.00	10.00	32	71	300

REV.	MODIFICATION.	DATE	DRN
01	NEW DRAWING	19/06/06	NJB
02	CO2010196	24/04/08	SF
03	CO2010845	20/10/09	OW
04	CO2010989	01/10/10	SF
05	CO2011049	26/01/11	SF
06	CO2011144	17/05/11	SF
07	CO2011253	16/04/12	SF
08	CO2011277	31/07/12	SF

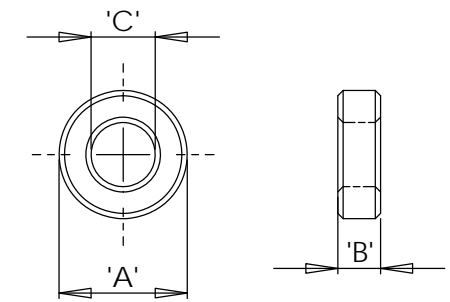
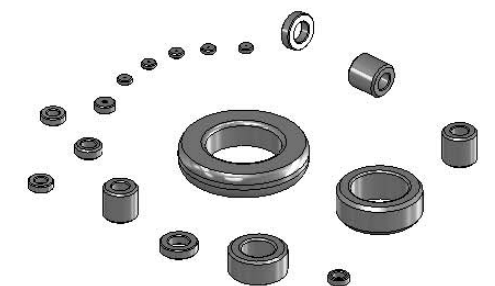

- NOTES.**
- 1) See drawings 06-073 sheets 3 of 12 to 12 for Impedance graphs.
 - 2) Impedance figures are typical values.
 - 3) Other sizes available by special order.
 - 4) Packaging information is only a guide & subject to variation.

INFORMATION CONTAINED IN THIS DOCUMENT IS CONFIDENTIAL TO RICHCO INTERNATIONAL Co. Ltd. AND MAY NOT BE DISCLOSED OR REPRODUCED IN WHOLE OR PART WITHOUT THEIR WRITTEN CONSENT.

RICHCO, INC.
WWW.RICHCO-INC.COM

ALL DIMENSIONS IN MM
GENERAL TOLERANCES ±0.25
UNLESS OTHERWISE STATED
1 DECIMAL PLACE ±
2 DECIMAL PLACES ±
ANGULAR ±1°

THIRD ANGLE

MATERIAL: See Table COLOUR:

DESCRIPTION: RT Toroid Cores. PART No: See Table

DRG No: 06-073 NPR No: Mass:(g) SHEET SIZE A3

DRN NJB DATE 19/06/06 CHKD AS DATE 19/06/06 SCALE NTS SHEET No. 1 OF 12

FERRITE MATERIAL: K5B(RMS-303)						
PART NUMBER	A	B	IMPEDANCE (Ω)		STANDARD PACK	
			25MHz	100MHz		
RT-160-100-80	16.00	8.00	29	55	200	
RT-160-100-100		10.00	43	85	150	
RT-160-120-80		8.00	12.00	26	48	200
RT-160-120-150	15.00	33		58		
RT-165-82-130	16.50	13.00	70	125	120	
RT-165-82-160		16.00	83	140		
RT-165-92-75		7.50	9.2	35	70	200
RT-175-80-100	17.50	10.00	8.00	62	94	98
RT-175-95-50		5.00	10.00	22	44	200
RT-175-95-64		6.00	9.50	31	53	
RT-175-95-70		7.00		30	54	
RT-175-95-110		11.00		55	96	
RT-175-95-127		13.00		59	95	100
RT-175-95-135		14.00	63	115		
RT-175-95-150	15.00	70	113	112		
RT-175-107-80	18.00	8.00	10.70	33	60	200
RT-180-100-60		6.00	31	55		
RT-180-100-100		10.00	10.00	47	77	
RT-180-100-150	18.67	15.00	69	123	100	
RT-187-102-143		14.27	70	119		
RT-187-102-170		17.02	75	125		
RT-190-100-100	19.00	10.00	10.00	54	102	200
RT-190-120-80		8.00	12.00	32	72	
RT-190-120-100		10.00	37	78	100	
RT-200-100-50	20.00	5.00	10.00	28	68	140
RT-200-100-80		8.00	38	62	100	
RT-200-100-100		10.00	50	82		
RT-200-120-100	20.50	10.00	12.00	40	68	84
RT-205-102-100		10.20	53	86	80	
RT-212-127-60		21.20	6.00	12.70	27	52
RT-220-135-64	22.00	6.35	13.50	28	53	
RT-220-135-80		8.00	37	78	100	
RT-220-140-65		7.00	14.00	28	68	84
RT-220-140-80	8.00	33		73	100	
RT-220-140-100	10.00	42		90	84	
RT-220-140-120	12.00	40		85		
RT-221-137-127	22.10	12.70	13.72	48	83	100
RT-225-138-64	22.50	6.40	13.80	25	47	200
RT-225-138-127		12.70	46	71	50	
RT-230-135-64	23.00	6.35	13.50	28	53	200
RT-236-114-140	23.60	14.00	11.40	80	133	60
RT-236-150-60		6.00	26	70	72	
RT-236-150-114		11.00	15.00	43	85	100
RT-250-150-80	8.00	38		79		
RT-250-150-100	10.00	44		87	50	
RT-250-150-120	12.00	53		97	60	
RT-250-150-150	15.00	61	105			
RT-254-127-64	25.40	6.35	12.70	39	80	100
RT-259-128-213	25.91	21.30	12.80	106	174	40
RT-260-130-127	26.00	12.70	13.00	74	125	50

FERRITE MATERIAL: K5B(RMS-303)						
PART NUMBER	B	A	C	IMPEDANCE (Ω)		STANDARD PACK
				25MHz	100MHz	
RT-280-160-75	28.00	7.50	16.00	33	59	100
RT-280-160-130		13.00		55	100	
RT-280-160-170		17.00		71	120	
RT-280-160-200	29.00	20.00	19.00	85	155	40
RT-290-190-75		7.50		26	70	100
RT-290-190-77		7.70		33	76	50
RT-290-190-138	31.00	13.80	25.00	46	94	40
RT-310-190-70		7.00		35	77	
RT-310-190-80		8.00		30	55	
RT-310-190-160	16.00	68	115	32		
RT-310-190-222	22.00	88	146			
RT-360-250-70	36.00	7.00	27.40	23	63	36
RT-360-250-127		13.00		39	84	24
RT-406-274-150	40.60	15.00	27.40	55	106	18
RT-594-348-128	59.40	12.80	34.80	58	118	10

REV.	MODIFICATION.	DATE	DRN
01	NEW DRAWING	19/06/06	NJB
02	CO2010196	24/04/08	SF
03	CO2010845	20/10/09	OW
04	CO2010989	01/10/10	SF
05	CO2011049	26/01/11	SF
06	CO2011144	17/05/11	SF
07	CO2011253	16/04/12	SF
08	CO2011277	31/07/12	SF

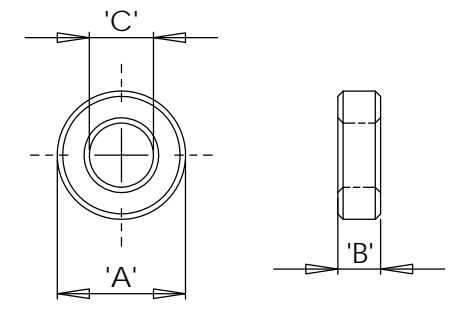

- NOTES.
- 1) See drawings 06-073 sheets 3 of 12 to 12 for Impedance graphs.
 - 2) Impedance figures are typical values.
 - 3) Other sizes available by special order.
 - 4) Packaging information is only a guide & subject to variation.

INFORMATION CONTAINED IN THIS DOCUMENT IS CONFIDENTIAL TO RICHCO INTERNATIONAL Co. Ltd. AND MAY NOT BE DISCLOSED OR REPRODUCED IN WHOLE OR PART WITHOUT THEIR WRITTEN CONSENT.

RICHCO, INC.
WWW.RICHCO-INC.COM

ALL DIMENSIONS IN MM
GENERAL TOLERANCES ±0.25
UNLESS OTHERWISE STATED
1 DECIMAL PLACE ±
2 DECIMAL PLACES ±
ANGULAR ±1°

THIRD ANGLE

MATERIAL: See Table COLOUR:

DESCRIPTION: RT Toroid Cores. PART No: See Table

DRG No: 06-073 NPR No: Mass:(g) SHEET SIZE A3

DRN DATE CHKD DATE SCALE SHEET No.
NJB 19/06/06 AS 19/06/06 NTS 2 OF 12

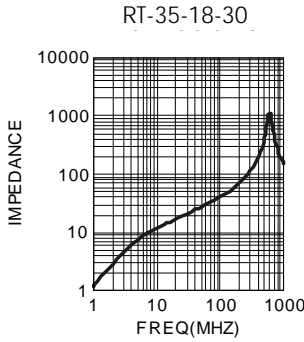
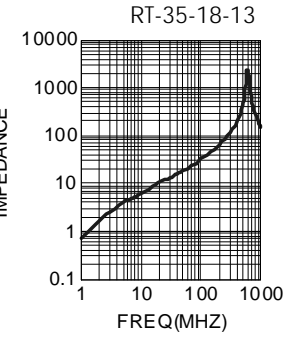
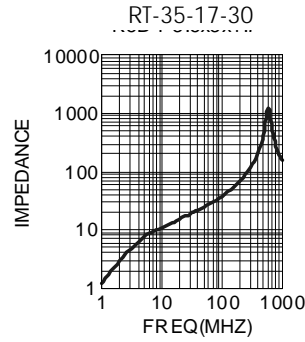
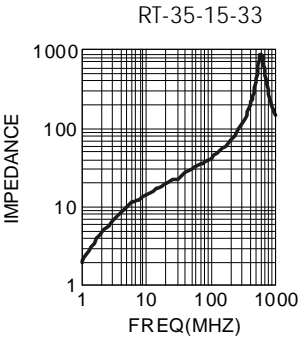
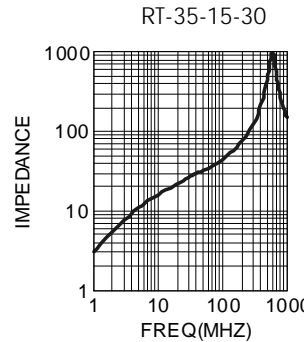
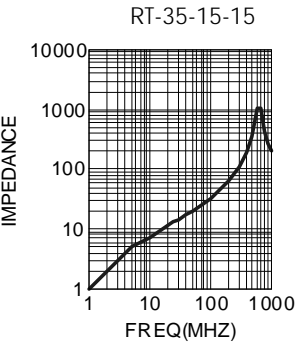
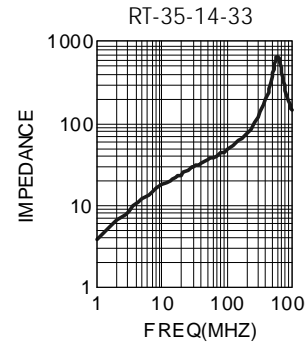
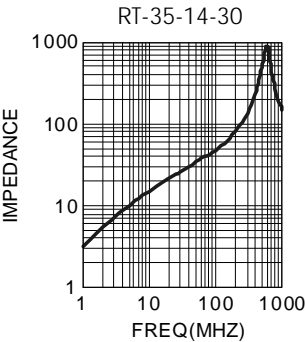
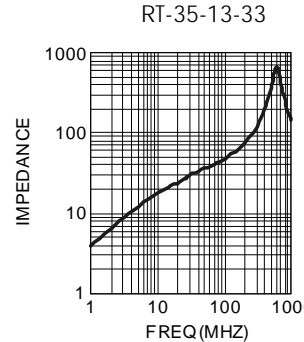
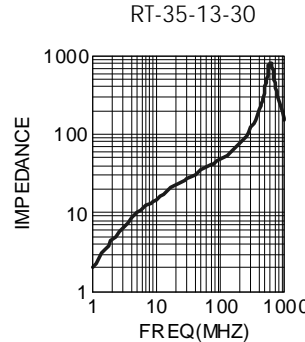
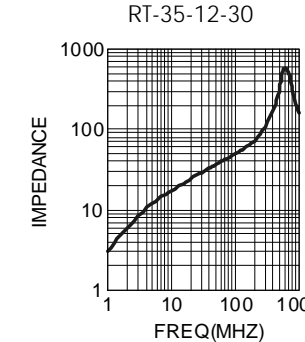
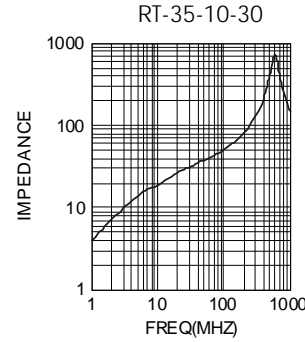
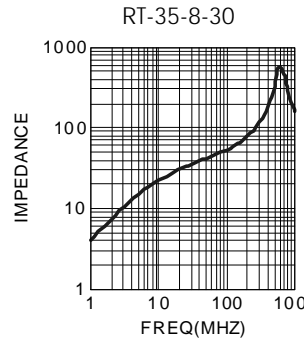
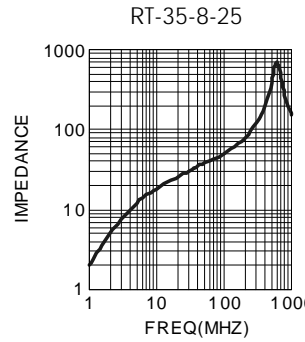
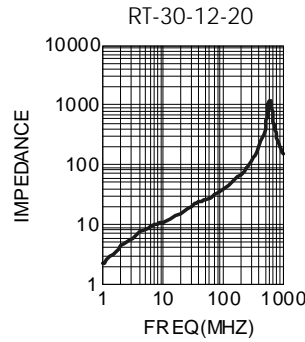
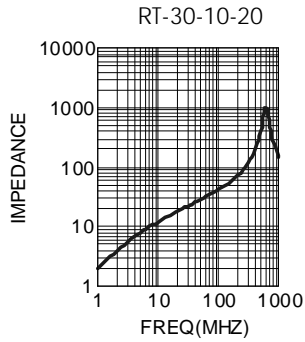

REV.	MODIFICATION.	DATE	DRN
01	NEW DRAWING	19/06/06	NJB
02	CO2010196	24/04/08	SF
03	CO2010845	20/10/09	OW
04	CO2010989	01/10/10	SF
05	CO2011049	26/01/11	SF
06	CO2011144	17/05/11	SF
07	CO2011253	16/04/12	SF
08	CO2011277	31/07/12	SF

NOTES.
1) Impedance figures are typical values.

INFORMATION CONTAINED IN THIS DOCUMENT IS CONFIDENTIAL TO RICHCO INTERNATIONAL Co. Ltd. AND MAY NOT BE DISCLOSED OR REPRODUCED IN WHOLE OR PART WITHOUT THEIR WRITTEN CONSENT.

RICHCO, INC.
WWW.RICHCO-INC.COM

DESCRIPTION:

RT Toroid Cores, Impedance Graphs.

DRG No.

06-073

SHEET SIZE

A3

DRN

NJB

DATE

30/05/06

CHKD

AS

DATE

30/05/06

SCALE

NTS

SHEET No.

3 OF 12

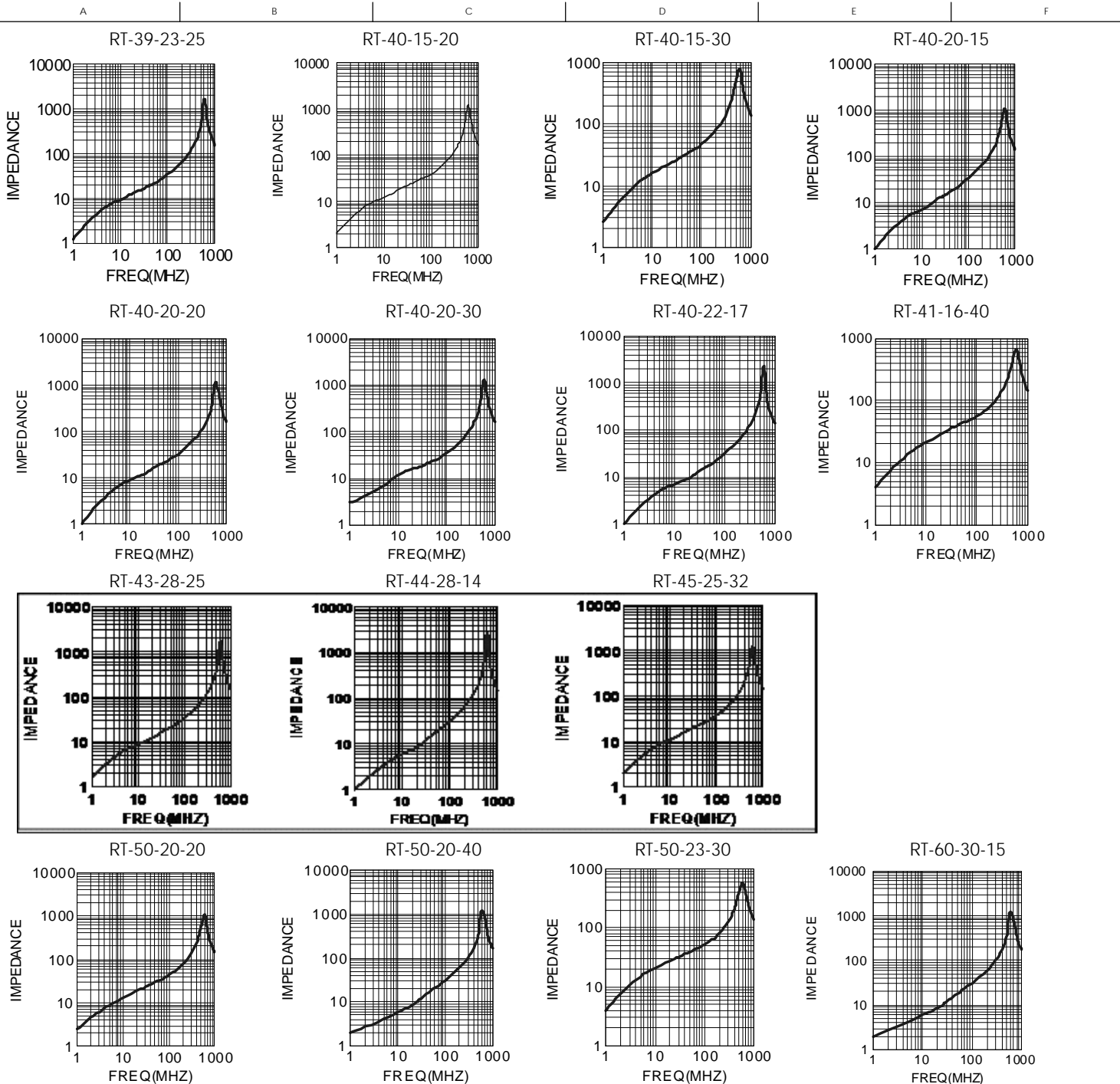

REV.	MODIFICATION.	DATE	DRN
01	NEW DRAWING	19/06/06	NJB
02	CO2010196	24/04/08	SF
03	CO2010845	20/10/09	OW
04	CO2010989	01/10/10	SF
05	CO2011049	26/01/11	SF
06	CO2011144	17/05/11	SF
07	CO2011253	16/04/12	SF
08	CO2011277	31/07/12	SF

NOTES.
1) Impedance figures are typical values.

INFORMATION CONTAINED IN THIS DOCUMENT IS CONFIDENTIAL TO RICHCO INTERNATIONAL Co. Ltd. AND MAY NOT BE DISCLOSED OR REPRODUCED IN WHOLE OR PART WITHOUT THEIR WRITTEN CONSENT.

RICHCO, INC.
WWW.RICHCO-INC.COM

DESCRIPTION:
RT Toroid Cores, Impedance Graphs.

DRG No. 06-073	SHEET SIZE A3	
DRN NJB	DATE 30/05/06	CHKD AS
DATE 30/05/06	SCALE NTS	SHEET No. 4 OF 12

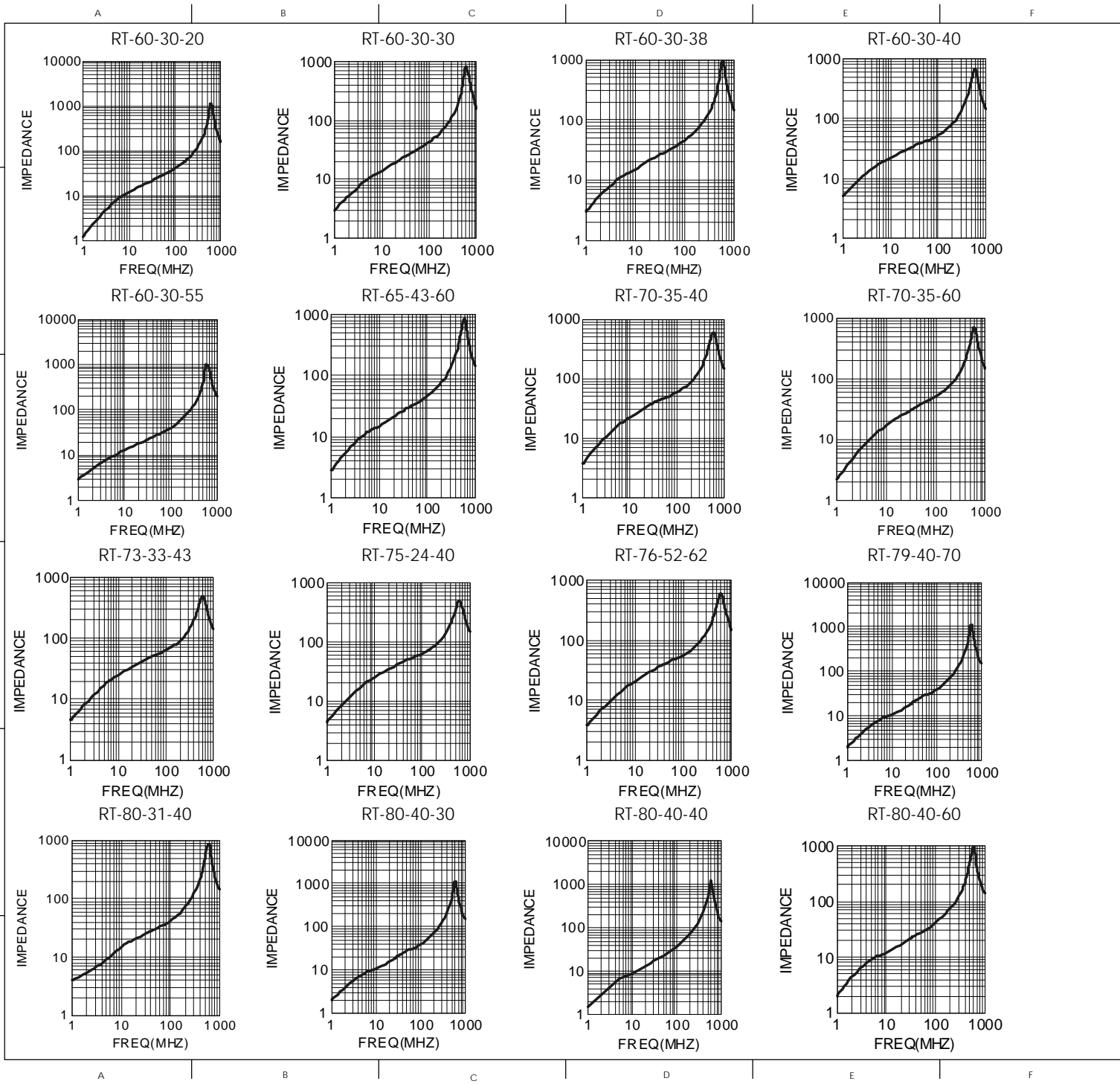

REV.	MODIFICATION.	DATE	DRN
01	NEW DRAWING	19/06/06	NJB
02	CO2010196	24/04/08	SF
03	CO2010845	20/10/09	OW
04	CO2010989	01/10/10	SF
05	CO2011049	26/01/11	SF
06	CO2011144	17/05/11	SF
07	CO2011253	16/04/12	SF
08	CO2011277	31/07/12	SF

NOTES.
 1) Impedance figures are typical values.

INFORMATION CONTAINED IN THIS DOCUMENT IS CONFIDENTIAL TO RICHCO INTERNATIONAL Co. Ltd. AND MAY NOT BE DISCLOSED OR REPRODUCED IN WHOLE OR PART WITHOUT THEIR WRITTEN CONSENT.

RICHCO, INC.
 WWW.RICHCO-INC.COM

DESCRIPTION:
 RT Toroid Cores, Impedance Graphs.

DRG No: 06-073

SHEET SIZE: A3

DRN	DATE	CHKD	DATE	SCALE	SHEET No.
NJB	30/05/06	AS	30/05/06	NTS	5 OF 12

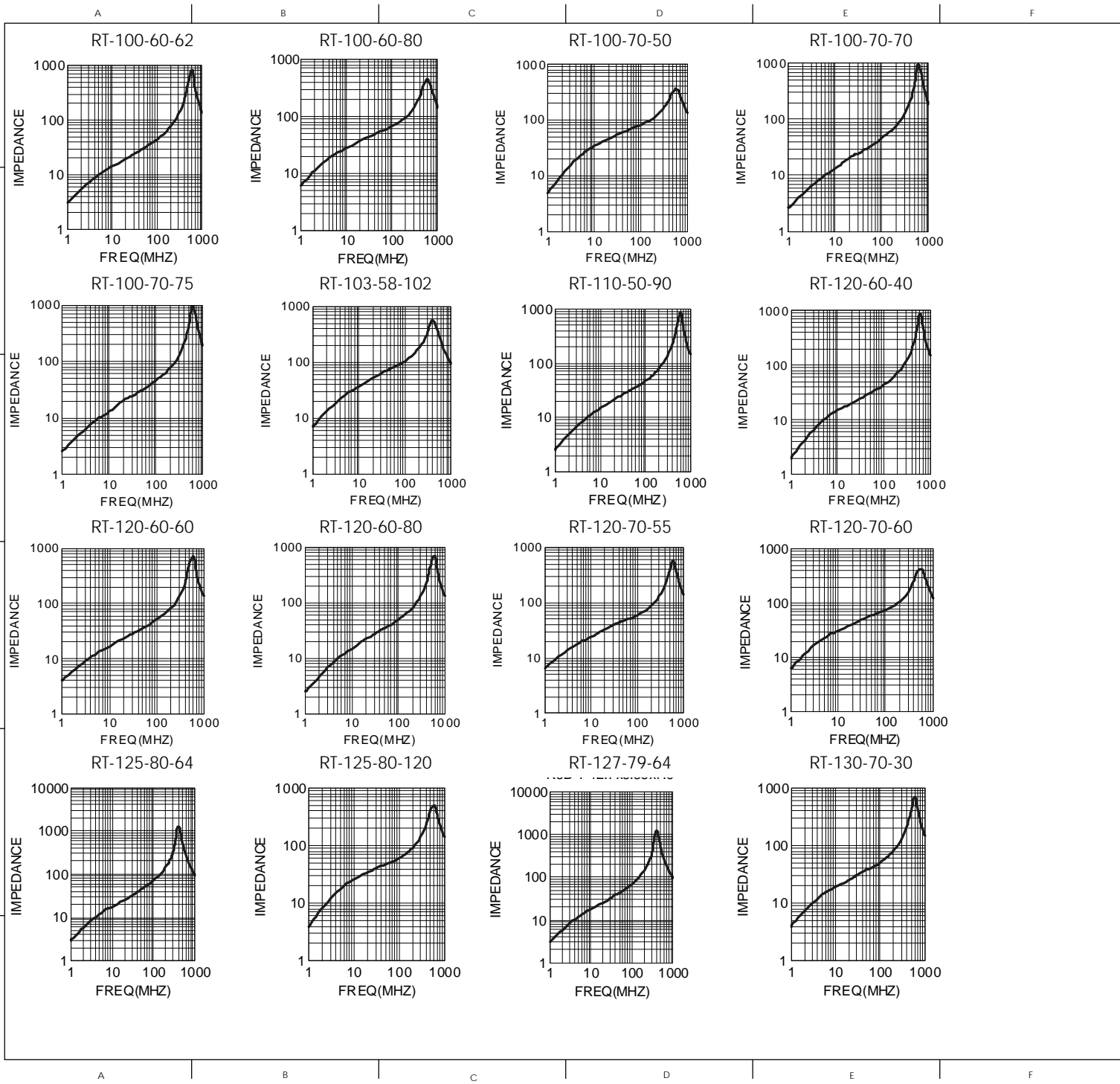

REV.	MODIFICATION.	DATE	DRN
01	NEW DRAWING	19/06/06	NJB
02	CO2010196	24/04/08	SF
03	CO2010845	20/10/09	OW
04	CO2010989	01/10/10	SF
05	CO2011049	26/01/11	SF
06	CO2011144	17/05/11	SF
07	CO2011253	16/04/12	SF
08	CO2011277	31/07/12	SF

NOTES.
 1) Impedance figures are typical values.

INFORMATION CONTAINED IN THIS DOCUMENT IS CONFIDENTIAL TO RICHCO INTERNATIONAL Co. Ltd. AND MAY NOT BE DISCLOSED OR REPRODUCED IN WHOLE OR PART WITHOUT THEIR WRITTEN CONSENT.

RICHCO, INC.
 WWW.RICHCO-INC.COM

DESCRIPTION:
 RT Toroid Cores, Impedance Graphs.

DRG No. 06-073	SHEET SIZE A3		
DRN NJB	DATE 30/05/06	CHKD AS	SCALE NTS
DATE 30/05/06		SCALE NTS	SHEET No. 6 OF 12

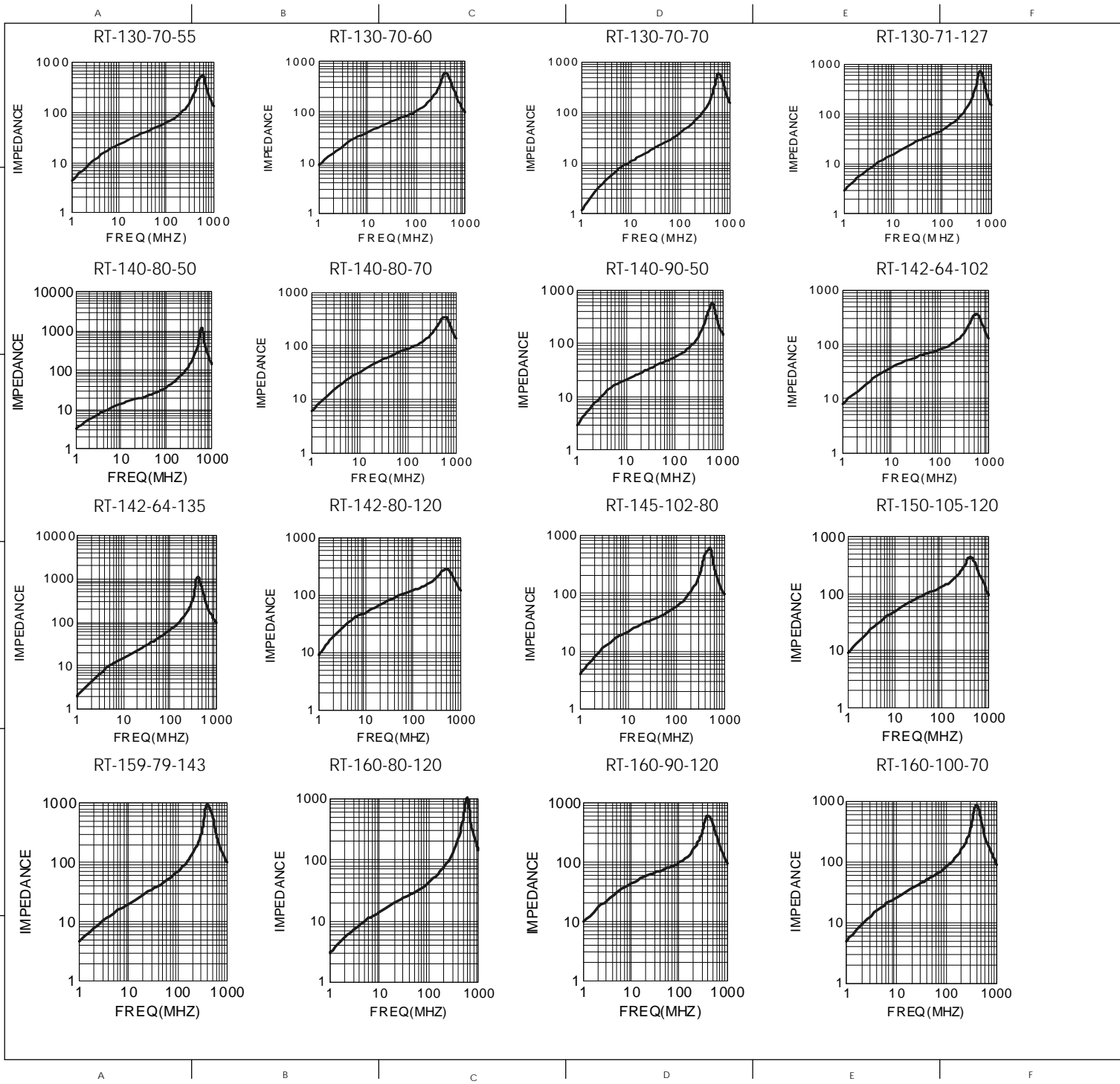

REV.	MODIFICATION.	DATE	DRN
01	NEW DRAWING	19/06/06	NJB
02	CO2010196	24/04/08	SF
03	CO2010845	20/10/09	OW
04	CO2010989	01/10/10	SF
05	CO2011049	26/01/11	SF
06	CO2011144	17/05/11	SF
07	CO2011253	16/04/12	SF
08	CO2011277	31/07/12	SF

NOTES.
 1) Impedance figures are typical values.

INFORMATION CONTAINED IN THIS DOCUMENT IS CONFIDENTIAL TO RICHCO INTERNATIONAL Co. Ltd. AND MAY NOT BE DISCLOSED OR REPRODUCED IN WHOLE OR PART WITHOUT THEIR WRITTEN CONSENT.

RICHCO, INC.
 WWW.RICHCO-INC.COM

DESCRIPTION:
 RT Toroid Cores, Impedance Graphs.

DRG No. 06-073	SHEET SIZE A3	
DRN NJB	DATE 30/05/06	CHKD AS
DATE 30/05/06	SCALE NTS	SHEET No. 7 OF 12

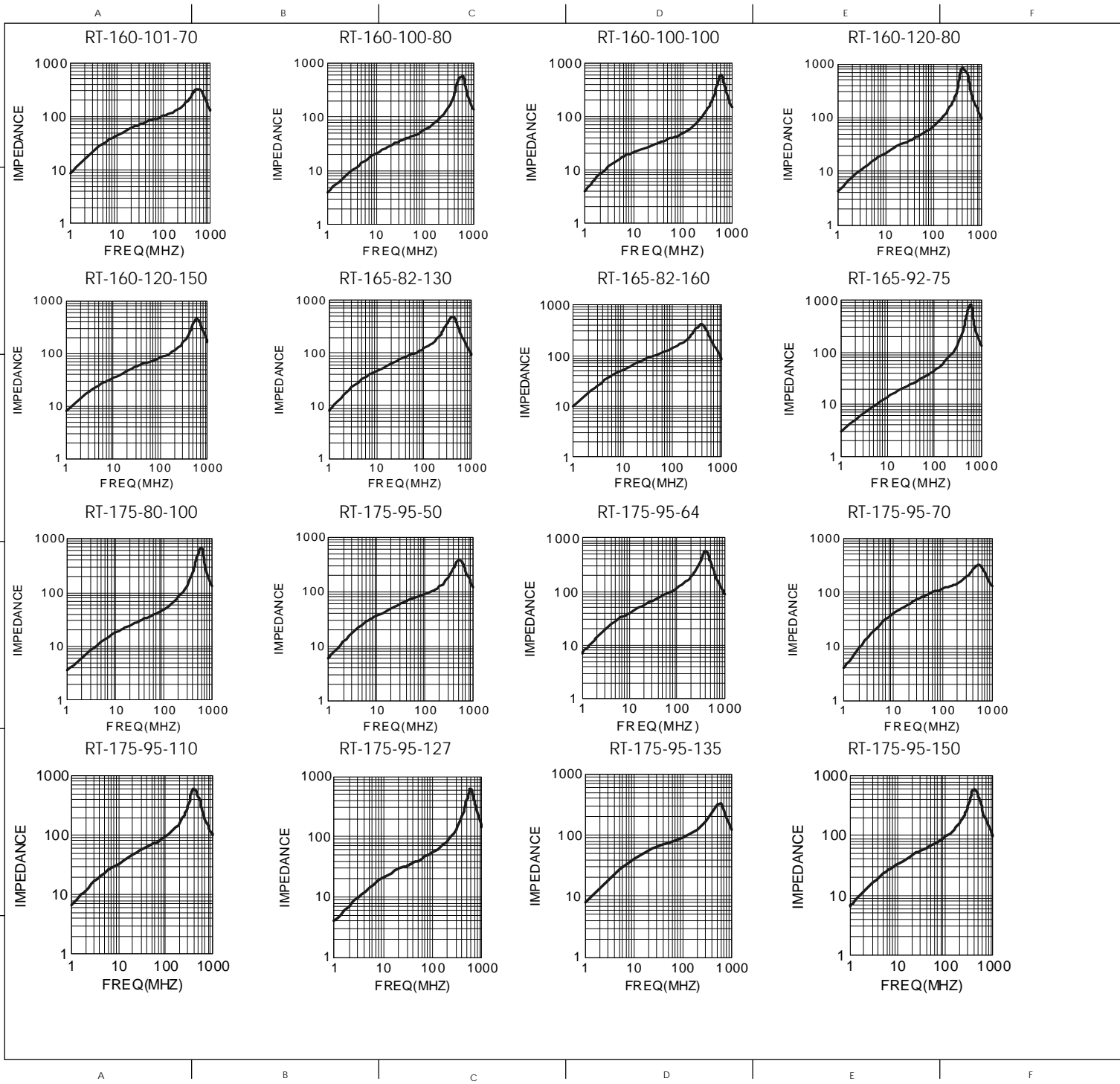

REV.	MODIFICATION.	DATE	DRN
01	NEW DRAWING	19/06/06	NJB
02	CO2010196	24/04/08	SF
03	CO2010845	20/10/09	OW
04	CO2010989	01/10/10	SF
05	CO2011049	26/01/11	SF
06	CO2011144	17/05/11	SF
07	CO2011253	16/04/12	SF
08	CO2011277	31/07/12	SF

NOTES.
 1) Impedance figures are typical values.

INFORMATION CONTAINED IN THIS DOCUMENT IS CONFIDENTIAL TO RICHCO INTERNATIONAL Co. Ltd. AND MAY NOT BE DISCLOSED OR REPRODUCED IN WHOLE OR PART WITHOUT THEIR WRITTEN CONSENT.

RICHCO, INC.
 WWW.RICHCO-INC.COM

DESCRIPTION:
 RT Toroid Cores, Impedance Graphs.

DRG No. 06-073	SHEET SIZE A3		
DRN NJB	DATE 30/05/06	CHKD AS	SCALE NTS
	DATE 30/05/06	SCALE NTS	SHEET No. 8 OF 12

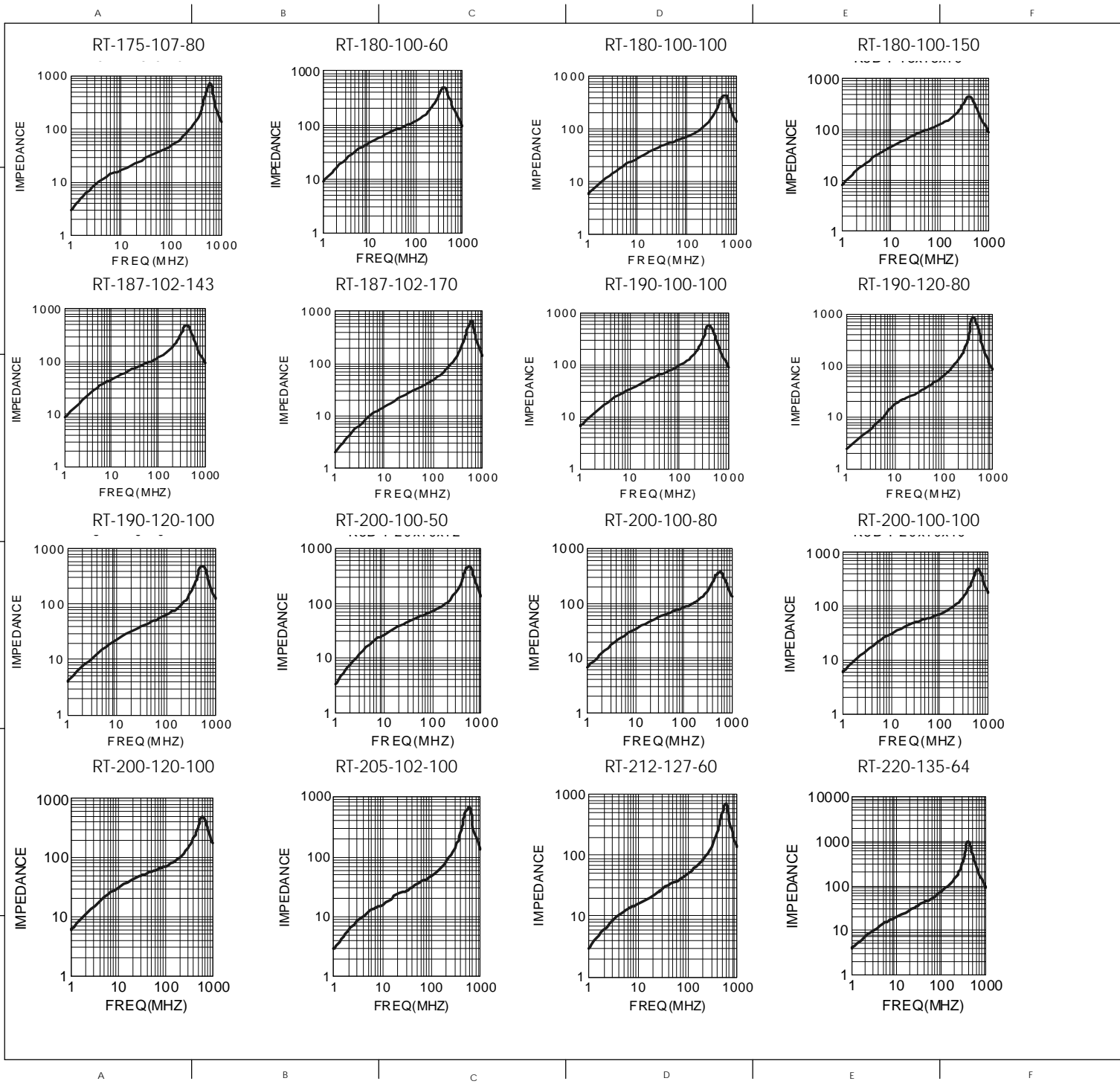

REV.	MODIFICATION.	DATE	DRN
01	NEW DRAWING	19/06/06	NJB
02	CO2010196	24/04/08	SF
03	CO2010845	20/10/09	OW
04	CO2010989	01/10/10	SF
05	CO2011049	26/01/11	SF
06	CO2011144	17/05/11	SF
07	CO2011253	16/04/12	SF
08	CO2011277	31/07/12	SF

NOTES.
 1) Impedance figures are typical values.

INFORMATION CONTAINED IN THIS DOCUMENT IS CONFIDENTIAL TO RICHCO INTERNATIONAL Co. Ltd. AND MAY NOT BE DISCLOSED OR REPRODUCED IN WHOLE OR PART WITHOUT THEIR WRITTEN CONSENT.

RICHCO, INC.
 WWW.RICHCO-INC.COM

DESCRIPTION:
 RT Toroid Cores, Impedance Graphs.

DRG No. 06-073	SHEET SIZE A3		
DRN NJB	DATE 30/05/06	CHKD AS	DATE 30/05/06
SCALE NTS		SHEET No. 9 OF 12	

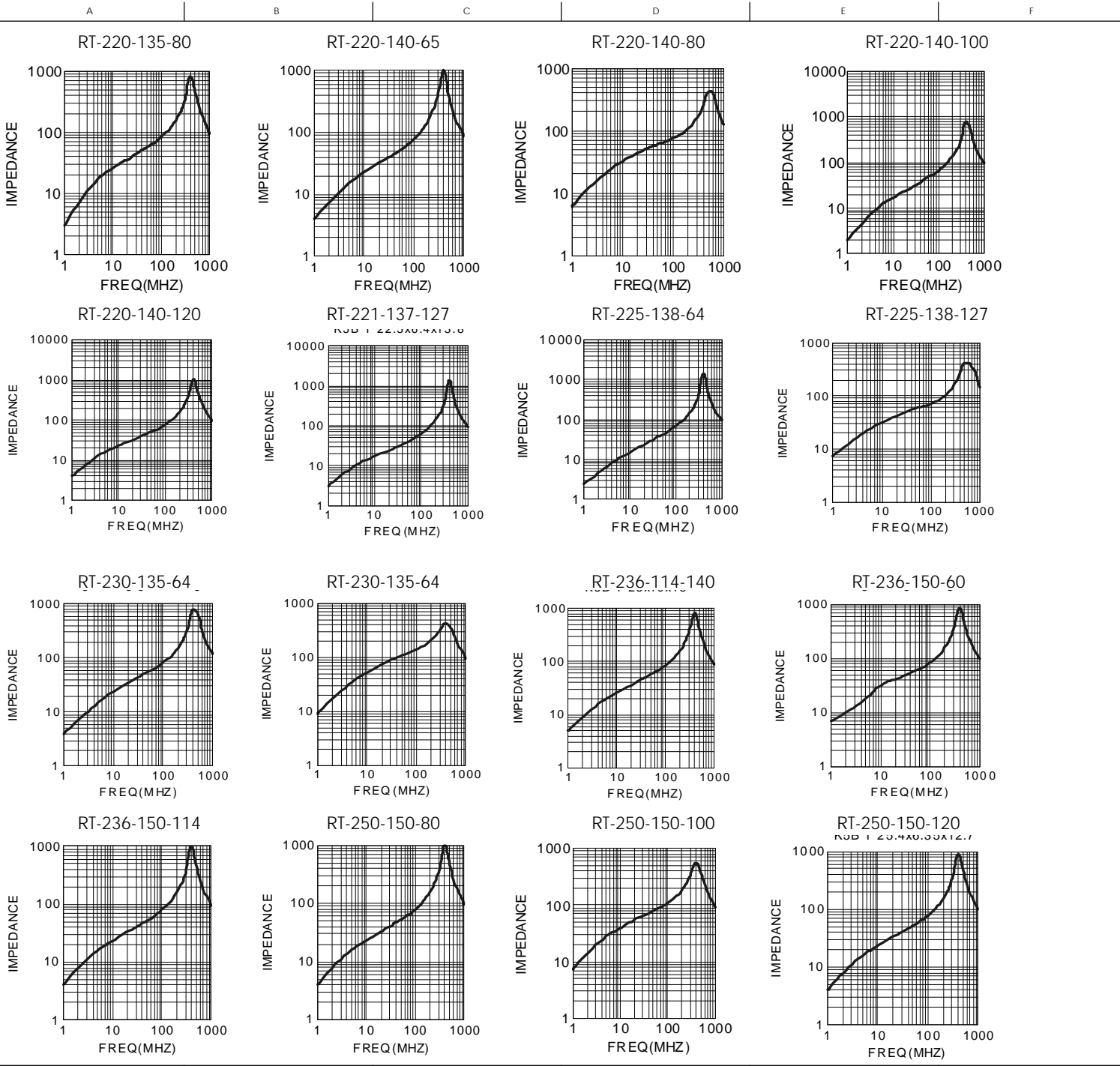

REV.	MODIFICATION.	DATE	DRN
01	NEW DRAWING	19/06/06	NJB
02	CO2010196	24/04/08	SF
03	CO2010845	20/10/09	OW
04	CO2010989	01/10/10	SF
05	CO2011049	26/01/11	SF
06	CO2011144	17/05/11	SF
07	CO2011253	16/04/12	SF
08	CO2011277	31/07/12	SF

NOTES.
1) Impedance figures are typical values.

INFORMATION CONTAINED IN THIS DOCUMENT IS CONFIDENTIAL TO RICHCO INTERNATIONAL Co. Ltd. AND MAY NOT BE DISCLOSED OR REPRODUCED IN WHOLE OR PART WITHOUT THEIR WRITTEN CONSENT.

RICHCO, INC.
WWW.RICHCO-INC.COM

DESCRIPTION:
RT Toroid Cores, Impedance Graphs.

DRG No: 06-073

DRN: NJB DATE: 30/05/06 CHKD: AS DATE: 30/05/06 SCALE: NTS

SHEET No: A3
10 OF 12

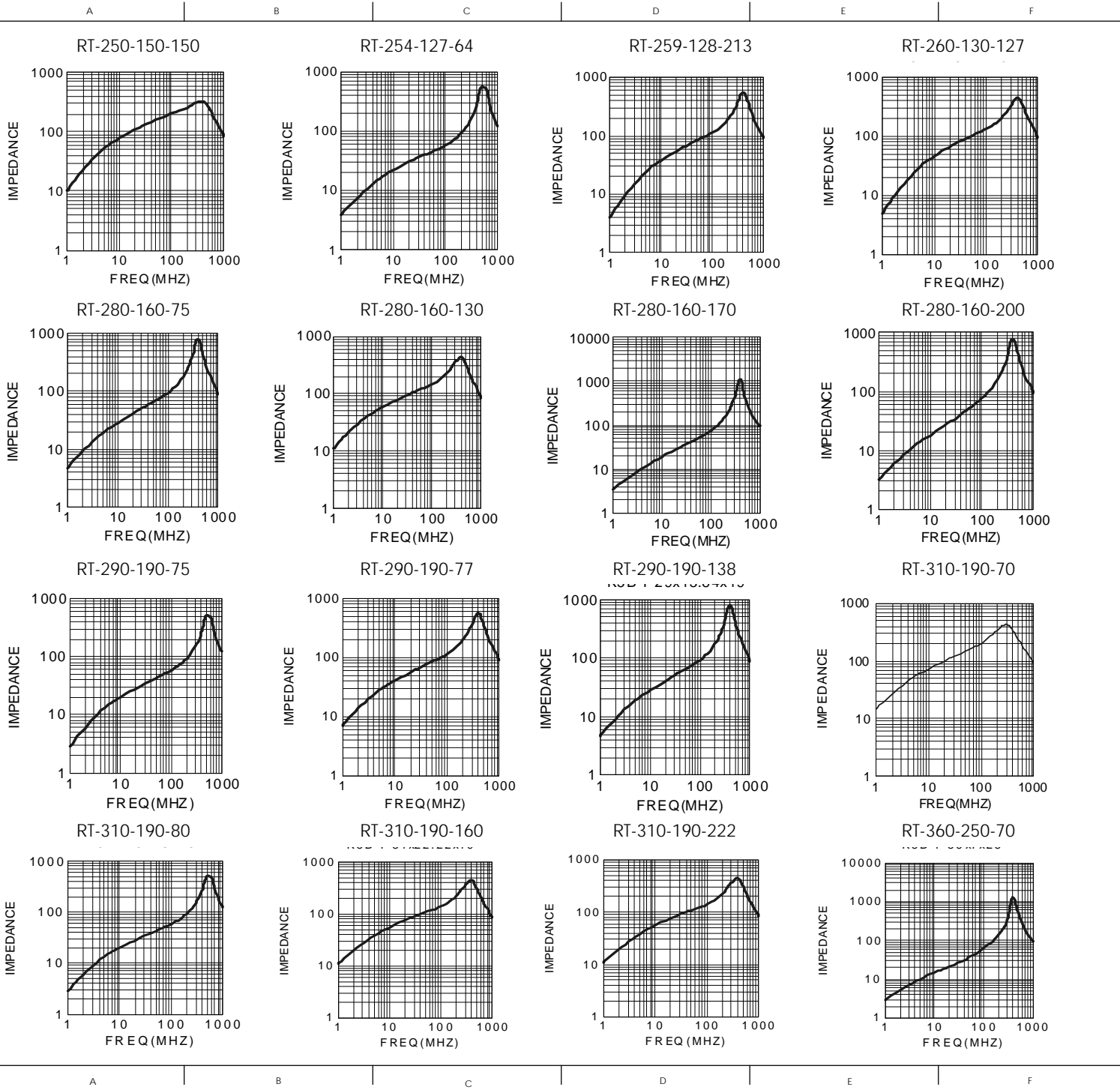

REV.	MODIFICATION.	DATE	DRN
01	NEW DRAWING	19/06/06	NJB
02	CO2010196	24/04/08	SF
03	CO2010845	20/10/09	OW
04	CO2010989	01/10/10	SF
05	CO2011049	26/01/11	SF
06	CO2011144	17/05/11	SF
07	CO2011253	16/04/12	SF
08	CO2011277	31/07/12	SF

NOTES.
1) Impedance figures are typical values.

INFORMATION CONTAINED IN THIS DOCUMENT IS CONFIDENTIAL TO RICHCO INTERNATIONAL Co. Ltd. AND MAY NOT BE DISCLOSED OR REPRODUCED IN WHOLE OR PART WITHOUT THEIR WRITTEN CONSENT.

RICHCO, INC.
WWW.RICHCO-INC.COM

DESCRIPTION:
RT Toroid Cores, Impedance Graphs.

DRG No: 06-073

DRN: NJB DATE: 30/05/06 CHKD: AS DATE: 30/05/06 SCALE: NTS

SHEET SIZE: A3
SHEET No.: 11 OF 12

RT-360-250-127

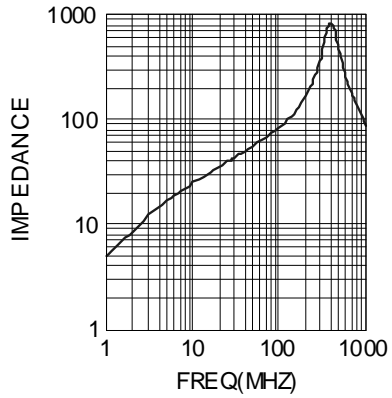

RT-406-274-150

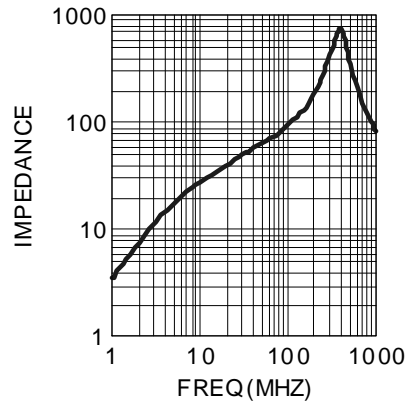

RT-594-348-128

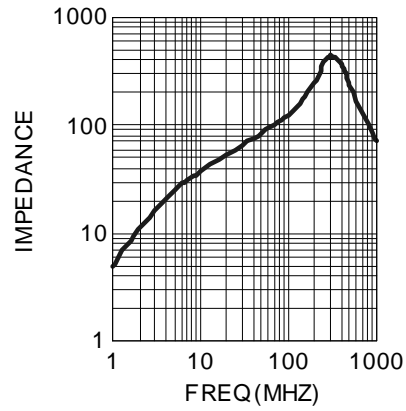

REV.	MODIFICATION.	DATE	DRN
01	NEW DRAWING	19/06/06	NJB
02	CO2010196	24/04/08	SF
03	CO2010845	20/10/09	OW
04	CO2010989	01/10/10	SF
05	CO2011049	26/01/11	SF
06	CO2011144	17/05/11	SF
07	CO2011253	16/04/12	SF
08	CO2011277	31/07/12	SF

NOTES.

1) Impedance figures are typical values.

INFORMATION CONTAINED IN THIS DOCUMENT IS CONFIDENTIAL TO RICHCO INTERNATIONAL Co. Ltd. AND MAY NOT BE DISCLOSED OR REPRODUCED IN WHOLE OR PART WITHOUT THEIR WRITTEN CONSENT.

RICHCO, INC.
WWW.RICHCO-INC.COM

DESCRIPTION:

RT Toroid Cores, Impedance Graphs.

DRG No. 06-073		SHEET SIZE A3		
DRN NJB	DATE 30/05/06	CHKD AS	SCALE NTS	SHEET No. 12 OF 12

X-ON Electronics

Largest Supplier of Electrical and Electronic Components

Click to view similar products for [Ferrite Toroids / Ferrite Rings](#) category:

Click to view products by [Richco](#) manufacturer:

Other Similar products are found below :

[5943001601](#) [28B0200-4](#) [28B0250-1](#) [29D3800-000](#) [28B0137-3](#) [4327 018 35221](#) [432703013571](#) [432703033201](#) [4327 030 37511](#) [4327 030 37911](#) [4327 030 57161](#) [432703057191](#) [B62152P0007X030](#) [432202090241](#) [432202101631](#) [432202133882](#) [432703012441](#) [4327 030 12521](#) [4327 030 57111](#) [5343232001](#) [5943000901](#) [432703034521](#) [5961004101](#) [5961000621](#) [4078034621](#) [4077378111](#) [28B1250-2](#) [28B2000-3](#) [28B1387-1](#) [B64291A1304X000](#) [28B2400-0](#) [B64290A0699X010](#) [5510-017](#) [5961000811](#) [CBCT-35-1](#) [CBCT-120-1](#) [CBCT-70-1](#) [5977004801](#) [5976000201](#) [5968003801](#) [5975011101](#) [5977000501](#) [5978008001](#) [28B0355-0](#) [7427018](#) [M-060](#) [CST29/19/7.5-4S2](#) [T9X8X5](#) [4077485111](#)
[TN10/6/4-3F3](#)