

# LED-Indicators



## LED-INDICATORS – red section

We offer a complete range of high-quality bracket indicators. Diodes are carefully selected for constant colour and brightness, housings are solid brass and chromium-plated.

### LED-Indicators

Ø 7 mm



Ø 7 mm



Ø 10,5 mm



Ø 9 mm  
superbright



Ø 12,2 mm  
waterproof



Ø 7 mm  
tricoloured



Ø 9 mm  
tricoloured



Ø 9 mm  
flashing



Ø 12,2 mm  
waterproof



with lead and  
connector



# LED-Indicators

| Specifications:              |                             |  |   |   |  |                                       |   |   |                                    |                 |                  |     |     |              |                      |
|------------------------------|-----------------------------|--|---|---|--|---------------------------------------|---|---|------------------------------------|-----------------|------------------|-----|-----|--------------|----------------------|
| Models                       | P<br>Power dissipation (mW) | V <sub>F</sub> <sup>1</sup><br>Forward voltage (V) | I <sub>F</sub><br>Forward current (mA)    | I <sub>V</sub><br>Luminous intensity (mcd)<br>at I <sub>F</sub> = 10 mA | λ <sub>P</sub><br>Peak emission wavelength (nm) <sup>1</sup> | V <sub>R</sub><br>Reverse voltage (V) | I <sub>R</sub><br>Reverse current (μA)<br>at V <sub>R</sub> = 3 V | T <sub>OP</sub><br>Operating temperature (°C) |                                    |                 |                  |     |     |              |                      |
| LD 30<br>LD 32               | 85                          | min.<br>2,1<br>typ.<br>3,0<br>max.                 | 20<br>25                                  | 1,8   | 700  | 5,0                                   | 100   | - 40<br>+ 85                                  |                                    |                 |                  |     |     |              |                      |
| LD 34                        |                             | min.<br>2,0<br>typ.<br>2,2<br>max.                 |   |   |  |                                       |   |   | 20<br>40                           | 20 <sup>4</sup> | 630              | 4,0 | 10  | - 30<br>+ 70 |                      |
| LD 36<br>LDE 36 <sup>3</sup> | 100                         | min.<br>1,7<br>typ.<br>2,0<br>max.                 | 20<br>50                                  | 20<br>30  | 660  | 4,0                                   | 100   | - 30<br>+ 85                                  |                                    |                 |                  |     |     |              |                      |
| LD 40<br>LD 42               |                             | 85   |   |   |  |                                       |   |   | min.<br>2,1<br>typ.<br>3,0<br>max. | 20<br>25        | 3,2              | 555 | 5,0 | 100          | - 40<br>+ 85         |
| LD 44                        | 110                         |  | min.<br>2,0<br>typ.<br>2,1<br>max.        | 25<br>45  | 8 <sup>4</sup>   | 565                                   | 4,0   | 10  | - 30<br>+ 70                       |                 |                  |     |     |              |                      |
| LD 46<br>LDE 46 <sup>3</sup> |                             | 125  | min.<br>2,1<br>typ.<br>2,5<br>max.        |   |  |                                       |   |   |                                    | 20<br>50        | 8<br>12          | 555 | 4,0 | 100          | - 30<br>+ 85         |
| LD 60<br>LD 62               | 85                          |  | min.<br>2,1<br>typ.<br>3,0<br>max.        | 20<br>25  | 2,7  | 600                                   | 5,0   | 100   | - 40<br>+ 85                       |                 |                  |     |     |              |                      |
| LD 64                        |                             | 110  | min.<br>2,1<br>typ.<br>2,2<br>max.        |   |  |                                       |   |   |                                    | 35<br>50        | 10 <sup>4</sup>  | 585 | 4,0 | 10           | - 30<br>+ 70         |
| LD 66<br>LDE 66 <sup>3</sup> | 125                         |  | min.<br>2,2<br>typ.<br>2,5<br>max.        | 20<br>50  | 16<br>24   | 580                                   | 4,0   | 100   | - 30<br>+ 85                       |                 |                  |     |     |              |                      |
| LD 70<br>LD 72               |                             | 62   | min.<br>2,7<br>typ.<br>3,0<br>max.<br>3,3 |   |  |                                       |   |   |                                    | 20<br>50        | 0,9 <sup>4</sup> | 470 | 5,0 | 30           | - 20<br>+ 80         |
| LD 53                        | 70                          |  | min.<br>2,0<br>typ.<br>2,6<br>max.        | 10<br>30  | 0,5<br>1,0   | 632                                   | 3,0   | 10  | - 25<br>+ 85                       |                 |                  |     |     |              |                      |
|                              |                             | green  | min.<br>1,9<br>typ.<br>2,4<br>max.        |   |  |                                       |   |   |                                    | 20<br>30        | 0,25<br>0,5      | 558 | 3,0 | 10           | - 25<br>- 25<br>+ 85 |
|                              |                             | yellow   | Combination red / green                   |   |  |                                       |   |   |                                    |                 |                  |     |     |              |                      |
| LD 56                        | 45                          | min.<br>2,1<br>typ.<br>3,0<br>max.                 | 10<br>20                                  | 2,2   | 700  | 5,0                                   | 100   | - 40<br>+ 85                                  |                                    |                 |                  |     |     |              |                      |
|                              |                             | green  |   |   |  |                                       |   |   | min.<br>2,1<br>typ.<br>3,0<br>max. | 10<br>25        | 3,9              | 555 | 5,0 | 100          | - 40<br>+ 85         |
|                              |                             | yellow   |   |   |  |                                       |   |   | Combination red / green            |                 |                  |     |     |              |                      |
| LD 96 flashing               | 200                         | min.<br>typ.<br>max.                               |   | 0,5 <sup>2</sup><br>1,6 <sup>2</sup>                                    | 660  | 0,4                                   |   | - 40<br>+ 70                                  |                                    |                 |                  |     |     |              |                      |

<sup>1</sup> with typical forward current  
<sup>2</sup> at V<sub>S</sub> = 5 V

<sup>3</sup> Water proofing at 30 minutes at 1 m water column = IP 67.  
<sup>4</sup> at I<sub>F</sub> = 20 mA

# LED-Indicators



## Models:

Light colour

Housing

Dimensions

|         |                    |
|---------|--------------------|
| LD 30   |                    |
| LD 40   | brass              |
| LD 60   | chromium-plated    |
| LD 70   |                    |
| LD 30 S |                    |
| LD 40 S | brass              |
| LD 60 S | black, matt finish |
| LD 70 S |                    |

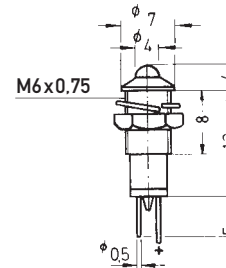

Also available with integrated resistor for 24 V operation.  
Additional to type number: – 24

|         |                    |
|---------|--------------------|
| LD 32   |                    |
| LD 42   | brass              |
| LD 62   | chromium-plated    |
| LD 72   |                    |
| LD 32 S |                    |
| LD 42 S | brass              |
| LD 62 S | black, matt finish |
| LD 72 S |                    |

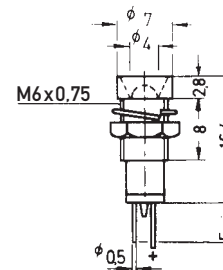

Also available with integrated resistor for 24 V operation.  
Additional to type number: – 24

|         |                    |
|---------|--------------------|
| LD 34   |                    |
| LD 44   | brass              |
| LD 64   | chromium-plated    |
| LD 34 S |                    |
| LD 44 S | brass              |
| LD 64 S | black, matt finish |

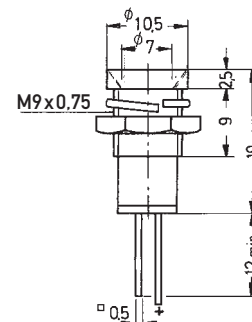

|         |                    |             |
|---------|--------------------|-------------|
| LD 36   | brass              | superbright |
| LD 46   | chromium-plated    |             |
| LD 66   |                    |             |
| LD 36 S | brass              | superbright |
| LD 46 S | black, matt finish |             |
| LD 66 S |                    |             |

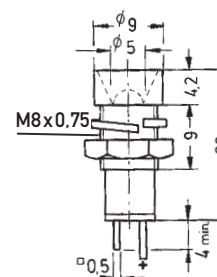

Also available with integrated resistor for 24 V operation.  
Additional to type number: – 24



# LED-Indicators

## Models:

Light colour

Housing

Dimensions

LD 53

brass  
chromium-plated

tricoloured

Connection diagram:

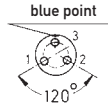

1 = anode green  
2 = anode red  
3 = common cathode

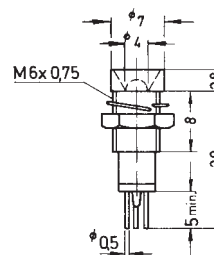

LD 53 S

brass  
black, matt finish

tricoloured

LD 56

brass  
chromium-plated

tricoloured

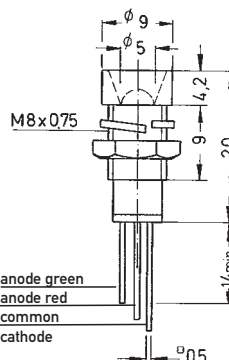

LD 56 S

brass  
black, matt finish

tricoloured

LD 96 R

brass

flashing

LD 96 G

chromium-plated

LD 96 Y

LD 96 SR

brass

flashing

LD 96 SG

black, matt finish

LD 96 SY

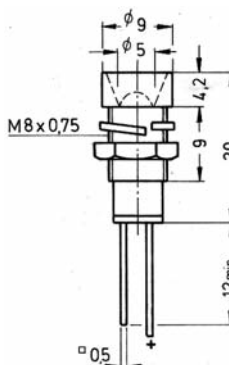

Flashing frequency = 3 Hz

Supply voltage = 4,75 V – 7 V

LDE 36

brass

waterproof

LDE 46

chromium-plated

LDE 66

brass

waterproof

LDE 36 S

black, matt finish

LDE 46 S

LDE 66 S

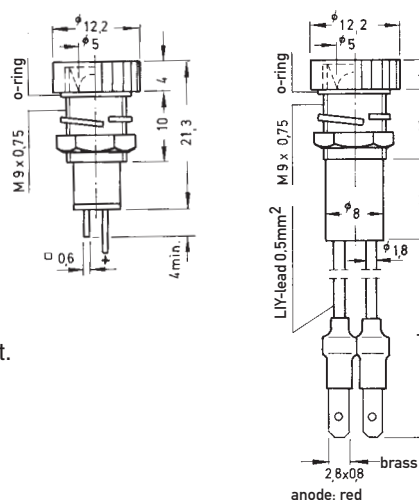

**Special version:** with lead and connector

Additional to type number: W

L = 50 mm; other length: minimum quantity and delivery time on request.

Also available with integrated resistor for 24 V operation.

Additional to type number: – 24

## X-ON Electronics

Largest Supplier of Electrical and Electronic Components

*Click to view similar products for [Other Tools](#) category:*

*Click to view products by [Knitter-Switch](#) manufacturer:*

Other Similar products are found below :

[CR-05FL7--150R](#) [CR-05FL7--698K](#) [899-2-KT46](#) [899-5-KT46](#) [CR-0AFL4--332K](#) [CR-12FP4--260R](#) [CRCW04021100FRT7](#)  
[CRCW04021961FRT7](#) [5800-0090](#) [CRCW04024021FRT7](#) [CRCW040254R9FRT7](#) [CRCW0603102JRT5](#) [59065-5](#) [00-8273-RDPP](#) [00-8729-](#)  
[WHPP](#) [593033](#) [593058](#) [593072](#) [593564100](#) [593575](#) [593591](#) [593593](#) [011349-000](#) [LTLA506SBLAMNBL](#) [CRCW08052740FRT1](#) [LUC-](#)  
[012S070DSM](#) [LUC-018S070DSP](#) [599-2021-3-NME](#) [599-JJ-2021-03](#) [00-5080-YWPP](#) [5E4750/01-20R0-T/R](#) [LW1A-L1-GL](#) [LW1A-P1-GD](#)  
[LW1L-A1C10V-GL](#) [LW1L-M1C70-A](#) [0202-0173](#) [00-9089-RDPP](#) [00-9300-RDPP](#) [CRCW2010331JR02](#) [01-1003W-8/32-10](#) [601-GP-08-](#)  
[KT39](#) [601-JJ-06](#) [601-SPB](#) [601YSY](#) [602-JJ-03](#) [602SPB](#) [602Z](#) [603-JJ-07-FP](#) [603-JJY-04](#) [604J](#)