

DIN 6885 A | ISO R773

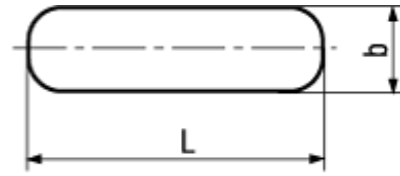

BN 4629
Parallel keys
 deep pattern, face side domed
 Stainless steel A4
 • VSM 15161 A
 • ~UNI 6604 A
 • ~CSN 022513

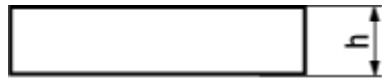

| Article# | b | h | d ₁ | t | t ₁ | L |
|----------|---|---|----------------|---------|----------------|----|
| 3061012 | 3 | 3 | 8-10 | 1,8-1,9 | 1,4-1,5 | 8 |
| 3061013 | | | | | | 10 |
| 3061014 | | | | | | 12 |
| 3061015 | | | | | | 16 |
| 3061016 | | | | | | 20 |
| 3061017 | | | | | | 25 |
| 3061018 | 4 | 4 | 10-12 | 2,5-2,6 | 1,8-1,9 | 8 |
| 3061019 | | | | | | 10 |
| 3061020 | | | | | | 12 |
| 3061021 | | | | | | 16 |
| 3061022 | | | | | | 20 |
| 3061023 | | | | | | 25 |
| 3061024 | | | | | | 28 |
| 3061025 | | | | | | 32 |
| 5523560 | 5 | 5 | 12-17 | 3-3,1 | 2,3-2,4 | 10 |
| 3061026 | | | | | | 12 |
| 3061027 | | | | | | 16 |
| 3061028 | | | | | | 20 |
| 3061029 | | | | | | 25 |
| 3061030 | | | | | | 28 |
| 3061031 | | | | | | 32 |
| 3061032 | | | | | | 36 |
| 3061033 | | | | | | 40 |
| 3061034 | | | | | | 45 |

| Article# | b | h | d ₁ | t | t ₁ | L |
|----------|----|---|----------------|---------|----------------|----|
| 3061035 | 5 | 5 | 12-17 | 3-3,1 | 2,3-2,4 | 50 |
| 3061036 | 6 | 6 | 17-22 | 3,5-3,6 | 2,8-2,9 | 16 |
| 3061037 | | | | | | 20 |
| 3061038 | | | | | | 25 |
| 3061039 | | | | | | 28 |
| 3061040 | | | | | | 32 |
| 3061041 | | | | | | 36 |
| 3061042 | | | | | | 40 |
| 3061044 | | | | | | 45 |
| 3061045 | | | | | | 50 |
| 3061046 | | | | | | 56 |
| 3061047 | | | | | | 63 |
| 3061050 | | | | | | 70 |
| 3061051 | 8 | 7 | 22-30 | 4-4,2 | 3,3-3,5 | 20 |
| 3061053 | | | | | | 25 |
| 3061054 | | | | | | 28 |
| 3061057 | | | | | | 32 |
| 3061058 | | | | | | 36 |
| 3061060 | | | | | | 40 |
| 3061061 | | | | | | 45 |
| 3061063 | | | | | | 50 |
| 3061064 | | | | | | 56 |
| 3061065 | | | | | | 63 |
| 3061066 | | | | | | 70 |
| 3061067 | | | | | | 80 |
| 3061068 | 10 | | 30-38 | 5-5,2 | 3,3-3,5 | 25 |
| 3061069 | | | | | | 28 |
| 3061070 | | | | | | 32 |
| 3061072 | | | | | | 36 |
| 3061074 | | | | | | 40 |
| 3061075 | | | | | | 45 |
| 3061076 | | | | | | 50 |
| 3061077 | | | | | | 56 |
| 3061078 | | | | | | 63 |
| 3061079 | | | | | | 70 |
| 3061080 | | | | | | 80 |
| 3061081 | 12 | 8 | 38-44 | 5-5,2 | 3,3-3,5 | 32 |
| 3061082 | | | | | | 36 |
| 3061084 | | | | | | 40 |
| 3061087 | | | | | | 45 |
| 3061088 | | | | | | 50 |

| Article# | b | h | d ₁ | t | t ₁ | L |
|----------|----|---|----------------|-------|----------------|----|
| 3061090 | 12 | 8 | 38-44 | 5-5,2 | 3,3-3,5 | 56 |
| 3061091 | | | | | | 63 |
| 3061093 | | | | | | 70 |
| 3061095 | | | | | | 80 |

X-ON Electronics

Largest Supplier of Electrical and Electronic Components

Click to view similar products for [Terminal Block Tools & Accessories](#) category:

Click to view products by [Bossard](#) manufacturer:

Other Similar products are found below :

[1029563](#) [00171430102](#) [00171420102](#) [014415](#) [CSTSPC1-2](#) [9-1437653-4](#) [928358-1](#) [QC209/J](#) [HCL10-6](#) [1437403-6](#) [1437403-9](#) [1437403-8](#)
[147832-1](#) [EC0037-000](#) [MT2/H--](#) [MT2/H-32](#) [MT6/H-N](#) [MT6/V-GRND](#) [MT8/H-101-110](#) [BB2-09BF](#) [EP2.5/4UN/BG](#) [1707755](#) [1735590](#)
[1755480](#) [1760336](#) [BO3-02](#) [1789281](#) [1840227](#) [1840230](#) [1893164](#) [2-1437402-1](#) [2-1437644-9](#) [JB2-09/J](#) [2202307](#) [2302463](#) [2305949](#) [2310581](#)
[8TK2-24](#) [91.201.1](#) [L2U2](#) [2778.0](#) [2890137](#) [2901107](#) [2901123](#) [2901699](#) [2MP/J](#) [2MV-06](#) [1705126](#) [1756294](#) [F03-25](#)