

1. SMA Straight Plug (With Center Contact)

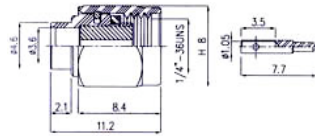

Semi-Rigid
Cable -Direct
Solder Attachment

Finish: gold plated center contact & body
Insulation: Teflon

Ordering Code	Applicable Cable RG/U	Notes
SMA-50PAG0112BRX	RG 402/U (.141")	
SMA-50PAG0113BRX	RG 405/U (.085")	

2. SMA Right Angle Plug

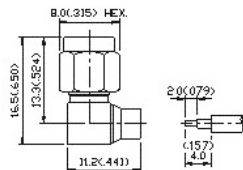

Semi-Rigid
Cable -Direct
Solder Attachment

Finish: gold plated center contact & body
Insulation: Teflon

Ordering Code	Applicable Cable RG/U	Notes
SMA-50PAG0612BRX	RG 402/U (.141")	
SMA-50PAG0613BRX	RG 405/U (.085")	

3. SMA Straight Jack

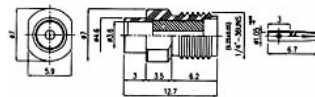

Semi-Rigid
Cable -Direct
Solder Attachment

Finish: gold plated center contact & body
Insulation: Teflon

Ordering Code	Applicable Cable RG/U	Notes
SMA-50SAG0112BRX	RG 402/U (.141")	
SMA-50SAG0113BRX	RG 405/U (.085")	

4. SMA Straight Bulkhead Jack

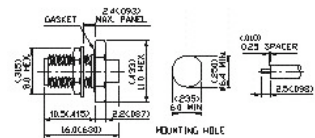

Semi-Rigid
Cable -Direct
Solder Attachment

Finish: gold plated center contact & body
Insulation: Teflon

Ordering Code	Applicable Cable RG/U	Notes
SMA-50SAG6412BRX	RG 402/U (.141")	
SMA-50SAG6413BRX	RG 405/U (.085")	

5. SMA Straight Square Flange Jack

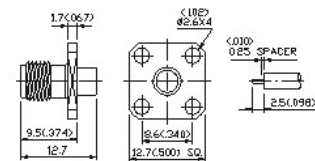

Semi-Rigid
Cable -Direct
Solder Attachment

Finish: gold plated center contact & body
Insulation: Teflon

Ordering Code	Applicable Cable RG/U	Notes
SMA-50SAG5612BRX	RG 402/U (.141")	
SMA-50SAG5613BRX	RG 405/U (.085")	

6. SMA Straight 2 Hole Flange Jack



Finish: gold plated center contact & body
Insulation: Teflon

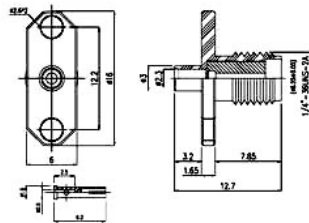

Semi-Rigid
Cable -Direct
Solder Attachment

Ordering Code	Applicable Cable RG/U	Notes
SMA-50SAG7812BRX	RG 402/U (.141")	
SMA-50SAG7813BRX	RG 405/U (.085")	

7. SMA Straight Plug Clamp



Finish: gold plated center contact & body
Insulation: Teflon

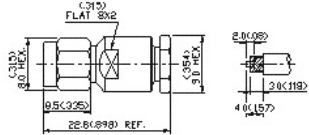

Flexible
Cable -Clamp
Attachment

Ordering Code	Applicable Cable RG/U	Notes
SMA-50PAG0704BRX	RG 402/U (.141")	
SMA-50PAG0702BRX	RG 405/U (.085")	

8. SMA Right Angle Plug Crimp



Finish: gold plated center contact & body
Insulation: Teflon

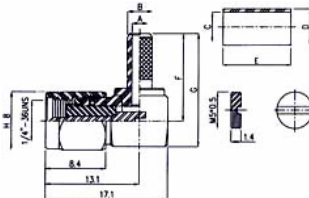

Flexible
Cable -Clamp
Attachment

Ordering Code	Applicable Cable RG/U	Notes
SMA-50PAG0404BRX	58,58A,141A	
SMA-50PAG0402BRX	174,188A,316	
SMA-50PAG0416BRX	142B/U	

9. SMA Stright Plug Crimp

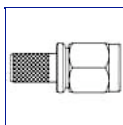

Finish: gold plated center contact & body
Insulation: Teflon

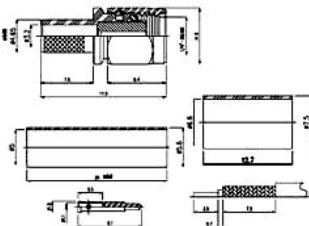

Ordering Code	Applicable Cable RG/U	Notes
SMA-50PAG0321BRX	RG-142/U.223	

10. SMA Straight Plug Crimp



Finish: gold plated center contact & body
Insulation: Teflon

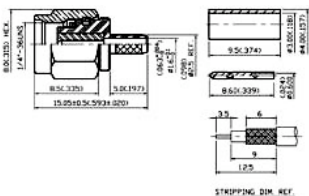

Flexible
Cable -Clamp
Attachment

Ordering Code	Applicable Cable RG/U	Notes
SMA-50PAG0304BRX	58,58A,141A	L=17.8mm
SMA-50PAG0302BRX	174,188A,316	L=16.3mm
SMA-50PAG0316BRX	142B/U	L=17.8mm

11. SMA Straight Jack Crimp

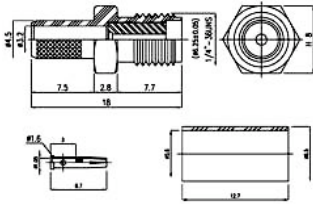

Flexible
Cable -Clamp
Attachment

Finish: gold plated center contact & body
Insulation: Teflon

Ordering Code	Applicable Cable RG/U	Notes
SMA-50SAG0304BRX	58,58A,141A	L=17.5mm
SMA-50SAG0302BRX	174,188A,316	L=16.0mm

12. SMA Straight Bulkhead Jack Crimp

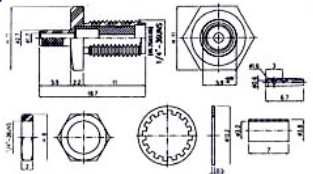

Flexible
Cable -Clamp
Attachment

Finish: gold plated center contact & body
Insulation: Teflon

Ordering Code	Applicable Cable RG/U	Notes
SMA-50SAG6404BRX	58,58A,141A	L=20.2mm
SMA-50SAG6402BRX	174,188A,316	L=18.8mm
SMA-50SAG6416BRX	142B/U	L=20.2mm

13. SMA Square Flange Plug Receptacle (Solder Pot Contact)

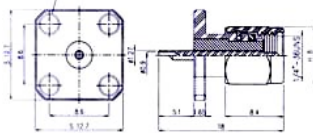

Panel Mount
Receptacle (Solder
Pot Contact)

Finish: gold plated center contact & body
Insulation: Teflon

Ordering Code
SMA-50PAG5899BRX

14. SMA Square Flange Jack Receptacle (Solder Pot Contact)

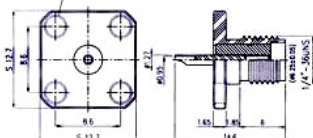

Panel Mount
Receptacle (Solder
Pot Contact)

Finish: gold plated center contact & body
Insulation: Teflon

Ordering Code
SMA-50SAG5899BRX

15. SMA 2 Hole Flange Plug Receptacle (Solder Pot Contact)

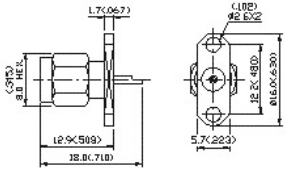

Panel Mount
Receptacle (Solder
Pot Contact)

Finish: gold plated center contact & body
Insulation: Teflon

Ordering Code
SMA-50PAG5999BRX

16. SMA 2 Hole Jack Receptacle (Solder Pot Contact)

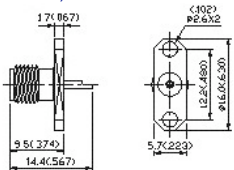

Panel Mount
Receptacle (Solder
Pot Contact)

Finish: gold plated center contact & body
Insulation: Teflon

Ordering Code
SMA-50SAG5999BRX

17. SMA Square Flange Jack Receptacle (Exposed Teflon)

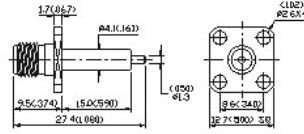

Panel Mount
Receptacle
(Exposed Teflon)

Finish: gold plated center contact & body
Insulation: Teflon

Ordering Code
SMA-50SAG6999BRX

18. SMA 2 Hole Flange Jack Receptacle (Exposed Teflon)

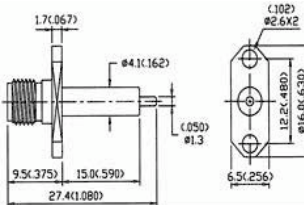

Panel Mount
Receptacle (Exposed
Teflon)

Finish: gold plated center contact & body
Insulation: Teflon

Ordering Code
SMA-50SAG6199BRX
SMA-50SAG6152BRX

19. SMA Square Flange Plug Receptacle (Tab Contact)

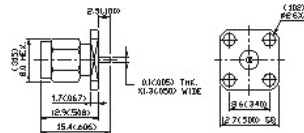

Panel Mount
Receptacle (Tab
Contact)

Finish: gold plated center contact & body
Insulation: Teflon

Ordering Code
SMA-50PAG6299BRX

20. SMA Square Flange Jack Receptacle (Tab Contact)



Click on the picture
for a detailed view

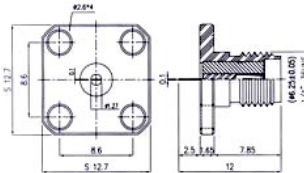

Panel Mount
Receptacle (Tab
Contact)

Finish: gold plated center contact & body
Insulation: Teflon

Ordering Code
SMA-50SAG6299BRX

21. SMA 2 Hole Flange Plug Receptacle (Tab Contact)

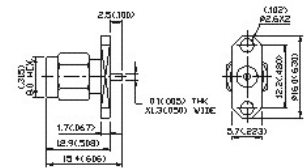

Panel Mount
Receptacle (Tab
Contact)

Finish: gold plated center contact & body
Insulation: Teflon

Ordering Code
SMA-50PAG6399BRX

22. SMA 2 Hole Flange Jack Receptacle (Tab Contact)

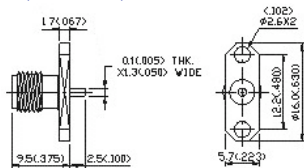

Panel Mount
Receptacle (Tab
Contact)

Finish: gold plated center contact & body
Insulation: Teflon

Ordering Code
SMA-50SAG6399BRX

23. SMA Square Flange Plug Receptacle (For Microstrip Line Circuits)



Finish: gold plated center contact & body
Insulation: Teflon

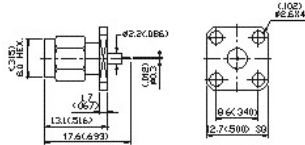

Panel Mount Receptacle (For Microstrip Line Circuits)

Ordering Code
SMA-50PAG5599BRX

24. SMA Square Flange Plug Receptacle (For Microstrip Line Circuits)



Finish: gold plated center contact & body
Insulation: Teflon

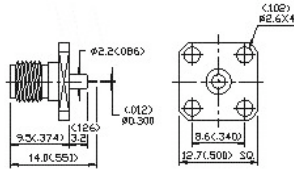

Panel Mount Receptacle (For Microstrip Line Circuits)

Ordering Code
SMA-50SAG5599BRX

25. SMA 2 Hole Flange Jack Receptacle (For Microstrip Line Circuits)



Finish: gold plated center contact & body
Insulation: Teflon

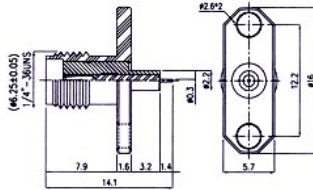

Panel Mount Receptacle (For Microstrip Line Circuits)

Ordering Code
SMA-50SAG5499BRX

26. SMA Square Flange Jack Receptacle (For Microstrip Line Circuits)



Finish: gold plated center contact & body
Insulation: Teflon

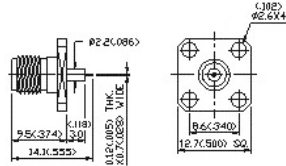

Panel Mount Receptacle (For Microstrip Line Circuits)

Ordering Code
SMA-50SAG6250BRX

27. SMA 2 Hole Flange Jack Receptacle (For Microstrip Line Circuits)



Finish: gold plated center contact & body
Insulation: Teflon

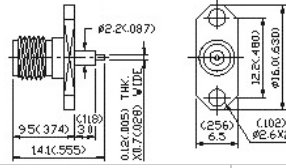

Panel Mount Receptacle (For Microstrip Line Circuits)

Ordering Code	Contact horizontal to panel
SMA-50SAG6354BRX	

28. SMA Right Angle Square Flange Jack Receptacle (Exposed Teflon)



Finish: gold plated center contact & body
Insulation: Teflon

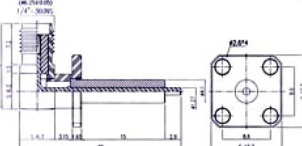

Panel Mount Receptacle (Exposed Teflon)

Ordering Code
SMA-50SAG6956BRX

29. SMA Square Flange Jack Receptacle (Blunt Post Contact)



Finish: gold plated center contact & body
Insulation: Teflon

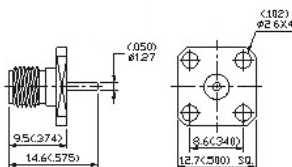

Panel Mount
Receptacle (Blunt
Post Contact)

Ordering Code	
SMA-50SAG6099BRX	Captivated
SMA-50SAG6052BRX	Epoxy Captivated

30. SMA 2 Hole Flange Jack Receptacle (Blunt Post Contact)



Finish: gold plated center contact & body
Insulation: Teflon

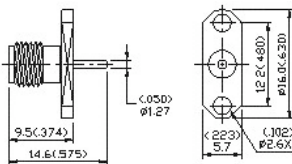

Panel Mount
Receptacle (Blunt
Post Contact)

Ordering Code	
SMA-50SAG7960BRX	

31. SMA Square Flange Jack Receptacle (Half Round Contact)



Finish: gold plated center contact & body
Insulation: Teflon

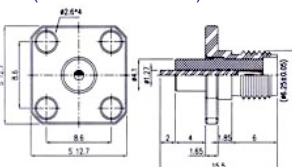

Panel Mount
Receptacle (Half
Round Contact)

Ordering Code	
SMA-50SAG7450BRX	

32. SMA 2 Hole Flange Jack Receptacle (Half Round Contact)



Finish: gold plated center contact & body
Insulation: Teflon

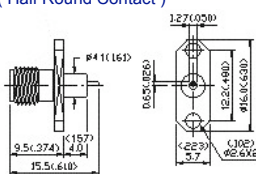

Panel Mount
Receptacle (Half
Round Contact)

Ordering Code	
SMA-50SAG5050BRX	

33. SMA Straight Bulkhead Jack Receptacle (Front Mount)



Finish: gold plated center contact & body
Insulation: Teflon

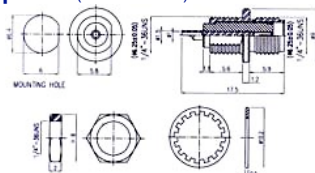

Bulkhead Mount
Receptacle (Solder
Pot Contact)

Ordering Code	
SMA-50SAG7361BRX	

34. SMA Straight Bulkhead Jack Receptacle (Rear Mount)



Finish: gold plated center contact & body
Insulation: Teflon

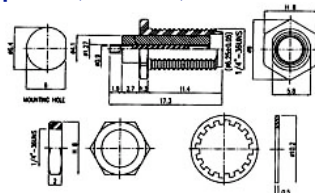

Bulkhead Mount
Receptacle (Solder
Pot Contact)

Ordering Code	
SMA-50SAG6461BRX	

35. SMA Straight PCB Mount Jack Receptacle

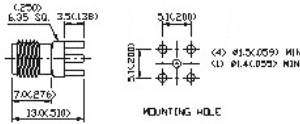

Printed Circuit Board Receptacle

Finish: gold plated center contact & body
Insulation: Teflon

Ordering Code	
SMA-50SAG5199BRX	

36. SMA Right Angle PCB Mount Jack Receptacle

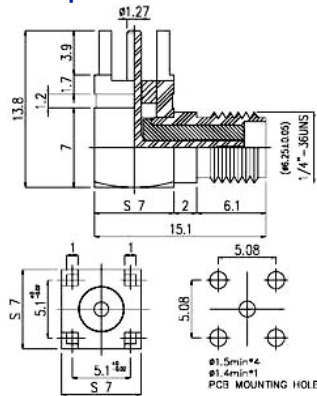

Printed Circuit Board Receptacle

Finish: gold plated center contact & body
Insulation: Teflon

Ordering Code	
SMA-50SAG7599BRX	

37. SMA Straight Surface Mount Jack Receptacle

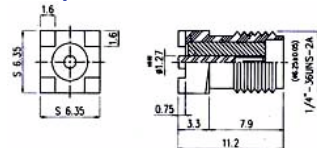

Surface Mount Receptacle

Finish: gold plated center contact & body
Insulation: Teflon

Ordering Code	
SMA-50SAG7650BRX	

38. SMA Right Angle Surface Mount Jack Receptacle

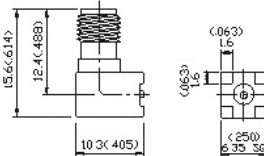

Surface Mount Receptacle

Finish: gold plated center contact & body
Insulation: Teflon

Ordering Code	
SMA-50SAG7656BRX	

39. SMA End Launch Jack Receptacle

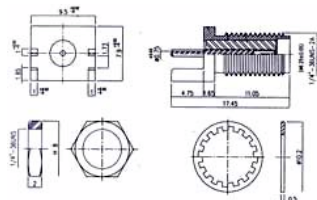

End Launch Jack Receptacle

Finish: gold plated center contact & body
Insulation: Teflon

Ordering Code	Notes
SMA-50SJG7762BRX	center contact 50 μ" gold plated
SMA-50SAG7762BRX	center contact 30 μ" gold plated

40. SMA Bulkhead Jack-Jack In-series Adapter



Finish: gold plated center contact & body
 Insulation: Teflon

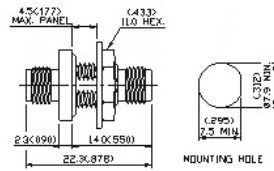

In-Series Adapter

Ordering Code
SMAS-SMASAG02X

41. SMA Plug-Plug In-series Adapter



Finish: gold plated center contact & body
 Insulation: Teflon

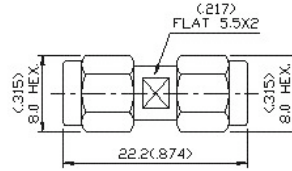

In-Series Adapter

Ordering Code
SMAP-SMAPAG01X

42. SMA Jack-Jack In-series Adapter



Finish: gold plated center contact & body
 Insulation: Teflon

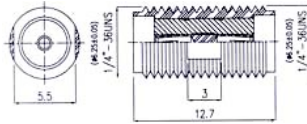

In-Series Adapter

Ordering Code
SMAS-SMASAG01X

For other plating options contact factory

43. SMA Right Angle PCB Mount Jack Receptacle



Finish: gold plated center contact & body
 Insulation: Teflon

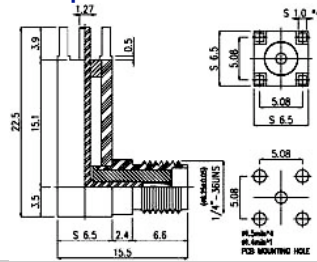

Printed Circuit Board
 Receptacle

Ordering Code
SMA-50SAG7567BRX

For other plating options contact factory

X-ON Electronics

Largest Supplier of Electrical and Electronic Components

Click to view similar products for [RF Adapters - Between Series](#) category:

Click to view products by [CONEC](#) manufacturer:

Other Similar products are found below :

[R191203007](#) [R191209000](#) [R191212000](#) [R191215000](#) [R191301000](#) [R191325000](#) [R191389200](#) [R191403000](#) [R191405000](#) [R191416000](#)
[R191419000](#) [R191421000](#) [R191424000](#) [R191445000](#) [R191511000](#) [R191552000](#) [R191720000](#) [R191722000](#) [R191733000](#) [R191759000](#)
[R191841001W](#) [R191911000](#) [R191912000](#) [R191968001W](#) [R192417010](#) [R921390000](#) [ADBJ20-E1-BJ379](#) [ADM2](#) [ADPL75-A1-PL75](#)
[ADPL75-E1-UBJ20](#) [9317505](#) [931RPBUFLP](#) [AD130](#) [ADBJ20-E1-PL74](#) [ADBJ20-E2-BJ79](#) [ADBJ77-A1PL3155](#) [ADBJ77-E1-UPL20](#)
[ADBJ77-E2-PL20](#) [242215](#) [242228](#) [CP-AD851](#) [R125680000W](#) [R191117000](#) [R191123000](#) [R191.147.000](#) [R191303000](#) [R191313000](#)
[R191315000](#) [R191316700](#) [R191327000](#)