

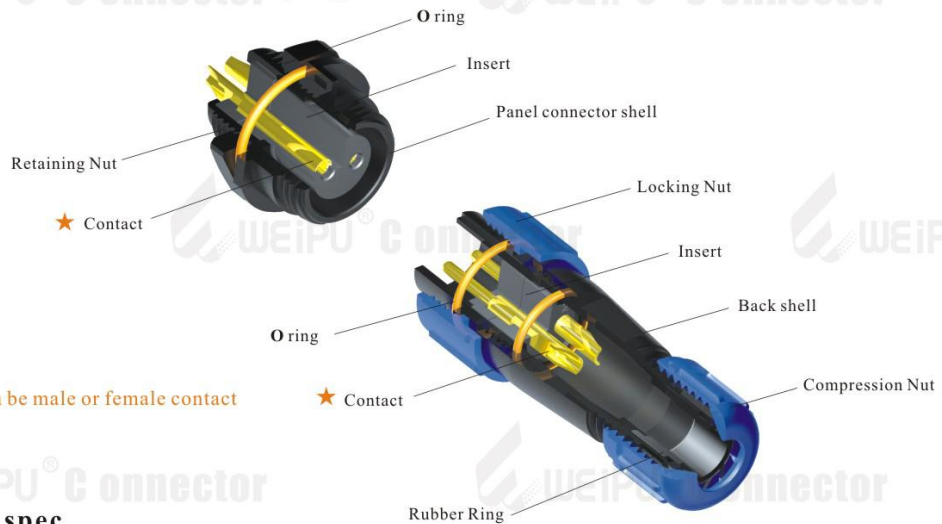

● SP13/SP17/SP21 IP68 Threaded coupling



★ Each side can be male or female contact

**Material and spec**

| Product type               | Connector  | Overmolded Cable Assemblies   |
|----------------------------|--|---|
| Coupling                   | Threaded coupling  | Threaded coupling   |
| Shell material             | Nylon66, fire resistance : V-0   | PC、PVC, fire resistance:V-0;<br>Locking nut material: Anodized aluminum |
| Insert material            | PPS max temperature 260℃, fire resistance : V-0                                  | PPS max temperature 260℃, fire resistance : V-0                         |
| Contact material           | Brass with gold plating  | Brass with gold plating   |
| Termination                | SP13:solder, SP17:solder/crimp, SP21:solder / screw/crimp                        |   |
| Cable outer diameter range | SP13 I: 4-6.5mm SP13 II: 5-8mm<br>SP17 :6-10mm<br>SP21 I: 4.5-7mm SP21 II:7-12mm |   |
| IP rating                  | IP68   | IP66  |
| Mating cycle               | >500   | >500  |
| Temperature range          | -25℃~+85℃  | -20℃~+85℃   |
| Insulation resistance MΩ   | 2000   | 2000  |

## SP21 Series IP68

**SP  
21**



**Cable connector**  
Mate with SP2111, SP2112, SP2113

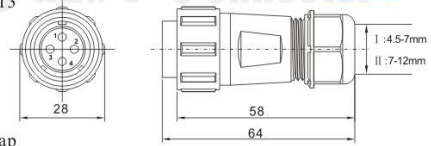

SP2110/P --- SP2110/S

- C: with cap, N: without cap
- 1: solder, 2: screw, 3: crimp
- Cable outer diameter I : 4.5-7mm, II : 7-12mm
- Number of contact: 2,3,4,5,5B,5C,7,8,9,12



**In-line cable connector**  
Mate with SP2110

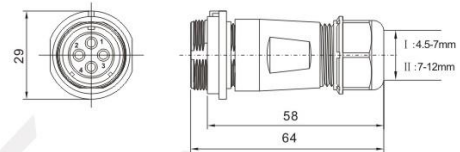

SP2111/P --- SP2111/S



**Front mount**  
Mate with SP2110

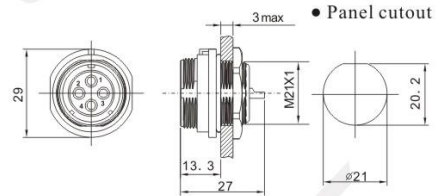

SP2112/P --- SP2112/S



**2-hole flange**  
Mate with SP2110

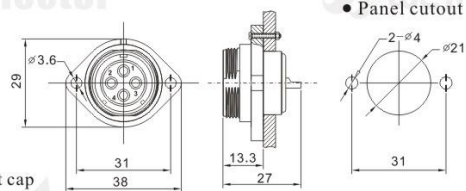

SP2113/P --- SP2113/S





- C: with cap, N: without cap
- 1: solder, 2: screw, 3: crimp
- Number of contact: 2,3,4,5,5B,5C,7,8,9,12

### Contact arrangement and spec for solder/screw

★ For crimp spec see P49-P52

| Number of contact              | 2              | 3              | 4              | 5              | 5B                    | 5C     | 7      | 9         | 12        |
|--------------------------------|----------------|----------------|----------------|----------------|-----------------------|--------|--------|-----------|-----------|
| Male contact face view         |                |                |                |                |                       |        |        |           |           |
| Rated current (A)              | 30A            | 30A            | 30A            | 30A            | 5A, 30A               | 15A    | 15A    | 5A        | 5A        |
| Contact diameter               | ∅ 3X2          | ∅ 3X3          | ∅ 3X4          | ∅ 3X5          | ∅ 1X3<br>∅ 3X2        | ∅ 2X5  | ∅ 2X7  | ∅ 1X9     | ∅ 1X12    |
| Termination                    | solder / screw | solder / screw | solder / screw | solder / screw | solder / screw        | solder | solder | solder    | solder    |
| Rated voltage (AC.V)           | 500V           | 500V           | 500V           | 500V           | 500V                  | 500V   | 500V   | 500V      | 400V      |
| Test voltage(AC.V) 1 min       | 1500V          | 1500V          | 1500V          | 1500V          | 1500V                 | 1500V  | 1500V  | 1500V     | 1200V     |
| Contact resistance $\Omega$    | 1              | 1              | 1              | 1              | 5, 1                  | 2.5    | 2.5    | 5         | 5         |
| Wire size mm <sup>2</sup> /AWG | ≤4.17/11       | ≤4.17/11       | ≤4.17/11       | ≤4.17/11       | ≤0.785/18<br>≤4.17/11 | ≤2/14  | ≤2/14  | ≤0.785/18 | ≤0.785/18 |

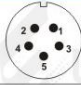
★ Crimp contact arrangement and spec for WS,WF,WY,WP,SP,SY series

| WS20、WF20、WY20、WP20<br>SP21、SY21 | 2   | 3   | 5   | 7   | 8   |
|----------------------------------|---|---|---|---|---|
| Male contact face view           |  |  |  |  |  |
| Rated current (A)                | 25A   | 25A   | 10A   | 10A   | 5A  |
| Contact diameter                 | ∅ 2.5X2   | ∅ 2.5X3   | ∅ 1.5X5   | ∅ 1.5X7   | ∅ 1X8   |
| Rated voltage (AC.V)             | 500V  | 500V  | 500V  | 500V  | 500V  |
| Test voltage(AC.V) 1 min         | 1500V   | 1500V   | 1500V   | 1500V   | 1500V   |
| Contact resistance mΩ            | 1   | 1   | 2.5   | 2.5   | 5   |
| Insulation resistanceMΩ          | 2000  | 2000  | 2000  | 2000  | 2000  |

## X-ON Electronics

Largest Supplier of Electrical and Electronic Components

*Click to view similar products for [Circular Push Pull Connectors](#) category:*

*Click to view products by [Weipu](#) manufacturer:*

Other Similar products are found below :

[FEA.1B.308.CYCD72Z](#) [D38999/20ZC8JA](#) [D38999/20ZG39BN](#) [D38999/20ZG41PN-LC](#) [D38999/20ZH21SA](#) [D38999/20ZH53SA](#)  
[D38999/20ZJ24SA](#) [D38999/20ZJ29PA-LC](#) [D38999/20ZJ43HA](#) [D38999/20ZJ43PA-LC](#) [D38999/20ZJ61PA-LC](#) [D38999/24ZF11SA-LC](#)  
[D38999/24ZF32BA](#) [D38999/24ZF32PA-LC](#) [D38999/24ZF32SA-LC](#) [D38999/24ZF35BA](#) [D38999/24ZF35SA-LC](#) [EXG.00.250.NTNY](#)  
[FFA.00.250.CTAZ](#) [FFA.1S.302.CLAZ](#) [FFA.1Y.410.CTAC52](#) [FFA.2S.310.ZLA](#) [FFG.1B.302.CLAD52Z](#) [FFG.1B.304.CLAD42Z](#)  
[FFG.1B.304.CLAD72Z](#) [FFG.1B.308.CLAD42Z](#) [FGA.1B.304.CLAD62Z](#) [FGA.1B.304.CYCD72Z](#) [FGA.1B.305.CLAD76](#)  
[FGA.1B.306.CYCD72](#) [FGA.1B.307.CYCD72Z](#) [FGA.1B.308.CLAD76Z](#) [FGA.1B.308.CYCD42Z](#) [FGA.1B.308.CYCD52Z](#)  
[FGA.1B.308.CYCD72Z](#) [FGA.1B.310.CLAD42](#) [FGA.1B.310.CLAD52Z](#) [FGA.1B.316.CLAD42](#) [FGA.1B.316.CLAD62Z](#)  
[FGA.1B.316.CLAD76](#) [FGB.0B.307.CYCD31Z](#) [FGB.1B.302.CLAD72](#) [FGB.1B.303.CYCD62](#) [FGB.1B.305.CLAZ](#) [FGB.1B.307.CYCD62Z](#)  
[FGB.1B.316.CLAD42](#) [FGC.0B.309.CLAD56](#) [FGC.1B.304.CLAD52Z](#) [FGC.1B.305.CLAD52Z](#) [FGC.1B.308.CLAD42](#)