

REV
-
0
P

DESCRIPTION
SEE ENGINEERING FOR REV. A-N
SEE ECN #1260 FOR CHANGES
SEE ECN #1327 FOR CHANGES

ENGR DATE
-
SK 12.06.06
SK 05.23.07

TOLERANCES
UNLESS NOTED
XX=±.010
XXX=±.005
FRAC=1/64
ANG=1°

RICHCO, INC.
RICHCO INC.
PO BOX 804238, CHICAGO, 60680
(773) 539-4060

CA
PRINT TYPE
SEE CHART
PART #
FINAL

SNAP-RIVETS

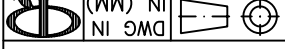

NOTES:
1. MATERIAL: NYLON 6, (RMS-52)
COLOR: BLACK & WHITE STANDARD.
ADD "B" FOR BLACK AND "W" FOR WHITE ON THE
END OF PART NUMBER
2. MATERIAL: NYLON 66/6, UL94 V-0, (RMS-103)
AVAILABLE BY SPECIAL ORDER.
TO ORDER USE P/N: SRV0-XXXX
COLOR: BLACK.
ALSO AVAILABLE IN COLOR WHITE BY SPECIAL ORDER.
TO ORDER ADD "W" TO THE END OF PART NO.
3. GREEN (GN), YELLOW (YL), RED (RD), BLUE (BL),
AND GRAY (GY), AVAILABLE BY SPECIAL ORDER ONLY.

FIG. NO.	"E" ±.012 (±0.3)	"D" "	"C" ±.012 (±0.3)	"B" ±.008 (±0.2)	"A" ±.008 (±0.2)	THICKNESS "F" "	EXTRACTION FORCE LB (KG)	HOLE DIA. "G" "	MATL: NYLON 6 (RMS-52) PART NO.
1	.11 (2.8) .15 (3.8) .22 (5.5) .28 (7.2) .28 (7.1)	.079 (2.0)	.16 (4.0) .19 (4.8) .22 (5.6) .25 (6.4) .25 (6.4)	.047 (1.2)	.165 (4.2)	6.6 MIN. (3 MIN.)	.051-.079 (1.3-2.0) .083-.110 (2.1-2.8) .114-.142 (2.9-3.6) .146-.173 (3.7-4.4) .173-.197 (4.4-5.0)	.083-.110 (2.1-2.8) .114-.142 (2.9-3.6) .146-.173 (3.7-4.4) .173-.197 (4.4-5.0)	SR-2024 SR-2032 SR-2040 SR-2048 SR-2056 SR-2064
1	.18 (4.5) .24 (6.1) .28 (7.1) .35 (9.0) .43 (11.0)	.102 (2.6)	.17 (4.2) .19 (4.8) .22 (5.5) .25 (6.4) .25 (6.4)	.055 (1.4)	.197 (5.0)	11.0 MIN. (5 MIN.)	.079-.118 (2.0-3.0) .106-.142 (2.7-3.6) .134-.169 (3.4-4.3) .169-.205 (4.3-5.2) .201-.236 (5.1-6.0)	.079-.118 (2.0-3.0) .106-.142 (2.7-3.6) .134-.169 (3.4-4.3) .169-.205 (4.3-5.2) .201-.236 (5.1-6.0)	SR-2672 SR-2664 SR-2648 SR-2642 SR-2632 SR-2064
1	.20 (5.1) .24 (6.1) .28 (7.1) .35 (9.0) .43 (11.0)	.118 (3.0)	.14 (3.5) .18 (4.5) .22 (5.5) .26 (6.5) .30 (7.5) .31 (8.0) .35 (9.0) .39 (10.0)	.063 (1.6)	.252 (6.4)	17.6 MIN. (8 MIN.)	.039-.079 (1.0-2.0) .079-.118 (2.0-3.0) .118-.158 (3.0-4.0) .158-.197 (4.0-5.0) .197-.236 (5.0-6.0) .236-.275 (6.0-7.0) .275-.314 (7.0-8.0) .314-.353 (8.0-9.0)	.039-.079 (1.0-2.0) .079-.118 (2.0-3.0) .118-.158 (3.0-4.0) .158-.197 (4.0-5.0) .197-.236 (5.0-6.0) .236-.275 (6.0-7.0) .275-.314 (7.0-8.0) .314-.353 (8.0-9.0)	SR-3035 SR-3045 SR-3055 SR-3065 SR-3075 SR-3080 SR-3090 SR-3100 SR-3535 SR-3545 SR-3550 SR-3555 SR-3560 SR-3570 SR-3580 SR-4080 SR-4090
2	.20 (5.1) .24 (6.1) .28 (7.1) .35 (9.0) .36 (9.1)	.138 (3.5)	.20 (5.0) .24 (6.0) .28 (7.0) .31 (8.0) .31 (8.0)	.063 (1.6)	.252 (6.4)	26.4 MIN. (12 MIN.)	.047-.083 (1.2-2.1) .083-.118 (2.1-3.0) .106-.142 (2.7-3.6) .146-.181 (3.7-4.6) .177-.217 (4.5-5.5) .217-.256 (5.5-6.5) .256-.295 (6.5-7.5) .295-.335 (7.5-8.5)	.047-.083 (1.2-2.1) .083-.118 (2.1-3.0) .106-.142 (2.7-3.6) .146-.181 (3.7-4.6) .177-.217 (4.5-5.5) .217-.256 (5.5-6.5) .256-.295 (6.5-7.5) .295-.335 (7.5-8.5)	SR-4050 SR-4060 SR-4070 SR-4080 SR-4090 SR-4100 SR-4120
2	.26 (6.5) .33 (8.5) .41 (10.5) .47 (12.0)	.197 (5.0)	.18 (4.5) .22 (5.5) .26 (6.5) .30 (7.5) .33 (8.5) .37 (9.5) .41 (10.5)	.087 (2.2)	.354 (9.0)	55.0 MIN. (25 MIN.)	.059-.098 (1.5-2.5) .098-.138 (2.5-3.5) .138-.177 (3.5-4.5) .177-.217 (4.5-5.5) .217-.256 (5.5-6.5) .256-.295 (6.5-7.5) .295-.335 (7.5-8.5) .335-.375 (8.5-9.5)	.059-.098 (1.5-2.5) .098-.138 (2.5-3.5) .138-.177 (3.5-4.5) .177-.217 (4.5-5.5) .217-.256 (5.5-6.5) .256-.295 (6.5-7.5) .295-.335 (7.5-8.5) .335-.375 (8.5-9.5)	SR-5045 SR-5055 SR-5065 SR-5075 SR-5085 SR-5095 SR-5105 SR-6060 SR-6080
2	.236 (6.0) .35 (9.0) .39 (10.0)	.236 (6.0)	.24 (6.0) .31 (8.0) .41 (10.5)	.098 (2.5)	.472 (12.0)	66.0 MIN. (30 MIN.)	.098-.158 (2.5-4.0) .158-.217 (3.5-5.5)	.098-.158 (2.5-4.0) .158-.217 (3.5-5.5)	

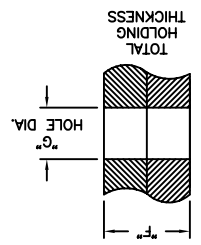
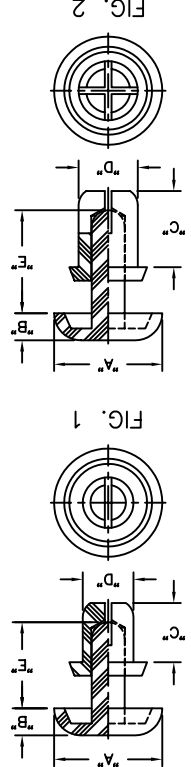

X-ON Electronics

Largest Supplier of Electrical and Electronic Components

Click to view similar products for [Vibration Sensors](#) category:

Click to view products by [Richco](#) manufacturer:

Other Similar products are found below :

[D7H-B2](#) [D7H-A1](#) [SCA1000-N1000070-004](#) [LDTC-VERTICAL](#) [SR-4070B](#) [SR-3080B](#) [SR-3065W](#) [SR-3065B](#) [SLG-2M-B](#) [2-1002908-0](#) [1-1002910-0](#) [1-1002786-1](#) [2-1002785-1](#) [1-1002908-0](#) [1-1002608-0](#) [1-1002785-1](#) [2-1002608-0](#) [1006015-1](#) [2-1003744-0](#) [1-1003745-0](#) [2-1002150-0](#) [1-1002150-0](#) [1005935-1](#) [1-1003744-0](#) [3-1004347-0](#) [1001777](#) [1-1004696-0](#) [1-1004347-0](#) [1-1004346-0](#) [PKGS-25TA-R](#) [3-1004346-0](#) [D7S-A0001](#) [SR-3045B](#) [PCH420V-M12-HZ](#) [RB-220-07A R](#) [VS-BV203-B](#) [VS-JV10A-K03](#) [VS-JV10A-K01](#) [VS-JV10A](#) [VS-JV10A-K02](#) [VS-JV10A-K04](#) [1005939-1](#) [1005940-1](#) [PKGS-25SXAP1-R](#) [SCA830-D07-1](#) [D7E-1](#) [D7E-2](#) [D7H-B1](#) [RBS070500T](#) [29132](#)