

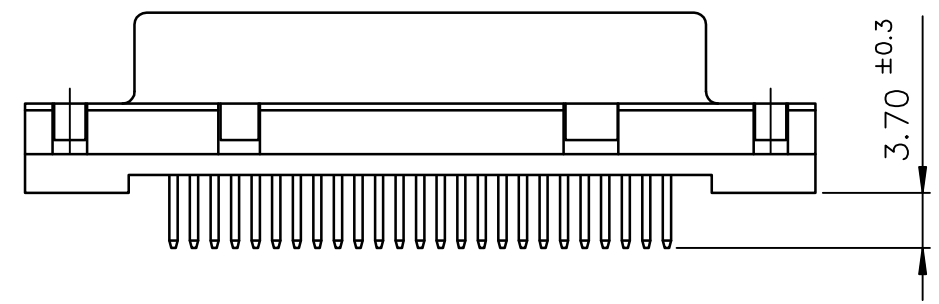

FCIconnect.com

Copyright FCI

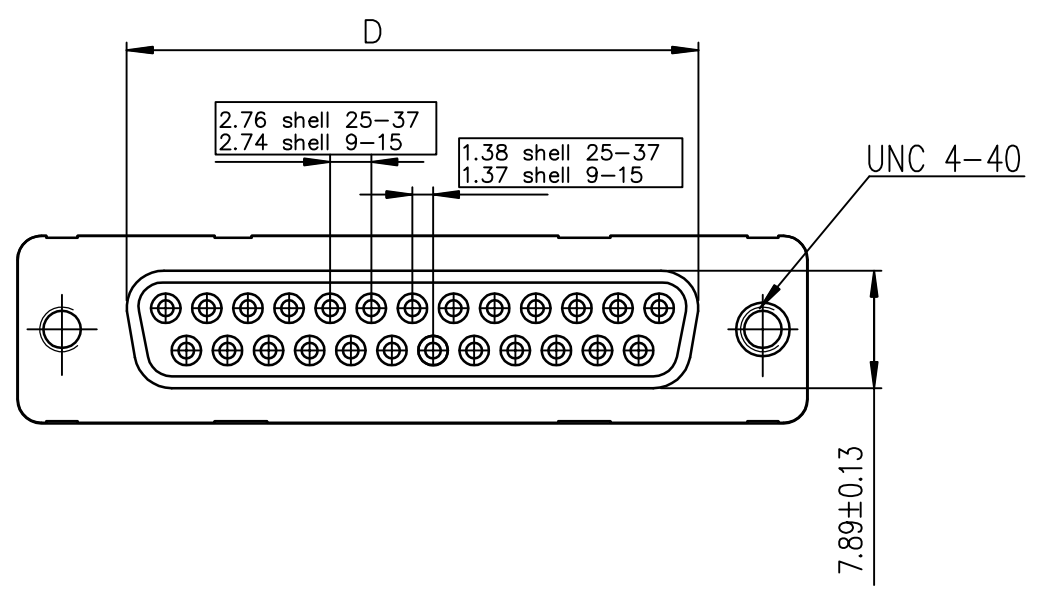
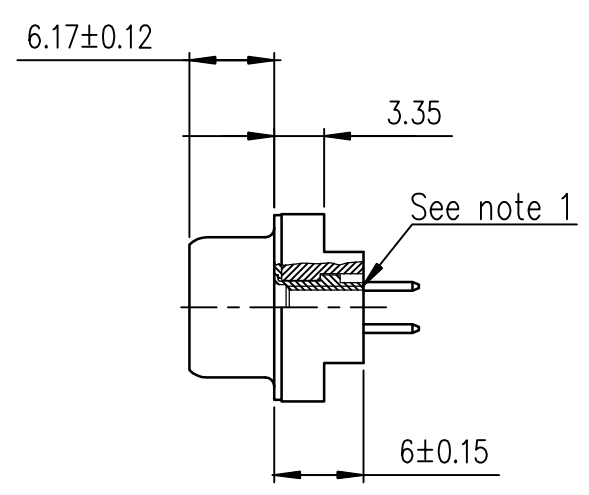
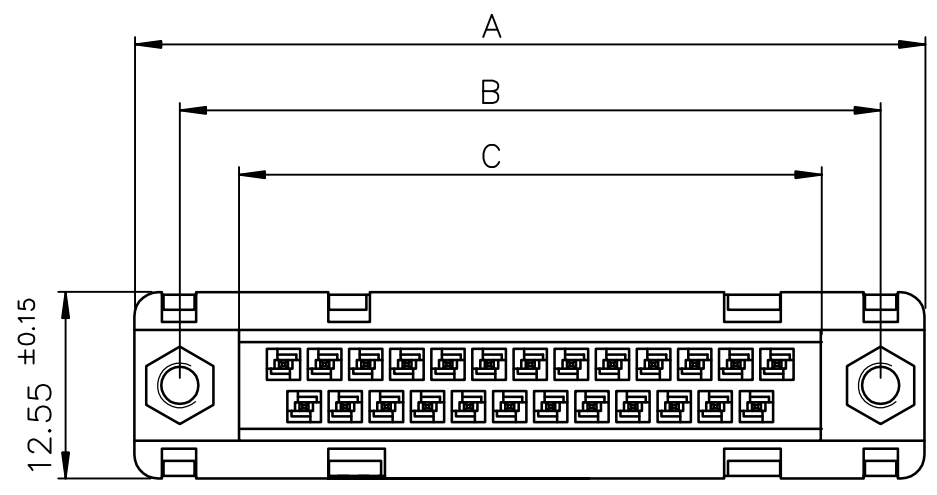

PC card drilling dimensions(after plating)  
(thickness 2.40±0.20mm)

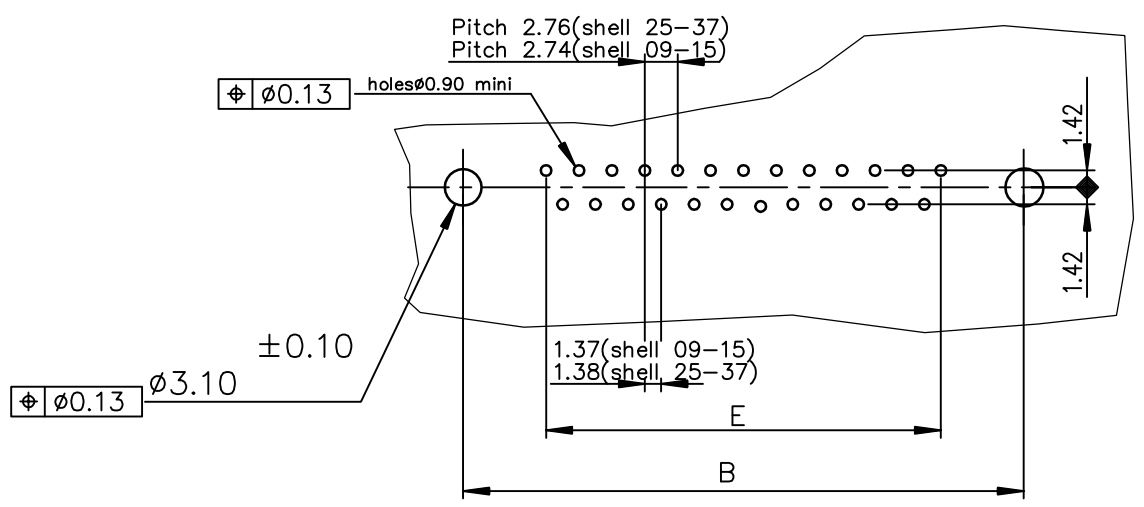

GENERAL CHARACTERISTICS AND ROHS INFORMATIONS:  
SEE DRAWING C01-8646-0000

LEAD FREE PART NUMBER

SHELL	A±0.38	B±0.12	C±0.10	D±0.25	E±0.07	PART NUMBER
09	30.81	24.99	16.96	16.21	10.96	D09S24B.PX00LF
15	39.14	33.32	25.18	24.54	19.18	D15S24B.PX00LF
25	53.03	47.04	39.12	38.25	33.12	D25S24B.PX00LF
37	69.32	63.50	55.68	54.71	49.68	D37S24B.PX00LF

Plating: 4 --> flash AU  
Plating: 6 --> 0.76µ AU

Notes:

1) The nut can protrude above the surface of insulator but maintaining the footprint dimension 6±0.15 mm.

mat'l. code				surface			tolerance			projection		product family			
-				ISO 1302 ✓			ISO 406 ISO 1101					D-SUB			
ltr				ecn no				dr				date			
E				ELX-I-22878				AB				2015/01/06			
angles				linear				.0±0.1				tolerances unless otherwise specified			
0±2'								.00±0.1				MM			
								.000±0.1				scale 2:1			
dr				LELEON				1992/09/16				title			
enr				ALIAS BABU				2015/01/06				FEMALE CONNECTOR DELTA-D			
chr				MITHUN PAUL				2015/01/06				STRAIGHT - SOLDER TYPE FOR PCB 2.4mm			
app				BIJU K PAUL				2015/01/06				dwg no			
												sheet 1 of 1			
												size			
												A3			
												type			
												Product Customer Drawing			
sheet index		revision sheet		E		1									

## X-ON Electronics

Largest Supplier of Electrical and Electronic Components

*Click to view similar products for [D-Sub Standard Connectors](#) category:*

*Click to view products by [FCT Electronics](#) manufacturer:*

Other Similar products are found below :

[DCM37S732N](#) [DAM15P500](#) [DEV09S364GTLF](#) [DEM09P032N](#) [DDM50P732N](#) [DAM15S332N](#) [173109-2218](#) [173109-2466](#) [173109-2436](#)  
[173109-2435](#) [56F706-005-LI](#) [56F711-015](#) [015-0341-000](#) [015-0372-008](#) [015-8544-011](#) [017041-0005](#) [020419-0104](#) [012-0515-000](#) [012-9507-](#)  
[034](#) [012-9507-114](#) [012-9534-001](#) [020745-0008](#) [609-25P](#) [M24308/2-23Z](#) [M243082310F](#) [M243082410F](#) [M243082411F](#) [M24308/4-21](#)  
[CT1A18-11PSA206](#) [CT1N36-5SC](#) [CT2-16S-17PS](#) [CT2-20-15PCAU](#) [CT2-24-12PS](#) [CT2-24-28PSF127A206](#) [CT2-32-9PC](#) [CT6F9767-14-4-](#)  
[14S-5PC](#) [CT6FA10SL-4PS](#) [CT7-18-10SC](#) [CT7-18-10SCAU](#) [CT7-18-12SCAU](#) [CT7-18-1PC](#) [CT7-18-1PCAU](#) [CT7-18-21SCAU](#) [M83513/01-](#)  
[FC](#) [M83723/76W24619 L/C](#) [M85049/48-3-2F](#) [69001-865](#) [6STD09PCM99B70X](#) [6STD09SCM99B30X](#) [6STD09SCT99S40X](#)