

**FGJ.1B.310.CLLD52**

Status Active

Size/Series 1B / B

Matching EGJ.1B.310.CLA

[Request a quote](#)
**MECHANICAL DETAILS**

**Shell Style/Model** FG\*: Straight plug, cable collet  
**Keying** 2 keys (gamma=45, plug: female contacts, receptacle: male contacts)  
**Housing Material** Brass (chrome plated) shell and collet nut, nickel plated brass latch sleeve and mid pieces  
**Cable Fixing** D52: 4.3 - 5.2 mm  
**Variant** :  
**Matching Cable** CMN.10.T28.052PGCE  
 CMN.10.T28.052PNCE

**PERFORMANCE DETAILS**

**Insert Configuration** 1B.310: 10 Low Voltage  
**Insulator** L: PEEK  
**Contact Type:** Solder  
**Max. Matings:** 5000  
**Contact Dia.:** 0.5 mm (0.02in)  
**Bucket Dia.:** 0.45 mm (0.018in)  
**Max. Solid Conductor:** 0.09 mm<sup>2</sup> (AWG 28)  
**Max. Stranded Conductor:** 0.09 mm<sup>2</sup> (AWG 28)  
**R(max):** 8.7 mOhm  
**Rated Current (A):** 2.5  
**Vtest (contact-shell):** 1500 V (AC), 2120 V (DC)  
**Vtest (contact-contact):** 900 V (AC), 1270 V (DC)  
**Spanner:** DCP.91.001.TN

**OTHER CHARACTERISTICS**

**Endurance (Shell)**  
**Temp (min)** -55°C deg  
**Temp (max)** +250°C deg  
**Humidity (max):** <=95% [at 60 deg C/140 F]  
**Vibration:** 15 g [10 Hz - 2000 Hz]  
**Shock Resistance:** 100 g [ 6 ms]  
**Salt Spray Corrosion:** >1000 hr  
**Climatical Category:** 50/175/21  
**Shielding (min):** 75 dB (10 MHz)  
**Shielding (min):** 40 dB (1 GHz)  
**IP Rating** 50

[Catalog](#)

	A	L	M	S1	S2
mm	12	43	32	10	9
in.	0.47	1.69	1.26	0.39	0.35

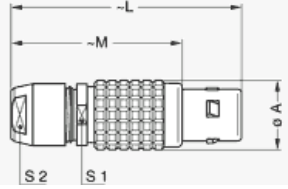
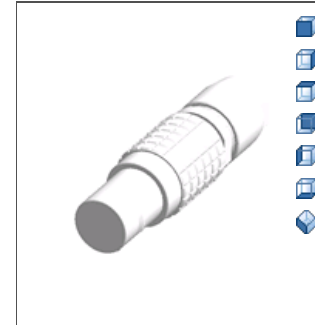
[Download 3D draw](#)

## X-ON Electronics

Largest Supplier of Electrical and Electronic Components

*Click to view similar products for [Circular MIL Spec Connector](#) category:*

*Click to view products by [LEMO](#) manufacturer:*

Other Similar products are found below :

[89075GULPR](#) [0025-262-542](#) [0025-264-3014](#) [58-570121-04S](#) [0134-213-1208](#) [0134-213-2209](#) [0025-258-000](#) [60-042022-07P](#) [60-042022-19P](#)  
[60-042022-23P](#) [60-042217-10P](#) [60-042217-11P](#) [0114-201-1278](#) [012-0467-000](#) [602GB06EG24-61SN](#) [0134-201-1207](#) [0134-213-1006](#) [6104-](#)  
[207-2302](#) [6104-208-1902](#) [61-168211-04P](#) [61-168617-10P](#) [6131-202-19149P](#) [6131-204-21149P](#) [6131-208-13149P](#) [6131-209-17149P](#) [6131-](#)  
[210-11149P](#) [6131-211-19149P](#) [6131-216-19149P](#) [6131-259-21149P](#) [6131-259-23149P](#) [6131-265-17149P](#) [6131-265-19149P](#) [CS3100A18-1P-](#)  
[472](#) [CS3100A-36-77P](#) [CS3101A-16-55P](#) [CS3102A-10SL-55P](#) [CS3102A-14S-58P](#) [CS3102A-18-1P116](#) [CS3102A-32-17P](#) [CS3102A32-25S](#)  
[CS3102C18-4P-472](#) [CS3106A10SL3S004](#) [CS3106A-18-73S](#) [CS3108A-14S-52S](#) [CS3108A-28-51S](#) [6162-233-1277](#) [6162-324-1231](#)  
[M243082296Z](#) [M2884010AC1S1](#) [CT0-24-10SC](#)