

Male

Dimensions

Positions	A	B	C	E
15	30.81	24.99	16.92	2.29
26	39.20	33.30	25.25	2.29
44	53.05	47.04	38.96	2.29
62	69.40	63.50	55.42	2.41

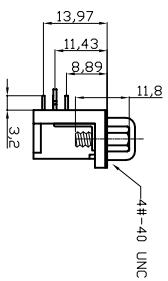
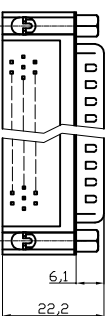
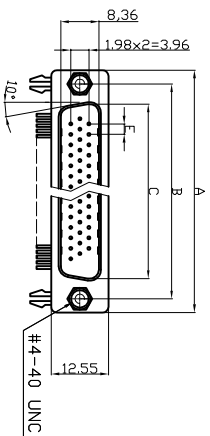
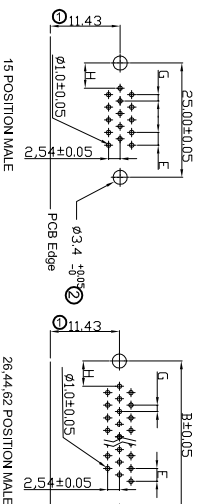
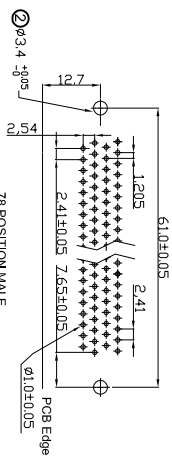
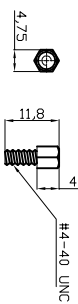
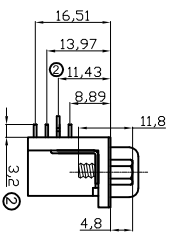
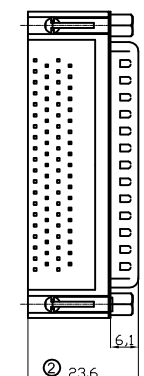
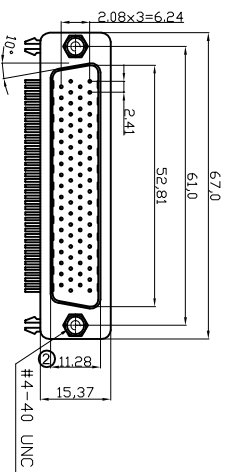

Positions	G	H
15MMF	1.145	7.04
26MMF	1.145	6.88
44MMF	1.145	6.88
62MMF	1.205	7.00

1

2

3

4

5

6

7

Product Specification**Material**

Insulator : Glass-Filled Thermoplastic PBT, UL94V-0 rated, Black
 Contact : Copper alloy, Gold flash full gold
 Shell : Steel, 100u" Tin Over 50u" min Copper
 Clinch Nut: Brass, 100u" min Nickel Plated.
 Boardlock : Brass, 100u" min Nickel Plated.
 Screwlock : Brass, 100u" min Nickel Plated.

Electrical

Contact Resistance : .20 milliohms Max at 1 AMP DC.
 Insulation Resistance : 1000 megohms at 500 VDC.
 Dielectric Withstanding Voltage : 1000 VAC/rms 60Hz for 1 minute
 Current Rating : .3 AMP
 Voltage Rating : 250 VAC/rms 60Hz
 Operating Temperature : -20°C ~ +85°C

Order Code:

A-HDX xx A-KG/T

Contact style: _____

No. of Contacts

15 / 26 / 44 / 62

S - Male

Standard: Quality class III

RoHS compliant
 Unit: mm

Scale	Free
TOLERANCE	
X.	±0.38
X.X	±0.25
X.XX	±0.13
DIM	TOL
X. °	±3°
X.X°	±1.0°
Angle	TOL

Free	Free	Free	Free	Free	Free
①	Add the dimension of PCB edge	①	Drawn	15.08.2012	Lucas
②	Update the dimension	②	Winnie	27.02.2015	
③		③	Ray	19.02.2014	
④		④	Lucas	15.08.2012	
⑤		⑤	Ray	27.02.2015	

Free	Free	Free	Free	Free	Free
Drawn	15.08.2012	Lucas			
Approved	27.02.2015	Ray			

Customer-No.	Customer-No.	Customer-No.	Customer-No.
ASSMANN WSW-No.	ASSMANN WSW-No.	ASSMANN WSW-No.	ASSMANN WSW-No.
A-HDX xx A-KG/T	A-HDX xx A-KG/T	A-HDX xx A-KG/T	A-HDX xx A-KG/T
Drawing-No.	Drawing-No.	Drawing-No.	Drawing-No.
ASS 4897 CO	ASS 4897 CO	ASS 4897 CO	ASS 4897 CO
Replace	Replace	Replace	Replace
rev02	rev02	rev02	rev02
Sheet 1/3	Sheet 1/3	Sheet 1/3	Sheet 1/3

1

2

3

4

5

6

7

H

G

F

E

D

C

B

A

H

G

F

E

D

C

B

A

1

2

3

4

5

6

7

Female

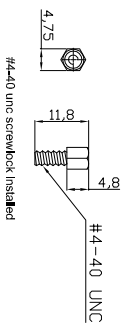
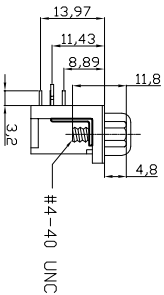
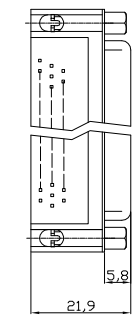
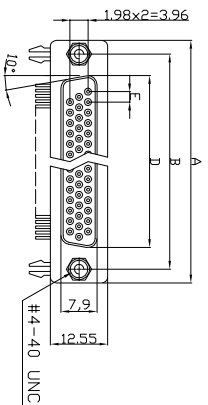

Dimensions

Positions	A	B	D	E
15	30.81	24.99	16.33	2.29
26	39.20	33.30	24.70	2.29
44	53.05	47.04	38.40	2.29
62	69.40	63.50	54.80	2.41

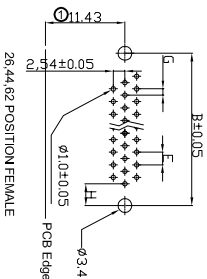
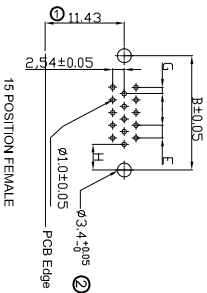
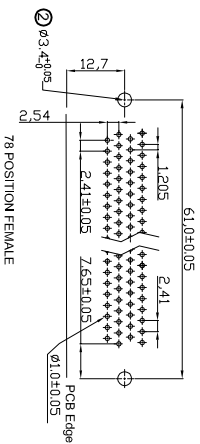
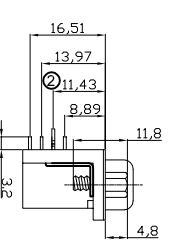
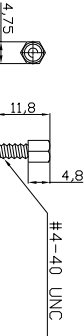
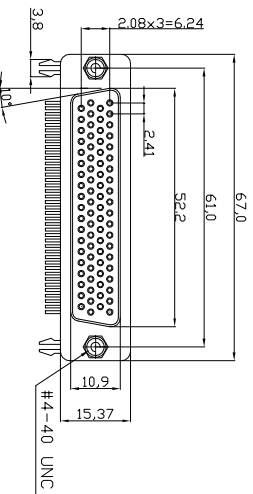

P.C.B LAYOUT PATTERN

Product Specification

Material

- Insulator : Glass-Filled Thermoplastic PBT UL94V-0 rated ,Black
- Contact : Copper alloy, Gold flash full gold
- Shell : Steel,100u" Tin Over 50u" min Copper
- Clinch Nut: Brass, 100u" min Nickel Plated.
- Boardlock :Brass, 100u" min Nickel Plated.
- Screwlock :Brass, 100u" min Nickel Plated.

Electrical

- Contact Resistance :20 milliohms Max at 1 AMP DC.
- Insulation Resistance :1000 magohms at 500 VDC.
- Dielectric Withstanding Voltage : 1000 VAC/rms 60Hz for 1 minute
- Current Rating :3 AMP
- Voltage Rating :250 VAC/rms 60Hz
- OPERATING TEMPERATURE:-20°C+85°C

Positions	G	H
15M/F	1,145	7.04
26M/F	1,145	6.88
44M/F	1,145	6.88
62M/F	1,205	7.00

78 Positions

Scale	Free
TOLERANCE	
X.	±0.38
X.X	±0.25
X.XX	±0.13
DIM	TOL
X. °	±3°
X.X°	±1.0°
Angle	TOL

Id.	Modification	Date	Name
①	Add the dimension of PCB edge	19.02.2014	Ray
②	Update the dimension	27.02.2015	Wirnie
③	Drawn	15.08.2012	Lucas

Date	Name
Drawn 15.08.2012	Lucas
Approved 27.02.2015	Ray



Customer-No.	Drawing-No.	Replace
	ASSMANN WSW-No. A-HDX XX A-KG/T	ASS 4897 CO
		rev02
		Sheet 2/3

RoHS compliant
Unit: mm

1

2

3

4

5

6

7

H

G

F

E

D

C

B

A

1	2	3	4	5	6	7	A
1	2	3	4	5	6	7	A
1	2	3	4	5	6	7	B
1	2	3	4	5	6	7	C
1	2	3	4	5	6	7	D
1	2	3	4	5	6	7	E
1	2	3	4	5	6	7	F
1	2	3	4	5	6	7	G
1	2	3	4	5	6	7	H

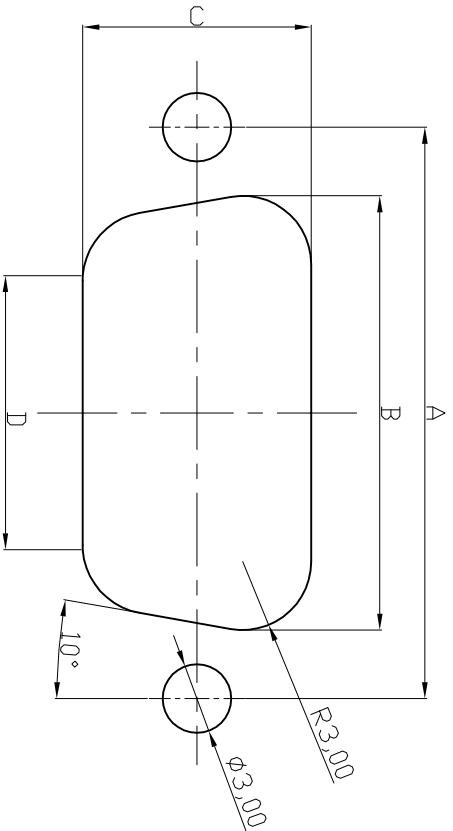

Recommended Panel Cut-Out

POSITION	A	B	C	D
15	24.99	20.47	10.67	12.01
26	33.30	28.80	10.67	20.35
44	47.04	42.52	10.67	34.06
62	63.50	59.08	10.67	50.62
78	61.00	56.34	14.10	46.90

RoHS compliant
Unit: mm

Scale	Free						
TOLERANCE							
X.	±0.15						
X.X	±0.10						
X.XX	±0.05	②	Update the dimension	27.02.2015	Wirtie		
DIM	TOL	①	Add the dimension of PCB edge	19.02.2014	Ray		
X. °	±3°						
X.X°	±1.0°	①	Drawn	15.08.2012	Lucas		
Angle	TOL		Modification				



Customer-No.	
ASSMANN W/SW-No.	
A-HDX XX A-KG/T	
Drawing-No.	
ASS 4897 CO	rev02
Replace	Sheet 3/3

X-ON Electronics

Largest Supplier of Electrical and Electronic Components

Click to view similar products for [D-Sub Micro-D Connectors](#) category:

Click to view products by [Assmann](#) manufacturer:

Other Similar products are found below :

[M243082311F](#) [M2430834F](#) [M24308/4-6F](#) [65-1920-15](#) [M83513/01-HN](#) [M83513/03-A10N](#) [M83513/03-B14C](#) [M83513/03-D09C](#) [M83513/03-D11N](#) [M83513/03-G02N](#) [M83513/03-G05N](#) [M83513/03-G08C](#) [M83513/03-G09N](#) [M83513/03-G12N](#) [M83513/03-H13N](#) [M83513/04-E15N](#) [M83513/04-G04C](#) [M83513/10-E01NP](#) [M83513/13-B01NP](#) [M83513/13-C01NN](#) [M83513/16-A01CP](#) [M83513/22-D01NP](#) [M83513/25-B01NP](#) [6R2004A30F015](#) [6R4006A28A120](#) [703006A13F060](#) [704002A03F200](#) [705001A13F120](#) [7-1532020-5](#) [748567-1-P](#) [MDB1-31SH003](#) [MDM-15PBS-L58](#) [MDM-15PCBRM7T](#) [MDM-15PH003B-A174](#) [75-068624-59S](#) [MDM-15PH034B](#) [MDM-15SH001L](#) [MDM-15SH004B](#) [MDM-21PH003K](#) [MDM-25PH003B-A174](#) [MDM-25PHW01F-A174](#) [MDM-37PH006L-A174](#) [MDM-37PH048M5-A174](#) [MDM-37SCBRP-A174](#) [MDM-51PBS-L56](#) [MDM-51PSF](#) [MDM-51SH003M7](#) [MDM-51SSM7-A174](#) [MDM-9PBSP-L58](#) [MDM-9PH003M7](#)