



D5-SA



D5-SS

The economically priced range of **CLIFF**[®] Screened DIN Connectors is complimentary to our unscreened range. Available in either 3, 4, 5, 6, 7 and 8 pin versions, they are intended for use in many types of consumer and professional audio equipment including MIDI. We also offer a range of molded DIN Leads, contact our sales office for more details on these products.

Significant features include:

- Standard size DIN connectors, to DIN 41524.
- Built in EMI / RFI screen.
- Robust construction.
- 3 pin to 8 pin versions available.
- Right angle PCB Mounting.
- Optional 5 pin version (D5FS) with 2 front mounting holes for direct chassis grounding.
- Suitable for wave soldering.

Cliff Electronic Components, Ltd.

76 Holmethorpe Avenue, Holmethorpe Ind. Est.

Redhill, Surrey RH1 2PF. England

Tel: +44 (0) 1737 771375

Fax: +44 (0) 1737 766012

Email: sales@cliffuk.co.uk



Visit us online at:

www.cliffuk.co.uk

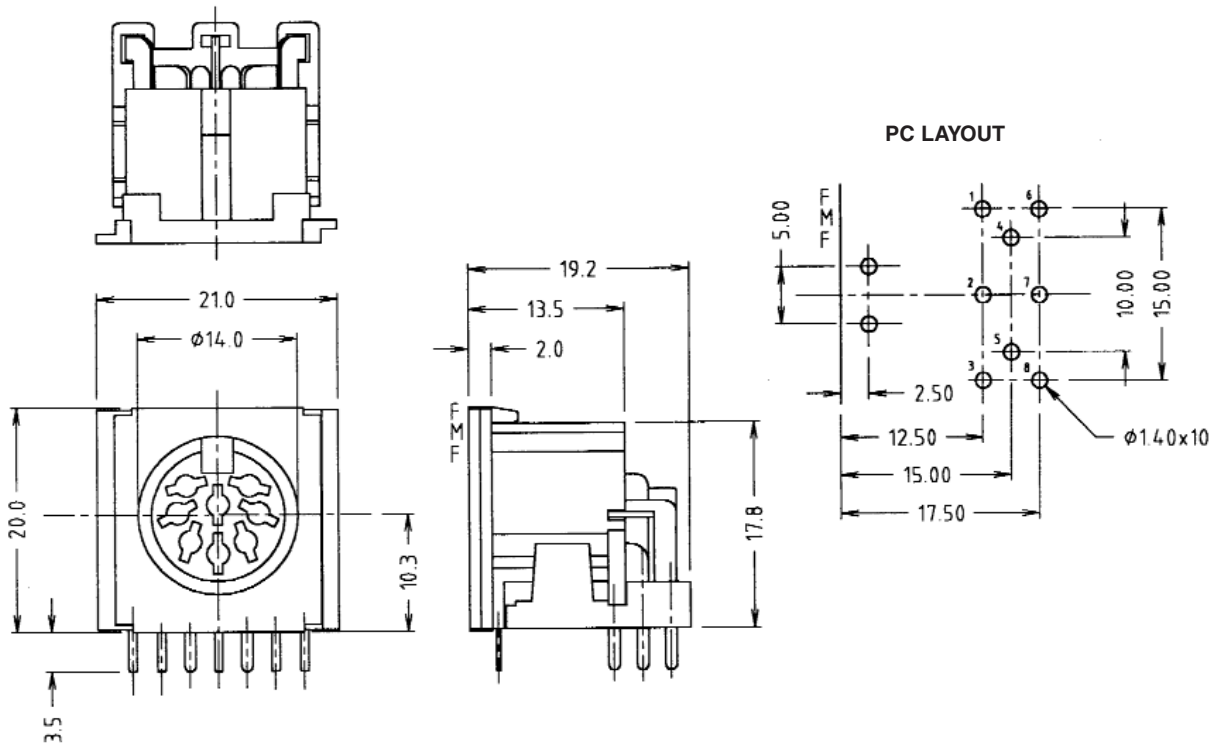

ARRANGEMENT OF CONTACTS						
MODEL No.	DIN-3SA	DIN-4SA	DIN-5SA	DIN-6SA	DIN-7SA	DIN-8SA
P/No.	FM 6723	FM 6724	FM 6725	FM 6726	FM 6727	FM 6728

Electrical Specifications:

Rated Current: 4A.

Rated Voltage: For Low Voltage use to 34Vac max.

Operating Temperature: -20 to 70 C.

Contact Resistance (new): <math><5\text{m}\Omega</math>. (mated)

Contact Resistance (after 1000 insertions): 15m Ω . max.

Mechanical Specifications:

Insertion Life (Minimum): >1000 insertions and removals

Insertion Force: <math><10\text{N}</math>

Materials:

Housing: PBT UL-94V0

Contacts: Brass

Plating: Tin

EMI/RFI Screen: Stainless Steel

X-ON Electronics

Largest Supplier of Electrical and Electronic Components

Click to view similar products for [DIN Connectors](#) category:

Click to view products by [Cliff](#) manufacturer:

Other Similar products are found below :

[60KD4M](#) [12DL6MX](#) [12JL6M](#) [164-183](#) [17DN100-EX](#) [17DN101-EX](#) [SMD7FRA011](#) [16PJ224-E](#) [171-0278](#) [17PP048-EX](#) [M55116/1-2](#)
[KQLAX-8P](#) [M55116/10-0](#) [SMD5FRA021](#) [15AN84X](#) [13AL6FX](#) [61GA5F](#) [152-002-2-4](#) [0134 05](#) [MDC-004](#) [MDC-104](#) [MDC-204](#) [MDC-208](#)
[12BPKG](#) [DC-001](#) [DC-007](#) [591-0400](#) [591-0500](#) [DS1093-01-BN40](#) [593-0700](#) [MJ-372-4](#) [MJ-372-6](#) [MJ-372-8](#) [57PC5M](#) [592-0301](#) [592-0511](#)
[164-377](#) [610-0520](#) [0105 05](#) [0105 08](#) [0107 08-1](#) [690-0300](#) [0132 05](#) [930009200 MAB 4](#) [930071200 MAB 5 S](#) [930303517 MAB 3100 S](#)
[GRAU](#) [930345200 MAB 8 S](#) [930356517 MAS 70 S GRAU](#) [930952517 MAB 5100](#) [930954517 MAB 6100 GRAU](#)