

Product Specification

Material

Insulator: Glass-filled Thermoplastic
PBT, UL94V-0 rates

Contact: Brass or Phosphor Bronze

Plated full gold or selected gold in
mating area, 100u" min. tin plated
on termination area, with entire contact

under-plated 50u" min. Nickel

Electrical

Contact Resistance: ≤ 20 milliohms
Max at 1 AMP DC.

Insulation Resistance: 5000
megohms at 500 VDC

Dielectric Withstanding Voltage:
500 VAC/rms 60Hz for 1 minute

Current Rating: 3 AMP

Voltage Rating: 250 VAC/rms 60Hz

IDC Socket:
2.54mm Pitch

Housing Color

0: Grey
1: Black

No of Positions:

06: 6 positions

:

:

64: 64 positions

Plating Options:

A1: Flash Gold

A2: 15u"/0.4um Gold

A3: 30u"/0.8um Gold

SN:Tin

T812 X XX XX C EU

EU: RoHS
Compliant
C: Fixed Index

Variation Code:

00: W/O Strain Relief
01: With Strain Relief

Dimensions

Positions		Positions	
A	B	A	B
6	12.16	5.08	40.64
8	14.74	7.62	43.18
10	17.27	10.16	48.26
12	19.85	12.70	53.34
14	22.40	15.24	60.96
Positions		Positions	
A	B	A	B
16	24.94	17.78	68.58
20	30.00	22.86	73.66
24	35.10	27.94	78.74
26	37.59	30.48	85.90
30	42.66	35.56	

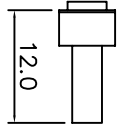
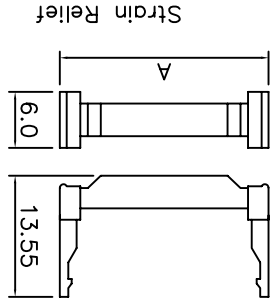
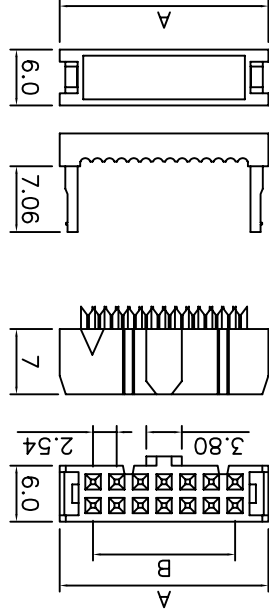

TOLERANCE (mm)

DRAWN	CHECKED	APPROVED
X. ± 0.3	Roger	
X.X. ± 0.2	Efic.	
X.XX ± 0.15	Rob K.	

APPROVALS

DATE	APPROVALS
29/Nov/2006	Roger
30/Nov/2006	Efic.
01/Dec/2006	Rob K.

UNITS: mm

SIZE	DATE
A4	01/Dec/2006

IDC Socket

T812 Series

Scale N.A. Sheet 1 of 1

Amphenol European Design Center

AMPHENOL

UNLESS OTHERWISE SPECIFIED

REV.	DESCRIPTION
B	

X-ON Electronics

Largest Supplier of Electrical and Electronic Components

Click to view similar products for [Headers & Wire Housings](#) category:

Click to view products by [Amphenol](#) manufacturer:

Other Similar products are found below :

[95000-104TRLF](#) [10135584-644402LF](#) [DF62W-EP2022PCA](#) [95000-106TRLF](#) [DF62W-2022SCA](#) [DF62W-EP2022PC](#) [2203348](#) [DF62W-2022SC](#) [1084018](#) [1029039](#) [1084017](#) [802-10-012-10-002000](#) [1112640](#) [1112639](#) [891-007-9SS-BST1T](#) [000-34000](#) [0008550134](#) [0009482033](#) [0009507031](#) [57102-F02-18ULF](#) [57102-S06-03LF](#) [57202-S52-04LF](#) [PCN6-15S-2.5E](#) [0039019024](#) [58102-G61-06LF](#) [582553-1](#) [0009485154](#) [0009508121](#) [0022285053](#) [0050291907](#) [018731A](#) [LY20-4P-DT1-P1E-BR](#) [02.125.8002.8](#) [60101931](#) [60598-1 \(Cut Strip\)](#) [M1625-3R/100](#) [61062-3](#) [61082-181009](#) [CSU011177004](#) [636-1427](#) [638009-1](#) [641938-9](#) [641991-4](#) [644168-1](#) [644827-2](#) [647662-1](#) [65039-019ELF](#) [65692-001LF](#) [65781-018](#) [65781-047](#)