

MARKETING SALES DRAWING

DIMENSIONS IN INCHES - DO NOT SCALE THIS DRAWING
DIMENSIONS IN METRIC - []

This drawing is the property of Tusonix, Inc., and may not be used, reproduced, published or disclosed to others without expressed authorization by Tusonix Inc.

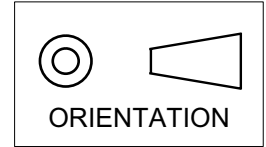

Electrical Testing
per Tusonix standard
test plans and Mil-Std-202
Test Methods.

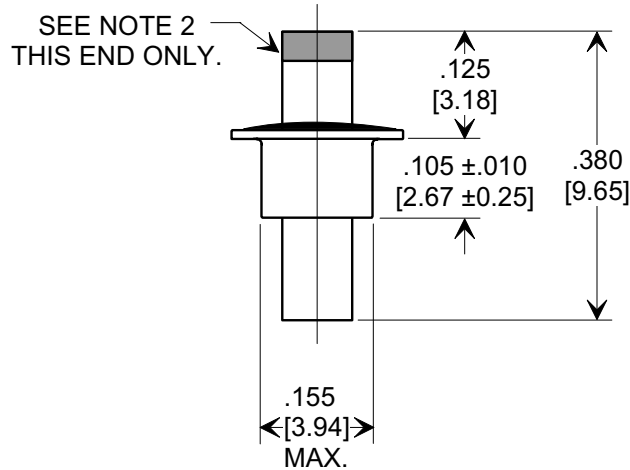
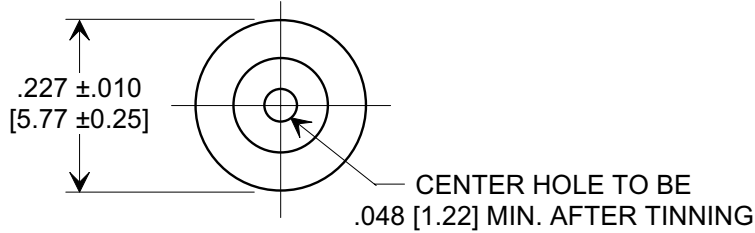
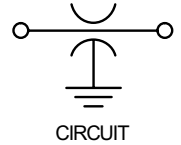

NOTES:

- TUSONIX STANDARD PART NUMBER: 2404-620-X5U0-102P.
 TUSONIX RoHS COMPLIANT PART NUMBER: 2404-620-X5U0-102P LF.
 CUSTOMER MUST SPECIFY STANDARD OR RoHS PART NUMBER WHEN ORDERING.
- CONTACT END: STANDARD PART #: 60/40 SOLDER OVER SILVER ELECTRODE. RoHS PART #: FIRED ON SILVER ELECTRODE ONLY.
- EYELET FINISH: STANDARD PART #:60/40 SOLDER PLATED. RoHS PART #: SILVER PLATED.
- PART MARKING: STANDARD PART: 3 DOT COLOR CODE. RoHS PART: ADDITIONAL GREEN DOT IDENTIFIER.

SPECIFICATIONS

TUSONIX STYLE:	2404-620
CAPACITANCE:	1000 pF
TOLERANCE:	+100% -0%
TEMP. COEF.:	X5U
OPERATING TEMP.:	-55°C TO 125°C
VOLTAGE RATING:	500 VDC @ + 85°C
DWV:	875 VDC
IR MIN. @ 100 VDC:	10 GΩ

REVISION RECORD	Original Release	0
	C.O. 20060214-2-01	
	DIM .155 WAS .160. REVISED NOTE 2. S.M. 05-11-06	
	20060510-3-02	1
CORRECTED NOTE NUMBER. WAS 3. EC05-31-06		
20060531-3-02	2	

--TOLERANCES-- Unless Otherwise Specified		Title FEED - THRU CAPACITOR	
DECIMAL ± .015 [0.38]		Drawn S.M. 02-16-06 Scale 4 X	
ANGLES ±		Approved R.C. 02-16-06	
TUSONIX TUCSON, ARIZONA		A 2404-620-X5U0-102P	

X-ON Electronics

Largest Supplier of Electrical and Electronic Components

Click to view similar products for [cts manufacturer](#):

Other Similar products are found below :

[744C083333JP](#) [407F11C012M0000](#) [0538-011-F-15.0-60](#) [Z3A-22IB-3-BNL](#) [4306-033](#) [CB3LV-3C-32M7680](#) [744C083222JP](#) [744C083102JP](#)
[770101223](#) [4400-506](#) [026TB32R253B1A1](#) [APF30-30-13CB/A01](#) [MXO45HST-3C-16M0000](#) [CB3-3I-24M0000](#) [ATS061C](#) [743C083104JP](#)
[744C083472JP](#) [77083103P](#) [218-10LPSTRF](#) [O7050147456MFDA4SC](#) [402WF20012IMR](#) [KFF6516A](#) [194-8MST](#) [742C083330JPTR](#) [750-](#)
[101-R120](#) [766143221GP](#) [766163470GP](#) [77061333P](#) [403C35D12M00000](#) [7609-501LF](#) [CTS-1621](#) [745C101103JP](#) [284TBCF502A26A1](#)
[766163560GP](#) [CB3-3I-20M0000](#) [4300-060LF](#) [218-4LPSTF](#) [4400-032](#) [ATS12ASM-1](#) [201XR104B](#) [770103101P](#) [209-2MSF](#) [6740-2015](#)
[CB3-3C-1M5440](#) [T8031-5V](#) [206-12ST](#) [767163104D](#) [PB1-36ND](#) [ATS049BSM-1E](#) [TX0506-1B](#)