

**Panasonic**  
ideas for life

**DIN48 SIZE ANALOG  
MULTIRANGE POWER  
OFF-DELAY TIMERS**

**PM4H-F**

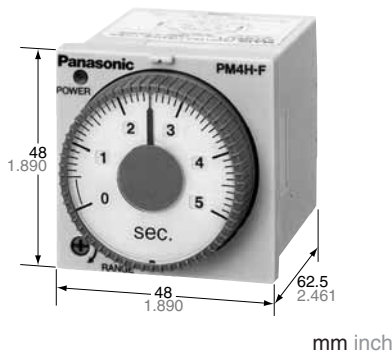

UL File No.: E122222  
CSA File No.: LR39291



**Features**

1. Switch operation times between three types of time ranges of 1 s to 10 s and 1 min to 10 min.
2. Instantaneous reset available.
3. The shorter body makes it easier to use.
4. Compliant with UL, CSA, CE and LLOYD.

RoHS Directive compatibility information  
<http://www.nais-e.com/>

**Specifications**

Item		Type	PM4H-F8	PM4H-F8R	PM4H-F11R
Rating	Rated operating voltage		100 to 120V AC, 200 to 240V AC, 24V AC, 12V DC, 24V DC		
	Rated frequency		50/60Hz common (AC operating type)		
	Rated power consumption		Approx. 1.6VA (100 to 120V AC, 200 to 240V AC), Approx. 2.3VA (24V AC) Approx. 1.1W (12V DC, 24V DC)		
	Rated control capacity		3A 250V AC (resistive load)		
	Operation mode		Power OFF-delay	Power OFF-delay (with reset)	
	Time range		1s to 10s: 3 range switchable 1 min to 10 min: 3 range selectable		
Time accuracy *1	Operation time fluctuation		±0.3%		
	Setting error		±5% (Full-scale value)		
	Voltage error		±0.5% (at the operating voltage changes between 85 to 110%)		
	Temperature error		±2% (at 20°C ambient temp. at the range of -10 to +50°C +14 to +122°F)		
Contact	Contact arrangement		Timed-out 2 Form C	Timed-out 1 Form C	Timed-out 2 Form C
	Contact resistance (Initial value)		Max. 100mΩ (at 1A 6V DC)		
	Contact material		Au flash on Silver alloy		
Life	Mechanical (contact)		10 <sup>7</sup>		
	Electrical (contact)		10 <sup>5</sup> (at rated control capacity)		
Electrical function	Allowable operating voltage range		85 to 110% of rated operating voltage (at 20°C coil temp.), 90 to 110% (DC Type)		
	Insulation resistance (Initial value)		Min. 100MΩ	Between live and dead metal parts Between input and output Between contacts of different poles (*3) Between contacts of same pole (At 500V DC)	
	Breakdown voltage (Initial value)		1,500Vrms for 1 min Between live and dead metal parts 1,500Vrms for 1 min Between input and output 1,000Vrms for 1 min Between contacts of different poles (*3) 750Vrms for 1 min Between contacts of same pole		
	Min. power supply width		s range type: 100ms min range type: 2s		
	Min. reset time			50ms	
	Max. temperature rise		55°C 131°F		
	Mechanical function	Vibration resistance	Functional	10 to 55Hz: 1 cycle/min double amplitude of 0.25mm (10min on 3 axes)	
Destructive			10 to 55Hz: 1 cycle/min double amplitude of 0.375mm (1hr on 3 axes)		
Shock resistance		Functional	Min. 98m/s <sup>2</sup> (4 times on 3 axes)		
		Destructive	Min. 980m/s <sup>2</sup> (5 times on 3 axes)		
Operating condition	Ambient temperature		-10 to +50°C +14 to +122°F		
	Ambient humidity		30 to 85%RH (non-condensing)		
	Atmospheric pressure		860 to 1,060hPa		
	Ripple factor (DC type)		20%		
Others	Protective construction		IP65 on front panel (using rubber gasket ATC18002) <only for IP65 type>		
	Weight		100g 3.527 oz (Pin type), 110g 3.880 oz (Screw terminal type)		

\*Notes: 1) Unless otherwise specified, the measurement conditions at the maximum scale time standard are specified to be the rated operating voltage (within 5% ripple factor for DC), 20°C 68°F ambient temperature.

2) For the 1s range, the tolerance for each specification becomes ±10ms. When the power goes on, in rush current (0.3A) flows. Cautions should be taken. The minimum power supplying time after forced reset input is 2s or more.

3) Between contacts of different pools for PM4H-F8, PM4H-F11R types only.

# PM4H-F

## Time range

<div>Time range</div> <div>Time range unit</div>	s range type	min range type
1	0.04s to 1s	0.04 min to 1 min
5	0.2s to 5s	0.2 min to 5 min
10	0.4s to 10s	0.4 min to 10 min

## Product types

Type	Operation mode	Contact arrangement	Time range	Protective construction	Rated operating voltage	Terminal type	Part number
PM4H-F8	Power OFF-delay (without reset)	Relay Timed-out 2 Form C	3 selectable time ranges over 1s to 10s	IP65	100 to 120V AC	8 pins	PM4HF8-S-AC120VW
					200 to 240V AC	8 pins	PM4HF8-S-AC240VW
					24V AC	8 pins	PM4HF8-S-AC24VW
					12V DC	8 pins	PM4HF8-S-DC12VW
			24V DC		8 pins	PM4HF8-S-DC24VW	
			100 to 120V AC		8 pins	PM4HF8-M-AC120VW	
			200 to 240V AC		8 pins	PM4HF8-M-AC240VW	
			24V AC		8 pins	PM4HF8-M-AC24VW	
			12V DC	8 pins	PM4HF8-M-DC12VW		
			24V DC	8 pins	PM4HF8-M-DC24VW		
			3 selectable time ranges over 1 min to 10 min	IP50	100 to 120V AC	8 pins	PM4HF8-S-AC120V
					200 to 240V AC	8 pins	PM4HF8-S-AC240V
					24V AC	8 pins	PM4HF8-S-AC24V
					12V DC	8 pins	PM4HF8-S-DC12V
			24V DC		8 pins	PM4HF8-S-DC24V	
			100 to 120V AC		8 pins	PM4HF8-M-AC120V	
200 to 240V AC	8 pins	PM4HF8-M-AC240V					
24V AC	8 pins	PM4HF8-M-AC24V					
12V DC	8 pins	PM4HF8-M-DC12V					
24V DC	8 pins	PM4HF8-M-DC24V					
PM4H-F8R	Power OFF-delay (with instantaneous reset)	Relay Timed-out 1 Form C	3 selectable time ranges over 1s to 10s	IP65	100 to 120V AC	8 pins	PM4HF8R-S-AC120VW
					200 to 240V AC	8 pins	PM4HF8R-S-AC240VW
					24V AC	8 pins	PM4HF8R-S-AC24VW
					12V DC	8 pins	PM4HF8R-S-DC12VW
			24V DC		8 pins	PM4HF8R-S-DC24VW	
			100 to 120V AC		8 pins	PM4HF8R-M-AC120VW	
			200 to 240V AC		8 pins	PM4HF8R-M-AC240VW	
			24V AC		8 pins	PM4HF8R-M-AC24VW	
			12V DC	8 pins	PM4HF8R-M-DC12VW		
			24V DC	8 pins	PM4HF8R-M-DC24VW		
			3 selectable time ranges over 1 min to 10 min	IP50	100 to 120V AC	8 pins	PM4HF8R-S-AC120V
					200 to 240V AC	8 pins	PM4HF8R-S-AC240V
					24V AC	8 pins	PM4HF8R-S-AC24V
					12V DC	8 pins	PM4HF8R-S-DC12V
			24V DC		8 pins	PM4HF8R-S-DC24V	
			100 to 120V AC		8 pins	PM4HF8R-M-AC120V	
200 to 240V AC	8 pins	PM4HF8R-M-AC240V					
24V AC	8 pins	PM4HF8R-M-AC24V					
12V DC	8 pins	PM4HF8R-M-DC12V					
24V DC	8 pins	PM4HF8R-M-DC24V					

Type	Operation mode	Contact arrangement	Time range	Protective construction	Rated operating voltage	Terminal type	Part number
PM4H-F11R	Power OFF-delay (with instantaneous reset)	Relay Timed-out 2 Form C	3 selectable time ranges over 1s to 10s	IP65	100 to 120V AC	11 pins	PM4HF11R-S-AC120VW
						Screw terminal	PM4HF11R-S-AC120VSW
					200 to 240V AC	11 pins	PM4HF11R-S-AC240VW
						Screw terminal	PM4HF11R-S-AC240VSW
					24V AC	11 pins	PM4HF11R-S-AC24VW
						Screw terminal	PM4HF11R-S-AC24VSW
					12V DC	11 pins	PM4HF11R-S-DC12VW
						Screw terminal	PM4HF11R-S-DC12VSW
					24V DC	11 pins	PM4HF11R-S-DC24VW
						Screw terminal	PM4HF11R-S-DC24VSW
				IP50	100 to 120V AC	11 pins	PM4HF11R-S-AC120V
						Screw terminal	PM4HF11R-S-AC120VS
					200 to 240V AC	11 pins	PM4HF11R-S-AC240V
						Screw terminal	PM4HF11R-S-AC240VS
					24V AC	11 pins	PM4HF11R-S-AC24V
						Screw terminal	PM4HF11R-S-AC24VS
					12V DC	11 pins	PM4HF11R-S-DC12V
						Screw terminal	PM4HF11R-S-DC12VS
					24V DC	11 pins	PM4HF11R-S-DC24V
						Screw terminal	PM4HF11R-S-DC24VS
			3 selectable time ranges over 1 min to 10 min	IP65	100 to 120V AC	11 pins	PM4HF11R-M-AC120VW
						Screw terminal	PM4HF11R-M-AC120VSW
					200 to 240V AC	11 pins	PM4HF11R-M-AC240VW
						Screw terminal	PM4HF11R-M-AC240VSW
					24V AC	11 pins	PM4HF11R-M-AC24VW
						Screw terminal	PM4HF11R-M-AC24VSW
					12V DC	11 pins	PM4HF11R-M-DC12VW
						Screw terminal	PM4HF11R-M-DC12VSW
					24V DC	11 pins	PM4HF11R-M-DC24VW
						Screw terminal	PM4HF11R-M-DC24VSW
				IP50	100 to 120V AC	11 pins	PM4HF11R-M-AC120V
						Screw terminal	PM4HF11R-M-AC120VS
					200 to 240V AC	11 pins	PM4HF11R-M-AC240V
						Screw terminal	PM4HF11R-M-AC240VS
					24V AC	11 pins	PM4HF11R-M-AC24V
						Screw terminal	PM4HF11R-M-AC24VS
					12V DC	11 pins	PM4HF11R-M-DC12V
						Screw terminal	PM4HF11R-M-DC12VS
					24V DC	11 pins	PM4HF11R-M-DC24V
						Screw terminal	PM4HF11R-M-DC24VS

# Dimensions

mm inch  
Toletance: ±0.5 ±.020

• Screw terminal type (Flush mount)

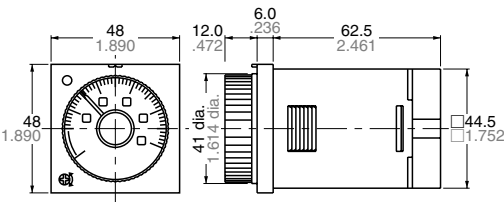

• Pin type (Flush mount/surface mount)

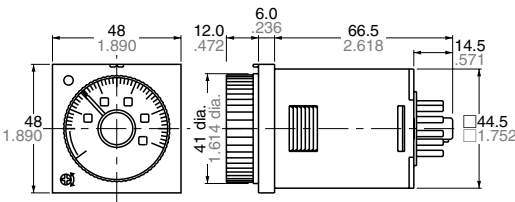

# PM4H-F

## Terminal layouts and Wiring diagrams

- **PM4H-F8 (without reset input)**  
Pin type  
Time-out 2 Form C

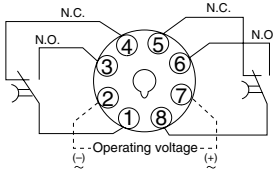

Screw-tightening pin type  
The PM4H-F11R should be used for the time-limit 2C.

- **PM4H-F8R (with reset input)**  
Pin type  
Time-out 1 Form C, with reset input

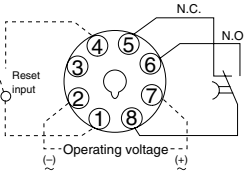

Screw-tightening pin type  
The PM4H-F11R should be used for the time-limit 1C and to connect reset input.

- **PM4H-F11R (with reset input)**  
Pin type  
Time-out 2 Form C, with reset input

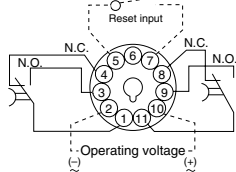

Screw terminal type  
Time-out 2 Form C, with reset input

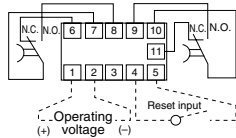

## PM4H-F (with reset) input conditions

### 1. Contact input (pin type example)

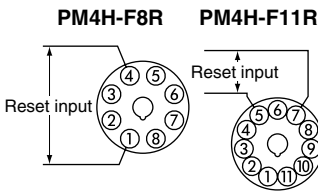

Use a contact with good contact reliability for the input. Contact bounce can lead to erroneous operation of the timer, so use a contact with short bounce time. Make the resistance between terminals for a short circuit less than 1k-ohms. Make the resistance between terminals for an open circuit greater than 100k-ohms.

### 2. Non-contact input (pin type example)

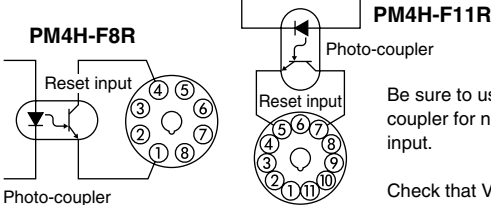

Be sure to use a photo-coupler for non-contact input.  
Check that  $V_{ce} = 0.6V$  Max. when ON.

## Operation

- **PM4H-F8 (without reset input)**

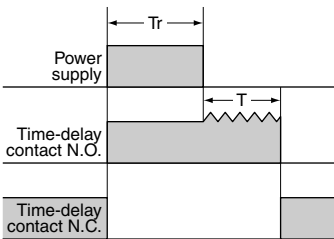

- **PM4H-F8R/F11R (with reset input)**

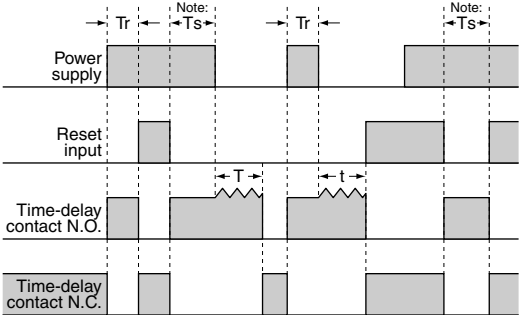

t<T: Time setting  
Tr: Minimum power supply application time  
Note: Ts: Min. 2s (Time to restart operation after reset input is set to OFF: both second type and minute type)

# PM4H SERIES MODES AND TIME SETTING

## 1. Operation method

### 1) Operation mode setting

#### [PM4H-A type]

8 operation modes are selectable with operation mode selector.

Turn the operation mode selector with screw driver.

Operation mode is shown up through the window above the mode selector. The marks are (ON), (FL), (FO), (OF), (SF), (OS), (OF2), (OC). Turn the mode selector to the mark until you can check by clicking sound.

Confirm the mode selector position if it is correct.

If the position is not stable, the timer might mis-operate.



### 2) Time range setting

#### [PM4H series common]

16 time ranges are selectable between 1s to 500h.

Turn the time range selector with the screw driver.

Clockwise turning increases the time range, and Counter-clockwise turning decrease the time range.

Confirm the range selector position if it is correct.

If the position is not stable, the timer might mis-operate.



### 3) Time setting [common]

To set the time, turn the set dial to a desired time within the range.

Instantaneous output will be on when the dial is set to "0".

When the instantaneous output is used, the dial should be set under "0" range.

(Instantaneous output area)

When power supply is on, the time range, setting time and operation mode cannot be changed.

Turn off the power supply or a reset signal is applied to set the new operation mode.

If the position is not stable, the timer might mis-operate.

## 2. How to use "Set ring" [PM4H series common]

### 1) Fixed time setting

Set the desired time and put 2 set rings together.

Insert the rings into stopper to fix the time.

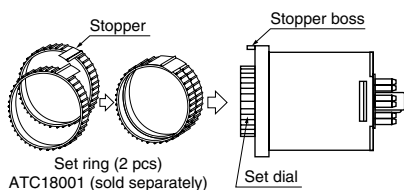

### 2) Time range setting

Example: Time range 20s to 30s.

#### ① Shorter time value setting

Set the dial to 20s.

Place the stop ring at the right side of stopper.

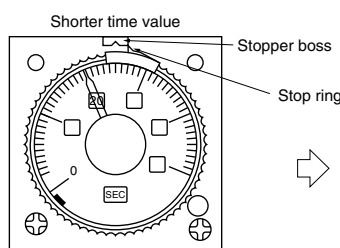

#### ② Longer time value setting

Set the dial to 30s.

Place the stop ring at the left side of stopper.

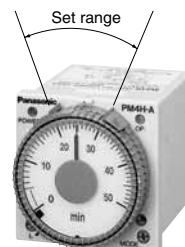
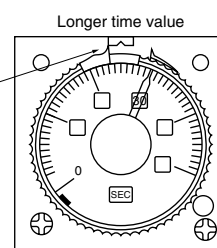

Note) The stoppers for the lower limit setting set ring and the upper limit setting set ring face the opposite directions.

## Applicable standard (PM4H series common)

Safety standard	EN61812-1	Pollution Degree 2/Overvoltage Category III
EMC	(EMI)EN61000-6-4 Radiation interference electric field strength Noise terminal voltage (EMS)EN61000-6-2 Static discharge immunity	EN55011 Group1 ClassA EN55011 Group1 ClassA
	RF electromagnetic field immunity EFT/B immunity Surge immunity Conductivity noise immunity Power frequency magnetic field immunity Voltage dip/Instantaneous stop/Voltage fluctuation immunity	EN61000-4-2 4 kV contact 8 kV air EN61000-4-3 10 V/m AM modulation (80 MHz to 1 GHz) 10 V/m pulse modulation (895 MHz to 905 MHz) EN61000-4-4 2 kV (power supply line) 1 kV (signal line) EN61000-4-5 1 kV (power line) EN61000-4-6 10 V/m AM modulation (0.15 MHz to 80 MHz) EN61000-4-8 30 A/m (50 Hz) EN61000-4-11 10 ms, 30% (rated voltage) 100 ms, 60% (rated voltage) 1,000 ms, 60% (rated voltage) 5,000 ms, 95% (rated voltage)

## X-ON Electronics

Largest Supplier of Electrical and Electronic Components

*Click to view similar products for [Timers](#) category:*

*Click to view products by [Panasonic](#) manufacturer:*

Other Similar products are found below :

[79237785](#) [H3DS-GL AC24-230/DC24-48](#) [H5AN-4DM DC12-24](#) [H5CN-XDNM AC100-240](#) [H5CN-YAN AC100-240](#) [H5CX-L8S-N AC100-240](#) [H3AMNSCAC100240](#) [H3AM-NSR-B AC100-240](#) [H3CA-8 DC12](#) [H3CR-A8-302 DC24](#) [H3CR-F AC24-48/DC12-48](#) [H3CR-G8EL AC200-240](#) [H3Y4DC245S](#) [H5AN-4D DC12-24](#) [81506944](#) [88225029](#) [H5S-YB4-X](#) [H3CR-A-301 AC100-240/DC100-125](#) [H3CR-AS AC24-48/DC12-48](#) [H3DK-GE AC240-440](#) [H3RN-2 AC24](#) [H3RN-21 AC24](#) [H3CR-H8RL AC/DC24 M](#) [H3CR-H8RL AC100-120 S](#) [H3CR-G8EL-31 AC100-120](#) [H3CR-H8RL AC100-120 M](#) [H3CR-HRL AC100-120 M](#) [H3CR-A8-301 AC24-48/DC12-48](#) [H3AM-NSR-C AC100-240](#) [H3CR-H8RL AC/DC24 S](#) [H7AN-2D DC12-24](#) [H5CN-XANS DC12-48](#) [H3CA-8 DC110](#) [H7AN-W4DM DC12-24](#) [H7AN-4DM DC12-24](#) [H7AN-4D DC12-24](#) [H7AN-RT6M AC100-240](#) [H3CA-8H AC200/220/240](#) [MTR17-BA-U240-116](#) [PM4HSDM-S-AC240VS](#) [PM4HSDM-S-AC240VSW](#) [PO-405](#) [600DT-CU](#) [H3Y-2-B DC24 30S](#) [H3Y-2-B DC24 1S](#) [PM4HF8-M-DC24V](#) [PM4HS-H-DC12VSW](#) [H3Y-2-B AC100-120 10S](#) [H3Y-2-B AC100-120 30S](#) [H3C-R](#)