

Model No.: **GP14E**

NO MERCURY ADDED	
Description	: Heavy Duty Battery, C Size
Chemical System	: Carbon Zinc
Nominal Voltage	: 1.5 Volts
Nominal Dimensions	: $\phi 26.2$ mm x 50.0 mm
Terminals	: Protruded positive (+) and flat negative (-) contacts
Jacket	: Metal jacket with PVC shrink tube insulation
Applications	: All electronic devices, e.g. transistor radios, cassette recorders, toys, alarm clocks, lighting, torches & portable fans.
Warranty Period	: 36 months
Average Weight	: 47.8g

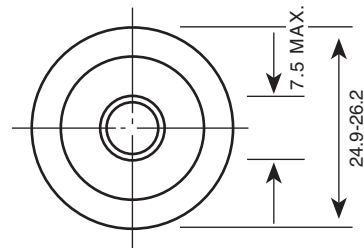

Cross References:

GP	JIS	IEC	Eveready	Duracell/ Mallory	Varta
14E	R14S	R14S	1035	M14P	2014

Typical Service Life:

Discharge Resistance	Discharge Condition	End Point Voltage	Service Life
3.9 Ohms	1 Hr/ Day	0.8V	5.0 Hrs

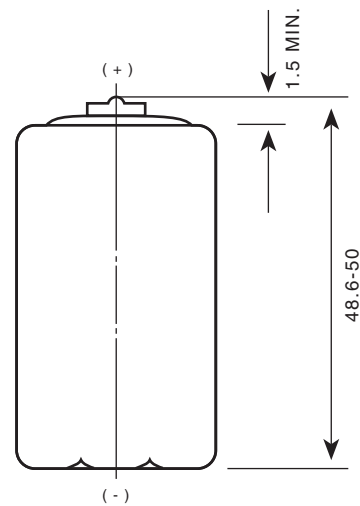
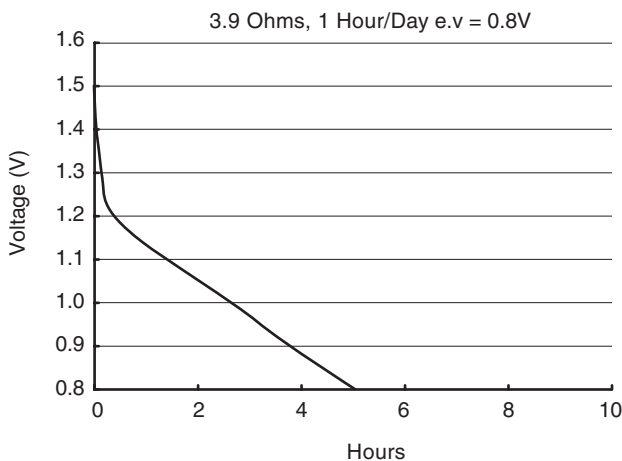

Unit : mm

The information (subject to change without prior notice) contained in this document is for reference only and should not be used as a basis for product guarantee or warranty. For applications other than those described here, please consult your nearest GP Sales and Marketing Office or Distributors.

X-ON Electronics

Largest Supplier of Electrical and Electronic Components

Click to view similar products for [Battery Packs](#) category:

Click to view products by [GP Batteries](#) manufacturer:

Other Similar products are found below :

[2280309-1](#) [R101-B](#) [4114 210 501](#) [4120 210 501](#) [4600 726 406](#) [4610 726 406](#) [312G-U1](#) [55615703012](#) [3LR12](#) [4103 210 392](#) [4103 210 394](#)
[4106 210 392](#) [4106 210 394](#) [4223 210 501](#) [4606 726 406](#) [4607 726 406](#) [ZA13](#) [LR03/AAA/MN2400\(K4\)](#) [LR03 MAXELL S4](#) [LR1130](#)
[MAXELL B10](#) [LR14-MN1400-C K2](#) [LR1/910A](#) [LR41 MAXELL B10](#) [LR43](#) [LR43 MAXELL B10](#) [LR6 MAXELL S4](#) [11012](#) [E23A](#) [E90](#)
[625302](#) [625304](#) [637871](#) [638006](#) [6LF22/9V/MN1604\(K1\)C&B](#) [6LF22/9V/MN1604 PLUS](#) [6LR61](#) [SR626SW MAXELL](#) [SR920SW](#)
[MAXELL](#) [7K67 J](#) [55615303059](#) [GP14A S2](#) [GP15E](#) [GP1604GLF-2UE1](#) [GP 1604 ULTRA PLUS](#) [23733](#) [10 ET](#) [675 ET](#) [11A B5](#) [A544](#) [A76-](#)
[U10](#)