



FMdesign

CFI.

Double hinges for profiles

Technopolymer



Main specifications

Material

Glass-fibre reinforced polyamide based (PA) technopolymer, black or grey colour RAL 7040 (C33), matte finish.

Rotating pins

Nickel-plated steel.

Standard execution

Pass-through holes for M6 countersunk head screws.

Technopolymer centering inserts (supplied)

For profiles with slot dimensions from 6 to 12 mm.

General information

Features and applications

This type of hinge is recommended when, for example, one central frame is connected with two lateral doors. It can be used with aluminium profiles from 30 up to 60 mm, also combining different dimensions.

Rotation angle (approximate value)

Max 260°/275° (-95° and +165°/180° being 0° the condition where the two interconnected surfaces are on the same plane).

Do not exceed the rotation angle limit so as not to prejudice the hinge mechanical performance.

To choose the convenient type and the right number of hinges for your application, see the [Guidelines](#).

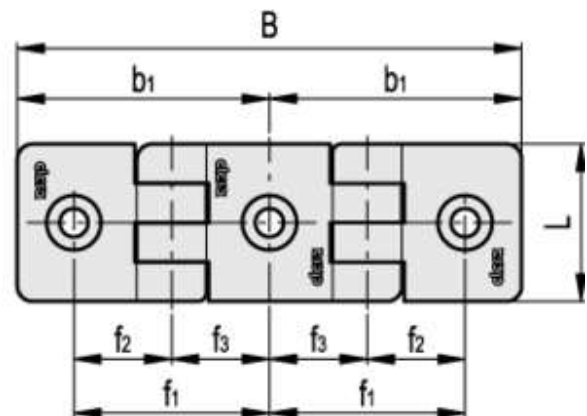
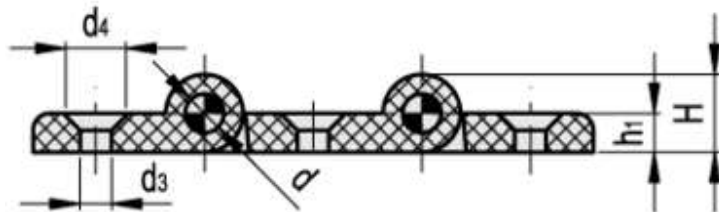

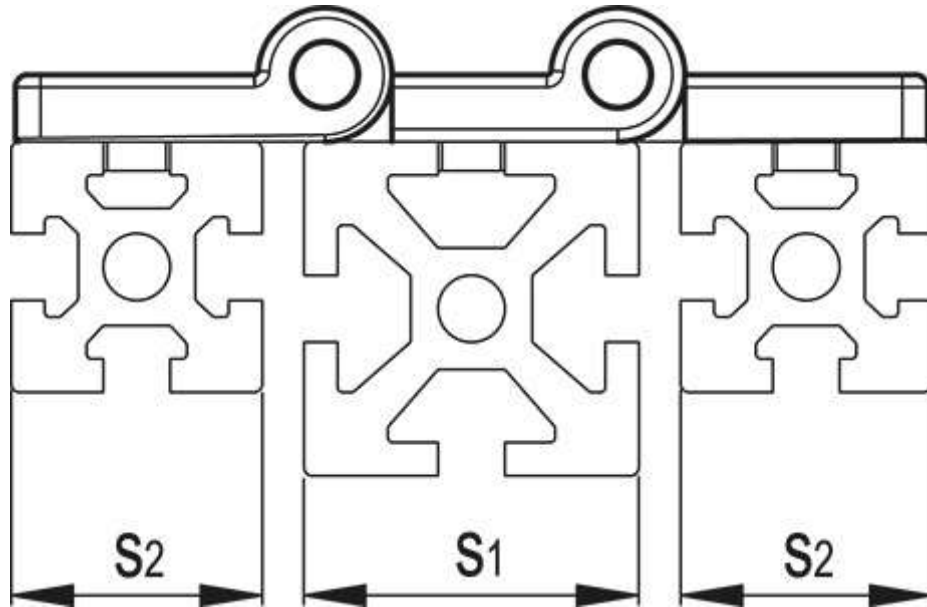

Black (RAL 9005) C9

C33

C33

CFI.

Code	Description	s ₁	s ₂	L	B	f ₁ ±0.25	f ₂	f ₃	H	h ₁	b ₁	d	d ₃	d ₄	β	C# [Nm]	Weight
424111	CFI.30-30/30 SH-6	30	30	36	89	35	17.5	17.5	16	8	44.5	8	6.5	12.5	180°	5	59
424111-C33	CFI.30-30/30 SH-6-C33	30	30	36	89	35	17.5	17.5	16	8	44.5	8	6.5	12.5	180°	5	59
424121	CFI.30-40/40 SH-6	30	40	36	109	40	22.5	17.5	16	8	54.5	8	6.5	12.5	165°	5	63
424121-C33	CFI.30-40/40 SH-6-C33	30	40	36	109	40	22.5	17.5	16	8	54.5	8	6.5	12.5	180°	5	63
424211	CFI.40-30/30 SH-6	40	30	36	99	40	17.5	22.5	16	8	49.5	8	6.5	12.5	180°	5	62
424211-C33	CFI.40-30/30 SH-6-C33	40	30	36	99	40	17.5	22.5	16	8	49.5	8	6.5	12.5	180°	5	62
424221	CFI.40-40/40 SH-6	40	40	36	119	45	22.5	22.5	16	8	59.5	8	6.5	12.5	180°	5	66
424221-C33	CFI.40-40/40 SH-6-C33	40	40	36	119	45	22.5	22.5	16	8	59.5	8	6.5	12.5	180°	5	66
424311	CFI.45-30/30 SH-6	45	30	36	104	42.5	17.5	25	16	8	52	8	6.5	12.5	180°	5	63
424311-C33	CFI.45-30/30 SH-6-C33	45	30	36	104	42.5	17.5	25	16	8	52	8	6.5	12.5	180°	5	63
424321	CFI.45-40/40 SH-6	45	40	36	124	47.5	22.5	25	16	8	62	8	6.5	12.5	180°	5	67
424321-C33	CFI.45-40/40 SH-6-C33	45	40	36	124	47.5	22.5	25	16	8	62	8	6.5	12.5	180°	5	67
424331	CFI.45-45/45 SH-6	45	45	36	134	50	25	25	16	8	67	8	6.5	12.5	180°	5	69
424331-C33	CFI.45-45/45 SH-6-C33	45	45	36	134	50	25	25	16	8	67	8	6.5	12.5	180°	5	69
424411	CFI.60-30/30 SH-6	60	30	36	119	50	17.5	32.5	16	8	59.5	8	6.5	12.5	180°	5	67
424411-C33	CFI.60-30/30 SH-6-C33	60	30	36	119	50	17.5	32.5	16	8	59.5	8	6.5	12.5	180°	5	67
424421	CFI.60-40/40 SH-6	60	40	36	139	55	22.5	32.5	16	8	69.5	8	6.5	12.5	180°	5	71
424421-C33	CFI.60-40/40 SH-6-C33	60	40	36	139	55	22.5	32.5	16	8	69.5	8	6.5	12.5	180°	5	71
424431	CFI.60-45/45 SH-6	60	45	36	149	57.5	25	32.5	16	8	74.5	8	6.5	12.5	180°	5	73
424431-C33	CFI.60-45/45 SH-6-C33	60	45	36	149	57.5	25	32.5	16	8	74.5	8	6.5	12.5	180°	5	73

Suggested tightening torque for assembly screws.

X-ON Electronics

Largest Supplier of Electrical and Electronic Components

Click to view similar products for [Mounting Fixings](#) category:

Click to view products by [Elesa & Ganter](#) manufacturer:

Other Similar products are found below :

[5912235-2](#) [007310](#) [007541](#) [6-141-P](#) [620HA038NF09](#) [620HA038NF11](#) [CTJ420E028-513](#) [M81714/60-12-01](#) [M81714/60-22-01](#) [L/C](#)
[MA1EAF1200](#) [70-584649-01P](#) [71-074914-006](#) [71-215091-8S](#) [712HA170B23128-N](#) [71-344699-4S](#) [71-441549-19S](#) [71-441864-5S](#) [71-](#)
[490451-4H](#) [EX-13-3-B-16-325PN](#) [75-69116-8S](#) [75-69211-3P](#) [75-69220-27S](#) [75-69224-5S](#) [75-69614-2S](#) [770-006A109](#) [770-006A109R](#) [770-](#)
[006A207](#) [770-006A208W1](#) [770-006A209](#) [770-006A306](#) [770-006A703W1](#) [770-006A704](#) [770-006A704W1](#) [770-006A705](#) [770-006A706](#)
[770-006A706W1](#) [770-006A707](#) [770-006A709](#) [770-007A203](#) [770-007A203W1](#) [770-007A204W1](#) [770-007A207W1](#) [770-007A703](#) [770-](#)
[007A704W1](#) [770-007A706](#) [770-007A707W1](#) [770-010Y208](#) [770-010Y308](#) [770-010Y705](#) [770-010Y706](#)