

inserts:		page
CK	3 poles + ⊕	36
CK	4 poles + ⊕	36
CKS	3 poles + ⊕	37
CKS	4 poles + ⊕	37
CD	7 poles + ⊕	39
CD	8 poles	40
CQ	5 poles + ⊕	63
CQ	12 poles + ⊕	62

overall dimensions:
21 x 21 mm

bulkhead housings



angled bulkhead housings



description	part No.	part No. (entry - Pg 11)	part No. (entry - M 20)
with lever ¹⁾	CK 03 I (white)		
with lever ¹⁾	CK 03 IN (black)		
without cable gland outlet, with lever ¹⁾		CK 03 IA (white)	
without cable gland outlet, with lever ¹⁾		CK 03 IAN (black)	
with threaded entry and lever ¹⁾		CK 03 IAPS (white)	MK IAP20 (white)
with threaded entry and lever ¹⁾		CK 03 IAPNS (black)	MK IAPN20 (black)
seal and screw kit for IP66/IP67 ²⁾ for CK, CQ 05, CKS inserts	CKR 65	CKR 65	
seal and screw kit for IP66/IP67 ²⁾ for CD 07/08 inserts	CKR 65 D	CKR 65 D	

panel cut-out for enclosures, in mm

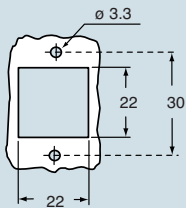

- enclosures with IP44 degree of protection, obtained by the elimination of the flexible washer normal supplied with the insert
- To achieve the IP66/IP67 protection rating, a kit is available which includes a seal to be fitted under the insert fastening screw supplied with the kit (see example illustrated), instead of the screw with spring washer supplied with the insert

Note:
The CQ 12 inserts are already fitted with seal and screw, allowing IP66/IP67 protection rating to be achieved.

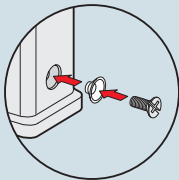

CALUS® Type 12
Type 4/4X only
with CKR 65 (D)

dimensions in mm

CK I(N)

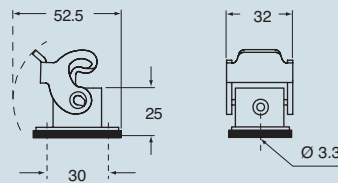

dimensions in mm

CK IA(N)

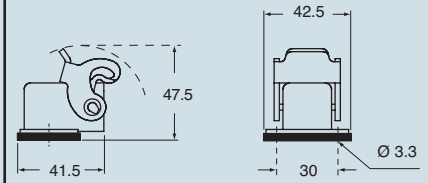

CK IAP(N)S and MK IAP(N)

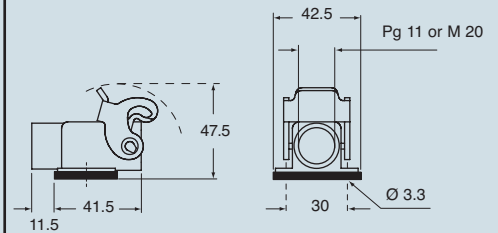

dimensions indicated are not binding
and may be changed without notice



inserts:		page
CK	3 poles + ⊕	36
CK	4 poles + ⊕	36
CKS	3 poles + ⊕	37
CKS	4 poles + ⊕	37
CD	7 poles + ⊕	39
CD	8 poles	40
CQ	5 poles + ⊕	63
CQ	12 poles + ⊕	62

overall dimensions:
21 x 21 mm

hoods



covers



description	part No. (entry - Pg 11)	part No. (entry - M 20)	part No.
with pegs, top entry ¹⁾	CK 03 VS (white)	MK V20 (white)	
with pegs, top entry ¹⁾	CK 03 VNS (black)	MK VN20 (black)	
with pegs, side entry ¹⁾	CK 03 VAS (white)	MK VA20 (white)	
with pegs, side entry ¹⁾	CK 03 VANS (black)	MK VAN20 (black)	
with lever, top entry ¹⁾	CK 03 VGS (white)	MK VG20 (white)	
with lever, top entry ¹⁾	CK 03 VGNS (black)	MK VGN20 (black)	
with pegs and gasket, for female inserts			CK 03 C (white)
with pegs and gasket, for female inserts			CK 03 CN (black)
with pegs, for male inserts			CK 03 CA (white)
with pegs, for male inserts			CK 03 CAN (black)
with lever and gasket, for female inserts			CK 03 CX (white)
with lever and gasket, for female inserts			CK 03 CXN (black)
with lever, for male inserts			CK 03 CXA (white)
with lever, for male inserts			CK 03 CXAN (black)
seal and screw kit for IP66/IP67 ²⁾ for CK, CQ 05, CKS inserts	CKR 65		
seal and screw kit for IP66/IP67 ²⁾ for CD 07/08 inserts	CKR 65 D		

- 1) enclosures with IP44 degree of protection, obtained by the elimination of the flexible washer normal supplied with the insert
- 2) To achieve the IP66/IP67 protection rating, a kit is available which includes a seal to be fitted under the insert fastening screw supplied with the kit (see example illustrated), instead of the screw with spring washer supplied with the insert

Note:
The CQ 12 inserts are already fitted with seal and screw, allowing IP66/IP67 protection rating to be achieved.

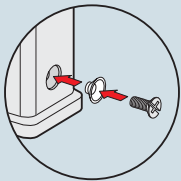

dimensions in mm

CK V(N)S and MK V(N)

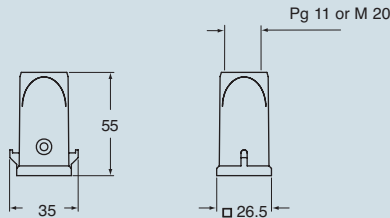

CK VA(N)S and MK VA(N)

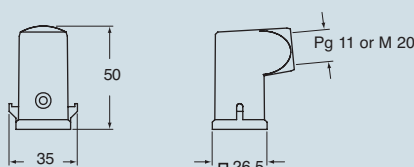

CK VG(N)S and MK VG(N)

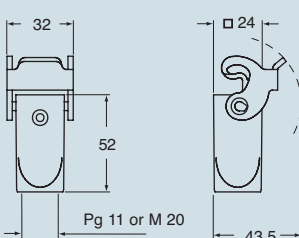

dimensions in mm

CK C(N)

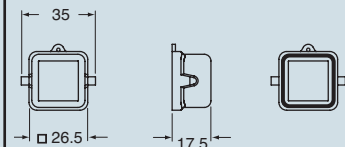

CK CA(N)

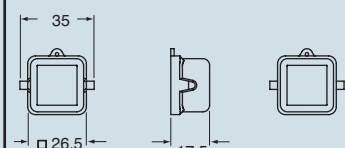

CK CX(N)

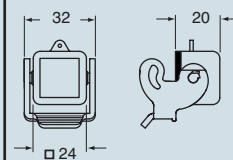

CK CXA(N)

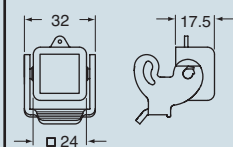

CAUS® Type 12
Type 4/4X only
with CKR 65 (D)

dimensions indicated are not binding
and may be changed without notice



inserts:		page
CK	3 poles + ⊕	36
CK	4 poles + ⊕	36
CKS	3 poles + ⊕	37
CKS	4 poles + ⊕	37
CD	8 poles	40
CQ	5 poles + ⊕	63
CQ	12 poles + ⊕	62

overall dimensions:
21 x 21 mm

bulkhead housings



angled bulkhead housings



description	part No.	part No. (entry - Pg 11)	part No. (entry - M 20)
with lever in galvanised steel ¹⁾ with stainless steel lever ¹⁾	CKA 03 I CKAX 03 I		
without cable gland outlet, lever in galvanised steel ¹⁾ without cable gland outlet, stainless steel lever ¹⁾		CKA 03 IA CKAX 03 IA	
with threaded entry, lever in galvanised steel ¹⁾ with threaded entry, stainless steel lever ¹⁾ with threaded entry, lever in galvanised steel ¹⁾ , bottom closed with threaded entry, stainless steel lever ¹⁾ , bottom closed		CKA 03 IAPS CKAX 03 IAPS CKA 03 APS CKAX 03 APS	MKA IAP20 MKAX IAP20 MKA AP20 MKAX AP20
seal and screw kit for IP66/IP67 ²⁾ for CK, CQ 05, CKS inserts	CKR 65	CKR 65	
seal and screw kit for IP66/IP67 ²⁾ for CD 07/08 inserts	CKR 65 D	CKR 65 D	

panel cut-out for enclosures, in mm

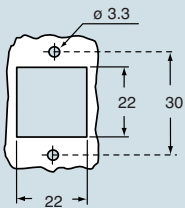

- 1) enclosures with IP44 degree of protection.
- 2) To achieve the IP66/IP67 protection rating, a kit is available which includes a seal to be fitted under the insert fastening screw supplied with the kit (see example illustrated), instead of the screw with spring washer supplied with the insert

Note:
The CQ 12 inserts are already fitted with seal and screw, allowing IP66/IP67 protection rating to be achieved.

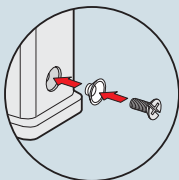

ILME® Type 12
Type 4/4X only
with CKR 65 (D)

dimensions indicated are not binding
and may be changed without notice

dimensions in mm

CKA I

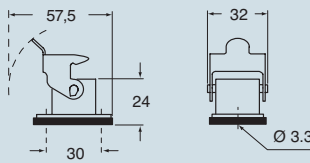

CKAX I

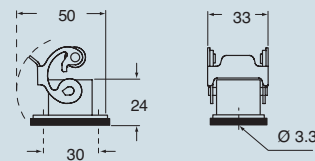

dimensions in mm

CKA IA

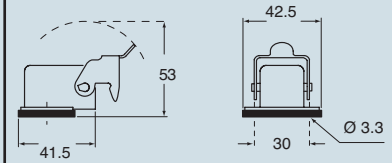

CKAX IA

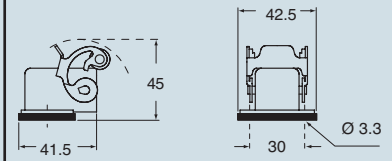

CKA IAPS (CKA APS) and MKA IAP (MKA AP)

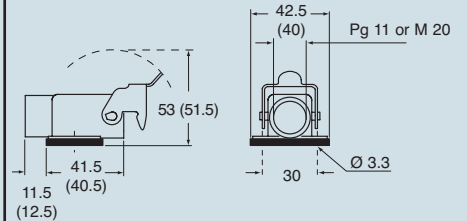

CKAX IAPS (CKAX APS) and MKAX IAP (MKAX AP)

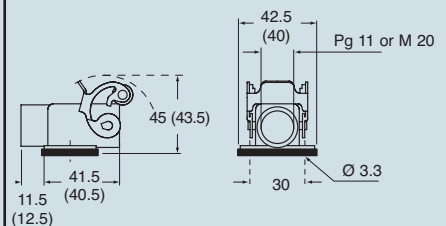



inserts:		page
CK	3 poles + ⊕	36
CK	4 poles + ⊕	36
CKS	3 poles + ⊕	37
CKS	4 poles + ⊕	37
CD	8 poles	40
CQ	5 poles + ⊕	63
CQ	12 poles + ⊕	62

overall dimensions:
21 x 21 mm

hoods



covers



description	part No. (entry - Pg 11)	part No. (entry - M 20)	part No.
with pegs, top entry ¹⁾ with pegs, side entry ¹⁾	CKA 03 VS CKA 03 VAS	MKA V20 MKA VA20	
with lever in galvanised steel, top entry ¹⁾ with stainless steel lever, top entry ¹⁾	CKA 03 VGS CKAX 03 VGS	MKA VG20 MKAX VG20	
with pegs and gasket, for female inserts with pegs, for male inserts			CKA 03 C ²⁾ CKA 03 CA ²⁾
with stainless steel lever and gasket, for female inserts with stainless steel lever, for male inserts			CKAX 03 CX CKAX 03 CXA
seal and screw kit for IP66/IP67 ³⁾ for CK, CQ 05, CKS inserts	CKR 65		
seal and screw kit for IP66/IP67 ³⁾ for CD 08 inserts	CKR 65 D		

- 1) enclosures with IP44 degree of protection.
- 2) better to use with CKAX enclosures (stainless steel lever).
- 3) To achieve the IP66/PI67 protection rating, a kit is available which includes a seal to be fitted under the insert fastening screw supplied with the kit (see example illustrated), instead of the screw with spring washer supplied with the insert

Note:
The CQ 12 inserts are already fitted with seal and screw, allowing IP66/IP67 protection rating to be achieved.

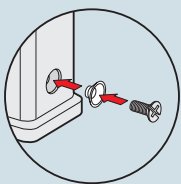

dimensions in mm

CKA VS and MKA V

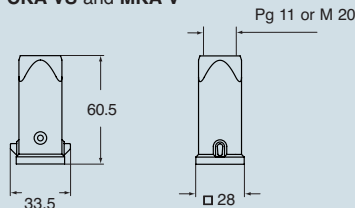

CKA VAS and MKA VA

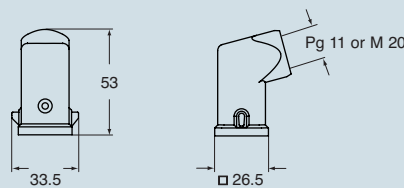

CKA VGS and MKA VG

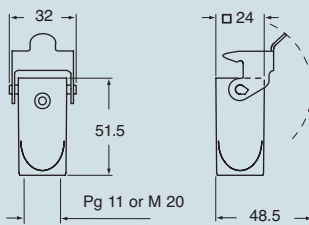

CKAX VGS and MKAX VG

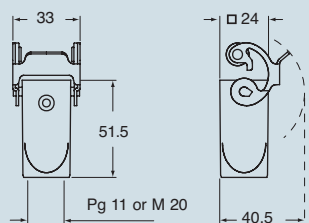

dimensions in mm

CKA C

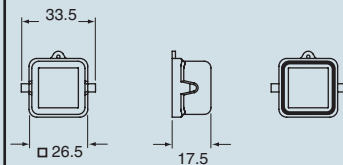

CKA CA

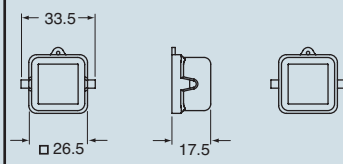

CKAX CX

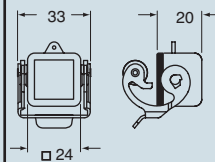

CKAX CXA

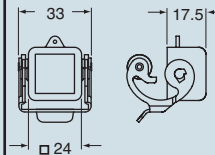

ILME®
Type 12
Type 4/4X only
with CKR 65 (D)

dimensions indicated are not binding
and may be changed without notice

size 21.21

inserts:		page
CK	3 poles + ⊕	36
CK	4 poles + ⊕	36
CKS	3 poles + ⊕	37
CKS	4 poles + ⊕	37
CD	8 poles	40
CQ	5 poles + ⊕	63
CQ	12 poles + ⊕	62

overall dimensions:
21 x 21 mm

**bulkhead housings
straight and angled**



hoods

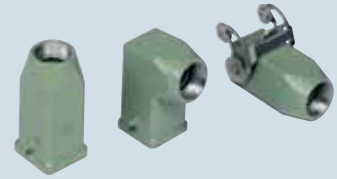

description	part No. (entry - Pg 11)	part No. (entry - M 20)	part No. (entry - Pg 11)	part No. (entry - M 20)
with stainless steel lever ¹⁾	CKAXW 03 I			
without cable gland outlet, stainless steel lever ¹⁾	CKAXW 03 IA			
with threaded entry, stainless steel lever ¹⁾	CKAXW 03 IAP	MKAXW IAP20		
with threaded entry, stainless steel lever ¹⁾ , bottom closed	CKAXW 03 AP	MKAXW AP20		
with pegs, top entry ¹⁾			CKAW 03 V	MKAW V20
with pegs, side entry ¹⁾			CKAW 03 VA	MKAW VA20
with stainless steel lever, top entry ¹⁾			CKAXW 03 VG	MKAXW VG20
seal and screw kit for IP66/IP67 ²⁾ for CK, CQ 05, CKS inserts	CKR 65		CKR 65	
seal and screw kit for IP66/IP67 ²⁾ for CD 08 inserts	CKR 65 D		CKR 65 D	

panel cut-out for enclosures, in mm

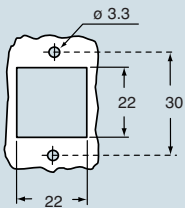

- 1) enclosures with IP44 degree of protection.
- 2) To achieve the IP66/IP67 protection rating, a kit is available which includes a seal to be fitted under the insert fastening screw supplied with the kit (see example illustrated), instead of the screw with spring washer supplied with the insert

Note:
The CQ 12 inserts are already fitted with seal and screw, allowing IP66/IP67 protection rating to be achieved.

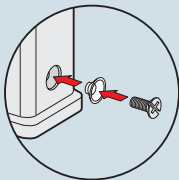

CRUS® Type 12
Type 4/4X only
with CKR 65 (D)

dimensions indicated are not binding
and may be changed without notice

dimensions in mm

CKAXW I

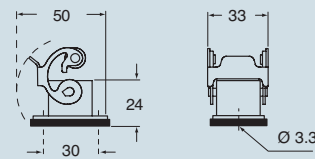

CKAXW IA

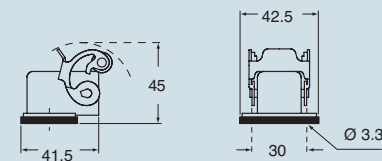

**CKAXW IAP (CKAXW AP) and
MKAXW IAP (MKAXW AP)**

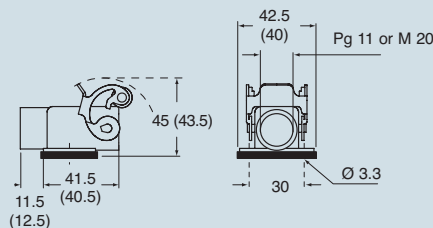

dimensions in mm

CKAW V and MKAW V

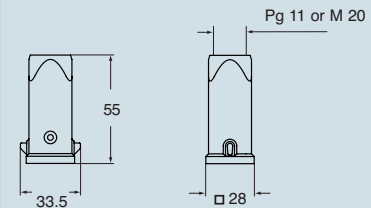

CKAW VA and MKAW VA

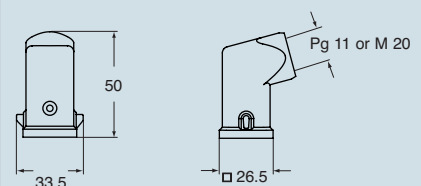

CKAXW VG and MKAXW VG

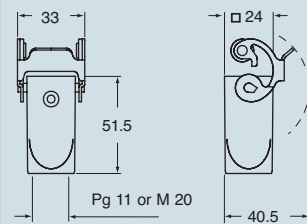



inserts:		page
CK	3 poles + ⊕	36
CK	4 poles + ⊕	36
CKS	3 poles + ⊕	37
CKS	4 poles + ⊕	37
CD	8 poles	40
CQ	5 poles + ⊕	63
CQ	12 poles + ⊕	62

overall dimensions:
21 x 21 mm

**bulkhead housings
straight and angled**



hoods



description	part No. (entry - Pg 11)	part No. (entry - M 20)	part No. (entry - Pg 11)	part No. (entry - M 20)
with stainless steel lever ¹⁾	CKAXS 03 I			
without cable gland outlet, stainless steel lever ¹⁾	CKAXS 03 IA			
with threaded entry, stainless steel lever ¹⁾	CKAXS 03 IAP	MKAXS IAP20		
with threaded entry, stainless steel lever ¹⁾ , bottom closed	CKAXS 03 AP	MKAXS AP20		
with pegs, top entry ¹⁾			CKAS 03 V	MKAS V20
with pegs, side entry ¹⁾			CKAS 03 VA	MKAS VA20
with stainless steel lever, top entry ¹⁾			CKAXS 03 VG	MKAXS VG20
seal and screw kit for IP66/IP67 ²⁾ for CK, CQ 05, CKS inserts	CKR 65		CKR 65	
seal and screw kit for IP66/IP67 ²⁾ for CD 08 inserts	CKR 65 D		CKR 65 D	

panel cut-out for enclosures, in mm

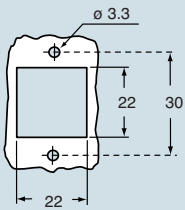

- 1) enclosures with IP44 degree of protection.
- 2) To achieve the IP66/IP67 protection rating, a kit is available which includes a seal to be fitted under the insert fastening screw supplied with the kit (see example illustrated), instead of the screw with spring washer supplied with the insert

Note:
The CQ 12 inserts are already fitted with seal and screw, allowing IP66/IP67 protection rating to be achieved.

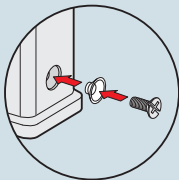

CALUS® Type 12
Type 4/4X only
with CKR 65 (D)

dimensions indicated are not binding
and may be changed without notice

dimensions in mm

CKAXS I

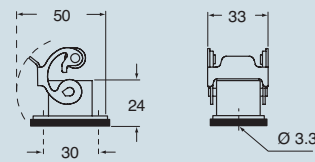

CKAXS IA

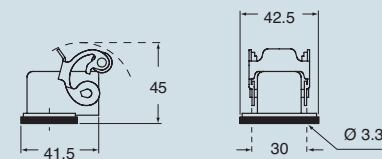

**CKAXS IAP (CKAXS AP) and
MKAXS IAP (MKAXS AP)**

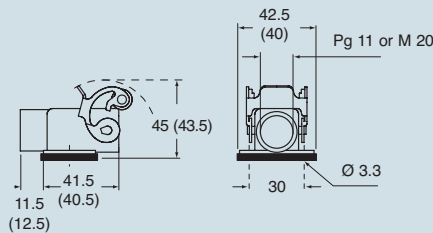

dimensions in mm

CKAS V and MKAS V

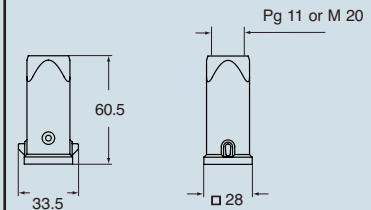

CKAS VA and MKAS VA

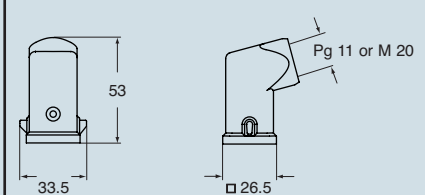

CKAXS VG and MKAXS VG

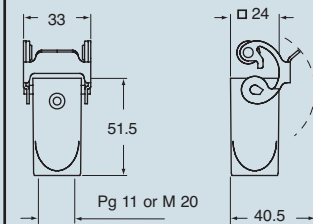

X-ON Electronics

Largest Supplier of Electrical and Electronic Components

Click to view similar products for [Standard Circular Connector](#) category:

Click to view products by [ILME](#) manufacturer:

Other Similar products are found below :

[C015 10F006 001 1](#) [5M2530B10P](#) [600247N007](#) [600259N006](#) [600273N007](#) [600432N009](#) [6280-2PG-519](#) [6280-3PG-311](#) [6280-3SG-311](#)
[6280-7SG-3DC](#) [6280-7SG-522](#) [6282-5PG-311](#) [6282-6PG-519](#) [6282-8SG-311](#) [6283-11](#) [6283-15](#) [6290](#) [6293](#) [6382-2PG-311](#) [6382-2PG-3DC](#)
[6382-2SG-321](#) [6382-2SG-3DC](#) [6382-4SG-516](#) [67-03E20-37P](#) [681-PMG](#) [CXS3102A14S2P](#) [CXS3102A181S](#) [CXS3106A14S6S](#)
[D38999/20FC8SA L/C](#) [MB12P-1](#) [MB12R-6](#) [7251-2PG-300](#) [7251-2SG-300](#) [7251-4PG-300](#) [7251-4SG-300](#) [7251-5PG-300](#) [7251-5SG-300](#)
[7251-6SG-300](#) [7251-7PG-300](#) [7251-8PG-300](#) [7271-6SG-300](#) [7282-3PG-300-CH3](#) [73000005663](#) [75-190011-03P](#) [75-190216-08S](#) [75-190218-](#)
[10P](#) [75-214636-52P](#) [75-474118-10P](#) [75-474211-03P](#) [75-474218-19S](#)