



Altech is pleased to announce a new, more extensive printed circuit board terminal block line. This line offers the standard single and double level fixed and pluggable terminal blocks in metric and US pin spacings. However, this product line goes beyond our past standard offering. There is now a wider array of products within each pin spacing as well as new types of blocks such as 35°, reverse horizontal wire entry, and triple level fixed blocks, card edge connectors, panel feed through blocks, barrier strips, and plugs/headers with screw flanges. This product assortment combined with the new pricing structure makes this line extremely competitive.

Altech printed circuit board terminal blocks give you highly dependable connections without the need for wire lugs. Choose either tubular screw clamps or box clamps when economy is paramount or screw-cage clamps for heavy-duty applications. In each case, simply strip and insert the wire and tighten the screw. We recommend the use of ferrules, especially for export applications and whenever fine stranded wires must be terminated.

Our board mounted terminal blocks meet or exceed most international standards and are accepted worldwide. They're available in single, double and triple level configurations with both, millimeter and inch pin spacings. All leave mini footprints to save valuable real estate.

PRINTED CIRCUIT BOARD TERMINAL BLOCKS

FIXED

Our printed circuit board terminal blocks designed for fixed mounting offer high density, and maximum flexibility. Modular construction simplifies ordering and reduces inventory. Two- and 3-pole modules can be interlocked to create multipole assemblies. Altech can also supply ready-made assemblies tailored to your specification. Fixed-mount blocks are available with the economical tubular screw, box clamp or the screw-cage clamp and offer several wire entry options to facilitate wiring and increase accessibility.

PLUGGABLE

The two-piece, plug and header design of our “pluggable” terminal blocks speed and simplify board replacement and reduce costly downtime and misconnections. No special tools are required. Headers are soldered into the board and accept the plugs, which are easily removed for fast, convenient board or device replacement. Choose single- mold designs for maximum strength. Or choose modular designs which are assembled from 2 and 3 pole modules when you need maximum flexibility to meet changing requirements. Both are available in a variety of configurations. Headers are available in vertical, and horizontal, single or double-level, with closed or open ends.

We offer pluggables with either screw-cage clamp termination for heavy duty requirements or with tubular screw termination and open headers for cost sensitive applications. We also offer a card edge connector for a quick, reliable and inexpensive connection.

CONNECTION

Altech's printed circuit board terminal blocks give you a choice between tubular screw, box clamp and screw-cage clamp designs:

- When your application calls for the highest reliability and frequent wire terminations, the screw-cage clamp should be your choice. As the clamp is tightened, the nickel-plated cage rises, pressing the wire firmly against the busbar, ensuring solid connections every time. Standard color is green.
- In the tubular screw and box clamp design, tightening the screw presses the conductor directly against the bottom of the clamp. These systems are ideal for cost sensitive, lighter duty applications or applications with infrequent wire terminations. Wire protectors are standard. Standard color is black for tubular screw and green for box clamp.

PIN SPACING

Each clamp style is offered in metric and inch pin spacing. For your convenience, this catalog is organized by pin spacing. Fixed blocks are first, starting with the smallest pin spacing, then pluggable shown in each available spacing.

MATERIALS

All of our printed circuit board terminal blocks feature precision formed or machined metal parts which are electrolytically plated. Nickel or tin-plated brass cage clamps or tubes, wire protectors, and tin-plated solder pins satisfy the most demanding requirements. Housings are precision-molded from self-extinguishing polyamid 6.8 or glass-filled polyester providing excellent strength and temperature resistance.

MARKING

Altech offers marking to identify terminal inputs. Order Hot Stamp Imprinting for permanent marking of large quantities or custom marked terminals. Standard marking is consecutive numbers, left to right. This standard marking can be ordered by adding the imprint sequence to the part number as a suffix (i.e. MV-4612/1-12 would be a MV-4612 terminal block imprinted 1 through 12, left to right).

Custom imprints are also available, consult Altech for ordering information.

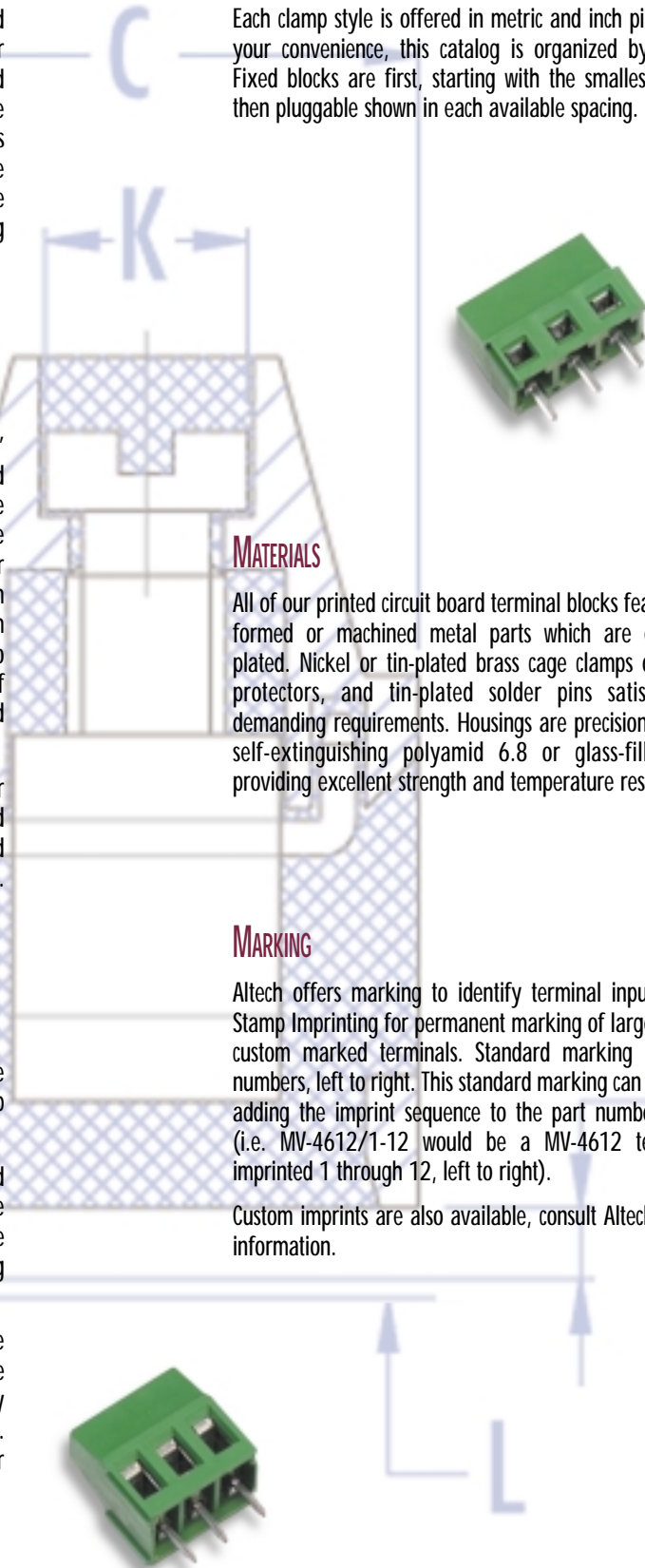

Fixed PCB Blocks

Pin Spacing: 3.50mm
 Orientation: Vertical*
 Clamp Type: Tubular Screw with Wire Protector
 Design: Modular



MLK-13

ELECTRICAL

| | Current | Voltage | Wire Range |
|------------|---------|---------|---|
| US Pending | 10A | 300V | 30-16AWG |
| | 10A | 130V | 1.0mm ² stranded 1.5mm ² solid |

INSTALLATION DATA

| | | | |
|-------------------|------------------------|------------------------|-------|
| Screw Size | M2 | PCB Hole Size | 1.3mm |
| Torque | 0.2Nm (1.8 lbf-in.) | Stripping Lgth. | 6.0mm |

MATERIAL

| | | | |
|---------------------------|-----------|-----------------|-------------------|
| Body | Polyamide | Screw | Galvanized Steel |
| Flammability Class | UL94V-0 | Terminal | Tin-Plated Brass |
| Temperature Limit | 85°C | Clamp | Tin-Plated Bronze |
| Color | Green | | |

| No. Poles | Cat. # | Length (B) (mm) | Std. Pk. |
|-----------|----------|-----------------|----------|
| 2 | MLK-132 | 7.0 | 100 |
| 3 | MLK-133 | 10.5 | 100 |
| 4 | MLK-134 | 14.0 | 50 |
| 5 | MLK-135 | 17.5 | 50 |
| 6 | MLK-136 | 21.0 | 50 |
| 7 | MLK-137 | 24.5 | 50 |
| 8 | MLK-138 | 28.0 | 50 |
| 9 | MLK-139 | 31.5 | 50 |
| 10 | MLK-1310 | 35.0 | 50 |
| 11 | MLK-1311 | 38.5 | 50 |
| 12 | MLK-1312 | 42.0 | 50 |
| 13 | MLK-1313 | 45.5 | 20 |
| 14 | MLK-1314 | 49.0 | 20 |
| 15 | MLK-1315 | 52.5 | 20 |
| 16 | MLK-1316 | 56.0 | 20 |
| 17 | MLK-1317 | 59.5 | 20 |
| 18 | MLK-1318 | 63.0 | 20 |
| 19 | MLK-1319 | 66.5 | 20 |
| 20 | MLK-1320 | 70.0 | 20 |
| 21 | MLK-1321 | 73.5 | 20 |
| 22 | MLK-1322 | 77.0 | 20 |
| 23 | MLK-1323 | 80.5 | 20 |
| 24 | MLK-1324 | 84.0 | 20 |

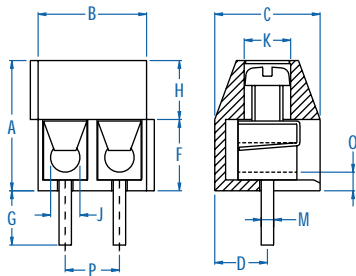

Dimensions

| | | | |
|---|---------|---|----------|
| A | 8.40 mm | I | - |
| B | 7.00 mm | J | 1.80 mm |
| C | 6.80 mm | K | 2.80 mm |
| D | 3.40 mm | L | - |
| E | - | M | Ø0.80 mm |
| F | 4.70 mm | N | - |
| G | 3.50 mm | O | 1.20 mm |
| H | 3.80 mm | P | 3.50 mm |

*Also available in horizontal orientation

Pin Spacing: 3.81mm
 Orientation: Vertical
 Clamp Type: Screw Cage
 Design: Modular

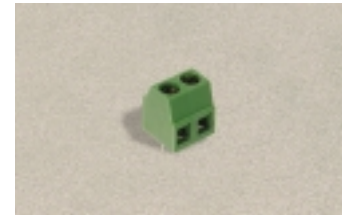

MCK-13

ELECTRICAL

| | Current | Voltage | Wire Range |
|------------|---------|---------|---|
| US Pending | 10A | 300V | 30-16AWG |
| | 10A | 130V | 1.0mm ² stranded 1.5mm ² solid |

INSTALLATION DATA

| | | | |
|-------------------|------------------------|------------------------|-------|
| Screw Size | M2 | PCB Hole Size | 1.3mm |
| Torque | 0.2Nm (1.8 lbf-in.) | Stripping Lgth. | 6.0mm |

MATERIAL

| | | | |
|---------------------------|-----------|-----------------|------------------|
| Body | Polyamide | Screw | Galvanized Steel |
| Flammability Class | UL94V-0 | Terminal | Tin-Plated Brass |
| Temperature Limit | 85°C | Clamp | Nickel Bronze |
| Color | Green | | |

| No. Poles | Cat. # | Length (B) (mm) | Std. Pk. |
|-----------|----------|-----------------|----------|
| 2 | MCK-132 | 7.6 | 100 |
| 3 | MCK-133 | 11.4 | 100 |
| 4 | MCK-134 | 15.2 | 50 |
| 5 | MCK-135 | 19.1 | 50 |
| 6 | MCK-136 | 22.9 | 50 |
| 7 | MCK-137 | 26.7 | 50 |
| 8 | MCK-138 | 30.5 | 50 |
| 9 | MCK-139 | 34.3 | 50 |
| 10 | MCK-1310 | 38.1 | 50 |
| 11 | MCK-1311 | 41.9 | 50 |
| 12 | MCK-1312 | 45.7 | 50 |
| 13 | MCK-1313 | 49.5 | 20 |
| 14 | MCK-1314 | 53.3 | 20 |
| 15 | MCK-1315 | 57.2 | 20 |
| 16 | MCK-1316 | 61.0 | 20 |
| 17 | MCK-1317 | 64.8 | 20 |
| 18 | MCK-1318 | 68.6 | 20 |
| 19 | MCK-1319 | 72.4 | 20 |
| 20 | MCK-1320 | 76.2 | 20 |
| 21 | MCK-1321 | 80.0 | 20 |
| 22 | MCK-1322 | 83.8 | 20 |
| 23 | MCK-1323 | 87.6 | 20 |
| 24 | MCK-1324 | 91.4 | 20 |

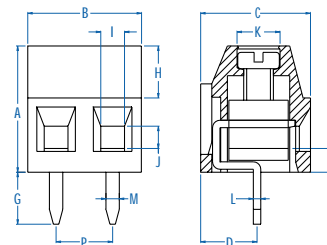

Dimensions

| | | | |
|---|---------|---|---------|
| A | 8.50 mm | I | 1.60 mm |
| B | 7.62 mm | J | 1.50 mm |
| C | 7.40 mm | K | 2.75 mm |
| D | 3.80 mm | L | 0.50 mm |
| E | - | M | 0.90 mm |
| F | - | N | - |
| G | 3.50 mm | O | 1.40 mm |
| H | 5.90 mm | P | 3.81 mm |

Fixed PCB Blocks



Pin Spacing: 5.00mm
 Orientation: Vertical
 Clamp Type: Box with
 Wire Protector
 Design: Modular

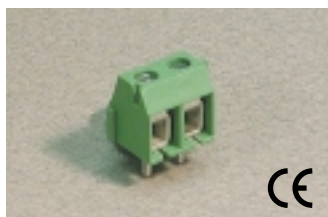

MBE-15

ELECTRICAL

| | Current | Voltage | Wire Range |
|--|---------|---------|---|
| | 10A | 300V | 30-16AWG |
| | 17.5A | 450V | 1.5mm ² Stranded 2.5mm ² Solid |

INSTALLATION DATA

| | | | |
|-------------------|------------------------|------------------------|-------|
| Screw Size | M2.5 | PCB Hole Size | 1.5mm |
| Torque | 0.4Nm (3.6 lbf-in.) | Stripping Lgth. | 7.1mm |

MATERIAL

| | | | |
|---------------------------|-----------------------|-----------------------|----------------------|
| Body | PA6.8 | Screw | Galvanized Steel |
| Flammability Class | UL94V-0 | Terminal | Tin-Plated Brass |
| Temperature Limit | 105°C UL 125°C IEC | Wire Protector | Tin-Plated Bronze |
| Color | Green | | |

| No. Poles | Cat. # | Length (B) (mm) | Std. Pk. |
|-----------|----------|-----------------|----------|
| 2 | MBE-152 | 10.0 | 100 |
| 3 | MBE-153 | 15.0 | 100 |
| 4 | MBE-154 | 20.0 | 50 |
| 5 | MBE-155 | 25.0 | 50 |
| 6 | MBE-156 | 30.0 | 50 |
| 7 | MBE-157 | 35.0 | 50 |
| 8 | MBE-158 | 40.0 | 50 |
| 9 | MBE-159 | 45.0 | 50 |
| 10 | MBE-1510 | 50.0 | 50 |
| 11 | MBE-1511 | 55.0 | 50 |
| 12 | MBE-1512 | 60.0 | 50 |
| 13 | MBE-1513 | 65.0 | 20 |
| 14 | MBE-1514 | 70.0 | 20 |
| 15 | MBE-1515 | 75.0 | 20 |
| 16 | MBE-1516 | 80.0 | 20 |
| 17 | MBE-1517 | 85.0 | 20 |
| 18 | MBE-1518 | 90.0 | 20 |
| 19 | MBE-1519 | 95.0 | 20 |
| 20 | MBE-1520 | 100.0 | 20 |
| 21 | MBE-1521 | 105.0 | 20 |
| 22 | MBE-1522 | 110.0 | 20 |
| 23 | MBE-1523 | 115.0 | 20 |
| 24 | MBE-1524 | 120.0 | 20 |

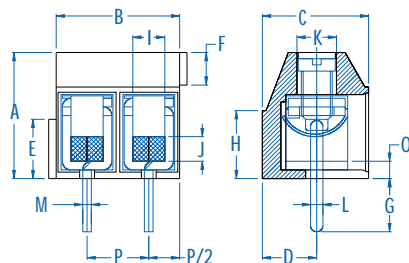

Dimensions

| | | | |
|---|----------|---|----------|
| A | 10.20 mm | I | 2.60 mm |
| B | 10.00 mm | J | 2.00 mm |
| C | 8.60 mm | K | Ø3.20 mm |
| D | 4.40 mm | L | 1.10 mm |
| E | 4.80 mm | M | 0.70 mm |
| F | 2.70 mm | N | - |
| G | 4.30 mm | O | 1.40 mm |
| H | 5.50 mm | P | 5.00 mm |

Pin Spacing: 5.00mm
 Orientation: Vertical
 Clamp Type: Box with
 Wire Protector
 Design: Modular



MVE-15

ELECTRICAL

| | Current | Voltage | Wire Range |
|--|---------|---------|---|
| | 10A | 300V | 30-16AWG |
| | 17.5A | 450V | 1.5mm ² Stranded 2.5mm ² Solid |

INSTALLATION DATA

| | | | |
|-------------------|------------------------|------------------------|-------|
| Screw Size | M2.5 | PCB Hole Size | 1.5mm |
| Torque | 0.4Nm (3.6 lbf-in.) | Stripping Lgth. | 6.8mm |

MATERIAL

| | | | |
|---------------------------|-----------------------|-----------------------|----------------------|
| Body | PA6.8 | Screw | Galvanized Steel |
| Flammability Class | UL94V-0 | Terminal | Tin-Plated Brass |
| Temperature Limit | 105°C UL 125°C IEC | Wire Protector | Tin-Plated Bronze |
| Color | Green | | |

| No. Poles | Cat. # | Length (B) (mm) | Std. Pk. |
|-----------|----------|-----------------|----------|
| 2 | MVE-152 | 10.0 | 100 |
| 3 | MVE-153 | 15.0 | 100 |
| 4 | MVE-154 | 20.0 | 50 |
| 5 | MVE-155 | 25.0 | 50 |
| 6 | MVE-156 | 30.0 | 50 |
| 7 | MVE-157 | 35.0 | 50 |
| 8 | MVE-158 | 40.0 | 50 |
| 9 | MVE-159 | 45.0 | 50 |
| 10 | MVE-1510 | 50.0 | 50 |
| 11 | MVE-1511 | 55.0 | 50 |
| 12 | MVE-1512 | 60.0 | 50 |
| 13 | MVE-1513 | 65.0 | 20 |
| 14 | MVE-1514 | 70.0 | 20 |
| 15 | MVE-1515 | 75.0 | 20 |
| 16 | MVE-1516 | 80.0 | 20 |
| 17 | MVE-1517 | 85.0 | 20 |
| 18 | MVE-1518 | 90.0 | 20 |
| 19 | MVE-1519 | 95.0 | 20 |
| 20 | MVE-1520 | 100.0 | 20 |
| 21 | MVE-1521 | 105.0 | 20 |
| 22 | MVE-1522 | 110.0 | 20 |
| 23 | MVE-1523 | 115.0 | 20 |
| 24 | MVE-1524 | 120.0 | 20 |

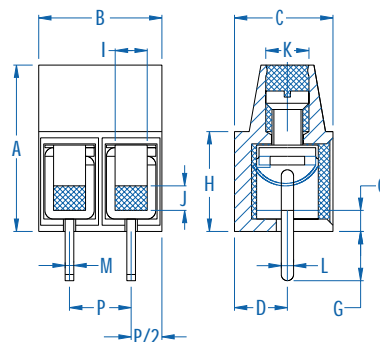

Dimensions

| | | | |
|---|----------|---|----------|
| A | 13.50 mm | I | 2.60 mm |
| B | 10.00 mm | J | 2.00 mm |
| C | 8.30 mm | K | Ø3.40 mm |
| D | 4.30 mm | L | 1.10 mm |
| E | - | M | 0.70 mm |
| F | - | N | - |
| G | 4.10 mm | O | 1.70 mm |
| H | 8.10 mm | P | 5.00 mm |

Fixed PCB Blocks

Pin Spacing: 5.00mm
 Orientation: Vertical
 Clamp Type: Screw Cage
 Design: Modular

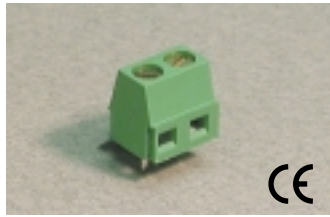

MV-15

ELECTRICAL

| | Current | Voltage | Wire Range |
|--|---------|---------|---|
| | 10A | 300V | 30-16AWG |
| | 13.5A | 250V | 1.5mm ² Stranded 2.5mm ² Solid |

INSTALLATION DATA

| | | | |
|-------------------|------------------------|------------------------|-------|
| Screw Size | M3 | PCB Hole Size | 1.3mm |
| Torque | 0.5Nm (4.5 lbf-in.) | Stripping Lgth. | 6.7mm |

MATERIAL

| | | | |
|---------------------------|-----------------------|-----------------|------------------|
| Body | PA6.8 | Screw | Galvanized Steel |
| Flammability Class | UL94V-0 | Terminal | Tin-Plated Brass |
| Temperature Limit | 105°C UL 125°C IEC | Clamp | Nickel Brass |
| Color | Green | | |

| No. Poles | Cat. # | Length (B) (mm) | Std. Pk. |
|-----------|---------|-----------------|----------|
| 2 | MV-152 | 10.0 | 100 |
| 3 | MV-153 | 15.0 | 100 |
| 4 | MV-154 | 20.0 | 50 |
| 5 | MV-155 | 25.0 | 50 |
| 6 | MV-156 | 30.0 | 50 |
| 7 | MV-157 | 35.0 | 50 |
| 8 | MV-158 | 40.0 | 50 |
| 9 | MV-159 | 45.0 | 50 |
| 10 | MV-1510 | 50.0 | 50 |
| 11 | MV-1511 | 55.0 | 50 |
| 12 | MV-1512 | 60.0 | 50 |
| 13 | MV-1513 | 65.0 | 20 |
| 14 | MV-1514 | 70.0 | 20 |
| 15 | MV-1515 | 75.0 | 20 |
| 16 | MV-1516 | 80.0 | 20 |
| 17 | MV-1517 | 85.0 | 20 |
| 18 | MV-1518 | 90.0 | 20 |
| 19 | MV-1519 | 95.0 | 20 |
| 20 | MV-1520 | 100.0 | 20 |
| 21 | MV-1521 | 105.0 | 20 |
| 22 | MV-1522 | 110.0 | 20 |
| 23 | MV-1523 | 115.0 | 20 |
| 24 | MV-1524 | 120.0 | 20 |

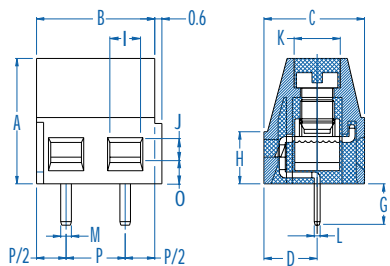

Dimensions

| | | | |
|---|----------|---|----------|
| A | 10.60 mm | I | 2.60 mm |
| B | 10.00 mm | J | 1.70 mm |
| C | 8.50 mm | K | Ø3.90 mm |
| D | 4.50 mm | L | 0.50 mm |
| E | - | M | 0.90 mm |
| F | - | N | - |
| G | 3.50 mm | O | 1.80 mm |
| H | 4.40 mm | P | 5.00 mm |

Pin Spacing: 5.00mm
 Orientation: Vertical
 Clamp Type: Screw Cage
 Design: Modular

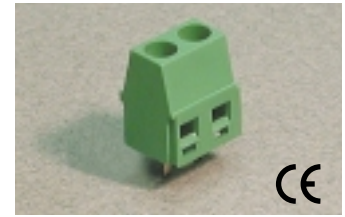

MVS-15

ELECTRICAL

| | Current | Voltage | Wire Range |
|--|------------------|---------|---|
| | 10A ^① | 300V | 30-16AWG |
| | 16A | 250V | 1.5mm ² Stranded 2.5mm ² Solid |

INSTALLATION DATA

| | | | |
|-------------------|------------------------|------------------------|-------|
| Screw Size | M3 | PCB Hole Size | 1.5mm |
| Torque | 0.5Nm (4.5 lbf-in.) | Stripping Lgth. | 6.9mm |

MATERIAL

| | | | |
|---------------------------|-----------------------|-----------------|------------------|
| Body | PA6.8 | Screw | Galvanized Steel |
| Flammability Class | UL94V-0 | Terminal | Tin-Plated Brass |
| Temperature Limit | 105°C UL 125°C IEC | Clamp | Nickel Brass |
| Color | Green | | |

| No. Poles | Cat. # | Length (B) (mm) | Std. Pk. |
|-----------|----------|-----------------|----------|
| 2 | MVS-152 | 10.0 | 100 |
| 3 | MVS-153 | 15.0 | 100 |
| 4 | MVS-154 | 20.0 | 50 |
| 5 | MVS-155 | 25.0 | 50 |
| 6 | MVS-156 | 30.0 | 50 |
| 7 | MVS-157 | 35.0 | 50 |
| 8 | MVS-158 | 40.0 | 50 |
| 9 | MVS-159 | 45.0 | 50 |
| 10 | MVS-1510 | 50.0 | 50 |
| 11 | MVS-1511 | 55.0 | 50 |
| 12 | MVS-1512 | 60.0 | 50 |
| 13 | MVS-1513 | 65.0 | 20 |
| 14 | MVS-1514 | 70.0 | 20 |
| 15 | MVS-1515 | 75.0 | 20 |
| 16 | MVS-1516 | 80.0 | 20 |
| 17 | MVS-1517 | 85.0 | 20 |
| 18 | MVS-1518 | 90.0 | 20 |
| 19 | MVS-1519 | 95.0 | 20 |
| 20 | MVS-1520 | 100.0 | 20 |
| 21 | MVS-1521 | 105.0 | 20 |
| 22 | MVS-1522 | 110.0 | 20 |
| 23 | MVS-1523 | 115.0 | 20 |
| 24 | MVS-1524 | 120.0 | 20 |

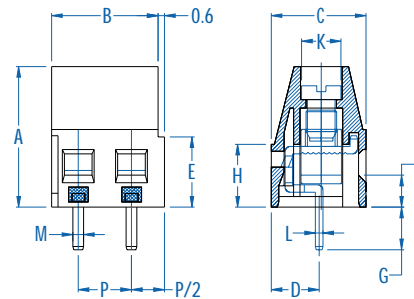

Dimensions

| | | | |
|---|----------|---|----------|
| A | 13.20 mm | I | 2.60 mm |
| B | 10.00 mm | J | 2.00 mm |
| C | 8.90 mm | K | Ø3.70 mm |
| D | 4.50 mm | L | 0.70 mm |
| E | 6.60 mm | M | 1.00 mm |
| F | - | N | - |
| G | 4.00 mm | O | 3.00 mm |
| H | 5.90 mm | P | 5.00 mm |

① 13.5A Factory Wiring - UL

Fixed PCB Blocks

Pin Spacing: 5.00mm
 Orientation: Vertical
 Clamp Type: Screw Cage
 Design: Modular

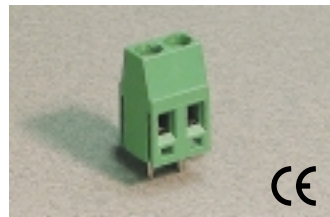

MVE-25

ELECTRICAL

| | Current | Voltage | Wire Range |
|--|------------------|---------|---|
| | 15A ^① | 300V | 30-14AWG |
| | 16A | 450V | 2.5mm ² Stranded 4.0mm ² Solid |

INSTALLATION DATA

| | | | |
|-------------------|------------------------|------------------------|-------|
| Screw Size | M3 | PCB Hole Size | 1.3mm |
| Torque | 0.5Nm (4.5 lbf-in.) | Stripping Lgth. | 7.1mm |

MATERIAL

| | | | |
|---------------------------|-----------------------|-----------------|------------------|
| Body | PA6.8 | Screw | Galvanized Steel |
| Flammability Class | UL94V-0 | Terminal | Tin-Plated Brass |
| Temperature Limit | 105°C UL 125°C IEC | Clamp | Nickel Brass |
| Color | Green | | |

| No. Poles | Cat. # | Length (B) (mm) | Std. Pk. |
|-----------|----------|-----------------|----------|
| 2 | MVE-252 | 10.0 | 100 |
| 3 | MVE-253 | 15.0 | 100 |
| 4 | MVE-254 | 20.0 | 50 |
| 5 | MVE-255 | 25.0 | 50 |
| 6 | MVE-256 | 30.0 | 50 |
| 7 | MVE-257 | 35.0 | 50 |
| 8 | MVE-258 | 40.0 | 50 |
| 9 | MVE-259 | 45.0 | 50 |
| 10 | MVE-2510 | 50.0 | 50 |
| 11 | MVE-2511 | 55.0 | 50 |
| 12 | MVE-2512 | 60.0 | 50 |
| 13 | MVE-2513 | 65.0 | 20 |
| 14 | MVE-2514 | 70.0 | 20 |
| 15 | MVE-2515 | 75.0 | 20 |
| 16 | MVE-2516 | 80.0 | 20 |
| 17 | MVE-2517 | 85.0 | 20 |
| 18 | MVE-2518 | 90.0 | 20 |
| 19 | MVE-2519 | 95.0 | 20 |
| 20 | MVE-2520 | 100.0 | 20 |
| 21 | MVE-2521 | 105.0 | 20 |
| 22 | MVE-2522 | 110.0 | 20 |
| 23 | MVE-2523 | 115.0 | 20 |
| 24 | MVE-2524 | 120.0 | 20 |

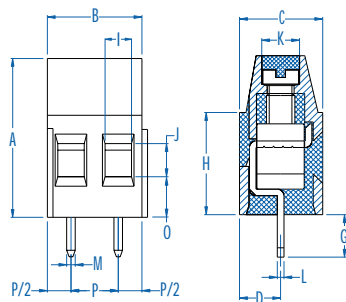

Dimensions

| | | | |
|---|----------|---|----------|
| A | 16.80 mm | I | 2.80 mm |
| B | 10.00 mm | J | 2.80 mm |
| C | 8.90 mm | K | Ø3.80 mm |
| D | 4.35 mm | L | 0.70 mm |
| E | - | M | 0.90 mm |
| F | - | N | - |
| G | 4.50 mm | O | 4.60 mm |
| H | 10.80 mm | P | 5.00 mm |

^① 16A Factory Wiring - UL

Pin Spacing: 5.00mm
 Orientation: Horizontal
 Clamp Type: Tubular Screw with Wire Protector
 Design: Modular



MHE-13

ELECTRICAL

| | Current | Voltage | Wire Range |
|--|---------|---------|------------|
| | 16A | 250V | 22-16AWG |

INSTALLATION DATA

| | | | |
|-------------------|------------------------|------------------------|-------|
| Screw Size | M2.6 | PCB Hole Size | 1.3mm |
| Torque | 0.4Nm (3.6 lbf-in.) | Stripping Lgth. | 5.6mm |

MATERIAL

| | | | |
|---------------------------|------------------------|-----------------------|------------------|
| Body | Glass-Filled Polyester | Screw | Galvanized Steel |
| Flammability Class | UL94V-0 | Terminal | Tin-Plated Brass |
| Temperature Limit | 130°C UL 125°C IEC | Wire Protector | CuSn6 |
| Color | Black | | |

| No. Poles | Cat. # | Length (B) (mm) | Std. Pk. |
|-----------|----------|-----------------|----------|
| 2 | MHE-132 | 10.0 | 100 |
| 3 | MHE-133 | 15.0 | 100 |
| 4 | MHE-134 | 20.0 | 50 |
| 5 | MHE-135 | 25.0 | 50 |
| 6 | MHE-136 | 30.0 | 50 |
| 7 | MHE-137 | 35.0 | 50 |
| 8 | MHE-138 | 40.0 | 50 |
| 9 | MHE-139 | 45.0 | 50 |
| 10 | MHE-1310 | 50.0 | 50 |
| 11 | MHE-1311 | 55.0 | 50 |
| 12 | MHE-1312 | 60.0 | 50 |
| 13 | MHE-1313 | 65.0 | 20 |
| 14 | MHE-1314 | 70.0 | 20 |
| 15 | MHE-1315 | 75.0 | 20 |
| 16 | MHE-1316 | 80.0 | 20 |
| 17 | MHE-1317 | 85.0 | 20 |
| 18 | MHE-1318 | 90.0 | 20 |
| 19 | MHE-1319 | 95.0 | 20 |
| 20 | MHE-1320 | 100.0 | 20 |
| 21 | MHE-1321 | 105.0 | 20 |
| 22 | MHE-1322 | 110.0 | 20 |
| 23 | MHE-1323 | 115.0 | 20 |
| 24 | MHE-1324 | 120.0 | 20 |

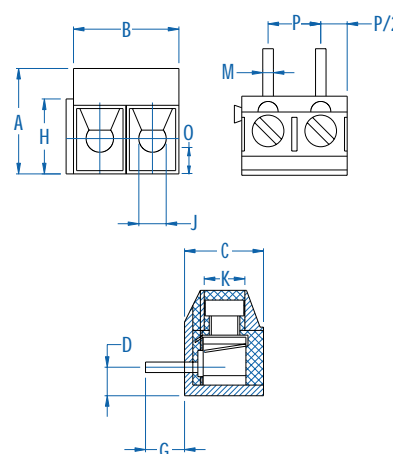

Dimensions

| | | | |
|---|----------|---|----------|
| A | 10.00 mm | I | - |
| B | 10.00 mm | J | Ø2.60 mm |
| C | 7.50 mm | K | Ø3.50 mm |
| D | 2.70 mm | L | - |
| E | - | M | Ø1.00 mm |
| F | - | N | - |
| G | 3.70 mm | O | 1.40 mm |
| H | 7.10 mm | P | 5.00 mm |

Fixed PCB Blocks

Pin Spacing: 5.00mm
 Orientation: Horizontal
 Clamp Type: Tubular Screw with Wire Protector
 Design: Modular



MHE-16

ELECTRICAL

| | Current | Voltage | Wire Range |
|--|---------|---------|------------|
| | 16A | 250V | 22-14AWG |

INSTALLATION DATA

| Screw Size | M3 | PCB Hole Size | 1.3mm |
|------------|---------------------|-----------------|-------|
| Torque | 0.5Nm (4.5 lbf-in.) | Stripping Lgth. | 5.8mm |

MATERIAL

| | | | |
|---------------------------|------------------------|-----------------------|------------------|
| Body | Glass-Filled Polyester | Screw | Galvanized Steel |
| Flammability Class | UL94V-0 | Terminal | Tin-Plated Brass |
| Temperature Limit | 130°C UL 125°C IEC | Wire Protector | CuSn6 |
| Color | Black | | |

| No. Poles | Cat. # | Length (B) (mm) | Std. Pk. |
|-----------|----------|-----------------|----------|
| 2 | MHE-162 | 10.0 | 100 |
| 3 | MHE-163 | 15.0 | 100 |
| 4 | MHE-164 | 20.0 | 50 |
| 5 | MHE-165 | 25.0 | 50 |
| 6 | MHE-166 | 30.0 | 50 |
| 7 | MHE-167 | 35.0 | 50 |
| 8 | MHE-168 | 40.0 | 50 |
| 9 | MHE-169 | 45.0 | 50 |
| 10 | MHE-1610 | 50.0 | 50 |
| 11 | MHE-1611 | 55.0 | 50 |
| 12 | MHE-1612 | 60.0 | 50 |
| 13 | MHE-1613 | 65.0 | 20 |
| 14 | MHE-1614 | 70.0 | 20 |
| 15 | MHE-1615 | 75.0 | 20 |
| 16 | MHE-1616 | 80.0 | 20 |
| 17 | MHE-1617 | 85.0 | 20 |
| 18 | MHE-1618 | 90.0 | 20 |
| 19 | MHE-1619 | 95.0 | 20 |
| 20 | MHE-1620 | 100.0 | 20 |
| 21 | MHE-1621 | 105.0 | 20 |
| 22 | MHE-1622 | 110.0 | 20 |
| 23 | MHE-1623 | 115.0 | 20 |
| 24 | MHE-1624 | 120.0 | 20 |

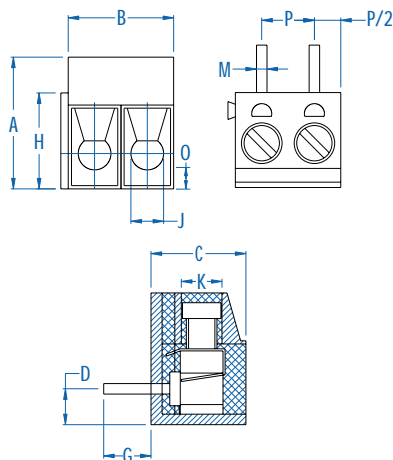

Dimensions

| | | | |
|---|----------|---|----------|
| A | 12.50 mm | I | - |
| B | 10.00 mm | J | Ø3.10 mm |
| C | 9.00 mm | K | Ø3.95 mm |
| D | 3.40 mm | L | - |
| E | - | M | Ø1.00 mm |
| F | - | N | - |
| G | 4.50 mm | O | 2.00 mm |
| H | 8.80 mm | P | 5.00 mm |

Pin Spacing: 5.00mm
 Orientation: Horizontal
 Clamp Type: Screw Cage
 Design: Modular



MH-15

ELECTRICAL

| | Current | Voltage | Wire Range |
|--|---------|---------|---------------------------------|
| | 10A | 300V | 30-16AWG |
| | 13.5A | 250V | 1.5mm² Stranded 2.5mm² Solid |

INSTALLATION DATA

| Screw Size | M3 | PCB Hole Size | 1.3mm |
|------------|---------------------|-----------------|-------|
| Torque | 0.5Nm (4.5 lbf-in.) | Stripping Lgth. | 6.7mm |

MATERIAL

| | | | |
|---------------------------|-----------------------|-----------------|------------------|
| Body | PA6.8 | Screw | Galvanized Steel |
| Flammability Class | UL94V-0 | Terminal | Tin-Plated Brass |
| Temperature Limit | 105°C UL 125°C IEC | Clamp | Nickel Brass |
| Color | Green | | |

| No. Poles | Cat. # | Length (B) (mm) | Std. Pk. |
|-----------|---------|-----------------|----------|
| 2 | MH-152 | 10.0 | 100 |
| 3 | MH-153 | 15.0 | 100 |
| 4 | MH-154 | 20.0 | 50 |
| 5 | MH-155 | 25.0 | 50 |
| 6 | MH-156 | 30.0 | 50 |
| 7 | MH-157 | 35.0 | 50 |
| 8 | MH-158 | 40.0 | 50 |
| 9 | MH-159 | 45.0 | 50 |
| 10 | MH-1510 | 50.0 | 50 |
| 11 | MH-1511 | 55.0 | 50 |
| 12 | MH-1512 | 60.0 | 50 |
| 13 | MH-1513 | 65.0 | 20 |
| 14 | MH-1514 | 70.0 | 20 |
| 15 | MH-1515 | 75.0 | 20 |
| 16 | MH-1516 | 80.0 | 20 |
| 17 | MH-1517 | 85.0 | 20 |
| 18 | MH-1518 | 90.0 | 20 |
| 19 | MH-1519 | 95.0 | 20 |
| 20 | MH-1520 | 100.0 | 20 |
| 21 | MH-1521 | 105.0 | 20 |
| 22 | MH-1522 | 110.0 | 20 |
| 23 | MH-1523 | 115.0 | 20 |
| 24 | MH-1524 | 120.0 | 20 |

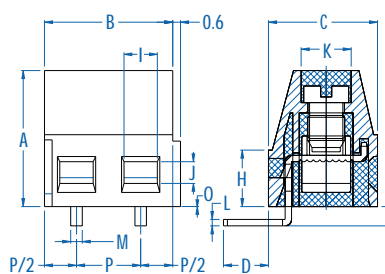

Dimensions

| | | | |
|---|----------|---|----------|
| A | 10.60 mm | I | 2.60 mm |
| B | 10.00 mm | J | 1.70 mm |
| C | 8.50 mm | K | Ø3.90 mm |
| D | 3.70 mm | L | 0.50 mm |
| E | - | M | 0.90 mm |
| F | - | N | - |
| G | 1.50 mm | O | 1.80 mm |
| H | 4.40 mm | P | 5.00 mm |

Fixed PCB Blocks



Pin Spacing: 5.00mm
 Orientation: Horizontal
 Clamp Type: Screw Cage
 Design: Modular

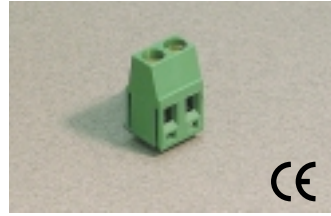

MHE-25

ELECTRICAL

| | Current | Voltage | Wire Range |
|--|------------------|---------|---|
| | 15A ^① | 300V | 30-14AWG |
| | 16A | 450V | 2.5mm ² Stranded 4.0mm ² Solid |

INSTALLATION DATA

| | | | |
|-------------------|------------------------|------------------------|-------|
| Screw Size | M3 | PCB Hole Size | 1.3mm |
| Torque | 0.5Nm (4.5 lbf-in.) | Stripping Lgth. | 7.1mm |

MATERIAL

| | | | |
|---------------------------|-----------------------|-----------------|------------------|
| Body | PA6.8 | Screw | Galvanized Steel |
| Flammability Class | UL94V-0 | Terminal | Tin-Plated Brass |
| Temperature Limit | 105°C UL 125°C IEC | Clamp | Nickeled Brass |
| Color | Green | | |

| No. Poles | Cat. # | Length (B) (mm) | Std. Pk. |
|-----------|----------|-----------------|----------|
| 2 | MHE-252 | 10.0 | 100 |
| 3 | MHE-253 | 15.0 | 100 |
| 4 | MHE-254 | 20.0 | 50 |
| 5 | MHE-255 | 25.0 | 50 |
| 6 | MHE-256 | 30.0 | 50 |
| 7 | MHE-257 | 35.0 | 50 |
| 8 | MHE-258 | 40.0 | 50 |
| 9 | MHE-259 | 45.0 | 50 |
| 10 | MHE-2510 | 50.0 | 50 |
| 11 | MHE-2511 | 55.0 | 50 |
| 12 | MHE-2512 | 60.0 | 50 |
| 13 | MHE-2513 | 65.0 | 20 |
| 14 | MHE-2514 | 70.0 | 20 |
| 15 | MHE-2515 | 75.0 | 20 |
| 16 | MHE-2516 | 80.0 | 20 |
| 17 | MHE-2517 | 85.0 | 20 |
| 18 | MHE-2518 | 90.0 | 20 |
| 19 | MHE-2519 | 95.0 | 20 |
| 20 | MHE-2520 | 100.0 | 20 |
| 21 | MHE-2521 | 105.0 | 20 |
| 22 | MHE-2522 | 110.0 | 20 |
| 23 | MHE-2523 | 115.0 | 20 |
| 24 | MHE-2524 | 120.0 | 20 |

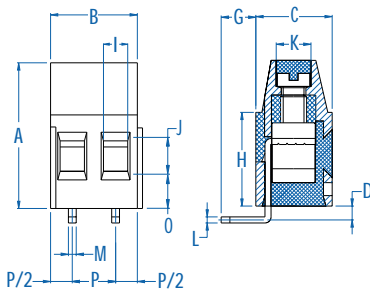

Dimensions

| | | | |
|---|----------|---|----------|
| A | 16.80 mm | I | 2.80 mm |
| B | 10.00 mm | J | 2.80 mm |
| C | 8.90 mm | K | Ø3.80 mm |
| D | 1.40 mm | L | 0.70 mm |
| E | - | M | 0.90 mm |
| F | - | N | - |
| G | 4.00 mm | O | 4.60 mm |
| H | 10.80 mm | P | 5.00 mm |

① 16A Factory Wiring - UL

Pin Spacing: 5.00mm
 Orientation: Reverse Horizontal
 Clamp Type: Screw Cage
 Design: Modular

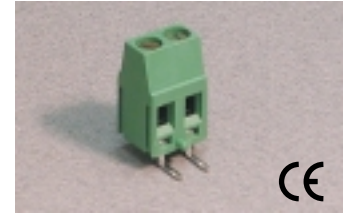

MHR-25

ELECTRICAL

| | Current | Voltage | Wire Range |
|--|------------------|---------|---|
| | 15A ^① | 300V | 30-14AWG |
| | 16A | 250V | 2.5mm ² Stranded 4.0mm ² Solid |

INSTALLATION DATA

| | | | |
|-------------------|------------------------|------------------------|-------|
| Screw Size | M3 | PCB Hole Size | 1.3mm |
| Torque | 0.5Nm (4.5 lbf-in.) | Stripping Lgth. | 7.1mm |

MATERIAL

| | | | |
|---------------------------|-----------------------|-----------------|------------------|
| Body | PA6.8 | Screw | Galvanized Steel |
| Flammability Class | UL94V-0 | Terminal | Tin-Plated Brass |
| Temperature Limit | 105°C UL 125°C IEC | Clamp | Nickeled Brass |
| Color | Green | | |

| No. Poles | Cat. # | Length (B) (mm) | Std. Pk. |
|-----------|----------|-----------------|----------|
| 2 | MHR-252 | 10.0 | 100 |
| 3 | MHR-253 | 15.0 | 100 |
| 4 | MHR-254 | 20.0 | 50 |
| 5 | MHR-255 | 25.0 | 50 |
| 6 | MHR-256 | 30.0 | 50 |
| 7 | MHR-257 | 35.0 | 50 |
| 8 | MHR-258 | 40.0 | 50 |
| 9 | MHR-259 | 45.0 | 50 |
| 10 | MHR-2510 | 50.0 | 50 |
| 11 | MHR-2511 | 55.0 | 50 |
| 12 | MHR-2512 | 60.0 | 50 |
| 13 | MHR-2513 | 65.0 | 20 |
| 14 | MHR-2514 | 70.0 | 20 |
| 15 | MHR-2515 | 75.0 | 20 |
| 16 | MHR-2516 | 80.0 | 20 |
| 17 | MHR-2517 | 85.0 | 20 |
| 18 | MHR-2518 | 90.0 | 20 |
| 19 | MHR-2519 | 95.0 | 20 |
| 20 | MHR-2520 | 100.0 | 20 |
| 21 | MHR-2521 | 105.0 | 20 |
| 22 | MHR-2522 | 110.0 | 20 |
| 23 | MHR-2523 | 115.0 | 20 |
| 24 | MHR-2524 | 120.0 | 20 |

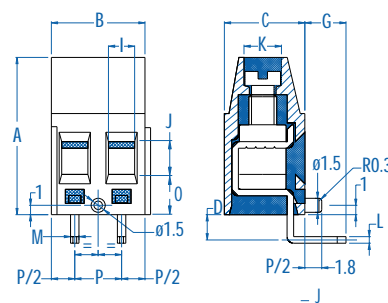

Dimensions

| | | | |
|---|----------|---|----------|
| A | 16.80 mm | I | 2.80 mm |
| B | 10.00 mm | J | 2.80 mm |
| C | 8.90 mm | K | Ø3.80 mm |
| D | 2.30 mm | L | 0.70 mm |
| E | - | M | 0.90 mm |
| F | - | N | - |
| G | 4.00 mm | O | 4.60 mm |
| H | - | P | 5.00 mm |

① 16A Factory Wiring - UL

Fixed PCB Blocks

Pin Spacing: 5.00mm
 Orientation: 45°
 Clamp Type: Screw Cage
 Design: Modular

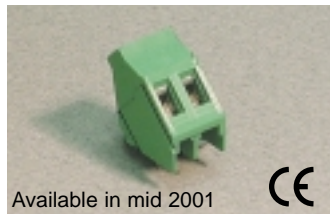

Available in mid 2001

MI-25(5.00)

ELECTRICAL

| | Current | Voltage | Wire Range |
|--|------------------|---------|---|
| | 15A ^① | 300V | 30-14AWG |
| | 16A | 450V | 2.5mm ² Stranded 4.0mm ² Solid |

INSTALLATION DATA

| | | | |
|-------------------|------------------------|------------------------|-------|
| Screw Size | M3 | PCB Hole Size | 1.3mm |
| Torque | 0.5Nm (4.5 lbf-in.) | Stripping Lgth. | 8.3mm |

MATERIAL

| | | | |
|---------------------------|-----------------------|-----------------|------------------|
| Body | PA6.8 | Screw | Galvanized Steel |
| Flammability Class | UL94V-0 | Terminal | Tin-Plated Brass |
| Temperature Limit | 105°C UL 125°C IEC | Clamp | Nickel Brass |
| Color | Green | | |

| No. Poles | Cat. # | Length (B) (mm) | Std. Pk. |
|-----------|----------------|-----------------|----------|
| 2 | MI-252 (5.00) | 10.0 | 100 |
| 3 | MI-253 (5.00) | 15.0 | 100 |
| 4 | MI-254 (5.00) | 20.0 | 50 |
| 5 | MI-255 (5.00) | 25.0 | 50 |
| 6 | MI-256 (5.00) | 30.0 | 50 |
| 7 | MI-257 (5.00) | 35.0 | 50 |
| 8 | MI-258 (5.00) | 40.0 | 50 |
| 9 | MI-259 (5.00) | 45.0 | 50 |
| 10 | MI-2510 (5.00) | 50.0 | 50 |
| 11 | MI-2511 (5.00) | 55.0 | 50 |
| 12 | MI-2512 (5.00) | 60.0 | 50 |
| 13 | MI-2513 (5.00) | 65.0 | 20 |
| 14 | MI-2514 (5.00) | 70.0 | 20 |
| 15 | MI-2515 (5.00) | 75.0 | 20 |
| 16 | MI-2516 (5.00) | 80.0 | 20 |
| 17 | MI-2517 (5.00) | 85.0 | 20 |
| 18 | MI-2518 (5.00) | 90.0 | 20 |
| 19 | MI-2519 (5.00) | 95.0 | 20 |
| 20 | MI-2520 (5.00) | 100.0 | 20 |
| 21 | MI-2521 (5.00) | 105.0 | 20 |
| 22 | MI-2522 (5.00) | 110.0 | 20 |
| 23 | MI-2523 (5.00) | 115.0 | 20 |
| 24 | MI-2524 (5.00) | 120.0 | 20 |

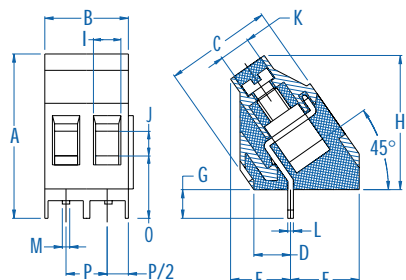

Dimensions

| | | | |
|---|----------|---|----------|
| A | 21.10 mm | I | 2.80 mm |
| B | 10.00 mm | J | 2.80 mm |
| C | 13.00 mm | K | Ø3.80 mm |
| D | 4.95 mm | L | 0.70 mm |
| E | 7.00 mm | M | 0.90 mm |
| F | 10.10 mm | N | - |
| G | 4.00 mm | O | 8.50 mm |
| H | 16.30 mm | P | 5.00 mm |

① 16A Factory Wiring - UL

Pin Spacing: 5.08mm
 Orientation: Vertical
 Clamp Type: Box with Wire Protector
 Design: Modular

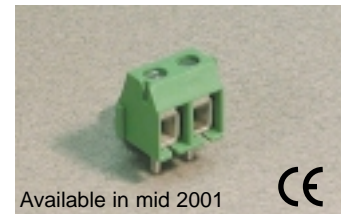

Available in mid 2001

MBES-15

ELECTRICAL

| | Current | Voltage | Wire Range |
|--|------------------|---------|---|
| | 10A ^① | 300V | 30-16AWG |
| | 17.5A | 250V | 1.5mm ² Stranded 2.5mm ² Solid |

INSTALLATION DATA

| | | | |
|-------------------|------------------------|------------------------|-------|
| Screw Size | M2.5 | PCB Hole Size | 1.5mm |
| Torque | 0.4Nm (3.6 lbf-in.) | Stripping Lgth. | 6.7mm |

MATERIAL

| | | | |
|---------------------------|-----------------------|-----------------------|----------------------|
| Body | PA6.8 | Screw | Galvanized Steel |
| Flammability Class | UL94V-0 | Terminal | Tin-Plated Brass |
| Temperature Limit | 105°C UL 125°C IEC | Wire Protector | Tin-Plated Bronze |
| Color | Green | | |

| No. Poles | Cat. # | Length (B) (mm) | Std. Pk. |
|-----------|-----------|-----------------|----------|
| 2 | MBES-152 | 10.2 | 100 |
| 3 | MBES-153 | 15.2 | 100 |
| 4 | MBES-154 | 20.3 | 50 |
| 5 | MBES-155 | 25.4 | 50 |
| 6 | MBES-156 | 30.5 | 50 |
| 7 | MBES-157 | 35.6 | 50 |
| 8 | MBES-158 | 40.6 | 50 |
| 9 | MBES-159 | 45.7 | 50 |
| 10 | MBES-1510 | 50.8 | 50 |
| 11 | MBES-1511 | 55.9 | 50 |
| 12 | MBES-1512 | 61.0 | 50 |
| 13 | MBES-1513 | 66.0 | 20 |
| 14 | MBES-1514 | 71.1 | 20 |
| 15 | MBES-1515 | 76.2 | 20 |
| 16 | MBES-1516 | 81.3 | 20 |
| 17 | MBES-1517 | 86.4 | 20 |
| 18 | MBES-1518 | 91.4 | 20 |
| 19 | MBES-1519 | 96.5 | 20 |
| 20 | MBES-1520 | 101.6 | 20 |
| 21 | MBES-1521 | 106.7 | 20 |
| 22 | MBES-1522 | 111.8 | 20 |
| 23 | MBES-1523 | 116.8 | 20 |
| 24 | MBES-1524 | 121.9 | 20 |

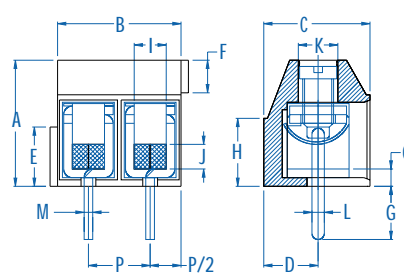

Dimensions

| | | | |
|---|----------|---|----------|
| A | 10.20 mm | I | 2.60 mm |
| B | 10.16 mm | J | 2.00 mm |
| C | 7.60 mm | K | Ø3.00 mm |
| D | 3.80 mm | L | 1.10 mm |
| E | 4.70 mm | M | 0.70 mm |
| F | 2.80 mm | N | - |
| G | 4.30 mm | O | 1.40 mm |
| H | 5.30 mm | P | 5.08 mm |

① 17.5A Factory Wiring - UL

Fixed PCB Blocks

Pin Spacing: 5.08mm
 Orientation: Vertical
 Clamp Type: Screw Cage
 Design: Modular

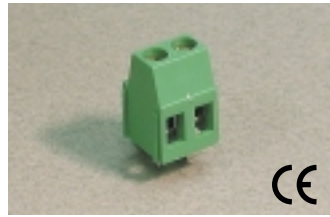

MV-25

ELECTRICAL

| | Current | Voltage | Wire Range |
|--|------------------|---------|---|
| | 15A ^① | 300V | 30-14AWG |
| | 16A | 450V | 2.5mm ² Stranded 4.0mm ² Solid |

INSTALLATION DATA

| | | | |
|-------------------|------------------------|------------------------|-------|
| Screw Size | M3 | PCB Hole Size | 1.3mm |
| Torque | 0.5Nm (4.5 lbf-in.) | Stripping Lgth. | 8.3mm |

MATERIAL

| | | | |
|---------------------------|-----------------------|-----------------|------------------|
| Body | PA6.8 | Screw | Galvanized Steel |
| Flammability Class | UL94V-0 | Terminal | Tin-Plated Brass |
| Temperature Limit | 105°C UL 125°C IEC | Clamp | Nickeled Brass |
| Color | Green | | |

| No. Poles | Cat. # | Length (B) (mm) | Std. Pk. |
|-----------|---------|-----------------|----------|
| 2 | MV-252 | 10.2 | 100 |
| 3 | MV-253 | 15.2 | 100 |
| 4 | MV-254 | 20.3 | 50 |
| 5 | MV-255 | 25.4 | 50 |
| 6 | MV-256 | 30.5 | 50 |
| 7 | MV-257 | 35.6 | 50 |
| 8 | MV-258 | 40.6 | 50 |
| 9 | MV-259 | 45.7 | 50 |
| 10 | MV-2510 | 50.8 | 50 |
| 11 | MV-2511 | 55.9 | 50 |
| 12 | MV-2512 | 61.0 | 50 |
| 13 | MV-2513 | 66.0 | 20 |
| 14 | MV-2514 | 71.1 | 20 |
| 15 | MV-2515 | 76.2 | 20 |
| 16 | MV-2516 | 81.3 | 20 |
| 17 | MV-2517 | 86.4 | 20 |
| 18 | MV-2518 | 91.4 | 20 |
| 19 | MV-2519 | 96.5 | 20 |
| 20 | MV-2520 | 101.6 | 20 |
| 21 | MV-2521 | 106.7 | 20 |
| 22 | MV-2522 | 111.8 | 20 |
| 23 | MV-2523 | 116.8 | 20 |
| 24 | MV-2524 | 121.9 | 20 |

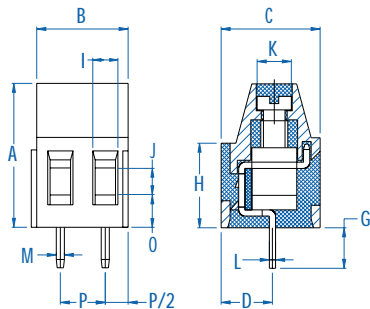

Dimensions

| | | | |
|---|----------|---|----------|
| A | 16.00 mm | I | 2.80 mm |
| B | 10.16 mm | J | 2.80 mm |
| C | 11.00 mm | K | Ø3.80 mm |
| D | 5.00 mm | L | 0.70 mm |
| E | - | M | 0.90 mm |
| F | - | N | - |
| G | 4.50 mm | O | 3.60 mm |
| H | 9.40 mm | P | 5.08 mm |

① 16A Factory Wiring - UL

Pin Spacing: 5.08mm
 Orientation: Vertical
 Clamp Type: Screw Cage
 Design: Modular

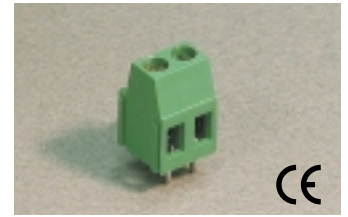

MV-25-D

ELECTRICAL

| | Current | Voltage | Wire Range |
|--|------------------|---------|---|
| | 15A ^① | 300V | 30-14AWG |
| | 24A | 450V | 2.5mm ² Stranded 4.0mm ² Solid |

INSTALLATION DATA

| | | | |
|-------------------|------------------------|------------------------|-------|
| Screw Size | M3 | PCB Hole Size | 1.3mm |
| Torque | 0.5Nm (4.5 lbf-in.) | Stripping Lgth. | 8.3mm |

MATERIAL

| | | | |
|---------------------------|-----------------------|-----------------|------------------|
| Body | PA6.8 | Screw | Galvanized Steel |
| Flammability Class | UL94V-0 | Terminal | Tin-Plated Brass |
| Temperature Limit | 105°C UL 125°C IEC | Clamp | Nickeled Brass |
| Color | Green | | |

| No. Poles | Cat. # | Length (B) (mm) | Std. Pk. |
|-----------|-----------|-----------------|----------|
| 2 | MV-252-D | 10.2 | 100 |
| 3 | MV-253-D | 15.2 | 100 |
| 4 | MV-254-D | 20.3 | 50 |
| 5 | MV-255-D | 25.4 | 50 |
| 6 | MV-256-D | 30.5 | 50 |
| 7 | MV-257-D | 35.6 | 50 |
| 8 | MV-258-D | 40.6 | 50 |
| 9 | MV-259-D | 45.7 | 50 |
| 10 | MV-2510-D | 50.8 | 50 |
| 11 | MV-2511-D | 55.9 | 50 |
| 12 | MV-2512-D | 61.0 | 50 |
| 13 | MV-2513-D | 66.0 | 20 |
| 14 | MV-2514-D | 71.1 | 20 |
| 15 | MV-2515-D | 76.2 | 20 |
| 16 | MV-2516-D | 81.3 | 20 |
| 17 | MV-2517-D | 86.4 | 20 |
| 18 | MV-2518-D | 91.4 | 20 |
| 19 | MV-2519-D | 96.5 | 20 |
| 20 | MV-2520-D | 101.6 | 20 |
| 21 | MV-2521-D | 106.7 | 20 |
| 22 | MV-2522-D | 111.8 | 20 |
| 23 | MV-2523-D | 116.8 | 20 |
| 24 | MV-2524-D | 121.9 | 20 |

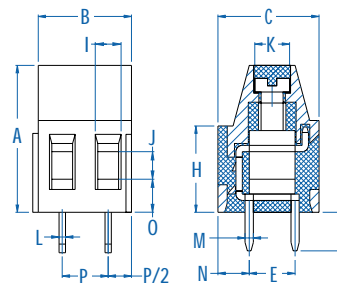

Dimensions

| | | | |
|---|----------|---|----------|
| A | 16.00 mm | I | 2.80 mm |
| B | 10.16 mm | J | 2.80 mm |
| C | 11.00 mm | K | Ø3.80 mm |
| D | - | L | 0.70 mm |
| E | 5.00 mm | M | 0.90 mm |
| F | - | N | 3.40 mm |
| G | 4.50 mm | O | 3.60 mm |
| H | 9.40 mm | P | 5.08 mm |

① 18A Factory Wiring - UL

Fixed PCB Blocks

Pin Spacing: 5.08mm*
 Orientation: Vertical
 Clamp Type: Screw Cage
 Design: Modular

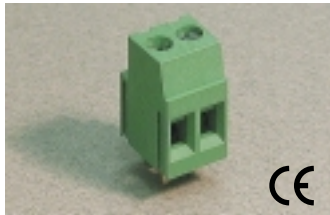

MVSP-25

ELECTRICAL

| | Current | Voltage | Wire Range |
|--|------------------|---------|---|
| | 15A ^① | 300V | 30-14AWG |
| | 24A | 450V | 2.5mm ² Stranded 4.0mm ² Solid |

INSTALLATION DATA

| Screw Size | M3 | PCB Hole Size | 1.5mm |
|------------|------------------------|-----------------|-------|
| Torque | 0.5Nm (4.5 lbf-in.) | Stripping Lgth. | 9.5mm |

MATERIAL

| | | | |
|---------------------------|-----------------------|-----------------|------------------|
| Body | PA6.8 | Screw | Galvanized Steel |
| Flammability Class | UL94V-0 | Terminal | Tin-Plated Brass |
| Temperature Limit | 105°C UL 125°C IEC | Clamp | Nickel Brass |
| Color | Green | | |

| No. Poles | Cat. # | Length (B) (mm) | Std. Pk. |
|-----------|-----------|-----------------|----------|
| 2 | MVSP-252 | 10.2 | 100 |
| 3 | MVSP-253 | 15.2 | 100 |
| 4 | MVSP-254 | 20.3 | 50 |
| 5 | MVSP-255 | 25.4 | 50 |
| 6 | MVSP-256 | 30.5 | 50 |
| 7 | MVSP-257 | 35.6 | 50 |
| 8 | MVSP-258 | 40.6 | 50 |
| 9 | MVSP-259 | 45.7 | 50 |
| 10 | MVSP-2510 | 50.8 | 50 |
| 11 | MVSP-2511 | 55.9 | 50 |
| 12 | MVSP-2512 | 61.0 | 50 |
| 13 | MVSP-2513 | 66.0 | 20 |
| 14 | MVSP-2514 | 71.1 | 20 |
| 15 | MVSP-2515 | 76.2 | 20 |
| 16 | MVSP-2516 | 81.3 | 20 |
| 17 | MVSP-2517 | 86.4 | 20 |
| 18 | MVSP-2518 | 91.4 | 20 |
| 19 | MVSP-2519 | 96.5 | 20 |
| 20 | MVSP-2520 | 101.6 | 20 |
| 21 | MVSP-2521 | 106.7 | 20 |
| 22 | MVSP-2522 | 111.8 | 20 |
| 23 | MVSP-2523 | 116.8 | 20 |
| 24 | MVSP-2524 | 121.9 | 20 |

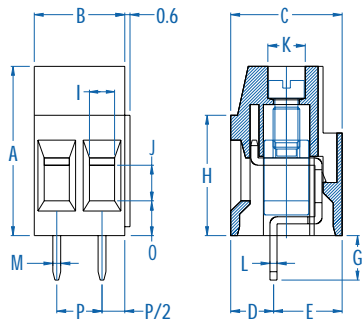

Dimensions

| | | | |
|---|----------|---|----------|
| A | 19.00 mm | I | 2.80 mm |
| B | 10.16 mm | J | 4.00 mm |
| C | 12.50 mm | K | Ø4.00 mm |
| D | 4.80 mm | L | 0.80 mm |
| E | 7.70 mm | M | 1.00 mm |
| F | - | N | - |
| G | 5.00 mm | O | 3.90 mm |
| H | 13.50 mm | P | 5.08 mm |

* Also available in 10.16mm pin spacing.

^① 18A Factory Wiring - UL

Pin Spacing: 5.08mm
 Orientation: Horizontal
 Clamp Type: Screw Cage
 Design: Modular

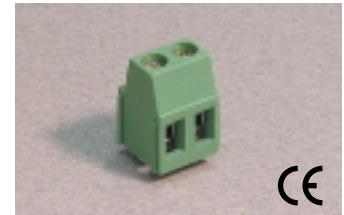

MH-25

ELECTRICAL

| | Current | Voltage | Wire Range |
|--|------------------|---------|---|
| | 15A ^① | 300V | 30-14AWG |
| | 16A | 450V | 2.5mm ² Stranded 4.0mm ² Solid |

INSTALLATION DATA

| Screw Size | M3 | PCB Hole Size | 1.3mm |
|------------|------------------------|-----------------|-------|
| Torque | 0.5Nm (4.5 lbf-in.) | Stripping Lgth. | 8.3mm |

MATERIAL

| | | | |
|---------------------------|-----------------------|-----------------|------------------|
| Body | PA6.8 | Screw | Galvanized Steel |
| Flammability Class | UL94V-0 | Terminal | Tin-Plated Brass |
| Temperature Limit | 105°C UL 125°C IEC | Clamp | Nickel Brass |
| Color | Green | | |

| No. Poles | Cat. # | Length (B) (mm) | Std. Pk. |
|-----------|---------|-----------------|----------|
| 2 | MH-252 | 10.2 | 100 |
| 3 | MH-253 | 15.2 | 100 |
| 4 | MH-254 | 20.3 | 50 |
| 5 | MH-255 | 25.4 | 50 |
| 6 | MH-256 | 30.5 | 50 |
| 7 | MH-257 | 35.6 | 50 |
| 8 | MH-258 | 40.6 | 50 |
| 9 | MH-259 | 45.7 | 50 |
| 10 | MH-2510 | 50.8 | 50 |
| 11 | MH-2511 | 55.9 | 50 |
| 12 | MH-2512 | 61.0 | 50 |
| 13 | MH-2513 | 66.0 | 20 |
| 14 | MH-2514 | 71.1 | 20 |
| 15 | MH-2515 | 76.2 | 20 |
| 16 | MH-2516 | 81.3 | 20 |
| 17 | MH-2517 | 86.4 | 20 |
| 18 | MH-2518 | 91.4 | 20 |
| 19 | MH-2519 | 96.5 | 20 |
| 20 | MH-2520 | 101.6 | 20 |
| 21 | MH-2521 | 106.7 | 20 |
| 22 | MH-2522 | 111.8 | 20 |
| 23 | MH-2523 | 116.8 | 20 |
| 24 | MH-2524 | 121.9 | 20 |

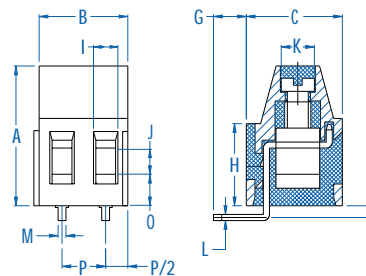

Dimensions

| | | | |
|---|----------|---|----------|
| A | 16.00 mm | I | 2.80 mm |
| B | 10.16 mm | J | 2.80 mm |
| C | 11.00 mm | K | Ø3.80 mm |
| D | 2.00 mm | L | 0.70 mm |
| E | - | M | 0.90 mm |
| F | - | N | - |
| G | 3.60 mm | O | 3.60 mm |
| H | 9.40 mm | P | 5.08 mm |

^① 16A Factory Wiring - UL

Fixed PCB Blocks



Pin Spacing: 5.08mm*
 Orientation: Horizontal
 Clamp Type: Screw Cage
 Design: Modular

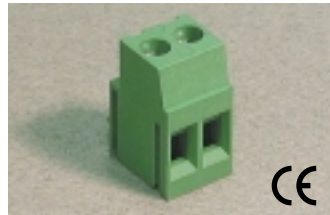

MHSP-25

ELECTRICAL

| | Current | Voltage | Wire Range |
|------------|------------------|---------|---|
| US Pending | 15A ^① | 300V | 30-14AWG |
| | 24A | 450V | 2.5mm ² Stranded 4.0mm ² Solid |

INSTALLATION DATA

| | | | |
|-------------------|------------------------|------------------------|-------|
| Screw Size | M3 | PCB Hole Size | 1.5mm |
| Torque | 0.5Nm (4.5 lbf-in.) | Stripping Lgth. | 9.5mm |

MATERIAL

| | | | |
|---------------------------|-----------------------|-----------------|------------------|
| Body | PA6.8 | Screw | Galvanized Steel |
| Flammability Class | UL94V-0 | Terminal | Tin-Plated Brass |
| Temperature Limit | 105°C UL 125°C IEC | Clamp | Nickeled Brass |
| Color | Green | | |

| No. Poles | Cat. # | Length (B) (mm) | Std. Pk. |
|-----------|-----------|-----------------|----------|
| 2 | MHSP-252 | 10.2 | 100 |
| 3 | MHSP-253 | 15.2 | 100 |
| 4 | MHSP-254 | 20.3 | 50 |
| 5 | MHSP-255 | 25.4 | 50 |
| 6 | MHSP-256 | 30.5 | 50 |
| 7 | MHSP-257 | 35.6 | 50 |
| 8 | MHSP-258 | 40.6 | 50 |
| 9 | MHSP-259 | 45.7 | 50 |
| 10 | MHSP-2510 | 50.8 | 50 |
| 11 | MHSP-2511 | 55.9 | 50 |
| 12 | MHSP-2512 | 61.0 | 50 |
| 13 | MHSP-2513 | 66.0 | 20 |
| 14 | MHSP-2514 | 71.1 | 20 |
| 15 | MHSP-2515 | 76.2 | 20 |
| 16 | MHSP-2516 | 81.3 | 20 |
| 17 | MHSP-2517 | 86.4 | 20 |
| 18 | MHSP-2518 | 91.4 | 20 |
| 19 | MHSP-2519 | 96.5 | 20 |
| 20 | MHSP-2520 | 101.6 | 20 |
| 21 | MHSP-2521 | 106.7 | 20 |
| 22 | MHSP-2522 | 111.8 | 20 |
| 23 | MHSP-2523 | 116.8 | 20 |
| 24 | MHSP-2524 | 121.9 | 20 |

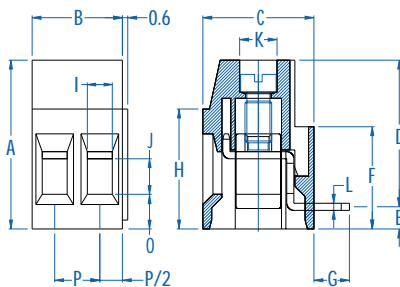

Dimensions

| | | | |
|---|----------|---|----------|
| A | 19.00 mm | I | 2.80 mm |
| B | 10.16 mm | J | 4.00 mm |
| C | 12.50 mm | K | Ø4.00 mm |
| D | 16.50 mm | L | 0.80 mm |
| E | 2.50 mm | M | 1.00 mm |
| F | 11.50 mm | N | - |
| G | 4.00 mm | O | 3.90 mm |
| H | 13.50 mm | P | 5.08 mm |

* Also available in 10.16mm pin spacing.

^① 18A Factory Wiring - UL

Pin Spacing: 5.08mm
 Orientation: 35°
 Clamp Type: Screw Cage
 Design: Modular

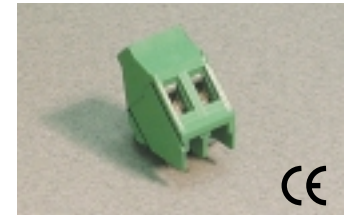

MI-25 (35)

ELECTRICAL

| | Current | Voltage | Wire Range |
|----|------------------|---------|---|
| US | 15A ^① | 300V | 30-14AWG |
| | 16A | 450V | 2.5mm ² Stranded 4.0mm ² Solid |

INSTALLATION DATA

| | | | |
|-------------------|------------------------|------------------------|-------|
| Screw Size | M3 | PCB Hole Size | 1.3mm |
| Torque | 0.5Nm (4.5 lbf-in.) | Stripping Lgth. | 8.3mm |

MATERIAL

| | | | |
|---------------------------|-----------------------|-----------------|------------------|
| Body | PA6.8 | Screw | Galvanized Steel |
| Flammability Class | UL94V-0 | Terminal | Tin-Plated Brass |
| Temperature Limit | 105°C UL 125°C IEC | Clamp | Nickeled Brass |
| Color | Green | | |

| No. Poles | Cat. # | Length (B) (mm) | Std. Pk. |
|-----------|--------------|-----------------|----------|
| 2 | MI-252 (35) | 10.2 | 100 |
| 3 | MI-253 (35) | 15.2 | 100 |
| 4 | MI-254 (35) | 20.3 | 50 |
| 5 | MI-255 (35) | 25.4 | 50 |
| 6 | MI-256 (35) | 30.5 | 50 |
| 7 | MI-257 (35) | 35.6 | 50 |
| 8 | MI-258 (35) | 40.6 | 50 |
| 9 | MI-259 (35) | 45.7 | 50 |
| 10 | MI-2510 (35) | 50.8 | 50 |
| 11 | MI-2511 (35) | 55.9 | 50 |
| 12 | MI-2512 (35) | 61.0 | 50 |
| 13 | MI-2513 (35) | 66.0 | 20 |
| 14 | MI-2514 (35) | 71.1 | 20 |
| 15 | MI-2515 (35) | 76.2 | 20 |
| 16 | MI-2516 (35) | 81.3 | 20 |
| 17 | MI-2517 (35) | 86.4 | 20 |
| 18 | MI-2518 (35) | 91.4 | 20 |
| 19 | MI-2519 (35) | 96.5 | 20 |
| 20 | MI-2520 (35) | 101.6 | 20 |
| 21 | MI-2521 (35) | 106.7 | 20 |
| 22 | MI-2522 (35) | 111.8 | 20 |
| 23 | MI-2523 (35) | 116.8 | 20 |
| 24 | MI-2524 (35) | 121.9 | 20 |

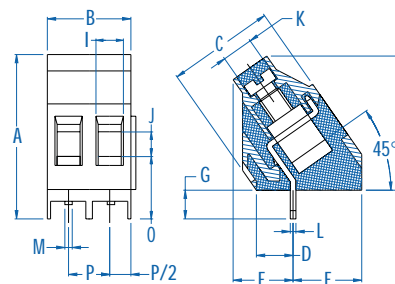

Dimensions

| | | | |
|---|----------|---|----------|
| A | 20.00 mm | I | 2.80 mm |
| B | 10.16 mm | J | 2.80 mm |
| C | 13.00 mm | K | Ø3.80 mm |
| D | 4.50 mm | L | 0.70 mm |
| E | 7.70 mm | M | 0.90 mm |
| F | 7.30 mm | N | - |
| G | 4.00 mm | O | 6.75 mm |
| H | 16.30 mm | P | 5.08 mm |

^① 16A Factory Wiring - UL

Fixed PCB Blocks

Pin Spacing: 5.08mm
 Orientation: 45°
 Clamp Type: Screw Cage
 Design: Modular

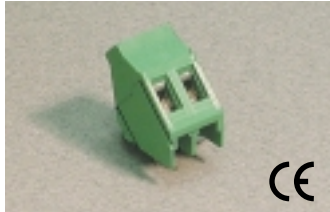

MI-25 (45)

ELECTRICAL

| | Current | Voltage | Wire Range |
|--|------------------|---------|---|
| | 15A ^① | 300V | 30-14AWG |
| | 16A | 450V | 2.5mm ² Stranded 4.0mm ² Solid |

INSTALLATION DATA

| | | | |
|-------------------|------------------------|------------------------|-------|
| Screw Size | M3 | PCB Hole Size | 1.3mm |
| Torque | 0.5Nm (4.5 lbf-in.) | Stripping Lgth. | 8.3mm |

MATERIAL

| | | | |
|---------------------------|-----------------------|-----------------|------------------|
| Body | PA6.8 | Screw | Galvanized Steel |
| Flammability Class | UL94V-0 | Terminal | Tin-Plated Brass |
| Temperature Limit | 105°C UL 125°C IEC | Clamp | Nickeled Brass |
| Color | Green | | |

| No. Poles | Cat. # | Length (B) (mm) | Std. Pk. |
|-----------|--------------|-----------------|----------|
| 2 | MI-252 (45) | 10.2 | 100 |
| 3 | MI-253 (45) | 15.2 | 100 |
| 4 | MI-254 (45) | 20.3 | 50 |
| 5 | MI-255 (45) | 25.4 | 50 |
| 6 | MI-256 (45) | 30.5 | 50 |
| 7 | MI-257 (45) | 35.6 | 50 |
| 8 | MI-258 (45) | 40.6 | 50 |
| 9 | MI-259 (45) | 45.7 | 50 |
| 10 | MI-2510 (45) | 50.8 | 50 |
| 11 | MI-2511 (45) | 55.9 | 50 |
| 12 | MI-2512 (45) | 61.0 | 50 |
| 13 | MI-2513 (45) | 66.0 | 20 |
| 14 | MI-2514 (45) | 71.1 | 20 |
| 15 | MI-2515 (45) | 76.2 | 20 |
| 16 | MI-2516 (45) | 81.3 | 20 |
| 17 | MI-2517 (45) | 86.4 | 20 |
| 18 | MI-2518 (45) | 91.4 | 20 |
| 19 | MI-2519 (45) | 96.5 | 20 |
| 20 | MI-2520 (45) | 101.6 | 20 |
| 21 | MI-2521 (45) | 106.7 | 20 |
| 22 | MI-2522 (45) | 111.8 | 20 |
| 23 | MI-2523 (45) | 116.8 | 20 |
| 24 | MI-2524 (45) | 121.9 | 20 |

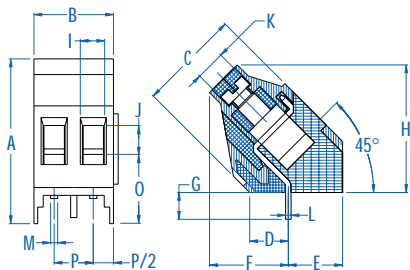

Dimensions

| | | | |
|---|----------|---|----------|
| A | 21.00 mm | I | 2.80 mm |
| B | 10.16 mm | J | 2.80 mm |
| C | 13.00 mm | K | Ø3.80 mm |
| D | 4.50 mm | L | 0.70 mm |
| E | 7.70 mm | M | 0.90 mm |
| F | 10.00 mm | N | - |
| G | 4.00 mm | O | 8.60 mm |
| H | 16.30 mm | P | 5.08 mm |

^① 16A Factory Wiring - UL

Pin Spacing: 5.08mm
 Orientation: Vertical-Double Level
 Clamp Type: Screw Cage
 Design: Modular-Offset

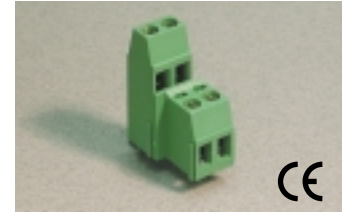

MVD-25

ELECTRICAL

| | Current | Voltage | Wire Range |
|--|------------------|---------|---|
| | 15A ^① | 300V | 30-14AWG |
| | 16A | 450V | 2.5mm ² Stranded 4.0mm ² Solid |

INSTALLATION DATA

| | | | |
|-------------------|------------------------|------------------------|-------|
| Screw Size | M3 | PCB Hole Size | 1.3mm |
| Torque | 0.5Nm (4.5 lbf-in.) | Stripping Lgth. | 8.3mm |

MATERIAL

| | | | |
|---------------------------|-----------------------|-----------------|------------------|
| Body | PA6.8 | Screw | Galvanized Steel |
| Flammability Class | UL94V-0 | Terminal | Tin-Plated Brass |
| Temperature Limit | 105°C UL 125°C IEC | Clamp | Nickeled Brass |
| Color | Green | | |

| No. Poles | Cat. # | Length (B) (mm) | Std. Pk. |
|-----------|----------|-----------------|----------|
| 4 | MVD-252 | 12.7 | 100 |
| 6 | MVD-253 | 17.8 | 100 |
| 8 | MVD-254 | 22.9 | 50 |
| 10 | MVD-255 | 27.9 | 50 |
| 12 | MVD-256 | 33.0 | 50 |
| 14 | MVD-257 | 38.1 | 50 |
| 16 | MVD-258 | 43.2 | 50 |
| 18 | MVD-259 | 48.3 | 50 |
| 20 | MVD-2510 | 53.3 | 50 |
| 22 | MVD-2511 | 58.4 | 20 |
| 24 | MVD-2512 | 63.5 | 20 |
| 26 | MVD-2513 | 68.6 | 20 |
| 28 | MVD-2514 | 73.7 | 20 |
| 30 | MVD-2515 | 78.7 | 20 |
| 32 | MVD-2516 | 83.2 | 20 |
| 34 | MVD-2517 | 88.9 | 20 |
| 36 | MVD-2518 | 94.0 | 20 |
| 38 | MVD-2519 | 99.1 | 20 |
| 40 | MVD-2520 | 104.1 | 10 |
| 42 | MVD-2521 | 109.2 | 10 |
| 44 | MVD-2522 | 114.3 | 10 |
| 46 | MVD-2523 | 119.4 | 10 |
| 48 | MVD-2524 | 124.5 | 10 |
| 50 | MVD-2525 | 129.5 | 10 |

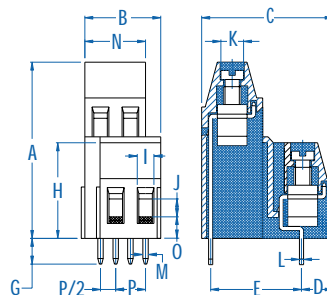

Dimensions

| | | | |
|---|----------|---|----------|
| A | 29.50 mm | I | 2.80 mm |
| B | 12.70 mm | J | 2.80 mm |
| C | 22.00 mm | K | Ø3.80 mm |
| D | 5.30 mm | L | 0.70 mm |
| E | 15.24 mm | M | 0.90 mm |
| F | - | N | 10.16 mm |
| G | 4.70 mm | O | 3.60 mm |
| H | 16.00 mm | P | 5.08 mm |

^① 16A Factory Wiring - UL

Fixed PCB Blocks



Pin Spacing: 5.08mm
 Orientation: Vertical-Double Level
 Clamp Type: Screw Cage
 Design: Modular-Aligned

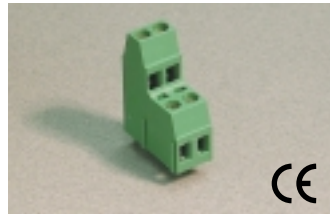

MVDK-25

ELECTRICAL

| | Current | Voltage | Wire Range |
|--|------------------|---------|---|
| | 15A ^① | 300V | 30-14AWG |
| | 16A | 450V | 2.5mm ² Stranded 4.0mm ² Solid |

INSTALLATION DATA

| | | | |
|-------------------|------------------------|------------------------|-------|
| Screw Size | M3 | PCB Hole Size | 1.3mm |
| Torque | 0.5Nm (4.5 lbf-in.) | Stripping Lgth. | 8.3mm |

MATERIAL

| | | | |
|---------------------------|-----------------------|-----------------|------------------|
| Body | PA6.8 | Screw | Galvanized Steel |
| Flammability Class | UL94V-0 | Terminal | Tin-Plated Brass |
| Temperature Limit | 105°C UL 125°C IEC | Clamp | Nickel Brass |
| Color | Green | | |

| No. Poles | Cat. # | Length (B) (mm) | Std. Pk. |
|-----------|-----------|-----------------|----------|
| 4 | MVDK-252 | 10.2 | 100 |
| 6 | MVDK-253 | 15.2 | 100 |
| 8 | MVDK-254 | 20.3 | 50 |
| 10 | MVDK-255 | 25.4 | 50 |
| 12 | MVDK-256 | 30.5 | 50 |
| 14 | MVDK-257 | 35.6 | 50 |
| 16 | MVDK-258 | 40.6 | 50 |
| 18 | MVDK-259 | 45.7 | 50 |
| 20 | MVDK-2510 | 50.8 | 50 |
| 22 | MVDK-2511 | 55.9 | 20 |
| 24 | MVDK-2512 | 61.0 | 20 |
| 26 | MVDK-2513 | 66.0 | 20 |
| 28 | MVDK-2514 | 71.1 | 20 |
| 30 | MVDK-2515 | 76.2 | 20 |
| 32 | MVDK-2516 | 81.3 | 20 |
| 34 | MVDK-2517 | 86.4 | 20 |
| 36 | MVDK-2518 | 91.4 | 20 |
| 38 | MVDK-2519 | 96.5 | 20 |
| 40 | MVDK-2520 | 101.6 | 10 |
| 42 | MVDK-2521 | 106.7 | 10 |
| 44 | MVDK-2522 | 111.8 | 10 |
| 46 | MVDK-2523 | 116.8 | 10 |
| 48 | MVDK-2524 | 121.9 | 10 |
| 50 | MVDK-2525 | 129.5 | 10 |

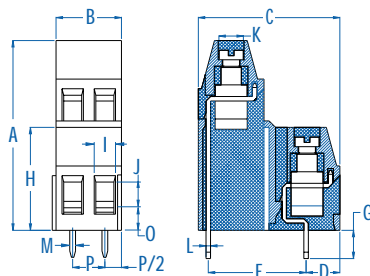

Dimensions

| | | | |
|---|----------|---|----------|
| A | 29.50 mm | I | 2.80 mm |
| B | 10.16 mm | J | 2.80 mm |
| C | 22.00 mm | K | Ø3.80 mm |
| D | 5.30 mm | L | 0.70 mm |
| E | 15.24 mm | M | 0.90 mm |
| F | - | N | - |
| G | 4.70 mm | O | 3.60 mm |
| H | 16.00 mm | P | 5.08 mm |

^① 16A Factory Wiring - UL

Pin Spacing: 5.08mm
 Orientation: Vertical-Triple Level
 Clamp Type: Screw Cage
 Design: Modular

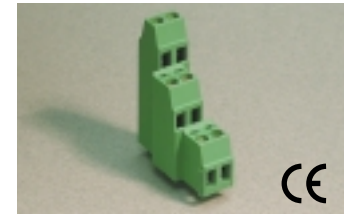

MVT-25

ELECTRICAL

| | Current | Voltage | Wire Range |
|--|------------------|---------|---|
| | 15A ^① | 300V | 30-14AWG |
| | 16A | 450V | 2.5mm ² Stranded 4.0mm ² Solid |

INSTALLATION DATA

| | | | |
|-------------------|------------------------|------------------------|-------|
| Screw Size | M3 | PCB Hole Size | 1.3mm |
| Torque | 0.5Nm (4.5 lbf-in.) | Stripping Lgth. | 8.3mm |

MATERIAL

| | | | |
|---------------------------|-----------------------|-----------------|------------------|
| Body | PA6.8 | Screw | Galvanized Steel |
| Flammability Class | UL94V-0 | Terminal | Tin-Plated Brass |
| Temperature Limit | 105°C UL 125°C IEC | Clamp | Nickel Brass |
| Color | Green | | |

| No. Poles | Cat. # | Length (B) (mm) | Std. Pk. |
|-----------|----------|-----------------|----------|
| 6 | MVT-252 | 12.7 | 50 |
| 9 | MVT-253 | 17.8 | 50 |
| 12 | MVT-254 | 22.9 | 30 |
| 15 | MVT-255 | 27.9 | 30 |
| 18 | MVT-256 | 33.0 | 30 |
| 21 | MVT-257 | 38.1 | 30 |
| 24 | MVT-258 | 43.2 | 30 |
| 27 | MVT-259 | 48.3 | 30 |
| 30 | MVT-2510 | 53.3 | 30 |
| 33 | MVT-2511 | 58.4 | 15 |
| 36 | MVT-2512 | 63.5 | 15 |
| 39 | MVT-2513 | 68.6 | 15 |
| 42 | MVT-2514 | 73.7 | 15 |
| 45 | MVT-2515 | 78.7 | 15 |
| 48 | MVT-2516 | 83.2 | 15 |
| 51 | MVT-2517 | 88.9 | 15 |
| 54 | MVT-2518 | 94.0 | 15 |
| 57 | MVT-2519 | 99.1 | 15 |
| 60 | MVT-2520 | 104.1 | 5 |
| 63 | MVT-2521 | 109.2 | 5 |
| 66 | MVT-2522 | 114.3 | 5 |
| 69 | MVT-2523 | 119.4 | 5 |
| 72 | MVT-2524 | 124.5 | 5 |

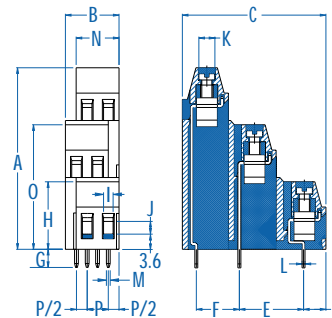

Dimensions

| | | | |
|---|----------|---|----------|
| A | 43.00 mm | I | 2.80 mm |
| B | 12.70 mm | J | 2.80 mm |
| C | 34.00 mm | K | Ø3.80 mm |
| D | 5.30 mm | L | 0.70 mm |
| E | 15.24 mm | M | 0.90 mm |
| F | 10.16 mm | N | 10.16 mm |
| G | 4.50 mm | O | 29.50 mm |
| H | 16.00 mm | P | 5.08 mm |

^① 16A Factory Wiring - UL

Fixed PCB Blocks

Pin Spacing: 6.35mm/ 12.7mm*
 Orientation: Vertical
 Clamp Type: Screw Cage
 Design: Modular

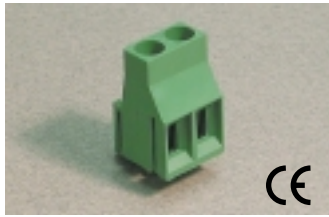

MV-46

ELECTRICAL

| | Current | Voltage | Wire Range |
|--|------------------|---------|---|
| | 20A ^① | 300V | 30-12AWG |
| | 25A | 500V | 4.0mm ² Stranded 6.0mm ² Solid |

INSTALLATION DATA

| | | | |
|-------------------|------------------------|------------------------|-------|
| Screw Size | M3 | PCB Hole Size | 1.3mm |
| Torque | 0.5Nm (4.5 lbf-in.) | Stripping Lgth. | 9.8mm |

MATERIAL

| | | | |
|---------------------------|-----------------------|-----------------|------------------|
| Body | PA6.8 | Screw | Galvanized Steel |
| Flammability Class | UL94V-0 | Terminal | Tin-Plated Brass |
| Temperature Limit | 105°C UL 125°C IEC | Clamp | Nickeled Brass |
| Color | Green | | |

| No. Poles | Cat. # | Length (B) (mm) | Std. Pk. |
|-----------|---------|-----------------|----------|
| 2 | MV-462 | 12.7 | 100 |
| 3 | MV-463 | 19.0 | 100 |
| 4 | MV-464 | 25.4 | 50 |
| 5 | MV-465 | 31.7 | 50 |
| 6 | MV-466 | 38.0 | 50 |
| 7 | MV-467 | 44.4 | 50 |
| 8 | MV-468 | 50.7 | 50 |
| 9 | MV-469 | 57.0 | 50 |
| 10 | MV-4610 | 63.4 | 50 |
| 11 | MV-4611 | 69.7 | 50 |
| 12 | MV-4612 | 76.0 | 50 |
| 13 | MV-4613 | 82.4 | 20 |
| 14 | MV-4614 | 88.7 | 20 |
| 15 | MV-4615 | 95.0 | 20 |
| 16 | MV-4616 | 101.4 | 20 |

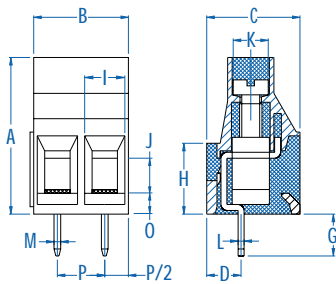

Dimensions

| | | | |
|---|----------|---|----------|
| A | 21.00 mm | I | 3.10 mm |
| B | 12.70 mm | J | 3.90 mm |
| C | 12.50 mm | K | Ø4.70 mm |
| D | 4.20 mm | L | 0.80 mm |
| E | — | M | 0.90 mm |
| F | — | N | — |
| G | 4.10 mm | O | 3.30 mm |
| H | 9.50 mm | P | 6.35 mm |

* 12.7mm Pin spacing available

① 25A Factory Wiring - UL

Pin Spacing: 7.50mm
 Orientation: Vertical
 Clamp Type: Screw Cage
 Design: Modular

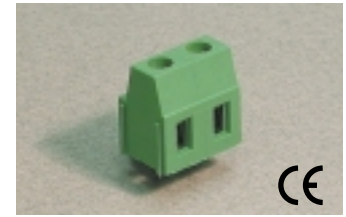

MV-27

ELECTRICAL

| | Current | Voltage | Wire Range |
|--|------------------|---------|---|
| | 15A ^① | 300V | 30-14AWG |
| | 16A | 750V | 2.5mm ² Stranded 4.0mm ² Solid |

INSTALLATION DATA

| | | | |
|-------------------|------------------------|------------------------|-------|
| Screw Size | M3 | PCB Hole Size | 1.3mm |
| Torque | 0.5Nm (4.5 lbf-in.) | Stripping Lgth. | 8.3mm |

MATERIAL

| | | | |
|---------------------------|-----------------------|-----------------|------------------|
| Body | PA6.8 | Screw | Galvanized Steel |
| Flammability Class | UL94V-0 | Terminal | Tin-Plated Brass |
| Temperature Limit | 105°C UL 125°C IEC | Clamp | Nickeled Brass |
| Color | Green | | |

| No. Poles | Cat. # | Length (B) (mm) | Std. Pk. |
|-----------|---------|-----------------|----------|
| 2 | MV-272 | 15.0 | 100 |
| 3 | MV-273 | 22.5 | 100 |
| 4 | MV-274 | 30.0 | 50 |
| 5 | MV-275 | 37.5 | 50 |
| 6 | MV-276 | 45.0 | 50 |
| 7 | MV-277 | 52.5 | 50 |
| 8 | MV-278 | 60.0 | 50 |
| 9 | MV-279 | 67.5 | 50 |
| 10 | MV-2710 | 75.0 | 50 |
| 11 | MV-2711 | 82.5 | 50 |
| 12 | MV-2712 | 90.0 | 50 |
| 13 | MV-2713 | 97.5 | 20 |
| 14 | MV-2714 | 105.0 | 20 |
| 15 | MV-2715 | 112.5 | 20 |
| 16 | MV-2716 | 120.0 | 20 |

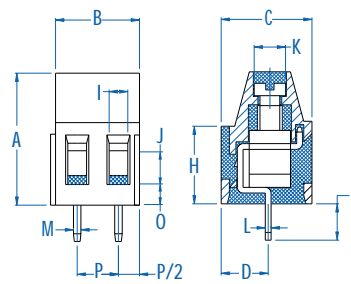

Dimensions

| | | | |
|---|----------|---|----------|
| A | 16.00 mm | I | 2.80 mm |
| B | 15.00 mm | J | 2.80 mm |
| C | 11.00 mm | K | Ø3.80 mm |
| D | 5.30 mm | L | 0.70 mm |
| E | — | M | 0.90 mm |
| F | — | N | — |
| G | 4.50 mm | O | 3.60 mm |
| H | 9.40 mm | P | 7.50 mm |

① 16A Factory Wiring - UL

Fixed PCB Blocks

Pin Spacing: 7.50mm
 Orientation: Vertical
 Clamp Type: Screw Cage
 Design: Modular

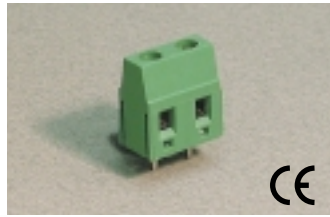

MVE-27

ELECTRICAL

| | Current | Voltage | Wire Range |
|--|------------------|---------|---|
| | 15A ^① | 300V | 30-14AWG |
| | 16A | 750V | 2.5mm ² Stranded 4.0mm ² Solid |

INSTALLATION DATA

| Screw Size | M3 | PCB Hole Size | 1.3mm |
|------------|------------------------|-----------------|-------|
| Torque | 0.5Nm (4.5 lbf-in.) | Stripping Lgth. | 7.1mm |

MATERIAL

| | | | |
|---------------------------|-----------------------|-----------------|------------------|
| Body | PA6.8 | Screw | Galvanized Steel |
| Flammability Class | UL94V-0 | Terminal | Tin-Plated Brass |
| Temperature Limit | 105°C UL 125°C IEC | Clamp | Nickel Brass |
| Color | Green | | |

| No. Poles | Cat. # | Length (B) (mm) | Std. Pk. |
|-----------|----------|-----------------|----------|
| 2 | MVE-272 | 15.0 | 100 |
| 3 | MVE-273 | 22.5 | 100 |
| 4 | MVE-274 | 30.0 | 50 |
| 5 | MVE-275 | 37.5 | 50 |
| 6 | MVE-276 | 45.0 | 50 |
| 7 | MVE-277 | 52.5 | 50 |
| 8 | MVE-278 | 60.0 | 50 |
| 9 | MVE-279 | 67.5 | 50 |
| 10 | MVE-2710 | 75.0 | 50 |
| 11 | MVE-2711 | 82.5 | 50 |
| 12 | MVE-2712 | 90.0 | 50 |
| 13 | MVE-2713 | 97.5 | 20 |
| 14 | MVE-2714 | 105.0 | 20 |
| 15 | MVE-2715 | 112.5 | 20 |
| 16 | MVE-2716 | 120.0 | 20 |

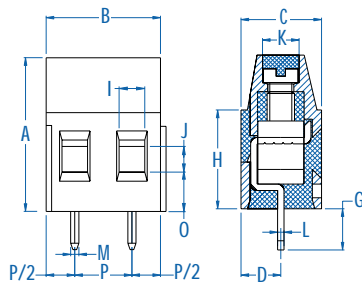

Dimensions

| | | | |
|---|----------|---|----------|
| A | 16.80 mm | I | 2.80 mm |
| B | 15.00 mm | J | 2.80 mm |
| C | 8.90 mm | K | Ø3.80 mm |
| D | 4.35 mm | L | 0.70 mm |
| E | - | M | 0.90 mm |
| F | - | N | - |
| G | 4.50 mm | O | 4.60 mm |
| H | 10.80 mm | P | 7.50 mm |

^① 16A Factory Wiring - UL

Pin Spacing: 7.50mm
 Orientation: Horizontal
 Clamp Type: Screw Cage
 Design: Modular

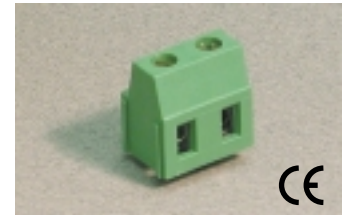

MH-27

ELECTRICAL

| | Current | Voltage | Wire Range |
|--|------------------|---------|---|
| | 15A ^① | 300V | 30-14AWG |
| | 16A | 750V | 2.5mm ² Stranded 4.0mm ² Solid |

INSTALLATION DATA

| Screw Size | M3 | PCB Hole Size | 1.3mm |
|------------|------------------------|-----------------|-------|
| Torque | 0.5Nm (4.5 lbf-in.) | Stripping Lgth. | 8.3mm |

MATERIAL

| | | | |
|---------------------------|-----------------------|-----------------|------------------|
| Body | PA6.8 | Screw | Galvanized Steel |
| Flammability Class | UL94V-0 | Terminal | Tin-Plated Brass |
| Temperature Limit | 105°C UL 125°C IEC | Clamp | Nickel Brass |
| Color | Green | | |

| No. Poles | Cat. # | Length (B) (mm) | Std. Pk. |
|-----------|---------|-----------------|----------|
| 2 | MH-272 | 15.0 | 100 |
| 3 | MH-273 | 22.5 | 100 |
| 4 | MH-274 | 30.0 | 50 |
| 5 | MH-275 | 37.5 | 50 |
| 6 | MH-276 | 45.0 | 50 |
| 7 | MH-277 | 52.5 | 50 |
| 8 | MH-278 | 60.0 | 50 |
| 9 | MH-279 | 67.5 | 50 |
| 10 | MH-2710 | 75.0 | 50 |
| 11 | MH-2711 | 82.5 | 50 |
| 12 | MH-2712 | 90.0 | 50 |
| 13 | MH-2713 | 97.5 | 20 |
| 14 | MH-2714 | 105.0 | 20 |
| 15 | MH-2715 | 112.5 | 20 |
| 16 | MH-2716 | 120.0 | 20 |

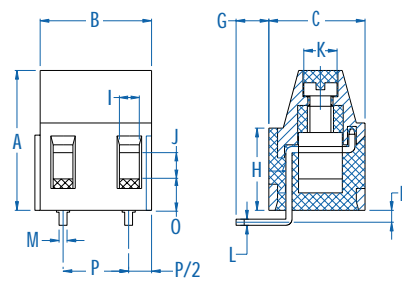

Dimensions

| | | | |
|---|----------|---|----------|
| A | 16.00 mm | I | 2.80 mm |
| B | 15.00 mm | J | 2.80 mm |
| C | 11.00 mm | K | Ø3.80 mm |
| D | 1.70 mm | L | 0.70 mm |
| E | - | M | 0.90 mm |
| F | - | N | - |
| G | 4.00 mm | O | 3.60 mm |
| H | 9.40 mm | P | 7.50 mm |

^① 16A Factory Wiring - UL

Fixed PCB Blocks

Pin Spacing: 7.50mm
 Orientation: Horizontal
 Clamp Type: Screw Cage
 Design: Modular

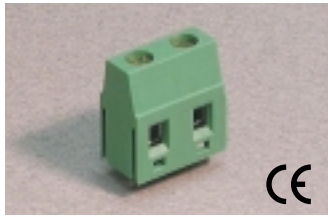

MHE-27

ELECTRICAL

| | Current | Voltage | Wire Range |
|--|------------------|---------|---|
| | 15A ^① | 300V | 30-14AWG |
| | 16A | 750V | 2.5mm ² Stranded 4.0mm ² Solid |

INSTALLATION DATA

| | | | |
|-------------------|------------------------|------------------------|-------|
| Screw Size | M3 | PCB Hole Size | 1.3mm |
| Torque | 0.5Nm (4.5 lbf-in.) | Stripping Lgth. | 7.1mm |

MATERIAL

| | | | |
|---------------------------|-----------------------|-----------------|------------------|
| Body | PA6.8 | Screw | Galvanized Steel |
| Flammability Class | UL94V-0 | Terminal | Tin-Plated Brass |
| Temperature Limit | 105°C UL 125°C IEC | Clamp | Nickeled Brass |
| Color | Green | | |

| No. Poles | Cat. # | Length (B) (mm) | Std. Pk. |
|-----------|----------|-----------------|----------|
| 2 | MHE-272 | 15.0 | 100 |
| 3 | MHE-273 | 22.5 | 100 |
| 4 | MHE-274 | 30.0 | 50 |
| 5 | MHE-275 | 37.5 | 50 |
| 6 | MHE-276 | 45.0 | 50 |
| 7 | MHE-277 | 52.5 | 50 |
| 8 | MHE-278 | 60.0 | 50 |
| 9 | MHE-279 | 67.5 | 50 |
| 10 | MHE-2710 | 75.0 | 50 |
| 11 | MHE-2711 | 82.5 | 50 |
| 12 | MHE-2712 | 90.0 | 50 |
| 13 | MHE-2713 | 97.5 | 20 |
| 14 | MHE-2714 | 105.0 | 20 |
| 15 | MHE-2715 | 112.5 | 20 |
| 16 | MHE-2716 | 120.0 | 20 |

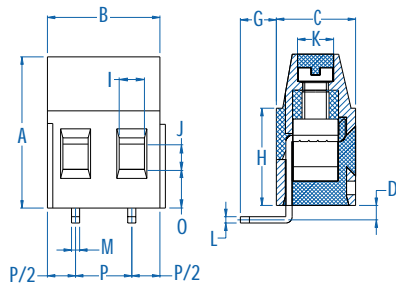

Dimensions

| | | | |
|---|----------|---|----------|
| A | 16.80 mm | I | 2.80 mm |
| B | 15.00 mm | J | 2.80 mm |
| C | 8.90 mm | K | Ø3.80 mm |
| D | 1.40 mm | L | 0.70 mm |
| E | — | M | 0.90 mm |
| F | — | N | — |
| G | 4.00 mm | O | 4.60 mm |
| H | 10.80 mm | P | 7.50 mm |

^① 16A Factory Wiring - UL

Pin Spacing: 7.50mm
 Orientation: Reverse Horizontal
 Clamp Type: Screw Cage
 Design: Modular

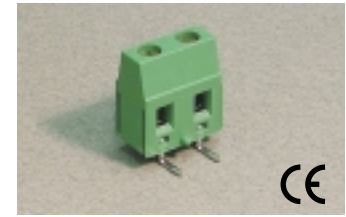

MHR-27

ELECTRICAL

| | Current | Voltage | Wire Range |
|--|------------------|---------|---|
| | 15A ^① | 300V | 30-14AWG |
| | 16A | 450V | 2.5mm ² Stranded 4.0mm ² Solid |

INSTALLATION DATA

| | | | |
|-------------------|------------------------|------------------------|-------|
| Screw Size | M3 | PCB Hole Size | 1.3mm |
| Torque | 0.5Nm (4.5 lbf-in.) | Stripping Lgth. | 7.1mm |

MATERIAL

| | | | |
|---------------------------|-----------------------|-----------------|------------------|
| Body | PA6.8 | Screw | Galvanized Steel |
| Flammability Class | UL94V-0 | Terminal | Tin-Plated Brass |
| Temperature Limit | 105°C UL 125°C IEC | Clamp | Nickeled Brass |
| Color | Green | | |

| No. Poles | Cat. # | Length (B) (mm) | Std. Pk. |
|-----------|----------|-----------------|----------|
| 2 | MHR-272 | 15.0 | 100 |
| 3 | MHR-273 | 22.5 | 100 |
| 4 | MHR-274 | 30.0 | 50 |
| 5 | MHR-275 | 37.5 | 50 |
| 6 | MHR-276 | 45.0 | 50 |
| 7 | MHR-277 | 52.5 | 50 |
| 8 | MHR-278 | 60.0 | 50 |
| 9 | MHR-279 | 67.5 | 50 |
| 10 | MHR-2710 | 75.0 | 50 |
| 11 | MHR-2711 | 82.5 | 50 |
| 12 | MHR-2712 | 90.0 | 50 |
| 13 | MHR-2713 | 97.5 | 20 |
| 14 | MHR-2714 | 105.0 | 20 |
| 15 | MHR-2715 | 112.5 | 20 |
| 16 | MHR-2716 | 120.0 | 20 |

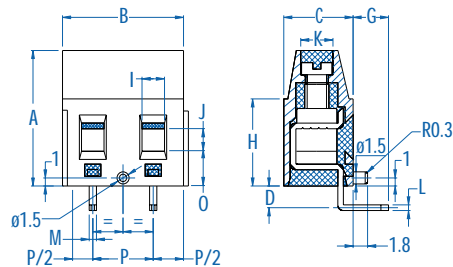

Dimensions

| | | | |
|---|----------|---|----------|
| A | 16.80 mm | I | 2.80 mm |
| B | 15.00 mm | J | 2.80 mm |
| C | 8.90 mm | K | Ø3.80 mm |
| D | 2.30 mm | L | 0.70 mm |
| E | — | M | 0.90 mm |
| F | — | N | — |
| G | 4.00 mm | O | 4.60 mm |
| H | 10.80 mm | P | 7.50 mm |

^① 16A Factory Wiring - UL

Fixed PCB Blocks

Pin Spacing: 7.50mm
 Orientation: 35°
 Clamp Type: Screw Cage
 Design: Modular

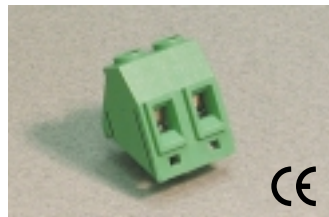

MI-27

ELECTRICAL

| | Current | Voltage | Wire Range |
|--|------------------|---------|---|
| | 15A ^① | 300V | 30-14AWG |
| | 16A | 750V | 2.5mm ² Stranded 4.0mm ² Solid |

INSTALLATION DATA

| | | | |
|-------------------|------------------------|------------------------|-------|
| Screw Size | M3 | PCB Hole Size | 1.3mm |
| Torque | 0.5Nm (4.5 lbf-in.) | Stripping Lgth. | 9.3mm |

MATERIAL

| | | | |
|---------------------------|-----------------------|-----------------|------------------|
| Body | PA6.8 | Screw | Galvanized Steel |
| Flammability Class | UL94V-0 | Terminal | Tin-Plated Brass |
| Temperature Limit | 105°C UL 125°C IEC | Clamp | Nickel Brass |
| Color | Green | | |

| No. Poles | Cat. # | Length (B) (mm) | Std. Pk. |
|-----------|---------|-----------------|----------|
| 2 | MI-272 | 15.0 | 100 |
| 3 | MI-273 | 22.5 | 100 |
| 4 | MI-274 | 30.0 | 50 |
| 5 | MI-275 | 37.5 | 50 |
| 6 | MI-276 | 45.0 | 50 |
| 7 | MI-277 | 52.5 | 50 |
| 8 | MI-278 | 60.0 | 50 |
| 9 | MI-279 | 67.5 | 50 |
| 10 | MI-2710 | 75.0 | 50 |
| 11 | MI-2711 | 82.5 | 50 |
| 12 | MI-2712 | 90.0 | 50 |
| 13 | MI-2713 | 97.5 | 20 |
| 14 | MI-2714 | 105.0 | 20 |
| 15 | MI-2715 | 112.5 | 20 |
| 16 | MI-2716 | 120.0 | 20 |

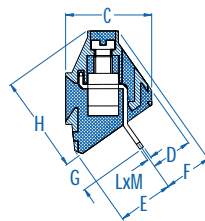
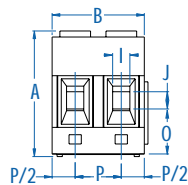

Dimensions

| | | | |
|---|----------|---|----------|
| A | 20.00 mm | I | 2.80 mm |
| B | 15.00 mm | J | 2.80 mm |
| C | 14.00 mm | K | Ø3.80 mm |
| D | 5.00 mm | L | 0.70 mm |
| E | 9.20 mm | M | 0.90 mm |
| F | 8.00 mm | N | - |
| G | 4.60 mm | O | 6.80 mm |
| H | 16.00 mm | P | 7.50 mm |

Pin Spacing: 7.62mm
 Orientation: Vertical
 Clamp Type: Screw Cage
 Design: Modular

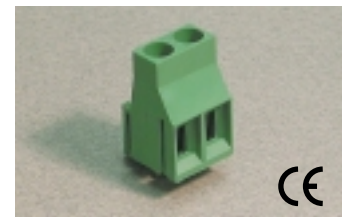

MV-47

ELECTRICAL

| | Current | Voltage | Wire Range |
|--|------------------|---------|---|
| | 20A ^① | 300V | 30-12AWG |
| | 25A | 750V | 4.0mm ² Stranded 6.0mm ² Solid |

INSTALLATION DATA

| | | | |
|-------------------|------------------------|------------------------|-------|
| Screw Size | M3 | PCB Hole Size | 1.3mm |
| Torque | 0.5Nm (4.5 lbf-in.) | Stripping Lgth. | 9.8mm |

MATERIAL

| | | | |
|---------------------------|-----------------------|-----------------|------------------|
| Body | PA6.8 | Screw | Galvanized Steel |
| Flammability Class | UL94V-0 | Terminal | Tin-Plated Brass |
| Temperature Limit | 105°C UL 125°C IEC | Clamp | Nickel Brass |
| Color | Green | | |

| No. Poles | Cat. # | Length (B) (mm) | Std. Pk. |
|-----------|---------|-----------------|----------|
| 2 | MV-472 | 15.2 | 100 |
| 3 | MV-473 | 22.9 | 100 |
| 4 | MV-474 | 30.5 | 50 |
| 5 | MV-475 | 38.1 | 50 |
| 6 | MV-476 | 45.7 | 50 |
| 7 | MV-477 | 53.3 | 50 |
| 8 | MV-478 | 61.0 | 50 |
| 9 | MV-479 | 68.6 | 50 |
| 10 | MV-4710 | 76.2 | 50 |
| 11 | MV-4711 | 83.8 | 50 |
| 12 | MV-4712 | 91.4 | 50 |
| 13 | MV-4713 | 99.1 | 20 |
| 14 | MV-4714 | 106.7 | 20 |
| 15 | MV-4715 | 114.3 | 20 |
| 16 | MV-4716 | 121.9 | 20 |

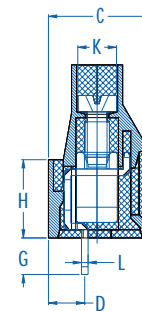
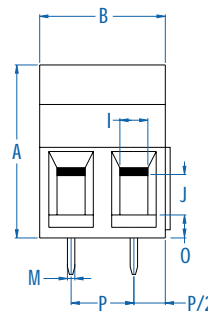

Dimensions

| | | | |
|---|----------|---|----------|
| A | 21.00 mm | I | 3.10 mm |
| B | 15.24 mm | J | 3.90 mm |
| C | 12.50 mm | K | Ø4.70 mm |
| D | 4.20 mm | L | 0.80 mm |
| E | - | M | 0.90 mm |
| F | - | N | - |
| G | 4.10 mm | O | 3.30 mm |
| H | 9.50 mm | P | 7.62 mm |

① 16A Factory Wiring - UL

① 25A Factory Wiring - UL

Fixed PCB Blocks

Pin Spacing: 7.62mm
 Orientation: Vertical
 Clamp Type: Screw Cage
 Design: Modular

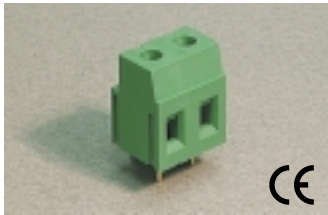

MVSP-27

ELECTRICAL

| | Current | Voltage | Wire Range |
|--|------------------|---------|---|
| | 15A ^① | 300V | 30-14AWG |
| | 24A | 750V | 2.5mm ² Stranded 4.0mm ² Solid |

INSTALLATION DATA

| | | | |
|-------------------|------------------------|------------------------|-------|
| Screw Size | M3 | PCB Hole Size | 1.5mm |
| Torque | 0.5Nm (4.5 lbf-in.) | Stripping Lgth. | 9.5mm |

MATERIAL

| | | | |
|---------------------------|-----------------------|-----------------|------------------|
| Body | PA6.8 | Screw | Galvanized Steel |
| Flammability Class | UL94V-0 | Terminal | Tin-Plated Brass |
| Temperature Limit | 105°C UL 125°C IEC | Clamp | Nickel Brass |
| Color | Green | | |

| No. Poles | Cat. # | Length (B) (mm) | Std. Pk. |
|-----------|-----------|-----------------|----------|
| 2 | MVSP-272 | 15.2 | 100 |
| 3 | MVSP-273 | 22.9 | 100 |
| 4 | MVSP-274 | 30.5 | 50 |
| 5 | MVSP-275 | 38.1 | 50 |
| 6 | MVSP-276 | 45.7 | 50 |
| 7 | MVSP-277 | 53.3 | 50 |
| 8 | MVSP-278 | 61.0 | 50 |
| 9 | MVSP-279 | 68.6 | 50 |
| 10 | MVSP-2710 | 76.2 | 50 |
| 11 | MVSP-2711 | 83.8 | 50 |
| 12 | MVSP-2712 | 91.4 | 50 |
| 13 | MVSP-2713 | 99.1 | 20 |
| 14 | MVSP-2714 | 106.7 | 20 |
| 15 | MVSP-2715 | 114.3 | 20 |
| 16 | MVSP-2716 | 121.9 | 20 |

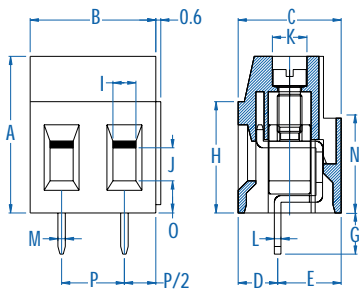

Dimensions

| | | | |
|---|----------|---|----------|
| A | 19.00 mm | I | 2.80 mm |
| B | 15.24 mm | J | 4.00 mm |
| C | 12.50 mm | K | Ø4.00 mm |
| D | 4.80 mm | L | 0.80 mm |
| E | 7.70 mm | M | 1.00 mm |
| F | - | N | 11.50 mm |
| G | 5.00 mm | O | 3.90 mm |
| H | 13.50 mm | P | 7.62 mm |

^① 20A Factory Wiring - UL

Pin Spacing: 7.62mm
 Orientation: Horizontal
 Clamp Type: Screw Cage
 Design: Modular



MHSP-27

ELECTRICAL

| | Current | Voltage | Wire Range |
|--|------------------|---------|---|
| | 15A ^① | 300V | 30-14AWG |
| | 24A | 750V | 2.5mm ² Stranded 4.0mm ² Solid |

INSTALLATION DATA

| | | | |
|-------------------|------------------------|------------------------|-------|
| Screw Size | M3 | PCB Hole Size | 1.5mm |
| Torque | 0.5Nm (4.5 lbf-in.) | Stripping Lgth. | 9.5mm |

MATERIAL

| | | | |
|---------------------------|-----------------------|-----------------|------------------|
| Body | PA6.8 | Screw | Galvanized Steel |
| Flammability Class | UL94V-0 | Terminal | Tin-Plated Brass |
| Temperature Limit | 105°C UL 125°C IEC | Clamp | Nickel Brass |
| Color | Green | | |

| No. Poles | Cat. # | Length (B) (mm) | Std. Pk. |
|-----------|-----------|-----------------|----------|
| 2 | MHSP-272 | 15.2 | 100 |
| 3 | MHSP-273 | 22.9 | 100 |
| 4 | MHSP-274 | 30.5 | 50 |
| 5 | MHSP-275 | 38.1 | 50 |
| 6 | MHSP-276 | 45.7 | 50 |
| 7 | MHSP-277 | 53.3 | 50 |
| 8 | MHSP-278 | 61.0 | 50 |
| 9 | MHSP-279 | 68.6 | 50 |
| 10 | MHSP-2710 | 76.2 | 50 |
| 11 | MHSP-2711 | 83.8 | 50 |
| 12 | MHSP-2712 | 91.4 | 50 |
| 13 | MHSP-2713 | 99.1 | 20 |
| 14 | MHSP-2714 | 106.7 | 20 |
| 15 | MHSP-2715 | 114.3 | 20 |
| 16 | MHSP-2716 | 121.9 | 20 |

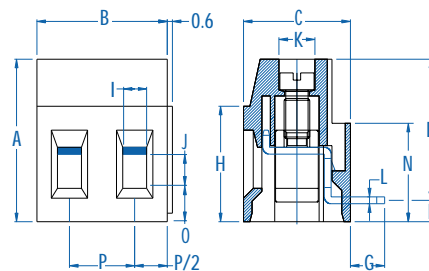

Dimensions

| | | | |
|---|----------|---|----------|
| A | 19.00 mm | I | 2.80 mm |
| B | 15.24 mm | J | 4.00 mm |
| C | 12.50 mm | K | Ø4.00 mm |
| D | 16.50 mm | L | 0.80 mm |
| E | 2.50 mm | M | 1.00 mm |
| F | - | N | 11.50 mm |
| G | 4.00 mm | O | 3.90 mm |
| H | 13.50 mm | P | 7.62 mm |

^① 20A Factory Wiring - UL

Fixed PCB Blocks

Pin Spacing: 9.52mm/ 19.04mm*
 Orientation: Vertical
 Clamp Type: Screw Cage
 Design: Modular

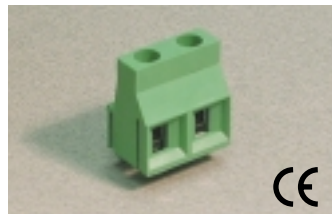

MV-49

ELECTRICAL

| | Current | Voltage | Wire Range |
|--|------------------|---------|---|
| | 20A ^① | 300V | 30-12AWG |
| | 25A | 750V | 4.0mm ² Stranded 6.0mm ² Solid |

INSTALLATION

DATA

| | | | |
|-------------------|------------------------|------------------------|-------|
| Screw Size | M3 | PCB Hole Size | 1.3mm |
| Torque | 0.5Nm (4.5 lbf-in.) | Stripping Lgth. | 9.8mm |

MATERIAL

| | | | |
|---------------------------|-----------------------|-----------------|------------------|
| Body | PA6.8 | Screw | Galvanized Steel |
| Flammability Class | UL94V-0 | Terminal | Tin-Plated Brass |
| Temperature Limit | 105°C UL 125°C IEC | Clamp | Nickeled Brass |
| Color | Green | | |

| No. Poles | Cat. # | Length (B) (mm) | Std. Pk. |
|-----------|---------|-----------------|----------|
| 2 | MV-492 | 19.0 | 100 |
| 3 | MV-493 | 28.6 | 100 |
| 4 | MV-494 | 38.1 | 50 |
| 5 | MV-495 | 47.6 | 50 |
| 6 | MV-496 | 57.1 | 50 |
| 7 | MV-497 | 66.6 | 50 |
| 8 | MV-498 | 76.2 | 50 |
| 9 | MV-499 | 85.7 | 50 |
| 10 | MV-4910 | 95.2 | 50 |
| 11 | MV-4911 | 104.7 | 50 |
| 12 | MV-4912 | 114.2 | 50 |
| 13 | MV-4913 | 123.8 | 20 |
| 14 | MV-4914 | 133.3 | 20 |
| 15 | MV-4915 | 142.8 | 20 |
| 16 | MV-4916 | 152.3 | 20 |

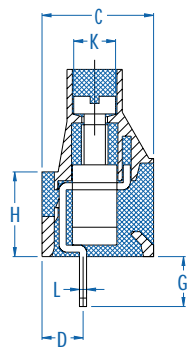
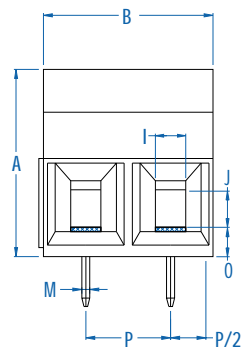

Dimensions

| | | | |
|---|----------|---|----------|
| A | 21.00 mm | I | 3.10 mm |
| B | 19.04 mm | J | 3.90 mm |
| C | 12.50 mm | K | Ø4.70 mm |
| D | 4.20 mm | L | 0.80 mm |
| E | - | M | 0.90 mm |
| F | - | N | - |
| G | 4.10 mm | O | 3.30 mm |
| H | 9.50 mm | P | 9.52 mm |

*19.04mm pin spacing available

^① 25A Factory Wiring - UL

Pin Spacing: 10.00mm
 Orientation: Vertical
 Clamp Type: Box with Wire Protector
 Design: Modular

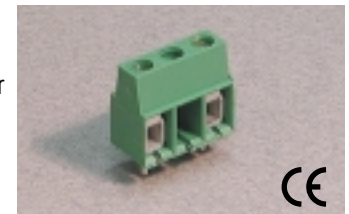

MVEB-15

ELECTRICAL

| | Current | Voltage | Wire Range |
|--|---------|---------|---|
| | 10A | 600V | 30-16AWG |
| | 17.5A | 750V | 1.5mm ² Stranded 2.5mm ² Solid |

INSTALLATION

DATA

| | | | |
|-------------------|------------------------|------------------------|-------|
| Screw Size | M2.5 | PCB Hole Size | 1.5mm |
| Torque | 0.4Nm (3.6 lbf-in.) | Stripping Lgth. | 6.8mm |

MATERIAL

| | | | |
|---------------------------|-----------------------|-----------------------|----------------------|
| Body | PA6.8 | Screw | Galvanized Steel |
| Flammability Class | UL94V-0 | Terminal | Tin-Plated Brass |
| Temperature Limit | 105°C UL 125°C IEC | Wire Protector | Tin-Plated Bronze |
| Color | Green | | |

| No. Poles | Cat. # | Length (B) (mm) | Std. Pk. |
|-----------|-----------|-----------------|----------|
| 2 | MVEB-152 | 15.0 | 100 |
| 3 | MVEB-153 | 25.0 | 50 |
| 4 | MVEB-154 | 35.0 | 50 |
| 5 | MVEB-155 | 45.0 | 50 |
| 6 | MVEB-156 | 55.0 | 50 |
| 7 | MVEB-157 | 65.0 | 50 |
| 8 | MVEB-158 | 75.0 | 20 |
| 9 | MVEB-159 | 85.0 | 20 |
| 10 | MVEB-1510 | 95.0 | 20 |
| 11 | MVEB-1511 | 105.0 | 20 |
| 12 | MVEB-1512 | 115.0 | 20 |

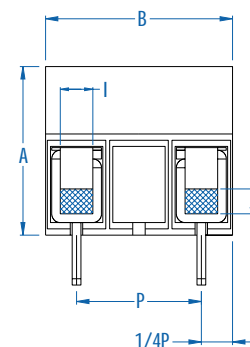
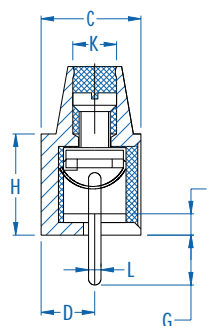

Dimensions

| | | | |
|---|----------|---|----------|
| A | 13.50 mm | I | 2.60 mm |
| B | 15.00 mm | J | 2.00 mm |
| C | 8.00 mm | K | Ø3.40 mm |
| D | 4.00 mm | L | 1.10 mm |
| E | - | M | 0.70 mm |
| F | - | N | - |
| G | 4.10 mm | O | 1.70 mm |
| H | 8.10 mm | P | 10.00 mm |

Fixed PCB Blocks

Pin Spacing: 10.00mm
 Orientation: Vertical
 Clamp Type: Screw Cage
 Design: Modular

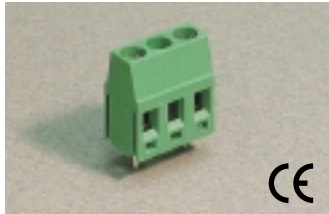

MVEB-25

ELECTRICAL

| | Current | Voltage | Wire Range |
|--|------------------|---------|---|
| | 15A ^① | 600V | 30-14AWG |
| | 16A | 750V | 2.5mm ² Stranded 4.0mm ² Solid |

INSTALLATION DATA

| | | | |
|-------------------|------------------------|------------------------|-------|
| Screw Size | M3 | PCB Hole Size | 1.3mm |
| Torque | 0.5Nm (4.5 lbf-in.) | Stripping Lgth. | 7.1mm |

MATERIAL

| | | | |
|---------------------------|-----------------------|-----------------|------------------|
| Body | PA6.8 | Screw | Galvanized Steel |
| Flammability Class | UL94V-0 | Terminal | Tin-Plated Brass |
| Temperature Limit | 105°C UL 125°C IEC | Clamp | Nickel Brass |
| Color | Green | | |

| No. Poles | Cat. # | Length (B) (mm) | Std. Pk. |
|-----------|-----------|-----------------|----------|
| 2 | MVEB-252 | 15.0 | 100 |
| 3 | MVEB-253 | 25.0 | 50 |
| 4 | MVEB-254 | 35.0 | 50 |
| 5 | MVEB-255 | 45.0 | 50 |
| 6 | MVEB-256 | 55.0 | 50 |
| 7 | MVEB-257 | 65.0 | 50 |
| 8 | MVEB-258 | 75.0 | 20 |
| 9 | MVEB-259 | 85.0 | 20 |
| 10 | MVEB-2510 | 95.0 | 20 |
| 11 | MVEB-2511 | 105.0 | 20 |
| 12 | MVEB-2512 | 115.0 | 20 |

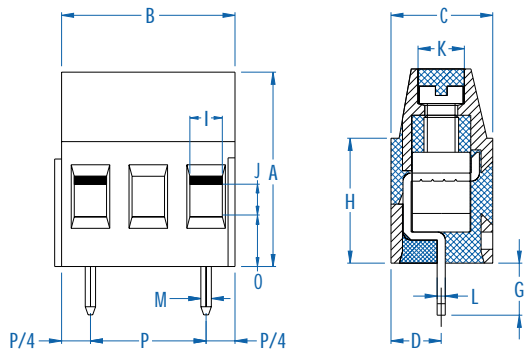

Dimensions

| | | | |
|---|----------|---|----------|
| A | 16.80 mm | I | 2.80 mm |
| B | 15.00 mm | J | 2.80 mm |
| C | 8.90 mm | K | Ø3.80 mm |
| D | 4.35 mm | L | 0.70 mm |
| E | - | M | 0.90 mm |
| F | - | N | - |
| G | 4.50 mm | O | 4.60 mm |
| H | 10.80 mm | P | 10.00 mm |

^① 16A Factory Wiring - UL

Pin Spacing: 10.00mm
 Orientation: Horizontal
 Clamp Type: Screw Cage
 Design: Modular

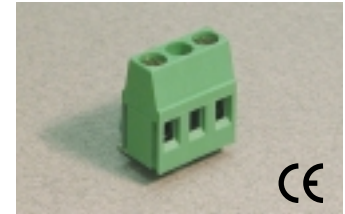

MHEB-25

ELECTRICAL

| | Current | Voltage | Wire Range |
|--|------------------|---------|---|
| | 15A ^① | 600V | 30-14AWG |
| | 16A | 750V | 2.5mm ² Stranded 4.0mm ² Solid |

INSTALLATION DATA

| | | | |
|-------------------|------------------------|------------------------|-------|
| Screw Size | M3 | PCB Hole Size | 1.3mm |
| Torque | 0.5Nm (4.5 lbf-in.) | Stripping Lgth. | 7.1mm |

MATERIAL

| | | | |
|---------------------------|-----------------------|-----------------|------------------|
| Body | PA6.8 | Screw | Galvanized Steel |
| Flammability Class | UL94V-0 | Terminal | Tin-Plated Brass |
| Temperature Limit | 105°C UL 125°C IEC | Clamp | Nickel Brass |
| Color | Green | | |

| No. Poles | Cat. # | Length (B) (mm) | Std. Pk. |
|-----------|-----------|-----------------|----------|
| 2 | MHEB-252 | 15.0 | 100 |
| 3 | MHEB-253 | 25.0 | 50 |
| 4 | MHEB-254 | 35.0 | 50 |
| 5 | MHEB-255 | 45.0 | 50 |
| 6 | MHEB-256 | 55.0 | 50 |
| 7 | MHEB-257 | 65.0 | 50 |
| 8 | MHEB-258 | 75.0 | 20 |
| 9 | MHEB-259 | 85.0 | 20 |
| 10 | MHEB-2510 | 95.0 | 20 |
| 11 | MHEB-2511 | 105.0 | 20 |
| 12 | MHEB-2512 | 115.0 | 20 |

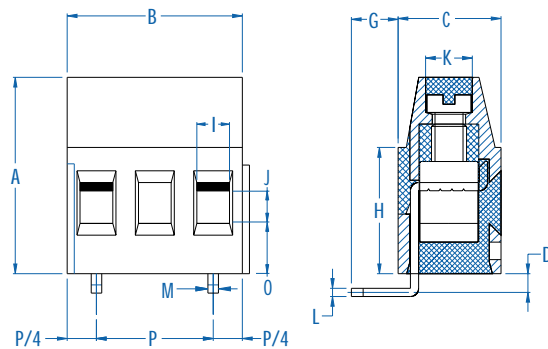

Dimensions

| | | | |
|---|----------|---|----------|
| A | 16.80 mm | I | 2.80 mm |
| B | 15.00 mm | J | 2.80 mm |
| C | 8.90 mm | K | Ø3.80 mm |
| D | 1.40 mm | L | 0.70 mm |
| E | - | M | 0.90 mm |
| F | - | N | - |
| G | 4.00 mm | O | 4.60 mm |
| H | 10.80 mm | P | 10.00 mm |

^① 16A Factory Wiring - UL

Pin Spacing: 10.16mm
 Orientation: Vertical
 Clamp Type: Screw Cage
 Design: Modular

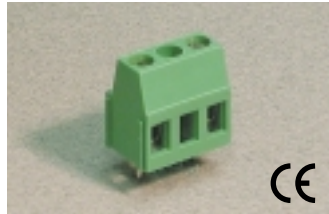

MVB-25

ELECTRICAL

| | Current | Voltage | Wire Range |
|--|------------------|---------|---|
| | 15A ^① | 300V | 30-14AWG |
| | 16A | 750V | 2.5mm ² Stranded 4.0mm ² Solid |

INSTALLATION DATA

| Screw Size | M3 | PCB Hole Size | 1.3mm |
|------------|------------------------|-----------------|-------|
| Torque | 0.5Nm (4.5 lbf-in.) | Stripping Lgth. | 8.3mm |

MATERIAL

| | | | |
|---------------------------|-----------------------|-----------------|------------------|
| Body | PA6.8 | Screw | Galvanized Steel |
| Flammability Class | UL94V-0 | Terminal | Tin-Plated Brass |
| Temperature Limit | 105°C UL 125°C IEC | Clamp | Nickeled Brass |
| Color | Green | | |

| No. Poles | Cat. # | Length (B) (mm) | Std. Pk. |
|-----------|----------|-----------------|----------|
| 2 | MVB-252 | 15.2 | 100 |
| 3 | MVB-253 | 25.4 | 50 |
| 4 | MVB-254 | 35.6 | 50 |
| 5 | MVB-255 | 45.7 | 50 |
| 6 | MVB-256 | 55.9 | 50 |
| 7 | MVB-257 | 66.0 | 50 |
| 8 | MVB-258 | 76.2 | 20 |
| 9 | MVB-259 | 86.4 | 20 |
| 10 | MVB-2510 | 96.5 | 20 |
| 11 | MVB-2511 | 106.7 | 20 |
| 12 | MVB-2512 | 116.8 | 20 |

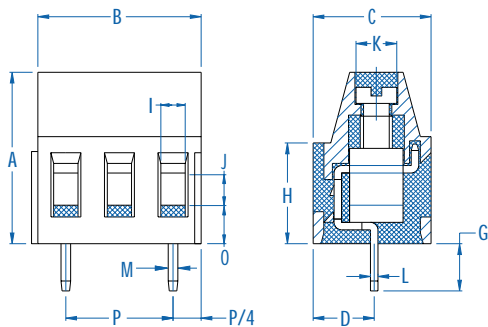

Dimensions

| | | | |
|---|----------|---|----------|
| A | 16.00 mm | I | 2.80 mm |
| B | 15.24 mm | J | 2.80 mm |
| C | 11.00 mm | K | Ø3.80 mm |
| D | 5.00 mm | L | 0.70 mm |
| E | - | M | 0.90 mm |
| F | - | N | - |
| G | 4.50 mm | O | 3.60 mm |
| H | 9.40 mm | P | 10.16 mm |

^① 16A Factory Wiring - UL

Pin Spacing: 10.16mm
 Orientation: Horizontal
 Clamp Type: Screw Cage
 Design: Modular

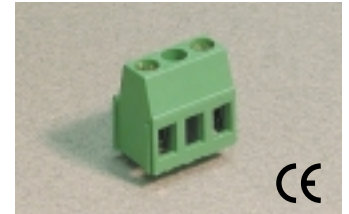

MHB-25

ELECTRICAL

| | Current | Voltage | Wire Range |
|--|------------------|---------|---|
| | 15A ^① | 300V | 30-14AWG |
| | 16A | 750V | 2.5mm ² Stranded 4.0mm ² Solid |

INSTALLATION DATA

| Screw Size | M3 | PCB Hole Size | 1.3mm |
|------------|------------------------|-----------------|-------|
| Torque | 0.5Nm (4.5 lbf-in.) | Stripping Lgth. | 8.3mm |

MATERIAL

| | | | |
|---------------------------|-----------------------|-----------------|------------------|
| Body | PA6.8 | Screw | Galvanized Steel |
| Flammability Class | UL94V-0 | Terminal | Tin-Plated Brass |
| Temperature Limit | 105°C UL 125°C IEC | Clamp | Nickeled Brass |
| Color | Green | | |

| No. Poles | Cat. # | Length (B) (mm) | Std. Pk. |
|-----------|----------|-----------------|----------|
| 2 | MHB-252 | 15.2 | 100 |
| 3 | MHB-253 | 25.4 | 50 |
| 4 | MHB-254 | 35.6 | 50 |
| 5 | MHB-255 | 45.7 | 50 |
| 6 | MHB-256 | 55.9 | 50 |
| 7 | MHB-257 | 66.0 | 50 |
| 8 | MHB-258 | 76.2 | 20 |
| 9 | MHB-259 | 86.4 | 20 |
| 10 | MHB-2510 | 96.5 | 20 |
| 11 | MHB-2511 | 106.7 | 20 |
| 12 | MHB-2512 | 116.8 | 20 |

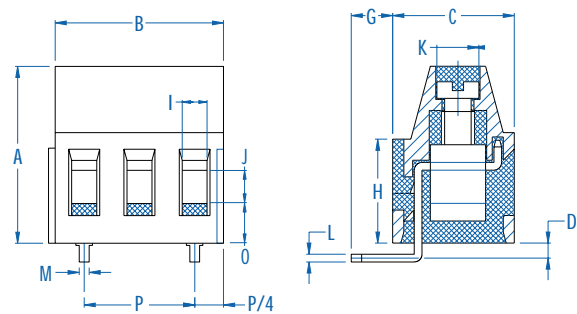

Dimensions

| | | | |
|---|----------|---|----------|
| A | 16.00 mm | I | 2.80 mm |
| B | 15.24 mm | J | 2.80 mm |
| C | 11.00 mm | K | Ø3.80 mm |
| D | 2.00 mm | L | 0.70 mm |
| E | - | M | 0.90 mm |
| F | - | N | - |
| G | 4.00 mm | O | 3.60 mm |
| H | 9.40 mm | P | 10.16 mm |

^① 16A Factory Wiring - UL

Fixed PCB Blocks

Pin Spacing: 10.16mm
 Orientation: Vertical
 Clamp Type: Screw Cage
 Design: Modular

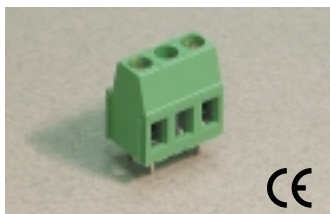

MVB-25-D

ELECTRICAL

| | Current | Voltage | Wire Range |
|--|------------------|---------|---|
| | 15A ^① | 300V | 30-14AWG |
| | 24A | 750V | 2.5mm ² Stranded 4.0mm ² Solid |

INSTALLATION DATA

| | | | |
|-------------------|------------------------|------------------------|-------|
| Screw Size | M3 | PCB Hole Size | 1.3mm |
| Torque | 0.5Nm (4.5 lbf-in.) | Stripping Lgth. | 8.3mm |

MATERIAL

| | | | |
|---------------------------|-----------------------|-----------------|------------------|
| Body | PA6.8 | Screw | Galvanized Steel |
| Flammability Class | UL94V-0 | Terminal | Tin-Plated Brass |
| Temperature Limit | 105°C UL 125°C IEC | Clamp | Nickel Brass |
| Color | Green | | |

| No. Poles | Cat. # | Length (B) (mm) | Std. Pk. |
|-----------|------------|-----------------|----------|
| 2 | MVB-252-D | 15.2 | 100 |
| 3 | MVB-253-D | 25.4 | 50 |
| 4 | MVB-254-D | 35.6 | 50 |
| 5 | MVB-255-D | 45.7 | 50 |
| 6 | MVB-256-D | 55.9 | 50 |
| 7 | MVB-257-D | 66.0 | 50 |
| 8 | MVB-258-D | 76.2 | 20 |
| 9 | MVB-259-D | 86.4 | 20 |
| 10 | MVB-2510-D | 96.5 | 20 |
| 11 | MVB-2511-D | 106.7 | 20 |
| 12 | MVB-2512-D | 116.8 | 20 |

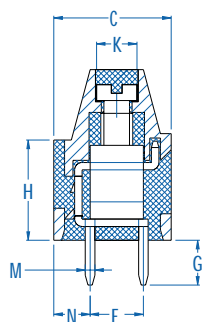
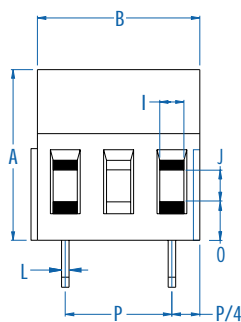

Dimensions

| | | | |
|---|----------|---|----------|
| A | 16.00 mm | I | 2.80 mm |
| B | 15.24 mm | J | 2.80 mm |
| C | 11.00 mm | K | Ø3.80 mm |
| D | — | L | 0.70 mm |
| E | 5.00 mm | M | 0.90 mm |
| F | — | N | 3.40 mm |
| G | 4.50 mm | O | 3.60 mm |
| H | 9.40 mm | P | 10.16 mm |

^① 18A Factory Wiring - UL

Pin Spacing: 10.16mm
 Orientation: Vertical-Double Level
 Clamp Type: Screw Cage
 Design: Modular-Aligned

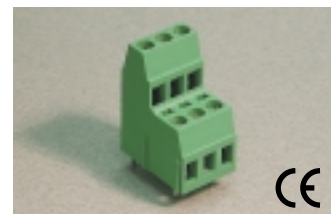

MVDKB-25

ELECTRICAL

| | Current | Voltage | Wire Range |
|--|------------------|---------|---|
| | 15A ^① | 300V | 30-14AWG |
| | 16A | 750V | 2.5mm ² Stranded 4.0mm ² Solid |

INSTALLATION DATA

| | | | |
|-------------------|------------------------|------------------------|-------|
| Screw Size | M3 | PCB Hole Size | 1.3mm |
| Torque | 0.5Nm (4.5 lbf-in.) | Stripping Lgth. | 8.3mm |

MATERIAL

| | | | |
|---------------------------|-----------------------|-----------------|------------------|
| Body | PA6.8 | Screw | Galvanized Steel |
| Flammability Class | UL94V-0 | Terminal | Tin-Plated Brass |
| Temperature Limit | 105°C UL 125°C IEC | Clamp | Nickel Brass |
| Color | Green | | |

| No. Poles | Cat. # | Length (B) (mm) | Std. Pk. |
|-----------|------------|-----------------|----------|
| 4 | MVDKB-252 | 15.2 | 100 |
| 6 | MVDKB-253 | 25.4 | 50 |
| 8 | MVDKB-254 | 35.6 | 50 |
| 10 | MVDKB-255 | 45.7 | 50 |
| 12 | MVDKB-256 | 55.9 | 20 |
| 14 | MVDKB-257 | 66.0 | 20 |
| 16 | MVDKB-258 | 76.2 | 20 |
| 18 | MVDKB-259 | 86.4 | 20 |
| 20 | MVDKB-2510 | 96.5 | 10 |
| 22 | MVDKB-2511 | 106.7 | 10 |
| 24 | MVDKB-2512 | 116.8 | 10 |

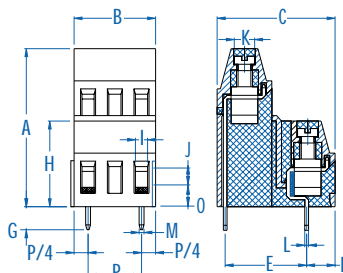

Dimensions

| | | | |
|---|----------|---|----------|
| A | 29.50 mm | I | 2.80 mm |
| B | 15.24 mm | J | 2.80 mm |
| C | 22.00 mm | K | Ø3.80 mm |
| D | 5.30 mm | L | 0.70 mm |
| E | 15.24 mm | M | 0.90 mm |
| F | — | N | — |
| G | 4.70 mm | O | 3.60 mm |
| H | 16.00 mm | P | 10.16 mm |

^① 16A Factory Wiring - UL

Pin Spacing: 10.16mm
 Orientation: Vertical-Double Level
 Clamp Type: Screw Cage
 Design: Modular

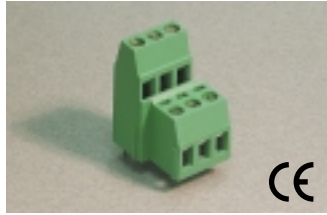

MVDB-25

ELECTRICAL

| | Current | Voltage | Wire Range |
|--|------------------|---------|---|
| | 15A ^① | 300V | 30-14AWG |
| | 16A | 750V | 2.5mm ² Stranded 4.0mm ² Solid |

INSTALLATION

DATA

| | | | |
|-------------------|------------------------|------------------------|-------|
| Screw Size | M3 | PCB Hole Size | 1.3mm |
| Torque | 0.5Nm (4.5 lbf-in.) | Stripping Lgth. | 8.3mm |

MATERIAL

| | | | |
|---------------------------|-----------------------|-----------------|------------------|
| Body | PA6.8 | Screw | Galvanized Steel |
| Flammability Class | UL94V-0 | Terminal | Tin-Plated Brass |
| Temperature Limit | 105°C UL 125°C IEC | Clamp | Nickeled Brass |
| Color | Green | | |

| No. Poles | Cat. # | Length (B) (mm) | Std. Pk. |
|-----------|-----------|-----------------|----------|
| 4 | MVDB-252 | 17.8 | 100 |
| 6 | MVDB-253 | 30.5 | 50 |
| 8 | MVDB-254 | 43.2 | 50 |
| 10 | MVDB-255 | 55.9 | 50 |
| 12 | MVDB-256 | 68.6 | 20 |
| 14 | MVDB-257 | 81.3 | 20 |
| 16 | MVDB-258 | 94.0 | 20 |
| 18 | MVDB-259 | 106.7 | 20 |
| 20 | MVDB-2510 | 119.4 | 10 |
| 22 | MVDB-2511 | 132.1 | 10 |
| 24 | MVDB-2512 | 144.8 | 10 |

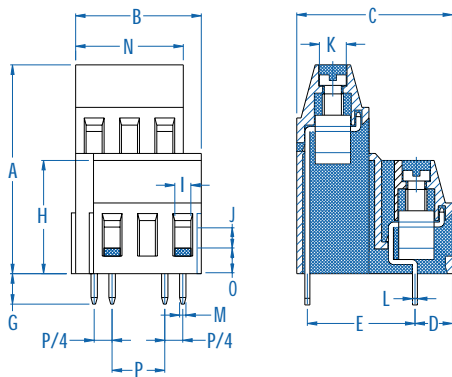

Dimensions

| | | | |
|---|----------|---|----------|
| A | 29.50 mm | I | 2.80 mm |
| B | 17.78 mm | J | 2.80 mm |
| C | 22.00 mm | K | Ø3.80 mm |
| D | 5.30 mm | L | 0.70 mm |
| E | 15.24 mm | M | 0.90 mm |
| F | — | N | 15.24 mm |
| G | 4.70 mm | O | 3.60 mm |
| H | 16.00 mm | P | 10.16 mm |

^① 16A Factory Wiring - UL

Pin Spacing: 10.16mm
 Orientation: Vertical-Triple Level
 Clamp Type: Screw Cage
 Design: Modular

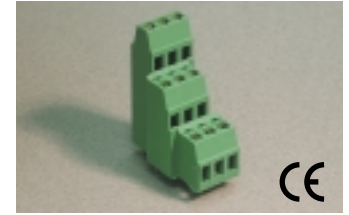

MVTB-25

ELECTRICAL

| | Current | Voltage | Wire Range |
|--|------------------|---------|---|
| | 15A ^① | 300V | 30-14AWG |
| | 16A | 750V | 2.5mm ² Stranded 4.0mm ² Solid |

INSTALLATION

DATA

| | | | |
|-------------------|------------------------|------------------------|-------|
| Screw Size | M3 | PCB Hole Size | 1.3mm |
| Torque | 0.5Nm (4.5 lbf-in.) | Stripping Lgth. | 8.3mm |

MATERIAL

| | | | |
|---------------------------|-----------------------|-----------------|------------------|
| Body | PA6.8 | Screw | Galvanized Steel |
| Flammability Class | UL94V-0 | Terminal | Tin-Plated Brass |
| Temperature Limit | 105°C UL 125°C IEC | Clamp | Nickeled Brass |
| Color | Green | | |

| No. Poles | Cat. # | Length (B) (mm) | Std. Pk. |
|-----------|-----------|-----------------|----------|
| 6 | MVTB-252 | 17.8 | 50 |
| 9 | MVTB-253 | 30.5 | 30 |
| 12 | MVTB-254 | 43.2 | 30 |
| 15 | MVTB-255 | 55.9 | 30 |
| 18 | MVTB-256 | 68.6 | 15 |
| 21 | MVTB-257 | 81.3 | 15 |
| 24 | MVTB-258 | 94.0 | 15 |
| 27 | MVTB-259 | 106.7 | 15 |
| 30 | MVTB-2510 | 119.4 | 5 |
| 33 | MVTB-2511 | 132.1 | 5 |
| 36 | MVTB-2512 | 144.8 | 5 |

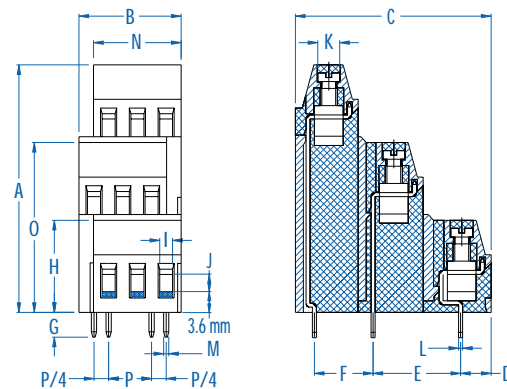

Dimensions

| | | | |
|---|----------|---|----------|
| A | 43.00 mm | I | 2.80 mm |
| B | 17.78 mm | J | 2.80 mm |
| C | 34.00 mm | K | Ø3.80 mm |
| D | 5.30 mm | L | 0.70 mm |
| E | 15.24 mm | M | 0.90 mm |
| F | 10.16 mm | N | 15.24 mm |
| G | 4.50 mm | O | 29.50 mm |
| H | 16.00 mm | P | 10.16 mm |

^① 16A Factory Wiring - UL

INDEX

| PART # | PAGE | PART # | PAGE |
|------------------------|------|----------------------|------|
| CMR-10 | 49 | MVEB-25 | 24 |
| CMR-75 | 49 | MVI | 39 |
| MBE-15 | 7 | MVS-15 | 8 |
| MBES-15 | 12 | MVSP-25 | 14 |
| MH-15 | 10 | MVSP-27 | 22 |
| MH-25 | 14 | MVT-25 | 17 |
| MH-27 | 19 | MVTB-25 | 27 |
| MHB-25 | 25 | PDSH-10.16 | 48 |
| MHE-13 | 9 | PDSH-5.08 | 37 |
| MHE-16 | 10 | PDSV-5.08 | 37 |
| MHE-25 | 11 | PDSV-10.16 | 47 |
| MHE-27 | 20 | PH-10.00 | 44 |
| MHEB-25 | 24 | PH-10.16 | 46 |
| MHR-25 | 11 | PH-5.00 | 32 |
| MHR-27 | 20 | PH-5.08 | 36 |
| MHSP-25 | 15 | PH-5.08-K | 39 |
| MHSP-27 | 22 | PH-7.50 | 41 |
| MI-25 (35) | 15 | PHP-10.00 | 44 |
| MI-25 (45) | 16 | PHP-10.16 | 47 |
| MI-25 (5.00) | 12 | PHP-5.00 | 33 |
| MI-27 | 21 | PHP-5.08 | 36 |
| MPT-275 | 49 | PHP-7.50 | 42 |
| MPT-410 | 49 | PV-10.00 | 43 |
| MT-210 | 48 | PV-10.16 | 45 |
| MV-15 | 8 | PV-5.00 | 31 |
| MV-25 | 13 | PV-5.08 | 35 |
| MV-25-D | 13 | PV-5.08-K | 38 |
| MV-27 | 18 | PV-7.50 | 40 |
| MV-46 | 18 | PVP-10.00 | 43 |
| MV-47 | 21 | PVP-10.16 | 46 |
| MV-49 | 23 | PVP-5.00 | 32 |
| MVB-25 | 25 | PVP-5.08 | 35 |
| MVB-25-D | 26 | PVP-7.50 | 41 |
| MVD-25 | 16 | PVS-5.00 | 30 |
| MVDB-25 | 27 | SH-10.00 | 42 |
| MVDK-25 | 17 | SH-10.16 | 45 |
| MVDKB-25 | 26 | SH-5.00 | 31 |
| MVE-15 | 7 | SH-5.08 | 33 |
| MVE-25 | 9 | SH-5.08-K | 38 |
| MVE-27 | 19 | SH-7.50 | 40 |
| MVE-35 | 6 | SHS-5.00 | 30 |
| MVE-38 | 6 | SVF-5.08 | 34 |
| MVEB-15 | 23 | SVP-5.08 | 34 |

COMMONLY USED METRIC AND OTHER USEFUL CONVERSIONS

| Length inch [in.] millimeters [mm] meters [m] miles [mi] kilometers [km] | x 25.4 x 0.03937 x 3.281 x 1.609 x 0.6214 | =millimeters =inches =feet =kilometers =miles | Metric Cross-Sectional Areas a | | | American Wire Gauge | | |
|---|---|---|--------------------------------------|--|------------|--------------------------------------|--|------------|
| | | | Cross-Sectional Area mm ² | Equivalent Metric Area mm ² | AWG or MCM | Cross-Sectional Area mm ² | Equivalent Metric Area mm ² | AWG or MCM |
| Torque Newtonmeter [Nm] lb-ft lb-in oz-in | x 0.738 x 1.356 x 0.113 x 0.0071 | =lb-ft =Nm =Nm =Nm | 0.50 | 0.519 | 20 AWG | 25.0 | 21.15 | 4 AWG |
| | | | 0.75 | 0.653 | 19 | 35.0 | 26.67 | 3 |
| | | | | 0.823 | 18 | | 33.63 | 2 |
| | | | | 1.04 | 17 | | 42.41 | 1 |
| | | | | 1.31 | 16 | 50.0 | 53.48 | 1/0 |
| | | | 1.5 | 1.65 | 15 | 70.0 | 67.43 | 2/0 |
| | | | | 2.08 | 14 | 95.0 | 85.03 | 3/0 |
| | | | 2.5 | 2.62 | 13 | | 107.20 | 4/0 |
| | | | | 3.31 | 12 | 120.0 | 126.64 | 250 MCM |
| | | | | 4.17 | 11 | 150.0 | 152.00 | 300 |
| | | | | 5.26 | 10 | 185.0 | 177.35 | 350 |
| | | | 4.0 | 6.63 | 9 | 240.0 | 202.71 | 400 |
| | | | | 8.37 | 8 | 300.0 | 253.35 | 500 |
| | | | 6.0 | 10.55 | 7 | 400.0 | 380.00 | 750 |
| | | | | 13.30 | 6 | 500.0 | 506.71 | 1000 |
| | | | 10.0 | 16.77 | 5 | 625.0 | | |
| | | | 16.0 | | | | | |

^aAs per IEC Publ. 228

| DEGREES CELSIUS VERSUS DEGREES FAHRENHEIT | | | | | | | | | | | | | | | |
|---|--------|-----|------|----|------|----|-------|----|-------|-----|-------|-----|-------|------|-------|
| °C | °F | °C | °F | °C | °F | °C | °F | °C | °F | °C | °F | °C | °F | °C | °F |
| -80 | -112.0 | -20 | -4.0 | 5 | 41.0 | 30 | 86.0 | 55 | 131.0 | 80 | 176.0 | 105 | 221.0 | 130 | 266.0 |
| -70 | -94.0 | -19 | -2.2 | 6 | 42.8 | 31 | 87.8 | 56 | 132.8 | 81 | 177.8 | 106 | 222.8 | 131 | 267.8 |
| -60 | -65.0 | -18 | -0.4 | 7 | 44.6 | 32 | 89.6 | 57 | 134.6 | 82 | 179.6 | 107 | 224.6 | 132 | 269.6 |
| -50 | -58.0 | -17 | +1.4 | 8 | 46.4 | 33 | 91.4 | 58 | 136.4 | 83 | 181.4 | 108 | 226.4 | 133 | 271.4 |
| -45 | -49.1 | -16 | 3.2 | 9 | 48.2 | 34 | 93.2 | 59 | 138.2 | 84 | 183.2 | 109 | 228.2 | 134 | 273.2 |
| -40 | -40.0 | -15 | 5.0 | 10 | 50.0 | 35 | 95.0 | 60 | 140.0 | 85 | 185.0 | 110 | 230.0 | 135 | 275.0 |
| -39 | -38.2 | -14 | 6.8 | 11 | 51.8 | 36 | 96.8 | 61 | 141.8 | 86 | 186.8 | 111 | 231.8 | 136 | 276.8 |
| -38 | -36.4 | -13 | 8.6 | 12 | 53.6 | 37 | 98.6 | 62 | 143.6 | 87 | 188.6 | 112 | 233.6 | 137 | 278.6 |
| -37 | -34.6 | -12 | 10.4 | 13 | 55.4 | 38 | 100.4 | 63 | 145.4 | 88 | 189.4 | 113 | 235.4 | 138 | 280.4 |
| -36 | -32.8 | -11 | 12.2 | 14 | 57.2 | 39 | 102.2 | 64 | 147.2 | 89 | 192.2 | 114 | 237.2 | 139 | 282.2 |
| -35 | -31.0 | -10 | 14.0 | 15 | 59.0 | 40 | 104.0 | 65 | 149.0 | 90 | 194.0 | 115 | 239.0 | 140 | 284.0 |
| -34 | -29.2 | -9 | 15.8 | 16 | 60.8 | 41 | 105.8 | 66 | 150.8 | 91 | 195.8 | 116 | 240.8 | 141 | 285.8 |
| -33 | -27.4 | -8 | 17.6 | 17 | 62.6 | 42 | 107.6 | 67 | 152.6 | 92 | 197.6 | 117 | 242.6 | 142 | 287.6 |
| -32 | -25.6 | -7 | 19.4 | 18 | 64.4 | 43 | 109.4 | 68 | 154.4 | 93 | 199.4 | 118 | 244.4 | 143 | 289.4 |
| -31 | -23.8 | -6 | 21.2 | 19 | 66.2 | 44 | 111.2 | 69 | 156.2 | 94 | 201.2 | 119 | 246.2 | 144 | 291.2 |
| -30 | -22.0 | -5 | 23.0 | 20 | 68.0 | 45 | 113.0 | 70 | 158.0 | 95 | 203.0 | 120 | 248.0 | 145 | 293.0 |
| -29 | -22.0 | -4 | 24.8 | 21 | 69.8 | 46 | 114.8 | 71 | 159.8 | 96 | 204.8 | 121 | 249.8 | 146 | 294.8 |
| -28 | -18.4 | -3 | 26.6 | 22 | 71.6 | 47 | 116.6 | 72 | 161.6 | 97 | 206.6 | 122 | 251.6 | 147 | 296.6 |
| -27 | -16.6 | -2 | 28.4 | 23 | 73.4 | 48 | 118.4 | 73 | 163.4 | 98 | 208.4 | 123 | 253.4 | 148 | 298.4 |
| -26 | -14.8 | -1 | 30.2 | 24 | 75.2 | 49 | 120.2 | 74 | 165.2 | 99 | 210.2 | 124 | 255.2 | 149 | 300.2 |
| -25 | -13.0 | 0 | 32.0 | 25 | 77.0 | 50 | 122.0 | 75 | 167.0 | 100 | 212.0 | 125 | 257.0 | 150 | 302.0 |
| -24 | -11.2 | 1 | 33.8 | 26 | 78.8 | 51 | 123.8 | 76 | 168.8 | 101 | 213.8 | 126 | 258.8 | 160 | 320.0 |
| -23 | -9.4 | 2 | 35.6 | 27 | 80.6 | 52 | 125.6 | 77 | 170.6 | 102 | 215.6 | 127 | 260.6 | 170 | 338.0 |
| -22 | -7.6 | 3 | 37.4 | 28 | 82.4 | 53 | 127.4 | 78 | 172.4 | 103 | 217.4 | 128 | 262.4 | 180 | 356.0 |
| -21 | -5.8 | 4 | 39.2 | 29 | 84.2 | 54 | 129.2 | 79 | 174.2 | 104 | 219.2 | 129 | 264.2 | 190 | 374.0 |
| | | | | | | | | | | | | | | 2000 | 3632 |

Conversion Formula °F = 9/5°C + 32° °C = 5/9(°F-32°)