

This document is the property of Amphenol Corporation and is intended for use in connection with the equipment specified herein. It is not to be distributed, reproduced or used, in whole or in part, without the prior consent of Amphenol Corporation. No part of this document may be reproduced or transmitted in any form or by any means, electronic or mechanical, including photocopying, recording, or by any information storage and retrieval system, without the prior consent of Amphenol Corporation. Amphenol Corporation shall be held harmless for any damages or losses of any kind, including consequential damages, arising from the use of this document. Amphenol Corporation shall be held harmless for any damages or losses of any kind, including consequential damages, arising from the use of this document.

REVISIONS		DATE	APPROVED
1	DESCRIPTION	26/02/07	
SM	EON		
A			

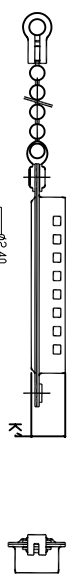

Flat MALE dust cover with Chain, for use with FEMALE connector

Part number

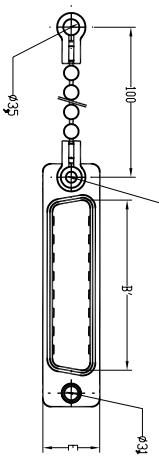

- 09 contacts or shell size E = L17D4K630 09
- 15 contacts or shell size A = L17D4K630 15
- 25 contacts or shell size B = L17D4K630 25
- 37 contacts or shell size C = L17D4K630 37
- 50 contacts or shell size D = L17D4K630 50

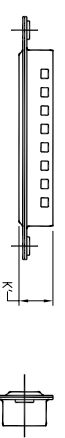
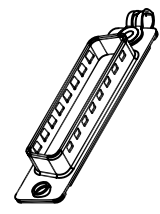
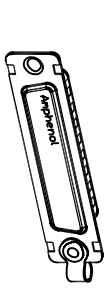

Flat MALE dust cover with Chain, for use with FEMALE connector

Part number

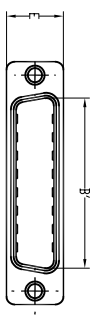

- 09 contacts or shell size E = L17D4K630 10
- 15 contacts or shell size A = L17D4K630 16
- 25 contacts or shell size B = L17D4K630 26
- 37 contacts or shell size C = L17D4K630 38
- 50 contacts or shell size D = L17D4K630 51

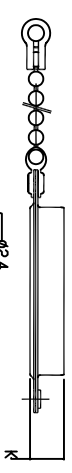
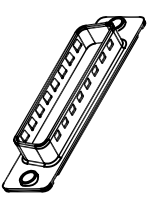
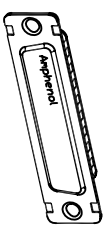

Flat FEMALE dust cover with Chain, for use with MALE connector

Part number

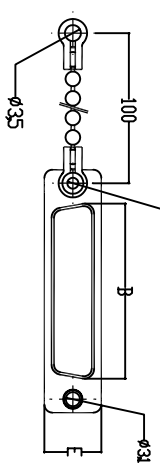

- 09 contacts or shell size E = L17D4K631 09
- 15 contacts or shell size A = L17D4K631 15
- 25 contacts or shell size B = L17D4K631 25
- 37 contacts or shell size C = L17D4K631 37
- 50 contacts or shell size D = L17D4K631 50

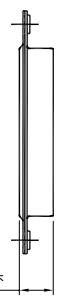
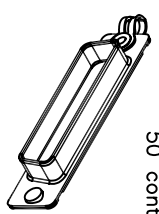
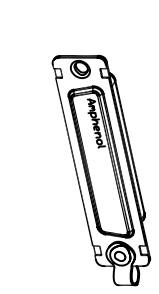

Flat FEMALE dust cover with Chain, for use with MALE connector

Part number

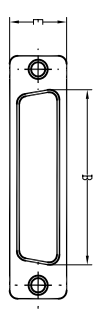

- 09 contacts or shell size E = L17D4K631 10
- 15 contacts or shell size A = L17D4K631 16
- 25 contacts or shell size B = L17D4K631 26
- 37 contacts or shell size C = L17D4K631 38
- 50 contacts or shell size D = L17D4K631 51

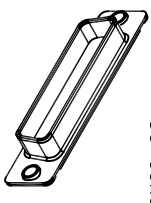
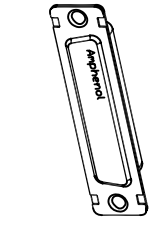

Shell = steel with tin plating

Size	B'	B	K'	K	E
E	16,8	16,4	7,6	7,9	12,4
A	25,1	24,8	7,6	7,9	12,4
B	38,8	38,5	7,6	7,9	12,4
C	55,3	54,9	7,6	7,9	12,4
D	52,7	52,5	7,6	7,9	15,2

DIMENSIONS SPECIFIED		APPROVAL		DATE	
TOLERANCES	U.S.	DRAWN	DATE	CHECKED	DATE
	METRIC	1/16	16/03/07	1/16	16/03/07
		CHECKED	16/03/07	CHECKED	16/03/07
SURFACE FINISH		DRAWING FILE :			
REMOVE SHARP EDGES		TITLE			
DIMENSIONS		Accessory, Dust Cover			
TYPICAL		SIZE: DRAWING NO. C L17D4K63XXX			
SCALE NONE		SHEET 1 OF 1			

Amphenol