

This document is the property of Amphenol Corporation and is delivered on the express condition that it is not to be distributed, reproduced or used, in whole or in part, without the prior consent of Amphenol Corporation. Amphenol Corporation will not be held liable for any errors or omissions in this document or for any damage or loss of any kind resulting from the use of the information contained herein. All rights are reserved to Amphenol Corporation.

REVISITONS		DATE	APPROVED
SM	EON		
A		26/02/07	

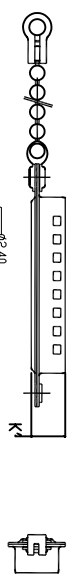

Flat MALE dust cover with Chain, for use with FEMALE connector

Part number

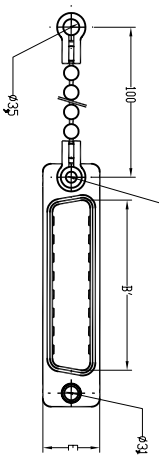

- 09 contacts or shell size E = L17D4K630 09
- 15 contacts or shell size A = L17D4K630 15
- 25 contacts or shell size B = L17D4K630 25
- 37 contacts or shell size C = L17D4K630 37
- 50 contacts or shell size D = L17D4K630 50

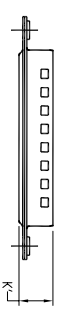
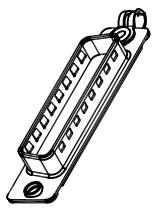
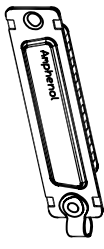

Flat MALE dust cover with Chain, for use with FEMALE connector

Part number

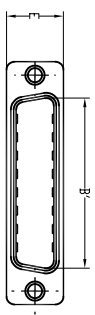

- 09 contacts or shell size E = L17D4K630 10
- 15 contacts or shell size A = L17D4K630 16
- 25 contacts or shell size B = L17D4K630 26
- 37 contacts or shell size C = L17D4K630 38
- 50 contacts or shell size D = L17D4K630 51

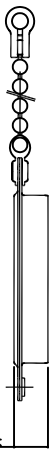
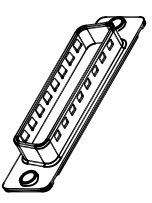
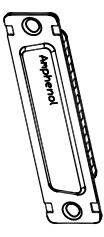

Flat FEMALE dust cover with Chain, for use with MALE connector

Part number

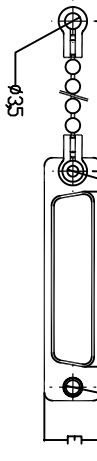

- 09 contacts or shell size E = L17D4K631 09
- 15 contacts or shell size A = L17D4K631 15
- 25 contacts or shell size B = L17D4K631 25
- 37 contacts or shell size C = L17D4K631 37
- 50 contacts or shell size D = L17D4K631 50

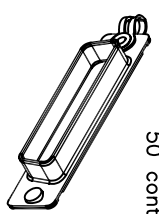
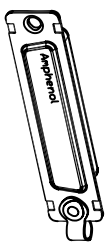

Flat FEMALE dust cover with Chain, for use with MALE connector

Part number

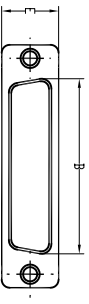

- 09 contacts or shell size E = L17D4K631 10
- 15 contacts or shell size A = L17D4K631 16
- 25 contacts or shell size B = L17D4K631 26
- 37 contacts or shell size C = L17D4K631 38
- 50 contacts or shell size D = L17D4K631 51

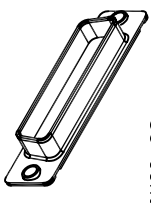
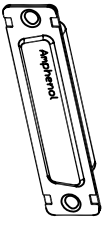

Shell = steel with tin plating

Size	B'	B	K'	K	E
E	16,8	16,4	7,6	7,9	12,4
A	25,1	24,8	7,6	7,9	12,4
B	38,8	38,5	7,6	7,9	12,4
C	55,3	54,9	7,6	7,9	12,4
D	52,7	52,5	7,6	7,9	15,2

DIMENSIONS SPECIFIED		APPROVAL		DATE	
TOLERANCES	U.S.	DRAWN	DATE	CHECKED	DATE
	METRIC	1/16	16/03/07	1/16	16/03/07
		CHECKED	16/03/07	CHECKED	16/03/07
SURFACE FINISH		DRAWING FILE :			
REMOVE SHARP EDGES		TITLE			
DIMENSIONS		Accessory, Dust Cover			
TOLERANCES		SIZE: DRAWING NO.			
TYPICAL		C L17D4K63XXX			
MATERIAL		SCALE NONE			
		SHEET 1 OF 1			

Amphenol

Accessory, Dust Cover

SIZE: DRAWING NO. C L17D4K63XXX

4

3

2

1