

This document is the property of Amphenol Corporation and is delivered on the express condition that it is not to be disclosed, reproduced or used, in whole or in part, for any purpose other than that for which it was originally prepared without the prior consent, in writing, of Amphenol Corporation or to use any information in this document.

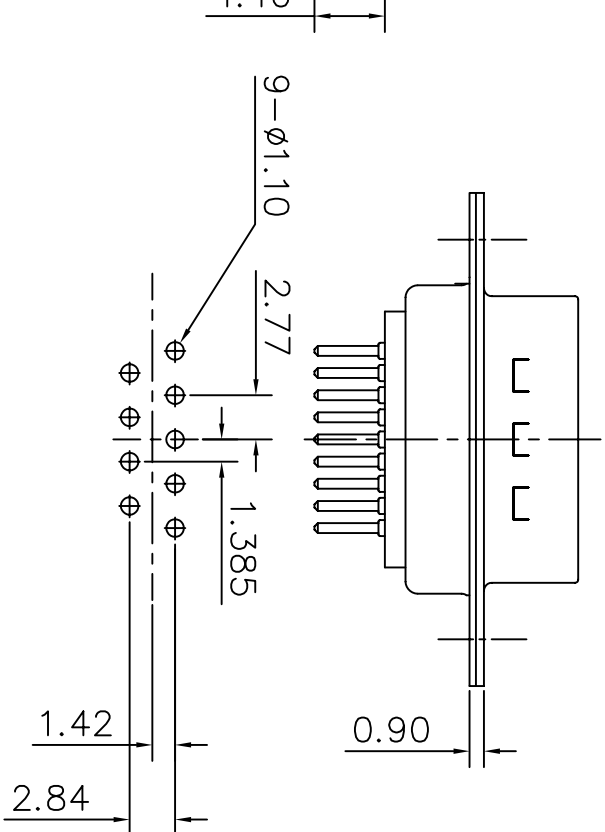
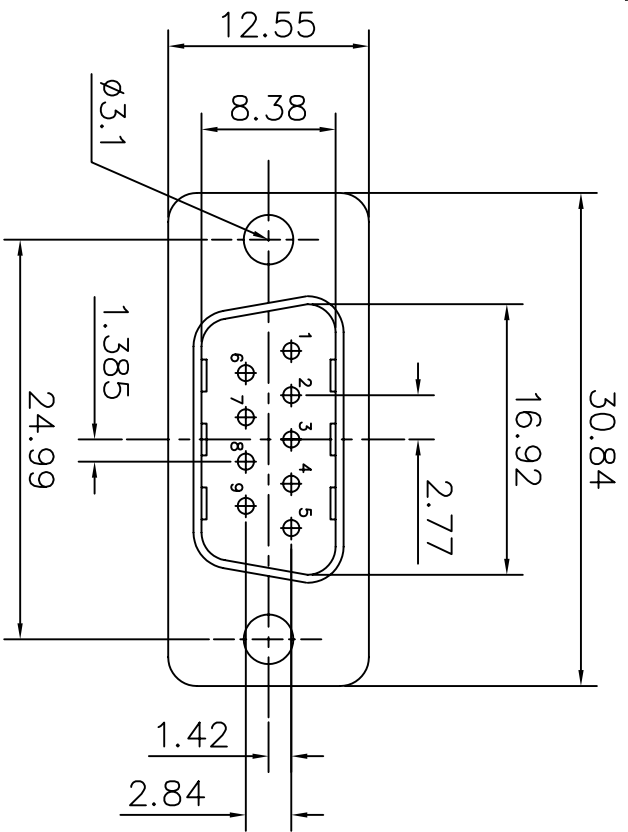

RECOMMENDED P.C.B LAYOUT  
(TOLERANCE +/-0.03)

REVISONS			DATE	APPROVED
SM	EDN	DESCRIPTION	15/01/07	
B				

**D-SUB TECHNICAL DATA**

SHELL : Steel, 100u" min. sn over 50u" min. nickel  
 BODY : Glass filled thermoplastic.  
 Flame retardant to UL94 V-0 Color Black  
 CONTACTS : brass  
 gold flash over 1.25um(50u") min nickel on mating area.  
 2.5um(100u") min sn over 1.25um(50u") min nickel on solder area  
 ELECTRICAL : Voltage rating : 250 V RMS at 50 Hz  
 Current rating :5A  
 Withstanding Voltage >1000 V Rms to 60 Hz for one minute  
 Insulation resistance >5000 M Ohms  
 Contact resistance 25 mOhms max.  
 CLIMATIC : Temperature range -55 °C up to 125°C  
 MACHANICAL : Insertion force per contact<3.41N Max  
 Extraction force per contact 0.21N Min..  
 MARKING : Amphenol...(Series No.)  
 Commercial reference  
 Manufacturing date

**PRODUCT CODE**

**L717SDE 09 P 0L2**

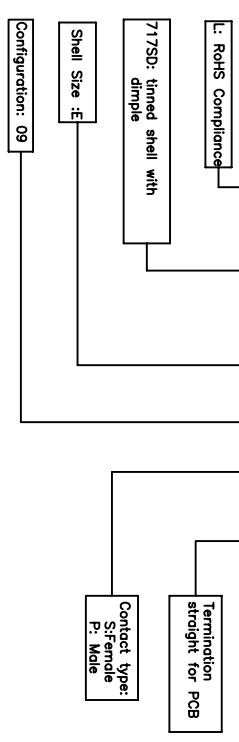

DIMENSIONAL TOLERANCES SPECIFIED	
U.S.	METRIC
XX	0.50
XX	0.30
XX	0.20
ANGLES	2°

APPROVAL	DATE
DRAWN	15/01/07
CHECKED	15/01/07

Amphenol

Stamped and Formed connector, SD series

FOR MATERIALS AND FINISHES REMOVE SHARP EDGES		DRAWING FILE :		ANGLE OF PROJECTION	
THICKNESS	MIN	ISO	ASME	ISO	ASME
SIZE	A4	SIZE	A4	SCALE	NONE
DRAWING NO.	C L717SDE09POL2	SCALE	NONE	SHEET	1 OF 1
REV.	B				